



# City of Gustavus Capital Improvement Plan Project Nomination Short Form

---

## Project eligibility

---

Does the proposed project represent a major, nonrecurring expense? YES X NO ☐

Will the proposed project result in a fixed asset (e.g., land, major equipment, building or other structure, road or trail) with an anticipated life of at least two years? YES X NO ☐

Will the project provide broad community benefit? YES X NO ☐

---

*If you were able to answer YES to all three questions, please provide the following additional information:*

1. Project title (Suggested heading in CIP): **Library Bike Shed**

2. Project description and benefit. Describe the project in half a page or less, including specific features, stages of construction, etc. Explain how the project will benefit the Gustavus community.

The community of Gustavus and its visitors enjoy, and depend upon, using bicycles for transportation. This project would provide a covered bike shed that could be used year-round by library patrons. The shed would be large enough to hold 20 bikes and to accommodate bikes with carts.

This structure would be placed near where the current bike rack is located, which is on the far side of the parking lot facing the forest (not the school).

This structure would serve more than one purpose. Not only would it provide a covered space for bikes, but it would also provide a covered space for outdoor programming in inclement weather and a covered space for patrons to use for internet access when the library is closed. We plan to include benches and small tables for patrons to use inside the structure.

Patrons have long complained about the lack of a covered space to park their bikes at the library. Some patrons squeeze their bikes underneath of the small covered area at the back entrance of the library. This is problematic since it is an entrance and exit and our outdoor book drop is located there. When bikes are parked there it blocks access to the door and the book drop.

This structure would provide a covered space to park bikes, hold programming, and for after-hours internet use. It would also be a way to encourage more patrons to use their bikes, thus reducing our city's carbon footprint.

3. Plans and progress. Describe in one or two paragraphs what has been accomplished so far (if anything). This may include feasibility study, conceptual design, final design/engineering/permitting, fundraising activity, and total funds raised to date.

We have a conceptual design and an estimate for the cost. We would need to fine tune the design and cost, but it would be a simple design of wood construction, yet lovely to look at.

4. Project cost:

A. TOTAL COST (including funds already secured) = **\$32,000**

B. For construction projects, break out preconstruction costs (feasibility/design/permitting):

Preconstruction costs = \$1,200    Construction costs = \$30,800

5. Timeline: Indicate when you hope to complete each phase of the project.

Please keep in mind that the CIP will not be published until the end of September. Legislative funding (if any) would not be available until July of next year (or later) for state funding and October of next year (or later) for federal funding.

A. For projects that consist of land or equipment purchase only, state when the purchase would be made:

\_\_\_\_\_

For construction projects:

B. Preconstruction phase to be completed by: **June 2022**

C. Construction phase to be completed by: **June 2023.**

6. Provide a quality digitized photo, drawing, map, or other graphic image of your project if possible.

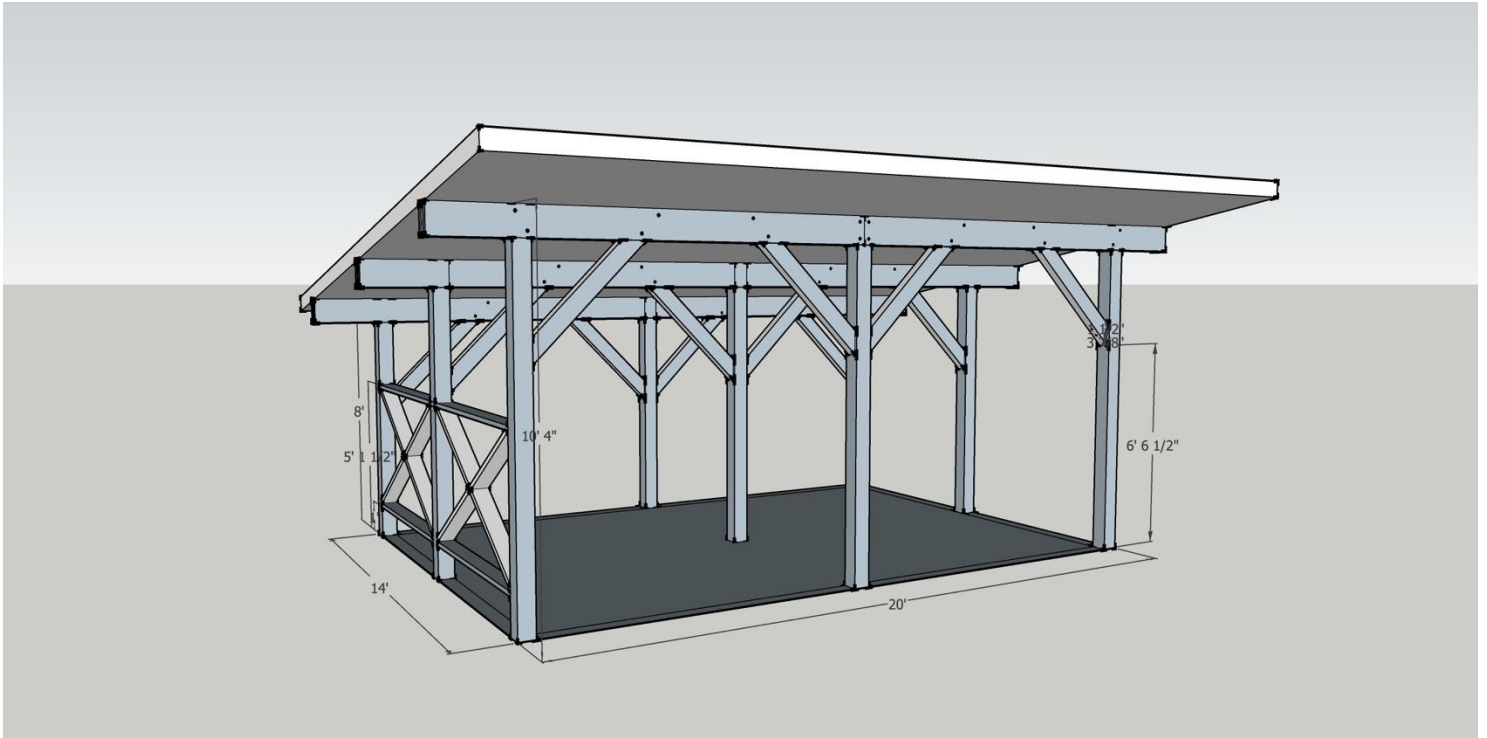

7. Date and name of person submitting form.

Jessie Soder

April 21, 2022