

MEMO 22-50

TO: Frank Schulte, City Administrator  
FROM: Jim Kowalski, Director of Public Services *J.K.*  
DATE: December 16, 2022  
SUBJECT: Recommendation – Chene – Trombley Park Improvement Project – Playground Equipment

On July 11, 2022 Stucky Vitale Architects was awarded phase two and three of the Chene – Trombley Park Improvement Project. The project includes new fencing, a covered picnic area, a rest room, a walking path, a tot lot, and an Americans with Disabilities approved swing set. Existing already in the park is a playscape for children ages 5 to 12 that will remain.

Stucky Vitale Architects obtained a quote from Pro-Techs Surfacing, LLC to purchase the playground equipment for the tot lot and the swing set through the Sourcewell Program for \$101,978.83 (proposal attached – total \$99,643.62 plus the alternate of \$2,335.21). The Sourcewell Program was formally known as the National Joint Powers Alliance (NJPA) Program. The Sourcewell Program is a cooperative purchasing program for states and government agencies and the City can take advantage of this government pricing offered.

To move forward with the Chene – Trombley Park project, I am recommending that Council approve the purchase of the playground equipment from Pro-Tech Surfacing, LLC, PO Box 301, Sharon Center, OH 44274, in the amount of \$101,978.83.

This is a budgeted item included in 2022/2023 fiscal year budget in Municipal Improvements – Parks and Rec account no. 401-902-977.104.

I do not believe any benefit will accrue to the City by seeking further bids. Approved for Council consideration.

*Frank Schulte*  
\_\_\_\_\_  
Frank Schulte, City Administrator

*12-16-22*  
\_\_\_\_\_  
Date

Fund Certification:

Account numbers and amounts have been verified as presented.

*Shawn Murphy*  
\_\_\_\_\_  
Shawn Murphy, Treasurer/Comptroller

\_\_\_\_\_  
Date

**Pro-Techs Surfacing,  
LLC**

**Make all P.O.s, Contracts, and Checks Payable to:  
Pro-Techs Surfacing, LLC.  
PO Box 301  
Sharon Center, OH 44274 USA**

# Proposal

Date	Project #
12/14/2022	23-1392-1

<b>Bill To</b>
City of Grosse Pointe Wood 20025 Mack Avenue Grosse Pointe Woods, MI 48236

<b>Ship To</b>
MRC

<b>Customer Contact</b>	<b>Customer Phone</b>	<b>Customer Fax</b>	<b>Terms</b>	<b>P.O. No.</b>	<b>Rep</b>
	313 343 2450		Net 30		LAS

Item	Description	Qty	Weight	Price	Total
PlayShaper	Chene Trombley Playground Equipment - Sourcewell - Revised Custom PlayShaper Play Structure Per Design #1167847-01-01 - Minus Talk Tubes	1		21,565.86	21,565.86
248819A	We-Go-Round	1		36,247.99	36,247.99
173909A	Log Stepper 28"	1		1,842.12	1,842.12
173908A	Log Stepper 18"	1		1,213.80	1,213.80
173907A	Log Stepper 8"	1		882.30	882.30
233058B	DigiRider Dinosaur	2		1,698.30	3,396.60
173594A	Log Crawl Tunnel	1		7,893.27	7,893.27
123831A	Super Scoop , DB Pine Green	1		1,310.70	1,310.70
123832B	SuperScoop, Wheelchair-Accessible, Direct Bury	1		1,208.70	1,208.70
170793A	Dino Egg Fossil Dig	1		749.70	749.70
170792A	Sea Shells Fossil Dig	1		821.10	821.10
170791A	Fossil Digs - T-Rex Bones	1		749.70	749.70
182503A	Welcome Sign Ages 2-5 years Direct Bury	1		0.00	0.00
141683A	TT Coated Bench 72" w/Back Direct Bury (121 lbs)	3		765.00	2,295.00
100122A	Dino Climber	1		14,524.80	14,524.80
177332A	Single Post Swing Frame 8' Beam Height	1		1,579.72	1,579.72
177333A	Single Post Swing Frame Additional 8' Bay	2		1,172.75	2,345.50
177351A	Molded Bucket Seat w/Harness & ProGuard Chains for 8' Beam Height	2		1,060.29	2,120.58
176038A	Full Bucket Seat w/Chains ProGuard Chains for 8' Beam Height	2		433.76	867.52
174018A	Belt Seat w/Chains ProGuard Chains for 8' Beam Height	2		155.30	310.60
298208	Symbol Communication Sign w/2 Posts DB	1		2,034.90	2,034.90
Freight	Freight			4,000.00	4,000.00
discount	Special Discount for using Sourcewell			-8,316.84	-8,316.84

Proposal good for 30 days.  
Ship Via: common carrier  
Delivery contact name and number: \_\_\_\_\_

Customer signature below constitutes a purchase order.

\_\_\_\_\_

<b>Subtotal</b>
<b>Sales Tax (0.0%)</b>
<b>Total</b>

Penchura, L.L.C. 889 S. Old US 23, Brighton, MI 48114  
Office: (810) 229-6245 Fax: (810) 229-6256 Toll Free: (888) 778-7529

**Pro-Techs Surfacing,  
LLC**

**Make all P.O.s, Contracts, and Checks Payable to:  
Pro-Techs Surfacing, LLC.  
PO Box 301  
Sharon Center, OH 44274 USA**

# Proposal

Date	Project #
12/14/2022	23-1392-1

<b>Bill To</b>
City of Grosse Pointe Wood 20025 Mack Avenue Grosse Pointe Woods, MI 48236

<b>Ship To</b>
MRC

Customer Contact	Customer Phone	Customer Fax	Terms	P.O. No.	Rep
	313 343 2450		Net 30		LAS

Item	Description	Qty	Weight	Price	Total
	* Alternate - (2) Saddle Spinners Model Number 152179A, ADD \$2,335.21				

Proposal good for 30 days.  
Ship Via: common carrier  
Delivery contact name and number: \_\_\_\_\_

Customer signature below constitutes a purchase order.  
  
\_\_\_\_\_

<b>Subtotal</b>	\$99,643.62
<b>Sales Tax (0.0%)</b>	\$0.00
<b>Total</b>	\$99,643.62

Penchura, L.L.C. 889 S. Old US 23, Brighton, MI 48114  
Office: (810) 229-6245 Fax: (810) 229-6256 Toll Free: (888) 778-7529

42'

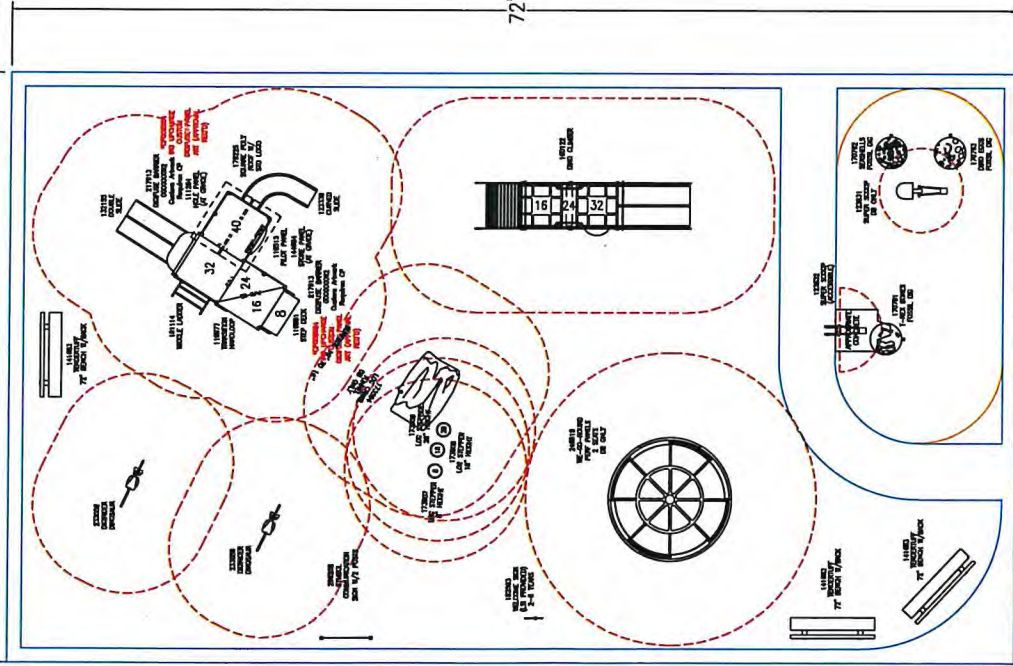

48'-5"

