

694 Peach Tree Ln - 300 ft. Buffer -Publication.csv

Property Address	OwnerName	Ownername2	OwnerAddress	CityStateZip
715 PEAR TREE LN	LOPORTO JOHN J	JOHN J. LOPORTO	715 PEAR TREE LN	GROSSE POINTE WOODS, MI 48236
19831 EDSHIRE LN	MORREALE, JOSEPH	JOSEPH MORREALE	19831 EDSHIRE LN	GROSSE POINTE WOODS, MI 48236
703 PEAR TREE LN	BUTLER TIMOTHY & BEVERLY LIFE ESTAT	TIMOTHY & BEVERLY BUTLER	703 PEAR TREE LN	GROSSE POINTE WOODS, MI 48236
693 PEAR TREE LN	GREENING ROBERT E	ROBERT E. GREENING	693 PEAR TREE LN	GROSSE POINTE WOODS, MI 48236
19817 EDSHIRE LN	CORONA GARY	GARY CORONA	19817 EDSHIRE LN	GROSSE POINTE WOODS, MI 48236
940 CRESCENT LN	VADUVA JON	JON VADUVA	940 CRESCENT LN	GROSSE POINTE WOODS, MI 48236
19806 WEDGEWOOD DR	EUGENIO ROY A	ROY A. EUGENIO	19806 WEDGEWOOD DR	GROSSE POINTE WOODS, MI 48236
19832 EDSHIRE LN	ARJESKI, EUGENE	EUGENE ARJESKI	19832 EDSHIRE LN	GROSSE POINTE WOODS, MI 48236
681 PEAR TREE LN	KRENGAL, BRENNAN	BRENNAN KRENGAL	681 PEAR TREE LN	GROSSE POINTE WOODS, MI 48236
19805 EDSHIRE LN	SHUMAKER, MARGARET M	MARGARET M. SHUMAKER	19805 EDSHIRE LN	GROSSE POINTE WOODS, MI 48236
669 PEAR TREE LN	CLARK PHIL	PHIL CLARK	669 PEAR TREE LN	GROSSE POINTE WOODS, MI 48236
676 PEACH TREE LN	MOCERI DOMINIC	DOMINIC MOCERI	676 PEACH TREE LN	GROSSE POINTE WOODS, MI 48236
19794 WEDGEWOOD DR	WAGNER STEPHEN	STEPHEN WAGNER	19794 WEDGEWOOD DR	GROSSE POINTE WOODS, MI 48236
19818 EDSHIRE LN	LUCIDO JOSEPH A	JOSEPH A. LUCIDO	19818 EDSHIRE LN	GROSSE POINTE WOODS, MI 48236
670 PEACH TREE LN	BESSERT LINK H	LINK H. BESSERT	670 PEACH TREE LN	GROSSE POINTE WOODS, MI 48236
19793 EDSHIRE LN	WELC, TERESA MARIE	TERESA MARIE WELC	19793 EDSHIRE LN	GROSSE POINTE WOODS, MI 48236
19806 EDSHIRE LN	PAQUETTE COURTNEY M	COURTNEY M. PAQUETTE	19806 EDSHIRE LN	GROSSE POINTE WOODS, MI 48236
19778 WEDGEWOOD DR	GUEST MICHAEL J	MICHAEL J. GUEST	19778 WEDGEWOOD DR	GROSSE POINTE WOODS, MI 48236
662 PEACH TREE LN	SHERER SAMUEL B	SAMUEL B. SHERER	662 PEACH TREE LN	GROSSE POINTE WOODS, MI 48236
682 PEACH TREE LN	PERRY EDWARD G	EDWARD G. PERRY	682 PEACH TREE LN	GROSSE POINTE WOODS, MI 48236
19779 EDSHIRE LN	BALCIRAK DAVID	DAVID BALCIRAK	19779 EDSHIRE LN	GROSSE POINTE WOODS, MI 48236
654 PEACH TREE LN	ZACHARIAS JEFFREY	JEFFREY ZACHARIAS	654 PEACH TREE LN	GROSSE POINTE WOODS, MI 48236
19792 EDSHIRE LN	JAYAKAR GANDAM S	GANDAM S. JAYAKAR	19792 EDSHIRE LN	GROSSE POINTE WOODS, MI 48236
19766 WEDGEWOOD DR	MANCILL, GOWANA	GOWANA MANCILL	19766 WEDGEWOOD DR	GROSSE POINTE WOODS, MI 48236
646 PEACH TREE LN	BRESCIAMI ANGELA	ANGELA BRESCIAMI	646 PEACH TREE LN	GROSSE POINTE WOODS, MI 48236
688 PEACH TREE LN	PRUSH KEVIN D	KEVIN D. PRUSH	688 PEACH TREE LN	GROSSE POINTE WOODS, MI 48236
19767 EDSHIRE LN	ASSUMPTION GREEK ORTHODOX CHURCH	ASSUMPTION GREEK ORTHODOX CHURCH	21800 MARTER RD	SAINT CLAIR SHORES, MI 48080
19780 EDSHIRE LN	BUCKLEY LAURA M	LAURA M. BUCKLEY	19767 EDSHIRE LN	GROSSE POINTE WOODS, MI 48236
694 PEACH TREE LN	ALEXANDER PATRICIA LYNN	PATRICIA LYNN ALEXANDER	19780 EDSHIRE LN	GROSSE POINTE WOODS, MI 48236
655 COOK RD	COOK ROAD 2017 LLC	OCCUPANT	PO BOX 171	WARREN, MI 48090
19766 EDSHIRE LN	AMORI JAMES	OCCUPANT	694 PEACH TREE LN	GROSSE POINTE WOODS, MI 48236
679 PEACH TREE LN	NANNAPANENI RAGHU R	OCCUPANT	20250 HARPER AVENUE	HARPER WOODS, MI 48225
665 PEACH TREE LN	BEJIN WILLIAM	JAMES AMORI	655 COOK RD	GROSSE POINTE WOODS, MI 48236
700 PEACH TREE LN	BROWN RODERICK D	RAGHU R. NANNAPANENI	19766 EDSHIRE LN	GROSSE POINTE WOODS, MI 48236
653 PEACH TREE LN	JANSON MELINDA M	WILLIAM BEJIN	679 PEACH TREE LN	GROSSE POINTE WOODS, MI 48236
689 PEACH TREE LN	TENAGLIA, THERESA	RODERICK D. BROWN	665 PEACH TREE LN	GROSSE POINTE WOODS, MI 48236
670 COOK RD	BORDEN GARY L	MELINDA M. JANSON	700 PEACH TREE LN	GROSSE POINTE WOODS, MI 48236
699 PEACH TREE LN	NELSON, SHAWN PETER - CARLA MARIE	TERESA TENAGLIA	653 PEACH TREE LN	GROSSE POINTE WOODS, MI 48236
660 COOK RD		BEN EVOLA	689 PEACH TREE LN	GROSSE POINTE WOODS, MI 48236
		GARY L. BORDEN	670 COOK RD	GROSSE POINTE WOODS, MI 48236
		SHAWN & CARLA NELSON	699 PEACH TREE LN	GROSSE POINTE WOODS, MI 48236
			660 COOK RD	GROSSE POINTE WOODS, MI 48236

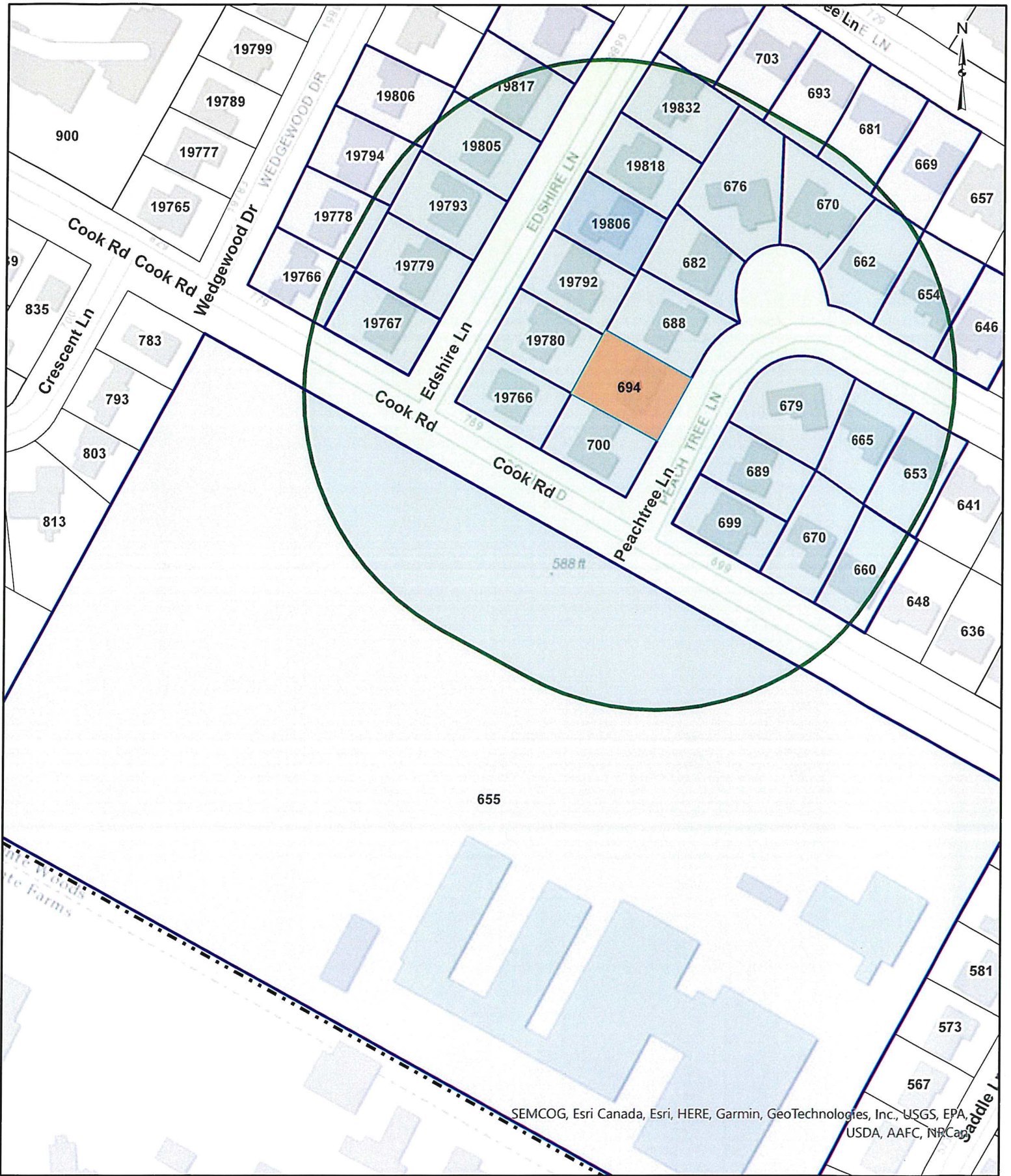

Copyright 1999 - 2021
The City of Grosse Pointe Woods, MI*

Copyright 1999 - 2021
Anderson, Eckstein & Westrick, Inc.*
*All Rights Reserved



Subject: 694 Peach Tree Lane

Date: 11/03/22

SEMCOG, Esri Canada, Esri, HERE, Garmin, GeoTechnologies, Inc., USGS, EPA, USDA, AAFC, NRCap