

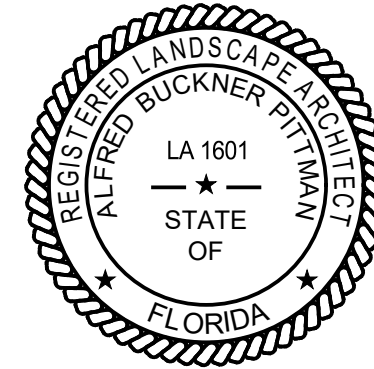

4049 San Servera Dr N
Jacksonville, Florida 32217
ph 904 327 7718 PittmanLA.com

This document has been digitally signed and sealed by:



**Alfred B
Pittman**

Digitally signed by Alfred B Pittman
DN: c=US, o=Pittman Landscape
Architecture,
dnQualifier=A01410D00000180664F
4A6A00095FCD, cn=Alfred B Pittman
Date: 2025.01.08 07:55:27 -05'00'

Printed copies of this document are not considered signed and sealed.
The signature must be verified on the electronic documents.

Pittman Landscape Architecture, Inc.
4049 San Servera Dr. N.
Jacksonville, FL 32217
904-327-7718
www.pittmanLA.com
Landscape Architect Comany No.: LC-26000443
Alfred B. Pittman Individual License: LA-1601

The above named professional landscape architect shall be responsible for the
following sheets in accordance with Chapter 481.321 Florida Statutes:

- DS-1 Digital Signature
- LA1 Tree Removal and Protection Plan
- LA2 Tree Mitigation Table
- LA3 Landscape Plan
- LA4 Landscape Specifications

PLANS PREPARED UNDER THE
DIRECTION OF
Alfred B. Pittman, MLA, PLA
Florida Landscape Architect LA-1601
ISA Certified Arborist FL-5742A

CLIENT

**Springs
Academy**

Green Cove Springs, FL

PROJECT

**Springs
Academy Site
Improvements**

Green Cove Springs, FL

DATE
1-8-25

REVISIONS
No. Date Description

| No. | Date | Description |
|-----|------|-------------|
| | | |
| | | |
| | | |
| | | |
| | | |
| | | |
| | | |

DRAWING TITLE

**DIGITAL
SIGNATURE
SHEET**

SHEET NO.

DS1



4049 San Servera Dr N
Jacksonville, Florida 32217
ph 904 327 7718 PittmanLA.com

PLANS PREPARED UNDER THE
DIRECTION OF
Alfred B. Pittman, MLA, PLA
Florida Landscape Architect LA-1601
ISA Certified Arborist FL-5742A

CLIENT

Springs Academy

Green Cove Springs, FL

PROJECT

Springs Academy Site Improvements

Green Cove Springs, FL

DATE

1-8-25

REVISIONS

| No. | Date | Description |
|-----|------|-------------|
| | | |
| | | |
| | | |
| | | |
| | | |
| | | |
| | | |
| | | |
| | | |
| | | |

DRAWING TITLE

TREE REMOVAL AND PROTECTION PLAN

SHEET NO.

LA1

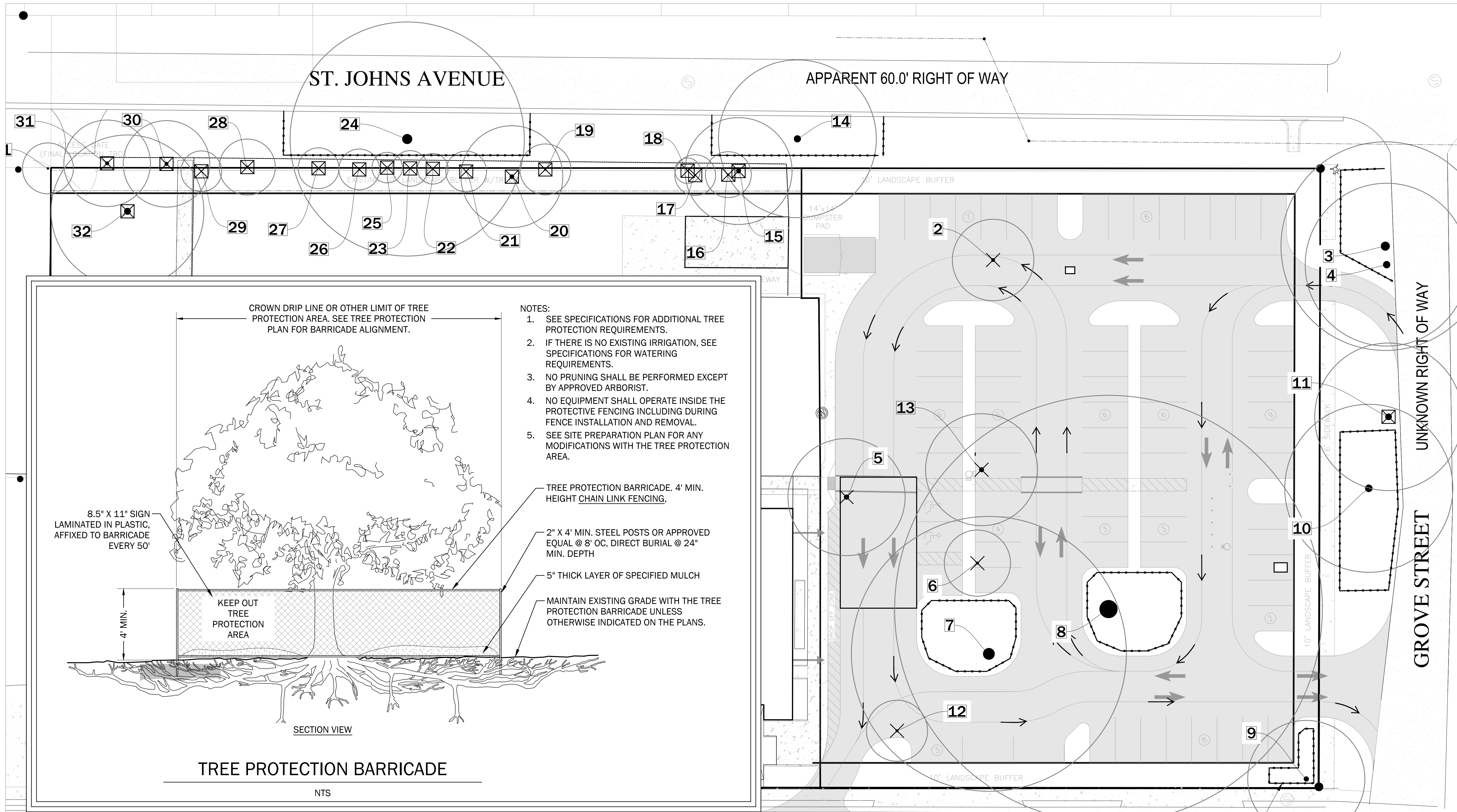

- NOTES:
1. SEE SPECIFICATIONS FOR ADDITIONAL TREE PROTECTION REQUIREMENTS.
 2. IF THERE IS NO EXISTING IRRIGATION, SEE SPECIFICATIONS FOR WATERING REQUIREMENTS.
 3. NO PRUNING SHALL BE PERFORMED EXCEPT BY APPROVED ARBORIST.
 4. NO EQUIPMENT SHALL OPERATE INSIDE THE PROTECTIVE FENCING INCLUDING DURING FENCE INSTALLATION AND REMOVAL.
 5. SEE SITE PREPARATION PLAN FOR ANY MODIFICATIONS WITH THE TREE PROTECTION AREA.

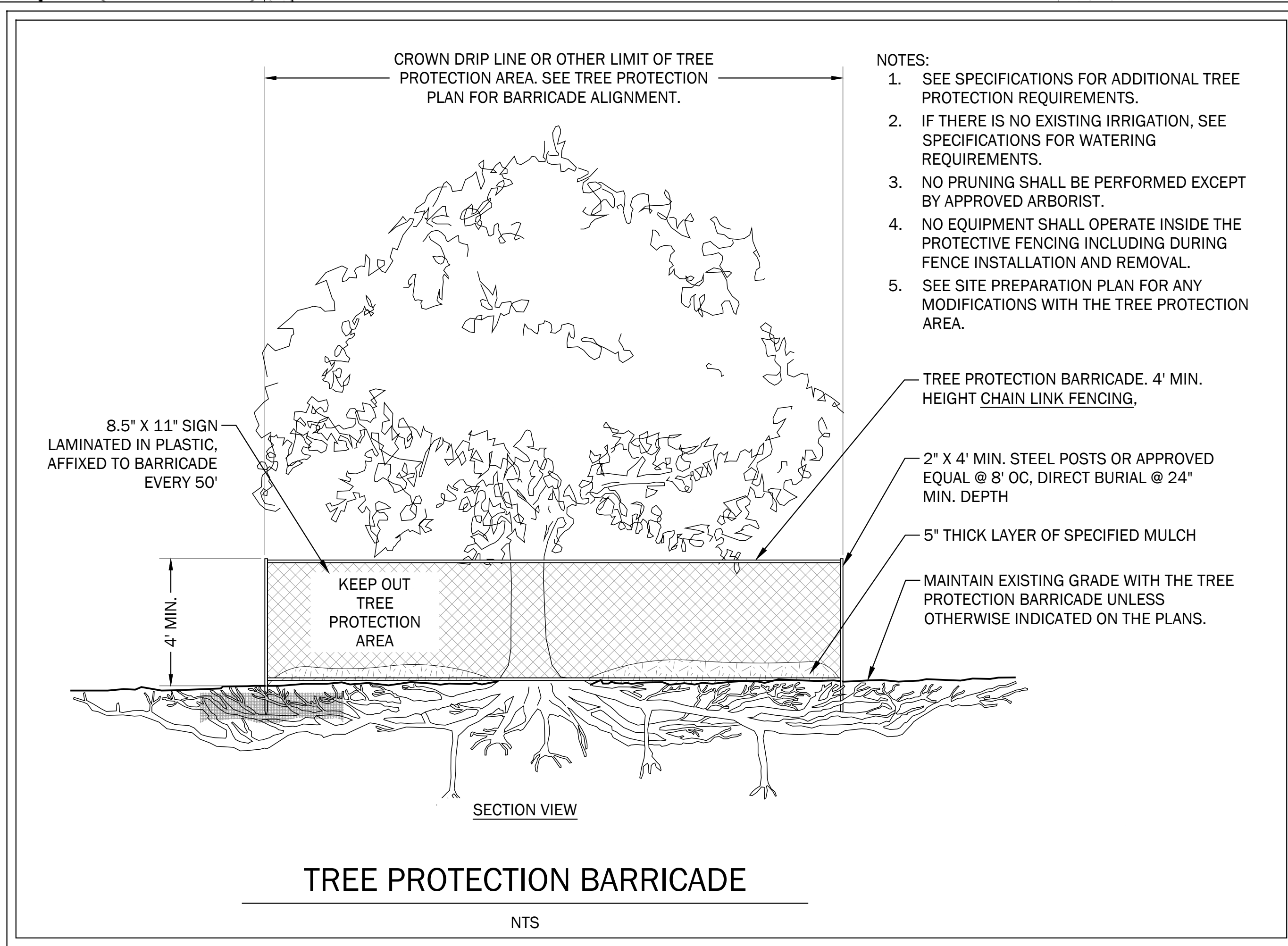

SITE BENCHMARK EL. = 18.63' NORTH ORANGE AVENUE MAGNOLIA AVENUE(P) RIGHT OF WAY UNDETERMINED

- = Existing non-protected tree to be removed
- = Existing protected tree to be removed
- = Existing tree preserved for credit
- = Tree barricade or silt fence

Install tree protection barricade according to the detail in these plans and prior to site clearing and construction activity. Leave barricade intact and in place during construction and remove only when irrigation and landscape plans are ready for installation. Silt fence may be used for tree protection when located at the Limits of Disturbance.

TREE BARRICADE, TYP. SEE DETAIL THIS SHEET

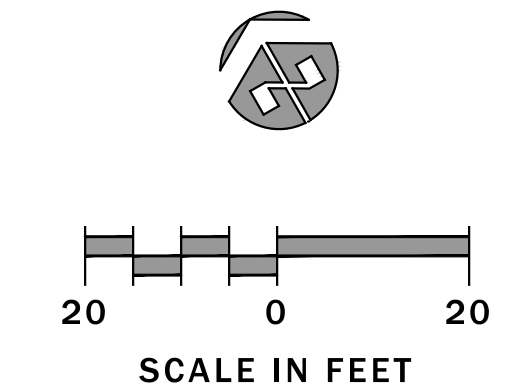

TREE EVALUATION AND MITIGATION TABLE

Project Name: Springs Academy
 Project Location: US 17, Green Cove Springs, Florida
 Protected Tree Jurisdiction: City of Green Cove Springs, Florida
 Development Type: Commercial/Institutional
 Date of Tree Evaluation: 12-23-24
 Evaluator: Alfred B. Pittman ISA Certified Arborist (FL-5742A) and Landscape Architect (Florida LA-1601)
 PITTMAN LANDSCAPE ARCHITECTURE
 4049 San Servera Drive North
 Jacksonville, Florida 32217

Notes: Tree locations and sizes based on tree survey provided by Toco Engineering. This evaluation supercedes the tree survey where discrepancies arise.
 Recommended Action and final inches and mitigation amounts are based on the proposed site plan and are subject to change based on final site design and impact to surveyed trees.
 Unless otherwise noted, protected trees identified for removal are due to unavoidable impact from proposed new construction.



4049 San Servera Dr N
 Jacksonville, Florida 32217
 ph 904 327 7718 PittmanLA.com

PLANS PREPARED UNDER THE DIRECTION OF
 Alfred B. Pittman, MLA, PLA
 Florida Landscape Architect LA-1601
 ISA Certified Arborist FL-5742A

CLIENT

Springs Academy

Green Cove Springs, FL

PROJECT

Springs Academy Site Improvements

Green Cove Springs, FL

DATE
 1-8-25

REVISIONS
 No. Date Description

| No. | Date | Description |
|-----|------|-------------|
| | | |
| | | |
| | | |
| | | |
| | | |
| | | |
| | | |
| | | |
| | | |
| | | |

DRAWING TITLE

TREE MITIGATION TABLE

SHEET NO.

LA2

| Tree No. (See Plan) | Tree Size (Inches DBH, each stem listed separately) | Common Name (Botanical Name) | Condition | Recommended Action | Protected Status by Ordinance | Hardwood Trees Removed (12"+) | Mitigation Rate | Live Oak Required Mitigation: | Southern Magnolia Required Mitigation: | Bald Cypress Required Mitigation: | Other Tree Required Mitigation: |
|---------------------|---|--|--|-------------------------|-------------------------------|-------------------------------|-----------------|-------------------------------|--|-----------------------------------|---------------------------------|
| 1 | 10 | Laurel oak (Quercus laurifolia) | Good condition, healthy | Preserve | Protected | | | | | | |
| 2 | 16 6 | Southern magnolia (Magnolia grandiflora) | Good condition, healthy | Remove for construction | Protected | 32 | 1:1 | | 32 | | |
| 3 | 41 | Live oak (Quercus virginiana) | Good condition, healthy | Preserve | Protected | | | | | | |
| 4 | 33 | Live oak (Quercus virginiana) | Good condition, healthy | Preserve | Protected | | | | | | |
| 5 | 23 | Southern magnolia (Magnolia grandiflora) | Good condition, healthy | Remove for construction | Protected | 23 | 1:1 | | 23 | | |
| 6 | 15 | Southern magnolia (Magnolia grandiflora) | Good condition, healthy | Remove for construction | Protected | 15 | 1:1 | | 15 | | |
| 7 | 54 | Live oak (Quercus virginiana) | Good condition, healthy | Preserve | Protected | | | | | | |
| 8 | 85 | Live oak (Quercus virginiana) | Good condition, healthy | Preserve | Protected | | | | | | |
| 9 | 23 | Laurel oak (Quercus laurifolia) | Good condition, healthy | Preserve | Protected | | | | | | |
| 10 | 34 | Live oak (Quercus virginiana) | Significant dieback in crown, lightning damaged | Remove for construction | Not protected | | | | | | |
| 11 | 30 | Live oak (Quercus virginiana) | Good condition, healthy | Preserve | Protected | | | | | | |
| 12 | 8 8 | Holly (Ilex spp.) | Good condition, healthy | Remove for construction | Protected | 16 | 1:3 | | | | 5 |
| 13 | 22 | Mockernut hickory (Carya tomentosa) | Good condition, healthy | Remove for construction | Protected | 22 | 1:3 | | | | 7 |
| 14 | 32 | Live oak (Quercus virginiana) | Good condition, healthy | Preserve | Protected | | | | | | |
| 15 | 21 | Pindo palm (Butea capitata) | Good condition, healthy | Remove for construction | Not protected | | | | | | |
| 16 | 9 3 | Cherry laurel (Prunus caroliniana) | Good condition, healthy | Remove for construction | Not protected | | | | | | |
| 17 | 8 | Cherry laurel (Prunus caroliniana) | Good condition, healthy | Remove for construction | Not protected | | | | | | |
| 18 | 5 | Laurel oak (Quercus laurifolia) | Good condition, healthy | Remove for construction | Not protected | | | | | | |
| 19 | 10 | Camphor (Cinnamoma camphora) | Good condition, healthy | Remove for construction | Not protected | | | | | | |
| 20 | 20 | Laurel oak (Quercus laurifolia) | Significant trunk deformity, main leader bent with openings and decay, storm-damaged | Remove for construction | Not protected | | | | | | |
| 21 | 8 | Camphor (Cinnamoma camphora) | Good condition, healthy | Remove for construction | Not protected | | | | | | |
| 22 | 6 | Camphor (Cinnamoma camphora) | Good condition, healthy | Remove for construction | Not protected | | | | | | |
| 23 | 7 | Camphor (Cinnamoma camphora) | Good condition, healthy | Remove for construction | Not protected | | | | | | |
| 24 | 46 | Live oak (Quercus virginiana) | Good condition, healthy | Preserve | Protected | | | | | | |
| 25 | 6 | Camphor (Cinnamoma camphora) | Good condition, healthy | Remove for construction | Not protected | | | | | | |
| 26 | 7 8 5 6 | Camphor (Cinnamoma camphora) | Good condition, healthy | Remove for construction | Not protected | | | | | | |
| 27 | 8 | Camphor (Cinnamoma camphora) | Good condition, healthy | Remove for construction | Not protected | | | | | | |
| 28 | 11 1 | Camphor (Cinnamoma camphora) | Good condition, healthy | Remove for construction | Not protected | | | | | | |
| 29 | 8 | Cherry laurel (Prunus caroliniana) | Good condition, healthy | Remove for construction | Not protected | | | | | | |
| 30 | 17 | Pindo palm (Butea capitata) | Good condition, healthy | Remove for construction | Not protected | | | | | | |
| 31 | 17 | Pindo palm (Butea capitata) | Good condition, healthy | Remove for construction | Not protected | | | | | | |
| 32 | 31 | Laurel oak (Quercus laurifolia) | Major opening at base with internal decay, high hazard potential | Remove for construction | Not protected | | | | | | |
| Total Inches | | | | | | 108 | | 0 | 70 | 0 | 13 |

| Total Inches Removed | | Total Inches Planted (See Plant List) | | Balance |
|----------------------|-----------|---------------------------------------|------------|------------|
| Live Oaks | 0 | Live Oaks | 40 | -40 |
| Southern Magnolia | 70 | Southern Magnolia | 54 | 16 |
| Bald Cypress | 0 | Bald Cypress | 0 | 0 |
| Other Tree | 13 | Other | 44 | -31 |
| Totals | 83 | | 138 | -55 |

| TREE MITIGATION | |
|--|--------------|
| Live Oak Deficit | 0.00 |
| Southern Magnolia Deficit | 16.00 |
| Bald Cypress Deficit | 0.00 |
| Total | 16.00 |
| City of Green Cove Springs Tree Mitigation Rate: | \$ 188.00 |



4049 San Servera Dr N
 Jacksonville, Florida 32217
 ph 904 327 7718 PittmanLA.com

PLANS PREPARED UNDER THE
 DIRECTION OF
 Alfred B. Pittman, MLA, PLA
 Florida Landscape Architect LA-1601
 ISA Certified Arborist FL-5742A

CLIENT

Springs Academy

Green Cove Springs, FL

PROJECT

Springs Academy Site Improvements

Green Cove Springs, FL

DATE
 1-8-25

REVISIONS
 No. Date Description

| No. | Date | Description |
|-----|------|-------------|
| | | |
| | | |
| | | |
| | | |
| | | |
| | | |
| | | |
| | | |
| | | |
| | | |

DRAWING TITLE

LANDSCAPE PLAN

SHEET NO.

LA3

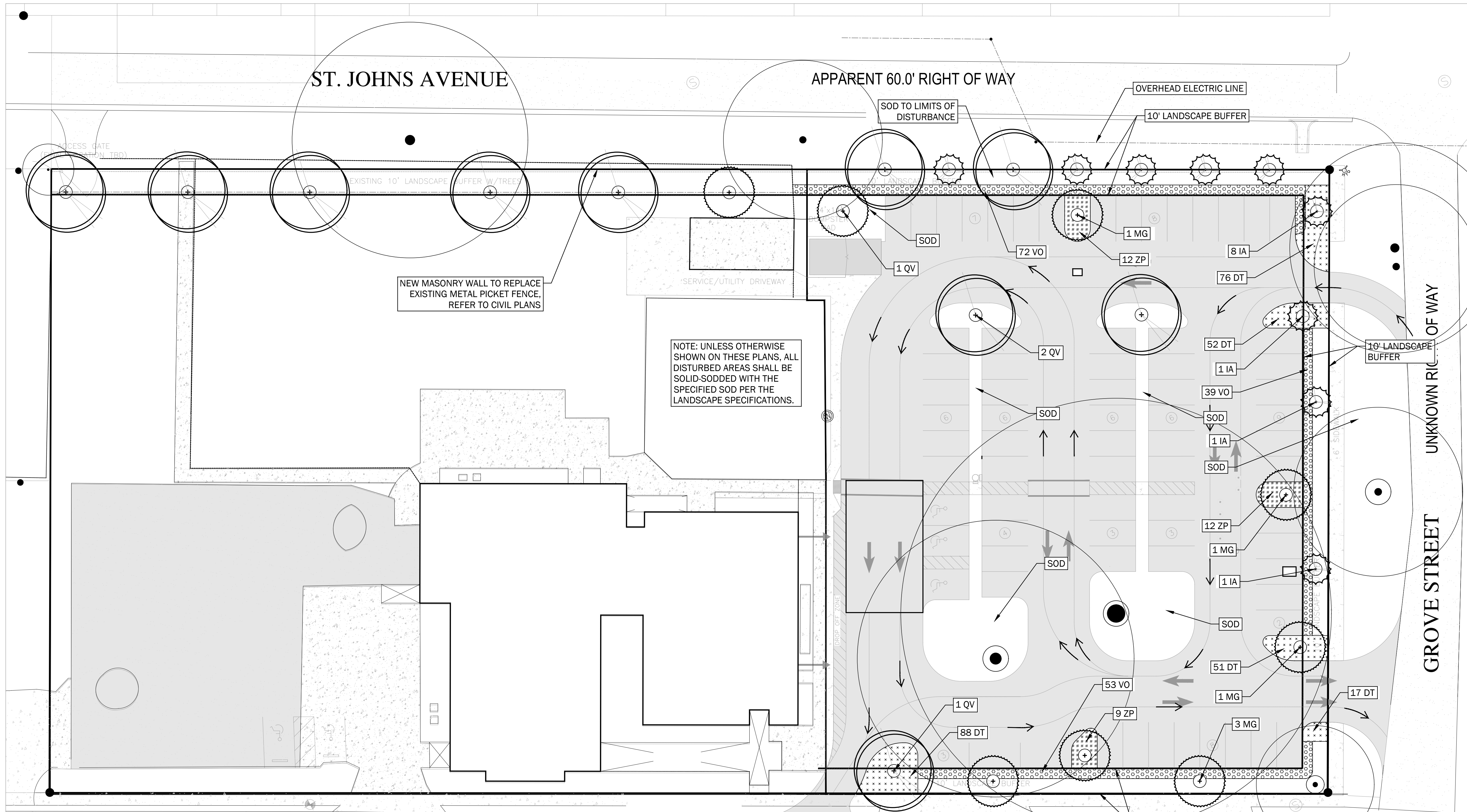

SITE BENCHMARK EL. = 18.63' NORTH ORANGE AVENUE MAGNOLIA AVENUE(P) RIGHT OF WAY UNDETERMINED

