

**CITY OF LOVELAND
REAL PROPERTY**

TO BE ACQUIRED

Permanent Easement Number: PE-8A

FROM

City of Greeley
1000 10th Street
Greeley, CO 80631-3808

FOR

Project Code: 23631-23949
CDOT Project Number: TAP M830-102 - MTF 830-104
Location: Centerra Trail

EXHIBIT "A"

PROJECT CODE: 23631-23949
PROJECT NUMBER: TAP M830-102 - MTF 830-104
PARCEL NUMBER: PE-8A
DATE: MARCH 5, 2021

PROPERTY DESCRIPTION

A Permanent Easement No. PE-8A of the Department of Transportation, State of Colorado Project Code 23631-23949, CDOT Project Number TAP M830-102 - MTF 830-104, containing 38,346 sq. ft. (0.880 acres) more or less located in the Southwest Quarter (SW1/4) of Section Eight (8), Township Five North (T.5N.), Range Sixty-nine West (R.69W.) of the Sixth Principal Meridian (6th P.M.), County of Larimer, State of Colorado, being a portion of Outlot 1 of Waterfall 4th Subdivision, recorded December 14, 2007, as Reception No. 20070093673, of the Records of Larimer County, being more particularly described as follows:

Commencing at the South Quarter Corner of said Section 8; Thence North 41°49'51" East, a distance of 1929.60 feet to the Northerly line of said Outlot 1 of Waterfall 4th Subdivision, said point being also a Point of Curvature (PC) and the POINT OF BEGINNING;

1. THENCE leaving said Northerly line of Outlot 1 along the arc of a non-tangent curve concave to the Northeast, a distance of 234.13 feet, a Radius of 1015.00 feet, a Delta of 13°12'59" and is subtended by a Chord bearing North 76°06'09" West, a distance of 233.61 feet to a Point of Tangency (PT);
2. THENCE along the arc of a reverse curve concave to the Southwest, a distance of 129.61 feet, a Radius of 985.00 feet, a Delta of 07°32'22" and is subtended by a Chord bearing North 73°15'51" West, a distance of 129.52 feet to a Point of Tangency (PT);
3. THENCE North 77°02'01" West, a distance of 490.60 feet to a Point of Curvature (PC);
4. THENCE along the arc of a curve concave to the Southwest, a distance of 308.81 feet, a Radius of 1985.00 feet, a Delta of 08°54'49" and is subtended by a Chord bearing North 81°29'26" West, a distance of 308.50 feet to a Point of Tangency (PT);
5. THENCE along the arc of a reverse curve concave to the Northeast, a distance of 145.53 feet, a Radius of 1015.00 feet, a Delta of 08°12'55" and is subtended by a Chord bearing North 81°50'23" West, a distance of 145.41 feet to a point on the Westerly line of said Outlot 1;
6. THENCE North 00°17'50" East along said Westerly line, a distance of 30.69 feet to a Point of Curvature (PC);
7. THENCE leaving said Westerly line along the arc of a non-tangent curve concave to the Northeast, a distance of 147.60 feet, a Radius of 985.00 feet, a Delta of 08°35'08" and is

subtended by a Chord bearing South 81°39'16" East, a distance of 147.46 feet to a Point of Tangency (PT);

8. THENCE along the arc of a reverse curve concave to the Southwest, a distance of 313.48 feet, a Radius of 2015.00 feet, a Delta of 08°54' 49" and is subtended by a Chord bearing South 81°29'26" East, a distance of 313.16 feet to a Point of Tangency (PT);
9. THENCE South 77°02'01" East, a distance of 490.60 feet to a Point of Curvature (PC);
10. THENCE along the arc of a curve concave to the Southwest, a distance of 133.56 feet, a Radius of 1015.00 feet, a Delta of 07° 32' 22" and is subtended by a Chord bearing South 73°15'51" East, a distance of 133.46 feet to a Point of Tangency (PT);
11. THENCE along the arc of a reverse curve concave to the Northeast, a distance of 155.61 feet, a Radius of 985.00 feet, a Delta of 09°03'05" and is subtended by a Chord bearing South 74°01'12" East, a distance of 155.44 feet to said Northerly line of Outlot 1;
12. THENCE along said Northerly line of Outlot 1 the following two (2) courses:

South 61°49'29" East, a distance of 28.63 feet;

South 56°08'51" East, a distance of 50.08 feet to the POINT OF BEGINNING;

The above described parcel contains 38,346 sq. ft. (0.880 acres), more or less.

The purpose of the above described Permanent Easement is for non-motorized concrete trail.

Basis of Bearings: The basis of bearings for project reference is the South line of the Southwest Quarter (SW1/4) of Section Eight (8), Township Five North (T.5N.), Range Sixty-nine West (R.69W.) of the Sixth Principal Meridian (6th P.M.), County of Larimer, State of Colorado, bearing North 89°39'41" East, based upon GPS observations and the City of Fort Collins Coordinate System, a distance of 2626.48 feet, with all other bearings contained herein relative thereto.

For and on the behalf of
KING SURVEYORS
Vladislav D. Skrejev, PLS 38705
650 East Garden Drive
Windsor, Colorado 80550
(970) 686-5011

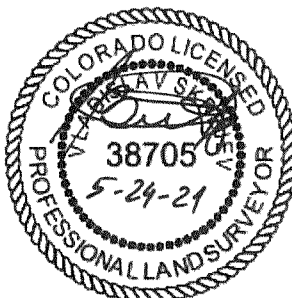

**CITY OF LOVELAND
REAL PROPERTY**

TO BE ACQUIRED

Permanent Easement Number: PE-8B

FROM

City of Greely
1000 10th Street
Greely, CO 80631-3808

FOR

Project Code: 23631-23949
CDOT Project Number: TAP M830-102 - MTF 830-104
Location: Centerra Trail

EXHIBIT "A"

PROJECT CODE: 23631-23949
PROJECT NUMBER: TAP M830-102 - MTF 830-104
PARCEL NUMBER: PE-8B
DATE: MARCH 5, 2021

PROPERTY DESCRIPTION

A Permanent Easement No. PE-8B of the Department of Transportation, State of Colorado Project Code 23631-23949, CDOT Project Number TAP M830-102 - MTF 830-104, containing 1,204 sq. ft. (0.028 acres) more or less located in the Southwest Quarter (SW1/4) of Section Eight (8), Township Five North (T.5N.), Range Sixty-nine West (R.69W.) of the Sixth Principal Meridian (6th P.M.), County of Larimer, State of Colorado, being a portion of Outlot 1 of Waterfall 4th Subdivision, recorded December 14, 2007, as Reception No. 20070093673, of the Records of Larimer County, being more particularly described as follows:

Commencing at the South Quarter Corner of said Section 8; Thence North 53°03'43" East, a distance of 2091.11 feet to the Easterly line of said Outlot 1 of Waterfall 4th Subdivision and the POINT OF BEGINNING;

1. THENCE leaving said Easterly line of Outlot 1 North 42°50'12" West, a distance of 70.46 feet to a Point of Curvature (PC);
2. THENCE along the arc of a reverse curve concave to the Southwest, a distance of 8.81 feet, a Radius of 385.00 feet, a Delta of 01°18'38" and is subtended by a Chord bearing North 43°29'31" West, a distance of 8.81 feet to said Northerly line of Outlot 1;
3. THENCE along said Northerly line the following two (2) courses:
South 76°20'01" East, a distance of 47.56 feet;
South 62°49'01" East, a distance of 8.90 feet to the Northeasterly corner of said Outlot 1;
4. THENCE South 00°12'56" West along the Easterly line of said Outlot 1, a distance of 42.76 feet to the POINT OF BEGINNING;

The above described parcel contains 1,204 sq. ft. (0.028 acres), more or less.

The purpose of the above described Permanent Easement is for non-motorized concrete trail.

Basis of Bearings: The basis of bearings for project reference is the South line of the Southwest Quarter (SW1/4) of Section Eight (8), Township Five North (T.5N.), Range Sixty-nine West (R.69W.) of the Sixth Principal Meridian (6th P.M.), County of Larimer, State of Colorado, bearing North 89°39'41" East, based upon GPS observations and the City of Fort Collins Coordinate System, a distance of 2626.48 feet, with all other bearings contained herein relative thereto.

For and on the behalf of
KING SURVEYORS
Vladislav D. Skrejev, PLS 38705
650 East Garden Drive
Windsor, Colorado 80550
(970) 686-5011

