

Shell Sign Exception (25PLN-31)

Conceptual Plan

1. Vicinity/Aerial Map
2. Applications (Universal, Sign Exception)
3. Sign Proposal

2001 NC Hwy - Vicinity

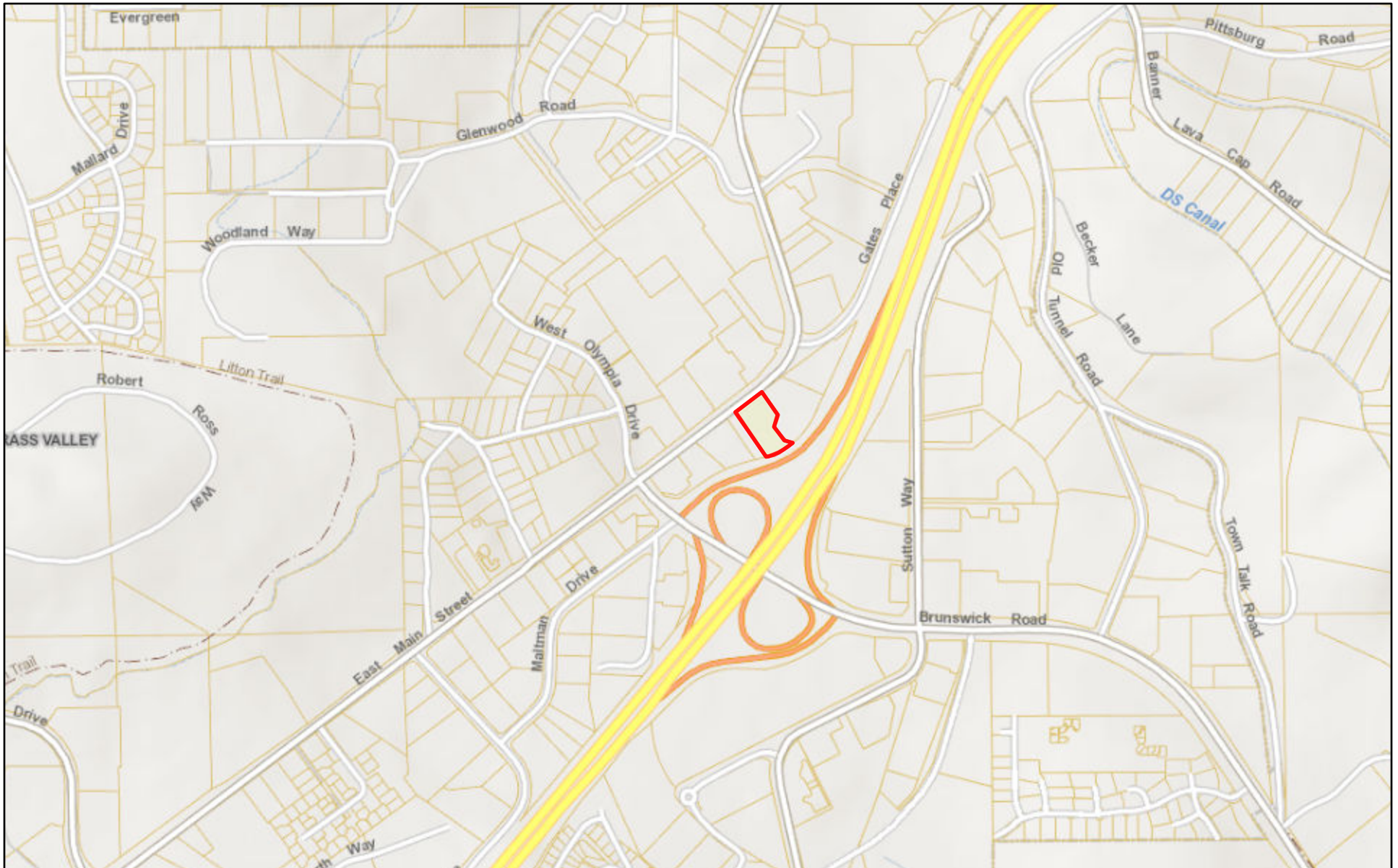

8/11/2025, 2:23:48 PM

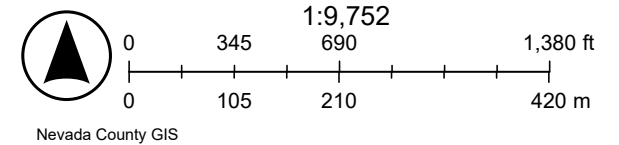

2001 NC Hwy - Aerial



8/11/2025, 12:21:20 PM

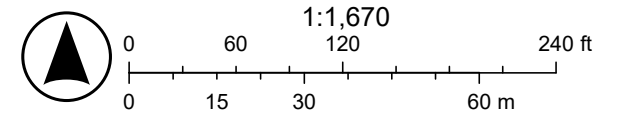

UNIVERSAL PLANNING APPLICATION



Application Types

Administrative

- ☐ Limited Term Permit
\$757.00
- ☐ Zoning Interpretation
\$243.00

Development Review

- ☐ Minor Development Review – under 10,000 sq. ft.
\$1,966.00
- ☐ Major Development Review – over 10,000 sq. ft.
\$3,571.00
- ☐ Conceptual Review - Minor
\$497.00
- ☐ Conceptual Review – Major
\$847.00
- ☐ Plan Revisions – Staff Review
\$342.00
- ☐ Plan Revisions – DRC / PC Review
\$901.00
- ☐ Extensions of Time – Staff Review
\$306.00
- ☐ Extensions of Time – DRC / PC Review
\$658.00

Entitlements

- ☐ Annexation
\$8,505.00 (deposit) + \$20.00 per acre
- ☐ Condominium Conversion
\$5,339.00 (deposit) + \$25 / unit or \$25 / 1,000 sf com.
- ☐ Development Agreement – New
\$20,023.00 (deposit) + cost of staff time & consultant minimum \$300
- ☐ Development Agreement – Revision
\$7,486.00 + cost of staff time & consultant minimum \$300
- ☐ General Plan Amendment
\$8,000.00
- ☐ Planned Unit Development
\$8,839.00 + \$100.00 /unit and / or \$100 / 1,000 sf floor area
- ☐ Specific Plan Review - New
Actual costs - \$18,399.00 (deposit) (+ consultant min. \$300)
- ☐ Specific Plan Review - Amendments / Revisions
Actual costs - \$7,576.00 (deposit) (+ consultant min. \$300)
- ☐ Zoning Text Amendment
\$3,364.00
- ☐ Zoning Map Amendment
\$5,501.00
- ☐ Easements (covenants & releases)
\$1,794.00

Environmental

- ☐ Environmental Review – Initial Study
\$1,858.00
- ☐ Environmental Review – EIR Preparation
Actual costs - \$34,274.00 (deposit)
- ☐ Environmental Review - Notice of Determination
\$162.00 (+ Dept. of Fish and Game Fees)

☐

Environmental Review - Notice of Exemption
\$162.00 (+ County Filing Fee)

Sign Reviews

- ☐ Minor – DRC, Historic District, Monument Signs or other districts having specific design criteria
\$330.00
- ☐ Major – Master Sign Programs
\$1,407.00
- ☒ Exception to Sign Ordinance
\$1,046.00

Subdivisions

- ☐ Tentative Map (4 or fewer lots)
\$3,788.00
- ☐ Tentative Map (5 to 10 lots)
\$5,267.00
- ☐ Tentative Map (11 to 25 lots)
\$7,053.00
- ☐ Tentative Map (26 to 50 lots)
\$9,668.00
- ☐ Tentative Map (51 lots or more)
\$14,151.00
- ☐ Minor Amendment to Approved Map (staff)
\$1,208.00
- ☐ Major Amendment to Approved Map (Public Hearing) \$2,642.00
- ☐ Reversion to Acreage
\$829.00
- ☐ Tentative Map Extensions
\$1,136.00
- ☐ Tentative Map - Lot Line Adjustments/Merger
\$1,325.00

Use Permits

- ☐ Minor Use Permit - Staff Review
\$562.00
- ☐ Major Use Permit - Planning Commission Review
\$3,292.00

Variances

- ☐ Minor Variance - Staff Review
\$562.00
- ☐ Major Variance - Planning Commission Review
\$2,200.00

Application	Fee
Exception to Sign Ordinance	\$1,046.00
Total*:	\$1,046.00

**Additional fees may be assessed by Nevada County Environmental Health and/or NSAQMD for services rendered for application review.*

Below is the Universal Planning Application form and instructions for submitting a complete planning application. In addition to the Universal Planning Application form, a project specific checklist shall be submitted. All forms and submittal requirements must be completely filled out and submitted with any necessary supporting information.

Upon receipt of the **completed forms, site plan/maps, and filing fees**, the Community Development Department will determine the completeness of the application. This review will be completed as soon as possible, but within thirty (30) days of the submittal of the application. If the application is determined to be complete, the City will begin environmental review, circulate the project for review by agencies and staff, and then schedule the application for a hearing before the Planning Commission.

If sufficient information **has not** been submitted to adequately process your application, you will receive a notice that your application is incomplete along with instructions on how to complete the application. Once the City receives the additional information or revised application, the thirty (30) day review period will begin again.

Since the information contained in your application is used to evaluate the project and in the preparation of the staff report, it is important that you provide complete and accurate information. Please review and respond to each question. If a response is not applicable, N/A should be used in the space provided. Failure to provide adequate information could delay the processing of your application.

Additional information may be obtained at www.cityofgrassvalley.com regarding the 2020 General Plan and Zoning. You may also contact the Community Development Department for assistance.

ADVISORY RE: FISH AND GAME FEE REQUIREMENT

Permit applicants are advised that pursuant to Section 711.4 of the Fish and Game Code a fee of **\$3,445.25** for an Environmental Impact Report and **\$2,480.25** for a Negative Declaration* shall be paid to the County Recorder at the time of recording the Notice of Determination for this project. This fee is required for Notices of Determination recorded after January 1, 1991. A Notice of Determination cannot be filed and any approval of the project shall not be operative, vested, or final until the required fee is paid. This shall mean that building, public works and other development permits cannot be approved until this fee is paid. These fees are accurate at the time of printing, but **increase the subsequent January 1st** of each year.

This fee is **not** a Grass Valley fee; it is required to be collected by the County pursuant to State law for transmission to the Department of Fish and Game. This fee was enacted by the State Legislature in September 1990, to be effective January 1, 1991.

*If the City finds that the project will not have an impact on wildlife resources, through a De Minimus Impact Finding, the City will issue certificate of fee exemption. Therefore, this fee will not be required to be paid at the time an applicant files the Notice of Determination with the County Recorder. The County's posting and filing fees will still be required.

4. **Cortese List:** Is the proposed property located on a site which is included on the Hazardous Waste and Substances List (Cortese List)? Y _____ N xxxxxx

The Cortese List is available for review at the Community Development Department counter. If the property is on the List, please contact the Planning Division to determine appropriate notification procedures prior to submitting your application for processing (Government Code Section 65962.5).

5. **Indemnification:** The City has determined that City, its employees, agents and officials should, to the fullest extent permitted by law, be fully protected from any loss, injury, damage, claim, lawsuit, expense, attorney's fees, litigation expenses, court costs or any other costs arising out of or in any way related to the issuance of this permit, or the activities conducted pursuant to this permit. Accordingly, to the fullest extent permitted by law, the applicant shall defend, indemnify and hold harmless City, its employees, agents and officials, from and against any liability, claims, suits, actions, arbitration proceedings, regulatory proceedings, losses, expenses or costs of any kind, whether actual, alleged or threatened, including, but not limited to, actual attorney's fees, litigation expenses and court costs of any kind without restriction or limitation, incurred in relation to, as a consequence of, arising out of or in any way attributable to, actually, allegedly or impliedly, in whole or in part, the issuance of this permit, or the activities conducted pursuant to this permit. Applicant shall pay such obligations as they are incurred by City, its employees, agents and officials, and in the event of any claim or lawsuit, shall submit a deposit in such amount as the City reasonably determines necessary to protect the City from exposure to fees, costs or liability with respect to such claim or lawsuit.
6. **Appeal:** Permits shall not be issued until such time as the appeal period has lapsed. A determination or final action shall become effective on the 16th day following the date by the appropriate review authority, where no appeal of the review authority's action has been filed in compliance with Chapter 17.91 of the City's Development Code.

The 15-day period (also known as the "appeal" period in compliance with Chapter 17.91) begins the first full day after the date of decision that the City Hall is open for business, and extends to the close of business (5:00 p.m.) on the 15th day, or the very next day that the City Hall is open for business.

I hereby certify, to the best of my knowledge, that the above statements are correct.

Property Owner/*Representative Signature: _____

****Property owner must provide a consent letter allowing representative to sign on their behalf.***

Applicant Signature: _____

--OFFICE USE ONLY--	
Application No.:	Date Filed:
Fees Paid by:	Amount Paid:
Other Related Application(s):	

MASTER SIGN PROGRAM MURALS & SIGN EXCEPTIONS



SUPPLEMENTAL APPLICATION INFORMATION

Application Request: SIGN EXCEPTIONS FOR INTERNAL ILLUMINATION OF THE EXISTING PRICE/ID SIGN, NEW PROPOSED CANOPY SIGNS, AND THE NEW PROPOSED LED RED BARS ON THE CANOPY FASCIA.

Property Address or Location: 2001 NEVADA CITY HIGHWAY

SUPPLEMENTAL CHECKLIST

The following includes items required for a complete application. Some specific types of information may not apply to your project. If you are unsure, check with Planning Division Staff. A copy of this list will be returned to you if your application is determined to be incomplete.

A. Application Checklist:

- ☒ One completed copy of Universal Application form.
- ☐ One completed copy of the Environmental Review Checklist (if applicable).
- ☒ One electronic copy of the site plan and all other applicable plans/information.
- ☐ One materials sample board (if applicable).
- ☒ If a sign exemption is being requested, list the reasons for the exemption.
- ☒ The appropriate non-refundable filing fee.

B. Site Plan:

- ☒ SITE PLAN; On electronic copy of the Site Plan for the property on which the sign(s) will be placed including:
- ☒ Location of existing and proposed signs on site.
- ☒ Provide square footage and type of each sign and total square footage for all signs.
- ☒ For more than one sign, please give each sign a number starting with the number 1.
- ☐ For suspended or projecting signs please note distance from sidewalk to bottom of sign.

- ☐ For wall signs add an additional sheet showing dimensions and square footage of building walls on which signs will be placed.
- ☐ For monument, shopping center, or other freestanding signs show sight distance from driveways and intersection corners.

C. Sign Illustrations:

- ☒ Color drawing of each proposed sign including:
- ☒ Number each sign corresponding to number shown on the site plan.
- ☒ Message on sign including; typeface, font, and design details.
- ☒ Dimensions in feet and total square footage area of proposed sign.
- ☒ Overall height of all monument and freestanding signs.

D. Murals: A mural placed on a wall of a structure may be allowed in any commercial, industrial, and other non-residential zone subject to the following requirements. All murals shall be subject to the review and recommendation by the Development Review Committee (DRC) and approval by the Commission.

- ☐ A mural without text visible from the public right-of-way may be approved in addition to (not counted as part of) the sign area allowed by the Development Code; a mural with text shall comply with the sign area limitations applicable to the site.
- ☐ Murals that illustrate the local setting, history, or cultural significance as sources of inspiration are encouraged.
- ☐ The approval of a mural shall require that the review authority first find that the colors, placement, and size of the mural are visually compatible with the structure's architecture, and that the mural will serve to enhance the aesthetics of the City.

E. Mounting Details:

- ☐ Mounting details may be placed on the Sign Plan or as a separate sheet but must include the following:
- ☐ Description of material used in construction of sign.
- ☐ Thickness and approximate weight of sign for suspended or projecting signs.
- ☐ Means of exterior or interior lighting including shielding, type, and size of lamps (if applicable).
- ☐ For suspended signs provide details of anti-sway devices.

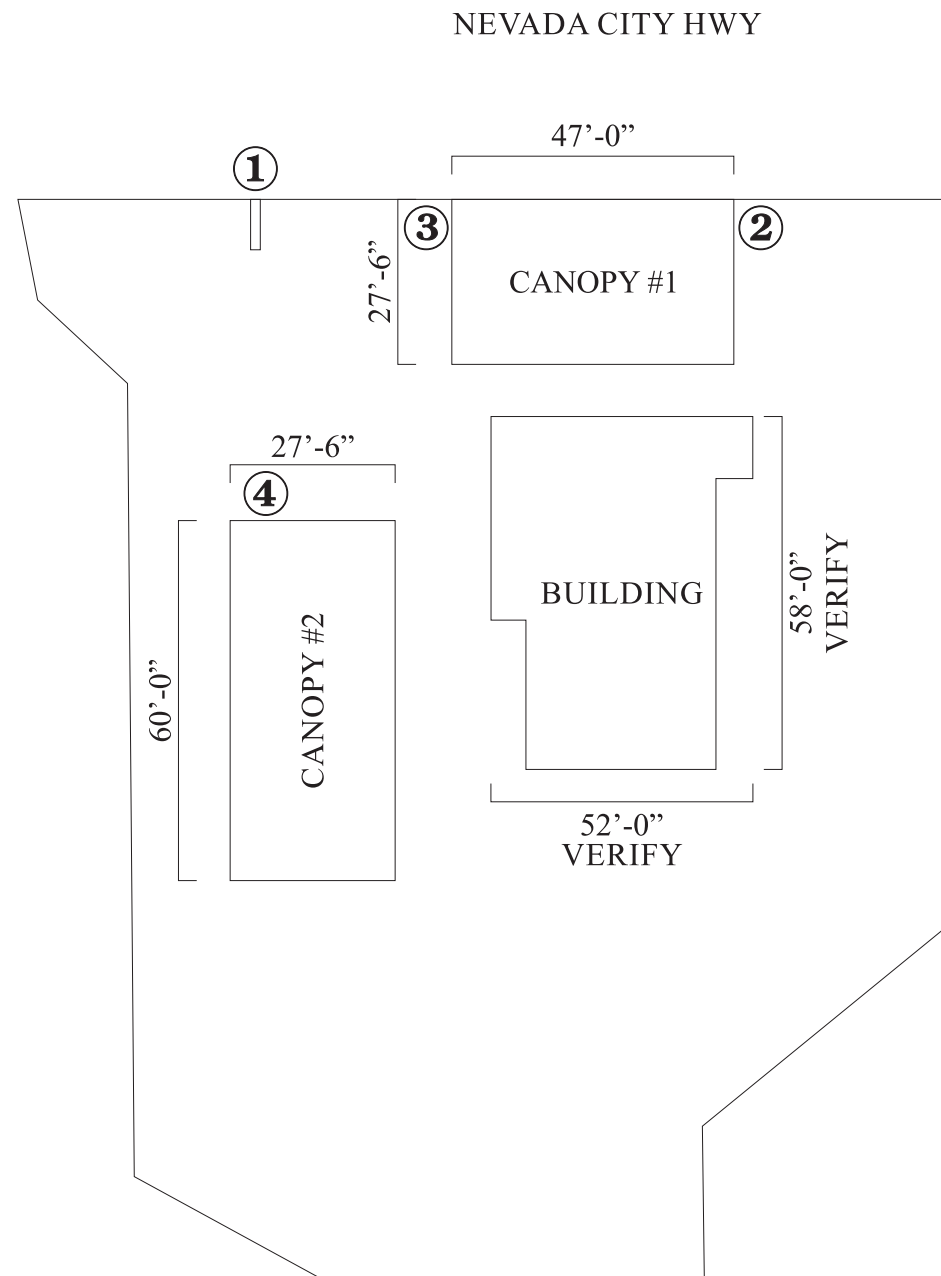

SITE PLAN
SCALE: 1/32" = 1'-0"



EXISTING SITE

SUBJECT TO CITY AND SHELL APPROVALS



Sign Development Inc.

License #576277

Upland, CA 91786 (909) 920-5535

PROPRIETARY INFORMATION. The information disclosed in this document, including all drawings, designs and related materials, is the valuable and proprietary information of Sign Development Inc. It is provided solely for the purpose of evaluation for purchase and, without the express written authorization of Sign Development Inc., may not be disclosed or duplicated, in whole or in part, for any reason. Sign Development Inc. expressly reserves all patent, copyright and other proprietary rights to this document, including all design, manufacturing, reproduction, use, and sales rights thereto. © 2011 SIGN DEVELOPMENT INC.

CUSTOMER APPROVAL

SIGN AND PRINT FULL NAME

DATE

NO. Z1610

DATE: 06.10.25BA

REV: 06.11.25BA

PAGE: 1 OF 10



**2001 NEVADA CITY HWY.
GRASS VALLEY, CA 95945**

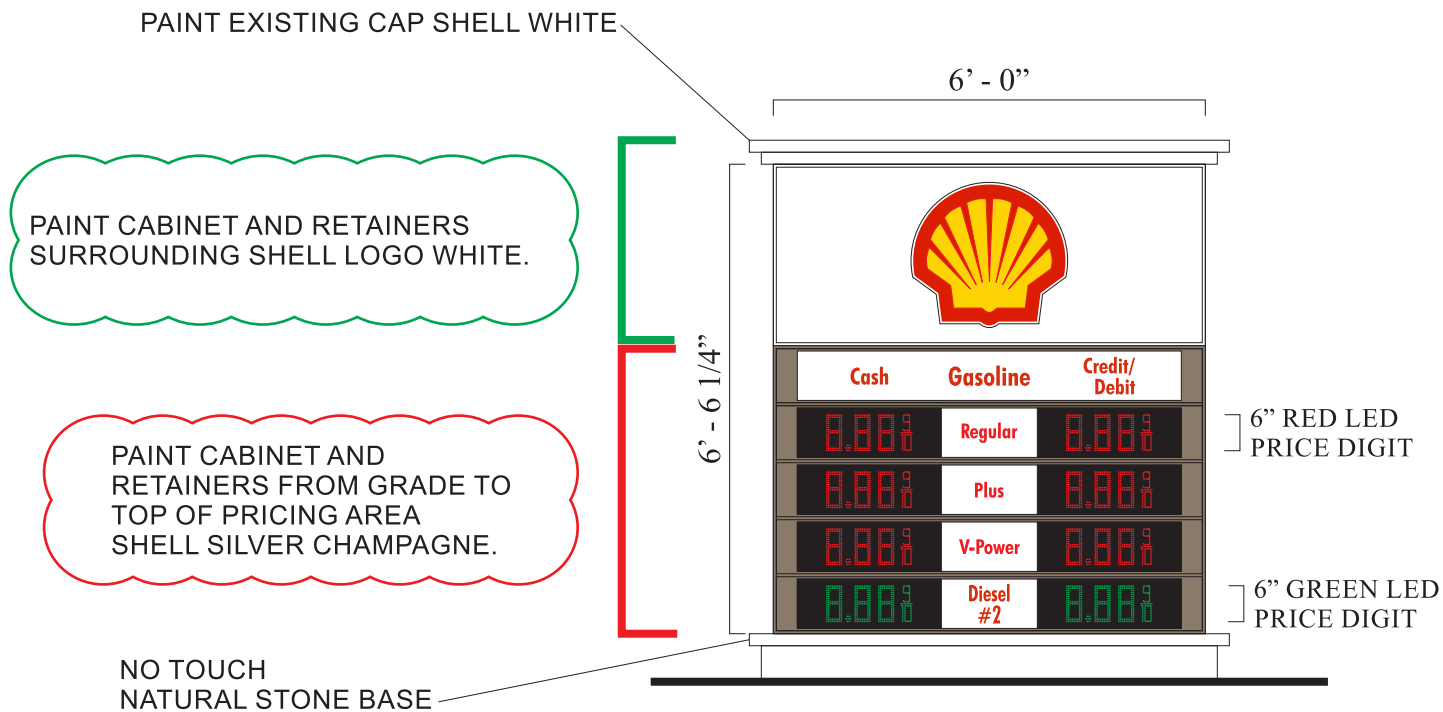

IMPORTANT: INSTALLER MUST REGISTER ALL LED SIGNS WITH ABLE. PLEASE CALL 614-388-8866 BEFORE 2:00PST TO REGISTER. MUST FORWARD CONFIRMATION NUMBER TO SDI AND WRITE REGISTRATION # INSIDE CABINET. FAILURE TO PROVIDE SDI WITH REGISTRATION # WILL DELAY PAYMENT.

INSTALL NEW 25 AMP PHOTO CELL TO CONTROL ALL BACKLIGHTING.

INSTALLER TO ADD SILICONE TO WIRE WAY INSIDE NIPPLE.

INCLUDES POS INTERFACE HANDSET

- ① INSTALL NEW LED INTERNAL ILLUMINATION TO EXISTING SIGN CABINET. USING EXISTING ELECTRICAL. REFACE EXISTING D/F PRICE/ID SIGN.
- ELECTRICAL: EXISTING SHOULD BE DEDICATED CIRCUITS, SDI IS NOT RESPONSIBLE FOR RUNNING NEW CIRCUITS OR SEPARATING EXISTING CIRCUITS FROM OTHER EQUIPMENT.**

EXISTING SIGN CABINET DOES NOT HAVE INTERNAL ILLUMINATION

REMOVE EXISTING GROUND MOUNTED SPOT LIGHTS. DISCONNECT AND CAP ELECTRICAL.



EXISTING D/F PRICE/ID SIGN

SUBJECT TO CITY AND SHELL APPROVALS



Sign Development Inc.

License #576277

Upland, CA 91786 (909) 920-5535

PROPRIETARY INFORMATION. The information disclosed in this document, including all drawings, designs and related materials, is the valuable and proprietary information of Sign Development Inc. It is provided solely for the purpose of evaluation for purchase and, without the express written authorization of Sign Development Inc., may not be disclosed or duplicated, in whole or in part, for any reason. Sign Development Inc. expressly reserves all patent, copyright and other proprietary rights to this document, including all design, manufacturing, reproduction, use, and sales rights thereto. © 2011 SIGN DEVELOPMENT INC.

CUSTOMER APPROVAL

SIGN AND PRINT FULL NAME

DATE

NO. Z1610

PAGE: 2 OF 10

DATE: 06.10.25BA

REV: 06.11.25BA



2001 NEVADA CITY HWY.
GRASS VALLEY, CA 95945

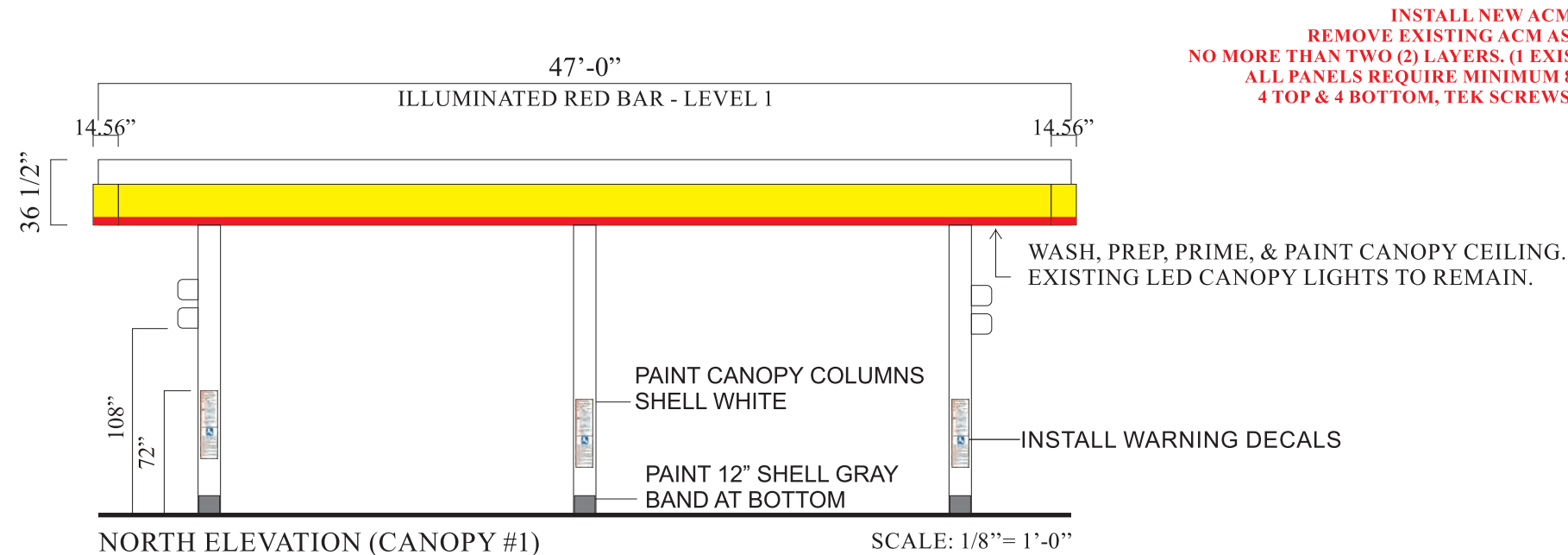

INSTALL NEW ACM.
REMOVE EXISTING ACM AS NEEDED,
NO MORE THAN TWO (2) LAYERS. (1 EXISTING + 1 NEW LAYER)
ALL PANELS REQUIRE MINIMUM 8 TECH SCREWS,
4 TOP & 4 BOTTOM, TEK SCREWS PER 10' PANEL



EXISTING NORTH ELEVATION (CANOPY #1)

PAINT CANOPY COLUMNS SHELL WHITE WITH 12" SHELL GRAY BAND AT BOTTOM.
PAINT BUMPER POLES SHELL WHITE WITH 12" SHELL GRAY BAND AT BOTTOM.
SUPPLY AND INSTALL FOUR (4) LARGE CSUs.
SUPPLY AND INSTALL FLAG SIGNS.
SUPPLY AND INSTALL TANK TAGS. (TAKE BEFORE AND AFTER PHOTOS OF NEW TANKS INSTALLED.)
PAINT FILL TANK LIDS PER EXISTING COLORS
ELECTRICAL: EXISTING SHOULD BE DEDICATED CIRCUITS, SDI IS NOT RESPONSIBLE FOR RUNNING NEW CIRCUITS OR SEPARATING EXISTING CIRCUITS FROM OTHER EQUIPMENT

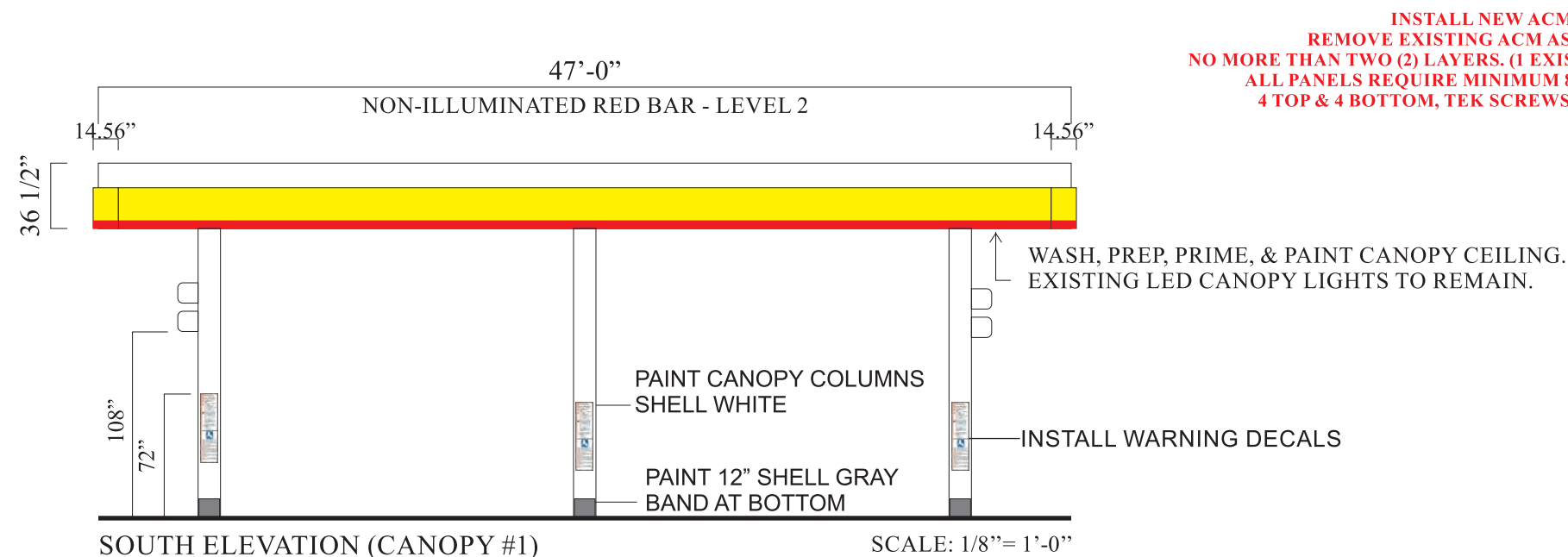

INSTALL NEW ACM.
REMOVE EXISTING ACM AS NEEDED,
NO MORE THAN TWO (2) LAYERS. (1 EXISTING + 1 NEW LAYER)
ALL PANELS REQUIRE MINIMUM 8 TECH SCREWS,
4 TOP & 4 BOTTOM, TEK SCREWS PER 10' PANEL

SUBJECT TO CITY AND SHELL APPROVALS



Sign Development Inc.

License #576277

Upland, CA 91786 (909) 920-5535

PROPRIETARY INFORMATION. The information disclosed in this document, including all drawings, designs and related materials, is the valuable and proprietary information of Sign Development Inc. It is provided solely for the purpose of evaluation for purchase and, without the express written authorization of Sign Development Inc., may not be disclosed or duplicated, in whole or in part, for any reason. Sign Development Inc. expressly reserves all patent, copyright and other proprietary rights to this document, including all design, manufacturing, reproduction, use, and sales rights thereto. © 2011 SIGN DEVELOPMENT INC.

CUSTOMER APPROVAL

SIGN AND PRINT FULL NAME

DATE

NO. Z1610

PAGE: 3 OF 10

DATE: 06.10.25BA

REV: 06.11.25BA



**2001 NEVADA CITY HWY.
GRASS VALLEY, CA 95945**

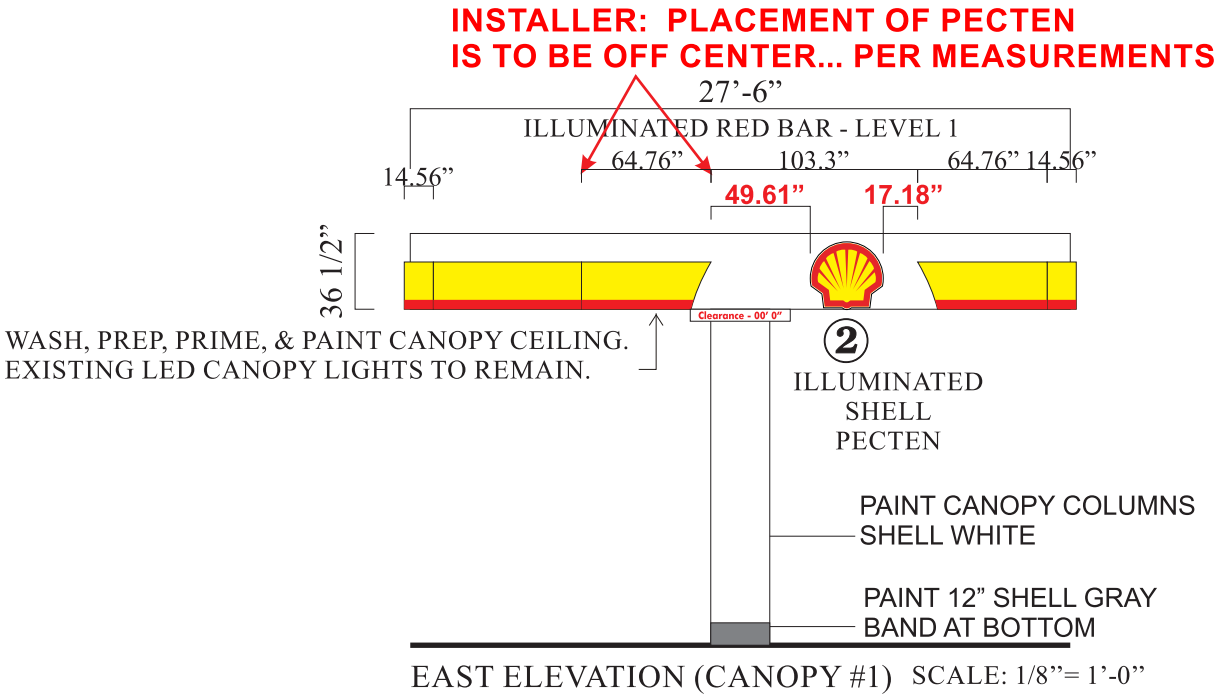

INSTALL NEW ACM.
REMOVE EXISTING ACM AS NEEDED,
NO MORE THAN TWO (2) LAYERS. (1 EXISTING + 1 NEW LAYER)
ALL PANELS REQUIRE MINIMUM 8 TECH SCREWS,
4 TOP & 4 BOTTOM, TEK SCREWS PER 10' PANEL



EXISTING EAST ELEVATION (CANOPY #1)

PAINT CANOPY COLUMNS SHELL WHITE WITH 12" SHELL GRAY BAND AT BOTTOM.
PAINT BUMPER POLES SHELL WHITE WITH 12" SHELL GRAY BAND AT BOTTOM.
SUPPLY AND INSTALL FOUR (4) LARGE CSUs.
SUPPLY AND INSTALL FLAG SIGNS.
SUPPLY AND INSTALL TANK TAGS. (TAKE BEFORE AND AFTER PHOTOS OF NEW TANKS INSTALLED.)
PAINT FILL TANK LIDS PER EXISTING COLORS
ELECTRICAL: EXISTING SHOULD BE DEDICATED CIRCUITS, SDI IS NOT RESPONSIBLE FOR RUNNING NEW CIRCUITS OR SEPARATING EXISTING CIRCUITS FROM OTHER EQUIPMENT

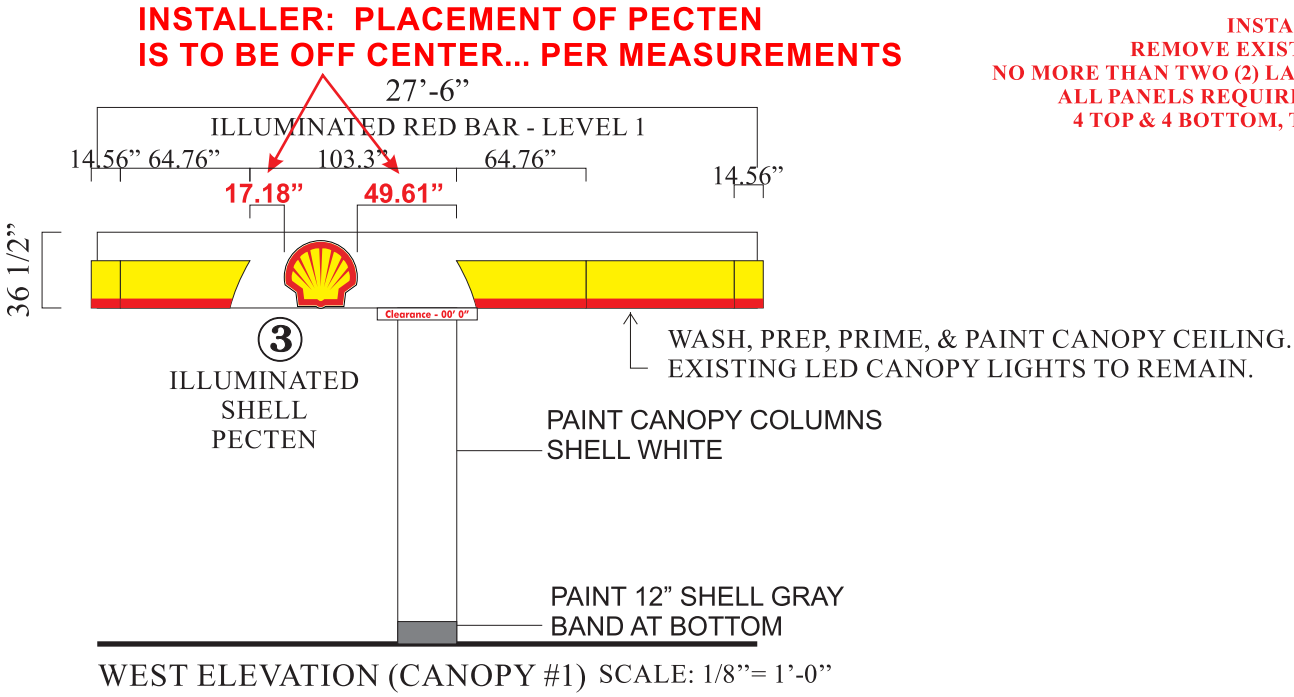

INSTALL NEW ACM.
REMOVE EXISTING ACM AS NEEDED,
NO MORE THAN TWO (2) LAYERS. (1 EXISTING + 1 NEW LAYER)
ALL PANELS REQUIRE MINIMUM 8 TECH SCREWS,
4 TOP & 4 BOTTOM, TEK SCREWS PER 10' PANEL

SUBJECT TO CITY AND SHELL APPROVALS



Upland, CA 91786 (909) 920-5535

PROPRIETARY INFORMATION. The information disclosed in this document, including all drawings, designs and related materials, is the valuable and proprietary information of Sign Development Inc. It is provided solely for the purpose of evaluation for purchase and, without the express written authorization of Sign Development Inc., may not be disclosed or duplicated, in whole or in part, for any reason. Sign Development Inc. expressly reserves all patent, copyright and other proprietary rights to this document, including all design, manufacturing, reproduction, use, and sales rights thereto. © 2011 SIGN DEVELOPMENT INC.

CUSTOMER APPROVAL

SIGN AND PRINT FULL NAME

DATE

NO. Z1610

PAGE: 4 OF 10

DATE: 06.10.25BA

REV: 06.11.25BA



2001 NEVADA CITY HWY.
GRASS VALLEY, CA 95945

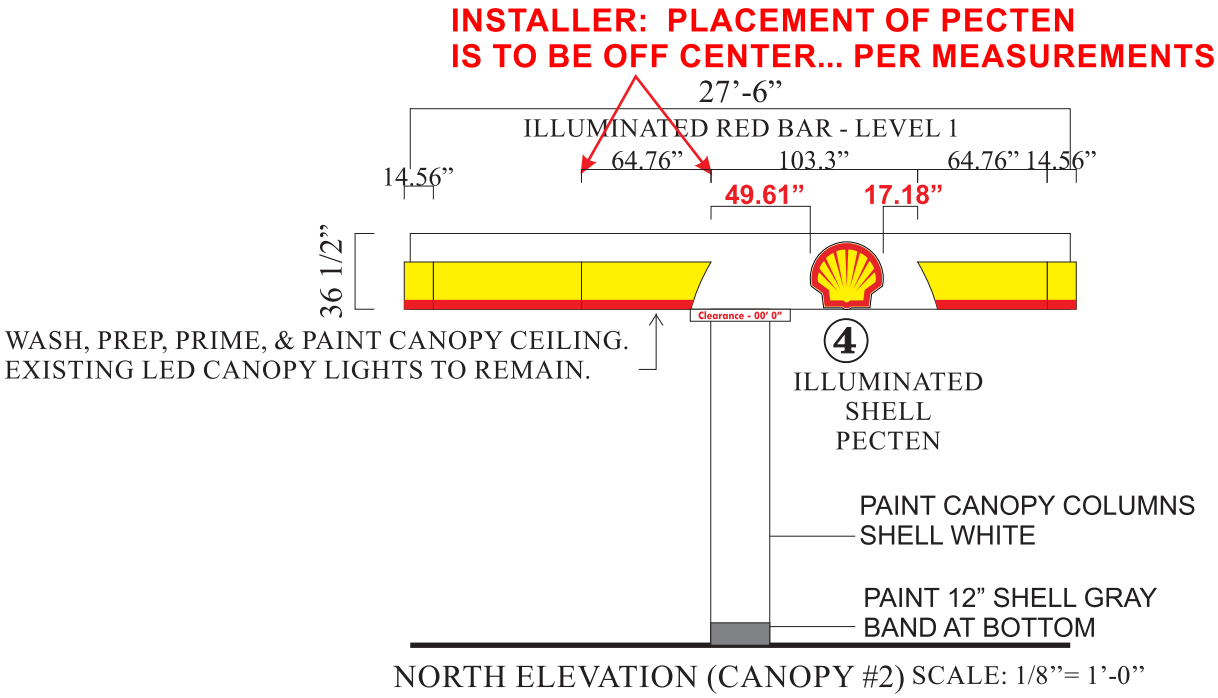

INSTALL NEW ACM.
REMOVE EXISTING ACM AS NEEDED,
NO MORE THAN TWO (2) LAYERS. (1 EXISTING + 1 NEW LAYER)
ALL PANELS REQUIRE MINIMUM 8 TECH SCREWS,
4 TOP & 4 BOTTOM, TEK SCREWS PER 10' PANEL



EXISTING NORTH ELEVATION (CANOPY #2)

PAINT CANOPY COLUMNS SHELL WHITE WITH 12" SHELL GRAY BAND AT BOTTOM.
PAINT BUMPER POLES SHELL WHITE WITH 12" SHELL GRAY BAND AT BOTTOM.
SUPPLY AND INSTALL FOUR (4) LARGE CSUs.
SUPPLY AND INSTALL FLAG SIGNS.
SUPPLY AND INSTALL TANK TAGS. (TAKE BEFORE AND AFTER PHOTOS OF NEW TANKS INSTALLED.)
PAINT FILL TANK LIDS PER EXISTING COLORS
ELECTRICAL: EXISTING SHOULD BE DEDICATED CIRCUITS, SDI IS NOT RESPONSIBLE FOR RUNNING NEW CIRCUITS OR SEPARATING EXISTING CIRCUITS FROM OTHER EQUIPMENT

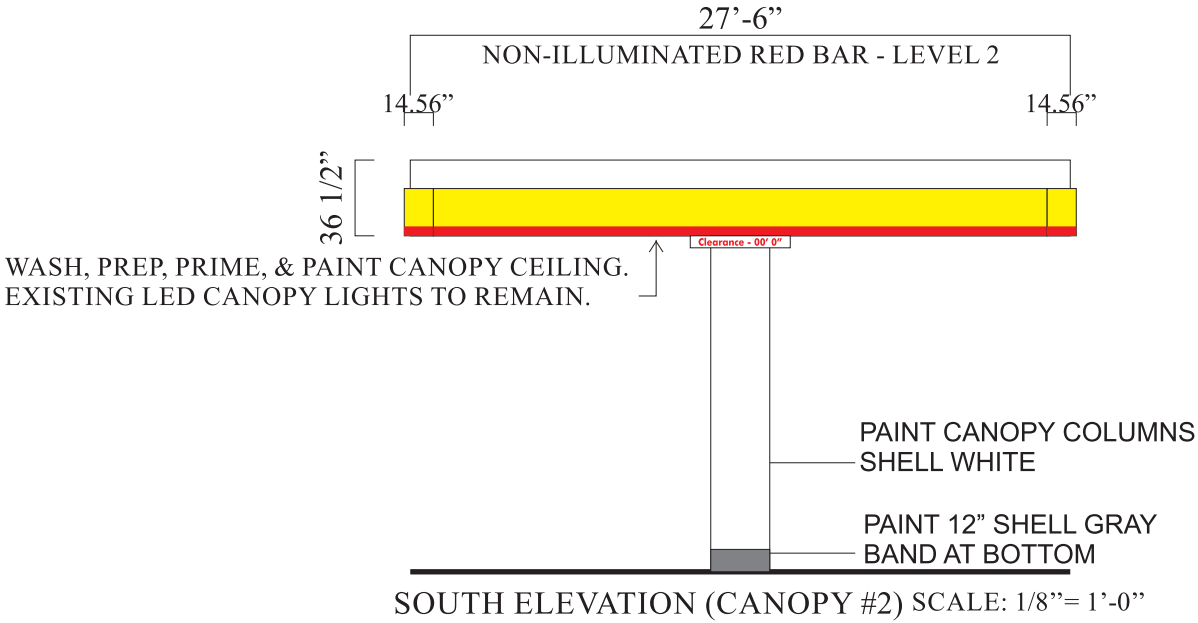

INSTALL NEW ACM.
REMOVE EXISTING ACM AS NEEDED,
NO MORE THAN TWO (2) LAYERS. (1 EXISTING + 1 NEW LAYER)
ALL PANELS REQUIRE MINIMUM 8 TECH SCREWS,
4 TOP & 4 BOTTOM, TEK SCREWS PER 10' PANEL

SUBJECT TO CITY AND SHELL APPROVALS



Upland, CA 91786 (909) 920-5535

PROPRIETARY INFORMATION. The information disclosed in this document, including all drawings, designs and related materials, is the valuable and proprietary information of Sign Development Inc. It is provided solely for the purpose of evaluation for purchase and, without the express written authorization of Sign Development Inc., may not be disclosed or duplicated, in whole or in part, for any reason. Sign Development Inc. expressly reserves all patent, copyright and other proprietary rights to this document, including all design, manufacturing, reproduction, use, and sales rights thereto. © 2011 SIGN DEVELOPMENT INC.

CUSTOMER APPROVAL

SIGN AND PRINT FULL NAME

DATE

NO. Z1610

PAGE: 5 OF 10

DATE: 06.10.25BA

REV: 06.11.25BA



**2001 NEVADA CITY HWY.
GRASS VALLEY, CA 95945**

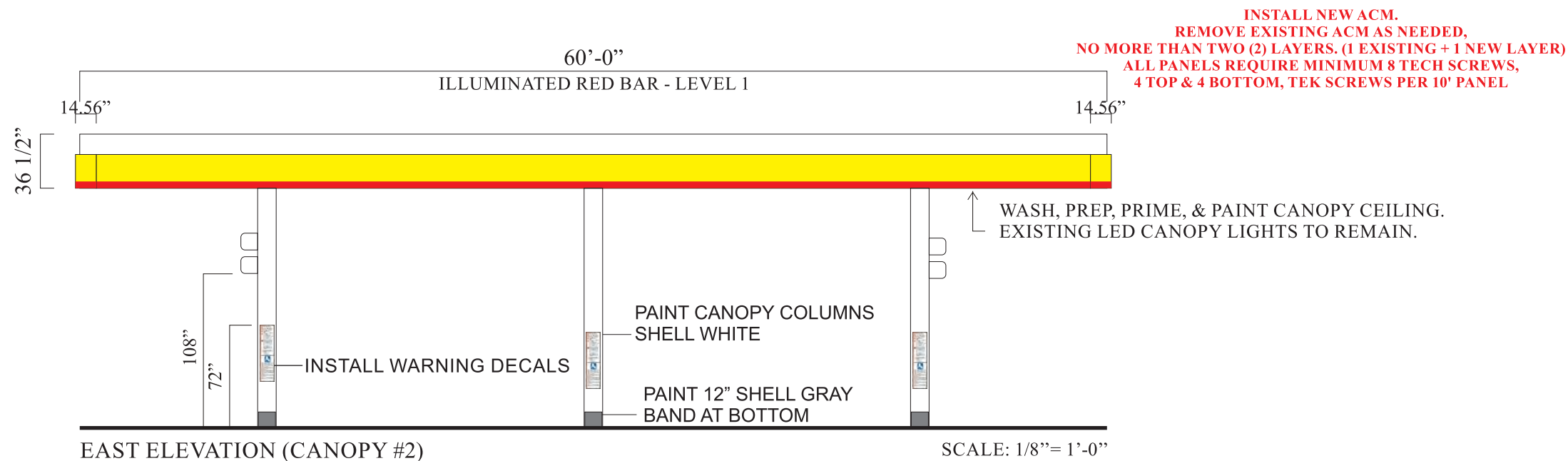

EXISTING EAST ELEVATION (CANOPY #2)

PAINT CANOPY COLUMNS SHELL WHITE WITH 12" SHELL GRAY BAND AT BOTTOM.
 PAINT BUMPER POLES SHELL WHITE WITH 12" SHELL GRAY BAND AT BOTTOM.
 SUPPLY AND INSTALL FOUR (4) LARGE CSUs.
 SUPPLY AND INSTALL FLAG SIGNS.
 SUPPLY AND INSTALL TANK TAGS. (TAKE BEFORE AND AFTER PHOTOS OF NEW TANKS INSTALLED.)
PAINT FILL TANK LIDS PER EXISTING COLORS
**ELECTRICAL: EXISTING SHOULD BE DEDICATED CIRCUITS,
 SDI IS NOT RESPONSIBLE FOR RUNNING NEW CIRCUITS OR
 SEPARATING EXISTING CIRCUITS FROM OTHER EQUIPMENT**

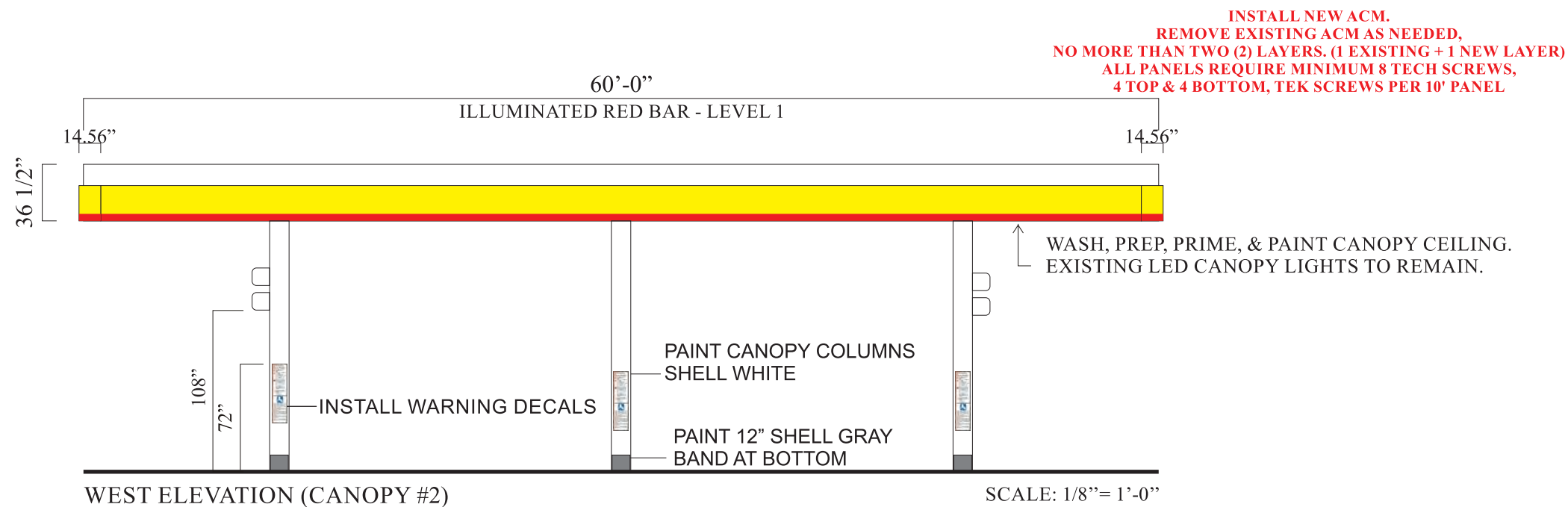

SUBJECT TO CITY AND SHELL APPROVALS



Sign Development Inc.

License #576277

Upland, CA 91786 (909) 920-5535

PROPRIETARY INFORMATION. The information disclosed in this document, including all drawings, designs and related materials, is the valuable and proprietary information of Sign Development Inc. It is provided solely for the purpose of evaluation for purchase and, without the express written authorization of Sign Development Inc., may not be disclosed or duplicated, in whole or in part, for any reason. Sign Development Inc. expressly reserves all patent, copyright and other proprietary rights to this document, including all design, manufacturing, reproduction, use, and sales rights thereto. © 2011 SIGN DEVELOPMENT INC.

CUSTOMER APPROVAL

SIGN AND PRINT FULL NAME

DATE

NO. Z1610

PAGE: 6 OF 10

DATE: 06.10.25BA

REV: 06.11.25BA



**2001 NEVADA CITY HWY.
GRASS VALLEY, CA 95945**



NO TOUCH - DO NOT PAINT BUILDING

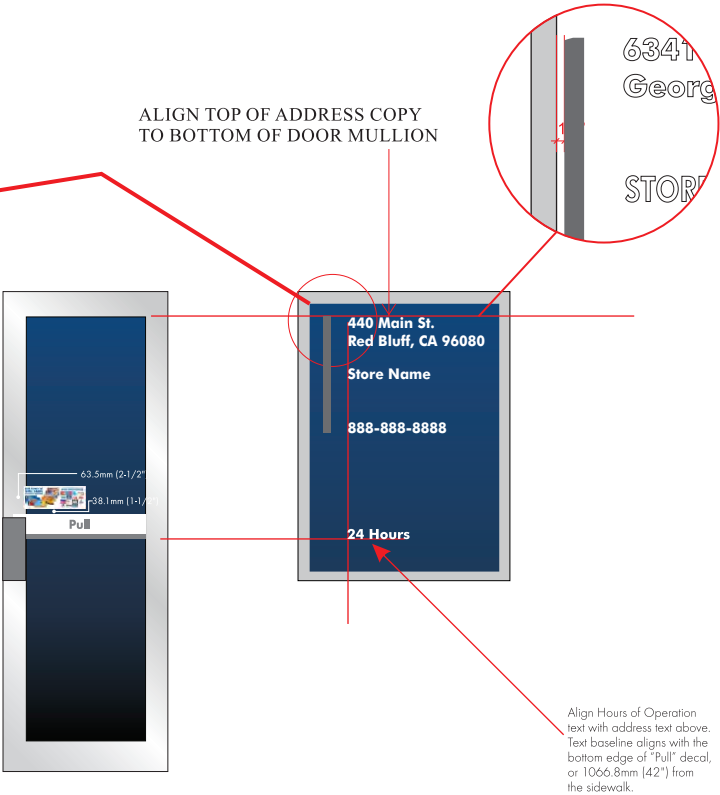

INSTALL SHELL REQUIRED DOOR DECALS

SUBJECT TO CITY AND SHELL APPROVALS



Sign Development Inc.

License #576277

Upland, CA 91786 (909) 920-5535

PROPRIETARY INFORMATION. The information disclosed in this document, including all drawings, designs and related materials, is the valuable and proprietary information of Sign Development Inc. It is provided solely for the purpose of evaluation for purchase and, without the express written authorization of Sign Development Inc., may not be disclosed or duplicated, in whole or in part, for any reason. Sign Development Inc. expressly reserves all patent, copyright and other proprietary rights to this document, including all design, manufacturing, reproduction, use, and sales rights thereto. © 2011 SIGN DEVELOPMENT INC.

CUSTOMER APPROVAL

SIGN AND PRINT FULL NAME

DATE

NO. Z1610

PAGE: 7 OF 10

DATE: 06.10.25BA

REV: 06.11.25BA



**2001 NEVADA CITY HWY.
GRASS VALLEY, CA 95945**

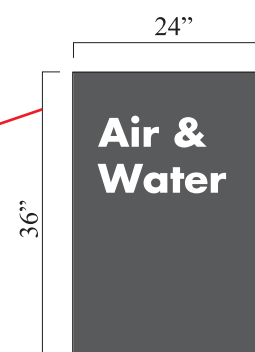

INSTALL NEW
NON-ILLUMINATED
AIR & WATER SIGN

FILL LID COLOR



REGULAR



PLUS



INSTALL IF NECESSARY



V-POWER

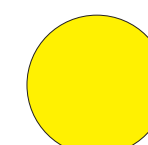

DIESEL #2

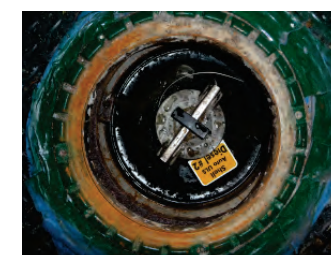

3 1/4"
Air & Water

INSTALL NON-ILLUMINATED VINYL COPY
TO BOTH SIDES OF UNIT 4" FROM TOP AND
4" FROM FRONT OF CABINET.

LEFT SIDE

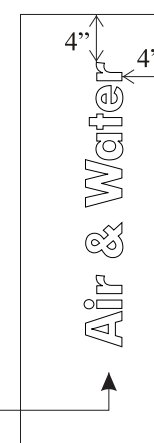

RIGHT SIDE

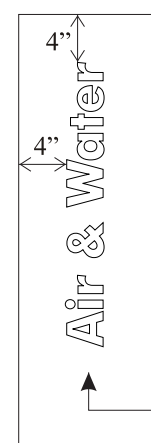

SUBJECT TO CITY AND SHELL APPROVALS



Sign Development Inc.

License #576277

Upland, CA 91786 (909) 920-5535

PROPRIETARY INFORMATION. The information disclosed in this document, including all drawings, designs and related materials, is the valuable and proprietary information of Sign Development Inc. It is provided solely for the purpose of evaluation for purchase and, without the express written authorization of Sign Development Inc., may not be disclosed or duplicated, in whole or in part, for any reason. Sign Development Inc. expressly reserves all patent, copyright and other proprietary rights to this document, including all design, manufacturing, reproduction, use, and sales rights thereto. © 2011 SIGN DEVELOPMENT INC.

CUSTOMER APPROVAL

SIGN AND PRINT FULL NAME

DATE

NO. Z1610

PAGE: 8 OF 10

DATE: 06.10.25BA

REV: 06.11.25BA



**2001 NEVADA CITY HWY.
GRASS VALLEY, CA 95945**



OWNER TO REPAIR CANOPY DAMAGE, PRIOR TO REIMAGE.

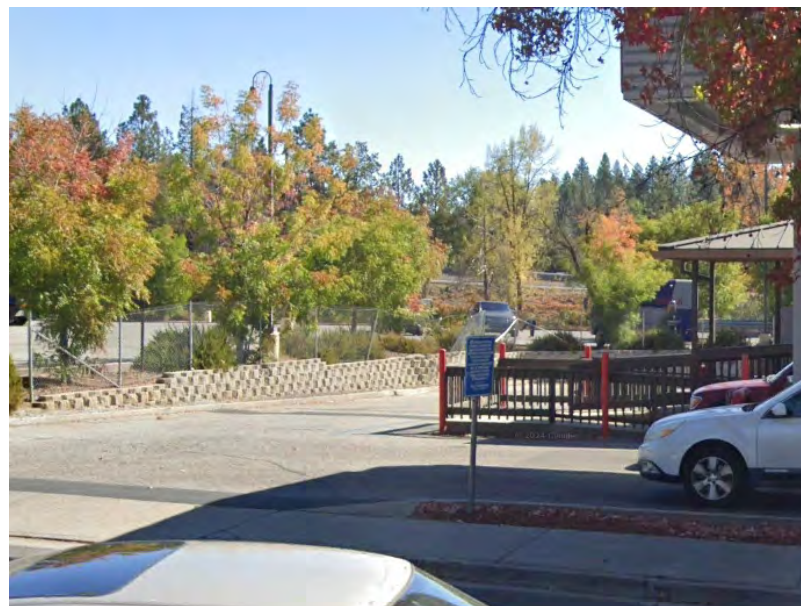

PAINT ALL BUMPER POLES SHELL WHITE
WITH 12" SHELL GRAY BAND AT BOTTOM.
NO TOUCH - DO NOT PAINT PERIMETER WALL.
NO TOUCH - DO NOT PAINT NATURAL CONCRETE
PERIMETER CURBS.



PAINT ALL BUMPER POLES SHELL WHITE
WITH 12" SHELL GRAY BAND AT BOTTOM.
NO TOUCH - DO NOT PAINT PERIMETER WALL.
NO TOUCH - DO NOT PAINT NATURAL CONCRETE
PERIMETER CURBS.

SUBJECT TO CITY AND SHELL APPROVALS



Sign Development Inc.

License #576277

Upland, CA 91786 (909) 920-5535

PROPRIETARY INFORMATION. The information disclosed in this document, including all drawings, designs and related materials, is the valuable and proprietary information of Sign Development Inc. It is provided solely for the purpose of evaluation for purchase and, without the express written authorization of Sign Development Inc., may not be disclosed or duplicated, in whole or in part, for any reason. Sign Development Inc. expressly reserves all patent, copyright and other proprietary rights to this document, including all design, manufacturing, reproduction, use, and sales rights thereto. © 2011 SIGN DEVELOPMENT INC.

CUSTOMER APPROVAL

SIGN AND PRINT FULL NAME

DATE

NO. Z1610

PAGE: 9 OF 10

DATE: 06.10.25BA

REV: 06.11.25BA



**2001 NEVADA CITY HWY.
GRASS VALLEY, CA 95945**



RE-STRIPE ALL PARKING LOT STRIPES AND HANDICAP ZONES



PAINT FILL TANK LIDS PER EXISTING COLORS

SUBJECT TO CITY AND SHELL APPROVALS



Sign Development Inc.

License #576277

Upland, CA 91786 (909) 920-5535

PROPRIETARY INFORMATION. The information disclosed in this document, including all drawings, designs and related materials, is the valuable and proprietary information of Sign Development Inc. It is provided solely for the purpose of evaluation for purchase and, without the express written authorization of Sign Development Inc., may not be disclosed or duplicated, in whole or in part, for any reason. Sign Development Inc. expressly reserves all patent, copyright and other proprietary rights to this document, including all design, manufacturing, reproduction, use, and sales rights thereto. © 2011 SIGN DEVELOPMENT INC.

CUSTOMER APPROVAL

SIGN AND PRINT FULL NAME

DATE

NO. Z1610

PAGE: 10 OF 10

**DATE: 06.10.25BA
REV: 06.11.25BA**



**2001 NEVADA CITY HWY.
GRASS VALLEY, CA 95945**

SUPPLY AND INSTALL MATERIALS TO IMAGE FOUR (4) DISPENSERS
(2) 3+0 AND (2) 3+1
AS PER SHELL MVI IMAGE REQUIREMENTS.
INCLUDES NEW VALANCES AND WHITE FACE PLATES.
DOES NOT INCLUDE NEW RISERS.

SIDE B:

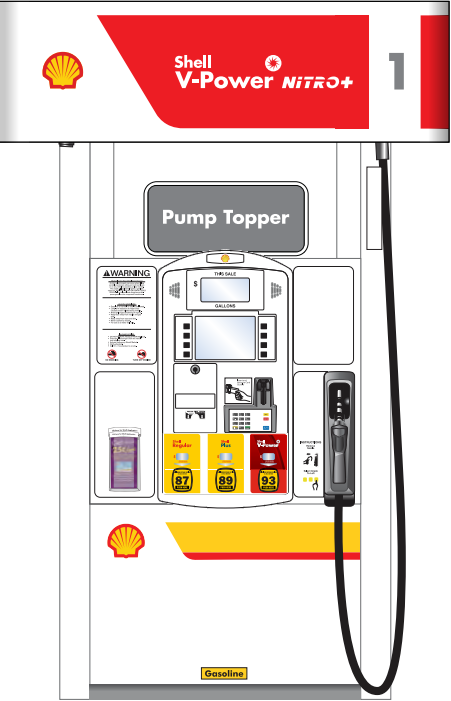

SIDE A:

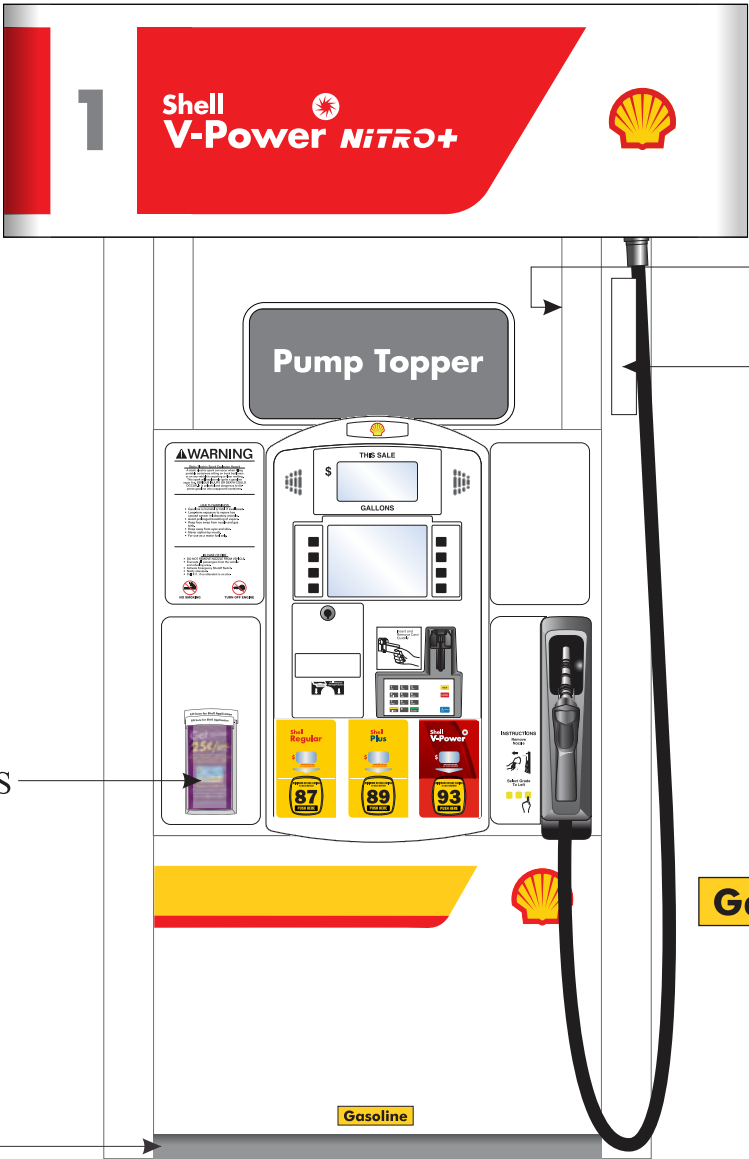

Gasoline

INSTALL RISER PROTECTORS

NOTE:
CREDIT CARD
APPLICATION HOLDERS
MUST BE INSTALLED
ON THE DISPENSERS.

BOTTOM REVEAL BELOW
DISPENSER DOOR
PAINTED SHELL GRAY

**INSTALL NEW SHELL
BRANDED TANK TAGS.**



EXISTING 3+0 DISPENSER

NEVADA CITY HWY

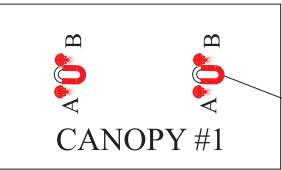

VALANCE
ORIENTATION

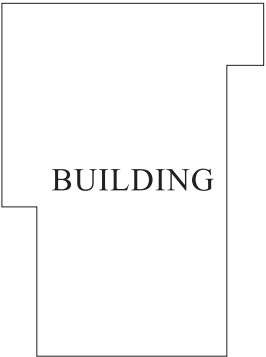

BUILDING

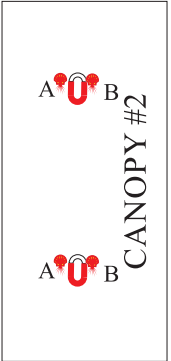

SUBJECT TO CITY AND SHELL APPROVALS



Sign Development Inc.

License #576277

Upland, CA 91786 (909) 920-5535



**2001 NEVADA CITY HWY.
GRASS VALLEY, CA 95945**

PROPRIETARY INFORMATION. The information disclosed in this document, including all drawings, designs and related materials, is the valuable and proprietary information of Sign Development Inc. It is provided solely for the purpose of evaluation for purchase and, without the express written authorization of Sign Development Inc., may not be disclosed or duplicated, in whole or in part, for any reason. Sign Development Inc. expressly reserves all patent, copyright and other proprietary rights to this document, including all design, manufacturing, reproduction, use, and sales rights thereto. © 2011 SIGN DEVELOPMENT INC.

CUSTOMER APPROVAL

SIGN AND PRINT FULL NAME

DATE

NO. Z1610

PAGE: DISP. 1

DATE: 06.10.25BA

REV: 06.11.25BA

SIDE A:

NOTE:
CREDIT CARD
APPLICATION HOLDERS
MUST BE INSTALLED
ON THE DISPENSERS.

BOTTOM REVEAL BELOW
DISPENSER DOOR
PAINTED SHELL GRAY

INSTALL NEW SHELL BRANDED TANK TAGS.

SIDE A:

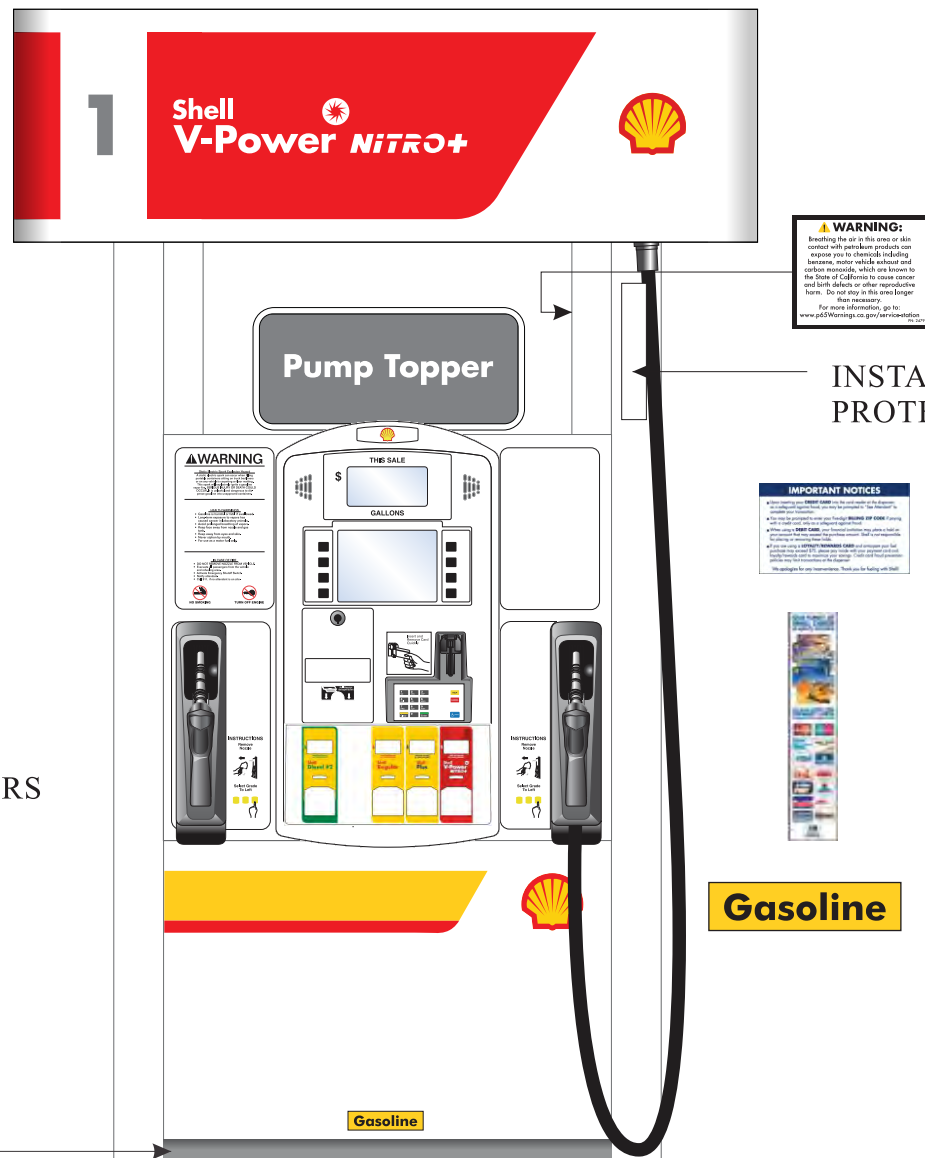

INSTALL RISER PROTECTORS

Gasoline

NEVADA CITY HWY

A A

CANOPY #1

VALANCE ORIENTATION

BUILDING

CANOPY #2

SUBJECT TO CITY AND SHELL APPROVALS



Sign Development Inc.

License #576277

Upland, CA 91786 (909) 920-5535



**2001 NEVADA CITY HWY.
GRASS VALLEY, CA 95945**

PROPRIETARY INFORMATION. The information disclosed in this document, including all drawings, designs and related materials, is the valuable and proprietary information of Sign Development Inc. It is provided solely for the purpose of evaluation for purchase and, without the express written authorization of Sign Development Inc., may not be disclosed or duplicated, in whole or in part, for any reason. Sign Development Inc. expressly reserves all patent, copyright and other proprietary rights to this document, including all design, manufacturing, reproduction, use, and sales rights thereto. © 2011 SIGN DEVELOPMENT INC.

CUSTOMER APPROVAL

SIGN AND PRINT FULL NAME

DATE _____

NO. Z1610

DATE: 06.10.25BA

REV: 06.11.25BA

PAGE: DISP. 1

EXISTING 3+1 DISPENSER

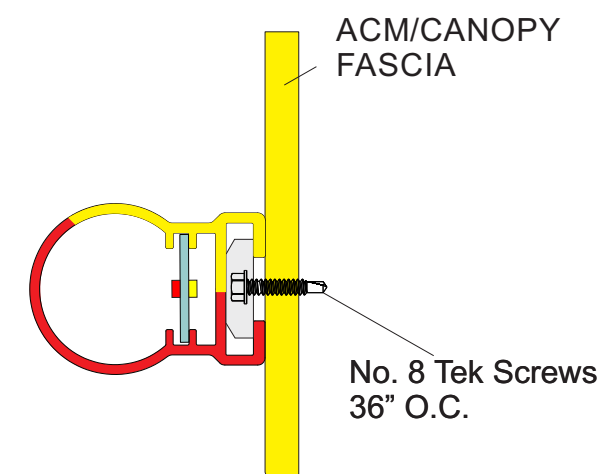
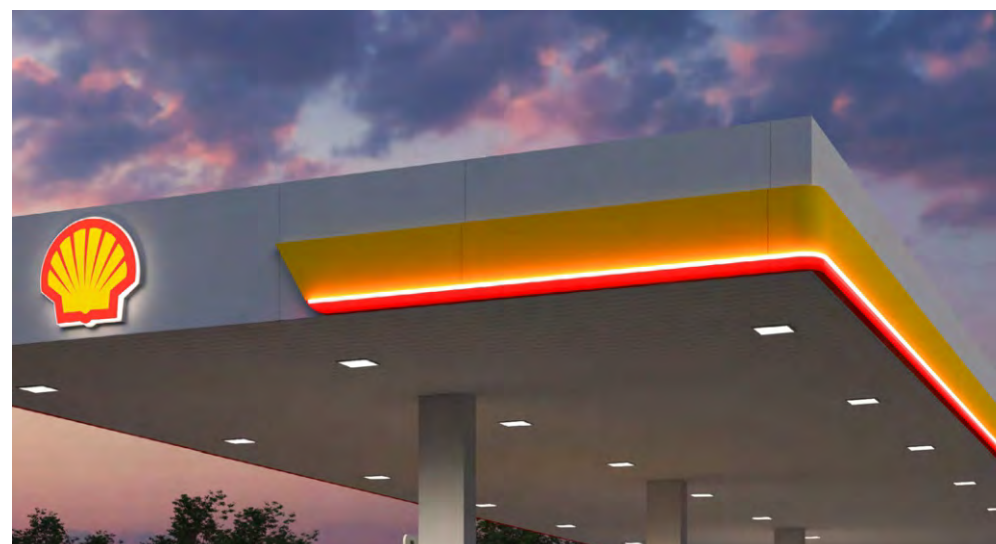
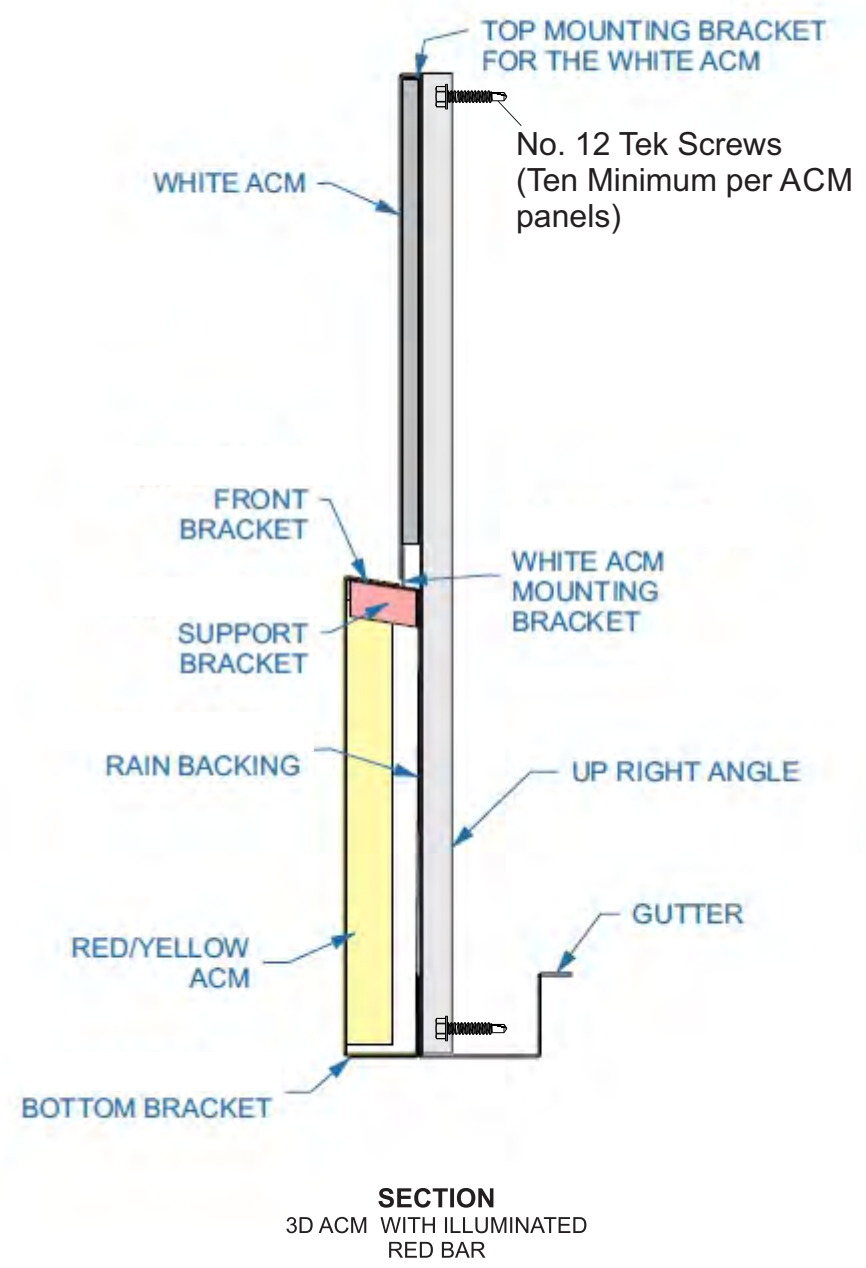

TYP. SECTION VIEW

SUBJECT TO CITY AND SHELL APPROVALS



Sign Development Inc.

License #576277

Upland, CA 91786 (909) 920-5535

PROPRIETARY INFORMATION. The information disclosed in this document, including all drawings, designs and related materials, is the valuable and proprietary information of Sign Development Inc. It is provided solely for the purpose of evaluation for purchase and, without the express written authorization of Sign Development Inc., may not be disclosed or duplicated, in whole or in part, for any reason. Sign Development Inc. expressly reserves all patent, copyright and other proprietary rights to this document, including all design, manufacturing, reproduction, use, and sales rights thereto. © 2011 SIGN DEVELOPMENT INC.

CUSTOMER APPROVAL

SIGN AND PRINT FULL NAME

DATE

NO. Z1610

PAGE: DISP. 1

DATE: 06.10.25BA

REV: 06.11.25BA



**2001 NEVADA CITY HWY.
GRASS VALLEY, CA 95945**

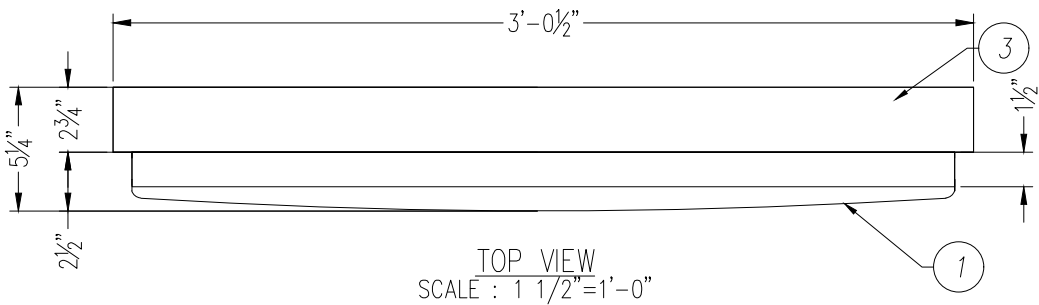

TOP VIEW
SCALE : 1 1/2"=1'-0"

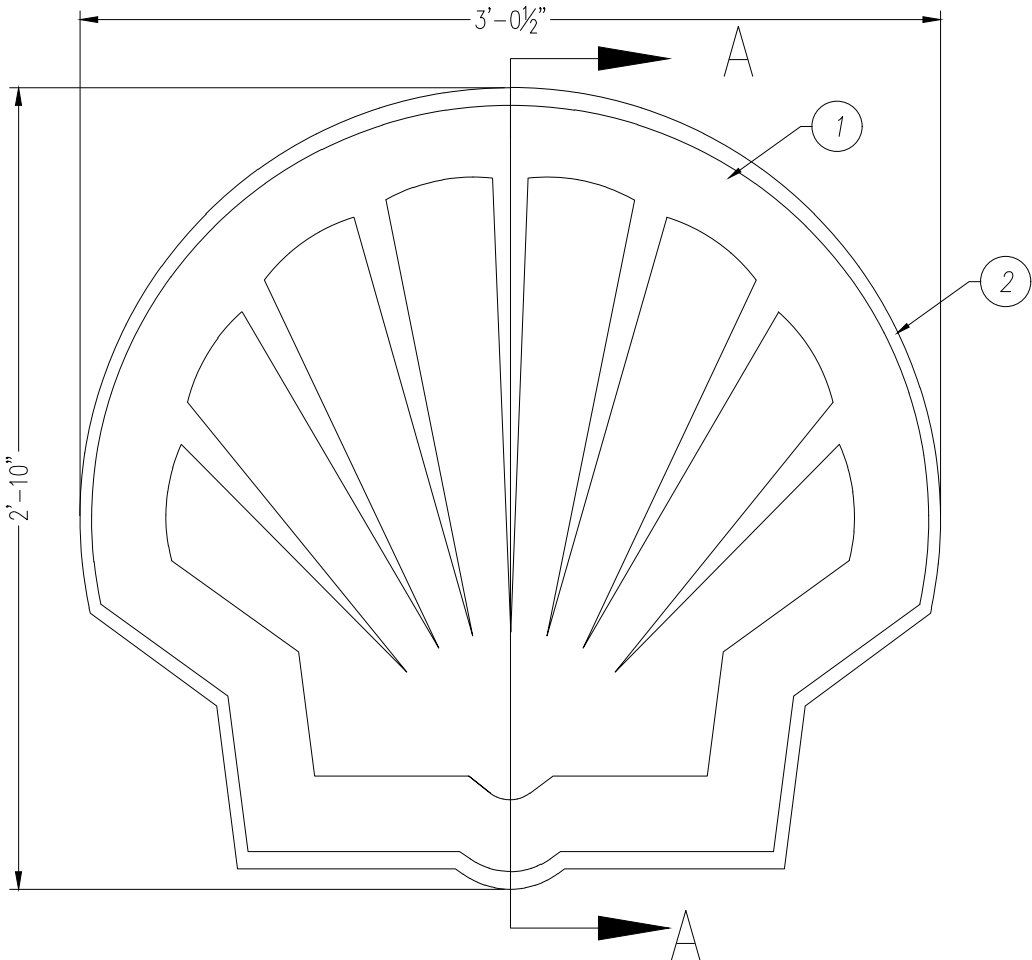

FRONT VIEW
SCALE : 1 1/2"=1'-0"

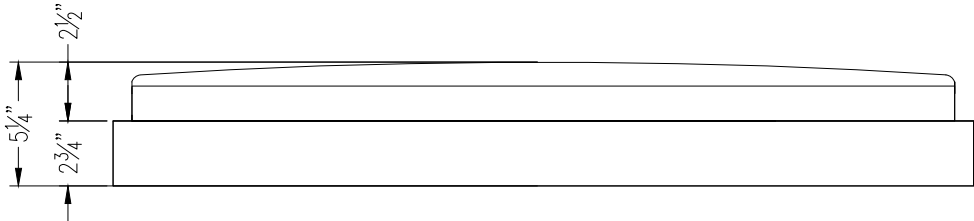

BOTTOM VIEW
SCALE : 1 1/2"=1'-0"

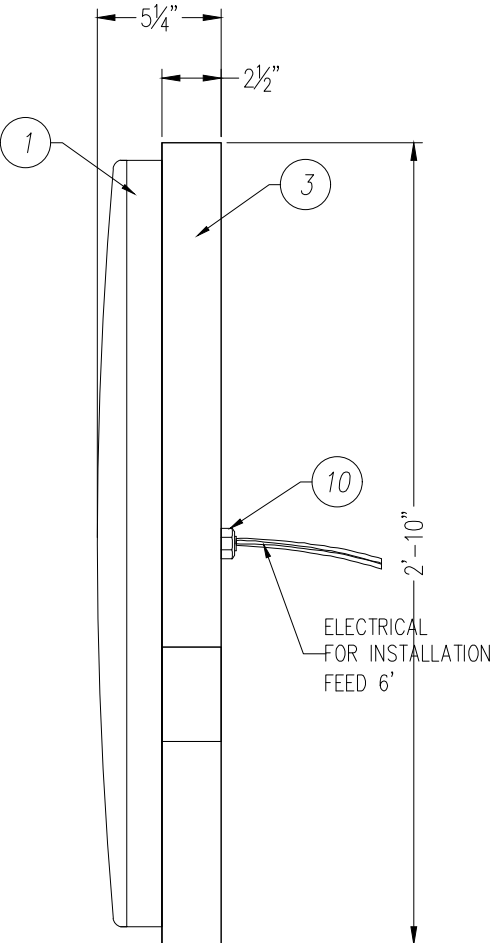

SIDE VIEW
SCALE : 1 1/2"=1'-0"

8.61 sq.ft PER LOGO

USE TAC WELDING AND LORD
ADHESIVE TO ATTACH ALUM.
RETURN TO ALUMINUM FACE
AND ALUMINUM BACKER

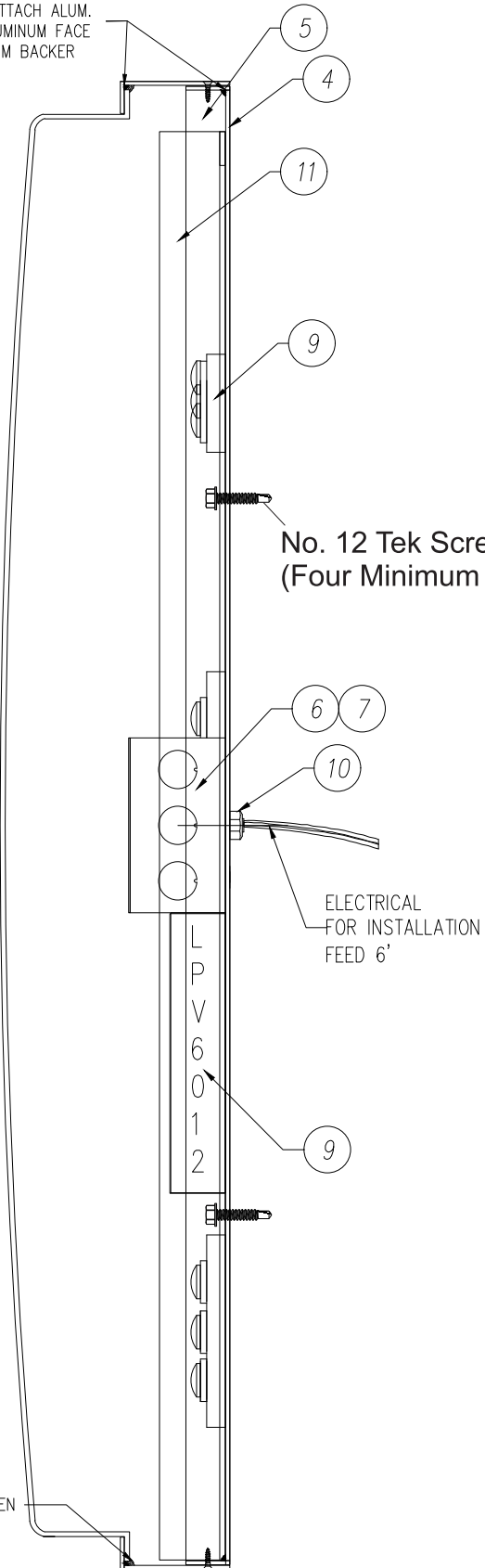

SECTION A-A
SCALE : 3"=1'-0"



P.O. Box 549 – Maywood CA 90270
800 423-4283 – 323 771-2098 – Fax 323 560-7143
Website: www.Signresource.net

RV	DESCRIPTION	DATE	BY
A	INITIAL DRAWING RELEASE	01/18/23	VA

1	3MVI34PEC	34" PECTEN FORMED FACE	1
2	0ASH0960103	.090" ALUMINUM FACE	1
3	0ASH0960103	.090" ALUMINUM FACE RETURN	1
4	0ASH0960103	.090" ALUMINUM BACKER	1
5	0ASH0960103	.090" ALUMINUM BACKER RETURN	1
6	0ECF000103	4"x4" JUNCTION BOX W/DUPLEX	1
7	0ECF000102	4" X 4" BLANK HANDY BOX COVER	1
8	0LEDPLV6012	60W 12V POWER SUPPLY MEANWELL	1
9	0LED00VLP23K	SLOAN LED PRISM WHITE	16
10	0ECF000024	1/2" LIQUID TIGHT FLEX CONNECTOR STRAIGHT	1
11	0EXT000420	1 X 1.5 X .1875 ALUM ANGLE 42 3/4"	2

Voltage	Circuits	Current	Drawn By	Date
120.0 V	1	1.12 AMP.	VA	01/18/23

Description	Checked By
34"X36 1/2" SINGLE FACE CANOPY FASCIA PECTEN LOGO	~

Sign Size	Design Load	Client	Page
8.61 SQ FT	30 PSF	SHELL	1 OF 2

Part Number	Drawing No.	Rev.
MMPECTEN34-LED	MMIPECTEN34-LED	A

This document reflects trade secrets and confidential business information, and may not be copied, published, or disseminated in any manner without the prior express written approval of SignResource. All rights reserved, including patent, trademark and copyrights.

Sign Lighting

CERTIFICATE OF COMPLIANCE		NRCC-LTS-E
<i>This document is used to demonstrate compliance with requirements in 110.9, 110.12, 130.0/ 160.5, 130.3/ 160.5(d), 140.8/ 170.2(e) and 141.0(b)2M/ 180.2(b)4Bvi for sign lighting scopes using the prescriptive path. Exit signs and traffic signs are not required to comply with prescriptive requirements per exceptions to 140.8/ 170.2(e) and do not need to complete this compliance document.</i>		
Project Name:	Grass Valley SHELL	Report Page: (Page 1 of 5)
Project Address:	2001 Nevada City Hwy. Grass Valley, CA 95945	Date Prepared: 2025-06-16T20:57:57-04:00

A. GENERAL INFORMATION			
01	Project Location (city)	Grass Valley	
02	Climate Zone	11	
03	Occupancy Types within Project	<input type="checkbox"/>	Healthcare Facility
		<input type="checkbox"/>	Multifamily/ MF Mixed-use >= 4 stories (includes dormitory, senior living)

B. PROJECT SCOPE				
<i>This table includes illuminated signs that are within the scope of the permit application and are demonstrating compliance using the prescriptive path outlined in 140.8/ 170.2(e) or 141.0(b)2M/ 180.2(b)4Bvi for alterations. Exit signs and traffic signs are not required to comply with prescriptive requirements per exceptions to 140.8/ 170.2(e) and do not need to complete this compliance document.</i>				
01	02	03	04	05
Name or Item Tag	Complete Sign Description	Sign Status ¹	Sign Type	Compliance Method ²
Existing Price/ID monument sign	Reface existing Price/ID monument sign with new LED pricers	Altered	Outdoor	Alternate Light Sources
New canopy signs SHELL Logo Pecten	New canopy fascia SHELL Logo Pecten signs	New	Outdoor	Alternate Light Sources
New LED Illuminated canopy fascia Red Bars	New LED illuminated Red Bars around the canopy fascia	New	Outdoor	Alternate Light Sources

¹FOOTNOTE: Sign alterations that increase the connected lighting load, replace and rewire more that 50% of the ballasts, or relocate the sign to a different location must comply with 140.8/ 170.2(e). See 141.0(b)2M/ 180.2(b)4Bvi for more details.

²The ENERGY VERIFIED Label compliance method is only applicable if the sign has a permanent, factory-installed, ENERGY VERIFIED label certified by UL or comparable, confirming the sign complies with 140.8/ 170.2(e). Note that using an ENERGY VERIFIED label is an optional compliance path, not a mandatory requirement. See the tooltips for this table for more details.

CERTIFICATE OF COMPLIANCE					NRCC-LTS-E				
Project Name: Grass Valley SHELL					Report Page: (Page 2 of 5)				
					Date Prepared: 2025-06-16T20:57:57-04:00				

C. COMPLIANCE RESULTS									
Results in this table are automatically calculated from data input and calculations in Tables B through H. Note: If any cell on this table says "COMPLIES with Exceptional Conditions" refer to Table D. Exceptional Conditions for guidance or see applicable Table referenced below.									
01	02	03	≥	04	OR	05	OR	06	07
Name or Item Tag (See Table B)	Complete Sign Description (See Table B)	Total Allowed (Watts) (See Table F)		Total Designed (Watts) (See Table F)		Compliant Light Sources (See Table G)		ENERGY VERIFIED Label (See Table H)	Compliance Results
Existing Price/ID monument sign	Reface existing Price/ID monument sign with new LED pricers		≥		OR	YES	OR		COMPLIES
Controls Compliance (See Table F/G/H for Details)									COMPLIES
New canopy signs SHELL Logo Pecten	New canopy fascia SHELL Logo Pecten signs		≥		OR	YES	OR		COMPLIES
Controls Compliance (See Table F/G/H for Details)									COMPLIES
New LED Illuminated canopy fascia Red Bars	New LED illuminated Red Bars around the canopy fascia		≥		OR	YES	OR		COMPLIES
Controls Compliance (See Table F/G/H for Details)									COMPLIES

D. EXCEPTIONAL CONDITIONS
This table is auto-filled with uneditable comments because of selections made or data entered in tables throughout the form.

E. ADDITIONAL REMARKS
This table includes remarks made by the permit applicant to the Authority Having Jurisdiction.

CERTIFICATE OF COMPLIANCE		NRCC-LTS-E	
Project Name: Grass Valley SHELL		Report Page:	(Page 3 of 5)
		Date Prepared:	2025-06-16T20:57:57-04:00

F. MAXIMUM ALLOWED LIGHTING POWER AND CONTROLS
<i>This section does not apply to this project.</i>

G. LIGHT SOURCES AND CONTROLS							
<i>This table includes illuminated signs using the Alternate Lighting Sources compliance method per 140.8(b)/ 170.2(e) as indicated on Table B of this compliance document. It also demonstrates compliance with mandatory controls requirements from 130.3 / 160.5(d) by indicating control types for each sign.</i>							
01	02	03	04			05	
Name or Item Tag	Complete Sign Description	Compliant Light Sources ^{1,2}	Mandatory Controls			Field Inspector	
			Shut-Off	Dimming	Demand Response ³	Pass	Fail
Existing Price/ID monument sign	Reface existing Price/ID monument sign with new LED pricers	LED + pwr supply 80%+ eff.	Automatic Time Switch + Photocontrol (outdoor)	NA: Outdoor 24x7x365 use		<input type="checkbox"/>	<input type="checkbox"/>
New canopy signs SHELL Logo Pecten	New canopy fascia SHELL Logo Pecten signs	LED + pwr supply 80%+ eff.	Automatic Time Switch + Photocontrol (outdoor)	NA: Outdoor 24x7x365 use		<input type="checkbox"/>	<input type="checkbox"/>
New LED Illuminated canopy fascia Red Bars	New LED illuminated Red Bars around the canopy fascia	LED + pwr supply 80%+ eff.	Automatic Time Switch + Photocontrol (outdoor)	NA: Outdoor 24x7x365 use		<input type="checkbox"/>	<input type="checkbox"/>
<i>* NOTES: Controls with a * require a note in the space below explaining how compliance is achieved. EX: Sign within tunnel illuminated day and night; EXCEPTION to 130.3(a)2A.</i>							

¹FOOTNOTE: Dropdown choices have been abbreviated, please refer to 140.8(b) / 170.2(e) to confirm compliance with the specific light source technologies listed.

² Authority having jurisdiction may ask for cutsheets to confirm compliance of light source.

³ Demand response controls are only required for an Electronic Message Center having a new connected lighting power load greater than 15 kW per 110.12(d).

CERTIFICATE OF COMPLIANCE		NRCC-LTS-E	
Project Name: Grass Valley SHELL		Report Page: (Page 4 of 5)	
		Date Prepared: 2025-06-16T20:57:57-04:00	

I. DECLARATION OF REQUIRED CERTIFICATES OF INSTALLATION	
<i>Selections have been made based on information provided in this document. If any selection have been changed by permit applicant, an explanation should be included in Table E. Additional Remarks. These documents must be provided to the building inspector during construction and can be found online</i>	
Form/Title	
NRCI-LTS-E - Must be submitted for all buildings	

J. DECLARATION OF REQUIRED CERTIFICATES OF ACCEPTANCE	
<i>There are no forms required for this project.</i>	

Sign Lighting

CERTIFICATE OF COMPLIANCE		NRCC-LTS-E	
Project Name: Grass Valley SHELL		Report Page: (Page 5 of 5)	
Project Address: 2001 Nevada City Hwy. Grass Valley, CA 95945		Date Prepared: 2025-06-16T20:57:57-04:00	

DOCUMENTATION AUTHOR'S DECLARATION STATEMENT			
I certify that this Certificate of Compliance documentation is accurate and complete.			
Documentation Author Name: Gus Ortega		Documentation Author Signature: <i>Sal Pablo</i>	
Company: Sign Development Inc.		Signature Date: 06/16/25	
Address: 1366 W. Ninth Street		CEA/ HERS Certification Identification (if applicable): 576277 C-45	
City/State/Zip: Upland, CA 91786		Phone: (909)920-5535 ext. 541	
RESPONSIBLE PERSON'S DECLARATION STATEMENT			
I certify the following under penalty of perjury, under the laws of the State of California:			
<div>1. The information provided on this Certificate of Compliance is true and correct.</div> <div>2. I am eligible under Division 3 of the Business and Professions Code to accept responsibility for the building design or system design identified on this Certificate of Compliance (responsible designer)</div> <div>3. The energy features and performance specifications, materials, components, and manufactured devices for the building design or system design identified on this Certificate of Compliance conform to the requirements of Title 24, Part 1 and Part 6 of the California Code of Regulations.</div> <div>4. The building design features or system design features identified on this Certificate of Compliance are consistent with the information provided on other applicable compliance documents, worksheets, calculations, plans and specifications submitted to the enforcement agency for approval with this building permit application.</div> <div>5. I will ensure that a completed signed copy of this Certificate of Compliance shall be made available with the building permit(s) issued for the building, and made available to the enforcement agency for all applicable inspections. I understand that a completed signed copy of this Certificate of Compliance is required to be included with the documentation the builder provides to the building owner at occupancy.</div>			
Responsible Designer Name: Sal Pablo		Responsible Designer Signature: <i>Sal Pablo</i>	
Company: Sign Development Inc.		Date Signed: 06/16/25	
Address: 1366 W. Ninth Street		License: 576277 C-45	
City/State/Zip: Upland, CA 91786		Phone: (909)920-5535 ext. 541	