

REFER TO L0.1 FOR TREE INVENTORY CHART

© 2023 KIMLEY-HORN AND ASSOCIATES, INC.  
4727 GAILLARD PARKWAY, SUITE 250, OKLAHOMA CITY, OK 73142  
PHONE: 405-241-5423 FIRM NO. 2740. EXP. JUNE 30, 2023  
WWW.KIMLEY-HORN.COM



**PROSE WESTCLIFF PH 2**  
**MULTIFAMILY**  
LOT 1, BLOCK A, PROSE WESTCLIFF PH 2  
ADDITION  
GRAND PRAIRIE, DALLAS COUNTY, TX

TREE  
PRESERVATION AND  
REMOVAL PLAN

SHEET NUMBER  
L0.0



STP-25-06-0018

This document, together with the contracts and design presented herein, is an instrument of service, is intended only for the specific purpose and shall not be used for any other purpose without the written approval of the engineer. The engineer shall not be held responsible for any errors or omissions in this document.

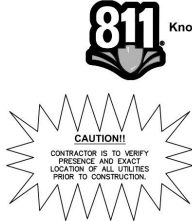
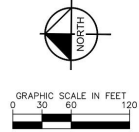
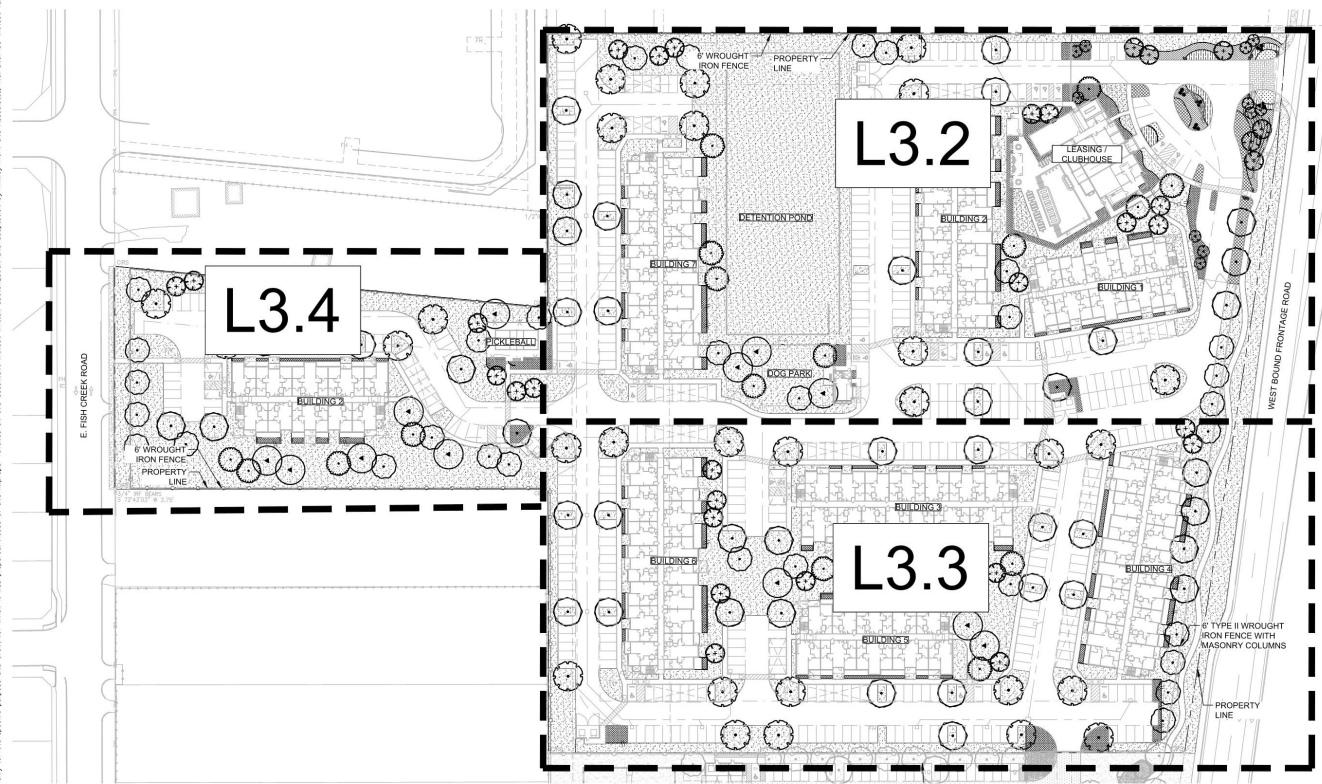

**CONTACT INFORMATION**  
DEVELOPER:  
ALLIANCE REALTY PARTNERS  
4525 GREENVILLE AVE., SUITE 1270  
DALLAS, TX 75206  
PH: (214) 388-2056  
CONTACT: DAVID DIERCKES  
LANDSCAPE ARCHITECT:  
KIMLEY-HORN  
4727 GALLARDA PARKWAY  
SUITE 200  
OKLAHOMA CITY, OK 73142  
PH: (405) 956-8752  
CONTACT: ANDREA POWELL, PLA

SHEET NUMBER		L3.1	
OVERALL		LANDSCAPE PLAN	
PROSE WESTCLIFF PH 2		MULTIFAMILY	
LOT 1, BLOCK A, PROSE WESTCLIFF PH 2		ADDITION	
GRAND PRAIRIE, DALLAS COUNTY, TX			
KHA PROJECT		001252832	DATE
		JULY 2023	
SCALE		AS SHOWN	
DESIGNED BY		A.P.	
DRAWN BY		A.M.	
CHECKED BY		D.A.S.	
<div>PROJECT</div> <div></div> <div><small>THIS DOCUMENT IS PREPARED BY KIMLEY-HORN AND ASSOCIATES, INC. 4727 GALLARDA PARKWAY, SUITE 200, OKLAHOMA CITY, OK 73142 PHONE: (405) 956-8752 FAX: (405) 956-8753 WWW.KIMLEY-HORN.COM</small></div> <div><small>© 2023 KIMLEY-HORN AND ASSOCIATES, INC.</small></div>			

