

	<u>CODE</u>	<u>BOTANICAL / COMMON NAME</u>
	ACSA	Araucaria arborescens / Ginkgo Southern Sugar Maple MATCH SPECIMEN, STRONG CENTRAL LEADER
	NYSL	Nyssa sylvatica / Black Gum MATCHED SPECIMEN, STRONG CENTRAL LEADER
	PTX	Platanus incana / Texas Platanus MATCHED SPECIMEN, STRONG CENTRAL LEADER
	QUMA	Quercus macrocarpa / Bur Oak MATCHED SPECIMEN, STRONG CENTRAL LEADER
	QUMO	Quercus polyandra / Monterey Oak MATCHED SPECIMEN, STRONG CENTRAL LEADER
	QPHJ	Quercus phellos / Shumard Red Oak MATCHED SPECIMEN, STRONG CENTRAL LEADER
	QUITE	Quercus laevis / Texas Red Oak MATCHED SPECIMEN, STRONG CENTRAL LEADER
	TAD	Taxodium distichum / Bald Cypress MATCHED SPECIMEN, STRONG CENTRAL LEADER
	ULAL	Ulmus alatus / Winged Elm MATCHED SPECIMEN, STRONG CENTRAL LEADER
	ULCR	Ulmus crassifolius / Cedar Elm MATCHED SPECIMEN, STRONG CENTRAL LEADER
	ULPA	Ulmus parviflorus / Alb / Allen London Elm MATCHED SPECIMEN, STRONG CENTRAL LEADER
 ORNAMENTAL TREES	<u>CODE</u>	<u>BOTANICAL / COMMON NAME</u>
	CCME	Cercis canadensis var. mexicana / Mexican Redbud MATCHED SPECIMEN, MULTI-STEM
	LIVO	Liriodendron / Yucca Holly MATCHED SPECIMEN, MULTI-STEM, TREE FORM
	ELNA	Lagerströmia / Natchez / White Crane Myrtle Multi-Trunk MATCHED SPECIMEN, MULTI-STEM
	VIAO	Viburnum acerifolium / Oakleaf Tree MATCHED SPECIMEN, MULTI-STEM
 SHRUBS	<u>CODE</u>	<u>BOTANICAL / COMMON NAME</u>
	ABSR	Abutilon shrubs A. grandifolium / Edward Goucher / Glorify Holly / Edward Goucher Bursa maritima / Winter Green / Double Winter Green Bursa maritima / Buffalo / Double Winter Green Ilex cornuta / Carissa / Carissa / Carissa
	LEPR	Leucophaea / Leucophaea / Depressed Texas Sage
	3-GALLON SHRUBS	
	ABR	Abutilon / Rose Cactus / Abutilon
	BNCH	Banksia laurifolia / Japanese Barberry
	TDH	Taxodium / Texas Cedar / Texas Cedar
	NDPO	Nandina domestica / Nandina Dwarf / Dwarf Nandina

**NOT FOR
CONSTRUCTION**



LAKE RIDGE COMMONS
TOWNHOMES



GRAND PRAIRIE, TEXAS

LAND DESIGN PROJECT 8520099

[illegible]

DESIGNED BY: LDI
DRAWN BY: LDI
CHECKED BY: LDI

VERT: N/A
HORIZ: 1" = 40'



PLANTING PLAN (NORTH)

SHEET NUMBER
L1-01

CASE NO. S210101

ORIGINAL SHEET SIZE: 36" X 36"

5160000 5-432M MATTIC CAID/MI D N102081030099C/M10001BACITATION/COSSITE DI AN ASSOCIATI V060-SI M21 ANTINO DIA

MATCH SHEET L1-01

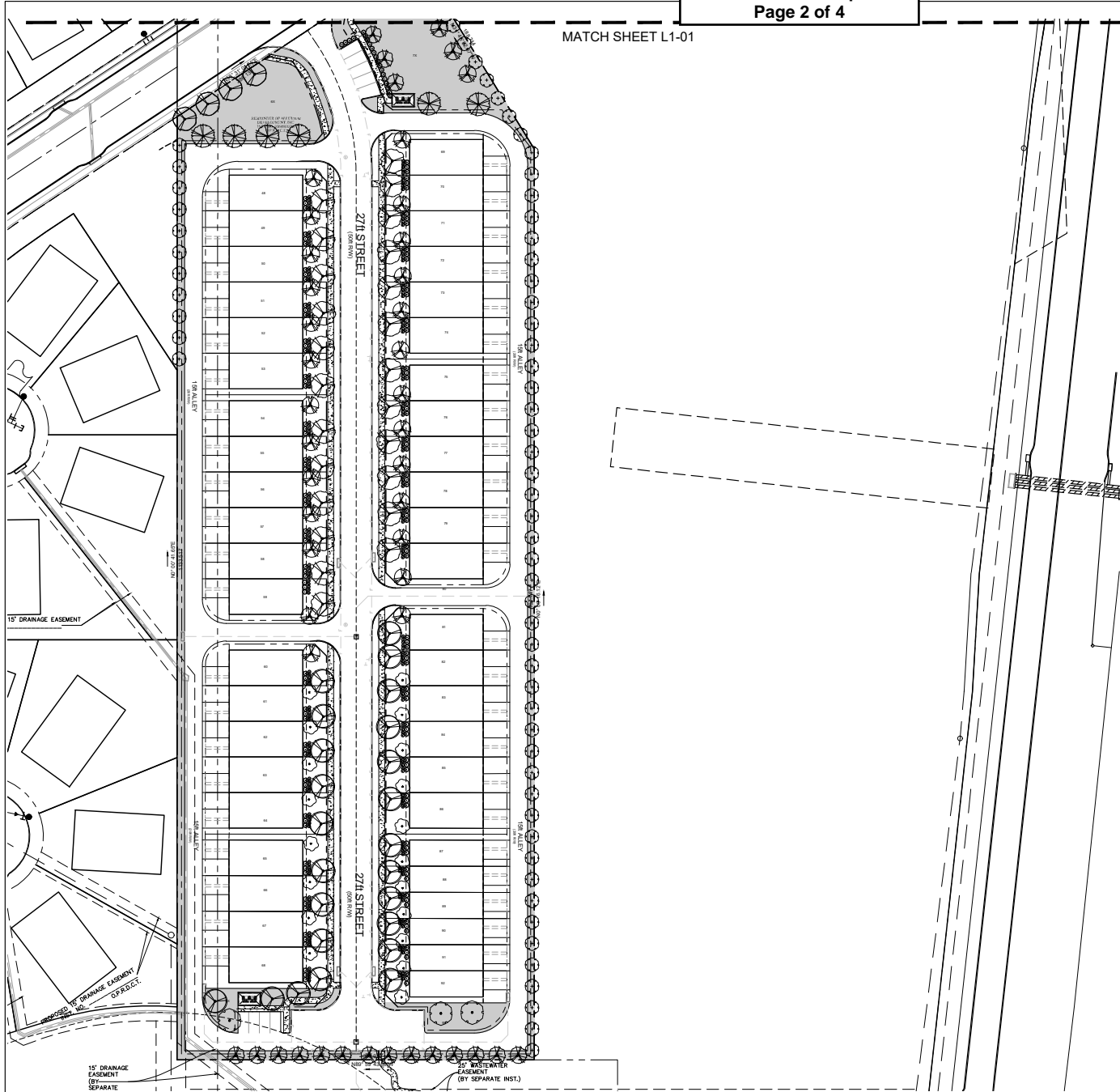

PLANT SCHEDULE

TREES	CODE	BOTANICAL / COMMON NAME
ACBA	Acacia baobab / Caddo Southern Sugar Maple	MATCH SPECIMEN, STRONG CENTRAL LEADER
NYSL	Nyssa sylvatica / Black Gum	MATCHED SPECIMEN, STRONG CENTRAL LEADER
PTX	Platanus texana / Texas Platanus	MATCHED SPECIMEN, STRONG CENTRAL LEADER
QUOA	Quercus macrocarpa / Bur Oak	MATCHED SPECIMEN, STRONG CENTRAL LEADER
QPMO	Quercus polymorpha / Monterey / Monterey Oak	MATCHED SPECIMEN, STRONG CENTRAL LEADER
QUOH	Quercus shumardii / Shumard Red Oak	MATCHED SPECIMEN, STRONG CENTRAL LEADER
QUTE	Quercus texana / Texas Red Oak	MATCHED SPECIMEN, STRONG CENTRAL LEADER
TADI	Taxodium distichum / Bald Cypress	MATCHED SPECIMEN, STRONG CENTRAL LEADER
ULAL	Ulmus alata / Winged Elm	MATCHED SPECIMEN, STRONG CENTRAL LEADER
ULCR	Ulmus crassifolia / Cedar Elm	MATCHED SPECIMEN, STRONG CENTRAL LEADER
ULPA	Ulmus parvifolia / Allee / Allee Leobach Elm	MATCHED SPECIMEN, STRONG CENTRAL LEADER
ORNAMENTAL TREES	CODE	BOTANICAL / COMMON NAME
CCME	Cercis canadensis var. mexicana / Mexican Redbud	MATCHED SPECIMEN, MULTI-STEM
ILVO	Ilex vomitoria / Yucca Holly	MATCHED SPECIMEN, MULTI-STEM, TREE FORM
LANA	Lagerstroemia x 'Natchez' / White Crapemyrtle Multi-Trunk	MATCHED SPECIMEN, MULTISTEM
VIAG	Viburnum acerifolium / Chalk Tree	MATCHED SPECIMEN, MULTI-STEM
SHRUBS	CODE	BOTANICAL / COMMON NAME
ABGR	Abutilon grandifolium / Edward Goucher / Ostray Abutilon / Edward Goucher	
BAGG	Baccharis myrsinites / Winter Green / Golden Winter Green / Broomrape	
ICBN	Ilex cornuta / Burford Holly	
ICCA	Ilex cornuta / Burford Holly	
LEPR	Leucophyllum frutescens / Grease / Desperado Texas Sage	
3-GALLON SHRUBS	CODE	BOTANICAL / COMMON NAME
ABGR	Abutilon grandifolium / Edward Goucher / Ostray Abutilon / Edward Goucher	
BTCP	Banksia integrifolia / Banksia / Banksia / Banksia	
HYD	Hydrangea macrophylla / Hydrangea / Hydrangea	
NDHD	Nandina domestica / Nandina Dwarf / Dwarf Nandina / Nandina	

NOT FOR
CONSTRUCTION



LAKE RIDGE COMMONS
TOWNHOMES

GRAND PRAIRIE, TEXAS

REVISION / ISSUANCE

NO.	DESCRIPTION	DATE
1	SITE PLAN SUBMITTAL	12.01.2020
2	SITE PLAN RESUBMITTAL	12.18.2020
3	SITE PLAN RESUBMITTAL	01.05.2021

DESIGNED BY: LDI
DRAWN BY: LDI
CHECKED BY: LDI

VERT: N/A
HORZ: 1" = 40'

0 20 40 80.0001

PLANTING PLAN (SOUTH)

L1-02

CASE NO. S210101

DATE: 01/05/2021

KEY MAP

**NOT FOR
CONSTRUCTION**



PROJECT

LAKE RIDGE COMMONS
TOWNHOMES

GRAND PRAIRIE, TEXAS

LANGUAGE SOURCE

REVISION / ISSUANCE

NO.	DESCRIPTION	DATE
1	SITE PLAN SUBMITTAL	12.01.2020
2	SITE PLAN RESUBMITTAL	12.18.2020
3	SITE PLAN RESUBMITTAL	01.05.2021

DESIGNED BY: LDI
DRAWN BY: LDI
CHECKED BY: LDI

VERT: N/A
HORZ: #####



PLANTING SCHEDULE & CALCULATIONS

SHEET NUMBER
L1-03

CASE NO. S210101

ORIGINAL SHEET SIZE: 24" X 36"

PLANT SCHEDULE

TREES	CODE	QTY	BOTANICAL / COMMON NAME	MN. CONT.	MN. CAL.	MN. HT.
	AYCA	28	Aze barbatum / Cadoño / Cadoño Bugar Bagle Maple MATCH SPECIMEN, STRONG CENTRAL LEADER	CONT.	3' CAL	12-14' HT.
	NYSB	15	Nyssa sylvatica / Black Gum MATCHED SPECIMEN, STRONG CENTRAL LEADER	CONT.	3' CAL	12-14' HT.
	PTIX	13	Platanus texana / Texas Platanus MATCHED SPECIMEN, STRONG CENTRAL LEADER	CONT.	3' CAL	12-14' HT.
	QJMA	6	Quercus macrocarpa / Burr Oak MATCHED SPECIMEN, STRONG CENTRAL LEADER	CONT.	3' CAL	12-14' HT.
	QJPM	32	Quercus polymorpha / Monterey / Monterey Oak MATCHED SPECIMEN, STRONG CENTRAL LEADER	CONT.	3' CAL	12-14' HT.
	QSHB	25	Quercus shumardii / Shumard Red Oak MATCHED SPECIMEN, STRONG CENTRAL LEADER	CONT.	3' CAL	12-14' HT.
	QUTE	25	Quercus texana / Texas Red Oak MATCHED SPECIMEN, STRONG CENTRAL LEADER	CONT.	3' CAL	12-14' HT.
	TADJ	5	Taxodium distichum / Red Cypress MATCHED SPECIMEN, STRONG CENTRAL LEADER	CONT.	3' CAL	12-14' HT.
	ULAL	13	Ulmus alata / Winged Elm MATCHED SPECIMEN, STRONG CENTRAL LEADER	CONT.	3' CAL	12-14' HT.
	ULOR	6	Ulmus crassifolia / Cedar Elm MATCHED SPECIMEN, STRONG CENTRAL LEADER	CONT.	3' CAL	12-14' HT.
	ULPA	24	Ulmus parvifolia / Akee / Akee Leocarb Elm MATCHED SPECIMEN, STRONG CENTRAL LEADER	CONT.	3' CAL	12-14' HT.
SHRUBS	CODE	QTY	BOTANICAL / COMMON NAME	MN. CONT.	MN. CAL.	MN. HT.
	CCME	50	Cercis canadensis var. mexicana / Mexican Redbud MATCHED SPECIMEN, MULTI-STEM	CONT.	3' CAL	8-10' HT.
	LVA	63	Leea venusta / Vase Tree, TREE FORM	CONT.	3' CAL	10-12' HT.
	ELNO	34	Leguminosia x Nashcot / White Crape Myrtle Multi-Turn MATCHED SPECIMEN, MULTI-STEM	CONT.	3' CAL	10-12' HT.
	VIAG	68	Vitis rotundifolia / Cluster Vine MATCHED SPECIMEN, MULTI-STEM	CONT.	3' CAL	12-14' HT.
SHRUBS	CODE	QTY	BOTANICAL / COMMON NAME			
	ABOR	296	5-GALLON SHRUBS			
	ABOR		Abelia x grandiflora / Edward Goucher / Olney Abelia / Edward Goucher			
	ICCA		Buxus microphylla / Winter Green / Globe Winter Green / Buxus			
	ICCA		Ice cornuta / Burford Holly / Dwarf Burford Holly			
	LEFR		Ice cornuta / Cassia / Carolina Holly			
			Leucophyllum frutescens / Greedo / Desperado Texas Gae			
	480		3-GALLON SHRUBS			
	ABOR		Abelia x Rose Creek / Rose Creek Abelia			
	BTOP		Barberry thornless / Crimson Pygmy / Crimson Pygmy Japanese Barberry			
	HYSD		Ice venusta / Blakes Dwarf / Blakes Dwarf Yapon Holly			
	ICND		Hamamelis dioica / Harlow Dwarf / Harlow Dwarf			

LANDSCAPE REQUIREMENT COMPLIANCE
APPENDIX W: LANDSCAPE AND SCREENING
CITY OF GRAND PRAIRIE, TEXAS

DEVELOPABLE AREA

NORTH PROPERTY (300,170.0 sf)				
STANDARD	AREA (SF)	REQUIRED	PROVIDED	
1 tree / 2,500 sf	300,017 sf	120 trees	120 trees (3" cal.)	
SOUTH PROPERTY (257,684.7 sf)				
STANDARD	AREA (SF)	REQUIRED	PROVIDED	
1 tree / 2,500 sf	257,684.7	103 trees	103 trees (3" cal.)	
RESIDENTIAL LOTS				
CANOPY TREES				
STANDARD	LOTS	REQUIRED	PROVIDED	
2 trees / lot (less than 5000sf)	North Property - 47 lots	94 trees	94 trees (3" cal.)	
	South Property - 45 lots	90 trees	90 trees (3" cal.)	
	TOTAL	184 trees	184 trees (3" cal.)	
FRONT YARD SHRUBS				
STANDARD	LOTS	REQUIRED	PROVIDED	
min. 30-gal / lot	North Property - 47 lots	94-gal / lot	94-gal / lot	
	South Property - 45 lots	90-gal / lot	90-gal / lot	
	TOTAL	2,760 gallons for development	2,760 gallons for development	
LANDSCAPE AREA				
All landscape areas on residential lots to be fully sodded.				

PLANTING NOTES:

- ALL QUANTITIES LISTED IN THE DRAWINGS ARE FOR INFORMATION ONLY. IT IS THE CONTRACTOR'S RESPONSIBILITY TO VERIFY ALL QUANTITIES AND TO PROVIDE ALL MATERIALS NECESSARY FOR FULL COVERAGE IN ALL PLANTING AREAS TO BE PLANTED. THE CONTRACTOR SHALL BE RESPONSIBLE FOR THE PROTECTION OF ALL EXISTING UTILITIES AND STRUCTURES.
- THIS PLAN IS FOR PLANTING LOCATIONS ONLY AND ALL PLANT MATERIAL SHALL BE SPACED AND LOCATED PER PLAN. HOWEVER, CONTRACTOR TO SLIGHTLY ADJUST PLANT LOCATIONS IN THE FIELD AS NECESSARY TO BE CLEAR OF EXISTING UTILITIES AND STRUCTURES. THE CONTRACTOR SHALL BE RESPONSIBLE FOR THE PROTECTION OF ALL EXISTING UTILITIES AND STRUCTURES. THE CONTRACTOR SHALL BE RESPONSIBLE FOR THE PROTECTION OF ALL EXISTING UTILITIES AND STRUCTURES.
- ALL PLANTS SHOULD BE IN ACCORDANCE WITH ANSI Z601 - 2.1, RESILIAN IN CONTRACTOR'S STANDARD FOR NURSERY STOCK. CALIPER SIZES AND CANOPY HEIGHTS TO BE MEASURED PER CITY OF GRAND PRairie, TEXAS LANDSCAPE CRONOMETRIC STANDARDS.
- ALL PLANT MATERIAL SHALL CONFORM TO THE SIZE SPECIFICATIONS (CANOPY HEIGHT, WIDTH AND SPREAD) GIVEN IN THE PLANT SCHEDULE AND SHALL BE NURSERY GROWN UNLESS SPECIFIED OTHERWISE. FAILURE TO MEET MINIMUM SIZE ON ANY PLANT SPECIFICATION SHALL BE REASON FOR REJECTION OF THE PLANT.
- ANY PLANT SUBSTITUTION SHALL BE APPROVED BY LANDSCAPE PRIOR TO PURCHASE. SUBSTITUTIONS OF PLANT MATERIAL ARE TO BE REQUESTED IN WRITING TO THE LANDSCAPE ARCHITECT AND APPROVED IN WRITING BY THE OWNER. PRIOR TO PURCHASE AND INSTALLATION, FAILURE TO OBTAIN SUBSTITUTION APPROVAL, IN WRITING MAY RESULT IN LIABILITY TO THE CONTRACTOR.
- SIZES LISTED ARE MIN. AND REFER TO HEIGHT, UNLESS OTHERWISE SPECIFIED.
- LANDSCAPE CONTRACTOR SHALL STAKE OUT LOCATIONS OF ALL TREES TO BE PLANTED FOR REVIEW BY LANDSCAPE PRIOR TO INSTALLATION. LOCATIONS TO BE REVIEWED FOR THE RIGHT TO ADJUST TREE LOCATIONS IN THE FIELD AS NECESSARY FOR SHRUBS/GROUNDCOVER BEDS SHALL BE STAKED FOR REVIEW BY LANDSCAPE/OWNER'S REPRESENTATIVE PRIOR TO EXCAVATION AND OR BED PREPARATION.
- LANDSCAPE CONTRACTOR SHALL INSTALL STEEL EDGING BETWEEN PLANTING BEDS AND LAWNS, OR AS SHOWN IN DETAILS.
- LANDSCAPE CONTRACTOR SHALL BE RESPONSIBLE FOR VERIFYING THE LOCATION OF ALL UNDERGROUND UTILITIES. ANY UTILITIES, EXISTING OR PROPOSED, SHALL BE PROTECTED AND THE CONTRACTOR SHALL BE RESPONSIBLE FOR THE PROTECTION OF ALL EXISTING UTILITIES AND STRUCTURES.
- IT IS THE RESPONSIBILITY OF THE CONTRACTOR TO ADVISE LANDSCAPE OF ANY CONDITION FOUND ON THE SITE WHICH PROHIBITS INSTALLATION AS SHOWN ON THE DRAWINGS.
- LANDSCAPE CONTRACTOR IS RESPONSIBLE FOR ALL COORDINATION WITH OTHER CONTRACTORS ON SITE AS REQUIRED ACCORDING TO ALL PLANTING OPERATIONS.
- ALL PLANT MATERIAL SHALL BE MAINTAINED IN A HEALTHY GROWING CONDITION AND MUST BE REPLACED WITH PLANT OF SAME VARIETY AND SIZE IF DAMAGED, DESTROYED, DEAD AND/OR REMOVED.
- LANDSCAPE CONTRACTOR SHALL BE RESPONSIBLE FOR FINE GRADING AND REMOVAL OF DEBRIS PRIOR TO PLANTING IN ALL AREAS.
- FINAL FINISHED GRADING SHALL BE REVIEWED BY LANDSCAPE. CONTRACTOR IS RESPONSIBLE FOR ANY ADDITIONAL GRADING REQUIRED TO CREATE A SMOOTH AND UNIFORM SURFACE FOR PLANTING.
- TREES OVERHANGING INTO THE PUBLIC R.O.W. SHALL HAVE A MINIMUM CLEAR TRUNK HEIGHT OF FOURTEEN(14) FEET OVER STREETS, DRIVE ALLEYS, AND FIRE LINES. TREES OVERHANGING PRIVATE STREETS, WALKS, AND COURTYARDS SHALL HAVE A MINIMUM CLEAR TRUNK HEIGHT OF TEN(10) FEET.
- LANDSCAPE CONTRACTOR IS REQUIRED TO PERFORM A TREE PIT PERCOLATION TEST FOR EACH TREE PIT PRIOR TO INSTALLATION. IF TREE PIT DOES NOT DRAIN WITHIN A 24-HOUR PERIOD, THE CONTRACTOR WILL BE REQUIRED TO CONSTRUCT A TREE PIT DRAINAGE SYSTEM. TREE PIT SUMP SHALL BE INCLUDED IN THE CONTRACTOR'S BED BID AS A UNIT PRICE AND PROVIDE AS A DEDUCT ALTERNATE PER TREE PIT SUMP NOT REQUIRED TO BE INSTALLED.
- LANDSCAPE CONTRACTOR IS RESPONSIBLE TO REVIEW SITE ENVIRONMENTAL CONDITIONS PRIOR TO AND DURING INSTALLATION OF PLANT MATERIAL, ANY DISCREPANCIES OR CONCERNS BETWEEN THE ENVIRONMENTAL SITE ANALYSIS AND THE PLANT MATERIAL SPECIFICATIONS AND THE PLANT MATERIAL SPECIFICATIONS SPECIFIED WITHIN THE DRAWING SHALL BE BROUGHT TO THE ATTENTION OF LANDSCAPE AND/OR OWNER, AND SHALL BE DONE SO IN WRITING PRIOR TO INSTALLATION. ANY DISCREPANCIES OR CONCERNS BETWEEN THE ENVIRONMENTAL SITE ANALYSIS AND THE PLANT MATERIAL SPECIFICATIONS AND THE PLANT MATERIAL SPECIFICATIONS SPECIFIED WITHIN THE DRAWING SHALL BE BROUGHT TO THE ATTENTION OF LANDSCAPE AND/OR OWNER, AND SHALL BE DONE SO IN WRITING PRIOR TO INSTALLATION.
- LANDSCAPE CONTRACTOR IS RESPONSIBLE TO REVIEW SITE ENVIRONMENTAL CONDITIONS PRIOR TO AND DURING INSTALLATION OF PLANT MATERIAL, ANY DISCREPANCIES OR CONCERNS BETWEEN THE ENVIRONMENTAL SITE ANALYSIS AND THE PLANT MATERIAL SPECIFICATIONS AND THE PLANT MATERIAL SPECIFICATIONS SPECIFIED WITHIN THE DRAWING SHALL BE BROUGHT TO THE ATTENTION OF LANDSCAPE AND/OR OWNER, AND SHALL BE DONE SO IN WRITING PRIOR TO INSTALLATION.
- ALL NEW PLANTING AREAS SHALL HAVE A SOIL COMPOSITION CONSISTENT WITH SANDY LOAM TO LOAM SOIL PROPERTIES. CONTRACTOR SHALL BE RESPONSIBLE FOR TESTING THE SOIL COMPOSITION AND PROVIDING A SOIL TEST REPORT TO LANDSCAPE PRIOR TO INSTALLATION. IF THE SOIL COMPOSITION IS NOT CONSISTENT WITH THE REQUIREMENTS, THE CONTRACTOR SHALL PROVIDE A SOIL AMENDMENT PLAN TO ACHIEVE THE SOIL COMPOSITION DESIRED ABOVE.
- SOIL AMENDMENTS SHALL BE SELECTED FROM THE SOIL AMENDMENTS PROVIDED IN THE PLANTING DETAILS.
- AMENDED SOIL SHALL HAVE UNIFORM COMPOSITION THROUGHOUT, WITH A MIXTURE OF EXISTING SUBSOIL. IT SHALL BE RESPONSIBLE FOR THE CONTRACTOR TO PROVIDE A SOIL TEST REPORT TO LANDSCAPE PRIOR TO INSTALLATION. IF THE SOIL COMPOSITION IS NOT CONSISTENT WITH THE REQUIREMENTS, THE CONTRACTOR SHALL PROVIDE A SOIL AMENDMENT PLAN TO ACHIEVE THE SOIL COMPOSITION DESIRED ABOVE.
- NO MAN-MADE MATERIALS UNLESS OTHERWISE SPECIFIED. AMENDED SOIL SHALL NOT BE USED WHEN IN A FROZEN OR CRUSTED STATE.
- ALL NEW PLANTING AREAS, AMENDED SOILS SHALL BE TO A DEPTH OF
- 23.1. 4" - 6" FOR SOILD TURF AREAS
- 23.2. 12" - 18" FOR SHRUB AREAS
- 23.3. 24" - 36" FOR TREE PITTS AND AREAS.
- AFTER PLANTING SOIL MIXES ARE INSTALLED IN PLANTING BED AREAS AND JUST PRIOR TO THE INSTALLATION OF SHRUB BEDS, THE CONTRACTOR SHALL BE RESPONSIBLE FOR THE PROTECTION OF ALL EXISTING UTILITIES AND STRUCTURES. THE CONTRACTOR SHALL BE RESPONSIBLE FOR THE PROTECTION OF ALL EXISTING UTILITIES AND STRUCTURES.
- THE CONTRACTOR SHALL BE RESPONSIBLE FOR THE PROTECTION OF ALL EXISTING UTILITIES AND STRUCTURES. THE CONTRACTOR SHALL BE RESPONSIBLE FOR THE PROTECTION OF ALL EXISTING UTILITIES AND STRUCTURES.
- AFTER PLANTING SOIL MIXES ARE INSTALLED IN PLANTING BED AREAS AND JUST PRIOR TO THE INSTALLATION OF SHRUB BEDS, THE CONTRACTOR SHALL BE RESPONSIBLE FOR THE PROTECTION OF ALL EXISTING UTILITIES AND STRUCTURES. THE CONTRACTOR SHALL BE RESPONSIBLE FOR THE PROTECTION OF ALL EXISTING UTILITIES AND STRUCTURES.
- THE CONTRACTOR SHALL BE RESPONSIBLE FOR THE PROTECTION OF ALL EXISTING UTILITIES AND STRUCTURES. THE CONTRACTOR SHALL BE RESPONSIBLE FOR THE PROTECTION OF ALL EXISTING UTILITIES AND STRUCTURES.
- AFTER PLANTING SOIL MIXES ARE INSTALLED IN PLANTING BED AREAS AND JUST PRIOR TO THE INSTALLATION OF SHRUB BEDS, THE CONTRACTOR SHALL BE RESPONSIBLE FOR THE PROTECTION OF ALL EXISTING UTILITIES AND STRUCTURES. THE CONTRACTOR SHALL BE RESPONSIBLE FOR THE PROTECTION OF ALL EXISTING UTILITIES AND STRUCTURES.
- THE CONTRACTOR SHALL BE RESPONSIBLE FOR THE PROTECTION OF ALL EXISTING UTILITIES AND STRUCTURES. THE CONTRACTOR SHALL BE RESPONSIBLE FOR THE PROTECTION OF ALL EXISTING UTILITIES AND STRUCTURES.
- AFTER PLANTING SOIL MIXES ARE INSTALLED IN PLANTING BED AREAS AND JUST PRIOR TO THE INSTALLATION OF SHRUB BEDS, THE CONTRACTOR SHALL BE RESPONSIBLE FOR THE PROTECTION OF ALL EXISTING UTILITIES AND STRUCTURES. THE CONTRACTOR SHALL BE RESPONSIBLE FOR THE PROTECTION OF ALL EXISTING UTILITIES AND STRUCTURES.
- THE CONTRACTOR SHALL BE RESPONSIBLE FOR THE PROTECTION OF ALL EXISTING UTILITIES AND STRUCTURES. THE CONTRACTOR SHALL BE RESPONSIBLE FOR THE PROTECTION OF ALL EXISTING UTILITIES AND STRUCTURES.
- AFTER PLANTING SOIL MIXES ARE INSTALLED IN PLANTING BED AREAS AND JUST PRIOR TO THE INSTALLATION OF SHRUB BEDS, THE CONTRACTOR SHALL BE RESPONSIBLE FOR THE PROTECTION OF ALL EXISTING UTILITIES AND STRUCTURES. THE CONTRACTOR SHALL BE RESPONSIBLE FOR THE PROTECTION OF ALL EXISTING UTILITIES AND STRUCTURES.
- THE CONTRACTOR SHALL BE RESPONSIBLE FOR THE PROTECTION OF ALL EXISTING UTILITIES AND STRUCTURES. THE CONTRACTOR SHALL BE RESPONSIBLE FOR THE PROTECTION OF ALL EXISTING UTILITIES AND STRUCTURES.
- AFTER PLANTING SOIL MIXES ARE INSTALLED IN PLANTING BED AREAS AND JUST PRIOR TO THE INSTALLATION OF SHRUB BEDS, THE CONTRACTOR SHALL BE RESPONSIBLE FOR THE PROTECTION OF ALL EXISTING UTILITIES AND STRUCTURES. THE CONTRACTOR SHALL BE RESPONSIBLE FOR THE PROTECTION OF ALL EXISTING UTILITIES AND STRUCTURES.
- THE CONTRACTOR SHALL BE RESPONSIBLE FOR THE PROTECTION OF ALL EXISTING UTILITIES AND STRUCTURES. THE CONTRACTOR SHALL BE RESPONSIBLE FOR THE PROTECTION OF ALL EXISTING UTILITIES AND STRUCTURES.
- AFTER PLANTING SOIL MIXES ARE INSTALLED IN PLANTING BED AREAS AND JUST PRIOR TO THE INSTALLATION OF SHRUB BEDS, THE CONTRACTOR SHALL BE RESPONSIBLE FOR THE PROTECTION OF ALL EXISTING UTILITIES AND STRUCTURES. THE CONTRACTOR SHALL BE RESPONSIBLE FOR THE PROTECTION OF ALL EXISTING UTILITIES AND STRUCTURES.
- THE CONTRACTOR SHALL BE RESPONSIBLE FOR THE PROTECTION OF ALL EXISTING UTILITIES AND STRUCTURES. THE CONTRACTOR SHALL BE RESPONSIBLE FOR THE PROTECTION OF ALL EXISTING UTILITIES AND STRUCTURES.
- AFTER PLANTING SOIL MIXES ARE INSTALLED IN PLANTING BED AREAS AND JUST PRIOR TO THE INSTALLATION OF SHRUB BEDS, THE CONTRACTOR SHALL BE RESPONSIBLE FOR THE PROTECTION OF ALL EXISTING UTILITIES AND STRUCTURES. THE CONTRACTOR SHALL BE RESPONSIBLE FOR THE PROTECTION OF ALL EXISTING UTILITIES AND STRUCTURES.
- THE CONTRACTOR SHALL BE RESPONSIBLE FOR THE PROTECTION OF ALL EXISTING UTILITIES AND STRUCTURES. THE CONTRACTOR SHALL BE RESPONSIBLE FOR THE PROTECTION OF ALL EXISTING UTILITIES AND STRUCTURES.
- AFTER PLANTING SOIL MIXES ARE INSTALLED IN PLANTING BED AREAS AND JUST PRIOR TO THE INSTALLATION OF SHRUB BEDS, THE CONTRACTOR SHALL BE RESPONSIBLE FOR THE PROTECTION OF ALL EXISTING UTILITIES AND STRUCTURES. THE CONTRACTOR SHALL BE RESPONSIBLE FOR THE PROTECTION OF ALL EXISTING UTILITIES AND STRUCTURES.
- THE CONTRACTOR SHALL BE RESPONSIBLE FOR THE PROTECTION OF ALL EXISTING UTILITIES AND STRUCTURES. THE CONTRACTOR SHALL BE RESPONSIBLE FOR THE PROTECTION OF ALL EXISTING UTILITIES AND STRUCTURES.
- AFTER PLANTING SOIL MIXES ARE INSTALLED IN PLANTING BED AREAS AND JUST PRIOR TO THE INSTALLATION OF SHRUB BEDS, THE CONTRACTOR SHALL BE RESPONSIBLE FOR THE PROTECTION OF ALL EXISTING UTILITIES AND STRUCTURES. THE CONTRACTOR SHALL BE RESPONSIBLE FOR THE PROTECTION OF ALL EXISTING UTILITIES AND STRUCTURES.
- THE CONTRACTOR SHALL BE RESPONSIBLE FOR THE PROTECTION OF ALL EXISTING UTILITIES AND STRUCTURES. THE CONTRACTOR SHALL BE RESPONSIBLE FOR THE PROTECTION OF ALL EXISTING UTILITIES AND STRUCTURES.
- AFTER PLANTING SOIL MIXES ARE INSTALLED IN PLANTING BED AREAS AND JUST PRIOR TO THE INSTALLATION OF SHRUB BEDS, THE CONTRACTOR SHALL BE RESPONSIBLE FOR THE PROTECTION OF ALL EXISTING UTILITIES AND STRUCTURES. THE CONTRACTOR SHALL BE RESPONSIBLE FOR THE PROTECTION OF ALL EXISTING UTILITIES AND STRUCTURES.
- THE CONTRACTOR SHALL BE RESPONSIBLE FOR THE PROTECTION OF ALL EXISTING UTILITIES AND STRUCTURES. THE CONTRACTOR SHALL BE RESPONSIBLE FOR THE PROTECTION OF ALL EXISTING UTILITIES AND STRUCTURES.
- AFTER PLANTING SOIL MIXES ARE INSTALLED IN PLANTING BED AREAS AND JUST PRIOR TO THE INSTALLATION OF SHRUB BEDS, THE CONTRACTOR SHALL BE RESPONSIBLE FOR THE PROTECTION OF ALL EXISTING UTILITIES AND STRUCTURES. THE CONTRACTOR SHALL BE RESPONSIBLE FOR THE PROTECTION OF ALL EXISTING UTILITIES AND STRUCTURES.
- THE CONTRACTOR SHALL BE RESPONSIBLE FOR THE PROTECTION OF ALL EXISTING UTILITIES AND STRUCTURES. THE CONTRACTOR SHALL BE RESPONSIBLE FOR THE PROTECTION OF ALL EXISTING UTILITIES AND STRUCTURES.
- AFTER PLANTING SOIL MIXES ARE INSTALLED IN PLANTING BED AREAS AND JUST PRIOR TO THE INSTALLATION OF SHRUB BEDS, THE CONTRACTOR SHALL BE RESPONSIBLE FOR THE PROTECTION OF ALL EXISTING UTILITIES AND STRUCTURES. THE CONTRACTOR SHALL BE RESPONSIBLE FOR THE PROTECTION OF ALL EXISTING UTILITIES AND STRUCTURES.
- THE CONTRACTOR SHALL BE RESPONSIBLE FOR THE PROTECTION OF ALL EXISTING UTILITIES AND STRUCTURES. THE CONTRACTOR SHALL BE RESPONSIBLE FOR THE PROTECTION OF ALL EXISTING UTILITIES AND STRUCTURES.
- AFTER PLANTING SOIL MIXES ARE INSTALLED IN PLANTING BED AREAS AND JUST PRIOR TO THE INSTALLATION OF SHRUB BEDS, THE CONTRACTOR SHALL BE RESPONSIBLE FOR THE PROTECTION OF ALL EXISTING UTILITIES AND STRUCTURES. THE CONTRACTOR SHALL BE RESPONSIBLE FOR THE PROTECTION OF ALL EXISTING UTILITIES AND STRUCTURES.
- THE CONTRACTOR SHALL BE RESPONSIBLE FOR THE PROTECTION OF ALL EXISTING UTILITIES AND STRUCTURES. THE CONTRACTOR SHALL BE RESPONSIBLE FOR THE PROTECTION OF ALL EXISTING UTILITIES AND STRUCTURES.
- AFTER PLANTING SOIL MIXES ARE INSTALLED IN PLANTING BED AREAS AND JUST PRIOR TO THE INSTALLATION OF SHRUB BEDS, THE CONTRACTOR SHALL BE RESPONSIBLE FOR THE PROTECTION OF ALL EXISTING UTILITIES AND STRUCTURES. THE CONTRACTOR SHALL BE RESPONSIBLE FOR THE PROTECTION OF ALL EXISTING UTILITIES AND STRUCTURES.
- THE CONTRACTOR SHALL BE RESPONSIBLE FOR THE PROTECTION OF ALL EXISTING UTILITIES AND STRUCTURES. THE CONTRACTOR SHALL BE RESPONSIBLE FOR THE PROTECTION OF ALL EXISTING UTILITIES AND STRUCTURES.
- AFTER PLANTING SOIL MIXES ARE INSTALLED IN PLANTING BED AREAS AND JUST PRIOR TO THE INSTALLATION OF SHRUB BEDS, THE CONTRACTOR SHALL BE RESPONSIBLE FOR THE PROTECTION OF ALL EXISTING UTILITIES AND STRUCTURES. THE CONTRACTOR SHALL BE RESPONSIBLE FOR THE PROTECTION OF ALL EXISTING UTILITIES AND STRUCTURES.
- THE CONTRACTOR SHALL BE RESPONSIBLE FOR THE PROTECTION OF ALL EXISTING UTILITIES AND STRUCTURES. THE CONTRACTOR SHALL BE RESPONSIBLE FOR THE PROTECTION OF ALL EXISTING UTILITIES AND STRUCTURES.
- AFTER PLANTING SOIL MIXES ARE INSTALLED IN PLANTING BED AREAS AND JUST PRIOR TO THE INSTALLATION OF SHRUB BEDS, THE CONTRACTOR SHALL BE RESPONSIBLE FOR THE PROTECTION OF ALL EXISTING UTILITIES AND STRUCTURES. THE CONTRACTOR SHALL BE RESPONSIBLE FOR THE PROTECTION OF ALL EXISTING UTILITIES AND STRUCTURES.
- THE CONTRACTOR SHALL BE RESPONSIBLE FOR THE PROTECTION OF ALL EXISTING UTILITIES AND STRUCTURES. THE CONTRACTOR SHALL BE RESPONSIBLE FOR THE PROTECTION OF ALL EXISTING UTILITIES AND STRUCTURES.
- AFTER PLANTING SOIL MIXES ARE INSTALLED IN PLANTING BED AREAS AND JUST PRIOR TO THE INSTALLATION OF SHRUB BEDS, THE CONTRACTOR SHALL BE RESPONSIBLE FOR THE PROTECTION OF ALL EXISTING UTILITIES AND STRUCTURES. THE CONTRACTOR SHALL BE RESPONSIBLE FOR THE PROTECTION OF ALL EXISTING UTILITIES AND STRUCTURES.
- THE CONTRACTOR SHALL BE RESPONSIBLE FOR THE PROTECTION OF ALL EXISTING UTILITIES AND STRUCTURES. THE CONTRACTOR SHALL BE RESPONSIBLE FOR THE PROTECTION OF ALL EXISTING UTILITIES AND STRUCTURES.
- AFTER PLANTING SOIL MIXES ARE INSTALLED IN PLANTING BED AREAS AND JUST PRIOR TO THE INSTALLATION OF SHRUB BEDS, THE CONTRACTOR SHALL BE RESPONSIBLE FOR THE PROTECTION OF ALL EXISTING UTILITIES AND STRUCTURES. THE CONTRACTOR SHALL BE RESPONSIBLE FOR THE PROTECTION OF ALL EXISTING UTILITIES AND STRUCTURES.
- THE CONTRACTOR SHALL BE RESPONSIBLE FOR THE PROTECTION OF ALL EXISTING UTIL

IRRIGATION NOTES:

1. FULLY AUTOMATED IRRIGATION SYSTEM PROVIDING 100% COVERAGE SHALL BE PROVIDED FOR ALL PLANTING AREAS. A SYSTEM NOTED OTHERWISE: SYSTEM SHALL BE IN OPERATION PRIOR TO INSTALLATION OF ANY PLANT MATERIAL OTHER THAN CANOPY TREES.
2. ALL PLANTING BEDS/SHRUB AND GROUNDCOVER AREAS TO BE IRRIGATED WITH EITHER 12" SPRAY POP-UPS AND/OR A LANDSCAPE DRIP-LINE SYSTEM, UNLESS NOTED OTHERWISE.
3. ALL PLANTER POTS AND RAISED PLANTERS TO BE IRRIGATED WITH MICRO SPRAY SPRINKLER HEADS.
4. IRRIGATION SYSTEM IS DESIGN/BUILD. CONTRACTOR TO PROVIDE DRAWINGS AND CUT SHEETS OF ALL COMPONENTS.
5. PROVIDE AS-BUILT DRAWINGS OF IRRIGATION AFTER INSTALLATION.

