

## APPLICATION FOR A SPECIAL EVENTS PERMIT

Department Use Only

IN ORDER TO QUALIFY FOR A SPECIAL EVENTS PERMIT, YOU MUST BE NONPROFIT  
AND ONE OF THE FOLLOWING (See back for details.)

- |                                    |  |   |
|------------------------------------|--|---|
| <input type="checkbox"/> SOCIAL    | <input type="checkbox"/> ATHLETIC                              | <input checked="" type="checkbox"/> PHILANTHROPIC INSTITUTION |
| <input type="checkbox"/> FRATERNAL | <input type="checkbox"/> CHARTERED BRANCH, LODGE OR CHAPTER    | <input type="checkbox"/> POLITICAL CANDIDATE                  |
| <input type="checkbox"/> PATRIOTIC | <input type="checkbox"/> OF A NATIONAL ORGANIZATION OR SOCIETY | <input type="checkbox"/> MUNICIPALITY OWNING ARTS FACILITIES  |
| <input type="checkbox"/> POLITICAL | <input type="checkbox"/> RELIGIOUS INSTITUTION                 |   |

**LIAB TYPE OF SPECIAL EVENT APPLICANT IS APPLYING FOR:**  
2110 ☒ MALT, VINOUS AND SPIRITUOUS LIQUOR \$25.00 PER DAY  
2170 ☐ FERMENTED MALT BEVERAGE (3.2 Beer) \$10.00 PER DAY

**DO NOT WRITE IN THIS SPACE**

LIQUOR PERMIT NUMBER

1. NAME OF APPLICANT ORGANIZATION OR POLITICAL CANDIDATE

Colorado Riverfront Foundation, Inc.

State Sales Tax Number (Required)

2. MAILING ADDRESS OF ORGANIZATION OR POLITICAL CANDIDATE  
(include street, city/town and ZIP)

PO Box 2477  
Grand Junction, CO 81502

3. ADDRESS OF PLACE TO HAVE SPECIAL EVENT  
(include street, city/town and ZIP)

James M. Robb Colorado River State Park - Fruita Section  
595 Hwy 340  
Fruita CO 81521

NAME

DATE OF BIRTH

HOME ADDRESS (Street, City, State, ZIP)

PHONE NUMBER

4. PRES./SEC'Y OF ORG. or POLITICAL CANDIDATE

5. EVENT MANAGER

Paul Nelson and Ron Wilson

03/07/52

07/28/57

697 Tilman Drive, GJ 81506

2370 Rana Road, GJ 8157

970-245-0853

970-243-8497

6. HAS APPLICANT ORGANIZATION OR POLITICAL CANDIDATE BEEN  
ISSUED A SPECIAL EVENT PERMIT THIS CALENDAR YEAR?

☒ NO ☐ YES HOW MANY DAYS?

7. IS PREMISES NOW LICENSED UNDER STATE LIQUOR OR BEER CODE?

☒ NO ☐ YES TO WHOM?

8. DOES THE APPLICANT HAVE POSSESSION OR WRITTEN PERMISSION FOR THE USE OF THE PREMISES TO BE LICENSED? ☐ Yes ☐ No

LIST BELOW THE EXACT DATE(S) FOR WHICH APPLICATION IS BEING MADE FOR PERMIT

Date	Hours	From	To	Date	Hours	From	To	Date	Hours	From	To	Date	Hours	From	To
8/12/2022				9/9/2022											
	From 5:00p				From 5:00p				From				From		
	To 10:00p				To 10:00p				To				To		

### OATH OF APPLICANT

I declare under penalty of perjury in the second degree that I have read the foregoing application and all attachments thereto, and that all information therein is true, correct, and complete to the best of my knowledge.

SIGNATURE

Paul W. Nelson

TITLE

Board Member/Manager

DATE

03/21/22

### REPORT AND APPROVAL OF LOCAL LICENSING AUTHORITY (CITY OR COUNTY)

The foregoing application has been examined and the premises, business conducted and character of the applicant is satisfactory, and we do report that such permit, if granted, will comply with the provisions of Title 12, Article 48, C.R.S., as amended.

**THEREFORE, THIS APPLICATION IS APPROVED.**

LOCAL LICENSING AUTHORITY (CITY OR COUNTY)

The City of Fruita

☒ CITY

☐ COUNTY

TELEPHONE NUMBER OF CITY/COUNTY CLERK

(970) 639-4210

SIGNATURE

TITLE

JOEL KINCAID, MAYOR

DATE

**DO NOT WRITE IN THIS SPACE - FOR DEPARTMENT OF REVENUE USE ONLY**

### LIABILITY INFORMATION

License Account Number	Liability Date	State	TOTAL
		-750 (999)	\$

(Instructions on Reverse Side)

## Special Event Liquor Permit - Narrative

- ***Security arrangements for monitoring and control of ingress and egress points to insure that alcoholic beverages do not come in or leave the licensed premises:***  
The licensed beverage area may be accessed by the public via two clearly designated gates within the permanent wood three rail fencing. Construction fencing will complete any openings in the fence structure. The two public gates will be staffed by private uniformed security with available backup by Park Rangers. Gates will be monitored when patrons enter and exit the venue.
- ***Security/law enforcement arrangements to monitor crowd behavior and alcohol consumption:***  
The audience is well supervised by adequate staffing provided by the event/promoter. In addition, private uniformed security is available, concert staff personnel and Park Rangers. Private security will be available and assigned to the park/event area for law enforcement presence, crowd control, or any law enforcement issues. Private security will be assigned to assist with traffic control with the event is over.
- ***Type and height of fencing or barriers that will be erected or used to define the licensed area:***  
Perimeter fencing will be a combination of 4' rail fence and construction fencing. In addition, signage will be posted along the length of the fenced area advising 'No alcoholic beverages to be brought in or out of the designated area.'
- ***Location of restroom facilities/porta-johns within the licensed area:***  
There are permanent and porta-johns within the area. Both are located and depicted on the attached map.
- ***Location of signage to be posted concerning the consumption of alcoholic beverages outside the licensed area:***  
Signs to be placed at both public entrances (coming and going) as well as at the vehicle entrance to the park. Each concert ticket reiterates our policy on both front and backsides. In addition, signage will be posted along the fenced area – as stated above.
- ***Identification and age verification procedures for purchase and consumption of alcohol:***  
It is worth noting that our events generally play to an older demographic with an average age of 45. The staff is experienced, many are TIPS trained and will be checking ID's as needed much of the same as in a commercial establishment. The umbrella layer of security being provided by event staff, park staff, and private security. Last call is at 9:30pm.
- ***Procedures for training staff/volunteers concerning the sale of alcoholic beverages:***  
Servers are trained and experienced in beverage sales (Two Rivers Event staff).
- ***Arrangements for food to be sold or provided:***  
TBD food vendor(s) will be selling food items. Entrom's will be selling ice cream/novelty items. Water and soft drinks sales will be handled by bar staff and One Riverfront volunteer(s).
- ***Clean up arrangements during alcohol sale:***  
Whatever is left on the lawn after the concert will be collected and disposed of. Trash cans in circulation zones are emptied to dumpsters as needed. Staff will monitor trash during the event and collect as necessary.



# JAMES M. ROBB - COLORADO RIVER STATE PARK

HC L78

Hwy. 340

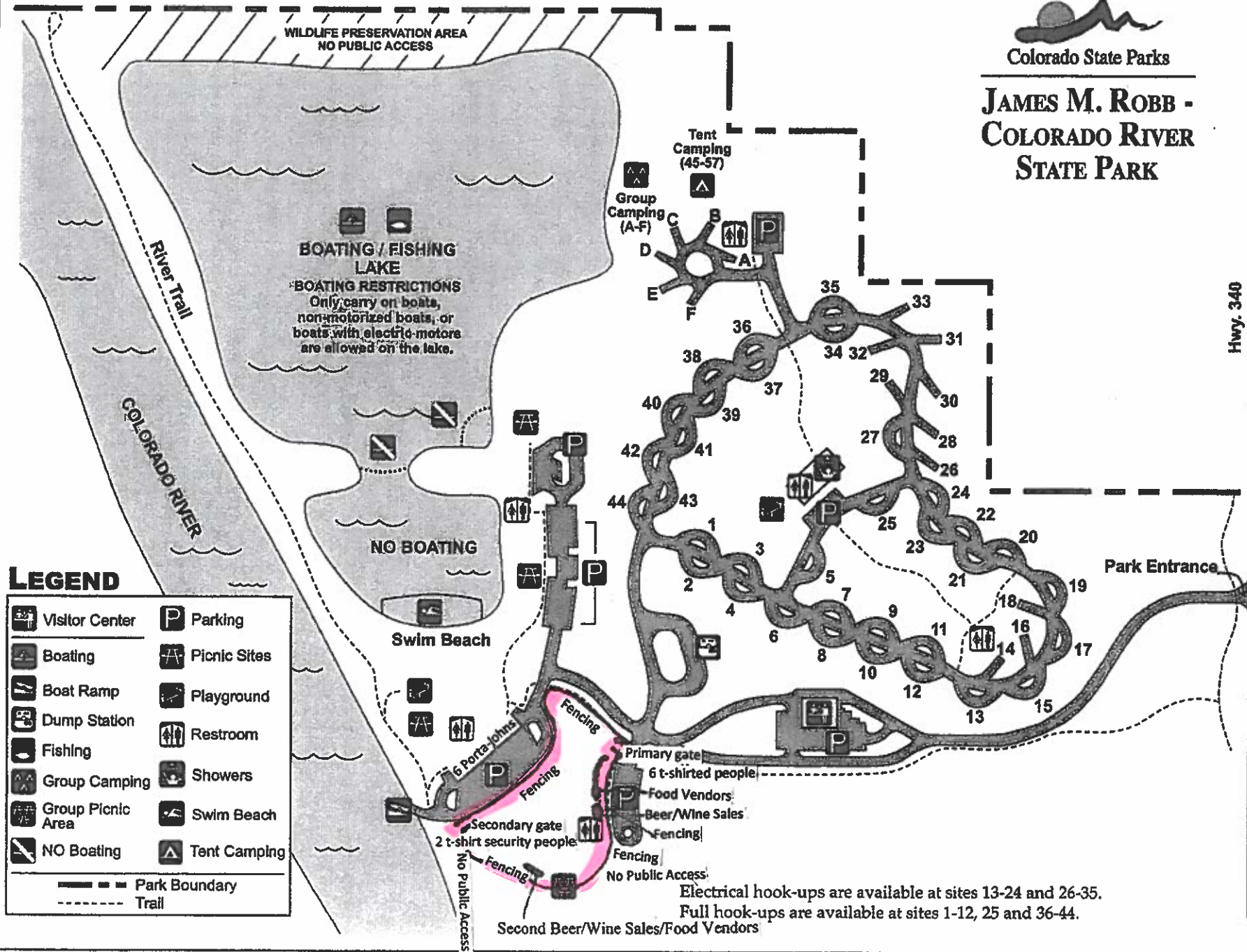

## LEGEND

- |                   |              |
|-------------------|--------------|
| Visitor Center    | Parking      |
| Boating           | Picnic Sites |
| Boat Ramp         | Playground   |
| Dump Station      | Restroom     |
| Fishing           | Showers      |
| Group Camping     | Swim Beach   |
| Group Picnic Area | Tent Camping |
| NO Boating        |              |
| Park Boundary     |              |
| Trail             |              |

Electrical hook-ups are available at sites 13-24 and 26-35.  
Full hook-ups are available at sites 1-12, 25 and 36-44.



## COLORADO

### Parks and Wildlife

Department of Natural Resources

James M. Robb-Colorado River State Park  
P.O. Box 700 (Mailing) 361 32 Rd. (Shipping)  
Clifton, CO, 81520  
P 970.434.3388 | F 970.434.6878

March 8, 2022

Riverfront Foundation  
544 Rood Ave.  
Grand Junction, CO. 81501

Sandstone Entertainment, Inc.  
P.O. Box 4544  
Grand Junction, CO. 81502

The Riverfront Foundation and Sandstone Entertainment, Inc. have my permission to apply for a Special Events Liquor Permit with the City of Fruita and the State of Colorado. The 2022 Concert Series is scheduled to be held at the Fruita Section of James M. Robb-Colorado River State Park.

Under a separate Special Activity Agreement issued by Colorado Parks and Wildlife, all parties agree to create a safe, clean and healthy environment for the concert series. The application for this liquor permit will assist in this effort. The special activity permit is contingent upon all parties securing required insurance and will be valid until October 31, 2022.

The Riverfront Foundation agrees to work with Sandstone Entertainment to provide all needed security and clean up for all events.

Sincerely,

Pete Firmin  
Park Manager, James M. Robb-Colorado River State Park



# Fruita Police Department

Chief David Krouse

157 S. Mesa St  
Fruita, CO 81521

970-858-3008 Phone  
970-858-3665 Fax  
[www.fruita.org](http://www.fruita.org)



**To:** Debra Woods  
**From:** Dave Krouse, Chief of Police  
**Date:** April 1, 2022  
**Re:** 2022 Riverfront Concerts Special Event Liquor Permit

The application and narrative have been reviewed. There is nothing which would prohibit the issuance of the license requested.

The licensee needs to be aware they are solely responsible for control of the licensed premises in regard to alcohol possession, consumption and adherence to state and municipal laws.

OFFICE OF THE SECRETARY OF STATE  
OF THE STATE OF COLORADO

**CERTIFICATE OF FACT OF GOOD STANDING**

I, Jena Griswold, as the Secretary of State of the State of Colorado, hereby certify that, according to the records of this office,

COLORADO RIVERFRONT FOUNDATION, INC.

is a

Nonprofit Corporation

formed or registered on 10/08/1987 under the law of Colorado, has complied with all applicable requirements of this office, and is in good standing with this office. This entity has been assigned entity identification number 19871755103 .

This certificate reflects facts established or disclosed by documents delivered to this office on paper through 03/18/2022 that have been posted, and by documents delivered to this office electronically through 03/21/2022 @ 11:05:16 .

I have affixed hereto the Great Seal of the State of Colorado and duly generated, executed, and issued this official certificate at Denver, Colorado on 03/21/2022 @ 11:05:16 in accordance with applicable law. This certificate is assigned Confirmation Number 13881626 .



*Jena Griswold*

Secretary of State of the State of Colorado

\*\*\*\*\*End of Certificate\*\*\*\*\*

*Notice: A certificate issued electronically from the Colorado Secretary of State's Web site is fully and immediately valid and effective. However, as an option, the issuance and validity of a certificate obtained electronically may be established by visiting the Validate a Certificate page of the Secretary of State's Web site, <http://www.sos.state.co.us/biz/CertificateSearchCriteria.do> entering the certificate's confirmation number displayed on the certificate, and following the instructions displayed. Confirming the issuance of a certificate is merely optional and is not necessary to the valid and effective issuance of a certificate. For more information, visit our Web site, <http://www.sos.state.co.us/> click "Businesses, trademarks, trade names" and select "Frequently Asked Questions."*