

In order to qualify for a Special Events Permit, You Must Be a Qualifying Organization Per 44-5-102 C.R.S. and One of the Following (See back for details.)

- ☐ Social ☐ Athletic ☒ Philanthropic Institution
☐ Fraternal ☐ Chartered Branch, Lodge or Chapter ☐ Political Candidate
☐ Patriotic ☐ National Organization or Society ☐ Municipality Owned Arts Facilities
☐ Political ☐ Religious Institution

LIAB Type of Special Event Applicant is Applying for: 2110 <input checked="" type="checkbox"/> Malt, Vinous And Spirituous Liquor \$25.00 Per Day 2170 <input type="checkbox"/> Fermented Malt Beverage \$10.00 Per Day		DO NOT WRITE IN THIS SPACE Liquor Permit Number	
1. Name of Applicant Organization or Political Candidate Museums of Western Colorado			State Sales Tax Number (Required) 98-04494-0000
2. Mailing Address of Organization or Political Candidate (include street, city/town and ZIP) 462 Ute Avenue Grand Junction, CO 81501		3. Address of Place to Have Special Event (include street, city/town and ZIP) 550 Jurassic Court Fruita, CO 81521	
4. Authorized Representative of Qualifying Organization or Political Candidate Julia McHugh		Date of Birth 07/31/79	Phone Number 970-242-0971 ext. 217
Authorized Representative's Mailing Address (if different than address provided in Question 2.) Same as Above			
5. Event Manager Julia McHugh		Date of Birth 07/31/79	Phone Number 970-242-0971 ext. 217
Event Manager Home Address (Street, City, State, ZIP) 121 S. Ash Street, Fruita, CO 81521		Email Address of Event Manager jmchugh@mowc.co	
6. Has Applicant Organization or Political Candidate been Issued a Special Event Permit this Calendar Year? <input type="checkbox"/> No <input checked="" type="checkbox"/> Yes How many days? 2		7. Is the premises for which your event is to be held currently licensed under the Colorado Liquor or Beer codes? <input checked="" type="checkbox"/> No <input type="checkbox"/> Yes License Number	
8. Does the Applicant Have Possession or Written Permission for the Use of The Premises to be Licensed? <input checked="" type="checkbox"/> Yes <input type="checkbox"/> No			
List Below the Exact Date(s) for Which Application is Being Made for Permit			
Date 08/03/24 Hours From 5:30 P.m. To 10:00 P.m.	Date Hours From .m. To .m.	Date Hours From .m. To .m.	Date Hours From .m. To .m.
Date Hours From .m. To .m.	Date Hours From .m. To .m.	Date Hours From .m. To .m.	Date Hours From .m. To .m.
Date Hours From .m. To .m.	Date Hours From .m. To .m.	Date Hours From .m. To .m.	Date Hours From .m. To .m.
Oath of Applicant I declare under penalty of perjury in the second degree that I have read the foregoing application and all attachments thereto, and that all information therein is true, correct, and complete to the best of my knowledge.			
Signature <i>J. McHugh</i>		Title Curator of Paleontology	Date 5-9-24
Report and Approval of Local Licensing Authority (City or County) The foregoing application has been examined and the premises, business conducted and character of the applicant is satisfactory, and we do report that such permit, if granted, will comply with the provisions of Title 44, Article 5, C.R.S., as amended. THEREFORE, THIS APPLICATION IS APPROVED.			
Local Licensing Authority (City or County) The City of Fruita		<input checked="" type="checkbox"/> City <input type="checkbox"/> County	Telephone Number of City/County Clerk (970) 639-4210
Signature <i>Matthew Brennan</i>		Title Mayor	Date
DO NOT WRITE IN THIS SPACE - FOR DEPARTMENT OF REVENUE USE ONLY			
Liability Information			
License Account Number	Liability Date	State	Total
		-750 (999)	\$

(Instructions on Reverse Side)

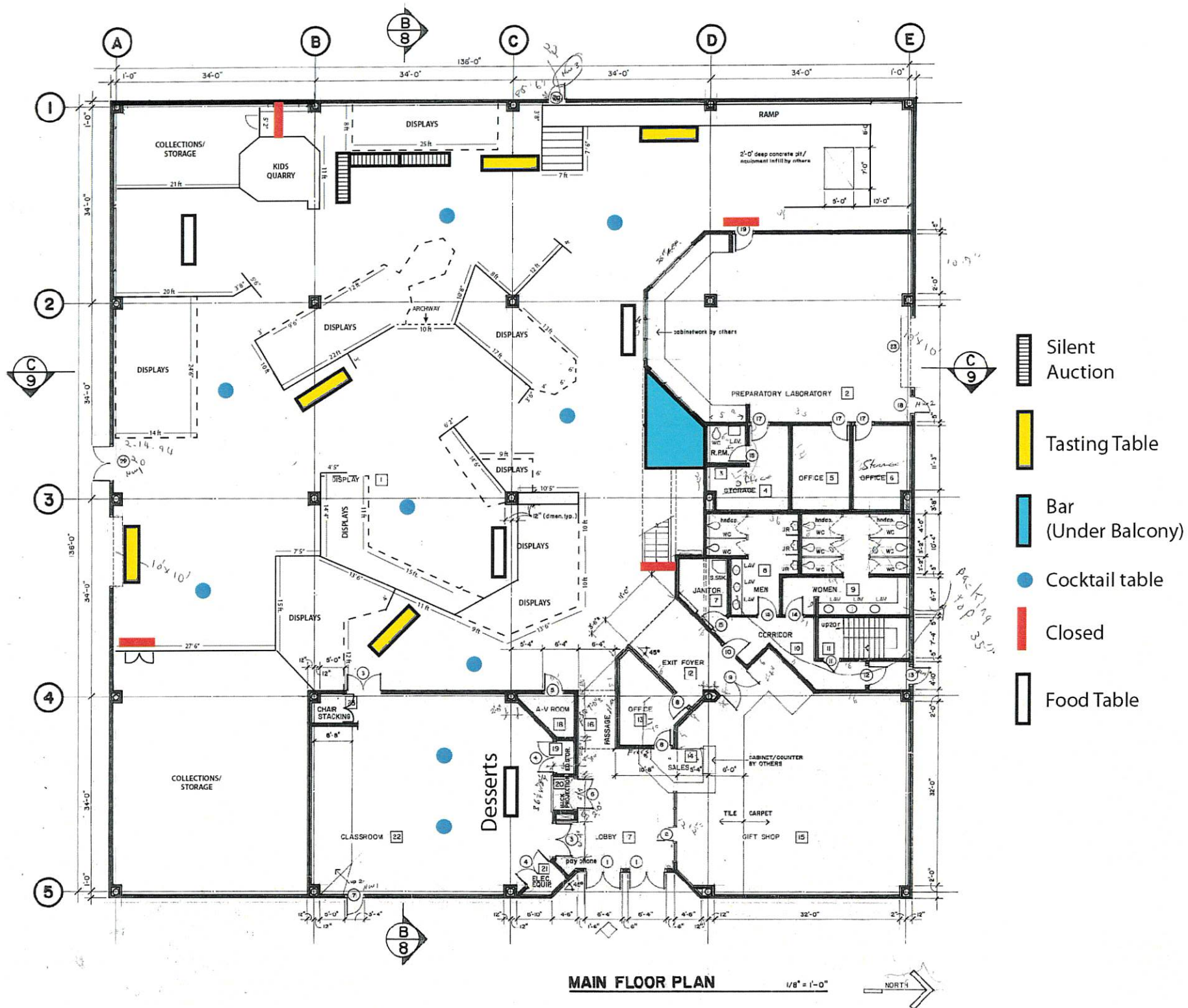

City of Fruita Special Event Liquor Permit Dinos on the Rocks Event Narrative

Dinos on the Rocks is a tasting event and fundraiser featuring local distilleries, bars & restaurants around the Grand Valley. Ticketed guests will be able sample tasting portions of cocktails, zero-proof mocktails, and spirits presented by participating vendors at the Dinosaur Journey Museum in Fruita on Aug. 3rd from 5:30-10:00 PM. All proceeds from the event will benefit the Museums of Western Colorado.

Guests will receive one drink token per admission (2 tokens for VIP admissions) that may be used for a full serving of a cocktail, zero-proof mocktail, or spirit. Additional tokens may be purchased at the event from the Museums of Western Colorado at the entrance/check in located in the museum lobby. Guests will vote after sampling for the best cocktail, zero-proof mocktail, spirit, and the most creative drink of the night. Winning vendors will be presented with prizes at the end of the evening.

Guests will enter and exit through the primary entrance of the museum (located on the east side of the building). Upon entering, a museum staff member (over 21) will check in arriving guests, validate event tickets, give each guest 4 voting tickets, their drink tokens, and check guest photo IDs. Additional drink tokens can be purchased in the front lobby. Guests over 21 will be given wrist bands to identify their drinking age to servers in the exhibition hall.

All alcohol servers will be provided by bar/distillery vendor staff, who are required to be over 21 and trained as alcohol servers. All participating bars and distilleries must hold current sales and liquor licenses for their own establishments and provide all required training for their serving employees. All alcohol and zero-proof cocktails will be served in acrylic or plastic cups.

Heavy appetizers and desserts will be served buffet-style during the event by The Cowboy & the Rose Catering. The room between the preparatory lab and the event bar will be provided to the caterers for food preparation and use during the event. Three food buffets will be placed inside the exhibition hall, where the tasting event will occur. A dessert buffet will be placed in the auditorium where event awards will be given out at the end of the event.

Alcohol will be permitted in the exhibition hall, auditorium, and front lobby. Signs posted in the front lobby, as well as near emergency exits, will state that removal of alcohol beyond the museum building or out the front doors is not permitted. Museum staff at the event will monitor the front lobby and the exit doors out of the exhibition hall to ensure guests adhere to the posted rules. The walls and doors of the building will form physical barriers to the designated area.

Restroom facilities are in the north hallway near the gift store at the Dinosaur Journey Museum. These include separate men's and women's facilities. In the men's restroom there are two stalls, one of which is handicap accessible, and three urinals. In the women's restroom there are six stalls, two of which are handicap accessible. Additionally, in the area to be used by the caterers at the event (room between the preparatory laboratory and the event bar area) there is a separate, single stall unisex restroom available.

Museum staff will monitor guests for behavior, provide resources for ride share or taxi to guests who need a designated driver, and contact Fruita police department or emergency services should any guests require medical attention or removal from the event. Serving staff from participating vendors will be required to monitor alcohol consumption by guests they serve and report any suspected intoxications to museum staff. At this point museum staff will take the next steps, either cutting off the patron from alcohol or getting them the appropriate services to leave the event. First aid supplies and an AED are located on site for medical needs and multiple museum staff are certified in CPR/AED/First Aid administration. Museum staff will perform janitorial services during the event, including monitoring and emptying full trash receptacles and ensuring any spills are promptly cleaned up.

Fruita Police Department

Chief David Krouse

157 S. Mesa St
Fruita, CO 81521

970-858-3008 Phone
970-858-3665 Fax
www.fruita.org



To: Debra Woods
From: Dave Krouse, Chief of Police
Date: May 1, 2024
Re: 2024 Dinos on the Rocks Special Event Liquor Permit

The application and narrative have been reviewed. There is nothing which would prohibit the issuance of the license requested.

The licensee needs to be aware they are solely responsible for control of the licensed premises in regard to alcohol possession, consumption and adherence to state and municipal laws.

Summary of Fruita Lease Agreement

The MWC is getting a \$1-a-year lease as requested by the Council, but they also wanted to codify in the lease that the MWC would still take care of Fruita's assets (building and site). This resulted in a long discussion in finding a way to insure the MWC gets the reduced rent and that Fruita's assets are protected. This lease draft is the result of that discussion.

Fruita will still charge the MWC \$57,600 in base rent a year; however the Museums can pay that rent by spending the money on other expenses that are related to Dinosaur Journey. Fruita is specifying how the MWC can use the rent savings (\$57,600).

For the most part, that money can be used on Dinosaur Journey professional labor (Dr. McHugh), insurance, exhibits, marketing, maintenance, and capital upgrade. All these easily add up to \$57,600 a year (Julia's salary and exhibits alone nearly take this all up), but there are a couple provisos.

- MWC needs to pay Fruita \$2,400 annually (\$200 per month) for outdoor maintenance and parking lot.
- 15% of the saving must be used on maintenance. That comes to \$8,640 per year. The \$2,400 Fruita fee can come out of that, so that obligates us to spending at least \$6,240 per year on maintenance ("which includes keeping the building, building systems, parking lot and common areas in good repair."). Last year, our maintenance expenses added up to approximately this amount.
- 20% has to be used on capital ("improvements and repairs to the Buildings") which comes to \$11,520 or put into a separate account and saved for future capital improvements and repairs. They are requiring us to put money into that account until it reaches \$60,000, and then we can use that 20% for other purposes. And of course, if we have an improvement or repair need, we can use a portion of the account and replenish it the following years.
 - Note: for this year, due to the roof repair, we have already exceeded the \$11,520, so we don't have to pull out any more money this year.
- MWC needs to pay the Grand Junction Drainage District fee for the Devils Canyon Center is estimated at \$1,402 (this doesn't go towards the base rent)

In addition, it is a 10-year lease renewable for four 5-year increments, thus the lease goes to December 31, 2039).

Provided the Board accepts the draft lease, it goes through two different "Readings" in front of the Fruita Council. The first is March 1st and the second is April 5th. The first is a formality and our presence is not needed; but at the second, the Council will vote on it and our presence is recommended.



MUSEOFW-01

SARAM

CERTIFICATE OF LIABILITY INSURANCE

DATE (MM/DD/YYYY)

5/9/2024

THIS CERTIFICATE IS ISSUED AS A MATTER OF INFORMATION ONLY AND CONFERS NO RIGHTS UPON THE CERTIFICATE HOLDER. THIS CERTIFICATE DOES NOT AFFIRMATIVELY OR NEGATIVELY AMEND, EXTEND OR ALTER THE COVERAGE AFFORDED BY THE POLICIES BELOW. THIS CERTIFICATE OF INSURANCE DOES NOT CONSTITUTE A CONTRACT BETWEEN THE ISSUING INSURER(S), AUTHORIZED REPRESENTATIVE OR PRODUCER, AND THE CERTIFICATE HOLDER.

IMPORTANT: If the certificate holder is an ADDITIONAL INSURED, the policy(ies) must have ADDITIONAL INSURED provisions or be endorsed. If SUBROGATION IS WAIVED, subject to the terms and conditions of the policy, certain policies may require an endorsement. A statement on this certificate does not confer rights to the certificate holder in lieu of such endorsement(s).

PRODUCER Home Loan & Investment Company 205 North 4th Street Grand Junction, CO 81501	CONTACT NAME: Sara Mendenhall PHONE (A/C, No, Ext): (970) 254-0846 FAX (A/C, No): (970) 243-3914 E-MAIL ADDRESS: saram@hlic.com
INSURED Museums Of Western Colorado DBA Museums of the West 462 Ute Ave Grand Junction, CO 81501	INSURER(S) AFFORDING COVERAGE INSURER A: Philadelphia Indemnity Insurance Company NAIC # 18058 INSURER B: Pinnacol Assurance 41190 INSURER C: INSURER D: INSURER E: INSURER F:

COVERAGES

CERTIFICATE NUMBER:

REVISION NUMBER:

THIS IS TO CERTIFY THAT THE POLICIES OF INSURANCE LISTED BELOW HAVE BEEN ISSUED TO THE INSURED NAMED ABOVE FOR THE POLICY PERIOD INDICATED. NOTWITHSTANDING ANY REQUIREMENT, TERM OR CONDITION OF ANY CONTRACT OR OTHER DOCUMENT WITH RESPECT TO WHICH THIS CERTIFICATE MAY BE ISSUED OR MAY PERTAIN, THE INSURANCE AFFORDED BY THE POLICIES DESCRIBED HEREIN IS SUBJECT TO ALL THE TERMS, EXCLUSIONS AND CONDITIONS OF SUCH POLICIES. LIMITS SHOWN MAY HAVE BEEN REDUCED BY PAID CLAIMS.

INSR LTR	TYPE OF INSURANCE	ADDL SUBR INSD WVD	POLICY NUMBER	POLICY EFF (MM/DD/YYYY)	POLICY EXP (MM/DD/YYYY)	LIMITS
A	<input checked="" type="checkbox"/> COMMERCIAL GENERAL LIABILITY <input type="checkbox"/> CLAIMS-MADE <input checked="" type="checkbox"/> OCCUR GEN'L AGGREGATE LIMIT APPLIES PER: <input checked="" type="checkbox"/> POLICY <input type="checkbox"/> PROJECT <input checked="" type="checkbox"/> LOC OTHER:	X	PHPK2638753	1/1/2024	1/1/2025	EACH OCCURRENCE \$ 1,000,000 DAMAGE TO RENTED PREMISES (Ea occurrence) \$ 100,000 MED EXP (Any one person) \$ 5,000 PERSONAL & ADV INJURY \$ 1,000,000 GENERAL AGGREGATE \$ 2,000,000 PRODUCTS - COMP/OP AGG \$ 2,000,000 LIQUOR LIABILITY \$ 1,000,000
A	AUTOMOBILE LIABILITY <input checked="" type="checkbox"/> ANY AUTO OWNED AUTOS ONLY <input checked="" type="checkbox"/> HIRED AUTOS ONLY <input type="checkbox"/> SCHEDULED AUTOS <input checked="" type="checkbox"/> NON-OWNED AUTOS ONLY		PHPK2638753	1/1/2024	1/1/2025	COMBINED SINGLE LIMIT (Ea accident) \$ 1,000,000 BODILY INJURY (Per person) \$ BODILY INJURY (Per accident) \$ PROPERTY DAMAGE (Per accident) \$
A	<input checked="" type="checkbox"/> UMBRELLA LIAB <input type="checkbox"/> EXCESS LIAB <input checked="" type="checkbox"/> RETENTION \$ 10,000	<input checked="" type="checkbox"/> OCCUR <input type="checkbox"/> CLAIMS-MADE	PHUB894731	1/1/2024	1/1/2025	EACH OCCURRENCE \$ 1,000,000 AGGREGATE \$ 1,000,000
B	WORKERS COMPENSATION AND EMPLOYERS' LIABILITY ANY PROPRIETOR/PARTNER/EXECUTIVE OFFICER/MEMBER EXCLUDED? (Mandatory in NH) If yes, describe under DESCRIPTION OF OPERATIONS below	Y/N N/A	2115532	2/1/2024	2/1/2025	<input checked="" type="checkbox"/> PER STATUTE OTHER E.L. EACH ACCIDENT \$ 500,000 E.L. DISEASE - EA EMPLOYEE \$ 500,000 E.L. DISEASE - POLICY LIMIT \$ 500,000

DESCRIPTION OF OPERATIONS / LOCATIONS / VEHICLES (ACORD 101, Additional Remarks Schedule, may be attached if more space is required)

RE: Dinos on the Rocks - August 3, 2024

City of Fruita is additional insured with regard to 550 Jurassic Ct - Fruita, CO on the General Liability coverage when required by written contract. Liquor Liability included.

CERTIFICATE HOLDER

CANCELLATION

City of Fruita
325 E Aspen
Fruita, CO 81521

SHOULD ANY OF THE ABOVE DESCRIBED POLICIES BE CANCELLED BEFORE THE EXPIRATION DATE THEREOF, NOTICE WILL BE DELIVERED IN ACCORDANCE WITH THE POLICY PROVISIONS.

AUTHORIZED REPRESENTATIVE