



June 16, 2025

**The proposed signage is as follows:**

**Monument Sign (Ground Sign) Illuminated:**

Size Permitted: 208' x 0.5 sq. ft. = 104 sq. ft. (Max. allowed per 1111.08-3 is 64 sq. ft.)

Size Proposed = 4'-1" x 2'-8" = 11 sq. ft.

**Wall Signs Illuminated:**

Size Permitted: 42' x 2 sq. ft. = 76 sq. ft.

South Elevation:

Lee's Famous Recipe Chicken Sign = 24 sq. ft.

North Elevation:

Lee's Famous Recipe Sign with Helen = 51 sq. ft.

Total Signage Provided: 75 sq. ft.

**Window Signs Nonilluminated:**

Size Permitted: 1 sq. ft.

(1) Front Door:

Welcome Back Sign = 1 sq. ft.

**Menu Board:**

Size Permitted: 48 sq. ft.

(3) panels = 3'-7" x 2'-1" each = 22 sq ft. total

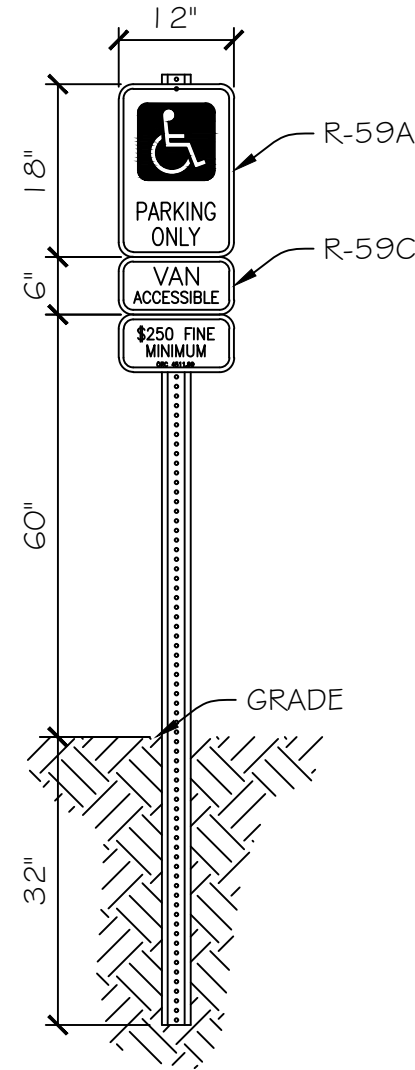

ACCESSIBLE PARKING  
SIGN DETAIL  
NO SCALE

NOTE:

FOR SIGNAGE REQUIREMENTS, SEE "MANUAL OF UNIFORM TRAFFIC CONTROL DEVICES", BY THE OHIO DEPARTMENT OF TRANSPORTATION. SIGN TYPE IS STANDARD, CODE NUMBER IS R-59A & SIZE IS 12" x 18", THE BORDER & PARKING ONLY IS GREEN LEGEND ON WHITE BACKGROUND AND THE SYMBOL IS WHITE ON BLUE BACKGROUND. "VAN ACCESSIBLE" SIGN, WHEN REQUIRED IS STANDARD, R-59C & SIZE IS 12" x 6", WITH GREEN LEGEND ON WHITE BACKGROUND.

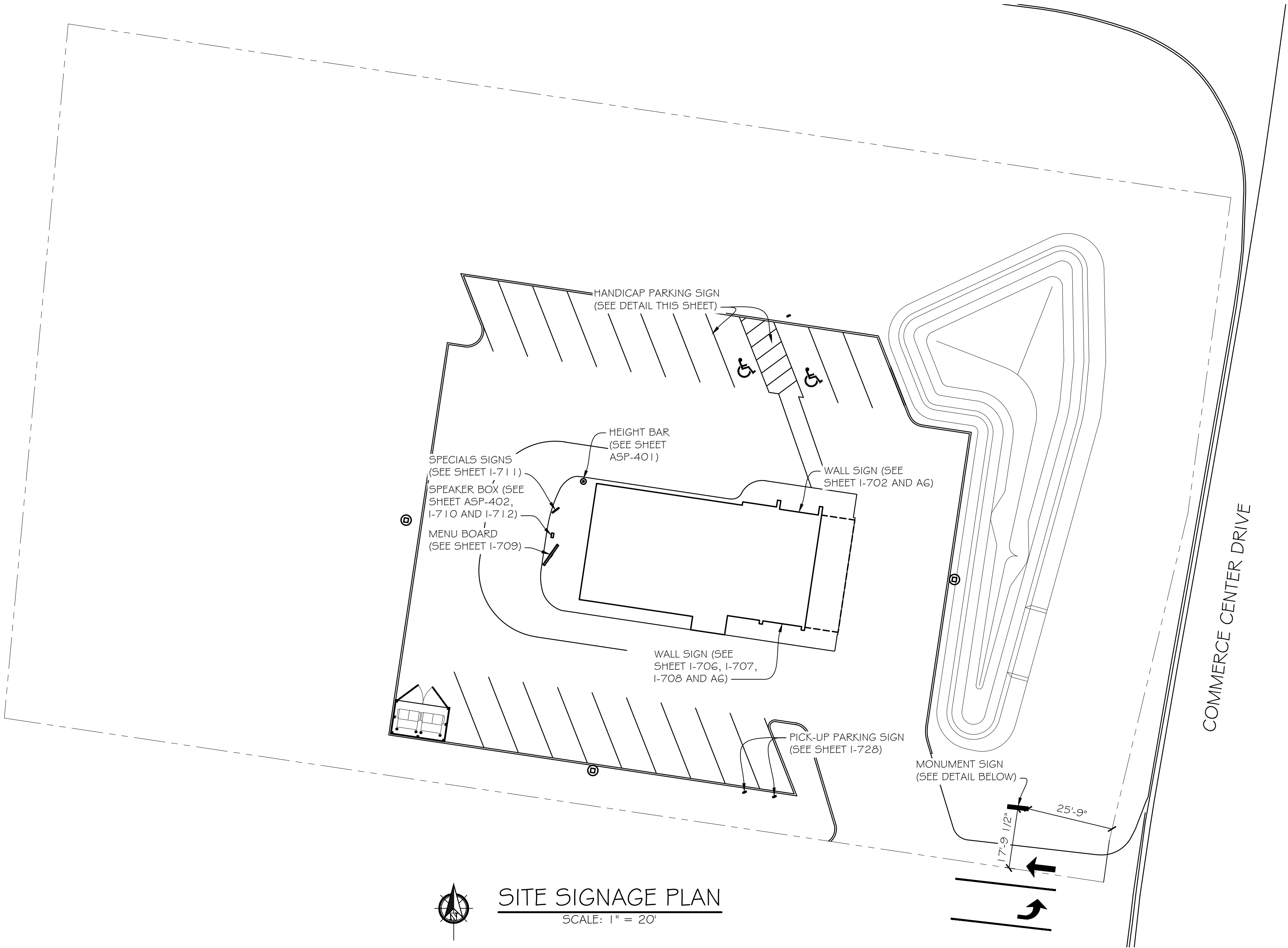

SITE SIGNAGE PLAN  
SCALE: 1" = 20'

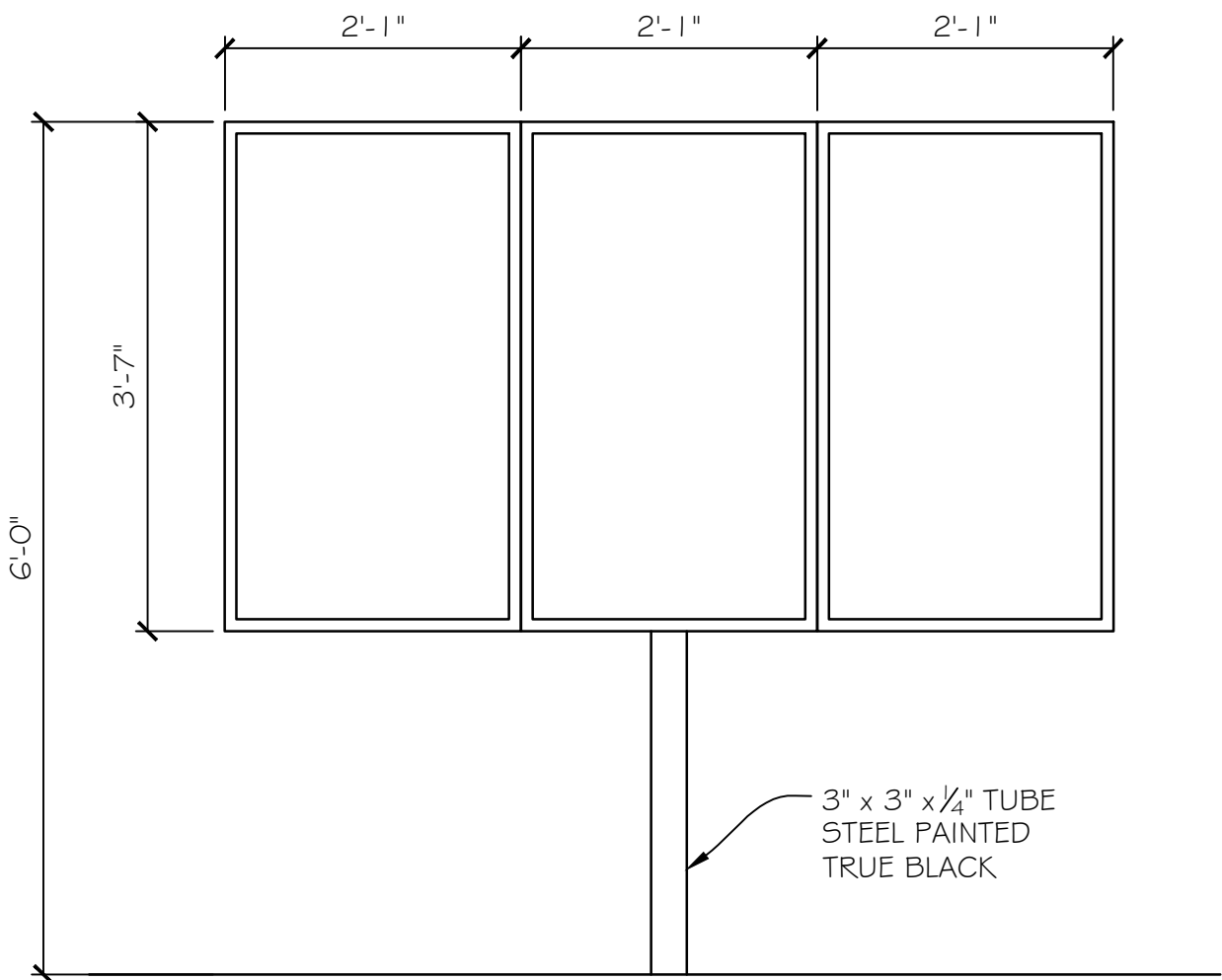

MENU BOARD  
SCALE: 3/4" = 1'-0"



MONUMENT SIGN  
(NORTH AND SOUTH FACES)  
SCALE: 3/4" = 1'-0"

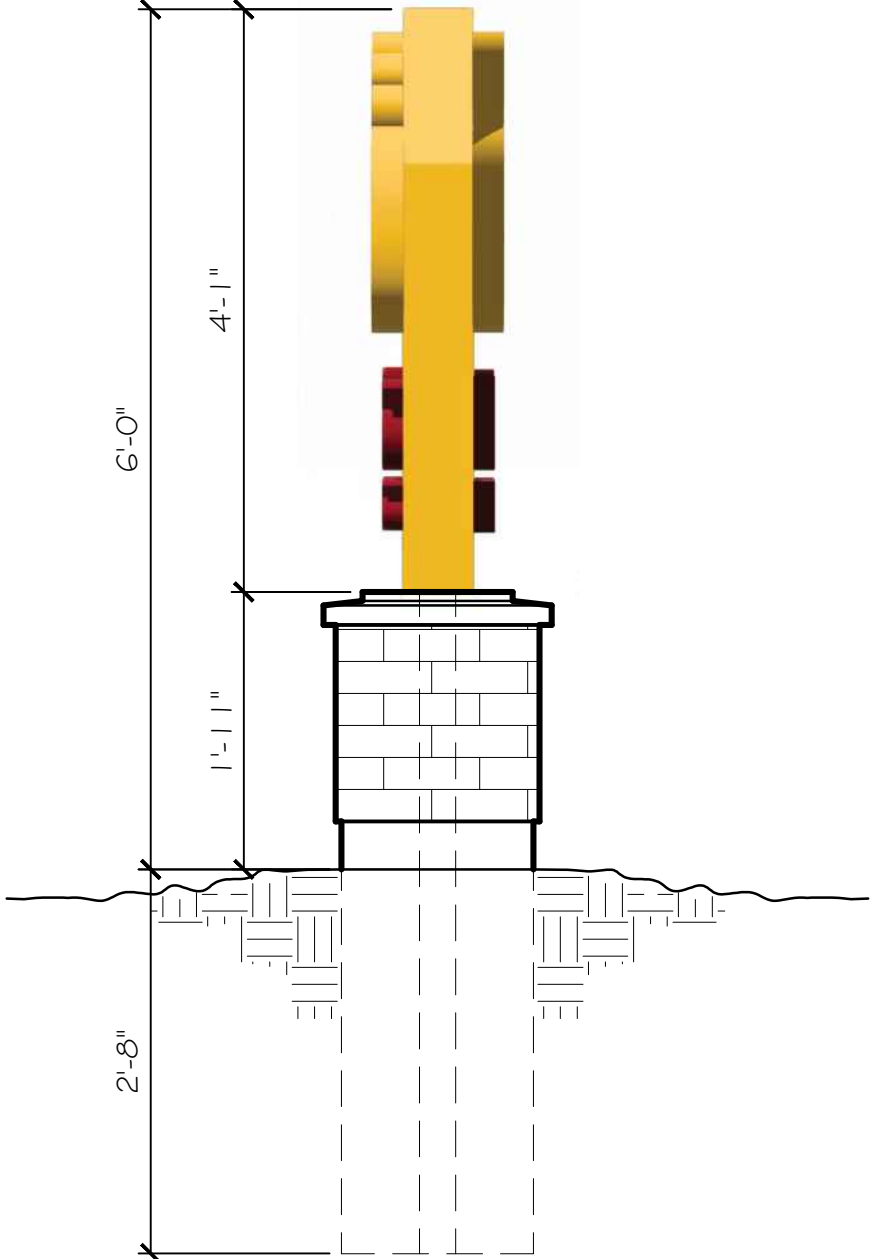

MONUMENT SIGN  
(EAST AND WEST FACES)  
SCALE: 3/4" = 1'-0"

REVISIONS/COMMENTS

1610 S.R. 718, Suite C  
Franklin, OH 45005  
Tel. - 937-552-9614  
Fax. - 937-339-8772  
www.AllianceEngLLC.com  
ALLIANCE ENGINEERING, LLC

Client Address  
0 Commerce Center Drive  
Parcel ID #042626034  
Franklin, Ohio 45005

Client Name  
**LEE'S FAMOUS RECIPE CHICKEN**

Project Number  
**25008**

Design By  
**WAL**

Design Date  
**4-8-25**

Sheet  
**1**

Sheets  
**of 1**

Drawing Number  
**SI-1**

Description  
**SITE SIGNAGE PLAN**

File  
**01**

Drawn By  
**WAL**

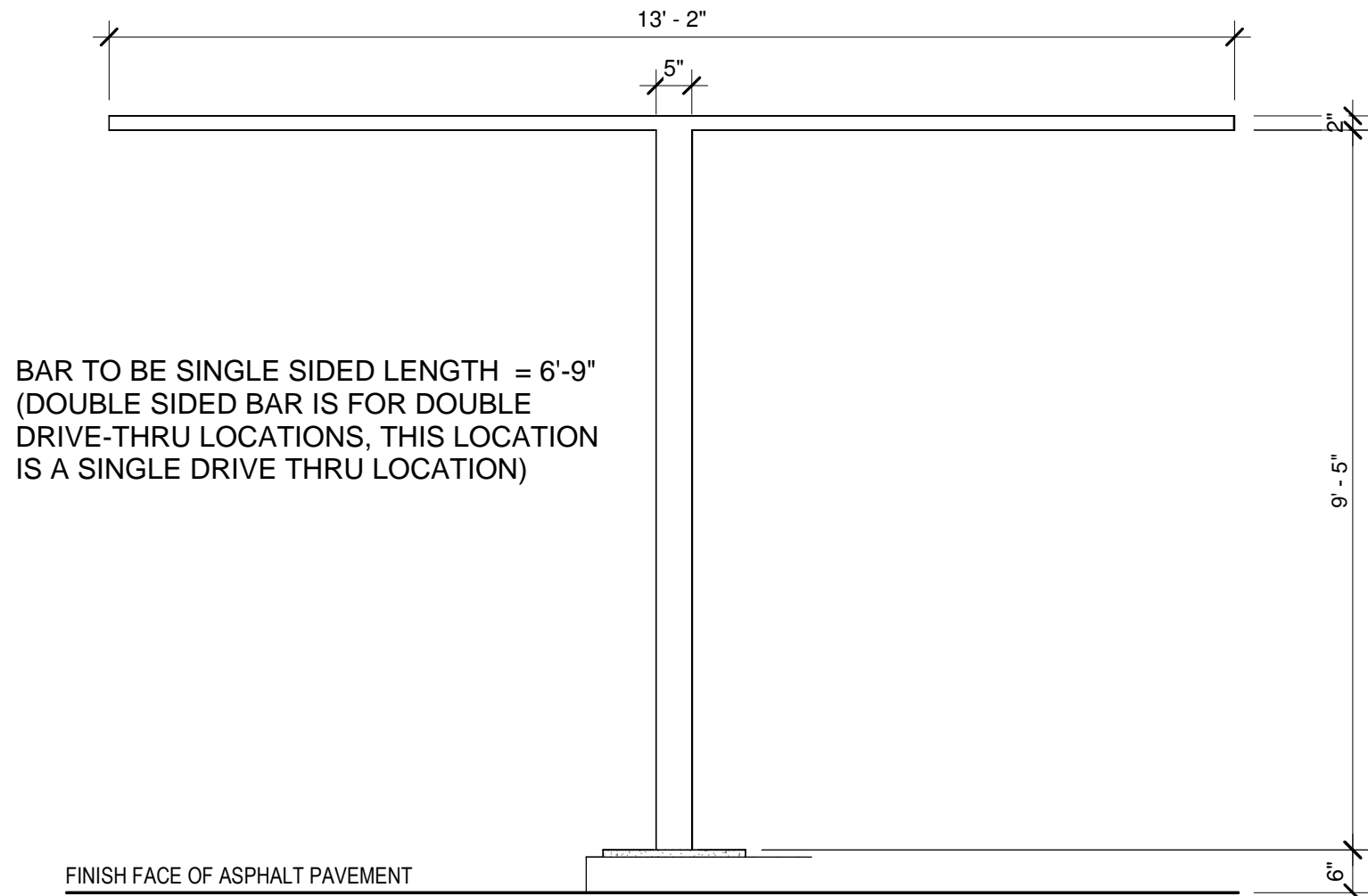

10 | SFX-03 - ELEVATION DETAIL

ASP-401 SCALE: 1/2" = 1'-0"

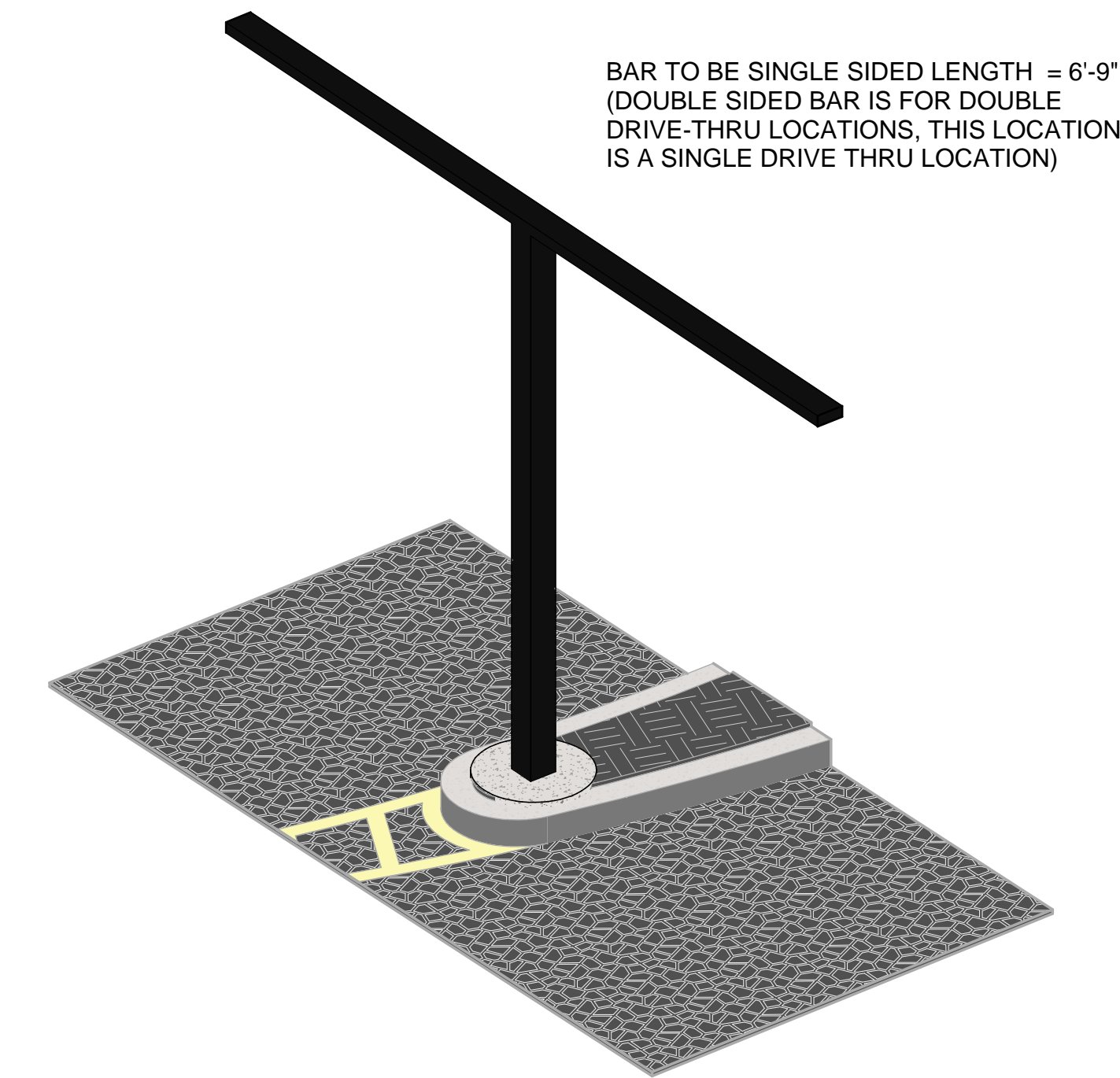

7 | SFX-03 - AXON

ASP-401 SCALE:

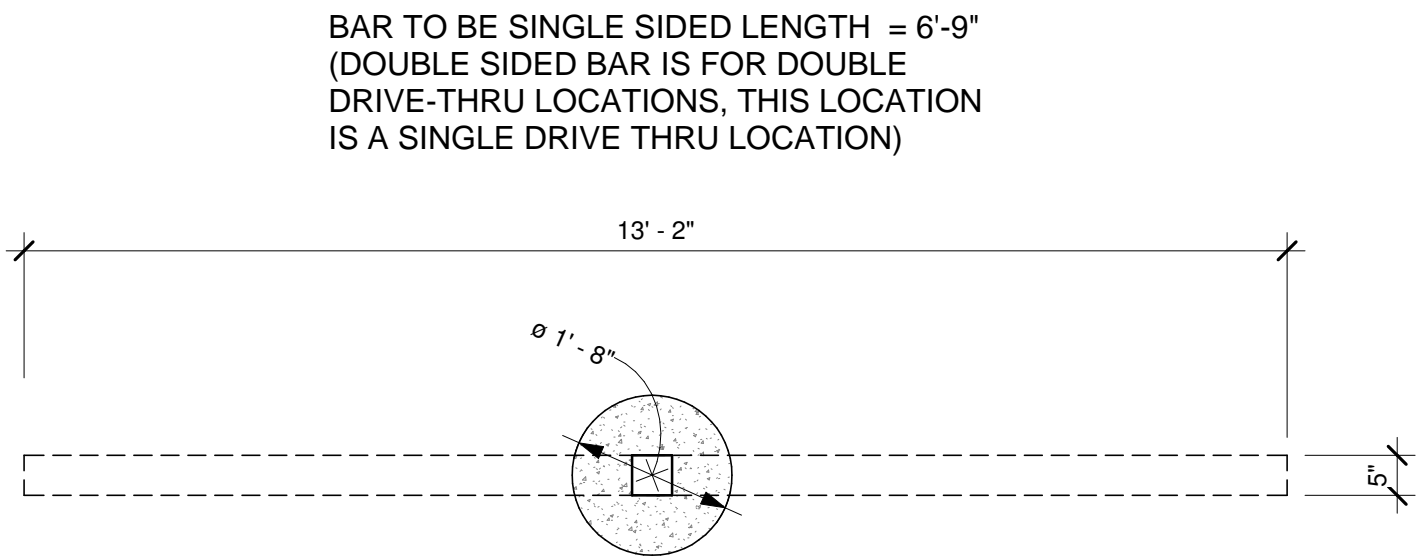

8 | SFX-03 - PLAN DETAIL

ASP-401 SCALE: 1/2" = 1'-0"



NOT FOR  
CONSTRUCTION



**STIPULATION FOR REUSE**  
THESE DRAWINGS AND SPECIFICATIONS SHALL NOT BE REPRODUCED (IN WHOLE OR IN PART), SHARED WITH THIRD PARTIES OR USED IN ANY MANNER ON OTHER PROJECTS OR EXTENSIONS TO THIS PROJECT WITHOUT PRIOR WRITTEN CONSENT OF CHUTE GERDEMAN AND / OR OWNER.

**DESIGN INTENT SET ONLY. NOT  
INTENDED FOR PERMITTING.**

PROJECT NAME:  
LEE'S FAMOUS RECIPE CHICKEN  
EVOLUTIONARY PROTOTYPE DESIGN

PROJECT ADDRESS:  
ADDRESS TBD  
CITY, STATE ZIPCODE

ISSUE DATE: 8.31.2023  
DESIGN CONTACT: NATE MOSURE

CURRENT SET			
#	Date	By	Description
1	8.31.23		DESIGN INTENT SET

SHEET TITLE:  
**SITE FIXTURE DETAILS**

SHEET NUMBER:  
**ASP-401**

SCALE: AS INDICATED WHEN PRINTED AT 24"X36"

DESIGN INTENT SET



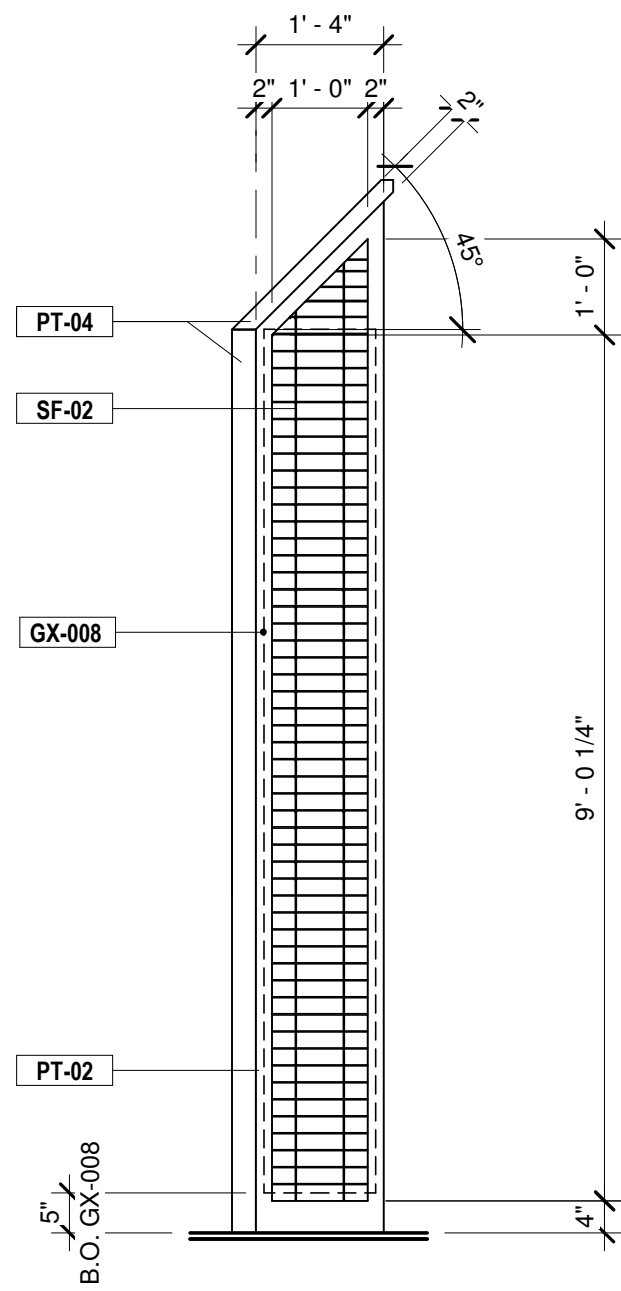

4 | SITE FX 05 - ELEVATION  
ASP-402 | SCALE: 1/2" = 1'-0"

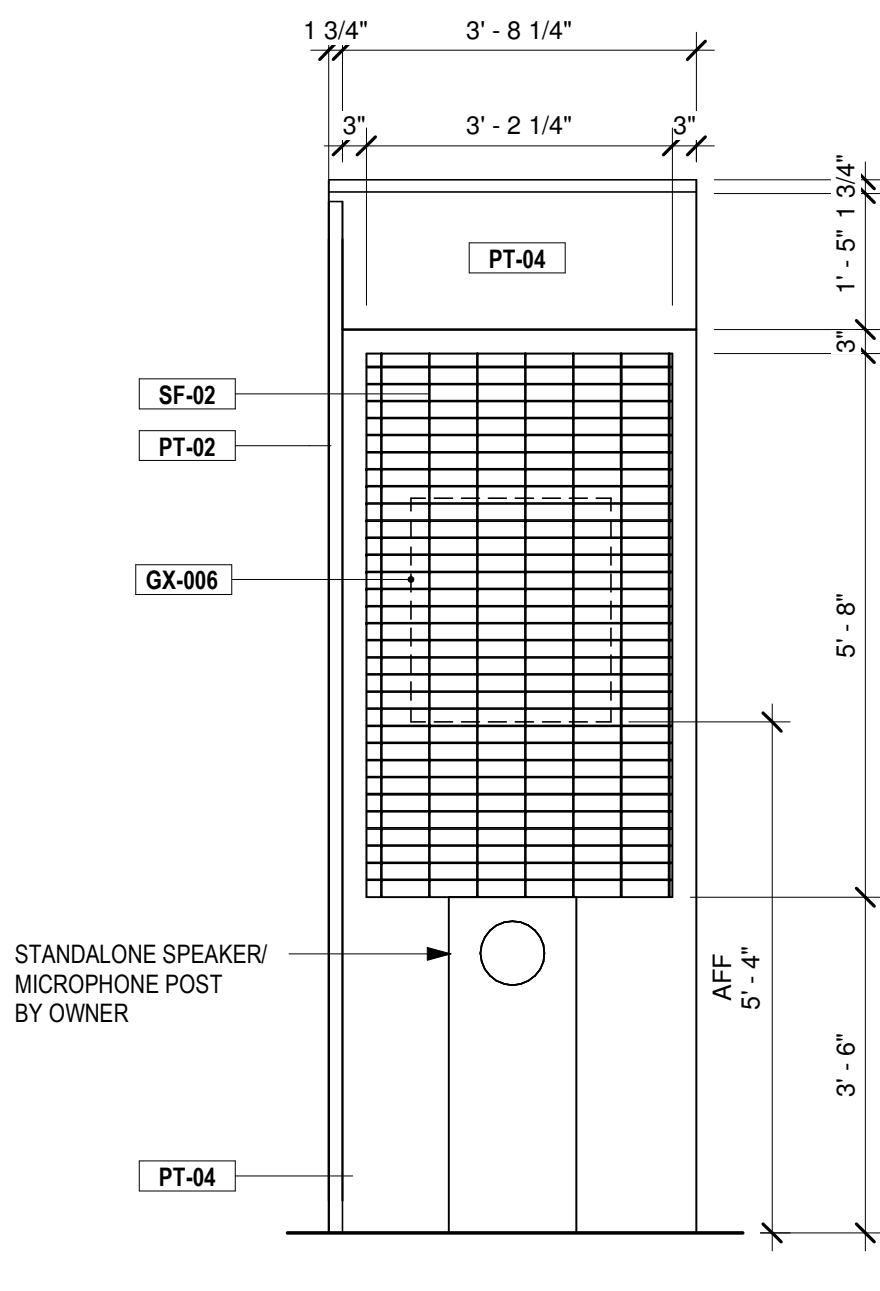

3 | SITE FX 05 - ELEVATION  
ASP-402 | SCALE: 1/2" = 1'-0"

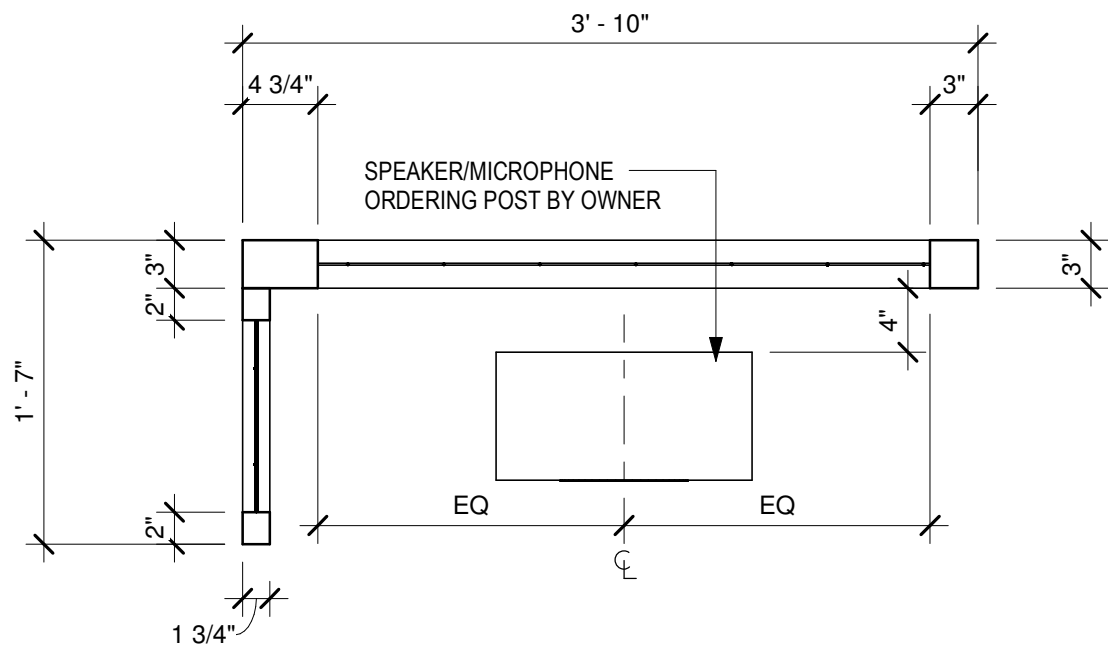

1 | SITE FX 05 - PLAN DETAIL  
ASP-402 | SCALE: 1" = 1'-0"

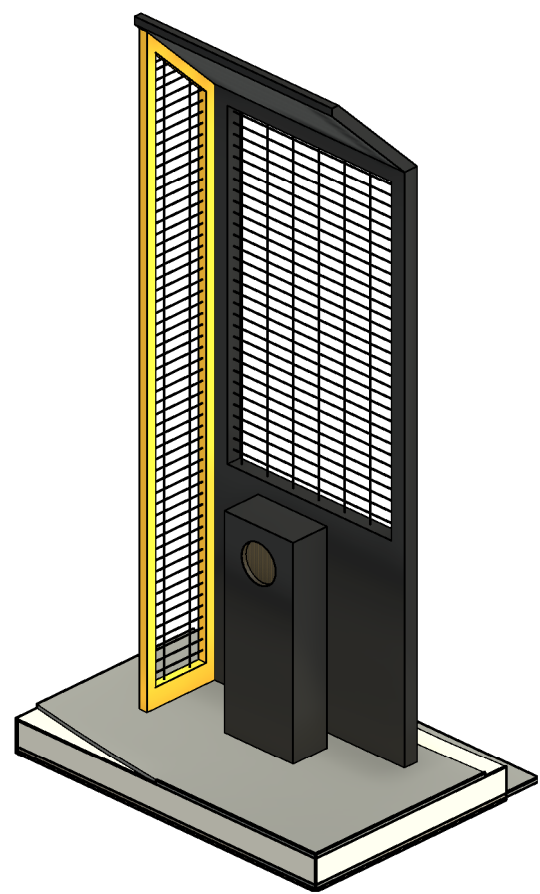

2 | AXON - SITE FX - 05  
ASP-402 | SCALE:



NOT FOR  
CONSTRUCTION



**STIPULATION FOR REUSE**  
THESE DRAWINGS AND SPECIFICATIONS SHALL NOT BE REPRODUCED (IN WHOLE OR IN PART), SHARED WITH THIRD PARTIES OR USED IN ANY MANNER ON OTHER PROJECTS OR EXTENSIONS TO THIS PROJECT WITHOUT PRIOR WRITTEN CONSENT OF CHUTE GERDEMAN AND / OR OWNER.

**DESIGN INTENT SET ONLY. NOT  
INTENDED FOR PERMITTING.**

PROJECT NAME:  
LEE'S FAMOUS RECIPE CHICKEN  
EVOLUTIONARY PROTOTYPE DESIGN

PROJECT ADDRESS:  
ADDRESS TBD  
CITY, STATE ZIPCODE

ISSUE DATE: 8.31.2023  
DESIGN CONTACT: NATE MOSURE

CURRENT SET			
#	Date	By	Description
1	8.31.23		DESIGN INTENT SET

SHEET TITLE:  
**ARCHITECTURAL SITE  
DETAILS**

SHEET NUMBER:  
**ASP-402**

SCALE: AS INDICATED WHEN PRINTED AT 24"X36"

DESIGN INTENT SET





3 CONCEPTUAL RENDERING  
Scale: None

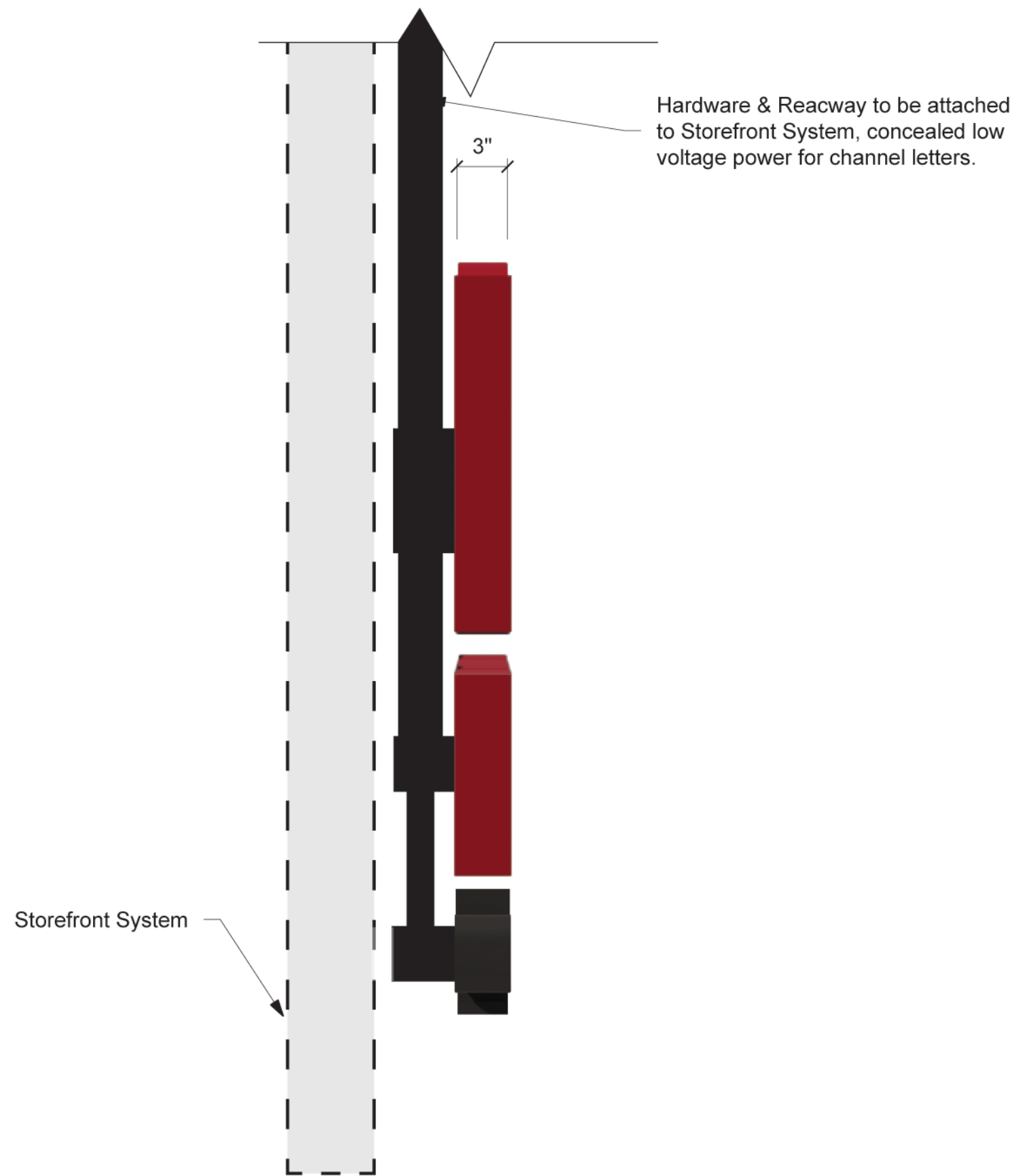

2 SIDE VIEW  
Scale: 1 1/2"= 1'



1 FRONT VIEW  
Scale: 1 1/2"= 1'



NOT FOR  
CONSTRUCTION

**ASG**  
**chute**  
**GERDEMAN**  
An ASG Company  
501 W Schrock Road  
Westerville, OH 43081 USA  
+1 614-212-5180

**STIPULATION FOR REUSE**  
THESE DRAWINGS AND SPECIFICATIONS SHALL NOT BE REPRODUCED (IN WHOLE OR IN PART), SHARED WITH THIRD PARTIES OR USED IN ANY MANNER ON OTHER PROJECTS OR EXTENSIONS TO THIS PROJECT WITHOUT PRIOR WRITTEN CONSENT OF CHUTE GERDEMAN AND / OR OWNER.

**DESIGN INTENT SET ONLY. NOT INTENDED FOR PERMITTING.**

**PROJECT NAME:**  
LEE'S FAMOUS RECIPE CHICKEN  
EVOLUTIONARY PROTOTYPE DESIGN

**PROJECT ADDRESS:**  
ADDRESS TBD  
CITY, STATE ZIPCODE

ISSUE DATE: 7.29.2023  
DESIGN CONTACT: NATE MOSURE

CURRENT SET				
#	Date	By	Description	

SHEET TITLE:  
**GRAPHIC DETAILS**

SHEET NUMBER:  
**I-702**

SCALE: AS INDICATED WHEN PRINTED AT 24"X36"

<div>DURABILITY / REQUIREMENTS / EXPECTATIONS</div> <div><div><input type="checkbox"/> Temporary/short</div><div><input type="checkbox"/> Monthly/seasonal</div><div><input type="checkbox"/> Semi-permanent 1+ yr</div><div><input checked="" type="checkbox"/> Permanent 5+ yrs</div><div><input type="checkbox"/> Graffiti-resistant</div><div><input checked="" type="checkbox"/> 24/7 operation req'd</div><div><input type="checkbox"/> Food prep area</div></div> <div><div><input type="checkbox"/> Exposed to frequent cleaning</div><div><input checked="" type="checkbox"/> Exterior weather exposure</div><div><input type="checkbox"/> Within reach of customers</div></div>	TYPEFACE / FONTS	PHOTO / I.P. / ILLUSTRATION ASSETS  Logo Type Asset	<div>COLOR / FINISH TARGETS</div> <div><div><input checked="" type="checkbox"/> Pantone 187 C - Satin Returns</div><div><input type="checkbox"/> White</div><div><input checked="" type="checkbox"/> Black - Satin</div></div>	<div>PRODUCTION NOTES / SIZE / TRIM</div> <div>OVERALL THICKNESS / DEPTH: 3"</div> <div>OVERALL SIZE: 6'w x 3'-11'h</div>	<div>QTY UNIQUE</div> <div>1</div>	<div>QTY OF EACH</div> <div>1</div>	<div>QTY TOTAL</div> <div>1</div>	THIS GRAPHIC MUST COORDINATE WITH	<div>GRAPHIC CODE #</div> <div>GX-001</div>
				<div>CHANGEABILITY:</div> <div><div><input type="checkbox"/> Store employee</div><div><input type="checkbox"/> Not changeable</div><div><input type="checkbox"/></div></div> <div><div><input checked="" type="checkbox"/> Graphic/Signage Professional</div><div><input type="checkbox"/> Store visual merchandising team</div><div><input type="checkbox"/> Client to change as-needed</div></div>	<div># OF SIDES</div> <div><div><input checked="" type="checkbox"/> One-Sided</div><div><input type="checkbox"/> Double-Sided (exact same content front and back)</div><div><input type="checkbox"/> Two-Sided (different content front and back)</div><div><input type="checkbox"/> Sculptural / multi-sided</div></div>	<div>ENVIRONMENTAL COORDINATION</div> <div>POWER: <input checked="" type="checkbox"/> Yes <input type="checkbox"/> No</div> <div>DATA: <input type="checkbox"/> Yes <input checked="" type="checkbox"/> No</div>	<div>ITEM NAME</div> <div>Exterior - Storefront Logotype</div>		
				<div>FINAL ART PROVIDED BY</div> <div>Client</div>				<div>SCALE</div> <div>See above drawings</div>	



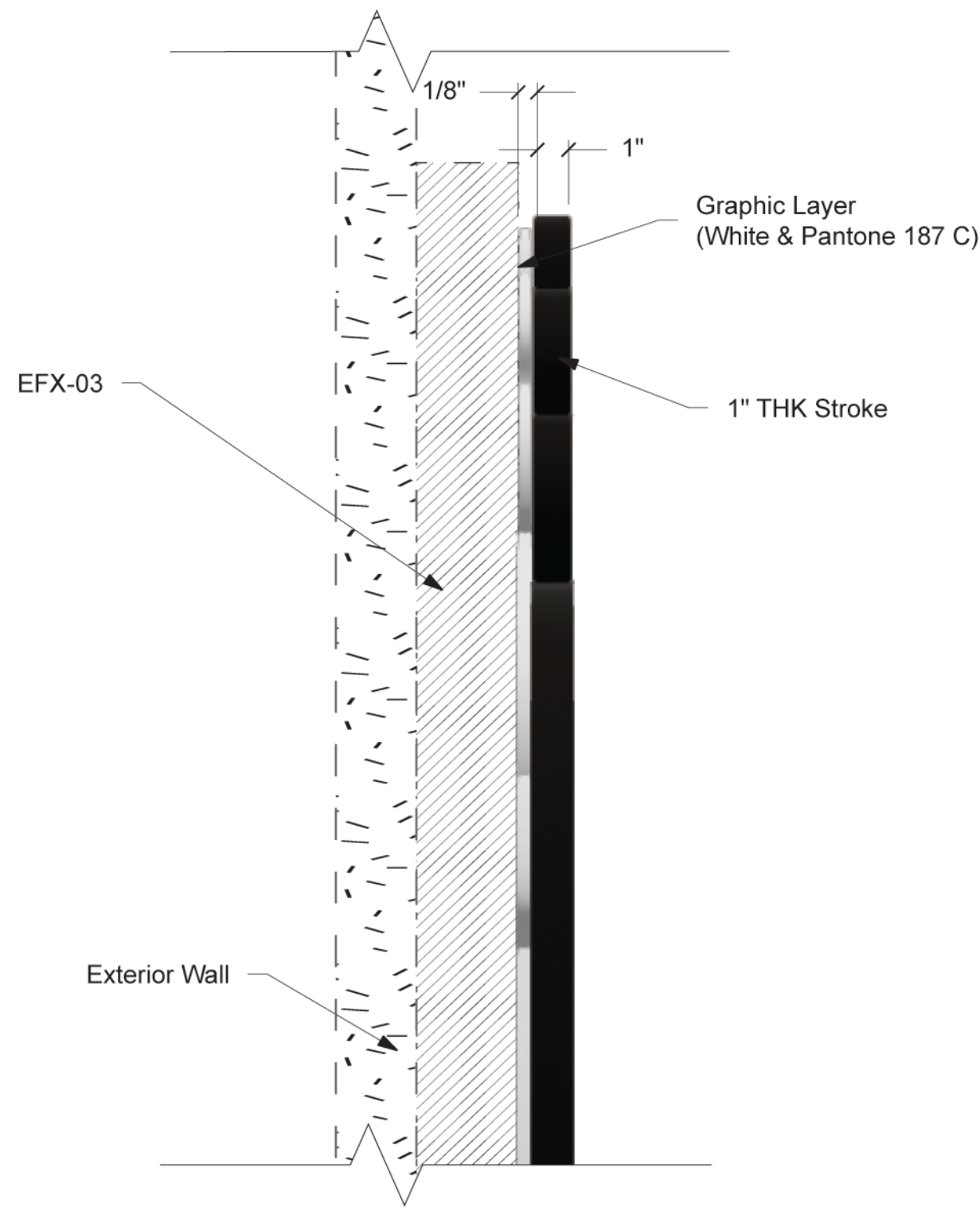

3 SIDE VIEW  
Scale: NA



4 CONCEPTUAL RENDERING  
Scale: NA

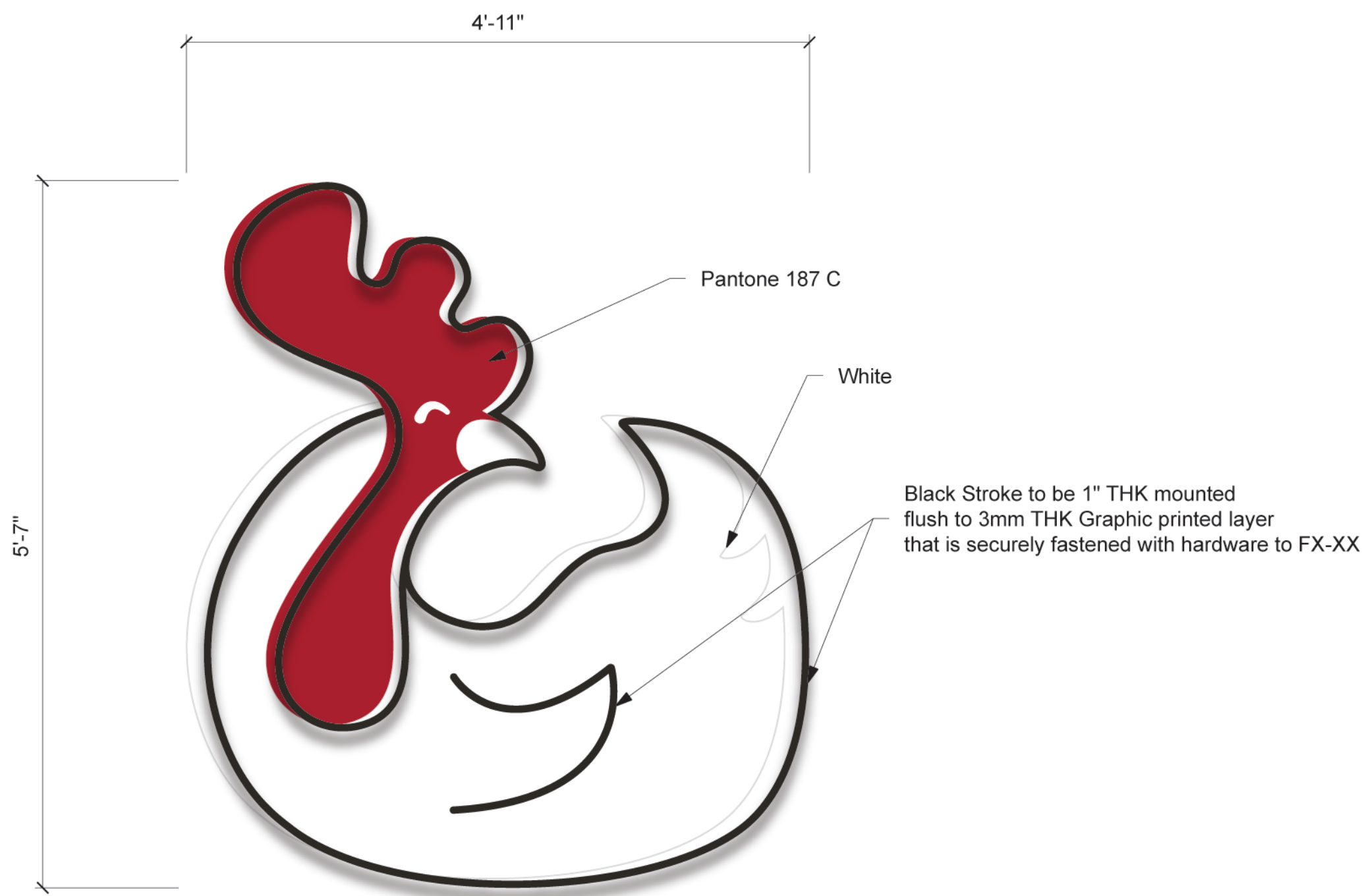

2 FRONT VIEW  
Scale: 2 1/2"= 1'

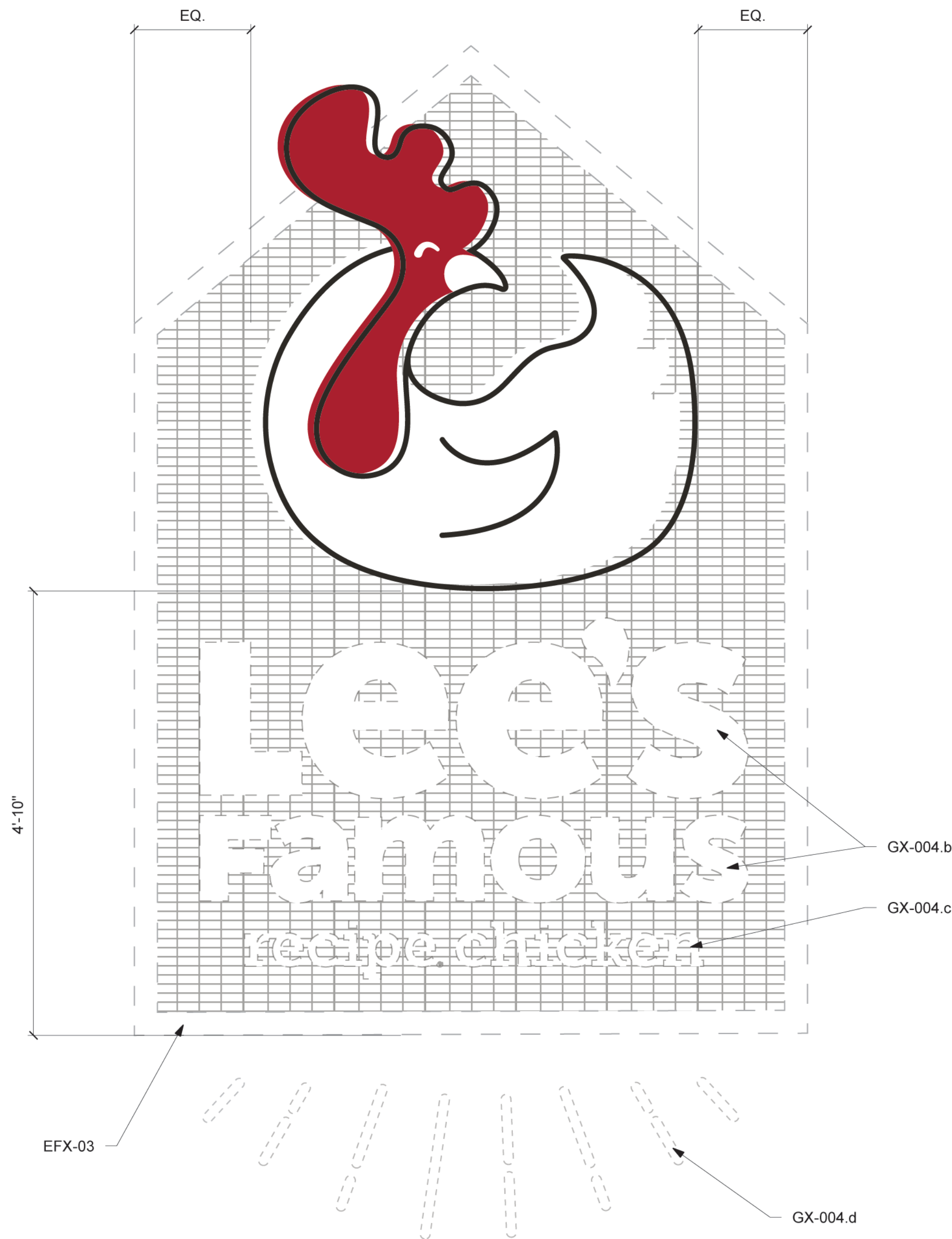

1 FRONT VIEW COMPONENT PLACEMENT  
Scale: 2 1/2"= 1'



NOT FOR  
CONSTRUCTION



**STIPULATION FOR REUSE**  
THESE DRAWINGS AND SPECIFICATIONS SHALL NOT BE REPRODUCED (IN WHOLE OR IN PART), SHARED WITH THIRD PARTIES OR USED IN ANY MANNER ON OTHER PROJECTS OR EXTENSIONS TO THIS PROJECT WITHOUT PRIOR WRITTEN CONSENT OF CHUTE GERDEMAN AND / OR OWNER.

**DESIGN INTENT SET ONLY. NOT INTENDED FOR PERMITTING.**

**PROJECT NAME:**  
LEE'S FAMOUS RECIPE CHICKEN  
EVOLUTIONARY PROTOTYPE DESIGN

**PROJECT ADDRESS:**  
ADDRESS TBD  
CITY, STATE ZIPCODE

ISSUE DATE: 7.29.2023  
DESIGN CONTACT: NATE MOSURE

CURRENT SET			
#	Date	By	Description

**SHEET TITLE:**  
**GRAPHIC DETAILS**

**SHEET NUMBER:**  
**I-706**

SCALE: AS INDICATED WHEN PRINTED AT 24"X36"

DURABILITY / REQUIREMENTS / EXPECTATIONS <div><input type="checkbox"/> Temporary/short <input type="checkbox"/> Monthly/seasonal <input type="checkbox"/> Semi-permanent 1+ yr <input checked="" type="checkbox"/> Permanent 5+ yrs <input type="checkbox"/> Graffiti-resistant <input checked="" type="checkbox"/> 24/7 operation req'd <input type="checkbox"/> Food prep area</div> <div><input type="checkbox"/> Exposed to frequent cleaning <input checked="" type="checkbox"/> Exterior weather exposure <input type="checkbox"/> Within reach of customers</div>	TYPEFACE / FONTS	PHOTO / I.P. / ILLUSTRATION ASSETS BrandMark-Primary-Vertical-inPeak	COLOR / FINISH TARGETS <div><input checked="" type="checkbox"/> Pantone 187 C - Satin Face <input checked="" type="checkbox"/> Black - Satin Returns</div>	PRODUCTION NOTES / SIZE / TRIM OVERALL THICKNESS / DEPTH: See above OVERALL SIZE: 4'-11"w x 5'-7"h	QTY UNIQUE 1	QTY OF EACH 1	QTY TOTAL 1	THIS GRAPHIC MUST COORDINATE WITH EFX-03, GX004.b , GX-004.c & GX004.d	GRAPHIC CODE # <b>GX-004.a</b>
				CHANGEABILITY: <div><input type="checkbox"/> Store employee <input type="checkbox"/> Not changeable <input type="checkbox"/> Client to change as-needed</div> <div><input checked="" type="checkbox"/> Graphic/Signage Professional <input type="checkbox"/> Store visual merchandising team <input type="checkbox"/> Client to change as-needed</div>	# OF SIDES <div><input type="checkbox"/> One-Sided <input type="checkbox"/> Double-Sided (exact same content front and back) <input type="checkbox"/> Two-Sided (different content front and back) <input checked="" type="checkbox"/> Sculptural / multi-sided</div>	ENVIRONMENTAL COORDINATION POWER: <input type="checkbox"/> Yes <input checked="" type="checkbox"/> No DATA: <input type="checkbox"/> Yes <input checked="" type="checkbox"/> No	ITEM NAME Exterior - Back Peak Brand Mark - Helen		
				FINAL ART PROVIDED BY Client			SCALE See above drawings		



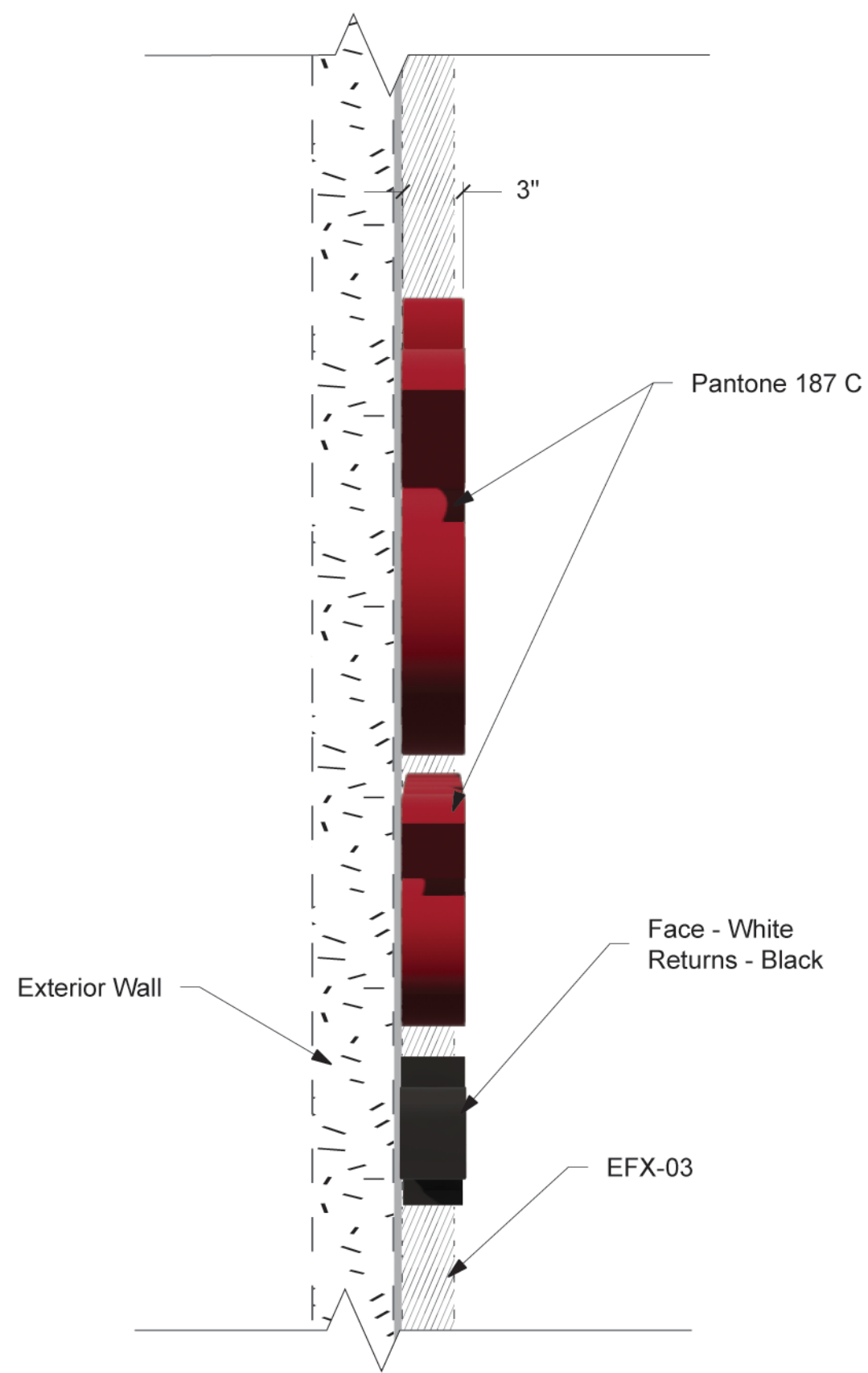

3 SIDE VIEW  
Scale: NA

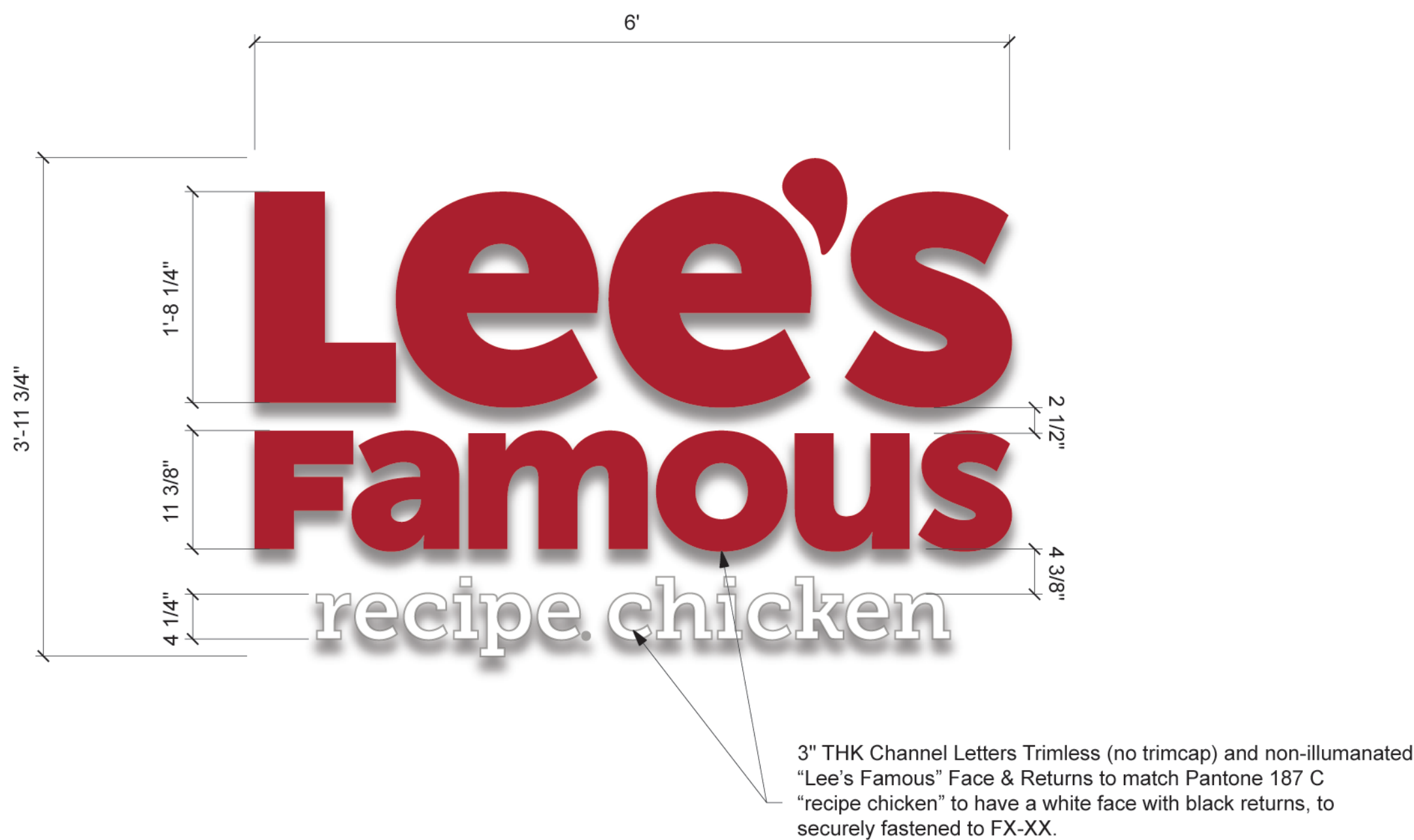

2 FRONT VIEW  
Scale: 2 1/2"= 1'

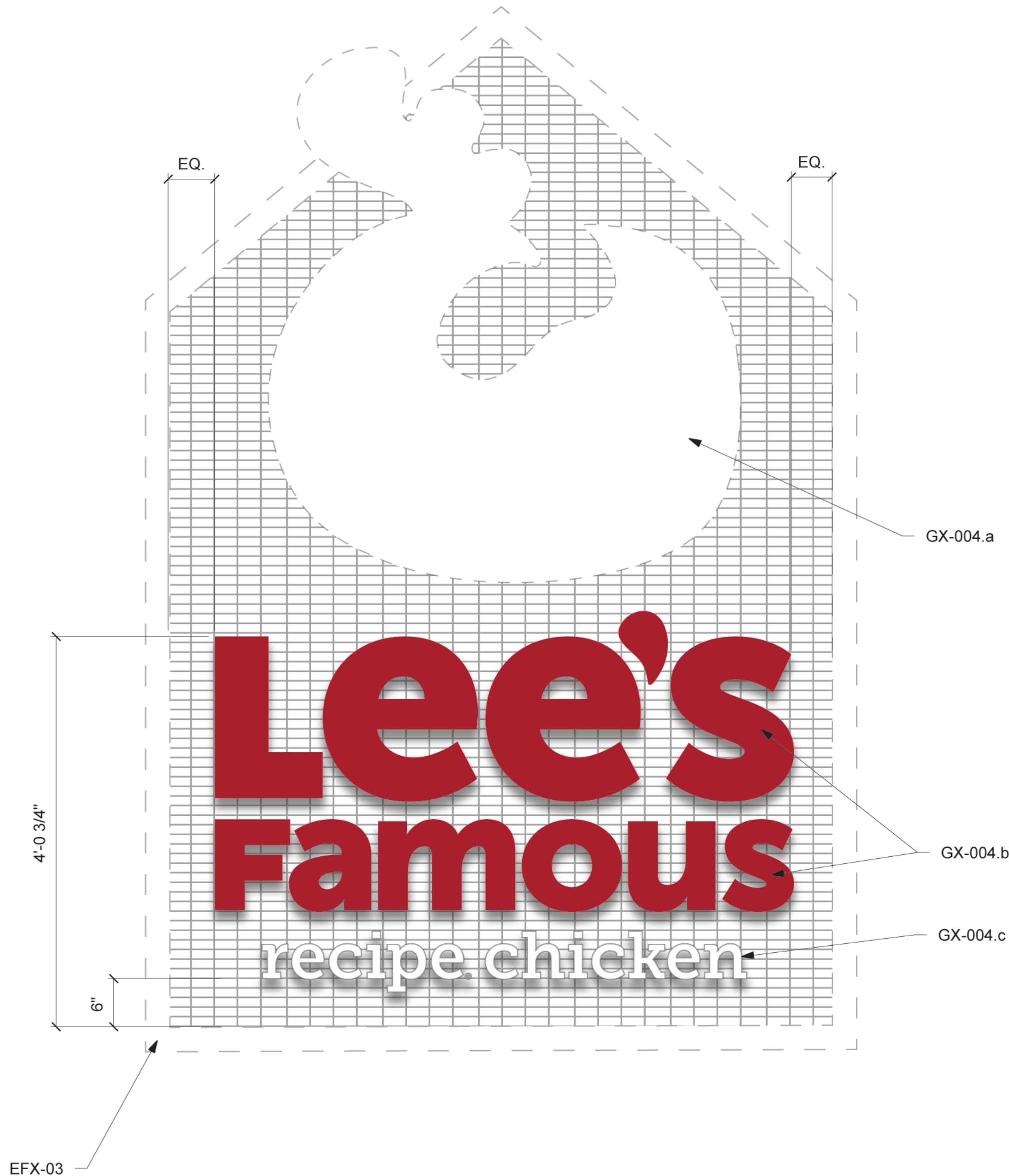

1 FRONT VIEW COMPONENT PLACEMENT  
Scale: 2 1/2"= 1'



NOT FOR  
CONSTRUCTION



**STIPULATION FOR REUSE**  
THESE DRAWINGS AND SPECIFICATIONS SHALL NOT BE REPRODUCED (IN WHOLE OR IN PART), SHARED WITH THIRD PARTIES OR USED IN ANY MANNER ON OTHER PROJECTS OR EXTENSIONS TO THIS PROJECT WITHOUT PRIOR WRITTEN CONSENT OF CHUTE GERDEMAN AND / OR OWNER.

**DESIGN INTENT SET ONLY. NOT INTENDED FOR PERMITTING.**

PROJECT NAME:  
LEE'S FAMOUS RECIPE CHICKEN  
EVOLUTIONARY PROTOTYPE DESIGN

PROJECT ADDRESS:  
ADDRESS TBD  
CITY, STATE ZIPCODE

ISSUE DATE: 7.29.2023  
DESIGN CONTACT: NATE MOSURE

CURRENT SET			
#	Date	By	Description

SHEET TITLE:  
**GRAPHIC DETAILS**

SHEET NUMBER:  
**I-707**

SCALE: AS INDICATED WHEN PRINTED AT 24"X36"

<div>DURABILITY / REQUIREMENTS / EXPECTATIONS</div> <div><div><input type="checkbox"/> Temporary/short</div><div><input type="checkbox"/> Monthly/seasonal</div><div><input type="checkbox"/> Semi-permanent 1+ yr</div><div><input checked="" type="checkbox"/> Permanent 5+ yrs</div><div><input checked="" type="checkbox"/> Graffiti-resistant</div><div><input checked="" type="checkbox"/> 24/7 operation req'd</div><div><input type="checkbox"/> Food prep area</div></div> <div><div><input type="checkbox"/> Exposed to frequent cleaning</div><div><input checked="" type="checkbox"/> Exterior weather exposure</div><div><input type="checkbox"/> Within reach of customers</div></div>	<div>TYPEFACE / FONTS</div> <div>Museo Sans - 900</div> <div>Museo Sans - 700</div>	<div>PHOTO / I.P. / ILLUSTRATION ASSETS</div> <div>BrandMark-Primary-Vertical-InPeak</div>	<div>COLOR / FINISH TARGETS</div> <div><div><input checked="" type="checkbox"/> Pantone 187 C - Satin Face / "Lee's Famous"</div><div><input checked="" type="checkbox"/> Black - Satin Returns / "recipe chicken"</div><div><input type="checkbox"/> White - Satin Face / "recipe chicken"</div></div>	<div>PRODUCTION NOTES / SIZE / TRIM</div> <div>OVERALL THICKNESS / DEPTH: 3"</div> <div>OVERALL SIZE: 6'w x 3'-11'h</div>	<div>QTY UNIQUE</div> <div>2</div>	<div>QTY OF EACH</div> <div>1</div>	<div>QTY TOTAL</div> <div>2</div>	<div>THIS GRAPHIC MUST COORDINATE WITH</div> <div>EFX-03, GX-004.a &amp; GX-004.d</div>	<div>GRAPHIC CODE #</div> <div>GX-004.b &amp; GX-004.c</div>
<div>CHANGEABILITY:</div> <div><div><input type="checkbox"/> Store employee</div><div><input type="checkbox"/> Not changeable</div><div><input type="checkbox"/> Client to change as-needed</div></div> <div><div><input checked="" type="checkbox"/> Graphic/Signage Professional</div><div><input type="checkbox"/> Store visual merchandising team</div><div><input type="checkbox"/> Client to change as-needed</div></div>				<div># OF SIDES</div> <div><div><input checked="" type="checkbox"/> One-Sided</div><div><input type="checkbox"/> Double-Sided (exact same content front and back)</div><div><input type="checkbox"/> Two-Sided (different content front and back)</div><div><input type="checkbox"/> Sculptural / multi-sided</div></div>	<div>ENVIRONMENTAL COORDINATION</div> <div>POWER: <input type="checkbox"/> Yes <input checked="" type="checkbox"/> No</div> <div>DATA: <input type="checkbox"/> Yes <input checked="" type="checkbox"/> No</div>		<div>ITEM NAME</div> <div>Exterior - Back Peak Brand Mark - Lee's Famous - Recipe Chicken</div>		
				<div>FINAL ART PROVIDED BY</div> <div>Client</div>		<div>SCALE</div> <div>See above drawings</div>			





NOT FOR CONSTRUCTION



chuteGERDEMAN

An ASG Company

501 W Schrock Road  
Westerville, OH 43081 USA  
+1 614-212-5180

**STIPULATION FOR REUSE**  
THESE DRAWINGS AND SPECIFICATIONS SHALL NOT BE REPRODUCED (IN WHOLE OR IN PART), SHARED WITH THIRD PARTIES OR USED IN ANY MANNER ON OTHER PROJECTS OR EXTENSIONS TO THIS PROJECT WITHOUT PRIOR WRITTEN CONSENT OF CHUTE GERDEMAN AND / OR OWNER.

**DESIGN INTENT SET ONLY. NOT INTENDED FOR PERMITTING.**

PROJECT NAME:  
LEE'S FAMOUS RECIPE CHICKEN  
EVOLUTIONARY PROTOTYPE DESIGN

PROJECT ADDRESS:  
ADDRESS TBD  
CITY, STATE ZIPCODE

ISSUE DATE: 7.29.2023  
DESIGN CONTACT: NATE MOSURE

CURRENT SET			
#	Date	By	Description

SHEET TITLE:  
**GRAPHIC DETAILS**

SHEET NUMBER:  
**I-711**

SCALE: AS INDICATED WHEN PRINTED AT 24"x36"

ONLY ONE PREVIEW BOARD WILL BE USED AT THIS LOCATION.



2

CONCEPTUAL RENDERING

Scale: None

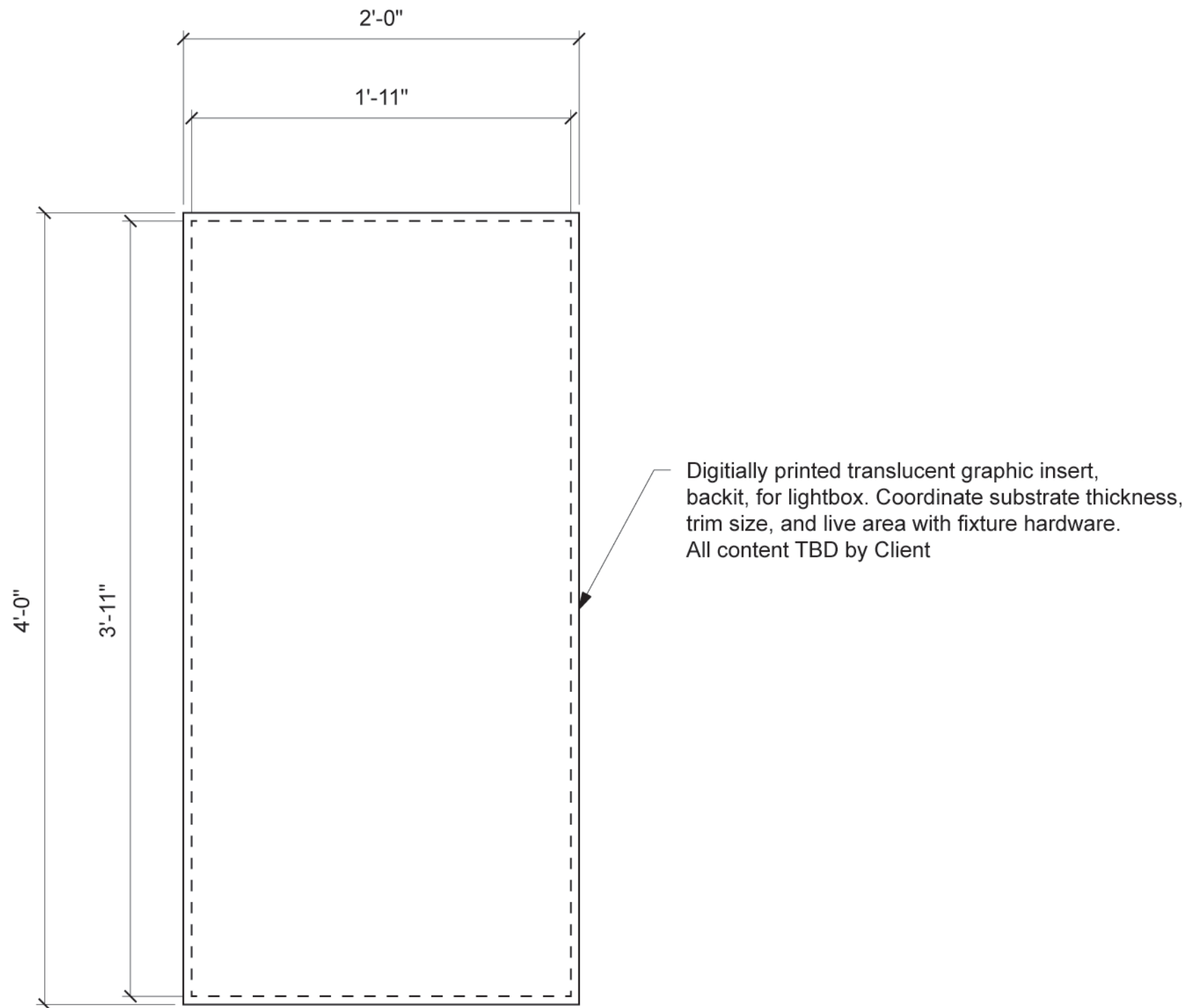

1

FRONT VIEW

Scale: 1-1/2" = 1'-0"

<b>DURABILITY / REQUIREMENTS / EXPECTATIONS</b> <div><div><input type="checkbox"/> Temporary/short</div><div><input checked="" type="checkbox"/> Monthly/seasonal</div><div><input type="checkbox"/> Semi-permanent 1+ yr</div><div><input type="checkbox"/> Permanent 5+ yrs</div><div><input type="checkbox"/> Graffiti-resistant</div><div><input type="checkbox"/> 24/7 operation req'd</div><div><input type="checkbox"/> Food prep area</div></div> <div><div><input type="checkbox"/> Exposed to frequent cleaning</div><div><input checked="" type="checkbox"/> Exterior weather exposure</div><div><input type="checkbox"/> Within reach of customers</div><div><input type="checkbox"/></div><div><input type="checkbox"/></div><div><input type="checkbox"/></div><div><input type="checkbox"/></div></div>
--





NOT FOR  
CONSTRUCTION



**chute**  
**GERDEMAN**  
An ASG Company

**501 W Schrock Road**  
**Westerville, OH 43081 USA**  
**+1 614-212-5180**

**STIPULATION FOR REUSE**  
THESE DRAWINGS AND SPECIFICATIONS SHALL NOT BE REPRODUCED (IN WHOLE OR IN PART), SHARED WITH THIRD PARTIES OR USED IN ANY MANNER ON OTHER PROJECTS OR EXTENSIONS TO THIS PROJECT WITHOUT PRIOR WRITTEN CONSENT OF CHUTE GERDEMAN AND / OR OWNER.

**DESIGN INTENT SET ONLY. NOT INTENDED FOR PERMITTING.**

PROJECT NAME:

LEE'S FAMOUS RECIPE CHICKEN  
EVOLUTIONARY PROTOTYPE DESIGN

PROJECT ADDRESS:

ADDRESS TBD  
CITY, STATE ZIPCODE

ISSUE DATE: 7.29.2023  
DESIGN CONTACT: NATE MOSURE

CURRENT SET				
#	Date	By	Description	

SHEET TITLE:  
**GRAPHIC DETAILS**

SHEET NUMBER:  
**I-713**

SCALE: AS INDICATED WHEN PRINTED AT 24"X36"

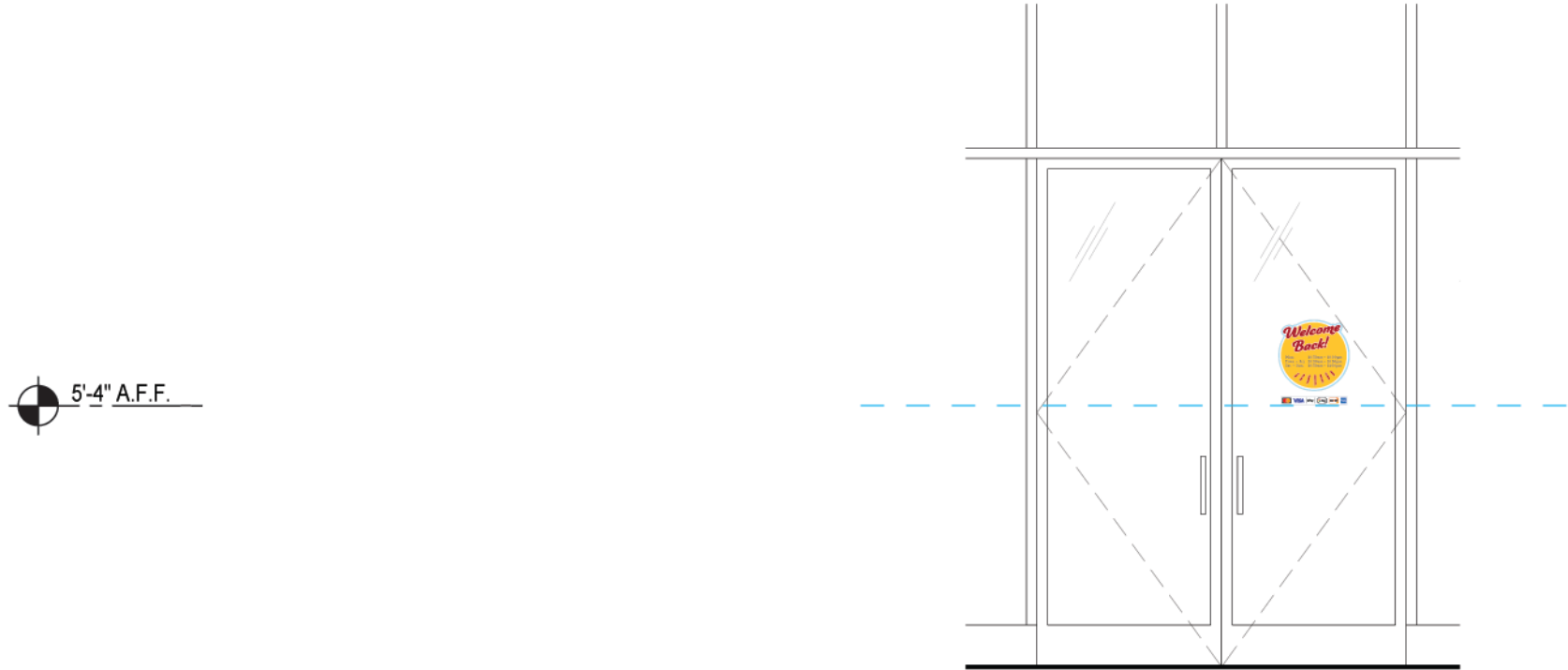

8 ELEVATION VIEWS  
Scale: NA



1 FRONT VIEW GX-009.a FRONT DOOR/DRIVE THRU SIDE DOOR  
Scale: 3" = 1'-0"

<b>DURABILITY / REQUIREMENTS / EXPECTATIONS</b> <div><div><input type="checkbox"/> Temporary/short</div><div><input type="checkbox"/> Monthly/seasonal</div><div><input type="checkbox"/> Semi-permanent 1+ yr</div><div><input checked="" type="checkbox"/> Permanent 5+ yrs</div><div><input type="checkbox"/> Graffiti-resistant</div><div><input checked="" type="checkbox"/> 24/7 operation req'd</div><div><input type="checkbox"/> Food prep area</div></div> <div><div><input checked="" type="checkbox"/> Exposed to frequent cleaning</div><div><input type="checkbox"/> Exterior weather exposure</div><div><input checked="" type="checkbox"/> Within reach of customers</div><div><input type="checkbox"/></div><div><input type="checkbox"/></div><div><input type="checkbox"/></div><div><input type="checkbox"/></div></div>	<b>TYPEFACE / FONTS</b> Ganache - Regular Museo Slab - 700 Museo Sans - 900	<b>PHOTO / I.P. / ILLUSTRATION ASSETS</b>	<b>COLOR / FINISH TARGETS</b> <div><div><input type="checkbox"/> White</div><div><input checked="" type="checkbox"/> Pantone 123 C</div><div><input checked="" type="checkbox"/> Pantone 187 C</div><div><input checked="" type="checkbox"/> Pantone Black C</div><div><input checked="" type="checkbox"/> Clear Vinyl</div></div>
---	--	---	---

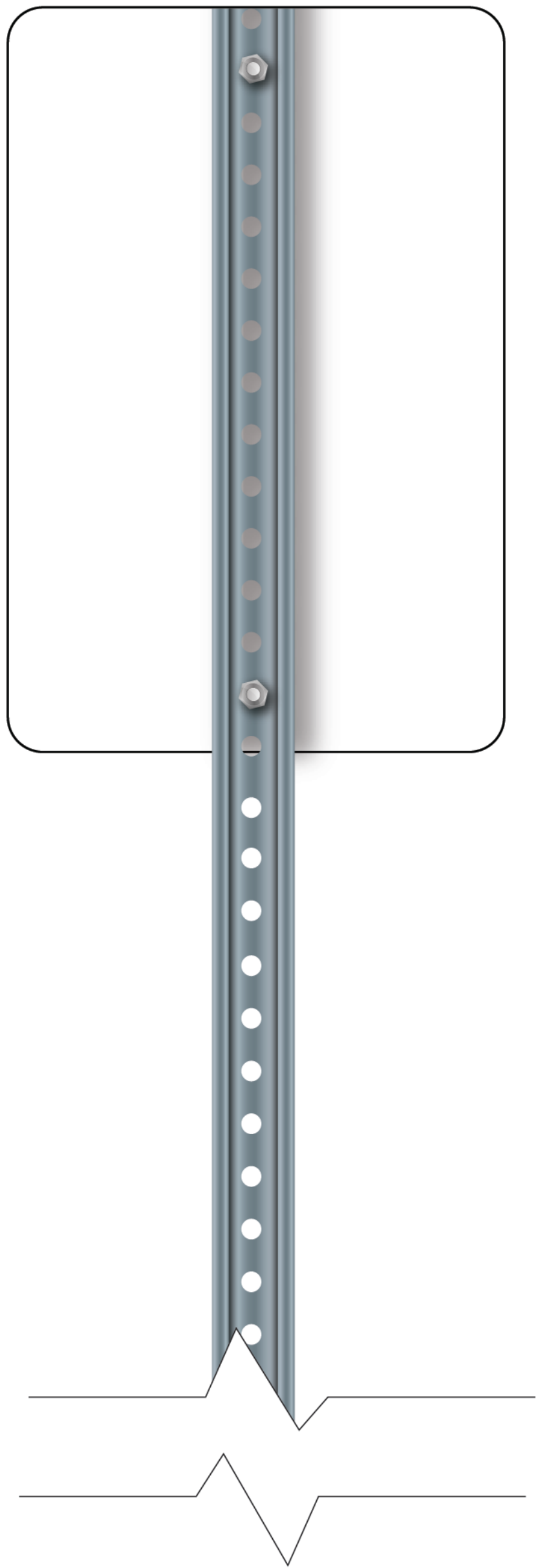

2 BACK VIEW  
Scale: 3" = 1'-0"



1 FRONT VIEW  
Scale: 3" = 1'-0"

<div>DURABILITY / REQUIREMENTS / EXPECTATIONS</div> <div><div><input type="checkbox"/> Temporary/short</div><div><input type="checkbox"/> Monthly/seasonal</div><div><input type="checkbox"/> Semi-permanent 1+ yr</div><div><input checked="" type="checkbox"/> Permanent 5+ yrs</div><div><input checked="" type="checkbox"/> Graffiti-resistant</div><div><input type="checkbox"/> 24/7 operation req'd</div><div><input type="checkbox"/> Food prep area</div></div> <div><div><input type="checkbox"/> Exposed to frequent cleaning</div><div><input checked="" type="checkbox"/> Exterior weather exposure</div><div><input type="checkbox"/> Within reach of customers</div></div>	<div>TYPEFACE / FONTS</div> <div>Museo Sans - 900</div>	<div>PHOTO / I.P. / ILLUSTRATION ASSETS</div>	<div>COLOR / FINISH TARGETS</div> <div><div><input type="checkbox"/> White</div><div><input checked="" type="checkbox"/> Pantone 123 C</div><div><input checked="" type="checkbox"/> Pantone 187 C</div><div><input checked="" type="checkbox"/> Pantone Black C</div></div>	<div>PRODUCTION NOTES / SIZE / TRIM</div> <div>OVERALL THICKNESS / DEPTH: 0.080"</div> <div>OVERALL SIZE: 1'w x 1'-6"h</div>	<div>QTY UNIQUE</div> <div>1</div>	<div>QTY OF EACH</div> <div>TBD by client</div>	<div>QTY TOTAL</div> <div>TBD by client</div>	<div>THIS GRAPHIC MUST COORDINATE WITH</div>	<div>GRAPHIC CODE #</div> <div>GX-024</div>
				<div>CHANGEABILITY:</div> <div><div><input type="checkbox"/> Store employee</div><div><input type="checkbox"/> Not changeable</div><div><input type="checkbox"/></div></div> <div><div><input checked="" type="checkbox"/> Graphic/Signage Professional</div><div><input type="checkbox"/> Store visual merchandising team</div><div><input type="checkbox"/> Client to change as-needed</div></div>	<div># OF SIDES</div> <div><div><input checked="" type="checkbox"/> One-Sided</div><div><input type="checkbox"/> Double-Sided (exact same content front and back)</div><div><input type="checkbox"/> Two-Sided (different content front and back)</div><div><input type="checkbox"/> Sculptural / multi-sided</div></div>	<div>ENVIRONMENTAL COORDINATION</div> <div>POWER: <input type="checkbox"/> Yes <input checked="" type="checkbox"/> No</div> <div>DATA: <input type="checkbox"/> Yes <input checked="" type="checkbox"/> No</div>	<div>ITEM NAME</div> <div>Exterior - Pick Up Parking Sign</div>		
				<div>FINAL ART PROVIDED BY Client</div>		<div>SCALE See above drawings</div>			



NOT FOR  
CONSTRUCTION



501 W Schrock Road  
Westerville, OH 43081 USA  
+1 614-212-5180

STIPULATION FOR REUSE  
THESE DRAWINGS AND SPECIFICATIONS SHALL NOT BE REPRODUCED (IN WHOLE OR IN PART), SHARED WITH THIRD PARTIES OR USED IN ANY MANNER ON OTHER PROJECTS OR EXTENSIONS TO THIS PROJECT WITHOUT PRIOR WRITTEN CONSENT OF CHUTE GERDEMAN AND / OR OWNER.

DESIGN INTENT SET ONLY. NOT  
INTENDED FOR PERMITTING.

PROJECT NAME:  
LEE'S FAMOUS RECIPE CHICKEN  
EVOLUTIONARY PROTOTYPE DESIGN

PROJECT ADDRESS:  
ADDRESS TBD  
CITY, STATE ZIPCODE

ISSUE DATE: 7.29.2023  
DESIGN CONTACT: NATE MOSURE

CURRENT SET			
#	Date	By	Description

SHEET TITLE:  
GRAPHIC DETAILS

SHEET NUMBER:  
I-728

SCALE: AS INDICATED WHEN PRINTED AT 24"X36"