



Overview



Legend

- Parcels
- Roads
- City Labels
- Sec-Twn-Rng

Parcel ID	04-07S-03W-3151-000C-0060	Alternate ID	03W07S043151000C0060	Owner Address	ST JAMES BAY PROPERTY OWNER!!
Sec/Twp/Rng	4-7S-3W	Class	COMMON ARE	Mailing →	160 LAUGHING GULL LANE
Property Address		Acreage	n/a		CARRABELLE, FL 32322
District	1			Physical Address:	
Brief Tax Description	UNIT 1 BLC LOT 6				2832 Hwy 98 East
	(Note: Not to be used on legal documents)				Carrabelle, FL

Date created: 10/23/2019
Last Data Uploaded: 10/23/2019 7:04:54 AM

Developed by Schneider GEOSPATIAL

HWY 98

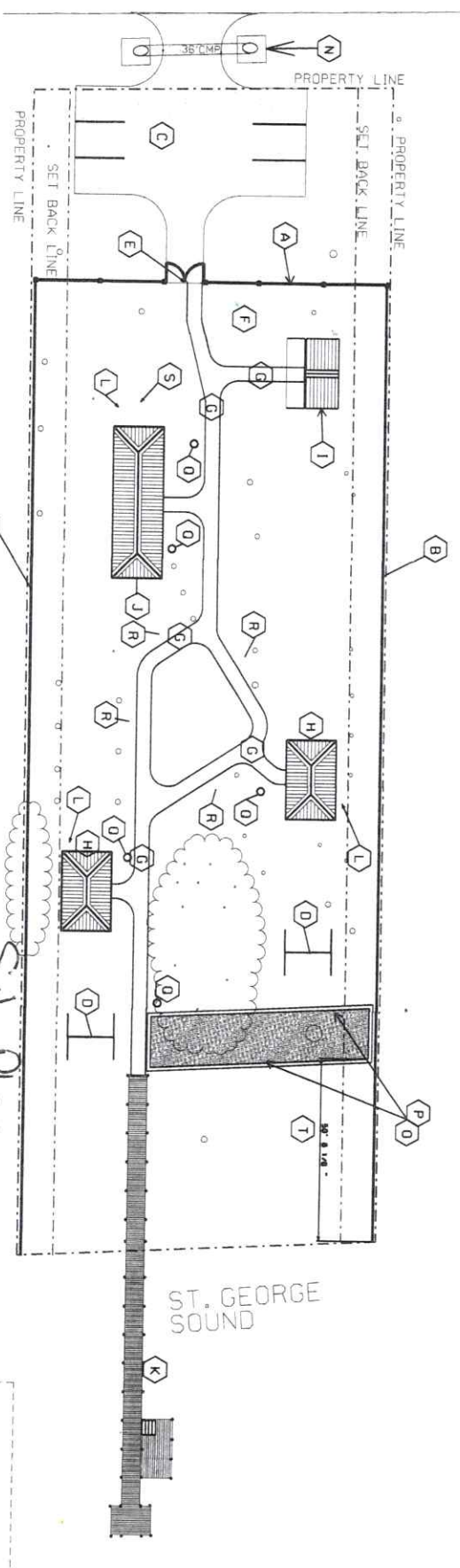

KEYED NOTES

- A LIGHT ON CMU BLOCK FENCE POST (TYPICAL) SEE SHEET A-XXXX
- B 6' HIGH PRIVACY FENCING-PRESSURE TREATED WOOD
- C 6" DEEP GRAVEL PARKING LOT OVER 12" COMPACTED ROAD BASE
- D 3" WIDE SET
- E 9" WIDE PRIVACY FENCE ACCESS GATE WITH LOCK - 5' WIDE LEAF + 3' WIDE LEAF LESS Dual Access Latch
- F NOT USED
- G 4" WIDE X 4" THICK CONCRETE WALKWAY OVER 6" COMPACTED ROAD BASE
- H TYPE A COVERED PICNIC BUILDING REFER TO SHEET A-XXXX
- I ELEVATED ADA PREFABRICATED TOILET (MEN AND WOMEN) BUILDING. REFER TO SHEET A-XXXX
- J NOT USED
- K DOCK - REFER TO SHEET A-XXXX
- L 8'00" PIT - PARK TABLE KP5716 Lip Gate, Park Grill - 300 sq. inch Cooking Surface
- M 100 AMP ELECTRICAL BOX IN BUILDING. REFER TO SHEET E-XXXX
- N RELOCATED PIPE AND NEW CONCRETE FOUNDATIONS
- O SAND PIT REFER TO SHEET A-XXXX
- P SAND PIT REFER TO SHEET A-XXXX
- Q 7 GALLON EXPANDED METAL TRUCK MOUNTED
- R PARK BENCH-50" STEEL FRAME WOOD SEAT
- S FIRE PLACE - F-20ND BRAVO Color-2G Modular Outdoor Fireplace Kit Sand 6" THICK REINFORCED CONCRETE
- T 50' SETBACK FROM MEAN HIGH TIDE LEVEL/ PROPERTY LINE

Side Plan
NEW WORK PLAN
 NOT TO SCALE:



ST. JAMES BAY PROPERTY OWNER ASSOCIATION
 MODIFICATIONS TO 04-07S-03W-3151-000C-0060
 PARKFRANKLIN COUNTY, FL 32323
 NEW PARK

MARVIN HEYMANN ARCHITECT
 1393 ALLIGATOR DRIVE
 ALLIGATOR POINT, FL 32346

DESIGNED BY: WWT	DATE: 1-4-18
DRAWN BY: WWT	
REVIEWED BY: WWT	
PROJECT SCALE: 1/4" = 1'-0"	TITLE: NEW WORK
SHEET NO. 11 X 17	

NO.	DATE	BY



Applicant: Armand Evans
St James P.D

2832 Hwy 98 East
Carrabelle, FL.

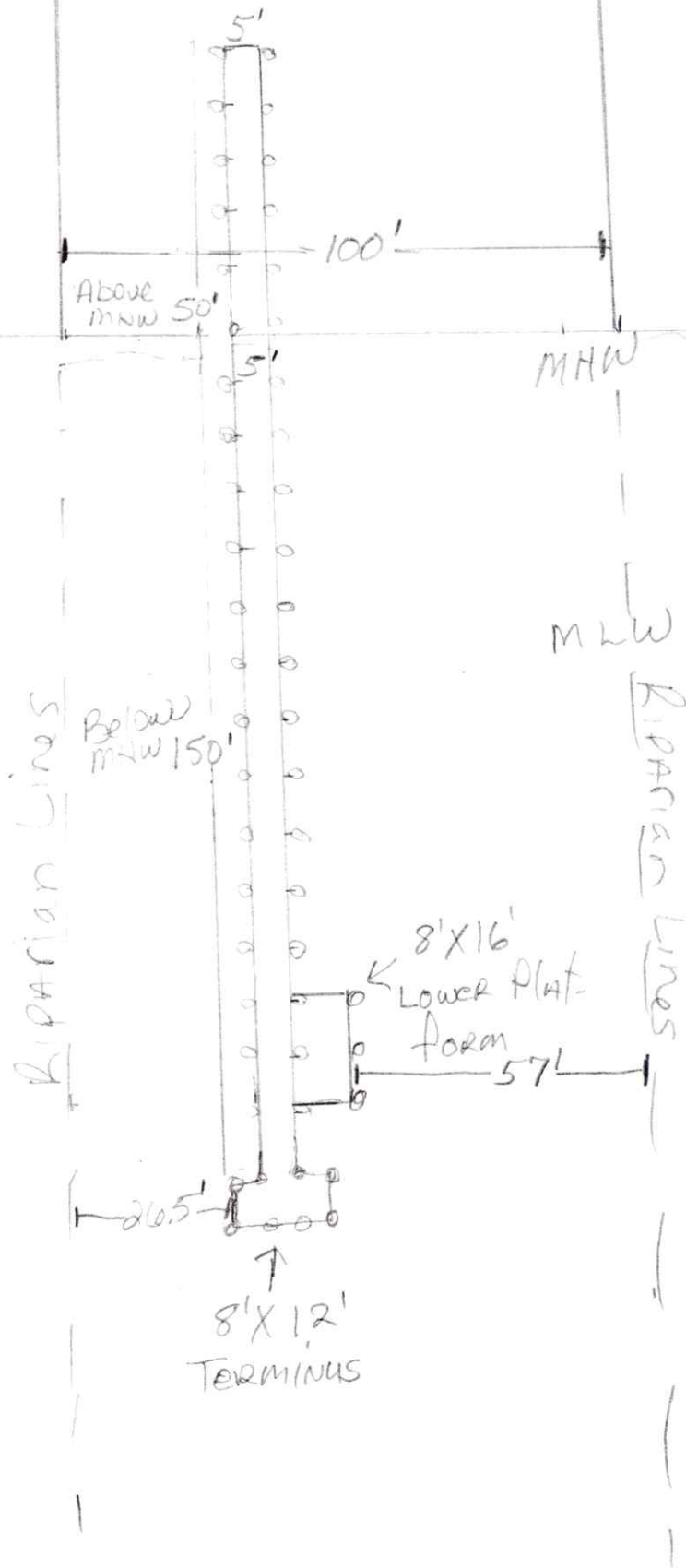

Applicant: Armand Evans
St James P.O.
2832 Hwy 98 East Corrallo, FL.

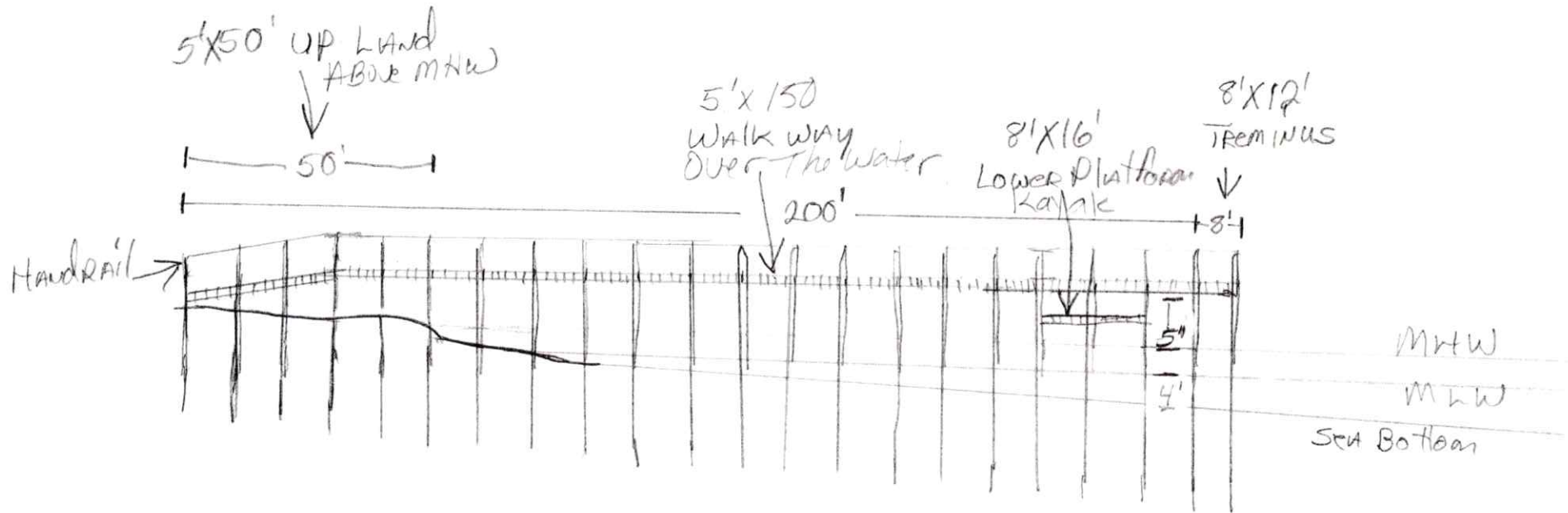

Scale $\frac{3}{8}'' = 10'$

Pole span every 10' Apart

Deck 5' Above MHW