



ADVISORY BOARD OF ADJUSTMENT APPLICATION

FRANKLIN COUNTY BUILDING DEPARTMENT

34 Forbes Street, Suite 1, Apalachicola, Florida 32320

Phone: 850-653-9783 Fax: 850-653-9799

http://www.franklincountyflorida.com/planning_building.aspx

ADVISORY BOARD OF ADJUSTMENT APPLICATION

PROPERTY OWNER'S NAME: Richard C. + Cindy A. Palm
MAILING ADDRESS: 128 Sweet Bay Trace City/State/Zip: Dothan, AL 36303
PHONE #: 334-685-3229 CELL #: _____ EMAIL: _____

AGENT'S NAME: DAN GARLICK - Garlick Environmental Assoc. Inc
MAILING ADDRESS: Post Office Box 385 City/State/Zip: Apalachicola, FL 32329
PHONE #: 653-8899 CELL #: 850-899-5252 EMAIL: dane@garlickenv.com

PROPERTY DESCRIPTION: 911 Address: 2700 Bluff Road (11 Bigoaks Dr.)
Lot/s: _____ Block: _____ Subdivision: _____ Unit: _____
Parcel Identification #: 21-08S-BW-0000-0040-0060

JURISDICTION: Franklin County
 Apalachicola Eastpoint St. George Island Carrabelle Dog Island Lanark/ St. James St. Teresa Alligator Point

LEGAL DESCRIPTION OF THE PROPERTY: (MUST ATTACH LEGAL DESCRIPTION)

DESCRIPTION OF REQUEST: Placement of RipRAP along an existing dilapidated
Seawall - The RipRAP will NOT be any steeper than a ratio
of two horizontal to one vertical (2:1) and will extend approximately
8 FT horizontally from the Seawall.
8'x100' along the Apalachicola River and 8'x93' along the private canal.

ADVISORY BOARD OF ADJUSTMENT DATE: _____

RECOMMENDED APPROVAL: _____ RECOMMENDED DENIAL: _____ RECOMMENDED TO TABLE: _____
CONDITIONS: _____

BOARD OF COUNTY COMMISSION MEETING DATE: _____
APPROVED: _____ DENIED: _____ TABLED: _____
CONDITIONS: _____

Instructions: Complete application, including proof of ownership in the form of deed, detailed description of request including any necessary information supporting request (site plan/survey) and application fee of \$250.00. Return to the following address:

Franklin County
34 Forbes Street, Suite 1
Apalachicola, FL 32320

THIS VARIANCE REQUEST WILL EXPIRE ONE YEAR FROM DATE OF APPROVAL BY THE FRANKLIN COUNTY BOARD OF COUNTY COMMISSIONER.

PREPARED BY: GARLICK ENVIRONMENTAL ASSOCIATES, INC.



APPLICANT/CLIENT: Clay Palm
WATERBODY/CLASS: Apalachicola River
PURPOSE: Environmental Permitting
PROJECT LOCATION / USGS: Apalachicola / Franklin County
LATITUDE: 29° 45' 58"
LONGITUDE: 85° 2' 26.24"
SECTION: 21 TWSHP: 8 South RNG: 8 West

JOB: 20-065
DEP:
COE:
OTHER:
DATE: October 9, 2020
SHEET: 1/5



PREPARED BY: GARLICK ENVIRONMENTAL ASSOCIATES, INC.



APPLICANT/CLIENT: Clay Palm
WATERBODY/CLASS: Apalachicola River
PURPOSE: Environmental Permitting
PROJECT LOCATION / USGS: Apalachicola / Franklin County
LATITUDE: 29° 45' 58"
LONGITUDE: 85° 2' 26.24"
SECTION: 21 TOWNSHIP: 8 South RING: 8 West

JOB: 20-065
DEP:
COE:
OTHER:
DATE: October 9, 2020
SHEET: 2/5



PREPARED BY: GARLICK ENVIRONMENTAL ASSOCIATES, INC.



APPLICANT/CLIENT: Clay Palm
WATERBODY/CLASS: Apalachicola River
PURPOSE: Environmental Permitting
PROJECT LOCATION / USGS: Apalachicola / Franklin County
LATITUDE: 29° 45' 58"
LONGITUDE: 85° 2' 26.24"
SECTION: 21 TOWNSHIP: 8 South RING: 8 West

JOB: 20-065
DEP:
COE:
OTHER:
DATE: October 9, 2020
SHEET: 4/5

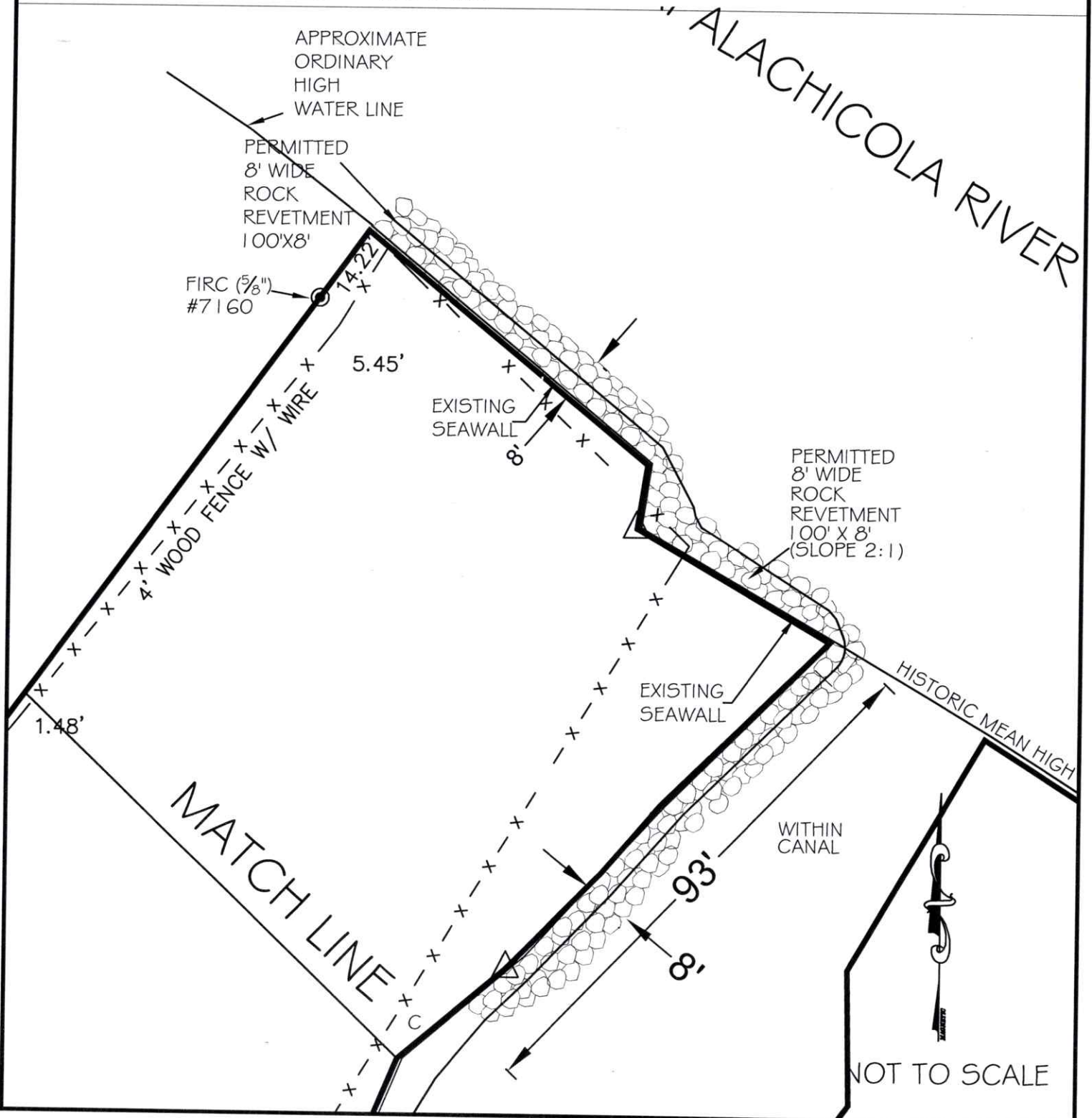

PREPARED BY: GARLICK ENVIRONMENTAL ASSOCIATES, INC.

P. O. BOX 385, APALACHICOLA FLORIDA 32329-0385

(850) 653-8899

FAX (850) 653-9656

garlick@garlickenv.com

LB No. 7415

APPLICANT/CLIENT: CLAY PALM

JOB: 20-065

WATERBODY/CLASS: Apalachicola River

DEP:

PURPOSE: Environmental Permitting

COE:

PROJECT LOCATION / USGS: Apalachicola / Franklin County

OTHER:

LATITUDE: 25° 45' 58"

DATE: October 9, 2020

LONGITUDE: 85° 2' 26.24"

SHEET: 5/5

SECTION: 21 TWSHP: 8 South

RNG: 8 West

