

### Third Easement

A parcel of land, being part of Lot 1, Poudre River Whitewater Park as recorded July 23, 2018 as Reception No. 20180044854 of the Records of the Larimer County Clerk and Recorder, situate in the Northwest Quarter (NW1/4) of Section Twelve (12), Township Seven North (T. 7N.), Range Sixty-nine West (R.69W.) of the Sixth Principal Meridian (6th P.M.), City of Fort Collins, County of Larimer, State of Colorado and being more particularly described as follows:

COMMENCING at the Southwest corner of said Lot 1 and assuming the most Southerly West line of Lot 1 as bearing North 00°16'45" East, as platted, a distance of 418.26 feet and with all other bearings contained herein relative thereto;

THENCE North 00°16'45" East, along said West line a distance of 327.01 feet to the POINT OF BEGINNING;

THENCE North 00°16'45" East, continuing along said West line, a distance of 15.21 feet;

THENCE North 80°49'09" East a distance of 104.71 feet;

THENCE South 09°10'51" East a distance of 15.00 feet;

THENCE South 80°49'09" West a distance of 107.21 feet to the POINT OF BEGINNING.

Said described parcel of land contains 1,589 Square Feet, more or less (±).

### SURVEYORS STATEMENT

I, Steven Parks, a Colorado Licensed Professional Land Surveyor do hereby state that this Parcel Description was prepared under my personal supervision and checking, and that it is true and correct to the best of my knowledge and belief.

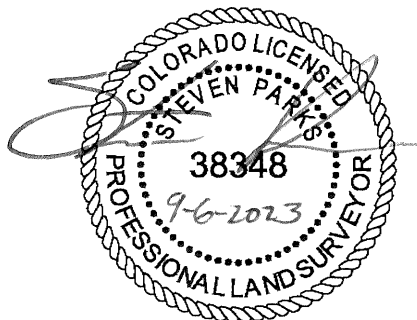

---

Steven Parks - on behalf of Majestic Surveying, LLC  
Colorado Licensed Professional Land Surveyor #38348



