



PROPOSAL

TO THE:

City of Forest Park (Sourcewell ID#77837)
4539 Jonesboro Rd
Forest Park, GA 30297

DATE: May 23, 2024

We hereby propose and agree to furnish the following firefighting equipment upon your acceptance of this Proposal via the Sourcewell Co-Operative Contract:

One (1) Sutphen Heavy Duty Heavy Rescue Complete and Delivered for the Total

Sum of \$ 1,098,071.00

The apparatus and equipment being purchased hereunder shall be completed within approximately 30 months after the Sutphen's receipt and approval of Purchaser's acceptance of this Proposal.

This Proposal shall be valid for thirty (30) days. If a Purchase Agreement or Purchase Order is not received by Sutphen within 30 days of the date of this Proposal, Sutphen reserves the right to extend, withdraw, or modify this Proposal, including pricing, delivery times, and prepayment discounts, as applicable.

Respectfully submitted,

Jerry Harley
Authorized Representative for Sutphen Corporation
336-613-8202

TERMS & CONDITIONS

Changes to National Fire Protection Association ("NFPA") 1900, Environmental Protection Agency ("EPA") or changes legislated by Federal, State or Local Governments or changes in parts availability or vendor relationships that impact the cost to manufacture the truck may incur additional charges which shall be borne by the Purchaser. These may include but are not limited to changes that affect the major vendors of the fire apparatus industry such as pump manufacturers, seat manufacturers, electrical power supplies (generators) and powertrain (engine & transmission). Any such changes shall be documented on a change order executed by both Sutphen and Purchaser.

Sutphen shall provide written notice to the Purchaser as soon as it reasonably believes any cost increase provision may be invoked. Sutphen shall provide, upon written request, documentation of such changes and increases.

Sutphen will use its reasonable best efforts to deliver the apparatus within the timeframe quoted herein, provided that such delivery date shall be automatically extended for delays beyond Sutphen's control, including, without limitation, strikes, labor disputes, riots, civil unrest, pandemics, war or other military actions, sabotage, government regulations or controls, fire or other casualty, or inability to obtain materials or services. If such delay occurs, Sutphen shall give notice of delay to Purchaser. Purchaser shall not be entitled to any discount or reduction in price for such delay and Sutphen shall not be liable for any damages (compensatory, incidental, consequential or otherwise) related to such delay.

Final payment shall be made at the time of final inspection at the factory. Should payment be delayed, Sutphen reserves the right to charge interest at the rate of one and one-half percent (1.5%) per month, beginning on the day after payment is due.

Delivery, payment, and transfer of the Manufacturer's Certificate of Origin (MCO) shall take place at Sutphen during final inspection, and upon payment in full in accordance with these terms. Sutphen reserves the right to withhold delivery of the MCO until payment in full is received. If Purchaser requires any third-party equipment mounting, the apparatus shall be moved to the third-party facility by the dealer or Purchaser for such mounting. Such third-party work shall not delay or offset payment to Sutphen. The apparatus shall be tested per NFPA #1900 at Sutphen's manufacturing facility. Purchaser agrees that the apparatus and equipment being purchased hereunder shall not be driven or used in any manner until it is paid for in full. In the event there are any shortages or omissions with the apparatus at time of completion, Purchaser may withhold a sum equivalent to the price of any such shortages as determined by Sutphen.

In the case of any default in payment hereunder or in the payment on any notes, negotiable paper, obligations or other instruments issued by Purchaser, Sutphen may take full possession of the apparatus and equipment or of the piece or pieces upon which default has been made, and any payments that have been made theretofore shall be applied as rent in full for the use of the apparatus and equipment up to the date of taking possession by Sutphen.

Sutphen warrants to Purchaser that all goods and services furnished hereunder will conform in all respects to the terms of this order, including any applicable change orders, drawings, specifications, or standards incorporated herein, and/or shall be free of defects in materials, workmanship, and free from such defects in design. In addition, Sutphen warrants that the goods and services are suitable for and will perform in accordance with the purposes for which they were intended, for a period of one year from the Warranty Registration Date, unless an extended warranty is purchased.

The purchase price provided for herein does not include any federal, state or local sales tax, duties, imposts, revenues, excise or other taxes which may hereafter be imposed by governmental authority or otherwise and which are made applicable to the apparatus or equipment covered by this Proposal. In the event that any such taxes are subsequently imposed and become applicable, the purchase price herein shall be increased by the amount of such taxes and such sum shall be immediately paid by Purchaser to Sutphen. To the extent applicable, the prices and deliveries set forth herein are subject to the Defense Production Act.

Sutphen shall provide insurance insuring the apparatus and equipment against loss by fire, theft, or collision and insuring against property damage and personal injury through the completion of the apparatus and transfer of the Manufacturer's Certificate of Origin.

After the execution of this Agreement, Purchaser shall have no right to terminate the Agreement. Sutphen may, in its absolute and sole discretion, accept Purchaser's request to terminate the Agreement. In the event Sutphen accepts Purchaser's request to terminate the Agreement, Sutphen may charge a cancellation fee. The following charge schedule based on costs incurred may be applied, at Sutphen's sole discretion: (a) 10% after order is accepted by Sutphen; (b) 30% of the Purchase Price after production has commenced. The cancellation fee may increase accordingly as costs are incurred as the order progresses through engineering and into manufacturing.

These Terms and Conditions ("T&C") contained in the Proposal provided herein take precedence over all previous negotiations, oral or written, and no representations or warranties are applicable except as specifically contained in these or in any subsequently signed agreement between the Parties. No waiver of any of the provisions of these T&C shall be deemed a waiver of any other provision, whether similar, nor shall any waiver constitute a continuing waiver. If a Purchase Order is issued, this Proposal, including the Terms and Conditions contained herein, shall supersede the terms in the Purchase Order where terms may be inconsistent.

This Proposal shall be governed and controlled as to interpretation, enforcement, validity, construction, effect and in all other respects by the laws, statutes, and decisions of the State of Ohio. Exclusive jurisdiction and venue for any litigation at all related to this in the Franklin County Court of Common Pleas, Columbus, Ohio, and the parties hereto consent and submit to the general jurisdiction of this court. All of these T&C shall be binding upon and inure to the benefit of and be enforceable by Sutphen, Purchaser, their successors and assigns.

LEASE FINANCING PROPOSAL

Requested by
Williams Fire Apparatus
 Jerry Harley

Representing



Presented To (As Lessee)
City of Forest Park, GA

Proposal Date:	May 24, 2024					
Equipment Description:	(1) Sutphen Heavy Rescue					
Commencement Date:	July 15, 2024					
	<u>Option 1</u>	<u>Option 2</u>	<u>Option 3</u>	<u>Option 4</u>	<u>Option 5</u>	<u>Option 6</u>
Equipment Cost:	\$1,098,071.00	\$1,098,071.00	\$1,098,071.00	\$1,098,071.00	\$1,098,071.00	\$1,098,071.00
Escrow Discount:	\$102,974.00	\$102,974.00	\$102,974.00	\$102,974.00	\$102,974.00	\$102,974.00
Amount Financed:	\$995,097.00	\$995,097.00	\$995,097.00	\$995,097.00	\$995,097.00	\$995,097.00
Lease Term:	3 Years	5 Years	7 Years	3 Years	5 Years	7 Years
First Payment Date:	7/15/2025	7/15/2025	7/15/2025	7/15/2026	7/15/2026	7/15/2026
Regular Payment Amount:	\$311,864.71	\$168,788.92	\$119,856.86	\$340,799.72	\$182,564.55	\$129,160.27
Payment Frequency:	Annual	Annual	Annual	Annual	Annual	Annual
Special Payment Amount:	\$500,000	\$500,000	\$500,000	\$500,000	\$500,000	\$500,000
Special Payment Date:	7/15/2027	7/15/2027	7/15/2027	7/15/2027	7/15/2027	7/15/2027
Interest Rate:	5.87%	5.79%	5.75%	5.93%	5.83%	5.77%

Truck funds available after January 15, 2027 to cover escrow discount (30 months)
*Escrow discount is a conservative estimate based on today's rate and delivery schedule.
 Final amount will be determined at closing.*

Qualifications:

1. **Pricing:** This is a lease proposal for the payment stream(s) indicated above. If any of the information identified above are not correct, please advise us so that we can determine if a new proposal is required. Other important elements of this proposal are:

- a) **Rate Expiration:** Due to the current increasing rate markets, this proposal is valid under the following circumstances:
 - The award is received within 30 days of the Proposal Date.
 - The transaction is closed within 60 days off the Proposal Date.
 If you are unable to award within 30 days, please contact us prior to your decision meeting date and we will provide a current proposal.

b) **Closing Costs:** There will be no up-front costs of any kind charged by Lessor including closing costs, points, administrative costs, etc. Your attorney may charge you to review the lease documents and complete the opinion letter required with our lease documentation.

c) **Fixed Rates:** Rates for ten (10) years and under are fixed for the entire term. Terms over ten years have a one time rate adjustment after ten (10) years to the then current interest rates for the remaining term.

2. **Type of Lease:** This is a lease-purchase type of financing. After all the lease payments are made, Lessee will own the equipment without further cost.

3. **Financial Reporting:** All city, county and tax districts (including fire districts) will be expected to provide GAAP audited financial reports. All non-for profit corporations (vfd's) will be expected to provide IRS 990 federal tax returns. If you do not maintain these types of financial reports, please contact us to discuss.

4. **Vendor Payable / Escrow Account (where applicable):** Proceeds of this lease will be held in a vendor payable account until delivery/acceptance. Projected escrow earnings have been pre-applied to reduce the amount financed. Additional escrow earnings over estimate will accrue to Lessee minus escrow management costs of \$750. Truck funds available after January 15, 2027 to cover escrow discount (30 months). The net effective rate reflects estimated escrow earnings. The actual Interest Rate on the reduced borrowing amount is provided below the Net Effective Rate.

5. **Credit Approval and Documentation:** This is a proposal only, and does not represent a commitment to lease. This financing is subject to credit review and approval and execution of mutually acceptable documentation, including the opinion of lessee's counsel opining that the agreement is legal, valid and binding, obligation of Lessee.

Financing by: Leasing 2, Inc.
Contact: Brad Meyers
Phone: 813-258-9888 x12
Email: bmeyers@leasing2.com
Web: www.leasing2.com



REQUEST TO PROCEED:

When you are ready to proceed with Leasing 2 towards finalizing this lease financing arrangement, please indicate so by signing below and completing the requested information. We will immediately email you our application. Thank you for your confidence and consideration.

Proposal date: May 24, 2024

Option Chosen: _____ (where applicable)

Upcoming Governing Body meeting date for lease approval: _____

City of Forest Park, GA

Name of Lessee

Authorized Signature

Date

Title

Printed Name Of Authorized Signature

Last month of your budget year?

Contact Name

(If Different Than Authorized Signature)

Contact Phone

Contact Email

Financial Contact Name

(Can be Treasurer or Clerk)

Contact Phone

Contact Email

Please complete the above information and fax or email all pages of the proposal to
813-258-9333 / bmeyers@leasing2.com



**** Important: A Resolution will be required with the lease contract ****

**In the event that you require board action to sign this proposal,
please call us so that we may forward the preferred form for the meeting.**

Are you ready to move forward with Leasing 2?

Here is a quick overview of our process

- 1. Signed Proposal** - When you are ready to move forward with Leasing 2, email a scan of the completed and signed proposal back to Leasing 2.
- 2. Credit Application** - A credit application and request for current financial reports will be emailed to the designated contacts upon receipt of the signed proposal. The credit application should be completed and returned promptly to protect your quoted interest rates. Credit approval usually comes within a few days receipt of the completed credit application.
- 3. Financing Agreement** - Once credit approval is accomplished, the financing agreement will be emailed for review and signature. Once the contracts are signed and returned, we are ready for closing.

FENDER STORAGE
 LFF: OIL DRY HOPPER
 LRF: FUEL/SCBA COMBO
 RRF: SINGLE SCBA
 RFF: SINGLE SCBA

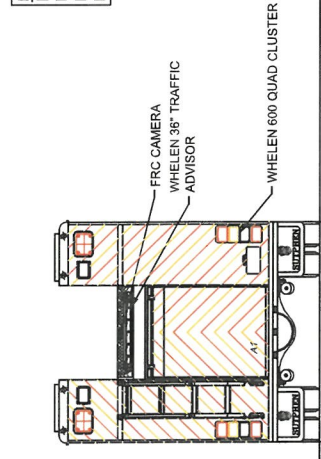
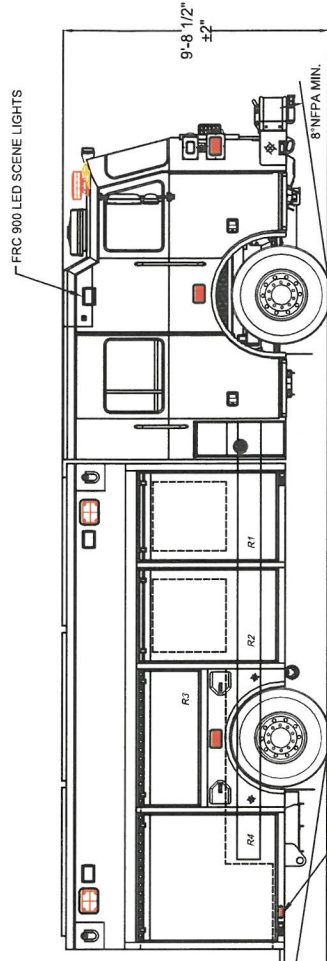

LEFT SIDE COMPARTMENTS		
COMP	DOORS	VOLUME
L1	ROLL-UP	57.1 CU. FT.
L2	ROLL-UP	31.1 CU. FT.
L3	ROLL-UP	31.1 CU. FT.
L4	ROLL-UP	31.1 CU. FT.
L5	ROLL-UP	31.1 CU. FT.
L6	ROLL-UP	31.1 CU. FT.
L7	ROLL-UP	31.1 CU. FT.
L8	ROLL-UP	31.1 CU. FT.
L9	ROLL-UP	31.1 CU. FT.
L10	ROLL-UP	31.1 CU. FT.
L11	ROLL-UP	31.1 CU. FT.
L12	ROLL-UP	31.1 CU. FT.
L13	ROLL-UP	31.1 CU. FT.
L14	ROLL-UP	31.1 CU. FT.
L15	ROLL-UP	31.1 CU. FT.
L16	ROLL-UP	31.1 CU. FT.
L17	ROLL-UP	31.1 CU. FT.
L18	ROLL-UP	31.1 CU. FT.
L19	ROLL-UP	31.1 CU. FT.
L20	ROLL-UP	31.1 CU. FT.
L21	ROLL-UP	31.1 CU. FT.
L22	ROLL-UP	31.1 CU. FT.
L23	ROLL-UP	31.1 CU. FT.
L24	ROLL-UP	31.1 CU. FT.
L25	ROLL-UP	31.1 CU. FT.
L26	ROLL-UP	31.1 CU. FT.
L27	ROLL-UP	31.1 CU. FT.
L28	ROLL-UP	31.1 CU. FT.
L29	ROLL-UP	31.1 CU. FT.
L30	ROLL-UP	31.1 CU. FT.
L31	ROLL-UP	31.1 CU. FT.
L32	ROLL-UP	31.1 CU. FT.
L33	ROLL-UP	31.1 CU. FT.
L34	ROLL-UP	31.1 CU. FT.
L35	ROLL-UP	31.1 CU. FT.
L36	ROLL-UP	31.1 CU. FT.
L37	ROLL-UP	31.1 CU. FT.
L38	ROLL-UP	31.1 CU. FT.
L39	ROLL-UP	31.1 CU. FT.
L40	ROLL-UP	31.1 CU. FT.
L41	ROLL-UP	31.1 CU. FT.
L42	ROLL-UP	31.1 CU. FT.
L43	ROLL-UP	31.1 CU. FT.
L44	ROLL-UP	31.1 CU. FT.
L45	ROLL-UP	31.1 CU. FT.
L46	ROLL-UP	31.1 CU. FT.
L47	ROLL-UP	31.1 CU. FT.
L48	ROLL-UP	31.1 CU. FT.
L49	ROLL-UP	31.1 CU. FT.
L50	ROLL-UP	31.1 CU. FT.
L51	ROLL-UP	31.1 CU. FT.
L52	ROLL-UP	31.1 CU. FT.
L53	ROLL-UP	31.1 CU. FT.
L54	ROLL-UP	31.1 CU. FT.
L55	ROLL-UP	31.1 CU. FT.
L56	ROLL-UP	31.1 CU. FT.
L57	ROLL-UP	31.1 CU. FT.
L58	ROLL-UP	31.1 CU. FT.
L59	ROLL-UP	31.1 CU. FT.
L60	ROLL-UP	31.1 CU. FT.
L61	ROLL-UP	31.1 CU. FT.
L62	ROLL-UP	31.1 CU. FT.
L63	ROLL-UP	31.1 CU. FT.
L64	ROLL-UP	31.1 CU. FT.
L65	ROLL-UP	31.1 CU. FT.
L66	ROLL-UP	31.1 CU. FT.
L67	ROLL-UP	31.1 CU. FT.
L68	ROLL-UP	31.1 CU. FT.
L69	ROLL-UP	31.1 CU. FT.
L70	ROLL-UP	31.1 CU. FT.
L71	ROLL-UP	31.1 CU. FT.
L72	ROLL-UP	31.1 CU. FT.
L73	ROLL-UP	31.1 CU. FT.
L74	ROLL-UP	31.1 CU. FT.
L75	ROLL-UP	31.1 CU. FT.
L76	ROLL-UP	31.1 CU. FT.
L77	ROLL-UP	31.1 CU. FT.
L78	ROLL-UP	31.1 CU. FT.
L79	ROLL-UP	31.1 CU. FT.
L80	ROLL-UP	31.1 CU. FT.
L81	ROLL-UP	31.1 CU. FT.
L82	ROLL-UP	31.1 CU. FT.
L83	ROLL-UP	31.1 CU. FT.
L84	ROLL-UP	31.1 CU. FT.
L85	ROLL-UP	31.1 CU. FT.
L86	ROLL-UP	31.1 CU. FT.
L87	ROLL-UP	31.1 CU. FT.
L88	ROLL-UP	31.1 CU. FT.
L89	ROLL-UP	31.1 CU. FT.
L90	ROLL-UP	31.1 CU. FT.
L91	ROLL-UP	31.1 CU. FT.
L92	ROLL-UP	31.1 CU. FT.
L93	ROLL-UP	31.1 CU. FT.
L94	ROLL-UP	31.1 CU. FT.
L95	ROLL-UP	31.1 CU. FT.
L96	ROLL-UP	31.1 CU. FT.
L97	ROLL-UP	31.1 CU. FT.
L98	ROLL-UP	31.1 CU. FT.
L99	ROLL-UP	31.1 CU. FT.
L100	ROLL-UP	31.1 CU. FT.

RIGHT SIDE COMPARTMENTS		
COMP	DOORS	VOLUME
R1	ROLL-UP	57.1 CU. FT.
R2	ROLL-UP	31.1 CU. FT.
R3	ROLL-UP	31.1 CU. FT.
R4	ROLL-UP	31.1 CU. FT.
R5	ROLL-UP	31.1 CU. FT.
R6	ROLL-UP	31.1 CU. FT.
R7	ROLL-UP	31.1 CU. FT.
R8	ROLL-UP	31.1 CU. FT.
R9	ROLL-UP	31.1 CU. FT.
R10	ROLL-UP	31.1 CU. FT.
R11	ROLL-UP	31.1 CU. FT.
R12	ROLL-UP	31.1 CU. FT.
R13	ROLL-UP	31.1 CU. FT.
R14	ROLL-UP	31.1 CU. FT.
R15	ROLL-UP	31.1 CU. FT.
R16	ROLL-UP	31.1 CU. FT.
R17	ROLL-UP	31.1 CU. FT.
R18	ROLL-UP	31.1 CU. FT.
R19	ROLL-UP	31.1 CU. FT.
R20	ROLL-UP	31.1 CU. FT.
R21	ROLL-UP	31.1 CU. FT.
R22	ROLL-UP	31.1 CU. FT.
R23	ROLL-UP	31.1 CU. FT.
R24	ROLL-UP	31.1 CU. FT.
R25	ROLL-UP	31.1 CU. FT.
R26	ROLL-UP	31.1 CU. FT.
R27	ROLL-UP	31.1 CU. FT.
R28	ROLL-UP	31.1 CU. FT.
R29	ROLL-UP	31.1 CU. FT.
R30	ROLL-UP	31.1 CU. FT.
R31	ROLL-UP	31.1 CU. FT.
R32	ROLL-UP	31.1 CU. FT.
R33	ROLL-UP	31.1 CU. FT.
R34	ROLL-UP	31.1 CU. FT.
R35	ROLL-UP	31.1 CU. FT.
R36	ROLL-UP	31.1 CU. FT.
R37	ROLL-UP	31.1 CU. FT.
R38	ROLL-UP	31.1 CU. FT.
R39	ROLL-UP	31.1 CU. FT.
R40	ROLL-UP	31.1 CU. FT.
R41	ROLL-UP	31.1 CU. FT.
R42	ROLL-UP	31.1 CU. FT.
R43	ROLL-UP	31.1 CU. FT.
R44	ROLL-UP	31.1 CU. FT.
R45	ROLL-UP	31.1 CU. FT.
R46	ROLL-UP	31.1 CU. FT.
R47	ROLL-UP	31.1 CU. FT.
R48	ROLL-UP	31.1 CU. FT.
R49	ROLL-UP	31.1 CU. FT.
R50	ROLL-UP	31.1 CU. FT.
R51	ROLL-UP	31.1 CU. FT.
R52	ROLL-UP	31.1 CU. FT.
R53	ROLL-UP	31.1 CU. FT.
R54	ROLL-UP	31.1 CU. FT.
R55	ROLL-UP	31.1 CU. FT.
R56	ROLL-UP	31.1 CU. FT.
R57	ROLL-UP	31.1 CU. FT.
R58	ROLL-UP	31.1 CU. FT.
R59	ROLL-UP	31.1 CU. FT.
R60	ROLL-UP	31.1 CU. FT.
R61	ROLL-UP	31.1 CU. FT.
R62	ROLL-UP	31.1 CU. FT.
R63	ROLL-UP	31.1 CU. FT.
R64	ROLL-UP	31.1 CU. FT.
R65	ROLL-UP	31.1 CU. FT.
R66	ROLL-UP	31.1 CU. FT.
R67	ROLL-UP	31.1 CU. FT.
R68	ROLL-UP	31.1 CU. FT.
R69	ROLL-UP	31.1 CU. FT.
R70	ROLL-UP	31.1 CU. FT.
R71	ROLL-UP	31.1 CU. FT.
R72	ROLL-UP	31.1 CU. FT.
R73	ROLL-UP	31.1 CU. FT.
R74	ROLL-UP	31.1 CU. FT.
R75	ROLL-UP	31.1 CU. FT.
R76	ROLL-UP	31.1 CU. FT.
R77	ROLL-UP	31.1 CU. FT.
R78	ROLL-UP	31.1 CU. FT.
R79	ROLL-UP	31.1 CU. FT.
R80	ROLL-UP	31.1 CU. FT.
R81	ROLL-UP	31.1 CU. FT.
R82	ROLL-UP	31.1 CU. FT.
R83	ROLL-UP	31.1 CU. FT.
R84	ROLL-UP	31.1 CU. FT.
R85	ROLL-UP	31.1 CU. FT.
R86	ROLL-UP	31.1 CU. FT.
R87	ROLL-UP	31.1 CU. FT.
R88	ROLL-UP	31.1 CU. FT.
R89	ROLL-UP	31.1 CU. FT.
R90	ROLL-UP	31.1 CU. FT.
R91	ROLL-UP	31.1 CU. FT.
R92	ROLL-UP	31.1 CU. FT.
R93	ROLL-UP	31.1 CU. FT.
R94	ROLL-UP	31.1 CU. FT.
R95	ROLL-UP	31.1 CU. FT.
R96	ROLL-UP	31.1 CU. FT.
R97	ROLL-UP	31.1 CU. FT.
R98	ROLL-UP	31.1 CU. FT.
R99	ROLL-UP	31.1 CU. FT.
R100	ROLL-UP	31.1 CU. FT.

FRONT COMPARTMENT		
COMP	DOORS	VOLUME
F1	ROLL-UP	10.0 CU. FT.
F2	ROLL-UP	10.0 CU. FT.
F3	ROLL-UP	10.0 CU. FT.
F4	ROLL-UP	10.0 CU. FT.
F5	ROLL-UP	10.0 CU. FT.
F6	ROLL-UP	10.0 CU. FT.
F7	ROLL-UP	10.0 CU. FT.
F8	ROLL-UP	10.0 CU. FT.
F9	ROLL-UP	10.0 CU. FT.
F10	ROLL-UP	10.0 CU. FT.
F11	ROLL-UP	10.0 CU. FT.
F12	ROLL-UP	10.0 CU. FT.
F13	ROLL-UP	10.0 CU. FT.
F14	ROLL-UP	10.0 CU. FT.
F15	ROLL-UP	10.0 CU. FT.
F16	ROLL-UP	10.0 CU. FT.
F17	ROLL-UP	10.0 CU. FT.
F18	ROLL-UP	10.0 CU. FT.
F19	ROLL-UP	10.0 CU. FT.
F20	ROLL-UP	10.0 CU. FT.
F21	ROLL-UP	10.0 CU. FT.
F22	ROLL-UP	10.0 CU. FT.
F23	ROLL-UP	10.0 CU. FT.
F24	ROLL-UP	10.0 CU. FT.
F25	ROLL-UP	10.0 CU. FT.
F26	ROLL-UP	10.0 CU. FT.
F27	ROLL-UP	10.0 CU. FT.
F28	ROLL-UP	10.0 CU. FT.
F29	ROLL-UP	10.0 CU. FT.
F30	ROLL-UP	10.0 CU. FT.
F31	ROLL-UP	10.0 CU. FT.
F32	ROLL-UP	10.0 CU. FT.
F33	ROLL-UP	10.0 CU. FT.
F34	ROLL-UP	10.0 CU. FT.
F35	ROLL-UP	10.0 CU. FT.
F36	ROLL-UP	10.0 CU. FT.
F37	ROLL-UP	10.0 CU. FT.
F38	ROLL-UP	10.0 CU. FT.
F39	ROLL-UP	10.0 CU. FT.
F40	ROLL-UP	10.0 CU. FT.
F41	ROLL-UP	10.0 CU. FT.
F42	ROLL-UP	10.0 CU. FT.
F43	ROLL-UP	10.0 CU. FT.
F44	ROLL-UP	10.0 CU. FT.
F45	ROLL-UP	10.0 CU. FT.
F46	ROLL-UP	10.0 CU. FT.
F47	ROLL-UP	10.0 CU. FT.
F48	ROLL-UP	10.0 CU. FT.
F49	ROLL-UP	10.0 CU. FT.
F50	ROLL-UP	10.0 CU. FT.
F51	ROLL-UP	10.0 CU. FT.
F52	ROLL-UP	10.0 CU. FT.
F53	ROLL-UP	10.0 CU. FT.
F54	ROLL-UP	10.0 CU. FT.
F55	ROLL-UP	10.0 CU. FT.
F56	ROLL-UP	10.0 CU. FT.
F57	ROLL-UP	10.0 CU. FT.
F58	ROLL-UP	10.0 CU. FT.
F59	ROLL-UP	10.0 CU. FT.
F60	ROLL-UP	10.0 CU. FT.
F61	ROLL-UP	10.0 CU. FT.
F62	ROLL-UP	10.0 CU. FT.
F63	ROLL-UP	10.0 CU. FT.
F64	ROLL-UP	10.0 CU. FT.
F65	ROLL-UP	10.0 CU. FT.
F66	ROLL-UP	10.0 CU. FT.
F67	ROLL-UP	10.0 CU. FT.
F68	ROLL-UP	10.0 CU. FT.
F69	ROLL-UP	10.0 CU. FT.
F70	ROLL-UP	10.0 CU. FT.
F71	ROLL-UP	10.0 CU. FT.
F72	ROLL-UP	10.0 CU. FT.
F73	ROLL-UP	10.0 CU. FT.
F74	ROLL-UP	10.0 CU. FT.
F75	ROLL-UP	10.0 CU. FT.
F76	ROLL-UP	10.0 CU. FT.
F77	ROLL-UP	10.0 CU. FT.
F78	ROLL-UP	10.0 CU. FT.
F79	ROLL-UP	10.0 CU. FT.
F80	ROLL-UP	10.0 CU. FT.
F81	ROLL-UP	10.0 CU. FT.
F82	ROLL-UP	10.0 CU. FT.
F83	ROLL-UP	10.0 CU. FT.
F84	ROLL-UP	10.0 CU. FT.
F85	ROLL-UP	10.0 CU. FT.
F86	ROLL-UP	10.0 CU. FT.
F87	ROLL-UP	10.0 CU. FT.
F88	ROLL-UP	10.0 CU. FT.
F89	ROLL-UP	10.0 CU. FT.
F90	ROLL-UP	10.0 CU. FT.
F91	ROLL-UP	10.0 CU. FT.
F92	ROLL-UP	10.0 CU. FT.
F93	ROLL-UP	10.0 CU. FT.
F94	ROLL-UP	10.0 CU. FT.
F95	ROLL-UP	10.0 CU. FT.
F96	ROLL-UP	10.0 CU. FT.
F97	ROLL-UP	10.0 CU. FT.
F98	ROLL-UP	10.0 CU. FT.
F99	ROLL-UP	10.0 CU. FT.
F100	ROLL-UP	10.0 CU. FT.

SUTPHEN
 CITY OF FOREST PARK
 FOREST PARK, GA
 CUSTOM HEAVY DUTY RESCUE - RA-18

DESIGNER: RAGHU DATE: 10/1/2023
 CHECKER: JVG DATE: 01/12/2024
 DRAWN BY: RAGHU DATE: 10/1/2023
 REV. BY DATE DESCRIPTION

THIS PRINT IS PROVIDED ON A RESTRICTED BASIS AND IS NOT TO BE USED IN ANY WAY DETRIMENTAL TO THE INTEREST OF SUTPHEN CORPORATION.

CUSTOMER APPROVAL

NAME: _____
 TITLE: _____
 DATE: _____

DIMENSIONS SHOWN ON THE DRAWINGS ARE APPROXIMATE AND ARE SUBJECT TO MINOR DEVIATIONS DURING CONSTRUCTION. IN THE EVENT OF A DISCREPANCY BETWEEN THE SUTPHEN SPECIFICATIONS AND DRAWING, THE SUTPHEN SPECIFICATIONS SHALL PREVAIL. DRAWING IS FOR REFERENCE ONLY. SOME ITEMS PROPOSED MAY NOT BE SHOWN OR NOTED.

 Sutphen Component Report Dealership: Williams Fire Apparatus_3 (Moore)	HS- City of Forest Park, Georgia Heavy Rescue
	Order#: DQ016770-2 Contact: Position: Phone: Mobile: Email:

Bill To	Ship To
Customer: City of Forest Park Contact: , Address: City Hall Forest Park, Georgia 30297	Customer: City of Forest Park Contact: , Address: City Hall Forest Park, Georgia 30297

Comments
Project Manager: Sales Person: Jerry Harley Revision Level: Truck Type: Body Facility:

Quote Line Number 1

Line	Item #	Qty	Item Description/Comments
1	PA	1	Facility = Pennsylvania
2	Sourcewell	1	Cooperative Purchasing =Sourcewell
3	10000225	1	STD WIRING SCHEMATIC (USB)
4	10310100	1	CHASSIS
CHASSIS			
5	10010001	1	CHASSIS, CUSTOM
6	51070220	1	WHEELBASE = 220
7	51010310	1	WHEELBASE GREATER THAN 200"
8	25010255	1	FRAME, 10" DOUBLE RAILS, DOMEX, SINGLE AXLE (110K PSI)
9	45040100	1	FRONT BUMPER CLIP
10	45010001	1	FRONT TOW EYES, BELOW BUMPER, PAINTED
11	46010000	1	REAR TOW EYES, PAINTED
12	40010250	1	STEERING - ROSS TAS-85
13	22010050	1	DRIVE LINE, SPICER, 1810 SERIES

Line	Item #	Qty	Item Description/Comments
14	23015100	1	ENGINE, CUMMINS X10 HHD 450HP DOC-DPF-DEF-SCR OBD
15	23029200	1	ENGINE WARRANTY, 5 YEAR, 100,000 MILES FOR CUMMINS (X SERIES)
16	23029400	1	AFTERTREATMENT WARRANTY, 5 YEAR, 100,000 MILES FOR CUMMINS (X SERIES)
17	23030006	1	AIR INTAKE/EMBER SEPARATOR
18	23031176	1	FUEL FILTER/WATER SEPARATOR, PRIMARY, FLEETGUARD FUEL PRO FH230
19	23031220	1	FUEL FILTER, SECONDARY, FLEETGUARD, FF5825NN
20	47012520	1	TRANSMISSION, ALLISON GEN 6, EVS4000 (X10HHD, X12, X15)
21	23110000	1	JACOBS ENGINE BRAKE
22	47024050	1	TRANSMISSION COOLER
23	47030000	1	ALLISON TOUCH PAD SHIFTER
24	47030140	1	SHIFTER PAD GEARING, 5 GEARS OPEN, 6TH GEAR LOCKED, MODE BUTTON FOR GENERATOR
25	21021200	1	COOLING SYSTEM
26	21030195	1	COOLANT FILTER
27	21030000	1	FAN CLUTCH
28	21030200	1	RADIATOR COOLANT RECOVERY, PRESSURIZED SYST
29	26010000	1	FUEL TANK, STEEL, 65 GALLON
30	26030000	1	FUEL FILL
31	26030100	1	FUEL COOLER
32	24040000	1	DIESEL EXHAUST FLUID TANK
33	13010225	1	ALTERNATOR, LEECE NEVILLE 420 AMP BLP4003
34	13030100	1	LOW VOLTAGE ALARM, FLOYD BELL TXB-V86-515-QF
35	15010500	1	BATTERIES, INTERSTATE TYPE 31 MHD (4)
36	15030215	1	MASTER BATTERY DISCONNECT SWITCH
37	15031700	1	BATTERY JUMPER TERMINALS
38	15031510	1	BATTERY CHARGER, KUSSMAUL CHIEF 4012
39	15030465	1	120V SHORELINE INLET, KUSSMAUL SUPER 20 AUTO EJECT W/ OLED DISPLAY 091-55-266-XX

Line	Item #	Qty	Item Description/Comments
40	15040100	4	120V OUTLET WIRED TO SHORELINE INLET - EA (4)
41	14022120	1	FRONT AXLE, HENDRICKSON STEERTEK NXT 20,000 LB.
42	41022120	1	FRONT SUSPENSION, HENDRICKSON 20,000 LBS. (4) 56" LEAFS
43	41040510	1	STEER ASSIST
44	43010306	1	FRONT TIRES, GOODYEAR 385/65R22.5 LRJ ARMOR MAX PRO 22.5 x 12.25 WHEELS
45	14510520	1	REAR AXLE, MERITOR RS-24-160 24,000 LB.
46	14530100	1	TOP SPEED, 68 MPH
47	42010010	1	REAR SUSPENSION, FIREMAAX 24,000 LBS. AIR RIDE
48	44010308	1	REAR TIRES, GOODYEAR 12R22.5 X 8.25 LRH ENDURANCE RSA HIGHWAY 24,000 - 27,000 GVWR
49	42910300	1	TIRE PRESSURE MONITOR, QUICK PRESSURE
50	44210100	1	WHEELS, ALUM, ACCURIDE (max 27K rear)
51	44270100	1	HUB COVERS, FRONT & REAR, POLISHED STS (Single Axle)
52	44270300	1	CHROME LUG NUT CAPS, FRONT & REAR (Single Axle)
53	44271100	1	MUD FLAPS, FRONT (PAIR)
54	44271200	1	MUD FLAPS, REAR (PAIR)
55	54010010	1	DATA, SAFETY & WARNING TAGS APPLICATION, ADHESIVE
56	16010220	1	BRAKES MERITOR SCAM 6" FRONT, SCAM 8.625" REAR (SINGLE AXLE)
57	18010041	1	AIR BRAKE SYST 4 TANKS WABCO 1200 DRYER (24K, 27K)
58	18030010	1	AIR BRAKE RELEASE VALVE, WABCO
59	18030140	1	AIR INLET CONNECTION W/CHECK VALVE
60	18035110	1	AIR COMPRESSOR, KUSSMAUL AUTO PUMP AC, 100PSI
61	18036105	1	TIMER, KUSSMAUL AUTO PUMP
62	18210000	1	ELEC STABILITY CONTROL SYST
63	18110050	1	WABCO 4 CHANNEL ANTI-LOCK BRAKES W/ASR (24K, 27K)
64	53510000	1	COMPRESSION FITTINGS ON AIR SYSTEM (CHASSIS)
65	54010000	1	MISCELLANEOUS ITEMS ON CHASSIS

Line	Item #	Qty	Item Description/Comments
66	10310110	1	CAB
CAB			
67	11023250	1	CAB TSAL4E 73" 10" RR 1/2
68	11030025	1	CAB CERTIFICATION - STRUCTURAL INTEGRITY
69	11030950	1	CAB LOCKDOWN LATCHES
70	11031025	1	CAB TILT SYSTEM, AIR CONTROL VALVE
71	11031100	1	MANUAL BACK-UP TILT SYSTEM
72	11031350	1	CAB DOORS, FULL LENGTH (4)
73	11031385	1	CAB STEPS, LOWER GRIP STRUT, INTERMEDIATE DIAMONDPLATE
74	11031399	1	CAB STEP LIGHTING, TECNIQ E45 LED STRIP LIGHTS
75	11031419	1	CAB DOOR WINDOWS, MANUAL (4)
76	11031400	1	DELETE CAB SIDE WINDOWS
77	11031460	1	NO WINDOWS, BACK WALL OF CAB
78	11031465	1	WINDOW TINTING (LIMO TINT 8%) - EACH (2)
79	52010010	1	ELECTRIC INTERMITTENT WIPERS
80	52030200	1	WINDSHIELD WASHER RESERVOIR
81	38010015	1	MIRRORS LANG MEKRA 300 SERIES REMOTE
82	11024420	1	UPPER GRILLE, AMERICAN FLAG LEVEL STYLE FACADE (X SERIES)
83	11024510	1	FLAMING "S" LOGO, UPPER GRILLE, ILLUMINATED
84	11024615	1	LOWER GRILLE, POLISHED STAINLESS, LASER CUT LETTERING W/ BACKLIGHTING
85	20010080	1	BUMPER, 18" POLISHED STAINLESS STEEL
86	20029800	1	BUMPER SIDES, DIAMONDPLATE
87	20040105	1	STORAGE WELL, DEEP CENTER, FULL WIDTH (18" BUMPER)
88	20030100	1	STORAGE WELL COVER, TREADPLATE, 2" RAISE
89	20050300	1	WINCH RECEIVER, FRONT
90	12010500	1	AIR HORNS, DUAL, GROVER #2040 RECTANGULAR, BEHIND PERFORATION
91	12030015	1	AIR HORNS CUTOUTS IN BUMPER, BEHIND PERFORATIONS (X SERIES)

Line	Item #	Qty	Item Description/Comments
92	12030305	1	FOOT SWITCH, DRIVER'S SIDE
93	12030350	1	LANYARD CONTROL FOR AIR HORNS
94	12510109	1	ELEC SIREN, WHELEN 295HFSA7, REMOTE FLUSH MOUNT WITH REMOVABLE MIC
95	12530205	1	ELEC SIREN WIRED TO STEERING WHEEL BUTTON
96	12620200	1	SIREN SPEAKER, 100W, WHELEN, SA314B, BLACK FINISH
97	12670110	1	SIREN SPEAKER(S) INSTALLED BEHIND CAB GRILLE
98	12710100	1	SIREN, FEDERAL Q2B, GRILLE MOUNT
99	12730305	1	FOOT SWITCH, DRIVER'S SIDE, FOR MECH SIREN
100	12730350	1	MOMENTARY SWITCH ON DASH, OFFICER'S SIDE, FOR MECH SIREN
101	12730363	1	SIREN BRAKE SWITCH FOR MECH SIREN, DRIVER'S & OFFICER'S SIDE
102	32520520	1	HEADLIGHTS, LED, FIRETECH FT-4X6, DUAL STS HOUSINGS (MIXED UPPER WARNING & TURN SIGNAL)
103	32530500	1	ALTERNATING FLASHER FOR HEADLIGHT
104	48010300	1	FRONT TURN SIGNALS, WHELEN 400 SERIES LED (4) (MIXED HOUSING)
105	32530750	1	ICC LIGHTS, LED, ROOF MOUNTED MARKERS, GROTE
106	27022120	1	HANDRAILS, CAB EXTERIOR, KNURLED STAINLESS STEEL (4) SIDE
107	27030710	1	HANDRAILS, FRONT OF CAB, KNURLED STAINLESS STEEL (PAIR)
108	27025000	1	HANDRAILS, CAB INTERIOR, BLACK RUBBER COATED (2) FRONT ENTRY
109	27030120	1	HANDRAILS, REAR CAB INTERIOR DOOR, BLACK RUBBERIZED (2) AND KNURLED STS AT WINDOW (2)
110	27040100	1	INTERIOR DOOR, NYLON STRAP
111	11032010	1	EXTERIOR COMPT, SIDE OF EXT CAB, 38" H, DS
112	11031930	1	EXTERIOR DOOR, HINGED, PAINTED
113	11032610	1	DRIVER SIDE, LEFT DOOR HINGE (OPEN TOWARDS FRONT OF CAB)
114	11032450	1	COMPT DOOR LOCK - NOT PROVIDED
115	11032100	1	NO OPENING TO CREW SEAT COMPT
116	11032060	1	EXTERIOR COMPT, SIDE OF EXT CAB, 38" H, OS
117	11031930	1	EXTERIOR DOOR, HINGED, PAINTED

Line	Item #	Qty	Item Description/Comments
118	11032620	1	OFFICER'S SIDE, RIGHT DOOR HINGE (OPEN TOWARDS FRONT OF CAB)
119	11032450	1	COMPT DOOR LOCK - NOT PROVIDED
120	11032100	1	NO OPENING TO CREW SEAT COMPT
121	11032300	1	PIKE POLE STORAGE, EXTERIOR CAB COMPT (BACK WALL)
122	11035555	1	REAR EXTERIOR WALL EDGES, TREADPLATE, 1" WIDE, FULL HEIGHT
123	11035420	1	DIAMONDPLATE CAB ROOF 30" x FULL WIDTH
124	11033202	1	3/16" SMOOTH ALUM BACK WALL & SIDE WALLS, INSIDE CAB
125	31010285	1	INTERIOR, MULTISPEC BLACK SPECKLE PAINT W/GRAY-BLACK DURAWEAR
126	11032929	1	DOOR PANEL, FULL STS
127	31010291	1	CAB INTERIOR FLOOR COVERING, BLACK RUBBERIZED
128	22510100	1	ENGINE ENCLOSURE, FULL LENGTH
129	22510530	1	ENGINE ENCLOSURE COVERING, SCORPION BLACK URETHANE BLEND
130	11031677	1	CENTER CONSOLE NOT PROVIDED
131	22610050	1	ENGINE HOOD LIGHT, LED (1)
132	11031515	1	COMPUTER TRAY W/STATIONARY STORAGE
133	11031712	1	UPPER CREW DOOR AREA, OPEN
134	29810100	1	CHASSIS ELECTRICAL DESCRIPTION
135	30010130	1	INSTRUMENTATION, AMETEK W/ CENTER & OVERHEAD CONSOLES
136	30010508	1	LOWER COMMAND CONSOLE, X10
137	30031612	1	DO NOT MOVE LIGHT, WHELEN LINZ6 LED
138	30031650	1	DO NOT MOVE ALARM
139	30031675	1	DO NOT MOVE DISENGAGE BUTTON
140	29930210	1	DELETE MAPBOOK SLOT ON FRONT BREAKER PANEL
141	29910100	1	PROGRAMMABLE LOAD MANAGER, CLASS-1 SUPERNODE II
142	30031100	1	HIGH IDLE SWITCH
143	11040000	1	CAB ACCESSORY FUSE PANEL

Line	Item #	Qty	Item Description/Comments
144	84541540	1	POWER & GROUND STUDS, UPPER COMMAND CONSOLE
145	84541545	1	POWER & GROUND STUDS, LOWER COMMAND CONSOLE
146	30110000	1	VEHICLE DATA RECORDER, AKRON/WELDON
147	30031810	3	12V POWER POINT (3)
148	30031830	4	12V DUAL POWER POINT, USB/USBC, POWERWERX (4)
149	33510030	1	INTERIOR CAB LIGHTS, WHELEN 6" ROUND RED/CLEAR LED (2)
150	34010030	1	INTERIOR CREW LIGHTS, WHELEN 6" ROUND RED/CLEAR LED (2)
151	28010750	1	DEFROSTER, HEATER & A/C, SEVERE CLIMATE (TM-31)
152	28090003	1	HEAT TO FEET
153	28030500	1	DEFROSTER DUCTWORK, ENTIRE WINDSHIELD
154	11031687	1	TOP HEAT/AC STORAGE, TOOL MOUNTING PLATE, 25" x 19.5"
155	38510104	1	DRIVER'S SEAT, BOSTROM SIERRA HIGH BACK AIR RIDE ABTS (DURAWEAR PLUS, LOW SEAM)
156	38340110	1	PRIMARY SEAT POSITION
157	38350100	1	SEAT BELT CONFIGURATION, PULL FROM LEFT SHOULDER TO BUCKLE AT RIGHT HIP
158	38320000	1	HELMET STORED IN COMPARTMENT
159	39010118	1	OFFICER'S SEAT, BOSTROM TANKER 450, ABTS SCBA (DURAWEAR PLUS, LOW SEAM)
160	38340110	1	PRIMARY SEAT POSITION
161	38350200	1	SEAT BELT CONFIGURATION, PULL FROM RIGHT SHOULDER TO BUCKLE AT LEFT HIP
162	39030010	1	OFFICER'S SEAT COMPT, OPEN FRONT
163	38320000	1	HELMET STORED IN COMPARTMENT
164	11031821	1	EMS CABINET, REAR FACING, BEHIND DRIVER
165	11032250	1	INTERIOR ACCESS, ROLL-UP DOOR, AMDOR
166	11032415	1	INTERIOR COMPARTMENT DOOR LOCK
167	11032311	1	ADJUSTABLE SHELF, EMS COMPT (1)
168	11031822	1	EMS CABINET, REAR FACING, BEHIND OFFICER
169	11032250	1	INTERIOR ACCESS, ROLL-UP DOOR, AMDOR

Line	Item #	Qty	Item Description/Comments
170	11032415	1	INTERIOR COMPARTMENT DOOR LOCK
171	11032311	1	ADJUSTABLE SHELF, EMS COMPT (1)
172	39521465	1	CREW SEAT 3, BOSTROM TANKER 450, ABTS SCBA FIXED (DURAWEAR PLUS, LOW SEAM)
173	38340120	1	SECONDARY SEAT POSITION
174	38350100	1	SEAT BELT CONFIGURATION, PULL FROM LEFT SHOULDER TO BUCKLE AT RIGHT HIP
175	38320000	1	HELMET STORED IN COMPARTMENT
176	39521466	1	CREW SEAT 4, BOSTROM TANKER 450, ABTS SCBA FIXED (DURAWEAR PLUS, LOW SEAM)
177	38340120	1	SECONDARY SEAT POSITION
178	38350200	1	SEAT BELT CONFIGURATION, PULL FROM RIGHT SHOULDER TO BUCKLE AT LEFT HIP
179	38320000	1	HELMET STORED IN COMPARTMENT
180	39550200	1	SEAT COLOR, BLACK
181	39610000	3	SCBA BRACKETS, BOSTROM, SECURE ALL (3)
182	38410000	1	SEAT BELT WARNING SYSTEM, AKRON / WELDON
183	39710015	1	FULL WIDTH CREW SEAT COMPT, FRONT DROP-DOWN DOORS (73" CAB)
184	84561015	1	CAMERA SYSTEM, FRC, INVIEW TRUEVIEW, TWO CAMERAS (WIRED)
185	10310300	1	BODY
BODY			
186	80029895	1	BODY SUBFRAME, RESCUES
187	80130120	1	BODY RA-20 20' ALUM, WALK AROUND, SINGLE AXLE, W/DOUBLE HATCH COMPTS
188	80421350	1	REAR COMPARTMENT, A1
189	80421450	1	UPPER BODY, CENTER WALKWAY
190	80421550	1	WALKWAY FINISH, DIAMONDPLATE
191	80421465	1	WALKWAY LIGHTS, TECNIQ E44
192	80421520	1	REAR ACCESS LADDER, STAINLESS STEEL
193	80421560	1	UPPER HATCH COMPT FINISH, DIAMONDPLATE
194	80421600	1	ROPE TIE-OFFS, (2) EA SIDE - TOTAL (4)
195	80421652	1	SCUFF PLATE FOR ROPE TIE-OFFS, ALUMINUM W/RAPTOR

Line	Item #	Qty	Item Description/Comments
196	10310302	1	BODY COMPARTMENTS
BODY COMPARTMENTS			
197	81165705	1	UNISTRUT TRACK IN COMPTS
198	80220140	1	COMPT DOORS, AMDOR ROLL-UP, PAINTED
199	80230600	1	DOOR SILL PROTECTION, BODY COMPTS, PROTEC, CLEAR FILM
200	80225100	1	REAR COMPT DOOR (A1) AMDOR ROLL-UP, SATIN FINISH
201	80230650	1	DOOR SILL PROTECTION, REAR COMPT, NOT FACTORY PROVIDED
202	80230350	1	COMPT INTERIOR FINISH, DA
203	84531110	1	COMPT LIGHTING, AMDOR LED LIGHT STRIPS, 2 PER COMPT
204	10310305	1	BODY EXTERIOR
BODY EXTERIOR			
205	81910100	1	HANDRAILS, KNURLED STS
206	82032000	1	FULL WIDTH TREADPLATE REAR STEP BELOW HOSEBED ABOVE REAR COMPT
207	82510000	1	RUB RAILS, ANODIZED ALUM
208	83010050	1	ALUMINUM TREADPLATE (ALUM PPR, PRG1, C-SER, TANKER)
209	80290060	1	OIL DRY HOPPER W/ SCBA CYLINDERS COMPT (3 SINGLE-SIG4)
210	80290310	3	DOOR FINISH, BRUSHED STAINLESS, SINGLE/DOUBLE SCBA COMPT (3)
211	80290520	1	DOOR FINISH, BRUSHED STAINLESS, OIL DRY HOPPER (1)
212	83030705	1	REAR FENDERS, ALUMINUM TREADPLATE
213	89021000	1	GROUND LADDERS, NOT PROVIDED
214	10310310	1	ELECTRICAL
ELECTRICAL			
215	84550110	1	LICENSE PLATE BRACKET W/ LIGHT, LED
216	84511100	1	BODY ELECTRICAL DESCRIPTION
217	84520000	1	BACK UP ALARM, ECCO SA917
218	85010302	1	TAILLIGHTS, WHELEN 600 SERIES, LED STOP/TAIL/TURN/REVERSE, QUAD HOUSING (PAIR)
219	85110100	1	ICC LIGHTS, LED

Line	Item #	Qty	Item Description/Comments
220	85510300	1	STEP LIGHTS, LED
221	85710010	1	UNDERCARRIAGE GROUND LIGHTS, TRUCK-LITE #44042C LED
222	86600020	1	OPTICAL WARNING SYSTEM, UPPER (RESCUE)
223	86610110	1	UPPER WARNING LIGHTS, ZONE A (FRONT), WHELEN FREEDOM IV 72" LED LIGHT BAR, F4N7QLED, 10 MODULES
224	86920100	1	UPPER ZONE A LIGHTBAR, STANDARD CONFIGURATION
225	86699998	1	UPPER WARNING LIGHTS, ZONE B (OFFICER'S SIDE), COVERED BY ZONES A & C (Surface Mount)
226	86710300	1	UPPER WARNING LIGHTS, ZONE C (REAR), WHELEN LED, 900 SERIES SURFACE MOUNT, 90**5F*R (QTY 4)
227	86899998	1	UPPER WARNING LIGHTS, ZONE D (DRIVER'S SIDE), COVERED BY ZONES A & C (Surface Mount)
228	87100020	1	OPTICAL WARNING SYSTEM, LOWER (RESCUE)
229	87110110	1	LOWER WARNING LIGHTS, ZONE A (FRONT), WHELEN 600 SUPER LED, 60*02F*R (QTY 4)
230	87811130	1	LOWER, ZONE A - MOUNTING LOCATION (DUAL HOUSINGS)
231	87210100	1	LOWER WARNING LIGHTS, ZONE B (OFFICER'S SIDE), WHELEN 600 SUPER LED, 60*02F*R (QTY 2), ION T-SERIES LED, TLI* (QTY 1)
232	87812110	1	LOWER, ZONE B - MOUNTING LOCATION (PUMPERS, TANKERS, RESCUES)
233	87310100	1	LOWER WARNING LIGHTS, ZONE C (REAR), WHELEN 600 SUPER LED, 60*02F*R (QTY 2)
234	87410100	1	LOWER WARNING LIGHTS, ZONE D (DRIVER'S SIDE), WHELEN 600 SUPER LED, 60*02F*R (QTY 2), ION T-SERIES TLI* (QTY 1)
235	87814110	1	LOWER, ZONE D - MOUNTING LOCATION (PUMPERS, TANKERS, RESCUES)
236	87537732	1	ADDITIONAL WARNING LIGHTS, WHELEN 600 SUPER LED, 60*02F*R (PAIR) (1)
237	87537742	1	ADDITIONAL WARNING LIGHTS, WHELEN 900 SERIES LED, 90**5F*R (PAIR) (1)
238	87040000	1	TRAFFIC ADVISOR, WHELEN LED, TAL65 36"
239	88390902	2	SCENE LIGHT, FRC SPECTRA 20K, 12V LED, BROW (2)
240	88390950	8	SCENE LIGHT, FRC SPECTRA 900, 12V LED, SURFACE MOUNT (8)
241	88399940	4	ADDITIONAL SWITCH, 3-WAY FOR 12V LIGHTS (EA) (4)
242	10310320	1	GENERATOR & ACCESSORIES
GENERATOR & ACCESSORIES			
243	88230200	1	GENERATOR, SMART POWER, 6KW TM HYD
244	88250405	1	CIRCUIT BREAKER PANEL WITH 8 SPACES FOR BREAKERS

Line	Item #	Qty	Item Description/Comments
245	88251100	1	BREAKER PANEL, STD LOCATION (L1)
246	88431205	1	HANNAY ECR-1616-17-18 REEL W/150' 10/3 (1)
247	88433010	1	MOUNTING OF ELEC CORD REEL IN BODY COMPT
248	88432000	1	AKRON FOUR-WAY RECEPTACLE BOX, WIRED TO REEL CABLE (1)
249	10310410	1	PAINT & FINISH
PAINT & FINISH			
250	90010020	1	PAINT SCHEME
251	90030010	1	TWO TONE CAB & BODY
252	90030002	1	METALLIC PAINT
253	90029910	1	PAINT BREAK #1 - BOTTOM OF WINDSHIELD
254	90030154	1	PAINT FRAME RAILS & BODY REAR DROP - BLACK
255	90030015	1	A/C CONDENSER PAINTED ROOF COLOR
256	90510000	1	3" LETTERING, 22K UP TO 40
257	90530005	40	ADDITIONAL 3" 22KT LETTERS (EACH) (40)
258	90530203	2	ADDITIONAL 1" SCOTCHLITE LETTERS (EACH) (2)
259	90530235	20	ADDITIONAL 9" SCOTCHLITE LETTERS (EACH) (20)
260	90588888	1	SPECIAL ITEM, FOREST PARK GRAPHICS PACKAGE
261	90600220	1	REFLECTIVE MATL, INTERIOR CAB DOORS, CHEVRONS, REFLEXITE
262	90630610	1	1/2" 22KT GOLD STRIPE W/PRINTED EDGES AT CAB PAINT BREAK
263	90610200	1	6" SCOTCHLITE STRIPE AROUND TRUCK
264	90630405	1	MITER EDGED "Z" STRIPE
265	90680120	1	CHEVRON STRIPING, REAR BODY OUTBOARD, REFLEXITE
266	90680250	1	CHEVRON STRIPING, REAR COMPT DOOR, REFLEXITE
267	10310420	1	EQUIPMENT
EQUIPMENT			
268	91010000	1	MISC EQUIP - (1) PINT TOUCH-UP PAINT, STAINLESS STEEL NUTS & BOLTS
269	10310600	1	COMPLETION & WARRANTY

Line	Item #	Qty	Item Description/Comments
COMPLETION & WARRANTY			
270	99010100	1	MANUALS, ELECTRONIC VERSION (2-USB)
271	99031195	1	DEALER DELIVERY
272	99520110	1	WARRANTY, ONE YEAR
273	99521100	1	WARRANTY, FRAME, LIFETIME
274	99521200	1	WARRANTY, CAB STRUCTURAL, 10 YR.
275	99521300	1	WARRANTY, BODY STRUCTURAL, 10 YR.
276	99521400	1	WARRANTY, PAINT, 10 YR.
277	99521900	1	WARRANTIES, MAJOR VENDOR COMPONENTS
278	10310500	1	DEALER SUPPLIED
DEALER SUPPLIED			
279	Other	1	DEALER SUPPLIED - OTHER - Shelving and Trays
280	Other	1	DEALER SUPPLIED - OTHER - Equipment Mounting
281	Other	1	DEALER SUPPLIED - OTHER - Wheel Chocks
282	Other	1	DEALER SUPPLIED - OTHER - Streamlights
283	Other	1	DEALER SUPPLIED - OTHER - Intercom System Firecom Wireless
284	Other	1	DEALER SUPPLIED - OTHER - Center Console

113021-SUT



Solicitation Number: RFP #113021

CONTRACT

This Contract is between Sourcewell, 202 12th Street Northeast, P.O. Box 219, Staples, MN 56479 (Sourcewell) and The Sutphen Corporation, 6450 Eiterman Road, Dublin, OH 43016 (Supplier).

Sourcewell is a State of Minnesota local government unit and service cooperative created under the laws of the State of Minnesota (Minnesota Statutes Section 123A.21) that offers cooperative procurement solutions to government entities. Participation is open to eligible federal, state/province, and municipal governmental entities, higher education, K-12 education, nonprofit, tribal government, and other public entities located in the United States and Canada. Sourcewell issued a public solicitation for Firefighting Apparatus and Fire Service Vehicles from which Supplier was awarded a contract.

Supplier desires to contract with Sourcewell to provide equipment, products, or services to Sourcewell and the entities that access Sourcewell's cooperative purchasing contracts (Participating Entities).

1. TERM OF CONTRACT

A. EFFECTIVE DATE. This Contract is effective upon the date of the final signature below.

B. EXPIRATION DATE AND EXTENSION. This Contract expires February 10, 2026, unless it is cancelled sooner pursuant to Article 22. This Contract may be extended one additional year upon the request of Sourcewell and written agreement by Supplier.

C. SURVIVAL OF TERMS. Notwithstanding any expiration or termination of this Contract, all payment obligations incurred prior to expiration or termination will survive, as will the following: Articles 11 through 14 survive the expiration or cancellation of this Contract. All other rights will cease upon expiration or termination of this Contract.

2. EQUIPMENT, PRODUCTS, OR SERVICES

A. EQUIPMENT, PRODUCTS, OR SERVICES. Supplier will provide the Equipment, Products, or Services as stated in its Proposal submitted under the Solicitation Number listed above.

113021-SUT

Supplier's Equipment, Products, or Services Proposal (Proposal) is attached and incorporated into this Contract.

All Equipment and Products provided under this Contract must be new and the current model. Supplier may offer close-out, refurbished, or remounted Equipment or Products if they are clearly indicated in Supplier's product and pricing list. Unless agreed to by the Participating Entities in advance, Equipment or Products must be delivered as operational to the Participating Entity's site.

This Contract offers an indefinite quantity of sales, and while substantial volume is anticipated, sales and sales volume are not guaranteed.

B. **WARRANTY.** Supplier warrants that all Equipment, Products, and Services furnished are free from liens and encumbrances, and are free from defects in design, materials, and workmanship. In addition, Supplier warrants the Equipment, Products, and Services are suitable for and will perform in accordance with the ordinary use for which they are intended. Supplier's dealers and distributors must agree to assist the Participating Entity in reaching a resolution in any dispute over warranty terms with the manufacturer. Any manufacturer's warranty that extends beyond the expiration of the Supplier's warranty will be passed on to the Participating Entity.

C. **DEALERS, DISTRIBUTORS, AND/OR RESELLERS.** Upon Contract execution and throughout the Contract term, Supplier must provide to Sourcewell a current means to validate or authenticate Supplier's authorized dealers, distributors, or resellers relative to the Equipment, Products, and Services offered under this Contract, which will be incorporated into this Contract by reference. It is the Supplier's responsibility to ensure Sourcewell receives the most current information.

3. PRICING

All Equipment, Products, or Services under this Contract will be priced at or below the price stated in Supplier's Proposal.

When providing pricing quotes to Participating Entities, all pricing quoted must reflect a Participating Entity's total cost of acquisition. This means that the quoted cost is for delivered Equipment, Products, and Services that are operational for their intended purpose, and includes all costs to the Participating Entity's requested delivery location.

Regardless of the payment method chosen by the Participating Entity, the total cost associated with any purchase option of the Equipment, Products, or Services must always be disclosed in the pricing quote to the applicable Participating Entity at the time of purchase.

A. **SHIPPING AND SHIPPING COSTS.** All delivered Equipment and Products must be properly packaged. Damaged Equipment and Products may be rejected. If the damage is not readily



Start New Search

RY3HQFRV6QB5 SUTPHEN CORP Search

Results Filtered by: Clear All

Data last updated Apr 11, 2024

Vendor Results "RY3HQFRV6QB5 SUTPHEN CORP"

Showing 1-1 out of 1

Contract Vehicles	10	Contract Vehicle	Contract Number	Current Option Period End Date	Ultimate Contract End Date	Vendor Name and Website	Actions
Categories	—	MAS	GS30F0012Y	Jan 4, 2027	Jan 4, 2032	SUTPHEN CORP	Vendor Profile
Subcategories	Vendor Information SUTPHEN CORP b2gmke@wi.rr.com 6450 EITERMAN RD DUBLIN, OH ZIP UNKNOWN		Buyer Information Janet Lamb 202-329-9198 janet.lamb@gsa.gov				
Socioeconomic	NAICS Information 336120 Heavy duty truck manufacturing		SIN Information 3361 Law Enforcement and Fire Fighting Vehicles and Attachments 3361RC 3361 Law Enforcement and Fire Fighting Vehicles and Attachments				
Additional Filters							

1

Give Feedback

[Return to top](#)

Award Letter

U.S. Department of Homeland Security
Washington, D.C. 20472

Effective date: 07/13/2023

Ioana Armstrong
CITY OF FOREST PARK
745 FOREST PARKWAY
FOREST PARK, GA 30297

EMW-2022-FG-03757

Dear Ioana Armstrong,

Congratulations on behalf of the Department of Homeland Security. Your application submitted for the Fiscal Year (FY) 2022 Assistance to Firefighters Grant (AFG) Grant funding opportunity has been approved in the amount of \$500,000.00 in Federal funding. As a condition of this grant, you are required to contribute non-Federal funds equal to or greater than 10.0% of the Federal funds awarded, or \$50,000.00 for a total approved budget of \$550,000.00. Please see the FY 2022 AFG Notice of Funding Opportunity for information on how to meet this cost share requirement.

Before you request and receive any of the Federal funds awarded to you, you must establish acceptance of the award through the FEMA Grants Outcomes (FEMA GO) system. By accepting this award, you acknowledge that the terms of the following documents are incorporated into the terms of your award:

- Summary Award Memo - included in this document
- Agreement Articles - included in this document
- Obligating Document - included in this document
- 2022 AFG Notice of Funding Opportunity (NOFO) - incorporated by reference

Please make sure you read, understand, and maintain a copy of these documents in your official file for this award.

Sincerely,



PAMELA WILLIAMS
Assistant Administrator, Grant Programs



Object Class	Total
Personnel	\$0.00
Fringe benefits	\$0.00
Travel	\$0.00
Equipment	\$550,000.00
Supplies	\$0.00
Contractual	\$0.00
Construction	\$0.00
Other	\$0.00
Indirect charges	\$0.00
Federal	\$500,000.00
Non-federal	\$50,000.00
Total	\$550,000.00
Program Income	\$0.00

Approved scope of work

After review of your application, FEMA has approved the below scope of work. Justifications are provided for any differences between the scope of work in the original application and the approved scope of work under this award. You must submit scope or budget revision requests for FEMA's prior approval, via an amendment request, as appropriate per 2 C.F.R. § 200.308 and the FY2022 AFG NOFO.

Approved request details:

Vehicle acquisition

Obligating document

1. Agreement No. EMW-2022-FG-03757	2. Amendment No. N/A	3. Recipient No. 586002562	4. Type of Action AWARD	5. Control No. WX01191N2023T		
6. Recipient Name and Address CITY OF FOREST PARK 745 FOREST PKWY FOREST PARK, GA 30297		7. Issuing FEMA Office and Address Grant Programs Directorate 500 C Street, S.W. Washington DC, 20528-7000 1-866-927-5646		8. Payment Office and Address FEMA, Financial Services Branch 500 C Street, S.W., Room 723 Washington DC, 20742		
9. Name of Recipient Project Officer Ioana Armstrong		9a. Phone No. 4048253586	10. Name of FEMA Project Coordinator Assistance to Firefighters Grant Program		10a. Phone No. 1-866-274-0960	
11. Effective Date of This Action 07/13/2023	12. Method of Payment OTHER - FEMA GO	13. Assistance Arrangement COST SHARING		14. Performance Period 07/20/2023 to 07/19/2025 Budget Period 07/20/2023 to 07/19/2025		
15. Description of Action a. (Indicate funding data for awards or financial changes)						
Program Name Abbreviation	Assistance Listings No.	Accounting Data (ACCS Code)	Prior Total Award	Amount Awarded This Action + or (-)	Current Total Award	Cumulative Non-Federal Commitment
AFG	97.044	2023-F2-GB01 - P410-xxx-4101-D	\$0.00	\$500,000.00	\$500,000.00	\$50,000.00
Totals			\$0.00	\$500,000.00	\$500,000.00	\$50,000.00
b. To describe changes other than funding data or financial changes, attach schedule and check here: N/A						
16. FOR NON-DISASTER PROGRAMS: RECIPIENT IS REQUIRED TO SIGN AND RETURN THREE (3) COPIES OF THIS DOCUMENT TO FEMA (See Block 7 for address) This field is not applicable for digitally signed grant agreements						