

Application Form

Small Redevelopment District Grant Program

NAME: COBE MIKALICH
PROPERTY ADDRESS: 600 SOUTH CENTRAL AVE FLAGLER BEACH FL 32136 Own ☒ Lease ☐
MAILING ADDRESS: SAME
PROPERTY ID # (on taxes): 121231255000000050 CURRENT USE HOME
TELEPHONE: 407-257-4335 (DAY) SAME (EVENING)
EMAIL: COBEMIK & AOL.COM
TYPE OF IMPROVEMENT PLANNED: (Attach a written summary)

PROJECT PROPOSAL ON IMPROVEMENTS (Not all inclusive, see procedures and guidelines for full requirements)

- A written summary of the scope of work to be performed.
- Digital color photographs clearly showing existing conditions of the facade, neighboring buildings and public entrances.
- Site/Sketch plans and specifications detailing the scope of work that will be required at the time of application and will be further developed at the project review conference.
- Samples of all paint colors, signage and awnings materials to be used on the building (if applicable).
- An all inclusive estimate supporting project costs. At least two (2) estimates must be provided.

ESTIMATED TOTAL COST OF PROPOSED IMPROVEMENTS: \$ 11,160.00
GRANT APPLICATION MOUNT: \$ 870 75% COB

I UNDERSTAND THAT IN ORDER FOR MY REQUEST FOR GRANT FUNDING TO BE APPROVED, I MUST AGREE TO THE FOLLOWING CONDITIONS

- To follow the design recommendations as approved by the CRA Board and the City of Flagler Beach Ordinances. I further agree to maintain all improvements and not to alter the project for a period of three (3) years without approval from the CRA. Acknowledgement of notification COB
- To adhere to the Application Procedures and Guidelines and the Grant Agreement as specified.
Acknowledgement of notification COB
- That I shall incur all initial project costs and receive reimbursement only after:
 - All improvements have been completed.
 - Final inspections of the improvements are approved and accepted by the CRA and Building Official.
 - Proof of payment for project costs have been received and verified.
- Additional improvements or changes not approved will not be funded.
Acknowledgement of notification COB
- Grant awards will be based on lowest bid unless approved by the CRA Board.
Acknowledgement of notification COB
- Attendance at the CRA Board meeting when this application is reviewed is mandatory.
Acknowledgement of notification COB

I ACKNOWLEDGE THAT I HAVE RECEIVED AND UNDERSTAND THE DESIGN GUIDELINES, THE REDEVELOPMENT DISTRICT GRANT PROGRAM PROCEDURES AND THE GRANT AGREEMENT.

APPLICANT SIGNATURE COBE MIKALICH

DATE Feb 20 2024

Flagler Beach CRA Grant Fencing Replacement

randy SMITH <resmith2007@bellsouth.net>

Tue 2/20/2024 9:01 AM

To:randy SMITH <resmith2007@bellsouth.net>

Requesting CRA Grant funds to replace the existing 20-year-old picket fence along Central Ave. This fence is damaged and has been abused by passerby people over the years. It is a white 4' high picket fence which runs along Central Ave over 8 properties. Pricing includes removal and disposal of old fencing and replaced with new fencing which will be same white picket look with stainless steel hardware at the three gates.

Properties affected:

600 South Central Ave

602 South Central Ave

604 South Central Ave

606 South Central Ave

608 South Central Ave

610 South Central Ave

612 South Central Ave

614 South Central Ave.

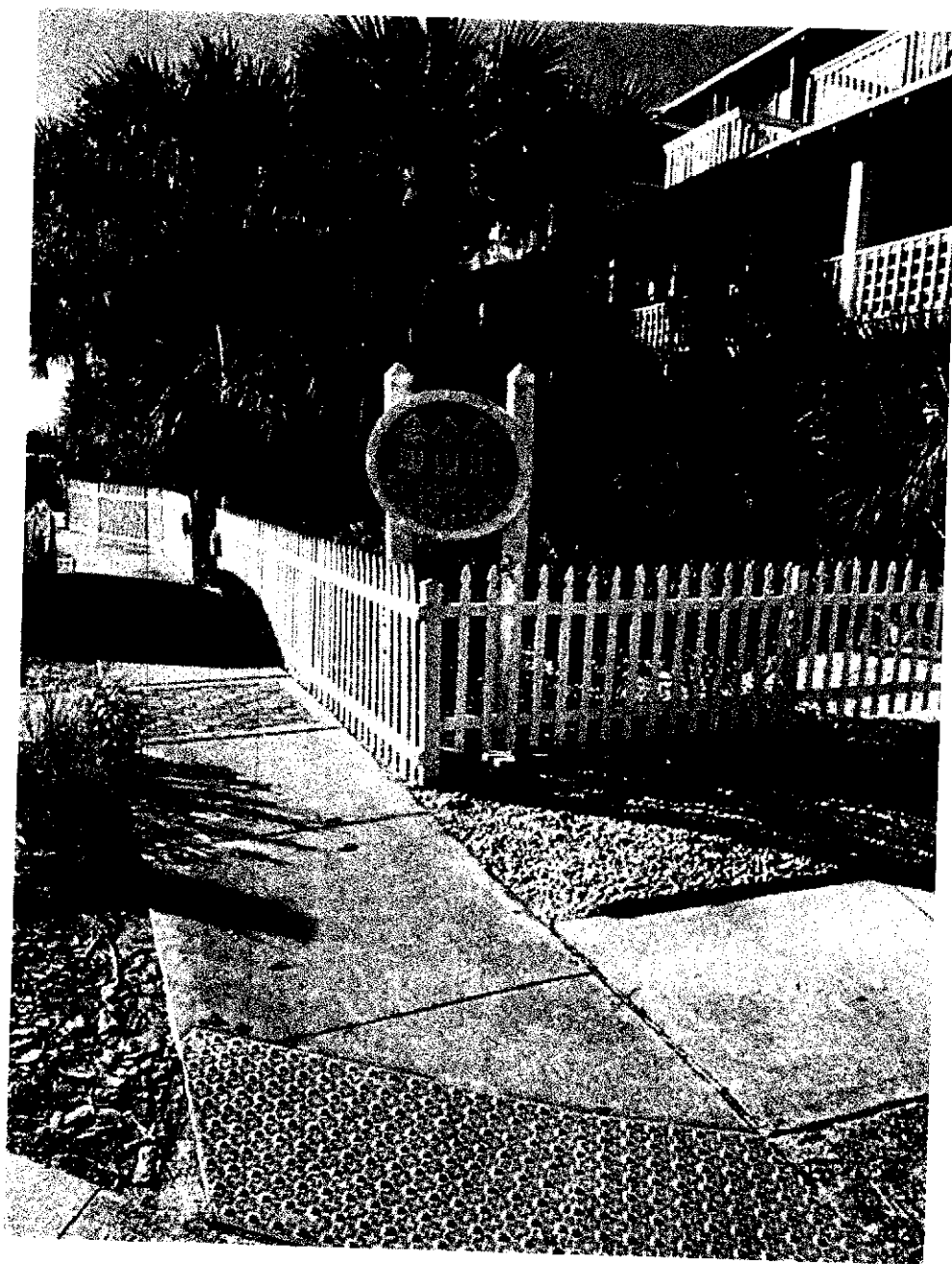



LEX FENCING INC.

Professional Fence Installation and Repairs.
Licensed & Insured

(386) 263 7888

Email: lexfencing@yahoo.com

Date: 3-1-24

ESTIMATE

Name: Randy Smith

Address: 610 S. Central Ave FB

Phone: 386-244-9222

Email: RESmith2007@bellsouth.net

Style of Fence: <u>Vinyl</u> Color: <u>White spear</u> Height: 3' 4' 5' 6' Number of Gates: <u>3</u> Gates: <input type="checkbox"/> Pool Code <input type="checkbox"/> Standard	<u>Top Picket fence</u> <div style="border: 1px solid black; width: 100px; height: 80px; margin: 20px auto; text-align: center; line-height: 80px;">HOUSE</div>	Underground Utilities <input type="checkbox"/> Irrigation <input type="checkbox"/> Electricity <input type="checkbox"/> Telephone <input type="checkbox"/> Water <input type="checkbox"/> Gas <input type="checkbox"/> Other ()
CAPS <input type="checkbox"/> Standard <input type="checkbox"/> New England <input type="checkbox"/> Gothic <input checked="" type="checkbox"/> Other (<u>11 Caps</u>)		Other tools <input type="checkbox"/> Core drill <input type="checkbox"/> Jack Hammer <input type="checkbox"/> Chain saw
OLD FENCE <input checked="" type="checkbox"/> Remove <input checked="" type="checkbox"/> Disposal <input type="checkbox"/> Leave at the job	OBSERVATIONS: 1000: 40' 1002: 28' 1004: 28' 1006: 23' w/gate 1008: 13' w/gate 1010: 20' 1012: 20' w/gate 1014: 50' Note: Each price includes Permit, and Removal and disposal	Gate Hardware <input checked="" type="checkbox"/> Standard <input type="checkbox"/> Upgrade (self-closing stainless steel hinges and lock latches with keys)
Property Grade <input type="checkbox"/> Follow the grade <input checked="" type="checkbox"/> Straight top Dirt:	1,462.80 204.54 1,023.94 241.11 475.41 950.82 731.90 1,828.50	INSTALLED PRICE: \$8,118.54 (Price includes taxes, materials, labor and permit)

- On vinyl fences, all virgin material with lifetime warranty. Price includes 120 lbs of concrete per post; 160 lbs of concrete and aluminum inserter on gate post.

Palm Coast Fencing Inc.

Professional Fence Installation & Repairs
Licensed & Insured 20 Years of Experience

(386)-346-1300 **Estimate**



Name: Randy Smith Date: 02/18/24
Address: 610 South Central Ave Flagler Beach
Phone: (386) 264-9222 Email: Rsmith2007@bellsouth.net

	Fence Style: <u>Vinyl (picket fence)</u> Color: <u>white</u> Height: 6' 5' <u>4</u> 3'
	Gates Quantity: <u>3</u> Pool Code <input type="checkbox"/> Caps Standard <input checked="" type="checkbox"/> Other: _____
Observations: <u>Install 223' of 4' high white Vinyl (picket fence) with 3 gates.</u> <u>* Removed and disposal of existing fence is included in the price.</u>	Old Fence Remove & Disposal <input checked="" type="checkbox"/> Remove & Leave on site <input type="checkbox"/> INSTALLED PRICE: <u>\$ 7,760.00</u> (Price includes taxes, materials, labor and permit)

PVC posts will be 30"-36" in the ground and 120 pounds of concrete will be used per post. Self-closing stainless steel hinges and lock latches with keys are included in the price. Stainless steel drop-rods for double gates are included. Lifetime warranty on material and 5 years on labor.

As soon as we have approval, planning can begin for this job. A down payment of 50% of the total price is required at the time of agreement contract signing. Remaining balance is due upon completion of job.

*Credit/debit card payments may be subject to a 3% merchant fee.

This estimate is valid for 15 days. After this period, you have the option to call and verify if the material price has changed.

\$1,425. ⁰⁰	\$980. ⁰⁰	\$815. ⁰⁰	\$874. ⁰⁰	\$980. ⁰⁰	\$895. ⁰⁰	\$630. ⁰⁰	\$1,160. ⁰⁰
614	612	610	608	606	604	602	600

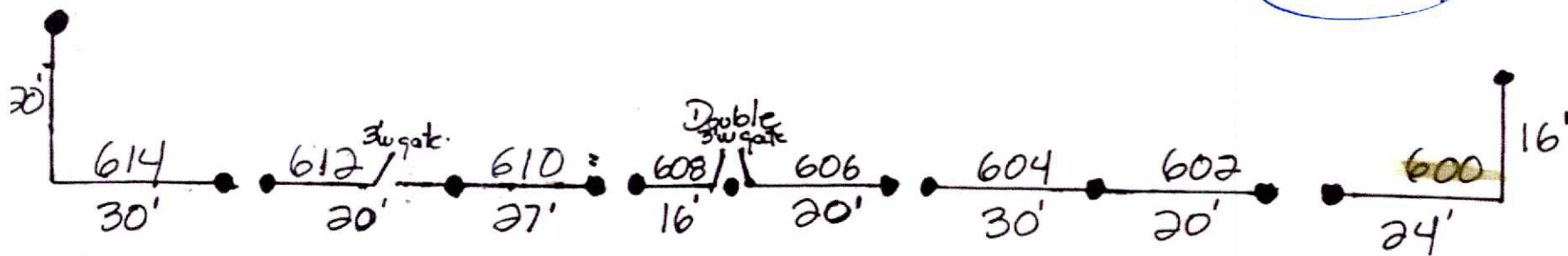

610 South Central Ave.

Randy Smith

(386) 264-9222.

email: Resmith2007@bellsouth.net.

Palm Coast Fencing Inc.



Style 1

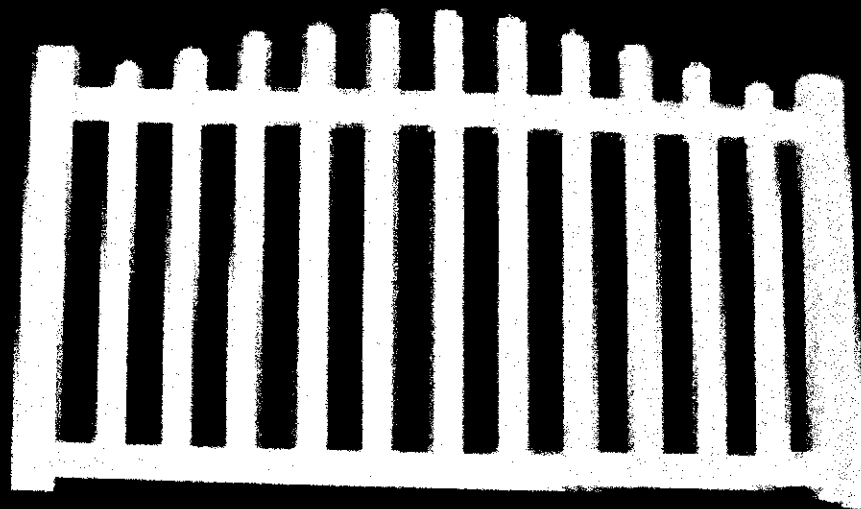

Style 2

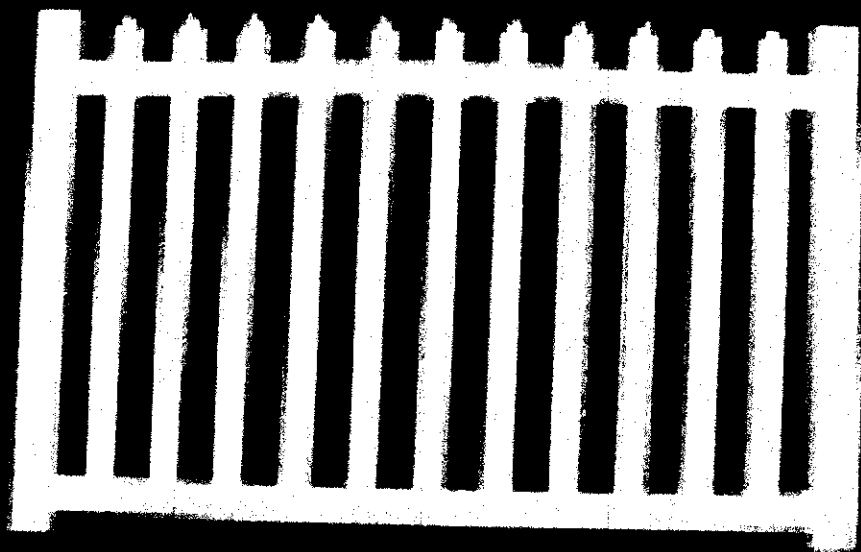

Style 3

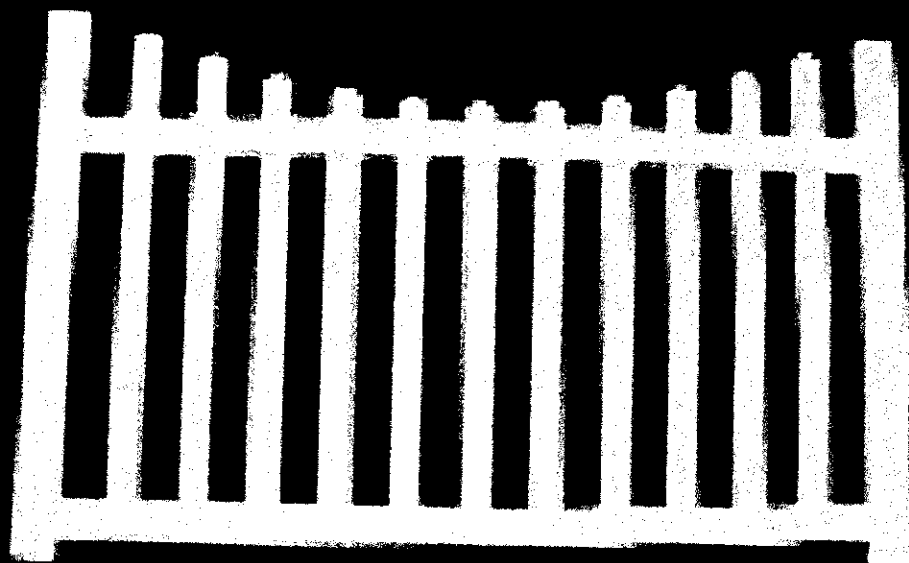

Style 4

PO BOX 530489
DEBARY, FL 32753-0489

VISA

MasterCard



OFFICE 386-789-1700

FAX 386-789-0796

www.davesfenceinc.com

INSTALLATION AND REPAIRS ON ALL TYPES OF FENCING

Proposal Submitted to: _____ Job Name: SAME Date: 2/13/2024

Street: 600 S CENTRAL AVE Job Location: SAME

City, State, and Zip: FLAGLER BCH FL 32136 Contact: _____

Phone: _____ Bus. Phone: _____ Cell: _____ Fax: _____

We Hereby Submit Specifications and Estimate For:

FURNISH AND INSTALL APPROXIMATELY 38' OF 3' HIGH PVC PICKET FENCE.

INCLUDES 0 GATE WITH ALUMINUM I BEAMS IN HINGE AND LATCH POST. ALL POSTS SET IN CONCRETE

INCLUDES LIFETIME GATE ADJUSTMENTS @ NO CHARGE.

PVC Vinyl PICKET	Aluminum	Wood	Chain Link
Style MCKINLEY	Style	Style	Gal Black Green
Height 3'	Height	Height	Height
Color WHITE	Color	Picks	Resid LghtCom Comm
Post 8'o/c 5"X5"X9'	Grade	Runners	Terminals
Caps FLAT	Caps	Post	Line Post
Walk Gate N/A	Walk Gate	Gate Post	Top Rail
Walk Gate N/A	Double Gate	Walk Gate	Fabric
DOUBLE GATE N/A	Picket Spacing	Gate	Bottom T-wire
Please Read: Wood fence has a 20 year manufacturer warranty against rot, decay, and termites. Warranty does not cover warping, splitting or cracking of any portion of the wood fence. Dave's fence recommends applying a water proofing sealant to help reduce cosmetic flaws in wood products.			Walk Gate
			Double Gate
			Gate
			Locate #

GENERAL INSTALLATION INFORMATION

Permit- DAVES	Clearing N/A	Cust Initial Drawing YES
Survey W/ PAPER WORK	Take Down 38'	Grade Changes YES
Cross St 7TH ST	Haul Away YES	Severity MINOR
HOA APPROVAL-- N/A	Open Pool NO	Location of Grade N/A
N.O.C. DAVES	Dog/SIZE NO N/A	Fence Straight on top NO
Requested Installation Date: _____		Fence Contour to ground YES
<p>All material is guaranteed to be specified. All work to be completed in substantial workmanlike manner according to specifications submitted per standard practices. Any alteration or deviation from above specifications involving extra costs will be executed only upon written orders, and will become an extra charge over and above the estimate. All materials remain the property of Dave's Fence until contract is paid in full. Right of access and removal is hereby granted in the event of non payment as agreed. Not responsible for damage to underground lines that cannot be located.</p> <p>According to Florida's construction Lien Law (sections 713.001-713.37, Florida statutes), those who work on your property or provide materials and are not paid in full have a right to enforce their claim for payment against your property. This claim is known as a construction lien. If your contractor or a subcontractor fails to pay subcontractors or material suppliers or neglects to make other legally required payments, the people who are owed money may look to your property for payment, even if you have paid your contract in full. If you fail to pay your contractor, your contractor may also have a lien on your property. This means if a lien is filed your property could be sold against your will to pay for labor, materials, or other services that your contractor or a subcontractor may have failed to pay. To protect yourself, you should stipulate in this contract that before any payment is made your contractor is required to provide you with a written release of lien from any person or company that has provided to you a "notice to owner." Florida's construction lien law is complex and it is recommended that, whenever a specific problem arises, you consult an attorney.</p>		Estimated Installation Date 4 TO 12 WKS
		Base Price \$1,800
		Permit + \$200
		N.O.C +
		Total Price = \$2,000

Retainer \$1,000

Balance due upon completion: \$1,000

Once proposal is accepted by Dave's Fence the proposal becomes a binding contract and is not subject to cancellation. Initials _____

This proposal may be withdrawn by Dave's Fence if not accepted within 21 days.

Company Representative:

SCOTT 386-232-9200

scottb.davesfence@gmail.com

Acceptance of proposal- The above prices, specifications and conditions are satisfactory and are hereby accepted. You are authorized to do the work specified. Payment will be made as outlined above.

SIGNATURE _____ Date: _____

SIGNATURE _____ Date: _____

7/8" x 3" PICKET ON 3" SPACING 11 PICKETS PER SECTION 2"X3.5" RAILS
60" & 72" HIGH SECTIONS HAVE A MID-RAIL, OPEN TOP STYLES HAVE POINTED PICKET CAPS

STYLE #1

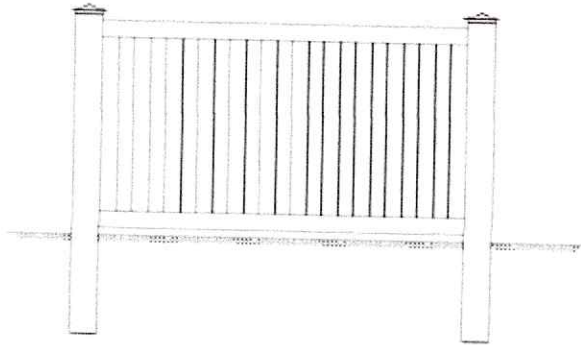

STYLE #2

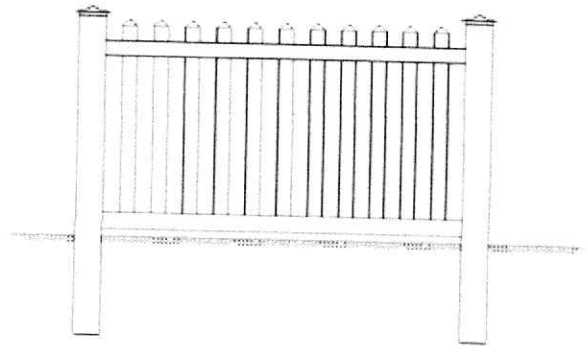

STYLE #3

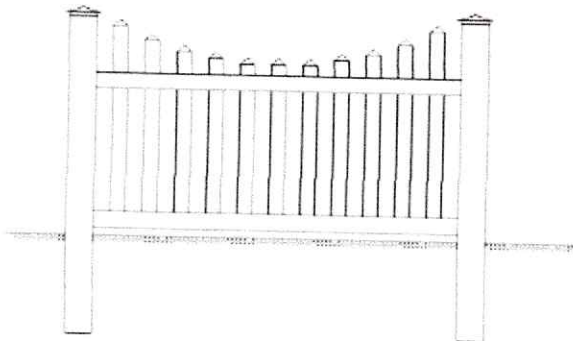

STYLE #4

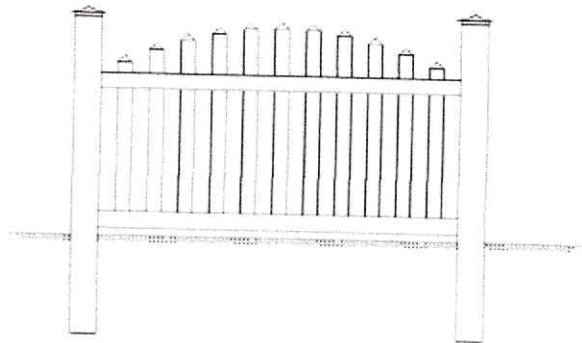

Merchants Metals
the first name in fence solutions

4921 Joanne Kearney Blvd
Tampa, FL 33619
813-980-0938

Application Form

Small Redevelopment District Grant Program

NAME: SILVIO DIBREGORIO Own ☒ Lease ☐
PROPERTY ADDRESS: 602 SOUTH CENTRAL AVE FLAGLER BEACH FL 32136
MAILING ADDRESS: PO BOX 96 FLAGLER BEACH FL 32136
PROPERTY ID # (on taxes) 12-12-31-2550-0000-0060 CURRENT USE HOME
TELEPHONE: 386-338-2493 (DAY) SAME (EVENING)
EMAIL: SD60NLINE@AOL.COM
TYPE OF IMPROVEMENT PLANNED: (Attach a written summary)

PROJECT PROPOSAL ON IMPROVEMENTS (Not all inclusive, see procedures and guidelines for full requirements)

- A written summary of the scope of work to be performed.
- Digital color photographs clearly showing existing conditions of the facade, neighboring buildings and public entrances
- Site/Sketch plans and specifications detailing the scope of work that will be required at the time of application and will be further developed at the project review conference.
- Samples of all paint colors, signage and awnings materials to be used on the building.(if applicable)
- An all inclusive estimate supporting project costs. At least two (2) estimates must be provided.

ESTIMATED TOTAL COST OF PROPOSED IMPROVEMENTS: \$ 630.00 # 630
GRANT APPLICATION MOUNT: \$ 630.00

I UNDERSTAND THAT IN ORDER FOR MY REQUEST FOR GRANT FUNDING TO BE APPROVED, I MUST AGREE TO THE FOLLOWING CONDITIONS:

- To follow the design recommendations as approved by the CRA Board and the City of Flagler Beach Ordinances. I further agree to maintain all improvements and not to alter the project for a period of three (3) years without approval from the CRA. Acknowledgement of notification [initials]
- To adhere to the Application Procedures and Guidelines and the Grant Agreement as specified. Acknowledgement of notification [initials]
- That I shall incur all initial project costs and receive reimbursement only after:
 - All improvements have been completed.
 - Final inspections of the improvements are approved and accepted by the CRA and Building Official.
 - Proof of payment for project costs have been received and verified.
- Additional improvements or changes not approved will not be funded. Acknowledgement of notification [initials]
- Grant awards will be based on lowest bid unless approved by the CRA Board. Acknowledgement of notification [initials]
- Attendance at the CRA Board meeting when this application is reviewed is mandatory. Acknowledgement of notification [initials]

I ACKNOWLEDGE THAT I HAVE RECEIVED AND UNDERSTAND THE DESIGN GUIDELINES, THE REDEVELOPMENT DISTRICT GRANT PROGRAM PROCEDURES AND THE GRANT AGREEMENT.

APPLICANT SIGNATURE [signature]

DATE 2/20/24

Flagler Beach CRA Grant Fencing Replacement

randy SMITH <resmith2007@bellsouth.net>

Tue 2/20/2024 9:01 AM

To:randy SMITH <resmith2007@bellsouth.net>

Requesting CRA Grant funds to replace the existing 20-year-old picket fence along Central Ave. This fence is damaged and has been abused by passerby people over the years. It is a white 4' high picket fence which runs along Central Ave over 8 properties. Pricing includes removal and disposal of old fencing and replaced with new fencing which will be same white picket look with stainless steel hardware at the three gates.

Properties affected:

600 South Central Ave

602 South Central Ave

604 South Central Ave

606 South Central Ave

608 South Central Ave

610 South Central Ave

612 South Central Ave

614 South Central Ave.

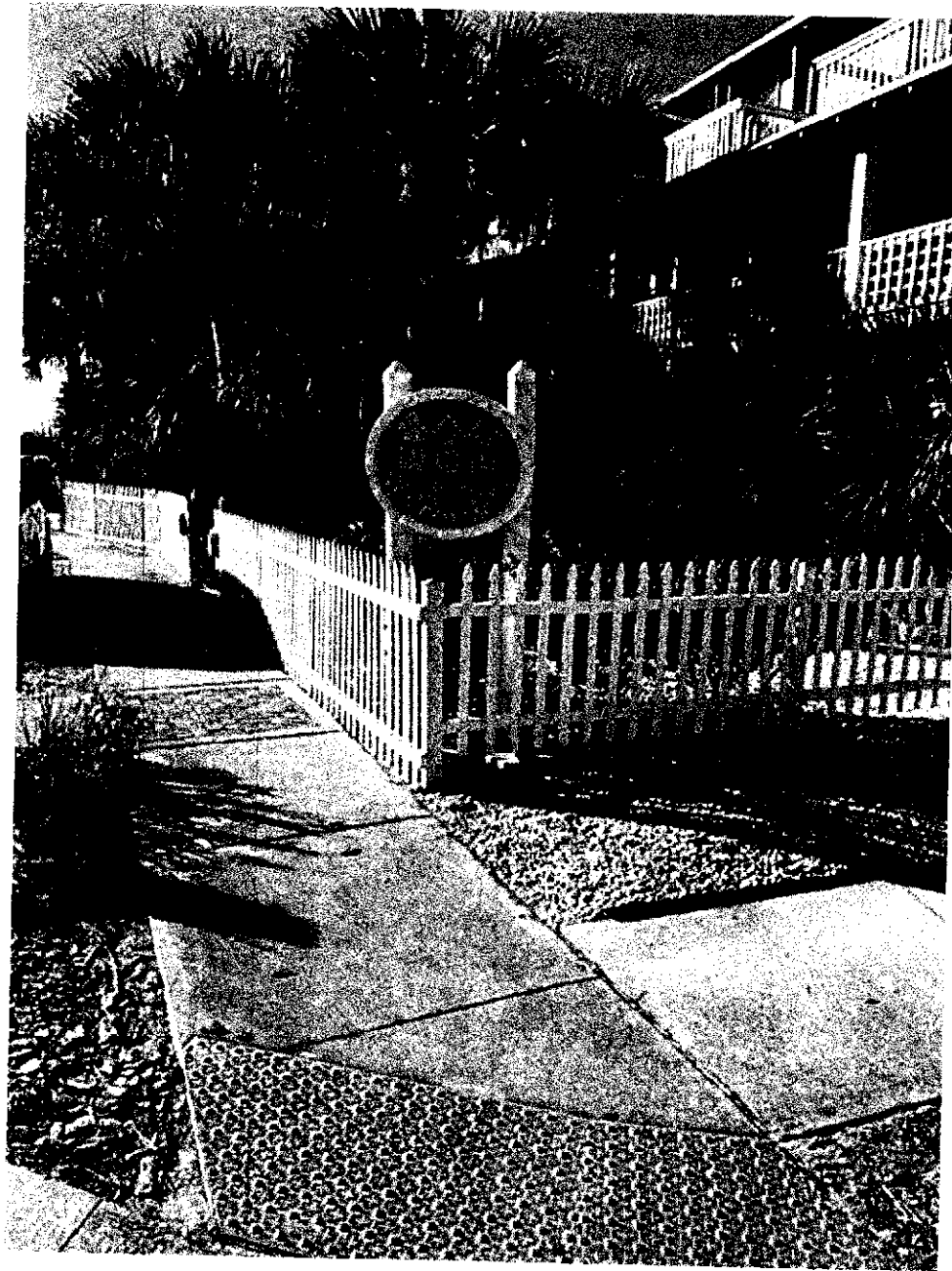

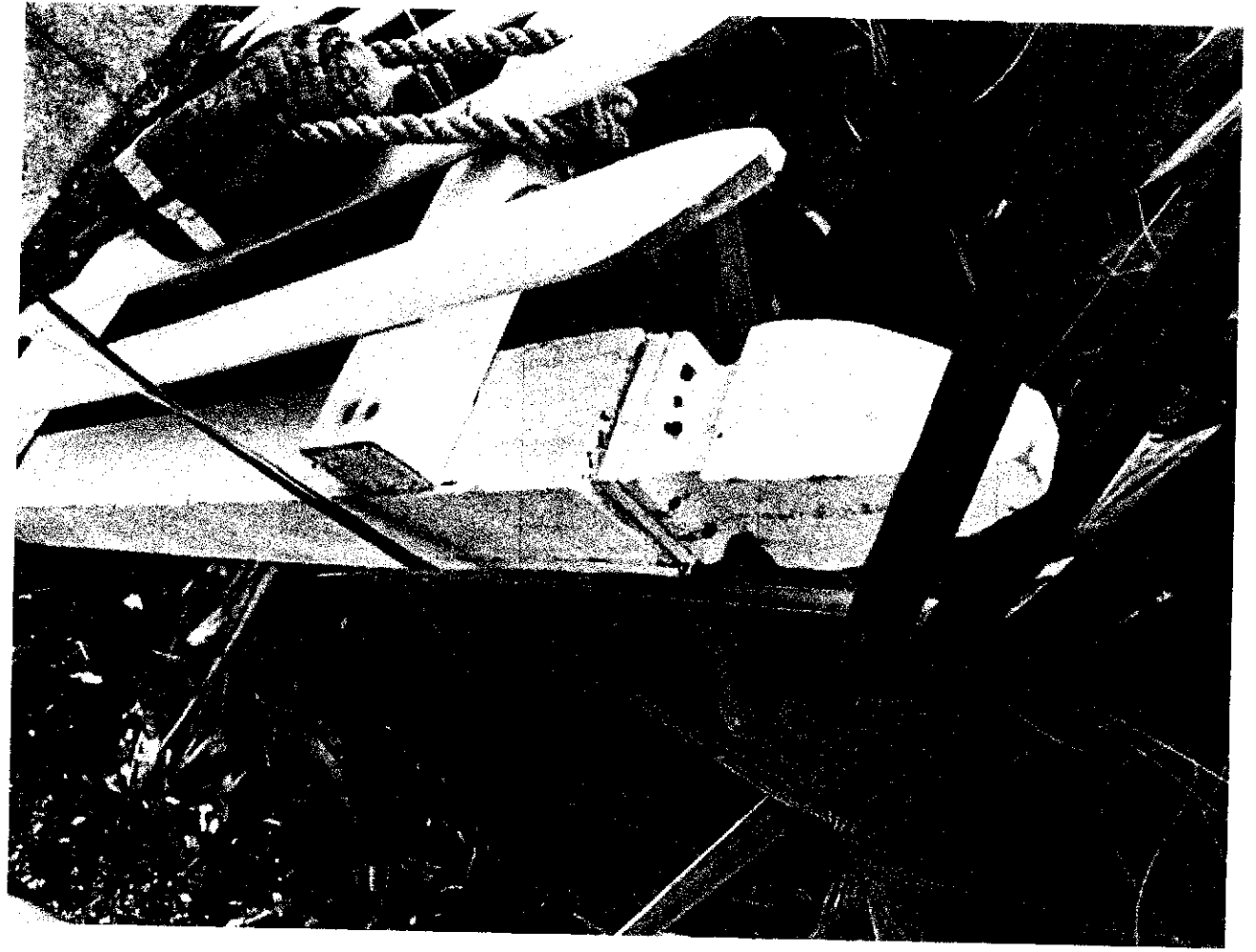

Palm Coast Fencing Inc.

Professional Fence Installation & Repairs
Licensed & Insured 20 Years of Experience

(386)-346-1300 **Estimate**



602

Name: Randy Smith Date: 02/18/24
Address: 610 South Central Ave Flagler Beach.
Phone: (386) 264-9222 Email: resmith2007@bellsouth.net

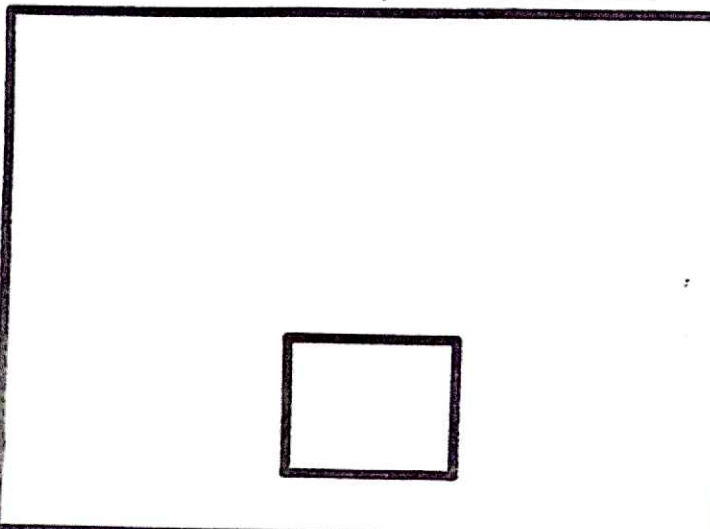

Fence
Style: Vinyl (picket fence).

Color: white

Height: 6' 5' 4 3'

Gates
Quantity: 3

Pool Code ☐

Caps
Standard ☒

Other: _____

Old Fence

Remove & Disposal ☒

Remove & Leave on site ☐

INSTALLED PRICE:

\$ 7,760.00

(Price includes taxes, materials, labor and permit)

Observations:

Install 223' of 4' high
white Vinyl (picket fence)
with 3 gates.

* Removed and disposal of
existing fence is included
in the price.

PVC posts will be 30"-36" in the ground and 120 pounds of concrete will be used per post. Self-closing stainless steel hinges and lock latches with keys are included in the price. Stainless steel drop-rods for double gates are included. Lifetime warranty on material and 5 years on labor.

As soon as we have approval, planning can begin for this job. A down payment of 50% of the total price is required at the time of agreement contract signing. Remaining balance is due upon completion of job.

*Credit/debit card payments may be subject to a 3% merchant fee.

This estimate is valid for 15 days. After this period, you have the option to call and verify if the material price has changed.

#1,425. ⁰⁰	#980. ⁰⁰	#815. ⁰⁰	#874. ⁰⁰	#980. ⁰⁰	#895. ⁰⁰	#630. ⁰⁰	#1,160. ⁰⁰
614	612	610	608	606	604	602	600.

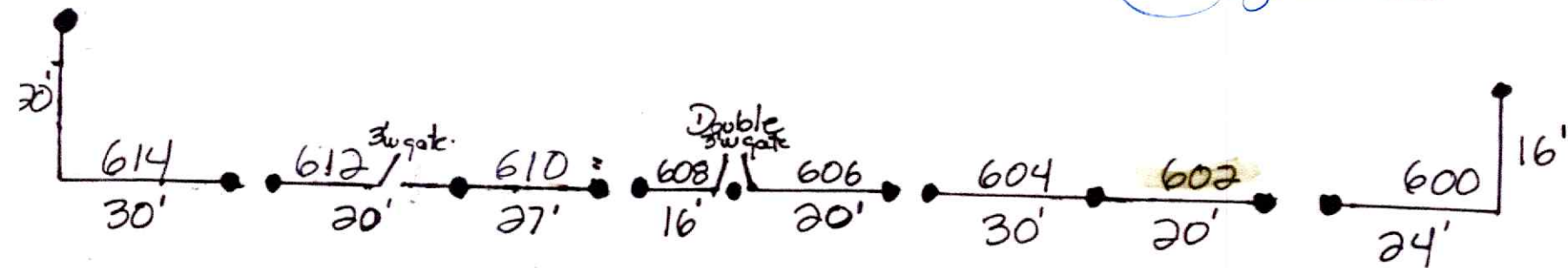

610 South Central Ave.

Randy Smith

(386) 264-9222.

email: Resmith2007@bellsouth.net.

Palm Coast Fencing Inc.

Scanned with CamScanner

LEX FENCING INC.

Professional Fence Installation and Repairs.
Licensed & Insured

(386) 263 7888

Email: lexfencing@yahoo.com

Date: 3-1-24

ESTIMATE

Name: Randy Smith

Address: 610 S. Central Ave FB

Phone: 386-244-9222

RESmith2007@
Email: bellsouth.net

Style of Fence: <u>Vinyl</u> Color: <u>White spear</u> Height: 3' 4' 5' 6' Number of Gates: <u>3</u> Gates: <input type="checkbox"/> Pool Code <input type="checkbox"/> Standard	<u>Top Picket fence</u> <div style="border: 1px solid black; width: 100px; height: 80px; margin: 20px auto; text-align: center; line-height: 80px;">HOUSE</div>	Underground Utilities <input type="checkbox"/> Irrigation <input type="checkbox"/> Electricity <input type="checkbox"/> Telephone <input type="checkbox"/> Water <input type="checkbox"/> Gas <input type="checkbox"/> Other ()																		
CAPS <input type="checkbox"/> Standard <input type="checkbox"/> New England <input type="checkbox"/> Gothic <input checked="" type="checkbox"/> Other (<u>11 Caps</u>)	Other tools <input type="checkbox"/> Core drill <input type="checkbox"/> Jack Hammer <input type="checkbox"/> Chain saw	Gate Hardware <input checked="" type="checkbox"/> Standard <input type="checkbox"/> Upgrade (self-closing stainless steel hinges and lock latches with keys)																		
OLD FENCE <input checked="" type="checkbox"/> Remove <input checked="" type="checkbox"/> Disposal <input type="checkbox"/> Leave at the job	OBSERVATIONS: <table border="0"> <tr> <td>1000: 40'</td> <td></td> </tr> <tr> <td>1002: 22'</td> <td>1,462.20</td> </tr> <tr> <td>1004: 28'</td> <td>204.54</td> </tr> <tr> <td>1006: 23' w/gate</td> <td>1,023.96</td> </tr> <tr> <td>1008: 13' w/gate</td> <td>241.11</td> </tr> <tr> <td>1010: 20'</td> <td>425.41</td> </tr> <tr> <td>1012: 20' w/gate</td> <td>950.82</td> </tr> <tr> <td>1014: 50'</td> <td>731.90</td> </tr> <tr> <td></td> <td>1,828.50</td> </tr> </table>	1000: 40'		1002: 22'	1,462.20	1004: 28'	204.54	1006: 23' w/gate	1,023.96	1008: 13' w/gate	241.11	1010: 20'	425.41	1012: 20' w/gate	950.82	1014: 50'	731.90		1,828.50	INSTALLED PRICE: \$8,118.54 (Price includes taxes, materials, labor and permit)
1000: 40'																				
1002: 22'	1,462.20																			
1004: 28'	204.54																			
1006: 23' w/gate	1,023.96																			
1008: 13' w/gate	241.11																			
1010: 20'	425.41																			
1012: 20' w/gate	950.82																			
1014: 50'	731.90																			
	1,828.50																			
Property Grade <input type="checkbox"/> Follow the grade <input checked="" type="checkbox"/> Straight top	Note: Each price includes Permit and Removal and disposal																			

- On vinyl fences, all virgin material with lifetime warranty. Price includes 120 lbs of concrete per post; 160 lbs of concrete and aluminum inserter on gate post.

PO BOX 530489
DEBARY, FL 32753-0489

VISA

MasterCard

AMERICAN EXPRESS



OFFICE 386-789-1700

FAX 386-789-0796

www.davesfenceinc.com

INSTALLATION AND REPAIRS ON ALL TYPES OF FENCING

Proposal Submitted to : _____ Job Name: SAME Date: 2/13/2024
Street: 602 S CENTRAL AVE Job Location: SAME
City, State, and Zip: FLAGLER BCH FL 32136 Contact: _____
Phone: _____ Bus. Phone: _____ Cell: _____ Fax: _____

We Hereby Submit Specifications and Estimate For:

FURNISH AND INSTALL APPROXIMATELY 22' OF 3' HIGH PVC PICKET FENCE.

INCLUDES 0 GATE WITH ALUMINUM I BEAMS IN HINGE AND LATCH POST. ALL POSTS SET IN CONCRETE

INCLUDES LIFETIME GATE ADJUSTMENTS @ NO CHARGE.

PVC Vinyl PICKET	Aluminum	Wood	Chain Link
Style MCKINLEY	Style	Style	Gal Black Green
Height 3'	Height	Height	Height
Color WHITE	Color	Picks	Resid LghtCom Comm
Post 8'o/c 5"X5"X9'	Grade	Runners	Terminals
Caps FLAT	Caps	Post	Line Post
Walk Gate N/A	Walk Gate	Gate Post	Top Rail
Walk Gate N/A	Double Gate	Walk Gate	Fabric
DOUBLE GATE N/A	Picket Spacing	Gate	Bottom T-wire
Please Read: Wood fence has a 20 year manufacturer warranty against rot, decay, and termites. Warranty does not cover warping, splitting or cracking of any portion of the wood fence. Dave's fence recommends applying a water proofing sealant to help reduce cosmetic flaws in wood products.			Walk Gate
			Double Gate
			Gate
			Locate #

GENERAL INSTALLATION INFORMATION

Permit- DAVES	Clearing N/A	Cust Initial Drawing YES
Survey W/ PAPER WORK	Take Down 22'	Grade Changes YES
Cross St 7TH ST	Haul Away YES	Severity MINOR
HOA APPROVAL-- N/A	Open Pool NO	Location of Grade N/A
N.O.C. DAVES	Dog/SIZE NO N/A	Fence Straight on top NO
		Fence Contour to ground YES

Requested Installation Date: _____

All material is guaranteed to be specified. All work to be completed in substantial workmanlike manner according to specifications submitted per standard practices. Any alteration or deviation from above specifications involving extra costs will be executed only upon written orders, and will become an extra charge over and above the estimate. All materials remain the property of Dave's Fence until contract is paid in full. Right of access and removal is hereby granted in the event of non payment as agreed. Not responsible for damage to underground lines that cannot be located.

According to Florida's construction Lien Law (sections 713.001-713.37, Florida statutes), those who work on your property or provide materials and are not paid in full have a right to enforce their claim for payment against your property. This claim is known as a construction lien. If your contractor or a subcontractor fails to pay subcontractors or material suppliers or neglects to make other legally required payments, the people who are owed money may look to your property for payment, even if you have paid your contract in full. If you fail to pay your contractor, your contractor may also have a lien on your property. This means if a lien is filed your property could be sold against your will to pay for labor, materials, or other services that your contractor or a subcontractor may have failed to pay. To protect yourself, you should stipulate in this contract that before any payment is made your contractor is required to provide you with a written release of lien from any person or company that has provided to you a "notice to owner." Florida's construction lien law is complex and it is recommended that, whenever a specific problem arises, you consult an attorney.

Acceptance of proposal- The above prices, specifications and conditions are satisfactory and are hereby accepted. You are authorized to do the work specified. Payment will be made as outlined above.

SIGNATURE _____ Date: _____
SIGNATURE _____ Date: _____

Estimated Installation Date	4 TO 12 WKS
Base Price	\$1,200
Permit +	\$200
N.O.C +	
Total Price =	\$1,400

Retainer \$700

Balance due upon completion: \$700

Once proposal is accepted by Dave's Fence the proposal becomes a binding contract and is not subject to cancellation. Initials _____

This proposal may be withdrawn by Dave's Fence if not accepted within 21 days.

Company Representative:

SCOTT 386-232-9200

scottb.davesfence@gmail.com

Application Form

Small Redevelopment District Grant Program

NAME JAMES NI
PROPERTY ADDRESS: 604 SOUTH CENTRAL AVE Own FL 32136
MAILING ADDRESS: 3054 ROBERT HAWES DR Lease FL 32186
PROPERTY ID # (on taxes) 121231255000000070
TELEPHONE: 107-252-0980 (DAY) SOME (EVENING)
EMAIL: JAMES.NI@GMAIL.COM
TYPE OF IMPROVEMENT PLANNED: (Attach a written summary)

PROJECT PROPOSAL ON IMPROVEMENTS (Not all inclusive, see procedures and guidelines for full requirements)

- A written summary of the scope of work to be performed.
- Digital color photographs clearly showing existing conditions of the facade, neighboring buildings and public entrances.
- Site Sketch plans and specifications detailing the scope of work that will be required at the time of application and will be further developed at the project review conference.
- Samples of all paint colors, signage and awnings materials to be used on the building, (if applicable)
- An all inclusive estimate supporting project costs. At least two (2) estimates must be provided.

ESTIMATED TOTAL COST OF PROPOSED IMPROVEMENTS: \$ 895.00
GRANT APPLICATION MOUNT: \$ 895.00

I UNDERSTAND THAT IN ORDER FOR MY REQUEST FOR GRANT FUNDING TO BE APPROVED, I MUST AGREE TO THE FOLLOWING CONDITIONS:

- To follow the design recommendations as approved by the CRA Board and the City of Flagler Beach Ordinances. I further agree to maintain all improvements and not to alter the project for a period of three (3) years without approval from the CRA. Acknowledgement of notification JN
- To adhere to the Application Procedures and Guidelines and the Grant Agreement as specified.
Acknowledgement of notification JN
- That I shall incur all initial project costs and receive reimbursement only after:
 - All improvements have been completed.
 - Final inspections of the improvements are approved and accepted by the CRA and Building Official.
 - Proof of payment for project costs have been received and verified.
- Additional improvements or changes not approved will not be funded.
Acknowledgement of notification JN
- Grant awards will be based on lowest bid unless approved by the CRA Board.
Acknowledgement of notification JN
- Attendance at the CRA Board meeting when this application is reviewed is mandatory.
Acknowledgement of notification JN

I ACKNOWLEDGE THAT I HAVE RECEIVED AND UNDERSTAND THE DESIGN GUIDELINES, THE REDEVELOPMENT DISTRICT GRANT PROGRAM PROCEDURES AND THE GRANT AGREEMENT.

APPLICANT SIGNATURE [Signature]

DATE 2-20-2024

Flagler Beach CRA Grant Fencing Replacement

randy SMITH <resmith2007@bellsouth.net>

Tue 2/20/2024 9:01 AM

To:randy SMITH <resmith2007@bellsouth.net>

Requesting CRA Grant funds to replace the existing 20-year-old picket fence along Central Ave. This fence is damaged and has been abused by passerby people over the years. It is a white 4' high picket fence which runs along Central Ave over 8 properties. Pricing includes removal and disposal of old fencing and replaced with new fencing which will be same white picket look with stainless steel hardware at the three gates.

Properties affected:

600 South Central Ave

602 South Central Ave

604 South Central Ave

606 South Central Ave

608 South Central Ave

610 South Central Ave

612 South Central Ave

614 South Central Ave.

~~DEMEGLIO~~

Безопасно

1. COMMONWEALTH LAND TITLE INSURANCE COMPANY
2. FLAGLER COUNTY ABSTRACT COMPANY
3. GEORGE V. DEMEGLIO Lot 4
4. PHH MORTGAGE SERVICES

Scale: 1" = 20'

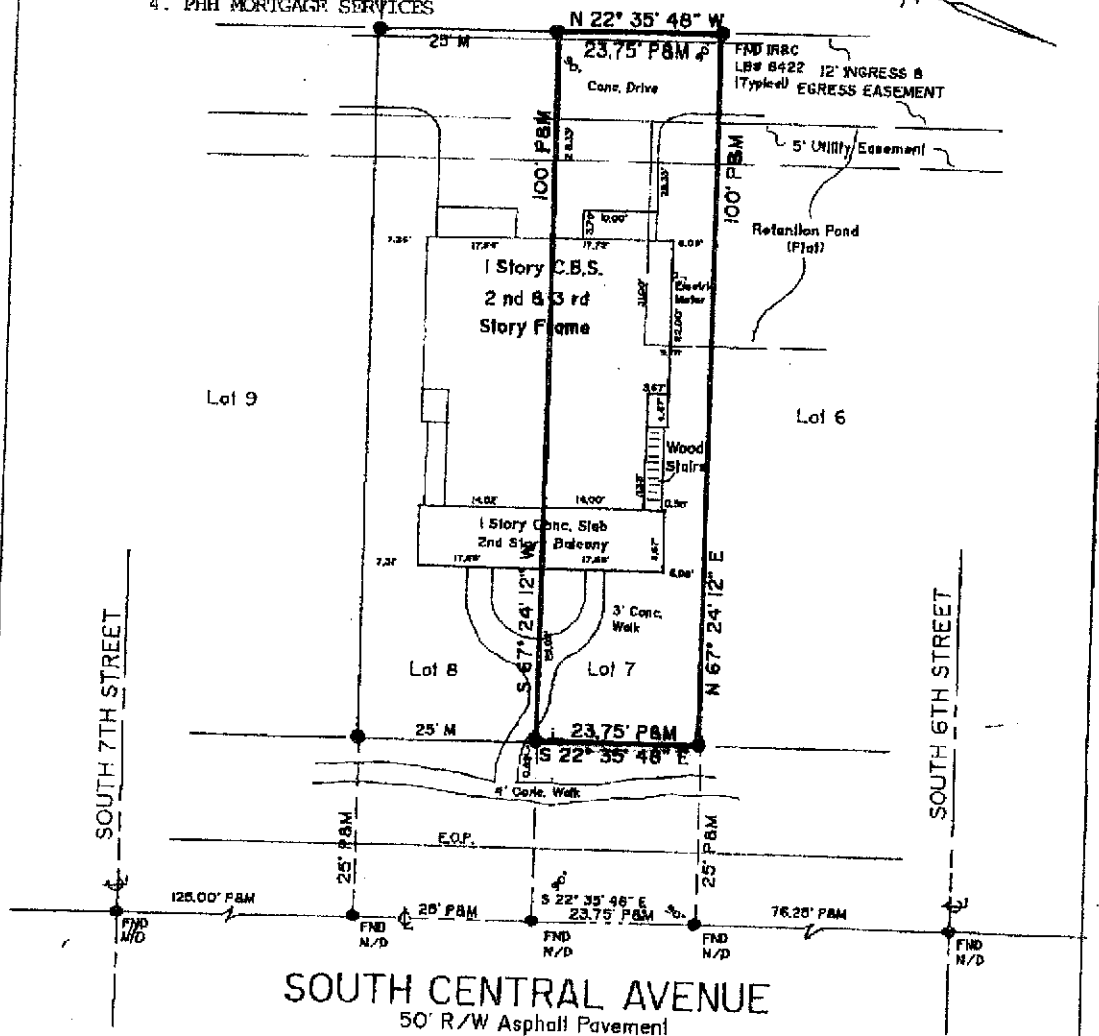

Lot 7, FLAGLER SEA COTTAGES; a subdivision as recorded in Map Book 31, Page 40; Public Records of Flagler County, Florida.

NOTES: 1. Description provided by client.

2. Bearings refer to plat data and to the center line of South Central Avenue as being S.22°35'48"E.
3. Property lies in Flood Zone "C", as shown on Flood Insurance Rate Map (FIRM), Community Panel Number 120087 0002 B, Effective Date: May 15, 1985.

, Page 40;

LEGEND: ● Iron Rod Found ○ Iron Rod Set ■ Concrete Monument Found □ Concrete Monument Set C/L - Center Line R/W - Right of Way E.O.P. - Edge of Pavement I.P. - Iron Pipe L.S. - Licensed Surveyor L.B. - Licensed Business	P.C.P. - Permanent Control Point P.R.M. - Permanent Reference Monument N.O. - Nail and Disk B.M. - Bench Mark T.B.M. - Temporary Bench Mark P.C. - Point of Curvature P.P. - Power Pole M.H. - Man Hole W.M. - Water Meter CONC. - Concrete C.B.S. Concrete Block & Stucco	Δ - Delta R. - Radius L. - Length CH. - Chord C.B. - Chord Bearing TAN - Tangent N.G.V.D. - National Geodetic Vertical Datum C.C.C.L - Coastal Construction Control Line M.S.L. - Mean Sea Level M.H.W. - Mean High Water MEAS. - Measure	P. Plat D. Deed O/E - Overhead Electric O.R. - Official Records Book & Page P.O.R. - Point of Reference P.O.B. - Point of Beginning P.T. - Point of Tangency P.R.C. - Point of Reverse Curve P.C.C. - Point of Compound Curve P.S.I. - Point of Street Intersection
BOUNDARY SURVEY FOR FT. LAUDERDALE COUNTY ABSTRACT COMPANY P.O. BOX 398 BUNNELL, FL. 32110		STEPHENSON SURVEYING, INC. (LB #6422) 204 N. Railroad St. • P.O. Box 1836 • Bunnell, FL. 32110 Bunnell 904/437-2363 • Daytona Beach 904/252-4725	
Job No. 01-4111		Date of last field work 7/21/01	
REVISED:		DAN A. WILCOX, Reg. Fla. Land Surveyor No. 2238 <i>(Signature)</i> Not valid without the signature and the original raised seal of a Florida licensed surveyor and member	





Palm Coast Fencing Inc.

Professional Fence Installation & Repairs
Licensed & Insured 20 Years of Experience

(386)-346-1300 **Estimate**



Name: Randy Smith Date: 02/18/24
Address: 610 South Central Ave Flagler Beach.
Phone: (386) 264-9222 Email: Rsmith2007@bellsouth.net

	Fence Style: <u>Vinyl (picket fence).</u> Color: <u>white</u> Height: 6' 5' <u>(4)</u> 3'
	Gates Quantity: <u>3</u> Pool Code <input type="checkbox"/> Caps Standard <input checked="" type="checkbox"/> Other: _____
Observations: <u>Install 223' or 4' high</u> <u>white Vinyl (picket fence)</u> <u>with 3 gates.</u> <u>* Removed and disposal of</u> <u>existing fence is included</u> <u>in the price.</u>	Old Fence Remove & Disposal <input checked="" type="checkbox"/> Remove & Leave on site <input type="checkbox"/> INSTALLED PRICE: <u>\$ 7,760.00</u> (Price includes taxes, materials, labor and permit)

PVC posts will be 30"-36" in the ground and 120 pounds of concrete will be used per post. Self-closing stainless steel hinges and lock latches with keys are included in the price. Stainless steel drop-rods for double gates are included. Lifetime warranty on material and 5 years on labor.

As soon as we have approval, planning can begin for this job. A down payment of 50% of the total price is required at the time of agreement contract signing. Remaining balance is due upon completion of job.

*Credit/debit card payments may be subject to a 3% merchant fee.

This estimate is valid for 15 days. After this period, you have the option to call and verify if the material price has changed.

\$1,425. ⁰⁰	\$980. ⁰⁰	\$815. ⁰⁰	\$874. ⁰⁰	\$980. ⁰⁰	\$895. ⁰⁰	\$630. ⁰⁰	\$1,160. ⁰⁰
614	612	610	608	606	604	602	600.

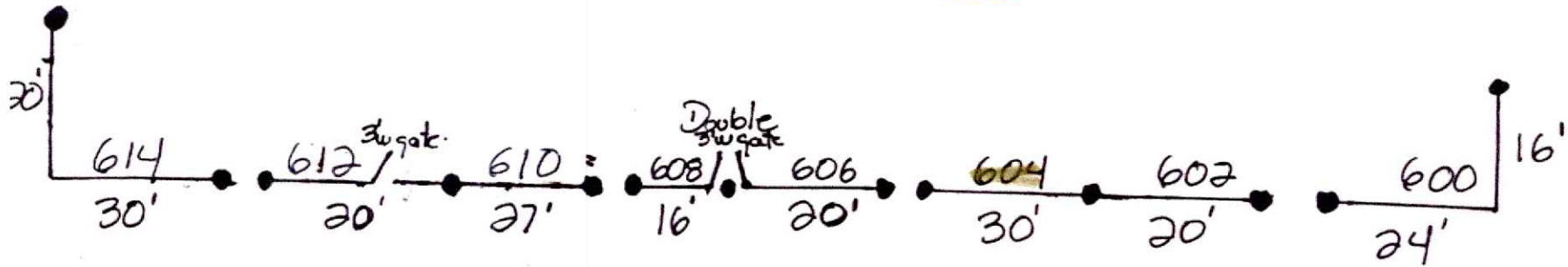

610 South Central Ave.

Randy Smith

(386) 264-9222.

email: Resmith2007@bellsouth.net.

Palm Coast Fencing Inc.

Scanned with CamScanner

1300

LEX FENCING INC.

Professional Fence Installation and Repairs.
Licensed & Insured

(386) 263 7888

Email: lexfencing@yahoo.com

Date: 3-1-24

ESTIMATE

Name: Randy Smith

Address: 610 S. Central Ave FB

Phone: 386-244-9222

RESmith2007@

Email: bellsouth.net

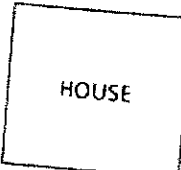
Style of Fence: <u>Vinyl</u>			Underground Utilities <input type="checkbox"/> Irrigation <input type="checkbox"/> Electricity <input type="checkbox"/> Telephone <input type="checkbox"/> Water <input type="checkbox"/> Gas <input type="checkbox"/> Other ()	
Color: <u>White spear</u> Top Picket fence			Other tools <input type="checkbox"/> Core drill <input type="checkbox"/> Jack Hammer <input type="checkbox"/> Chain saw	
Height: 3' 4' 5' 6'			Gate Hardware <input checked="" type="checkbox"/> Standard <input type="checkbox"/> Upgrade (self-closing stainless steel hinges and lock latches with keys)	
Number of Gates: <u>3</u>			INSTALLED PRICE: \$ <u>8,118.54</u> (Price includes taxes, materials, labor and permit)	
Gates: <input type="checkbox"/> Pool Code <input type="checkbox"/> Standard				
CAPS <input type="checkbox"/> Standard <input type="checkbox"/> New England <input type="checkbox"/> Gothic <input type="checkbox"/> Other (<u>11 caps</u>)				
OLD FENCE <input checked="" type="checkbox"/> Remove <input checked="" type="checkbox"/> Disposal <input type="checkbox"/> Leave at the job				
Property Grade <input type="checkbox"/> Follow the grade <input checked="" type="checkbox"/> Straight top				
Dirt:				
OBSERVATIONS:				
<u>600: 40'</u>		<u>1,462.80</u>		
<u>602: 22'</u>		<u>204.54</u>		
<u>604: 28'</u>		<u>1,023.96</u>		
<u>606: 23' w/gate</u>		<u>841.11</u>		
<u>608: 12' w/gate</u>		<u>475.41</u>		
<u>610: 20'</u>		<u>950.82</u>		
<u>612: 20' w/gate</u>		<u>731.40</u>		
<u>614: 50'</u>		<u>1,828.50</u>		
<u>Note: Each price includes Permit and Removal and disposal</u>				

- On vinyl fences, all virgin material with lifetime warranty. Price includes 120 lbs of concrete per post; 160 lbs of concrete and aluminum inserter on gate post.

PO BOX 530489
DEBARY, FL 32753-0489

VISA

MasterCard



OFFICE 386-789-1700

FAX 386-789-0796

www.davesfenceinc.com

INSTALLATION AND REPAIRS ON ALL TYPES OF FENCING

Proposal Submitted to :	Job Name: SAME	Date: 2/13/2024
Street: 604 S CENTRAL AVE	Job Location: SAME	
City, State, and Zip: FLAGLER BCH FL 32136	Contact:	
Phone:	Bus. Phone:	Cell:
		Fax:

We Hereby Submit Specifications and Estimate For:

FURNISH AND INSTALL APPROXIMATELY 28' OF 3' HIGH PVC PICKET FENCE.

INCLUDES 0 GATE WITH ALUMINUM I BEAMS IN HINGE AND LATCH POST. ALL POSTS SET IN CONCRETE

INCLUDES LIFETIME GATE ADJUSTMENTS @ NO CHARGE.

PVC Vinyl PICKET	Aluminum	Wood	Chain Link
Style MCKINLEY	Style	Style	Gal Black Green
Height 3'	Height	Height	Height
Color WHITE	Color	Picks	Resid LghtCom Comm
Post 8'o/c 5"X5"X9'	Grade	Runners	Terminals
Caps FLAT	Caps	Post	Line Post
Walk Gate N/A	Walk Gate	Gate Post	Top Rail
Walk Gate N/A	Double Gate	Walk Gate	Fabric
DOUBLE GATE N/A	Picket Spacing	Gate	Bottom T-wire
Please Read: Wood fence has a 20 year manufacturer warranty against rot, decay, and termites. Warranty does not cover warping, splitting or cracking of any portion of the wood fence. Dave's fence recommends applying a water proofing sealant to help reduce cosmetic flaws in wood products.			Walk Gate
			Double Gate
			Gate
			Locate #

GENERAL INSTALLATION INFORMATION

Permit- DAVES	Clearing N/A	Cust Initial Drawing YES
Survey W/ PAPER WORK	Take Down 28'	Grade Changes YES
Cross St 7TH ST	Haul Away YES	Severity MINOR
HOA APPROVAL-- N/A	Open Pool NO	Location of Grade N/A
N.O.C. DAVES	Dog/SIZE NO N/A	Fence Straight on top NO
		Fence Contour to ground YES

Requested Installation Date:

All material is guaranteed to be specified. All work to be completed in substantial workmanlike manner according to specifications submitted per standard practices. Any alteration or deviation from above specifications involving extra costs will be executed only upon written orders, and will become an extra charge over and above the estimate. All materials remain the property of Dave's Fence until contract is paid in full. Right of access and removal is hereby granted in the event of non payment as agreed. Not responsible for damage to underground lines that cannot be located.

Estimated Installation Date	4 TO 12 WKS
Base Price	\$1,400
Permit +	\$200
N.O.C +	
Total Price =	\$1,600

According to Florida's construction Lien Law (sections 713.001-713.37, Florida statutes), those who work on your property or provide materials and are not paid in full have a right to enforce their claim for payment against your property. This claim is known as a construction lien. If your contractor or a subcontractor fails to pay subcontractors or material suppliers or neglects to make other legally required payments, the people who are owed money may look to your property for payment, even if you have paid your contract in full. If you fail to pay your contractor, your contractor may also have a lien on your property. This means if a lien is filed your property could be sold against your will to pay for labor, materials, or other services that your contractor or a subcontractor may have failed to pay. To protect yourself, you should stipulate in this contract that before any payment is made your contractor is required to provide you with a written release of lien from any person or company that has provided to you a "notice to owner." Florida's construction lien law is complex and it is recommended that, whenever a specific problem arises, you consult an attorney.

Acceptance of proposal- The above prices, specifications and conditions are satisfactory and are hereby accepted. You are authorized to do the work specified. Payment will be made as outlined above.

SIGNATURE _____ Date: _____
SIGNATURE _____ Date: _____

Retainer \$800

Balance due upon completion: \$800

Once proposal is accepted by Dave's Fence the proposal becomes a binding contract and is not subject to cancellation. Initials _____

This proposal may be withdrawn by Dave's Fence if not accepted within 21 days.

Company Representative:

SCOTT 386-232-9200

scottb.davesfence@gmail.com

Application Form

Small Redevelopment District Grant Program

NAME: CHARLES TRIOLETT Own ☒ Lease ☐
PROPERTY ADDRESS: 606 S CENTRAL AVE FLAGLER BEACH FL 32136
MAILING ADDRESS: SAME
PROPERTY ID # (on taxes) _____ CURRENT USE HOME
TELEPHONE: 386-627-4099 (DAY) SAME (EVENING) _____
EMAIL: BOBSELYN@THEBEACHEMAIL.COM
TYPE OF IMPROVEMENT PLANNED: (Attach a written summary)

PROJECT PROPOSAL ON IMPROVEMENTS (Not all inclusive, see procedures and guidelines for full requirements)

- A written summary of the scope of work to be performed.
- Digital color photographs clearly showing existing conditions of the facade, neighboring buildings and public entrances
- Site/Sketch plans and specifications detailing the scope of work that will be required at the time of application and will be further developed at the project review conference.
- Samples of all paint colors, signage and awnings materials to be used on the building, (if applicable)
- An all inclusive estimate supporting project costs. At least two (2) estimates must be provided.

ESTIMATED TOTAL COST OF PROPOSED IMPROVEMENTS: \$ 885.00 980.00
GRANT APPLICATION MOUNT: \$ 1000.00

I UNDERSTAND THAT IN ORDER FOR MY REQUEST FOR GRANT FUNDING TO BE APPROVED, I MUST AGREE TO THE FOLLOWING CONDITIONS:

- To follow the design recommendations as approved by the CRA Board and the City of Flagler Beach Ordinances. I **further agree to maintain all improvements and not to alter the project for a period of three (3) years without approval from the CRA.** Acknowledgement of notification _____
- To adhere to the Application Procedures and Guidelines and the Grant Agreement as specified.
Acknowledgement of notification _____
- That I shall incur all initial project costs and receive reimbursement only after:
 - All improvements have been completed.
 - Final inspections of the improvements are approved and accepted by the CRA and Building Official.
 - Proof of payment for project costs have been received and verified.
- Additional improvements or changes not approved will not be funded.
Acknowledgement of notification _____
- Grant awards will be based on lowest bid unless approved by the CRA Board.
Acknowledgement of notification _____
- Attendance at the CRA Board meeting when this application is reviewed is mandatory.
Acknowledgement of notification _____

I ACKNOWLEDGE THAT I HAVE RECEIVED AND UNDERSTAND THE DESIGN GUIDELINES, THE REDEVELOPMENT DISTRICT GRANT PROGRAM PROCEDURES AND THE GRANT AGREEMENT.

APPLICANT SIGNATURE _____

DATE 2/20/24

Flagler Beach CRA Grant Fencing Replacement

randy SMITH <resmith2007@bellsouth.net>

Tue 2/20/2024 9:01 AM

To:randy SMITH <resmith2007@bellsouth.net>

Requesting CRA Grant funds to replace the existing 20-year-old picket fence along Central Ave. This fence is damaged and has been abused by passerby people over the years. It is a white 4' high picket fence which runs along Central Ave over 8 properties. Pricing includes removal and disposal of old fencing and replaced with new fencing which will be same white picket look with stainless steel hardware at the three gates.

Properties affected:

600 South Central Ave

602 South Central Ave

604 South Central Ave

606 South Central Ave

608 South Central Ave

610 South Central Ave

612 South Central Ave

614 South Central Ave.

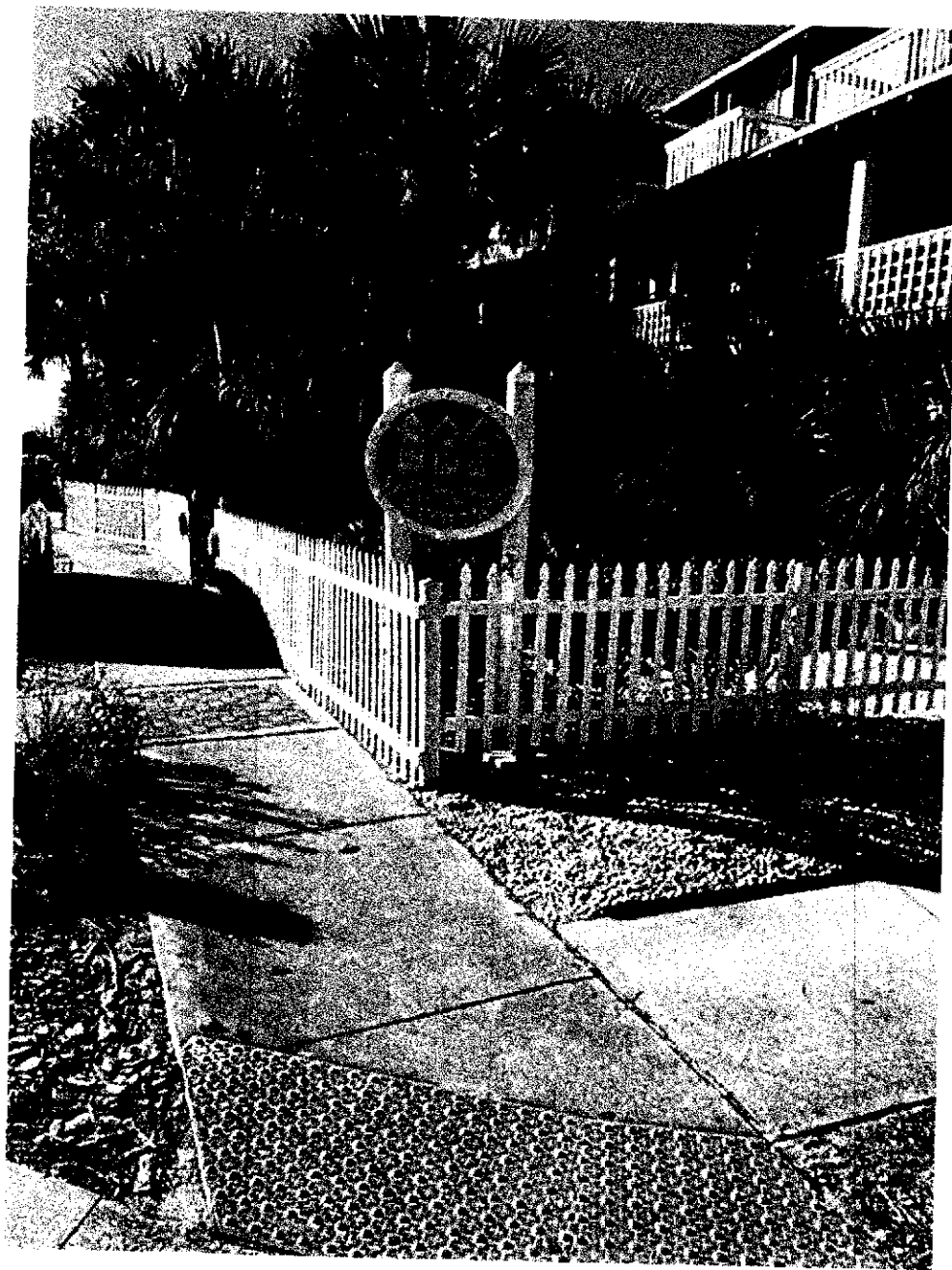



Palm Coast Fencing Inc.

Professional Fence Installation & Repairs
Licensed & Insured 20 Years of Experience

(386)-346-1300 **Estimate**



Name: Randy Smith Date: 02/18/24
Address: 610 South Central Ave Flagler Beach.
Phone: (386) 264-9222 Email: Rsmith2007@bellsouth.net

	Fence Style: <u>Vinyl (picket fence).</u> Color: <u>white</u> Height: 6' 5' <u>(4)</u> 3'
	Gates Quantity: <u>3</u> Pool Code <input type="checkbox"/> Caps Standard <input checked="" type="checkbox"/> Other: _____
Observations: <u>Install 223' of 4' high</u> <u>white Vinyl (picket fence)</u> <u>with 3 gates.</u> <u>* Removed and disposal of</u> <u>existing fence is included</u> <u>in the price.</u>	Old Fence Remove & Disposal <input checked="" type="checkbox"/> Remove & Leave on site <input type="checkbox"/> INSTALLED PRICE: <u>\$ 7,760.00</u> (Price includes taxes, materials, labor and permit)

PVC posts will be 30"-36" in the ground and 120 pounds of concrete will be used per post. Self-closing stainless steel hinges and lock latches with keys are included in the price. Stainless steel drop-rods for double gates are included. Lifetime warranty on material and 5 years on labor.

As soon as we have approval, planning can begin for this job. A down payment of 50% of the total price is required at the time of agreement contract signing. Remaining balance is due upon completion of job.

*Credit/debit card payments may be subject to a 3% merchant fee.

This estimate is valid for 15 days. After this period, you have the option to call and verify if the material price has changed.

#1,425. ⁰⁰	#980. ⁰⁰	#815. ⁰⁰	#874. ⁰⁰	#980. ⁰⁰	#895. ⁰⁰	#630. ⁰⁰	#1,160. ⁰⁰
614	612	610	608	606	604	602	600.

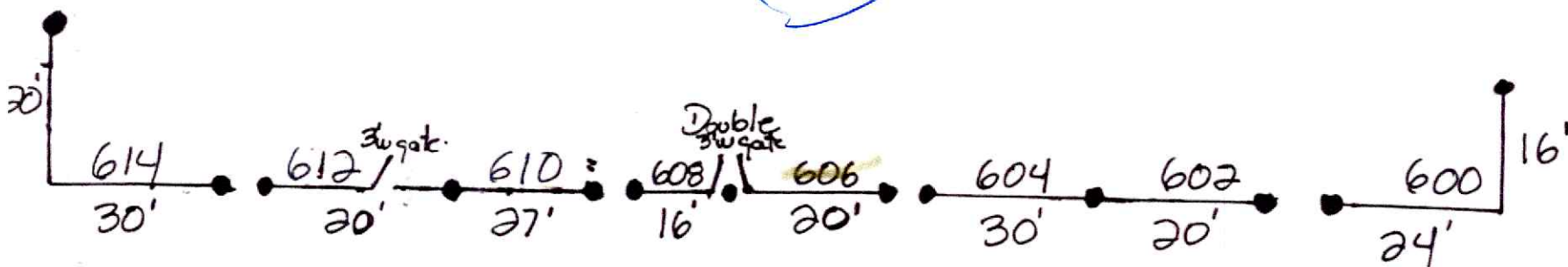

610 South Central Ave.

Randy Smith

(386) 264-9222.

email: Resmith2007@bellsouth.net.

Palm Coast Fencing Inc.

Scanned with CamScanner

1300

LEX FENCING INC.

Professional Fence Installation and Repairs.
Licensed & Insured

(386) 263 7888

Email: lexfencing@yahoo.com

Date: 3-1-24

ESTIMATE

Name: Randy Smith

Address: 610 S. Central Ave FB

Phone: 386-244-9222

Email: RESmith2007@bellsouth.net

Style of Fence: <u>Vinyl</u> Color: <u>White spear</u> Height: 3' 4' 5' 6' Number of Gates: <u>3</u> Gates: <input type="checkbox"/> Pool Code <input type="checkbox"/> Standard	<u>Top Picket fence</u> <div style="border: 1px solid black; width: 100px; height: 80px; margin: 20px auto; text-align: center; line-height: 80px;">HOUSE</div>	Underground Utilities <input type="checkbox"/> Irrigation <input type="checkbox"/> Electricity <input type="checkbox"/> Telephone <input type="checkbox"/> Water <input type="checkbox"/> Gas <input type="checkbox"/> Other ()
CAPS <input type="checkbox"/> Standard <input type="checkbox"/> New England <input type="checkbox"/> Gothic <input checked="" type="checkbox"/> Other (<u>11 Caps</u>)	Other tools <input type="checkbox"/> Core drill <input type="checkbox"/> Jack Hammer <input type="checkbox"/> Chain saw	Gate Hardware <input checked="" type="checkbox"/> Standard <input type="checkbox"/> Upgrade (self-closing stainless steel hinges and lock latches with keys)
OLD FENCE <input checked="" type="checkbox"/> Remove <input checked="" type="checkbox"/> Disposal <input type="checkbox"/> Leave at the job	Property Grade <input type="checkbox"/> Follow the grade <input checked="" type="checkbox"/> Straight top Dirt:	INSTALLED PRICE: \$8,118.54 (Price includes taxes, materials, labor and permit)

OBSERVATIONS:

1000: 40'	1,462.80
1002: 28'	804.54
1004: 28'	804.54
1006: 23' w/gate	1,023.96
1008: 12' w/gate	241.11
1010: 26'	425.41
1012: 20' w/gate	950.82
1014: 50'	731.40
	1,828.50

Note: Each price includes Permit and Removal and disposal

- On vinyl fences, all virgin material with lifetime warranty. Price includes 120 lbs of concrete per post; 160 lbs of concrete and aluminum inserter on gate post.

PO BOX 530489
DEBARY, FL 32753-0489

VISA

MasterCard

AMERICAN EXPRESS



OFFICE 386-789-1700

FAX 386-789-0796

www.davesfenceinc.com

INSTALLATION AND REPAIRS ON ALL TYPES OF FENCING

Proposal Submitted to: _____ Job Name: SAME Date: 2/13/2024

Street: 606 S CENTRAL AVE Job Location: SAME

City, State, and Zip: FLAGLER BCH FL 32136 Contact: _____

Phone: _____ Bus. Phone: _____ Cell: _____ Fax: _____

We Hereby Submit Specifications and Estimate For:

FURNISH AND INSTALL APPROXIMATELY 20' OF 3' HIGH PVC PICKET FENCE.

INCLUDES 1 GATE WITH ALUMINUM I BEAMS IN HINGE AND LATCH POST. ALL POSTS SET IN CONCRETE

INCLUDES LIFETIME GATE ADJUSTMENTS @ NO CHARGE.

PVC Vinyl PICKET	Aluminum	Wood	Chain Link
Style MCKINLEY	Style	Style	Gal Black Green
Height 3'	Height	Height	Height
Color WHITE	Color	Picks	Resid LghtCom Comm
Post 8'o/c 5"X5"X9'	Grade	Runners	Terminals
Caps FLAT	Caps	Post	Line Post
Walk Gate 1 @ 4FT	Walk Gate	Gate Post	Top Rail
Walk Gate N/A	Double Gate	Walk Gate	Fabric
DOUBLE GATE N/A	Picket Spacing	Gate	Bottom T-wire
Please Read: Wood fence has a 20 year manufacturer warranty against rot, decay, and termites. Warranty does not cover warping, splitting or cracking of any portion of the wood fence. Dave's fence recommends applying a water proofing sealant to help reduce cosmetic flaws in wood products.			Walk Gate
			Double Gate
			Gate
			Locate #

GENERAL INSTALLATION INFORMATION

Permit- DAVES	Clearing N/A	Cust Initial Drawing YES
Survey W/ PAPER WORK	Take Down 20'	Grade Changes YES
Cross St 7TH ST	Haul Away YES	Severity MINOR
HOA APPROVAL-- N/A	Open Pool NO	Location of Grade N/A
N.O.C. DAVES	Dog/SIZE NO N/A	Fence Straight on top NO
Requested Installation Date: _____		Fence Contour to ground YES

All material is guaranteed to be specified. All work to be completed in substantial workmanlike manner according to specifications submitted per standard practices. Any alteration or deviation from above specifications involving extra costs will be executed only upon written orders, and will become an extra charge over and above the estimate. All materials remain the property of Dave's Fence until contract is paid in full. Right of access and removal is hereby granted in the event of non payment as agreed. Not responsible for damage to underground lines that cannot be located.

According to Florida's construction Lien Law (sections 713.001-713.37, Florida statutes), those who work on your property or provide materials and are not paid in full have a right to enforce their claim for payment against your property. This claim is known as a construction lien. If your contractor or a subcontractor fails to pay subcontractors or material suppliers or neglects to make other legally required payments, the people who are owed money may look to your property for payment, even if you have paid your contract in full. If you fail to pay your contractor, your contractor may also have a lien on your property. This means if a lien is filed your property could be sold against your will to pay for labor, materials, or other services that your contractor or a subcontractor may have failed to pay. To protect yourself, you should stipulate in this contract that before any payment is made your contractor is required to provide you with a written release of lien from any person or company that has provided to you a "notice to owner." Florida's construction lien law is complex and it is recommended that, whenever a specific problem arises, you consult an attorney.

Acceptance of proposal- The above prices, specifications and conditions are satisfactory and are hereby accepted. You are authorized to do the work specified. Payment will be made as outlined above.

SIGNATURE _____ Date: _____

SIGNATURE _____ Date: _____

Estimated Installation Date	4 TO 12 WKS
Base Price	\$1,500
Permit +	\$200
N.O.C +	
Total Price =	\$1,700

Retainer \$850

Balance due upon completion: \$850

Once proposal is accepted by Dave's Fence the proposal becomes a binding contract and is not subject to cancellation. Initials _____

This proposal may be withdrawn by Dave's Fence if not accepted within 21 days.

Company Representative:

SCOTT 386-232-9200

scottb.davesfence@gmail.com

Application Form

Small Redevelopment District Grant Program

NAME: CLIFF HEINDEL Own ☒ Lease ☐
PROPERTY ADDRESS: 608 SOUTH CENTRAL AVE
MAILING ADDRESS: 4294 JUCKER NORTH DR. TOLVER GA 30084
PROPERTY ID # (on taxes) 12-12-31-2550-0000-0090 CURRENT USE HOME
TELEPHONE: 770-296-7871 (DAY) (EVENING)
EMAIL: HEINDEL@BELL-SOUTH.NET

TYPE OF IMPROVEMENT PLANNED: (Attach a written summary)

PROJECT PROPOSAL ON IMPROVEMENTS (Not all inclusive, see procedures and guidelines for full requirements)

- A written summary of the scope of work to be performed.
- Digital color photographs clearly showing existing conditions of the facade, neighboring buildings and public entrances
- Site/Sketch plans and specifications detailing the scope of work that will be required at the time of application and will be further developed at the project review conference.
- Samples of all paint colors, signage and awnings materials to be used on the building (if applicable)
- An all inclusive estimate supporting project costs. At least two (2) estimates must be provided.

ESTIMATED TOTAL COST OF PROPOSED IMPROVEMENTS: \$ 874.00
GRANT APPLICATION MOUNT: \$ 874

I UNDERSTAND THAT IN ORDER FOR MY REQUEST FOR GRANT FUNDING TO BE APPROVED, I MUST AGREE TO THE FOLLOWING CONDITIONS:

- To follow the design recommendations as approved by the CRA Board and the City of Flagler Beach Ordinances. I **further agree to maintain all improvements and not to alter the project for a period of three (3) years without approval from the CRA.** Acknowledgement of notification CH
- To adhere to the Application Procedures and Guidelines and the Grant Agreement as specified. Acknowledgement of notification CH
- That I shall incur all initial project costs and receive reimbursement only after:
 - All improvements have been completed.
 - Final inspections of the improvements are approved and accepted by the CRA and Building Official.
 - Proof of payment for project costs have been received and verified.
- Additional improvements or changes not approved will not be funded. Acknowledgement of notification CH
- Grant awards will be based on lowest bid unless approved by the CRA Board. Acknowledgement of notification CH
- Attendance at the CRA Board meeting when this application is reviewed is mandatory. Acknowledgement of notification CH

I ACKNOWLEDGE THAT I HAVE RECEIVED AND UNDERSTAND THE DESIGN GUIDELINES, THE REDEVELOPMENT DISTRICT GRANT PROGRAM PROCEDURES AND THE GRANT AGREEMENT.

APPLICANT SIGNATURE Cliff Heindel

DATE 2/20/24

Flagler Beach CRA Grant Fencing Replacement

randy SMITH <resmith2007@bellsouth.net>

Tue 2/20/2024 9:01 AM

To:randy SMITH <resmith2007@bellsouth.net>

Requesting CRA Grant funds to replace the existing 20-year-old picket fence along Central Ave. This fence is damaged and has been abused by passerby people over the years. It is a white 4' high picket fence which runs along Central Ave over 8 properties. Pricing includes removal and disposal of old fencing and replaced with new fencing which will be same white picket look with stainless steel hardware at the three gates.

Properties affected:

600 South Central Ave

602 South Central Ave

604 South Central Ave

606 South Central Ave

608 South Central Ave

610 South Central Ave

612 South Central Ave

614 South Central Ave.

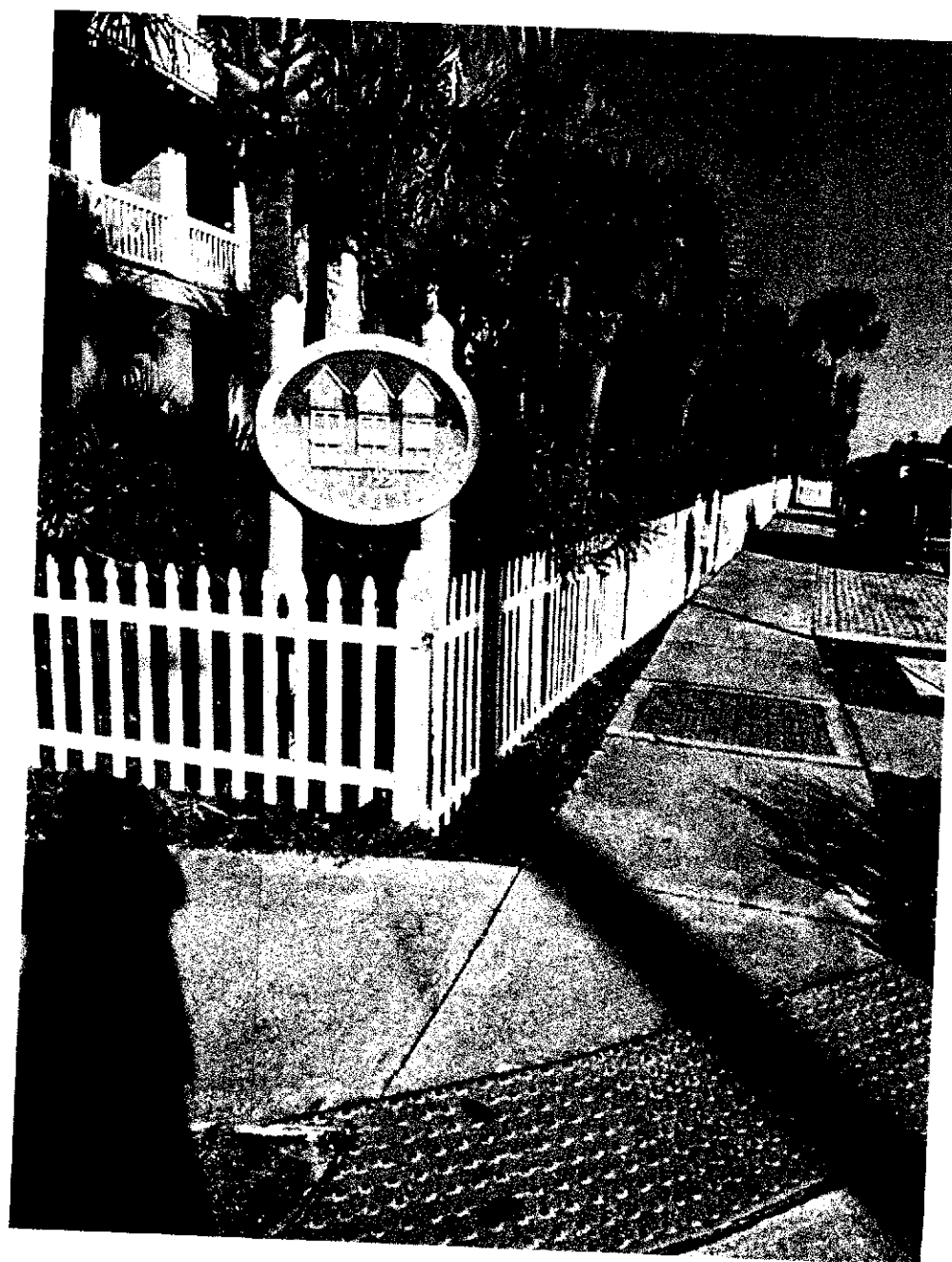

LEX FENCING INC.

Professional Fence Installation and Repairs.
Licensed & Insured

(386) 263 7888

Email: lexfencing@yahoo.com

Date: 3-1-24

ESTIMATE

Name: Randy Smith

Address: 4610 S. Central Ave FFB

Phone: 386-264-9222

RESmith2007@

Email: bellsouth.net

Style of Fence: <u>Vinyl</u> Color: <u>White spear</u> Height: 3' 4' 5' 6' Number of Gates: <u>3</u> Gates: <input type="checkbox"/> Pool Code <input checked="" type="checkbox"/> Standard CAPS <input type="checkbox"/> Standard <input type="checkbox"/> New England <input type="checkbox"/> Gothic <input checked="" type="checkbox"/> Other (<u>11 Caps</u>)	Top Picket fence <div style="border: 1px solid black; width: 100px; height: 80px; margin: 20px auto; text-align: center; line-height: 80px;">HOUSE</div>	Underground Utilities <input type="checkbox"/> Irrigation <input type="checkbox"/> Electricity <input type="checkbox"/> Telephone <input type="checkbox"/> Water <input type="checkbox"/> Gas <input type="checkbox"/> Other () Other tools <input type="checkbox"/> Core drill <input type="checkbox"/> Jack Hammer <input type="checkbox"/> Chain saw Gate Hardware <input checked="" type="checkbox"/> Standard <input type="checkbox"/> Upgrade (self-closing stainless steel hinges and lock latches with keys)																		
OLD FENCE <input checked="" type="checkbox"/> Remove <input checked="" type="checkbox"/> Disposal <input type="checkbox"/> Leave at the job Property Grade <input type="checkbox"/> Follow the grade <input checked="" type="checkbox"/> Straight top Dirt:	OBSERVATIONS: <table border="1"> <tr><td>1000: 40'</td><td></td></tr> <tr><td>1002: 22'</td><td>1,462.80</td></tr> <tr><td>1004: 28'</td><td>204.54</td></tr> <tr><td>1006: 23' w/gate</td><td>1,023.96</td></tr> <tr><td>1008: 13' w/gate</td><td>241.11</td></tr> <tr><td>1010: 20'</td><td>425.41</td></tr> <tr><td>1012: 20' w/gate</td><td>950.82</td></tr> <tr><td>1014: 50'</td><td>731.40</td></tr> <tr><td></td><td>1,828.50</td></tr> </table>	1000: 40'		1002: 22'	1,462.80	1004: 28'	204.54	1006: 23' w/gate	1,023.96	1008: 13' w/gate	241.11	1010: 20'	425.41	1012: 20' w/gate	950.82	1014: 50'	731.40		1,828.50	INSTALLED PRICE: \$ <u>8,118.54</u> (Price includes taxes, materials, labor and permit)
1000: 40'																				
1002: 22'	1,462.80																			
1004: 28'	204.54																			
1006: 23' w/gate	1,023.96																			
1008: 13' w/gate	241.11																			
1010: 20'	425.41																			
1012: 20' w/gate	950.82																			
1014: 50'	731.40																			
	1,828.50																			

Note: Each price includes Permit and Removal and disposal

- On vinyl fences, all virgin material with lifetime warranty. Price includes 120 lbs of concrete per post; 160 lbs of concrete and aluminum inserter on gate post.

Palm Coast Fencing Inc.

Professional Fence Installation & Repairs
Licensed & Insured 20 Years of Experience

(386)-346-1300

Estimate



608

Name: Randy Smith Date: 02/18/24
Address: 610 South Central Ave Flagler Beach.
Phone: (386) 264-9222 Email: Rsmith2007@bellsouth.net

	Fence Style: <u>Vinyl (picket fence)</u> Color: <u>white</u> Height: 6' 5' <u>4</u> 3'
	Gates Quantity: <u>3</u> Pool Code <input type="checkbox"/> Caps Standard <input checked="" type="checkbox"/> Other: _____
Observations: <u>Install 223' of 4' high</u> <u>white Vinyl (picket fence)</u> <u>with 3 gates.</u> <u>* Removed and disposal of</u> <u>existing fence is included</u> <u>in the price.</u>	Old Fence Remove & Disposal <input checked="" type="checkbox"/> Remove & Leave on site <input type="checkbox"/> INSTALLED PRICE: <u>\$ 7,760.00</u> (Price includes taxes, materials, labor and permit)

PVC posts will be 30"-36" in the ground and 120 pounds of concrete will be used per post. Self-closing stainless steel hinges and lock latches with keys are included in the price. Stainless steel drop-rods for double gates are included. Lifetime warranty on material and 5 years on labor.

As soon as we have approval, planning can begin for this job. A down payment of 50% of the total price is required at the time of agreement contract signing. Remaining balance is due upon completion of job.

*Credit/debit card payments may be subject to a 3% merchant fee.

This estimate is valid for 15 days. After this period, you have the option to call and verify if the material price has changed.

\$1,425. ⁰⁰	\$980. ⁰⁰	\$815. ⁰⁰	\$874. ⁰⁰	\$980. ⁰⁰	\$895. ⁰⁰	\$630. ⁰⁰	\$1,160. ⁰⁰
614	612	610	608	606	604	602	600.

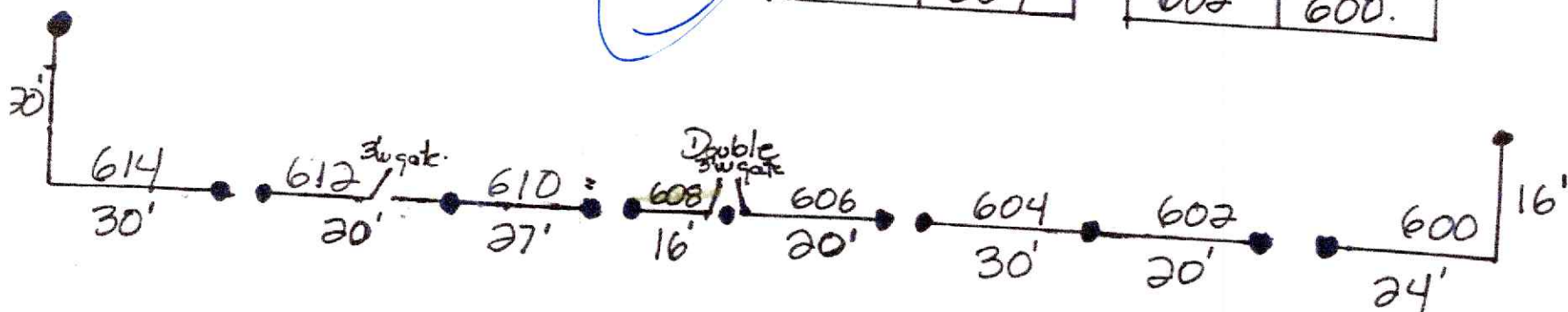

610 South Central Ave.

Randy Smith

(386) 264-9222.

email: Resmith2007@bellsouth.net.

Palm Coast Fencing Inc.

PO BOX 530489
DEBARY, FL 32753-0489

VISA

MasterCard



OFFICE 386-789-1700

FAX 386-789-0796

www.davesfenceinc.com

INSTALLATION AND REPAIRS ON ALL TYPES OF FENCING

Proposal Submitted to : _____ Job Name: SAME Date: 2/13/2024

Street: 608 S CENTRAL AVE Job Location: SAME

City, State, and Zip: FLAGLER BCH FL 32136 Contact: _____

Phone: _____ Bus. Phone: _____ Cell: _____ Fax: _____

We Hereby Submit Specifications and Estimate For:

FURNISH AND INSTALL APPROXIMATELY 14' OF 3' HIGH PVC PICKET FENCE.

INCLUDES 1 GATE WITH ALUMINUM I BEAMS IN HINGE AND LATCH POST. ALL POSTS SET IN CONCRETE

INCLUDES LIFETIME GATE ADJUSTMENTS @ NO CHARGE.

PVC Vinyl PICKET	Aluminum	Wood	Chain Link
Style MCKINLEY	Style	Style	Gal Black Green
Height 3'	Height	Height	Height
Color WHITE	Color	Picks	Resid LghtCom Comm
Post 8'o/c 5"X5"X9'	Grade	Runners	Terminals
Caps FLAT	Caps	Post	Line Post
Walk Gate 1 @ 4FT	Walk Gate	Gate Post	Top Rail
Walk Gate N/A	Double Gate	Walk Gate	Fabric
DOUBLE GATE N/A	Picket Spacing	Gate	Bottom T-wire
Please Read: Wood fence has a 20 year manufacturer warranty against rot, decay, and termites. Warranty does not cover warping, splitting or cracking of any portion of the wood fence. Dave's fence recommends applying a water proofing sealant to help reduce cosmetic flaws in wood products.			Walk Gate
			Double Gate
			Gate
			Locate #

GENERAL INSTALLATION INFORMATION

Permit- DAVES	Clearing N/A	Cust Initial Drawing YES
Survey W/ PAPER WORK	Take Down 14'	Grade Changes YES
Cross St 7TH ST	Haul Away YES	Severity MINOR
HOA APPROVAL-- N/A	Open Pool NO	Location of Grade N/A
N.O.C. DAVES	Dog/SIZE NO N/A	Fence Straight on top NO
Requested Installation Date: _____		Fence Contour to ground YES

All material is guaranteed to be specified. All work to be completed in substantial workmanlike manner according to specifications submitted per standard practices. Any alteration or deviation from above specifications involving extra costs will be executed only upon written orders, and will become an extra charge over and above the estimate. All materials remain the property of Dave's Fence until contract is paid in full. Right of access and removal is hereby granted in the event of non payment as agreed. Not responsible for damage to underground lines that cannot be located.

According to Florida's construction Lien Law (sections 713.001-713.37, Florida statutes), those who work on your property or provide materials and are not paid in full have a right to enforce their claim for payment against your property. This claim is known as a construction lien. If your contractor or a subcontractor fails to pay subcontractors or material suppliers or neglects to make other legally required payments, the people who are owed money may look to your property for payment, even if you have paid your contract in full. If you fail to pay your contractor, your contractor may also have a lien on your property. This means if a lien is filed your property could be sold against your will to pay for labor, materials, or other services that your contractor or a subcontractor may have failed to pay. To protect yourself, you should stipulate in this contract that before any payment is made your contractor is required to provide you with a written release of lien from any person or company that has provided to you a "notice to owner." Florida's construction lien law is complex and it is recommended that, whenever a specific problem arises, you consult an attorney.

Acceptance of proposal- The above prices, specifications and conditions are satisfactory and are hereby accepted. You are authorized to do the work specified. Payment will be made as outlined above.

SIGNATURE _____ Date: _____

SIGNATURE _____ Date: _____

Estimated Installation Date	4 TO 12 WKS
Base Price	\$1,300
Permit +	\$200
N.O.C +	
Total Price =	\$1,500

Retainer \$750

Balance due upon completion: \$750

Once proposal is accepted by Dave's Fence the proposal becomes a binding contract and is not subject to cancellation. Initials _____

This proposal may be withdrawn by Dave's Fence if not accepted within 21 days.

Company Representative:

SCOTT 386-232-9200

scottb.davesfence@gmail.com

Application Form

Small Redevelopment District Grant Program

NAME: RANDALL SMITH Own ☒ Lease ☐
PROPERTY ADDRESS: 610 S CENTRAL AVE FLAGLER BEACH FL 32136
MAILING ADDRESS: SAME
PROPERTY ID # (on taxes) 12-12-31-2550-0000-0100 CURRENT USE RENTAL
TELEPHONE: 386-264-9222 (DAY) SAME (EVENING)
EMAIL: DSMITH2007@BELL-SOUTH.NET
TYPE OF IMPROVEMENT PLANNED: (Attach a written summary)

PROJECT PROPOSAL ON IMPROVEMENTS (Not all inclusive, see procedures and guidelines for full requirements)

- A written summary of the scope of work to be performed.
- Digital color photographs clearly showing existing conditions of the facade, neighboring buildings and public entrances
- Site/Sketch plans and specifications detailing the scope of work that will be required at the time of application and will be further developed at the project review conference.
- Samples of all paint colors, signage and awnings materials to be used on the building.(if applicable)
- An all inclusive estimate supporting project costs. At least two (2) estimates must be provided.

ESTIMATED TOTAL COST OF PROPOSED IMPROVEMENTS: \$ 815.00
GRANT APPLICATION MOUNT: \$ 815.00

I UNDERSTAND THAT IN ORDER FOR MY REQUEST FOR GRANT FUNDING TO BE APPROVED, I MUST AGREE TO THE FOLLOWING CONDITIONS:

- To follow the design recommendations as approved by the CRA Board and the City of Flagler Beach Ordinances. I further agree to maintain all improvements and not to alter the project for a period of three (3) years without approval from the CRA. Acknowledgement of notification [Signature]
- To adhere to the Application Procedures and Guidelines and the Grant Agreement as specified.
Acknowledgement of notification [Signature]
- That I shall incur all initial project costs and receive reimbursement only after:
 - All improvements have been completed.
 - Final inspections of the improvements are approved and accepted by the CRA and Building Official.
 - Proof of payment for project costs have been received and verified.
- Additional improvements or changes not approved will not be funded.
Acknowledgement of notification [Signature]
- Grant awards will be based on lowest bid unless approved by the CRA Board.
Acknowledgement of notification [Signature]
- Attendance at the CRA Board meeting when this application is reviewed is mandatory.
Acknowledgement of notification [Signature]

I ACKNOWLEDGE THAT I HAVE RECEIVED AND UNDERSTAND THE DESIGN GUIDELINES, THE REDEVELOPMENT DISTRICT GRANT PROGRAM PROCEDURES AND THE GRANT AGREEMENT.

APPLICANT SIGNATURE [Signature]

DATE 2/20/24

Flagler Beach CRA Grant Fencing Replacement

randy SMITH <resmith2007@bellsouth.net>

Tue 2/20/2024 9:01 AM

To:randy SMITH <resmith2007@bellsouth.net>

Requesting CRA Grant funds to replace the existing 20-year-old picket fence along Central Ave. This fence is damaged and has been abused by passerby people over the years. It is a white 4' high picket fence which runs along Central Ave over 8 properties. Pricing includes removal and disposal of old fencing and replaced with new fencing which will be same white picket look with stainless steel hardware at the three gates.

Properties affected:

600 South Central Ave
602 South Central Ave
604 South Central Ave
606 South Central Ave
608 South Central Ave
610 South Central Ave
612 South Central Ave
614 South Central Ave.

01-4696

SCALE: 1"=20'
1540 8 1/2" I.R. 4
C2.0 G.B. 46783
(TYPICAL)

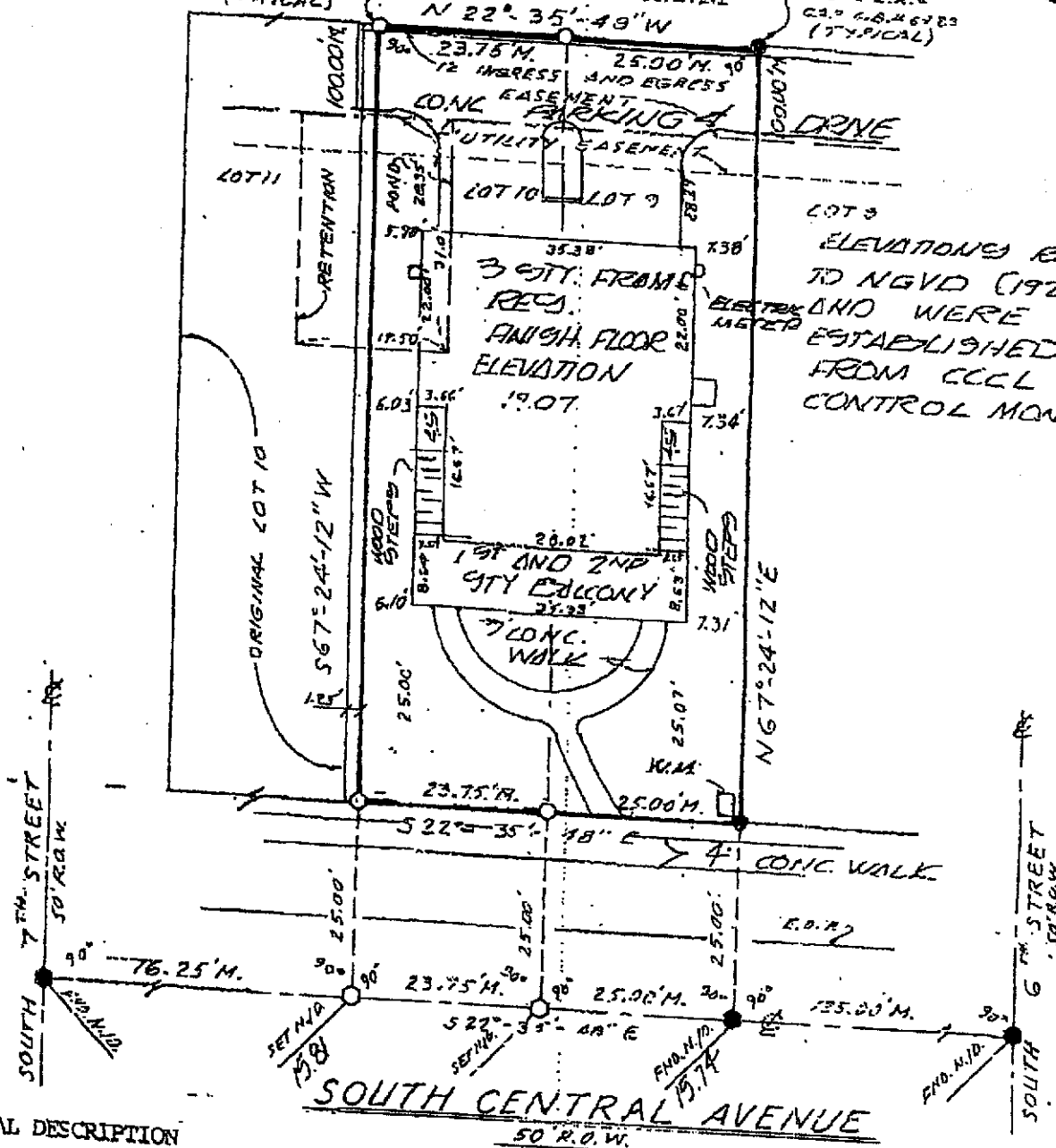

NOTES: 1. Description provided by client.
2. Bearings refer to plat data and to the center line of South Central Avenue as being S.22°35'48"E.
3. Property lies in Flood Zone "C", as shown on Flood Insurance Rate Map (FIRM), Community Panel Number 120087 0002 B, Effective Date: May 15, 1985.

P. Plat
D. Dood
O/E - Overhead Electric
N.A. - Official Revenue Book of B...



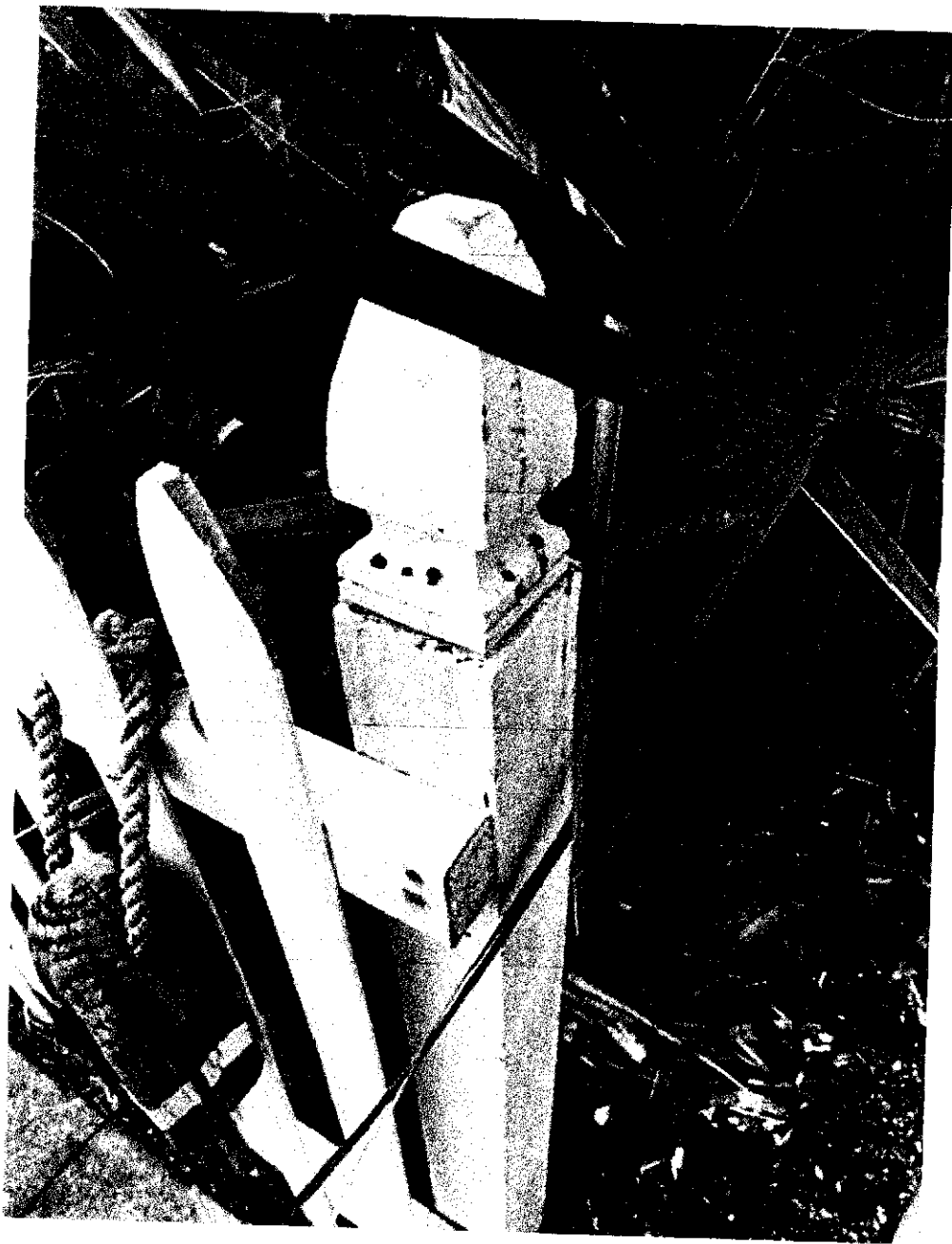

LEX FENCING INC.

Professional Fence Installation and Repairs.
Licensed & Insured

(386) 263 7888

Email: lexfencing@yahoo.com

Date: 3-1-24

ESTIMATE

Name: Randy Smith

Address: 610 S. Central Ave FB

Phone: 386-244-9222

RESmith2007@

Email: bellsouth.net

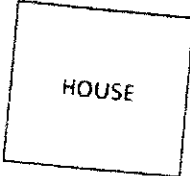
Style of Fence: <u>Vinyl</u>			Underground Utilities																		
Color: <u>White spear</u>			<input type="checkbox"/> Irrigation																		
Height: <u>3' 4' 5' 6'</u>			<input type="checkbox"/> Electricity																		
Number of Gates: <u>3</u>			<input type="checkbox"/> Telephone																		
Gates: <input type="checkbox"/> Pool Code <input type="checkbox"/> Standard		<input type="checkbox"/> Water																			
CAPS		<input type="checkbox"/> Gas																			
<input type="checkbox"/> Standard		<input type="checkbox"/> Other (<u> </u>)																			
<input type="checkbox"/> New England		Other tools																			
<input type="checkbox"/> Gothic		<input type="checkbox"/> Core drill																			
<input type="checkbox"/> Other (<u>11 caps</u>)		<input type="checkbox"/> Jack Hammer																			
OLD FENCE		<input type="checkbox"/> Chain saw																			
<input checked="" type="checkbox"/> Remove		Gate Hardware																			
<input checked="" type="checkbox"/> Disposal		<input checked="" type="checkbox"/> Standard																			
<input type="checkbox"/> Leave at the job		<input type="checkbox"/> Upgrade (self-closing stainless steel hinges and lock latches with keys)																			
Property Grade		INSTALLED PRICE: \$ <u>8,118.54</u>																			
<input checked="" type="checkbox"/> Follow the grade		(Price includes taxes, materials, labor and permit)																			
<input checked="" type="checkbox"/> Straight top																					
Dirt:																					
<table border="1"><thead><tr><th colspan="2">OBSERVATIONS:</th></tr></thead><tbody><tr><td>1000: 40'</td><td>1,462.80</td></tr><tr><td>1002: 22'</td><td>804.54</td></tr><tr><td>1004: 28'</td><td>1,023.96</td></tr><tr><td>1006: 23' w/gate</td><td>241.11</td></tr><tr><td>1008: 13' w/gate</td><td>475.41</td></tr><tr><td>1010: 20'</td><td>950.82</td></tr><tr><td>1012: 20' w/gate</td><td>731.40</td></tr><tr><td>1014: 50'</td><td>1,828.50</td></tr></tbody></table>				OBSERVATIONS:		1000: 40'	1,462.80	1002: 22'	804.54	1004: 28'	1,023.96	1006: 23' w/gate	241.11	1008: 13' w/gate	475.41	1010: 20'	950.82	1012: 20' w/gate	731.40	1014: 50'	1,828.50
OBSERVATIONS:																					
1000: 40'	1,462.80																				
1002: 22'	804.54																				
1004: 28'	1,023.96																				
1006: 23' w/gate	241.11																				
1008: 13' w/gate	475.41																				
1010: 20'	950.82																				
1012: 20' w/gate	731.40																				
1014: 50'	1,828.50																				
Note: Each price includes Permit and Removal and disposal																					

- On vinyl fences, all virgin material with lifetime warranty. Price includes 120 lbs of concrete per post; 160 lbs of concrete and aluminum inserter on gate post.

Palm Coast Fencing Inc.

Professional Fence Installation & Repairs
Licensed & Insured 20 Years of Experience

(386)-346-1300 **Estimate**



610

Name: Randy Smith Date: 02/18/24
Address: 610 South Central Ave Flagler Beach.
Phone: (386) 264-9222 Email: Rsmith2007@bellsouth.net

	Fence Style: <u>Vinyl (picket fence)</u> Color: <u>white</u> Height: 6' 5' <u>(4)</u> 3'
	Gates Quantity: <u>3</u> Pool Code <input type="checkbox"/> Caps Standard <input checked="" type="checkbox"/> Other: _____
Observations: <u>Install 223' of 4' high white Vinyl (picket fence) with 3 gates.</u> <u>* Removed and disposal of existing fence is included in the price.</u>	Old Fence Remove & Disposal <input checked="" type="checkbox"/> Remove & Leave on site <input type="checkbox"/> INSTALLED PRICE: <u>\$ 7,760.00</u> (Price includes taxes, materials, labor and permit)

PVC posts will be 30"-36" in the ground and 120 pounds of concrete will be used per post. Self-closing stainless steel hinges and lock latches with keys are included in the price. Stainless steel drop-rods for double gates are included. Lifetime warranty on material and 5 years on labor.

As soon as we have approval, planning can begin for this job. A down payment of 50% of the total price is required at the time of agreement contract signing. Remaining balance is due upon completion of job.

*Credit/debit card payments may be subject to a 3% merchant fee.

This estimate is valid for 15 days. After this period, you have the option to call and verify if the material price has changed.

\$1,425. ⁰⁰	\$980. ⁰⁰	\$815. ⁰⁰	\$874. ⁰⁰	\$980. ⁰⁰	\$895. ⁰⁰	\$630. ⁰⁰	\$1,160. ⁰⁰
614	612	610	608	606	604	602	600.

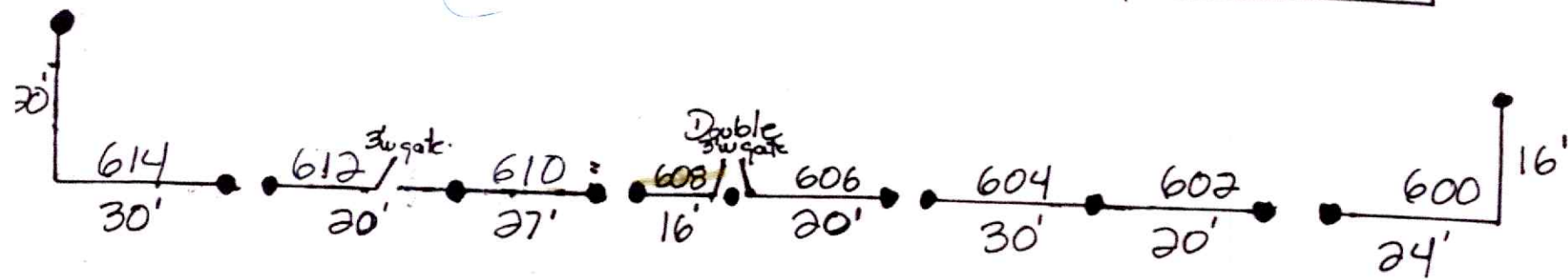

610 South Central Ave.

Randy Smith

(386) 264-9222.

email: Resmith2007@bellsouth.net.

Palm Coast Fencing Inc.

Scanned with CamScanner

12/11/2007

PO BOX 530489
DEBARY, FL 32753-0489

VISA

MasterCard

AMERICAN EXPRESS



OFFICE 386-789-1700

FAX 386-789-0796

www.davesfenceinc.com

INSTALLATION AND REPAIRS ON ALL TYPES OF FENCING

Proposal Submitted to : _____ Job Name: SAME Date: 2/13/2024

Street: 610 S CENTRAL AVE Job Location: SAME

City, State, and Zip: FLAGLER BCH FL 32136 Contact: _____

Phone: _____ Bus. Phone: _____ Cell: _____ Fax: _____

We Hereby Submit Specifications and Estimate For:

FURNISH AND INSTALL APPROXIMATELY 27' OF 3' HIGH PVC PICKET FENCE.

INCLUDES 0 GATE WITH ALUMINUM I BEAMS IN HINGE AND LATCH POST. ALL POSTS SET IN CONCRETE

INCLUDES LIFETIME GATE ADJUSTMENTS @ NO CHARGE.

PVC Vinyl PICKET	Aluminum	Wood	Chain Link
Style MCKINLEY	Style	Style	Gal Black Green
Height 3'	Height	Height	Height
Color WHITE	Color	Picks	Resid LghtCom Comm
Post 8'o/c 5"X5"X9'	Grade	Runners	Terminals
Caps FLAT	Caps	Post	Line Post
Walk Gate N/A	Walk Gate	Gate Post	Top Rail
Walk Gate N/A	Double Gate	Walk Gate	Fabric
DOUBLE GATE N/A	Picket Spacing	Gate	Bottom T-wire
Please Read: Wood fence has a 20 year manufacturer warranty against rot, decay, and termites. Warranty does not cover warping, splitting or cracking of any portion of the wood fence. Dave's fence recommends applying a water proofing sealant to help reduce cosmetic flaws in wood products.			Walk Gate
			Double Gate
			Gate
			Locate #

GENERAL INSTALLATION INFORMATION

Permit- DAVES	Clearing N/A	Cust Initial Drawing YES
Survey W/ PAPER WORK	Take Down 27'	Grade Changes YES
Cross St 7TH ST	Haul Away YES	Severity MINOR
HOA APPROVAL-- N/A	Open Pool NO	Location of Grade N/A
N.O.C. DAVES	Dog/SIZE NO N/A	Fence Straight on top NO
Requested Installation Date: _____		Fence Contour to ground YES

All material is guaranteed to be specified. All work to be completed in substantial workmanlike manner according to specifications submitted per standard practices. Any alteration or deviation from above specifications involving extra costs will be executed only upon written orders, and will become an extra charge over and above the estimate. All materials remain the property of Dave's Fence until contract is paid in full. Right of access and removal is hereby granted in the event of non payment as agreed. Not responsible for damage to underground lines that cannot be located.

According to Florida's construction Lien Law (sections 713.001-713.37, Florida statutes), those who work on your property or provide materials and are not paid in full have a right to enforce their claim for payment against your property. This claim is known as a construction lien. If your contractor or a subcontractor fails to pay subcontractors or material suppliers or neglects to make other legally required payments, the people who are owed money may look to your property for payment, even if you have paid your contract in full. If you fail to pay your contractor, your contractor may also have a lien on your property. This means if a lien is filed your property could be sold against your will to pay for labor, materials, or other services that your contractor or a subcontractor may have failed to pay. To protect yourself, you should stipulate in this contract that before any payment is made your contractor is required to provide you with a written release of lien from any person or company that has provided to you a "notice to owner." Florida's construction lien law is complex and it is recommended that, whenever a specific problem arises, you consult an attorney.

Acceptance of proposal- The above prices, specifications and conditions are satisfactory and are hereby accepted. You are authorized to do the work specified. Payment will be made as outlined above.

SIGNATURE _____ Date: _____

SIGNATURE _____ Date: _____

Estimated Installation Date	4 TO 12 WKS
Base Price	\$1,400
Permit +	\$200
N.O.C. +	
Total Price =	\$1,600

Retainer \$800

Balance due upon completion: \$800

Once proposal is accepted by Dave's Fence the proposal becomes a binding contract and is not subject to cancellation. Initials _____

This proposal may be withdrawn by Dave's Fence if not accepted within 21 days.

Company Representative:

SCOTT 386-232-9200

scottb.davesfence@gmail.com

Application Form

Small Redevelopment District Grant Program

NAME: VINCENTI CORRAO Own ☒ Lease ☐
PROPERTY ADDRESS: 612 SOUTH CENTRAL AVE FL 32136
MAILING ADDRESS: 512 NORTH DAYTONA AVE FL 32136
PROPERTY ID # (on taxes) 1212312550 00000110 CURRENT USE RENTAL
TELEPHONE: _____ (DAY) _____ (EVENING)
EMAIL: VICORRAO59@gmail.com

TYPE OF IMPROVEMENT PLANNED: (Attach a written summary)

PROJECT PROPOSAL ON IMPROVEMENTS (Not all inclusive, see procedures and guidelines for full requirements)

- A written summary of the scope of work to be performed.
- Digital color photographs clearly showing existing conditions of the facade, neighboring buildings and public entrances
- Site/Sketch plans and specifications detailing the scope of work that will be required at the time of application and will be further developed at the project review conference.
- Samples of all paint colors, signage and awnings materials to be used on the building (if applicable)
- An all inclusive estimate supporting project costs. At least two (2) estimates must be provided.

ESTIMATED TOTAL COST OF PROPOSED IMPROVEMENTS: \$ 980
GRANT APPLICATION MOUNT: \$ 980

I UNDERSTAND THAT IN ORDER FOR MY REQUEST FOR GRANT FUNDING TO BE APPROVED, I MUST AGREE TO THE FOLLOWING CONDITIONS:

- To follow the design recommendations as approved by the CRA Board and the City of Flagler Beach Ordinances. I further agree to maintain all improvements and not to alter the project for a period of three (3) years without approval from the CRA. Acknowledgement of notification ☒
- To adhere to the Application Procedures and Guidelines and the Grant Agreement as specified. Acknowledgement of notification ☒
- That I shall incur all initial project costs and receive reimbursement only after:
 - All improvements have been completed.
 - Final inspections of the improvements are approved and accepted by the CRA and Building Official.
 - Proof of payment for project costs have been received and verified.
- Additional improvements or changes not approved will not be funded. Acknowledgement of notification ☒
- Grant awards will be based on lowest bid unless approved by the CRA Board. Acknowledgement of notification ☒
- Attendance at the CRA Board meeting when this application is reviewed is mandatory. Acknowledgement of notification ☒

I ACKNOWLEDGE THAT I HAVE RECEIVED AND UNDERSTAND THE DESIGN GUIDELINES, THE REDEVELOPMENT DISTRICT GRANT PROGRAM PROCEDURES AND THE GRANT AGREEMENT.

APPLICANT SIGNATURE Vincenti Corrao

DATE 2/20/24

Flagler Beach CRA Grant Fencing Replacement

randy SMITH <resmith2007@bellsouth.net>

Tue 2/20/2024 9:01 AM

To:randy SMITH <resmith2007@bellsouth.net>

Requesting CRA Grant funds to replace the existing 20-year-old picket fence along Central Ave. This fence is damaged and has been abused by passerby people over the years. It is a white 4' high picket fence which runs along Central Ave over 8 properties. Pricing includes removal and disposal of old fencing and replaced with new fencing which will be same white picket look with stainless steel hardware at the three gates.

Properties affected:

600 South Central Ave
602 South Central Ave
604 South Central Ave
606 South Central Ave
608 South Central Ave
610 South Central Ave
612 South Central Ave
614 South Central Ave.

PROPOSED BUILDING 5
FINISH FLOOR 19.0 +/-
(Match Adjacent Building)

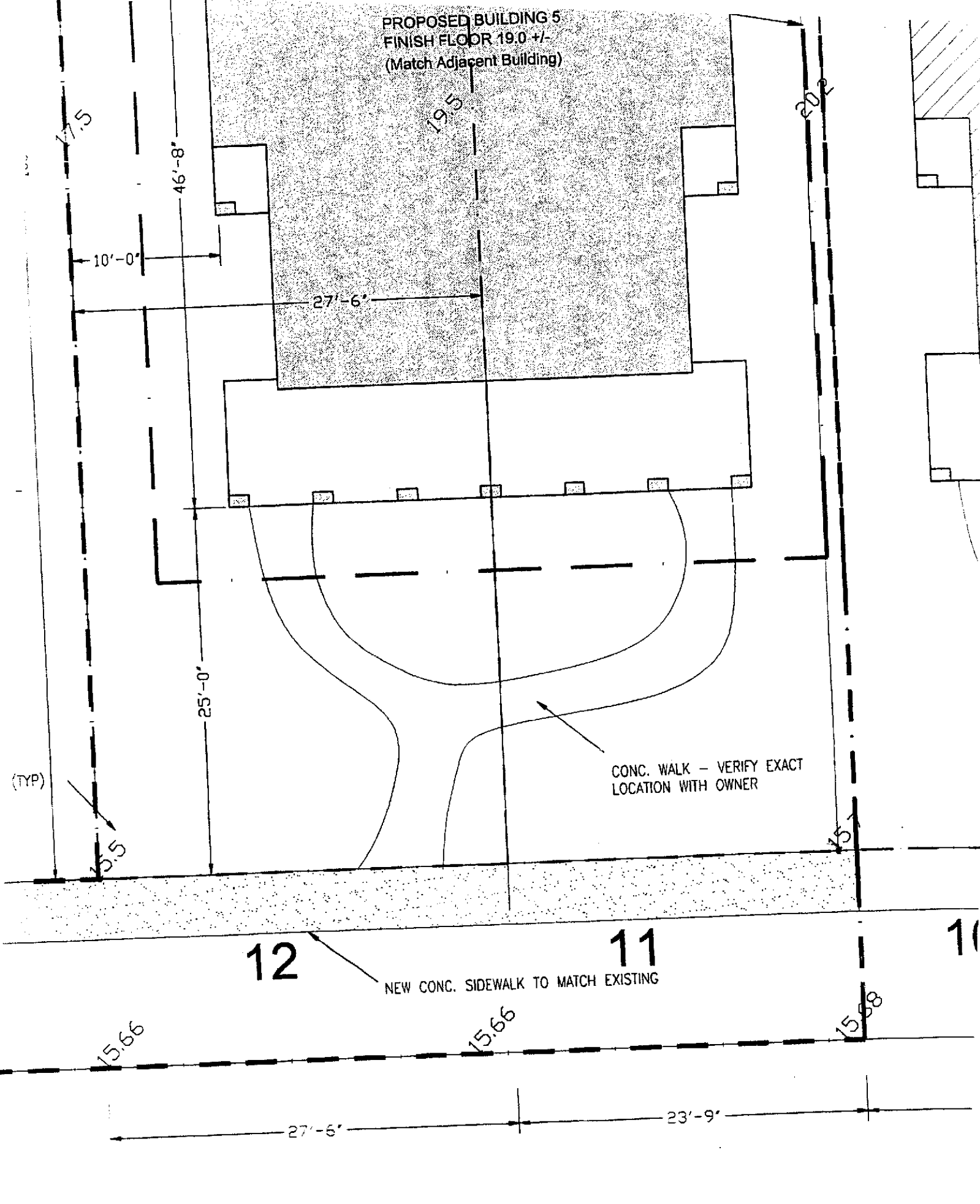



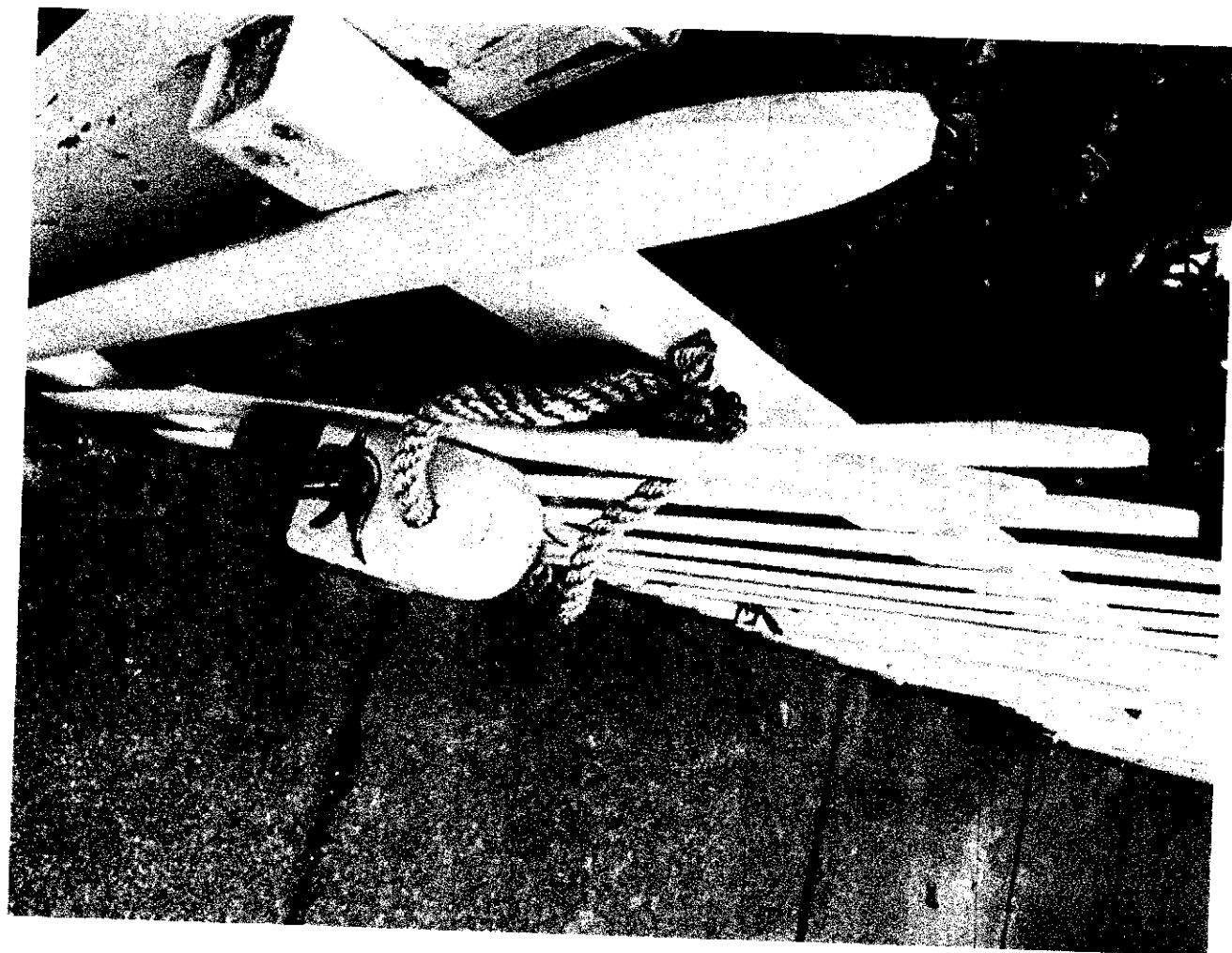

LEX FENCING INC.

Professional Fence Installation and Repairs.
Licensed & Insured

(386) 263 7888

Email: lexfencing@yahoo.com

Date: 3-1-24

ESTIMATE

Name: Randy Smith

Address: 610 S. Central Ave FB

Phone: 386-264-9222

RESmith2007@

Email: bellsouth.net

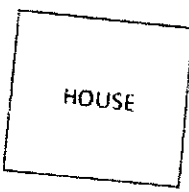
Style of Fence: <u>Vinyl</u>			Top Picket fence	
Color: <u>White spear</u>				
Height: 3' 4' 5' 6'				
Number of Gates: <u>3</u>				
Gates: <input type="checkbox"/> Pool Code <input checked="" type="checkbox"/> Standard				Underground Utilities <input type="checkbox"/> Irrigation <input type="checkbox"/> Electricity <input type="checkbox"/> Telephone <input type="checkbox"/> Water <input type="checkbox"/> Gas <input type="checkbox"/> Other ()
CAPS <input type="checkbox"/> Standard <input type="checkbox"/> New England <input type="checkbox"/> Gothic <input checked="" type="checkbox"/> Other (<u>11 Caps</u>)				Other tools <input type="checkbox"/> Core drill <input type="checkbox"/> Jack Hammer <input type="checkbox"/> Chain saw
OLD FENCE <input checked="" type="checkbox"/> Remove <input checked="" type="checkbox"/> Disposal <input type="checkbox"/> Leave at the job		OBSERVATIONS: <u>1000 : 90'</u> <u>1002 : 22'</u> <u>1004 : 28'</u> <u>1006 : 23' w/gate</u> <u>1008 : 13' w/gate</u> <u>1010 : 26'</u> <u>1012 : 20' w/gate</u> <u>1014 : 50'</u>		Gate Hardware <input checked="" type="checkbox"/> Standard <input type="checkbox"/> Upgrade (self-closing stainless steel hinges and lock latches with keys)
Property Grade <input checked="" type="checkbox"/> Follow the grade <input type="checkbox"/> Straight top				INSTALLED PRICE: \$8,118.54 (Price includes taxes, materials, labor and permit)
Dirt:				

Note: Each price includes Permit and Removal and disposal

On vinyl fences, all virgin material with lifetime warranty. Price includes 120 lbs of concrete per post; 160 lbs of concrete and aluminum inserter on gate post.

Palm Coast Fencing Inc.

Professional Fence Installation & Repairs
Licensed & Insured 20 Years of Experience

(386)-346-1300

Estimate



Name: Randy Smith

Address: 610 South Central Ave

Date: 02/18/24

Phone: (386) 264-9222

Email: Resmith2007@bellsouth.net

Fence

Style: Vinyl (picket fence)

Color: white

Height: 6' 5' (4) 3'

Gates

Quantity: 3

Pool Code ☐

Caps

Standard ☒

Other: _____

Old Fence

Remove & Disposal ☒

Remove & Leave on site ☐

INSTALLED PRICE:

\$6,960.00

(Price includes taxes, materials, labor and permit)

Observations:

Install 223' of 4' high white Vinyl (picket fence) with 3 gates.

* Removed and disposal of existing fence is included in the price.

PVC posts will be 30"-36" in the ground and 120 pounds of concrete will be used per post. Self-closing stainless steel hinges and lock latches with keys are included in the price. Stainless steel drop-rods for double gates are included. Lifetime warranty on material and 5 years on labor.

As soon as we have approval, planning can begin for this job. A down payment of 50% of the total price is required at the time of agreement contract signing. Remaining balance is due upon completion of job.

*Credit/debit card payments may be subject to a 3% merchant fee.

This estimate is valid for 15 days. After this period, you have the option to call and verify if the material price has changed.

\$1,425. ⁰⁰	\$980. ⁰⁰	\$815. ⁰⁰	\$874. ⁰⁰	\$980. ⁰⁰	\$895. ⁰⁰	\$630. ⁰⁰	\$1,160. ⁰⁰
614	612	610	608	606	604	602	600

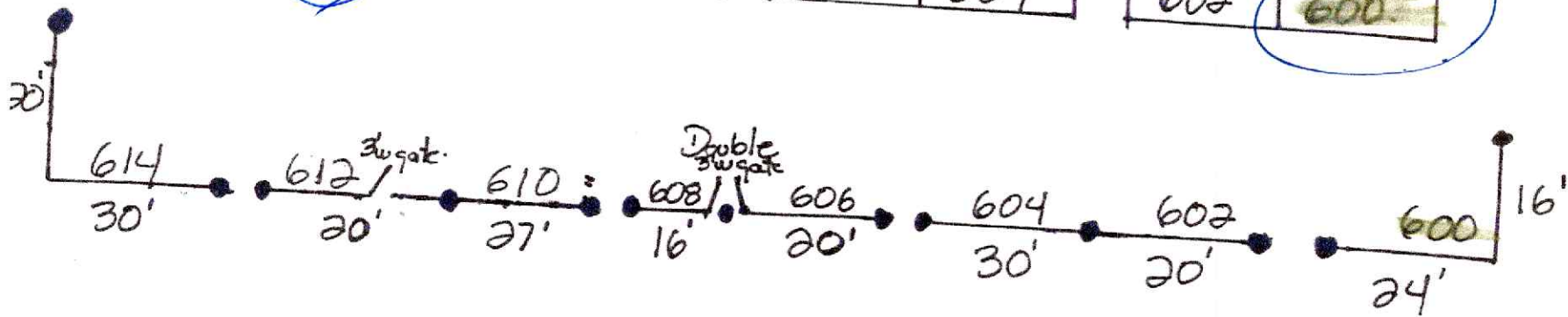

610 South Central Ave.

Randy Smith

(386) 264-9222.

email: Resmith2007@bellsouth.net.

Palm Coast Fencing Inc.

Scanned with CamScanner

PO BOX 530489
DEBARY, FL 32753-0489

VISA

MasterCard



OFFICE 386-789-1700

FAX 386-789-0796

www.davesfenceinc.com

INSTALLATION AND REPAIRS ON ALL TYPES OF FENCING

Proposal Submitted to :		Job Name: SAME	Date: 2/13/2024
Street:	612 S CENTRAL AVE	Job Location: SAME	
City, State, and Zip:	FLAGLER BCH FL 32136	Contact:	
Phone:	Bus. Phone:	Cell:	Fax:

We Hereby Submit Specifications and Estimate For:

FURNISH AND INSTALL APPROXIMATELY 20' OF 3' HIGH PVC PICKET FENCE.

INCLUDES 1 GATE WITH ALUMINUM I BEAMS IN HINGE AND LATCH POST. ALL POSTS SET IN CONCRETE

INCLUDES LIFETIME GATE ADJUSTMENTS @ NO CHARGE.

PVC Vinyl PICKET	Aluminum	Wood	Chain Link
Style MCKINLEY	Style	Style	Gal Black Green
Height 3'	Height	Height	Height
Color WHITE	Color	Picks	Resid LghtCom Comm
Post 8'o/c 5"X5"X9'	Grade	Runners	Terminals
Caps FLAT	Caps	Post	Line Post
Walk Gate 1 @ 4FT	Walk Gate	Gate Post	Top Rail
Walk Gate N/A	Double Gate	Walk Gate	Fabric
DOUBLE GATE N/A	Picket Spacing	Gate	Bottom T-wire
Please Read: Wood fence has a 20 year manufacturer warranty against rot, decay, and termites. Warranty does not cover warping, splitting or cracking of any portion of the wood fence. Dave's Fence recommends applying a water proofing sealant to help reduce cosmetic flaws in wood products.			Walk Gate
			Double Gate
			Gate
			Locate #

GENERAL INSTALLATION INFORMATION

Permit- DAVES	Clearing N/A	Cust Initial Drawing YES
Survey W/ PAPER WORK	Take Down 20'	Grade Changes YES
Cross St 7TH ST	Haul Away YES	Severity MINOR
HOA APPROVAL-- N/A	Open Pool NO	Location of Grade N/A
N.O.C. DAVES	Dog/SIZE NO N/A	Fence Straight on top NO
		Fence Contour to ground YES

Requested Installation Date:

All material is guaranteed to be specified. All work to be completed in substantial workmanlike manner according to specifications submitted per standard practices. Any alteration or deviation from above specifications involving extra costs will be executed only upon written orders, and will become an extra charge over and above the estimate. All materials remain the property of Dave's Fence until contract is paid in full. Right of access and removal is hereby granted in the event of non payment as agreed. Not responsible for damage to underground lines that cannot be located.

According to Florida's construction Lien Law (sections 713.001-713.37, Florida statutes), those who work on your property or provide materials and are not paid in full have a right to enforce their claim for payment against your property. This claim is known as a construction lien. If your contractor or a subcontractor fails to pay subcontractors or material suppliers or neglects to make other legally required payments, the people who are owed money may look to your property for payment, even if you have paid your contract in full. If you fail to pay your contractor, your contractor may also have a lien on your property. This means if a lien is filed your property could be sold against your will to pay for labor, materials, or other services that your contractor or a subcontractor may have failed to pay. To protect yourself, you should stipulate in this contract that before any payment is made your contractor is required to provide you with a written release of lien from any person or company that has provided to you a "notice to owner." Florida's construction lien law is complex and it is recommended that, whenever a specific problem arises, you consult an attorney.

Acceptance of proposal- The above prices, specifications and conditions are satisfactory and are hereby accepted. You are authorized to do the work specified. Payment will be made as outlined above.

SIGNATURE _____ Date: _____
SIGNATURE _____ Date: _____

Estimated Installation Date	4 TO 12 WKS
Base Price	\$1,500
Permit +	\$200
N.O.C +	
Total Price =	\$1,700

Retainer \$850

Balance due upon completion: \$850

Once proposal is accepted by Dave's Fence the proposal becomes a binding contract and is not subject to cancellation. Initials _____

This proposal may be withdrawn by Dave's Fence if not accepted within 21 days.

Company Representative:

SCOTT 386-232-9200

scottb.davesfence@gmail.com

Application Form

Small Redevelopment District Grant Program

NAME: JOSEPH YOUNG Own ☒ Lease ☐
PROPERTY ADDRESS: 614 SOUTH CENTRAL AVE
MAILING ADDRESS: SAME
PROPERTY ID # (on taxes) 12-12-31-2550-0000-0129 CURRENT USE HOME
TELEPHONE: 815-383-3837 (DAY) SAME (EVENING)
EMAIL: JOE.YOUNG.CRA@GMAIL.COM
TYPE OF IMPROVEMENT PLANNED: (Attach a written summary)

PROJECT PROPOSAL ON IMPROVEMENTS (Not all inclusive, see procedures and guidelines for full requirements)

- A written summary of the scope of work to be performed.
- Digital color photographs clearly showing existing conditions of the facade, neighboring buildings and public entrances
- Site/Sketch plans and specifications detailing the scope of work that will be required at the time of application and will be further developed at the project review conference.
- Samples of all paint colors, signage and awnings materials to be used on the building (if applicable)
- An all inclusive estimate supporting project costs. At least two (2) estimates must be provided.

ESTIMATED TOTAL COST OF PROPOSED IMPROVEMENTS: \$ 1,425
GRANT APPLICATION MOUNT: \$ 1,068.75 75%

I UNDERSTAND THAT IN ORDER FOR MY REQUEST FOR GRANT FUNDING TO BE APPROVED, I MUST AGREE TO THE FOLLOWING CONDITIONS:

- To follow the design recommendations as approved by the CRA Board and the City of Flagler Beach Ordinances. I further agree to maintain all improvements and not to alter the project for a period of three (3) years without approval from the CRA. Acknowledgement of notification 3x
- To adhere to the Application Procedures and Guidelines and the Grant Agreement as specified.
Acknowledgement of notification 3x
- That I shall incur all initial project costs and receive reimbursement only after:
 - All improvements have been completed.
 - Final inspections of the improvements are approved and accepted by the CRA and Building Official.
 - Proof of payment for project costs have been received and verified.
- Additional improvements or changes not approved will not be funded.
Acknowledgement of notification 3x
- Grant awards will be based on lowest bid unless approved by the CRA Board.
Acknowledgement of notification 3x
- Attendance at the CRA Board meeting when this application is reviewed is mandatory.
Acknowledgement of notification 3x

I ACKNOWLEDGE THAT I HAVE RECEIVED AND UNDERSTAND THE DESIGN GUIDELINES, THE REDEVELOPMENT DISTRICT GRANT PROGRAM PROCEDURES AND THE GRANT AGREEMENT.

APPLICANT SIGNATURE James
DATE 02-21-2024

Flagler Beach CRA Grant Fencing Replacement

randy SMITH <resmith2007@bellsouth.net>

Tue 2/20/2024 9:01 AM

To:randy SMITH <resmith2007@bellsouth.net>

Requesting CRA Grant funds to replace the existing 20-year-old picket fence along Central Ave. This fence is damaged and has been abused by passerby people over the years. It is a white 4' high picket fence which runs along Central Ave over 8 properties. Pricing includes removal and disposal of old fencing and replaced with new fencing which will be same white picket look with stainless steel hardware at the three gates.

Properties affected:

600 South Central Ave

602 South Central Ave

604 South Central Ave

606 South Central Ave

608 South Central Ave

610 South Central Ave

612 South Central Ave

614 South Central Ave.

PROPOSED BUILDING 5
FINISH FLOOR 19.0 +/-
(Match Adjacent Building)

17.5
46'-8"
10'-0"
27'-6"
19.5
20.2
25'-0"
15.5
15.66
15.68
12
11
1
27'-6"
23'-9"

(TYP)

CONC. WALK - VERIFY EXACT LOCATION WITH OWNER

NEW CONC. SIDEWALK TO MATCH EXISTING



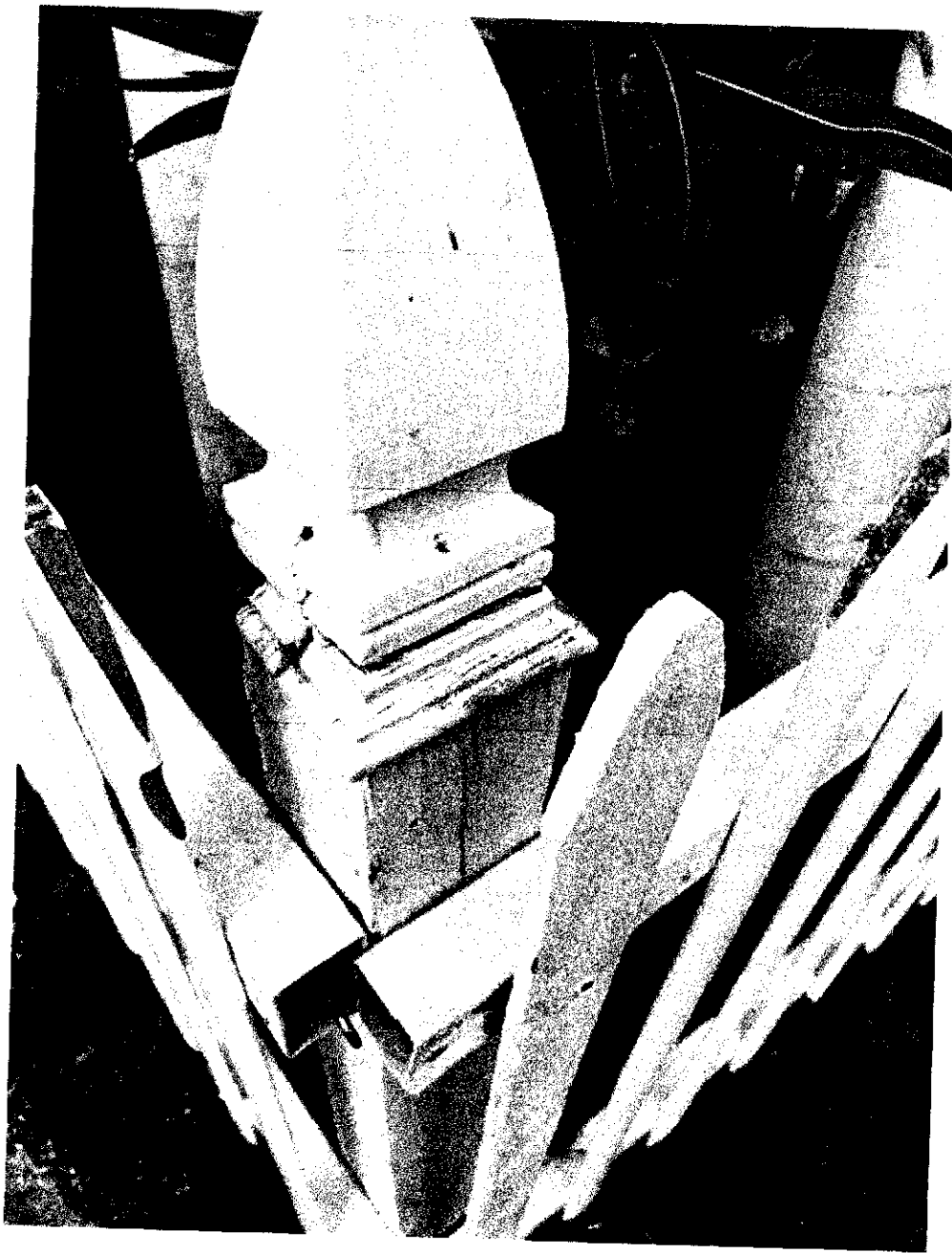

LEX FENCING INC.

Professional Fence Installation and Repairs.
Licensed & Insured

(386) 263 7888

Email: lexfencing@yahoo.com

Date: 3-1-24

ESTIMATE

Name: Randy Smith

Address: 610 S. Central Ave FB

Phone: 386-264-9222

RESMITH2007@

Email: bellsouth.net

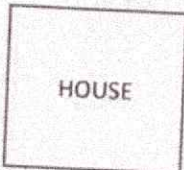
Style of Fence: <u>Vinyl</u>			Underground Utilities <input type="checkbox"/> Irrigation <input type="checkbox"/> Electricity <input type="checkbox"/> Telephone <input type="checkbox"/> Water <input type="checkbox"/> Gas <input type="checkbox"/> Other ()	
Color: <u>White spear Top Preket fence</u>			Other tools <input type="checkbox"/> Core drill <input type="checkbox"/> Jack Hammer <input type="checkbox"/> Chain saw	
Height: 3' 4' 5' 6'			Gate Hardware <input checked="" type="checkbox"/> Standard <input type="checkbox"/> Upgrade (self-closing stainless steel hinges and lock latches with keys)	
Number of Gates: <u>3</u>			INSTALLED PRICE: \$8,118.54 (Price includes taxes, materials, labor and permit)	
Gates: <input type="checkbox"/> Pool Code <input type="checkbox"/> Standard				
CAPS <input type="checkbox"/> Standard <input type="checkbox"/> New England <input type="checkbox"/> Gothic <input type="checkbox"/> Other (<u>11 Caps</u>)				
OLD FENCE <input checked="" type="checkbox"/> Remove <input checked="" type="checkbox"/> Disposal <input type="checkbox"/> Leave at the job		OBSERVATIONS: <u>600: 40'</u> <u>1,462.80</u> <u>602: 22'</u> <u>804.54</u> <u>604: 28'</u> <u>1,023.96</u> <u>606: 23' w/gate</u> <u>841.11</u> <u>608: 13' w/gate</u> <u>475.41</u> <u>610: 20'</u> <u>950.82</u> <u>612: 20' w/gate</u> <u>731.40</u> <u>614: 50'</u> <u>1,828.50</u>		
Property Grade <input type="checkbox"/> Follow the grade <input checked="" type="checkbox"/> Straight top				
Dirt:				

Note: Each price includes Permit, and Removal and disposal

- On vinyl fences, all virgin material with lifetime warranty. Price includes 120 lbs of concrete per post; 160 lbs of concrete and aluminum inserter on gate post.

Palm Coast Fencing Inc.

Professional Fence Installation & Repairs
Licensed & Insured 20 Years of Experience

(386)-346-1300 **Estimate**



604

Name: Randy Smith Date: 02/18/24
Address: 610 South Central Ave. Flagler Beach.
Phone: (386) 264-9222 Email: Rsmith2007@bellsouth.net

	Fence Style: <u>Vinyl (picket fence)</u> Color: <u>white</u> Height: 6' 5' @ 3'
	Gates Quantity: <u>3</u> Pool Code <input type="checkbox"/> Caps Standard <input checked="" type="checkbox"/> Other: _____
Observations: <u>Install 223' of 4' high white Vinyl (picket fence) with 3 gates.</u> <u>* Removed and disposal of existing fence is included in the price.</u>	Old Fence Remove & Disposal <input checked="" type="checkbox"/> Remove & Leave on site <input type="checkbox"/> INSTALLED PRICE: <u>\$ 7,760.00</u> (Price includes taxes, materials, labor and permit)

PVC posts will be 30"-36" in the ground and 120 pounds of concrete will be used per post. Self-closing stainless steel hinges and lock latches with keys are included in the price. Stainless steel drop-rods for double gates are included. Lifetime warranty on material and 5 years on labor.

As soon as we have approval, planning can begin for this job. A down payment of 50% of the total price is required at the time of agreement contract signing. Remaining balance is due upon completion of job.

*Credit/debit card payments may be subject to a 3% merchant fee.

This estimate is valid for 15 days. After this period, you have the option to call and verify if the material price has changed.

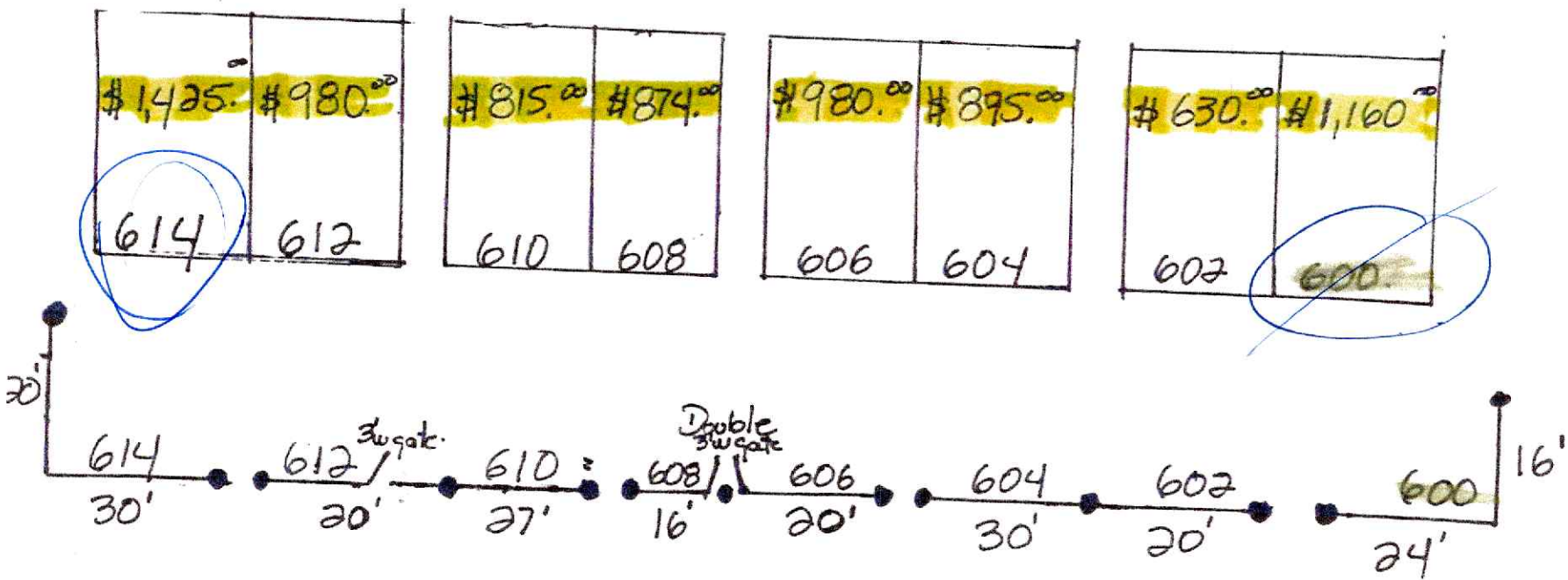

610 South Central Ave.

Randy Smith

(386) 264-9222.

email: Resmith2007@bellsouth.net.

Palm Coast Fencing Inc.

Scanned with CamScanner

1300

PO BOX 530489
DEBARY, FL 32753-0489

VISA

MasterCard

AMERICAN EXPRESS



OFFICE 386-789-1700

FAX 386-789-0796

www.davesfenceinc.com

INSTALLATION AND REPAIRS ON ALL TYPES OF FENCING

Proposal Submitted to :	Job Name: SAME	Date: 2/13/2024
Street: 614 S CENTRAL AVE	Job Location: SAME	
City, State, and Zip: FLAGLER BCH FL 32136	Contact:	
Phone:	Bus. Phone:	Cell:
		Fax:

We Hereby Submit Specifications and Estimate For:

FURNISH AND INSTALL APPROXIMATELY 60' OF 3' HIGH PVC PICKET FENCE.

INCLUDES 0 GATE WITH ALUMINUM I BEAMS IN HINGE AND LATCH POST. ALL POSTS SET IN CONCRETE

INCLUDES LIFETIME GATE ADJUSTMENTS @ NO CHARGE.

PVC Vinyl PICKET	Aluminum	Wood	Chain Link
Style MCKINLEY	Style	Style	Gal Black Green
Height 3'	Height	Height	Height
Color WHITE	Color	Picks	Resid LghtCom Comm
Post 8'o/c 5"X5"X9'	Grade	Runners	Terminals
Caps FLAT	Caps	Post	Line Post
Walk Gate N/A	Walk Gate	Gate Post	Top Rail
Walk Gate N/A	Double Gate	Walk Gate	Fabric
DOUBLE GATE N/A	Picket Spacing	Gate	Bottom T-wire
Please Read: Wood fence has a 20 year manufacturer warranty against rot, decay, and termites. Warranty does not cover warping, splitting or cracking of any portion of the wood fence. Dave's fence recommends applying a water proofing sealant to help reduce cosmetic flaws in wood products.			Walk Gate
			Double Gate
			Gate
			Locate #

GENERAL INSTALLATION INFORMATION

Permit- DAVES	Clearing N/A	Cust Initial Drawing YES
Survey W/ PAPER WORK	Take Down 60'	Grade Changes YES
Cross St 7TH ST	Haul Away YES	Severity MINOR
HOA APPROVAL-- N/A	Open Pool NO	Location of Grade N/A
N.O.C. DAVES	Dog/SIZE NO N/A	Fence Straight on top NO
Requested Installation Date:		Fence Contour to ground YES
All material is guaranteed to be specified. All work to be completed in substantial workmanlike manner according to specifications submitted per standard practices. Any alteration or deviation from above specifications involving extra costs will be executed only upon written orders, and will become an extra charge over and above the estimate. All materials remain the property of Dave's Fence until contract is paid in full. Right of access and removal is hereby granted in the event of non payment as agreed. Not responsible for damage to underground lines that cannot be located.		Estimated Installation Date 4 TO 12 WKS
		Base Price \$2,600
		Permit + \$200
		N.O.C +
		Total Price = \$2,800

According to Florida's construction Lien Law (sections 713.001-713.37, Florida statutes), those who work on your property or provide materials and are not paid in full have a right to enforce their claim for payment against your property. This claim is known as a construction lien. If your contractor or a subcontractor fails to pay subcontractors or material suppliers or neglects to make other legally required payments, the people who are owed money may look to your property for payment, even if you have paid your contract in full. If you fail to pay your contractor, your contractor may also have a lien on your property. This means if a lien is filed your property could be sold against your will to pay for labor, materials, or other services that your contractor or a subcontractor may have failed to pay. To protect yourself, you should stipulate in this contract that before any payment is made your contractor is required to provide you with a written release of lien from any person or company that has provided to you a "notice to owner." Florida's construction lien law is complex and it is recommended that, whenever a specific problem arises, you consult an attorney.

Acceptance of proposal- The above prices, specifications and conditions are satisfactory and are hereby accepted. You are authorized to do the work specified. Payment will be made as outlined above.

SIGNATURE _____ Date: _____
SIGNATURE _____ Date: _____

Retainer \$1,400
Balance due upon completion: \$1,400

Once proposal is accepted by Dave's Fence the proposal becomes a binding contract and is not subject to cancellation. Initials _____

This proposal may be withdrawn by Dave's Fence if not accepted within 21 days.

Company Representative:
SCOTT 386-232-9200
scottb.davesfence@gmail.com