



Legend



-  2023-CU-04_ADU
-  City_Limits



34534 Estes Road
2023-CU-04 for Accessory Dwelling Unit



Legend

-  2023-CU-04_ADU
-  City_Limits



Source: Esri, Maxar, Earthstar Geographics, and the GIS User Community



34534 Estes Road
2023-CU-04 for Accessory Dwelling Unit
Aerial Location



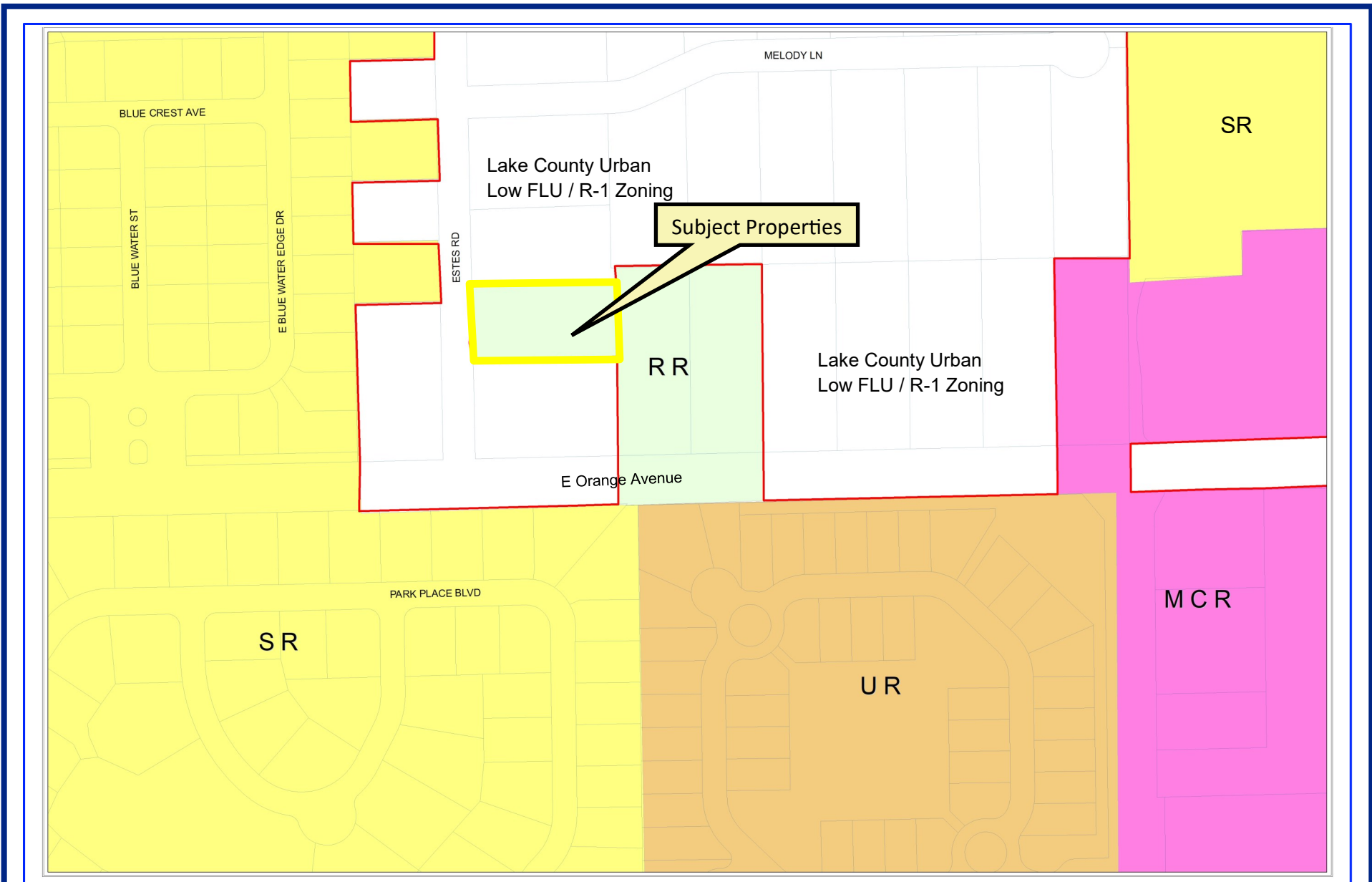

34534 Estes Road
 2023-CU-04 for Accessory Dwelling Unit
 Future Land Use (City)



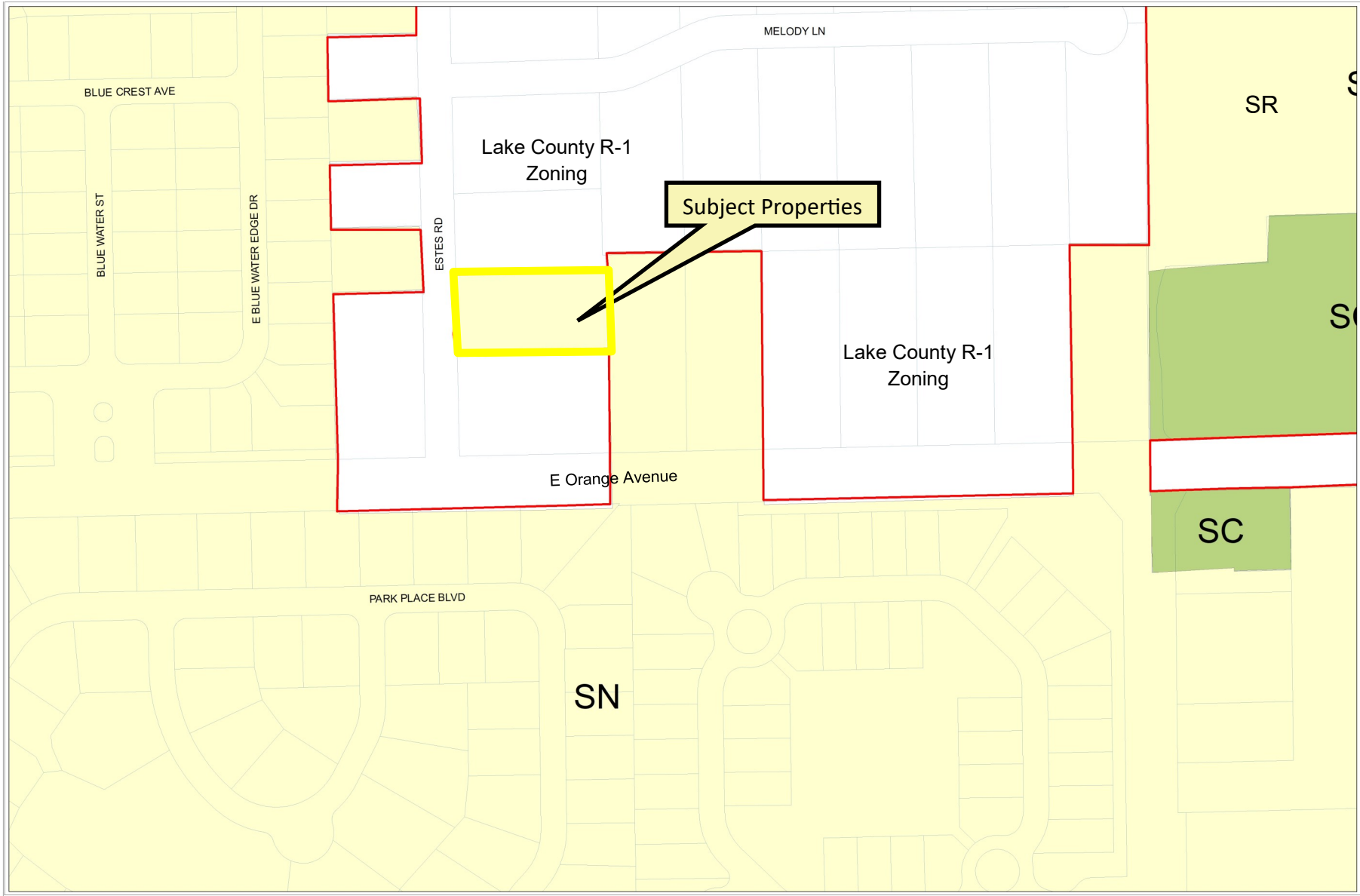

34534 Estes Road
2023-CU-04 for Accessory Dwelling Unit
Design District (City)



Legend

City_Limits

Flood Zones

Zone

A

AE



Flood Zone Map



34534 Estes Road
 2023-CU-04 for Accessory Dwelling Unit



Legend
City_Limits



Wetland Map



34534 Estes Road
2023-CU-04 for Accessory Dwelling Unit



Legend

- Potable_Water
- Sanitary_Sewer
- ▭ City_Limits

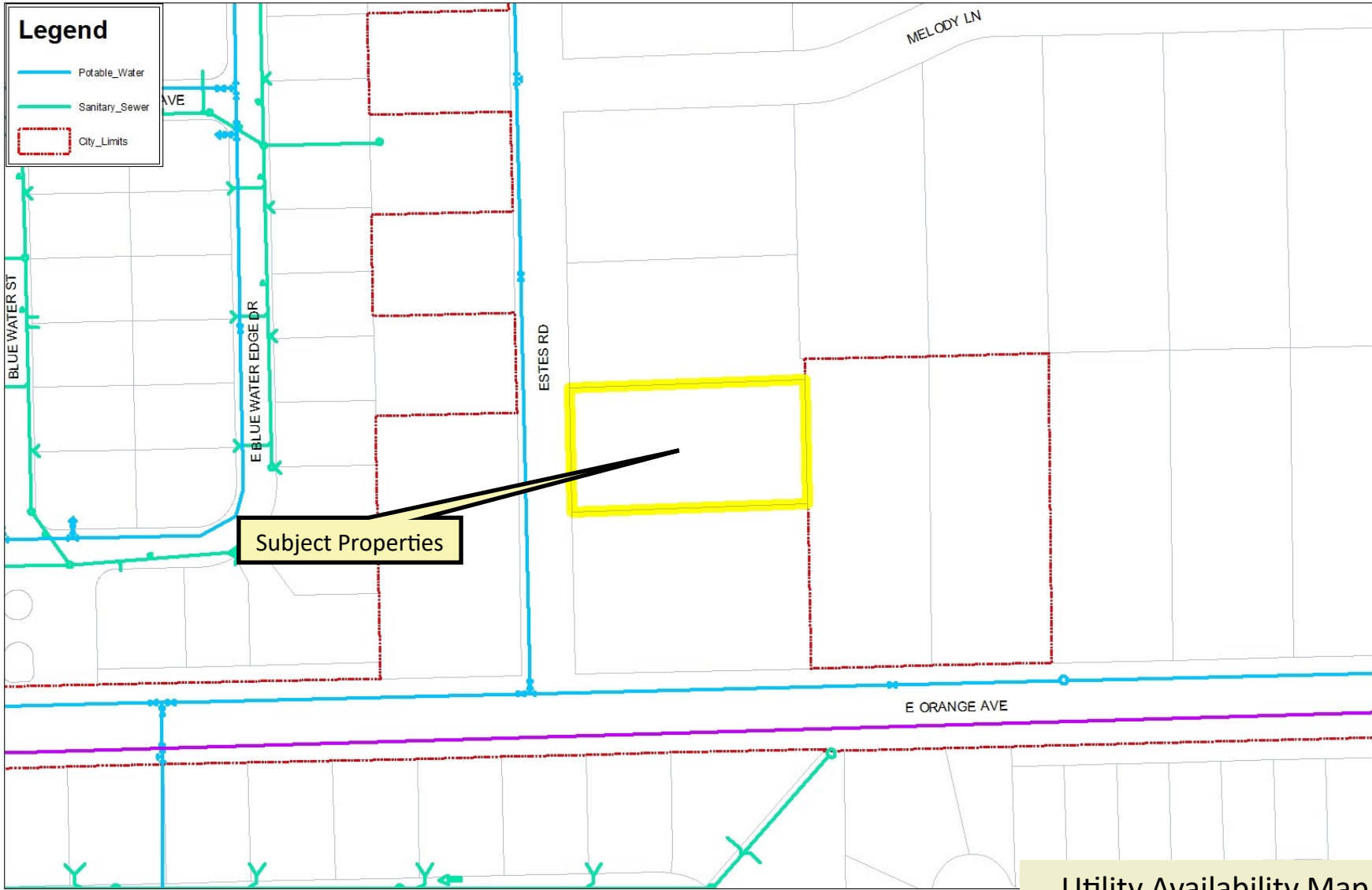

Utility Availability Map



34534 Estes Road
 2023-CU-04 for Accessory Dwelling Unit



Legend

 City_Limits

Potential Recharge

 12 - 20 In/Yr

 More than 20 In/Yr

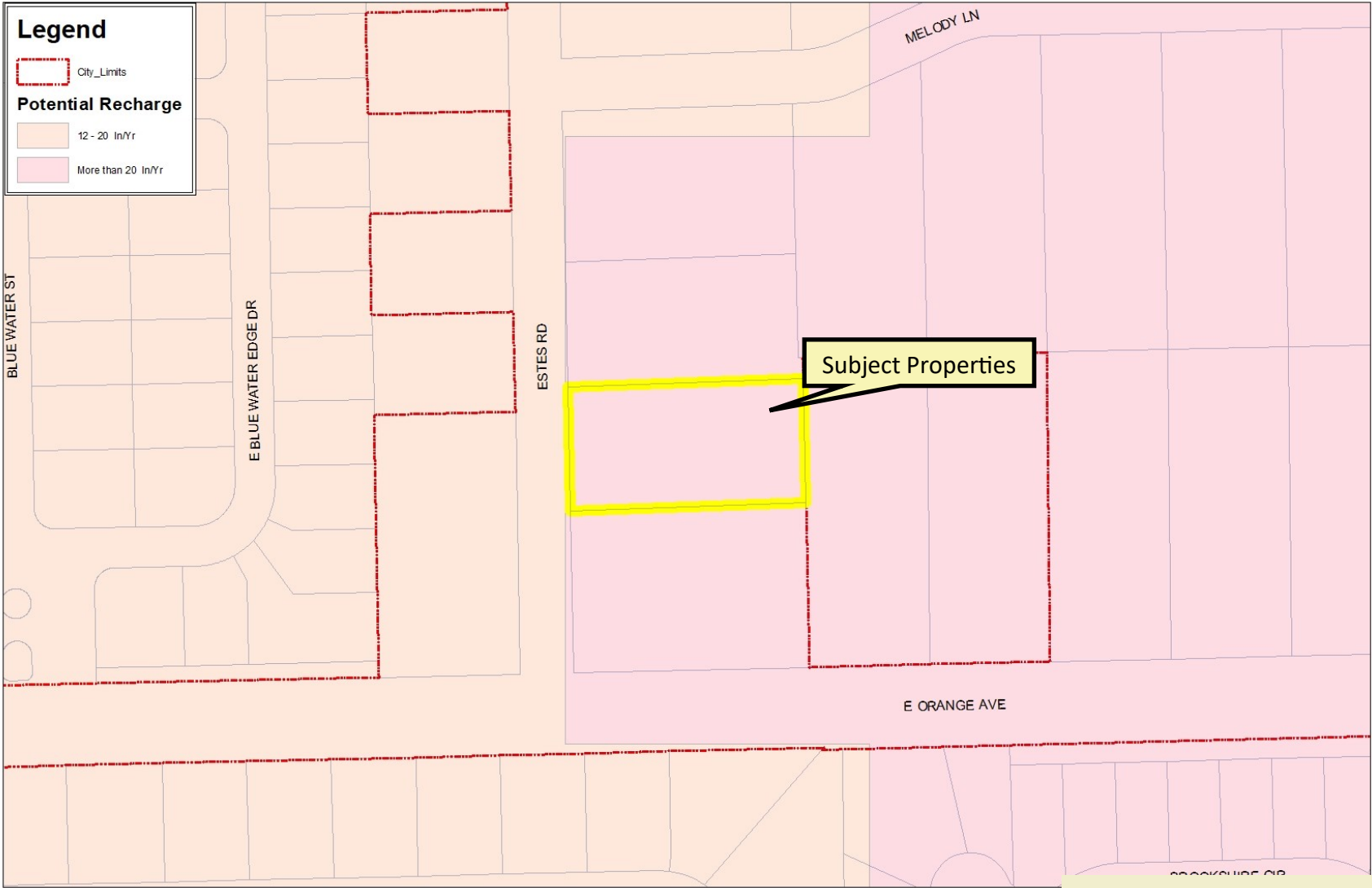

Subject Properties

Potential Recharge Areas



34534 Estes Road
 2023-CU-04 for Accessory Dwelling Unit



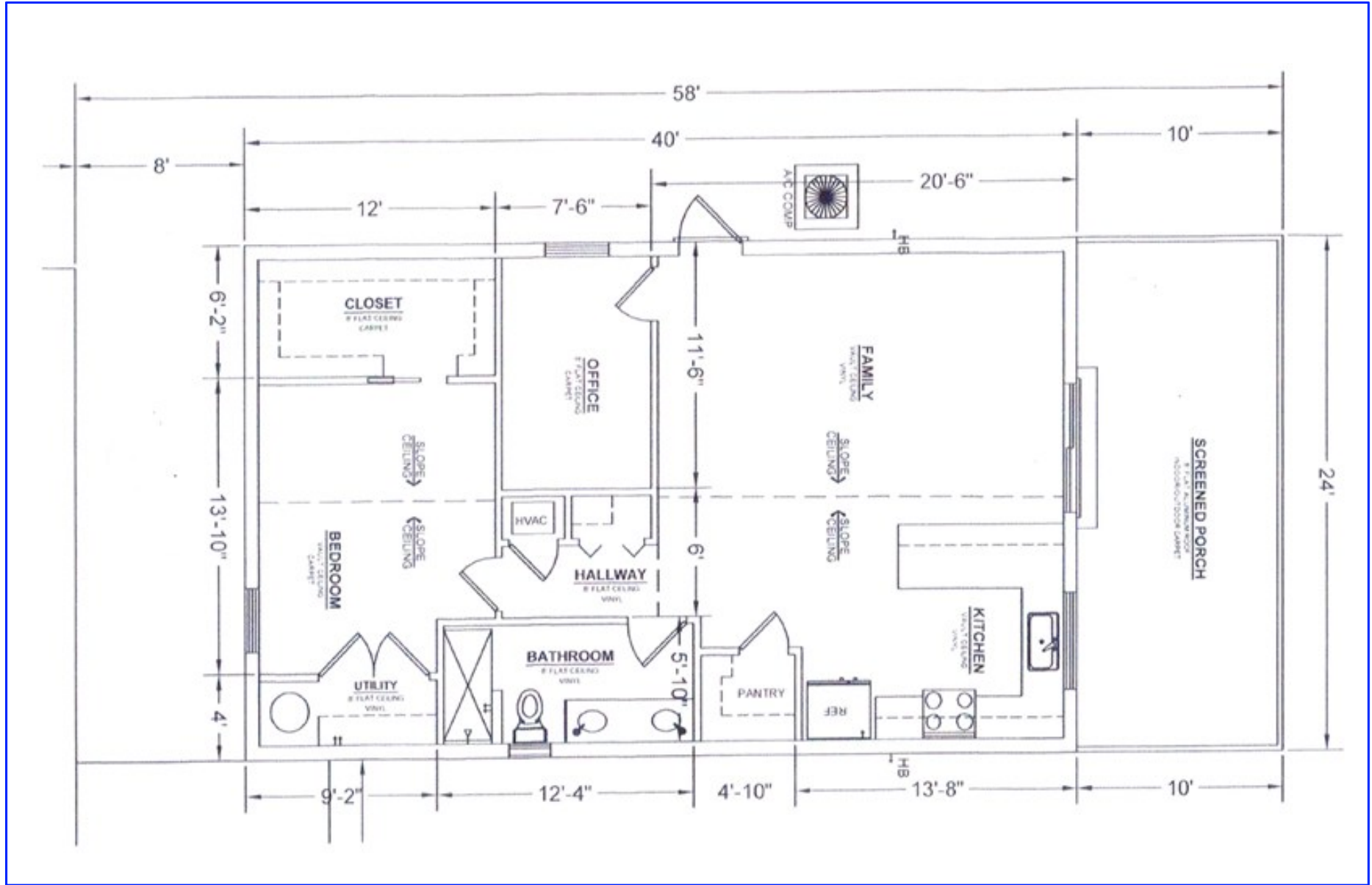

34534 Estes Road
 2023-CU-04 for Accessory Dwelling Unit



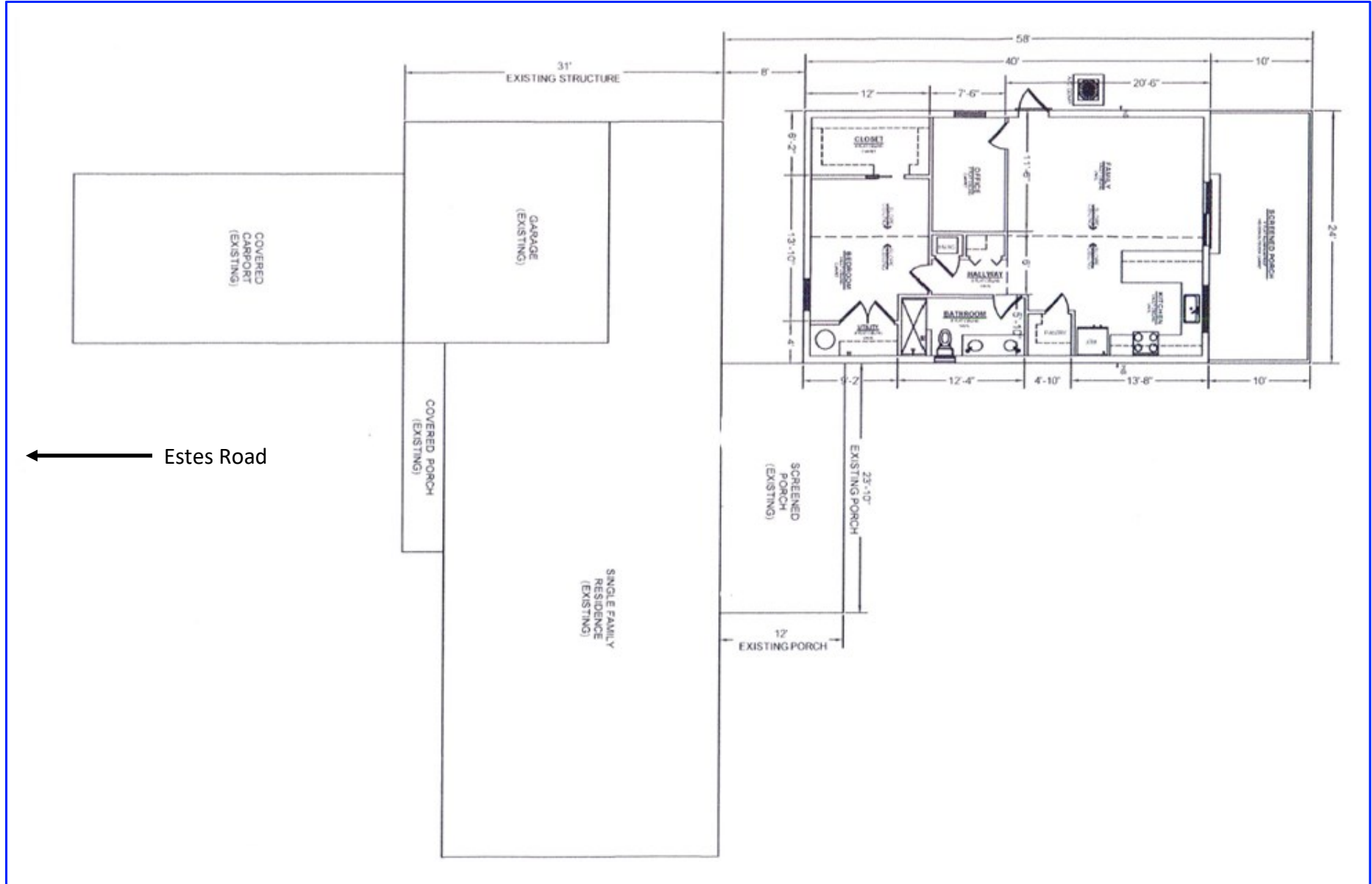

34534 Estes Road
 2023-CU-04 for Accessory Dwelling Unit

