



# City of Eustis

P.O. Drawer 68 • Eustis, Florida 32727-0068 • (352) 483-5430

TO: EUSTIS CITY COMMISSION

FROM: Tom Carrino, City Manager

DATE: July 6, 2023

RE: **FIRST READING**

ORDINANCE NUMBERS 23-18, 23-19, AND 23-20: EXPLANATION OF ORDINANCES FOR ANNEXATION OF PARCELS WITH ALTERNATE KEYS 2666820, 3884298, 3884439, AND 3884441

Ordinance Number 23-18 – Voluntary Annexation

Ordinance Number 23-19 – Comprehensive Plan Amendment

Ordinance Number 23-20 – Design District Assignment

---

**Introduction:**

Ordinance Number 23-18 provides for the voluntary annexation of approximately 5.8 acres of land located east of Coolidge Street south of the unimproved portion of Pine Avenue and north of the unimproved portion of Hollywood Avenue (Alternate Key Numbers 2666820, 3884298, 3884439, and 3884441). Provided the annexation of the subject property is approved, via Ordinance Number 23-18, Ordinance Number 23-19 would change the future land use designation from Urban Low in Lake County to Suburban Residential (SR) in the City of Eustis, and Ordinance Number 23-20 would assign the subject property a design district designation of Suburban Neighborhood. If Ordinance Number 23-18 is denied, then there can be no consideration of Ordinance Numbers 23-19 and 23-20.

**Background:**

1. The site contains approximately 5.8 acres and is located within the Eustis Joint Planning Area. The properties to be annexed are a portion of the Rosenwald Gardens subdivision and a subsequent partial replat dating back to 1954. *Source: Lake County Property Appraisers' Office Property Record Card Data.*
2. The proposed annexation properties are within an enclave area of the City and are contiguous to the City boundaries at several points represented on the Location map, herein.
3. The site has a Lake County land use designation of Urban Low, but approval of Ordinance Number 23-19 would change the land use designation to Suburban Residential (SR) in the City of Eustis.

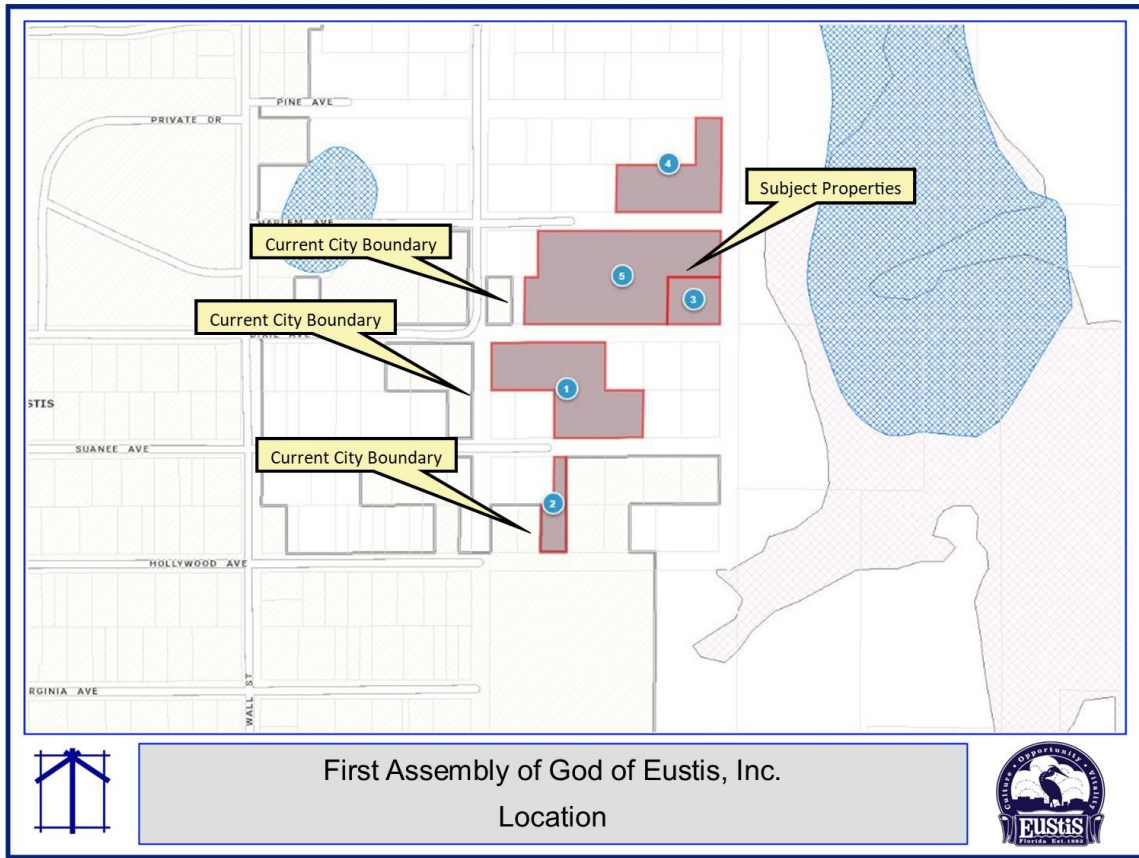

Surrounding properties have the following land use designations:

Location	Existing Use	Future Land Use	Design District
<b>Site</b>	Vacant	Urban Low (Lake County)	N/A
<b>North</b>	Single-Family/ Vacant	Urban Low (Lake County)	N/A
<b>South</b>	Single-Family / Vacant	Suburban Residential	Suburban Neighborhood
<b>East</b>	Vacant	Lake County Urban Low	N/A
<b>West</b>	Single-Family	Suburban Residential	Suburban Neighborhood

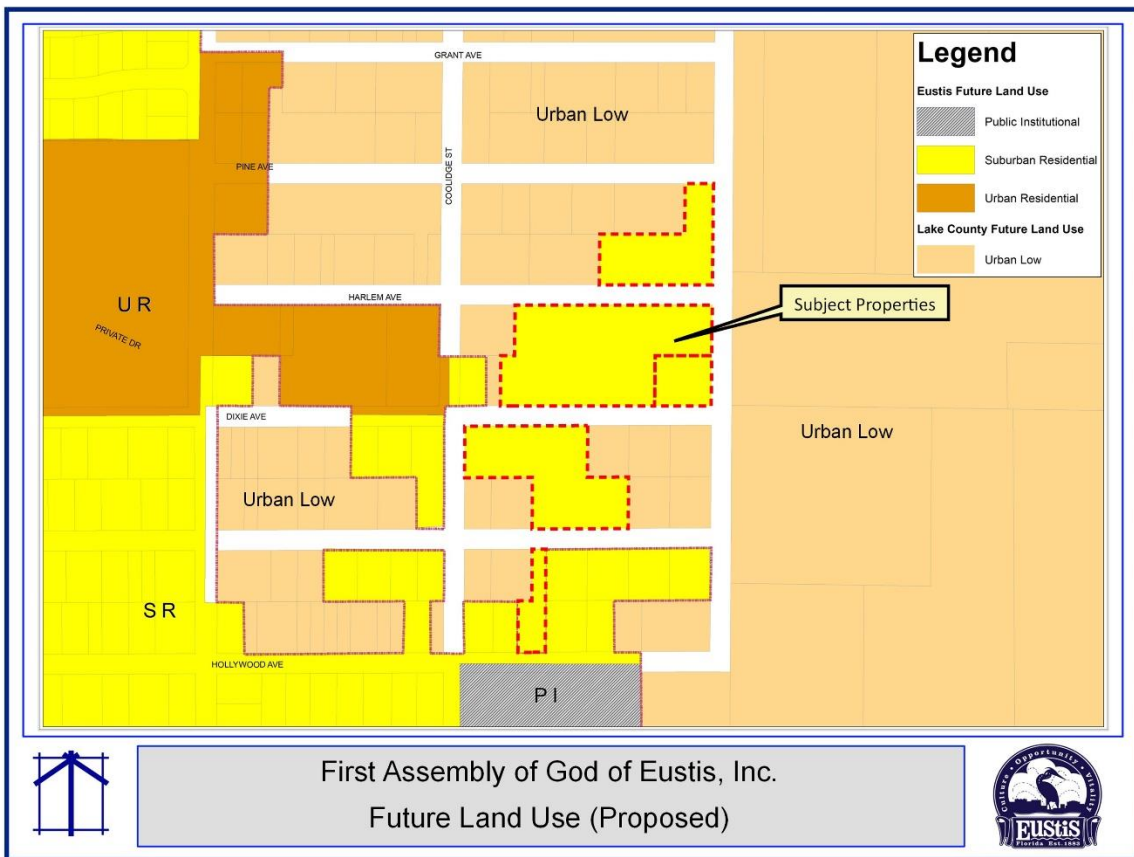
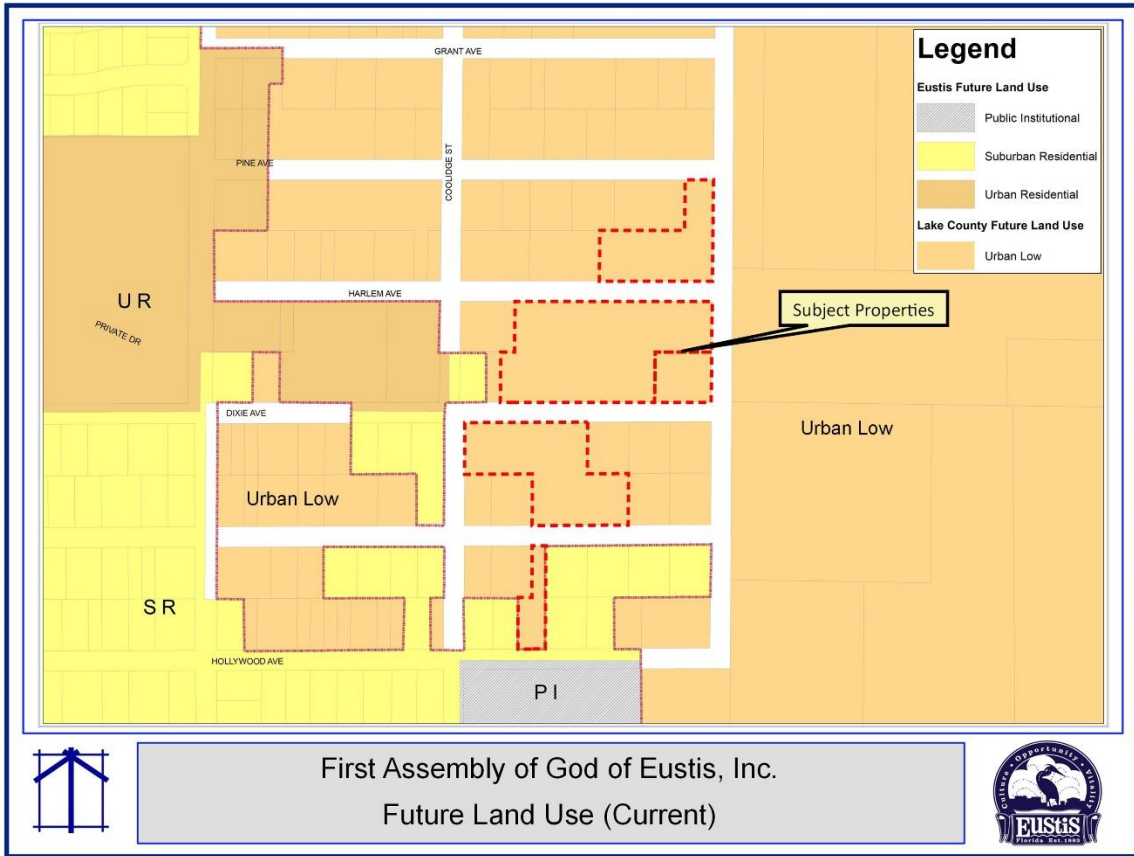

## Applicant's Request

The applicant and property owners, First Assembly of God of Eustis, Inc., wish to annex the referenced property, change the future land use to Suburban Residential (SR), and assign a design district of Suburban Neighborhood.

The current Lake County future land use designation for the subject property is Urban Low. The Lake County land use designation allows for residential uses of up to 4 dwelling units per net buildable acre.

The property owner has requested the City of Eustis Suburban Residential future land use designation with the annexation. The SR future land use provides for residential uses up to five (5) dwelling units per acre.

### Analysis of Annexation Request (**Ordinance Number 23-18**)

1. Resolution Number 87-34 – Joint Planning Area Agreement with Lake County:

“The City and the County agree that the unincorporated areas adjacent to the City might be appropriately served by urban services provided by the City, and might therefore be annexed into the City in accordance with State law.....The City agrees to annex property in accordance with State law and provide adequate urban services and facilities to serve those areas within the Joint Planning Area.”

***The subject property is located within the Eustis-Lake County Joint Planning Area. Urban services of adequate capacity are available to serve future development, consistent with the requested Suburban Residential future land use designation.***

2. Florida Statutes Voluntary Annexation - Chapter 171.044(1):

“The owner or owners of real property in an unincorporated area of a county which is contiguous to a municipality and reasonably compact may petition the governing body of said municipality that said property be annexed to the municipality.”

***The Eustis-Lake County Joint Planning Area boundaries define the reasonably compact area where the City could provide services effectively and efficiently. The subject property lies within that planning area; the property is part of a partial enclave, it is contiguous to the City limits at several points on the western and southern boundaries, and the owner petitioned for annexation.***

3. Florida Statutes Voluntary Annexation - Chapter 171.044(2):

“...Said ordinance shall be passed after notice of the annexation has been published at least once each week for 2 consecutive weeks in some newspaper in such city or town...”

***The department published notice of this annexation in the Daily Commercial following the established requirements on June 26, 2023, and again on June 30, 2023.***

4. Florida Statutes Voluntary Annexation - Chapter 171.044(5):

“Land shall not be annexed through voluntary annexation when such annexation results in the creation of enclaves.”

***Annexation of the subject property does not create an enclave as defined by the Florida Statutes. The subject properties are included in a portion of the city that can be considered a partial or open enclave.***

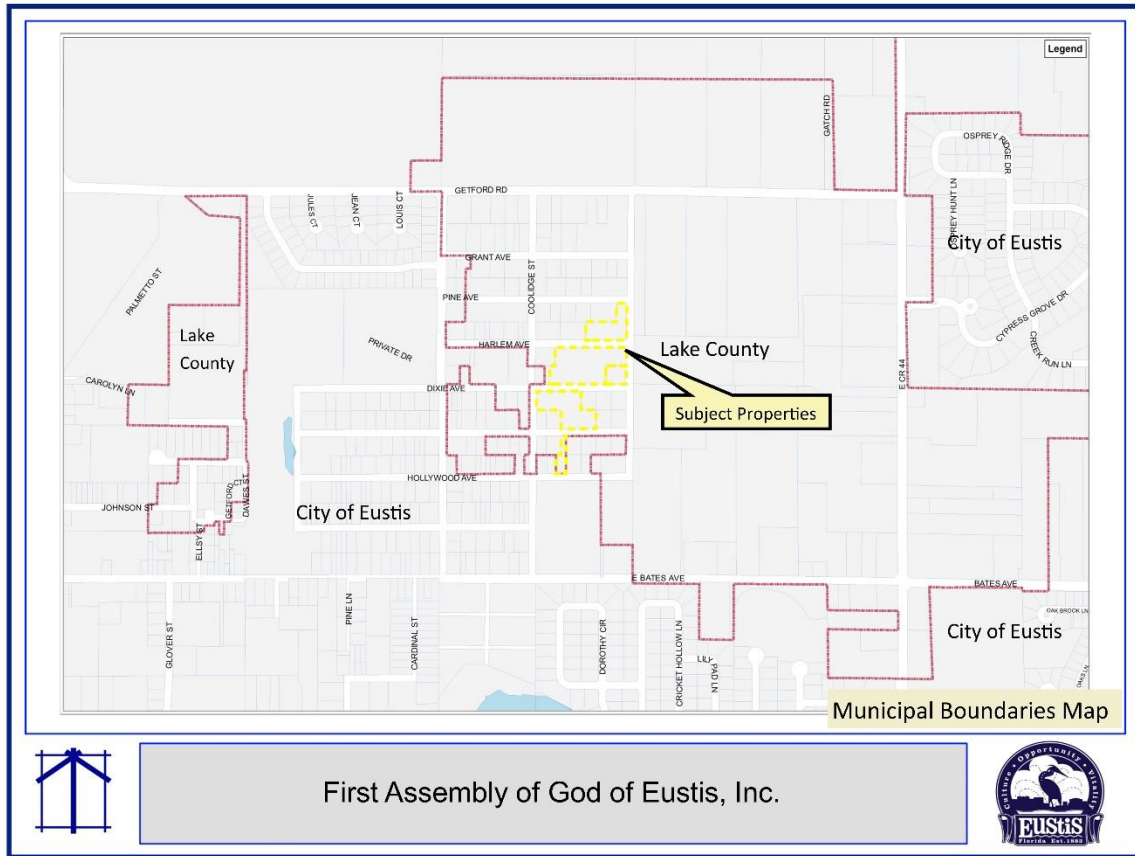

5. Florida Statutes Voluntary Annexation - Chapter 171.044(6):

“Not fewer than 10 days prior to publishing or posting the ordinance notice required under subsection (2), the governing body of the municipality must provide a copy of the notice, via certified mail, to the board of the county commissioners of the county wherein the municipality is located...”

***The department provided notice to the Lake County Board of County Commissioners on June 16, 2023, via email and by Certified Mail on June 16, 2023.***

Analysis of Comprehensive Plan/Future Land Use Request (**Ordinance Number 23-19**)

In accordance with the Florida Statutes Chapter 163.3177.9.:

*Discourage Urban Sprawl:*

Primary Indicators of Sprawl:

The future land use element and any amendment to the future land use element shall discourage the proliferation of urban sprawl. The primary indicators that a plan or plan amendment does not discourage the proliferation of urban sprawl are listed below. The evaluation of the presence of these indicators shall consist of an analysis of the plan or plan amendment within the context of features and characteristics unique to each locality in order to determine whether the plan or plan amendment:

## Review of Indicators

### 1. Low Intensity Development:

Promotes, allows, or designates for development substantial areas of the jurisdiction to develop as low-intensity, low-density, or single-use development or uses.

***This indicator does not apply. The requested future land use will provide for a higher density (5 du/acre) and the SR designation allows the infill of development types similar to the existing patterns at similar densities.***

### 2. Urban Development in Rural Areas:

Promotes, allows, or designates significant amounts of urban development to occur in rural areas at substantial distances from existing urban areas while not using undeveloped lands that are available and suitable for development.

***This indicator does not apply. The subject properties are located in an enclave area and will be requiring city services in order to develop.***

### 3. Strip or Isolated Development:

Promotes, allows, or designates urban development in radial, strip, isolated, or ribbon patterns generally emanating from existing urban developments.

***This indicator does not apply. The subject properties are located in an enclave area and will be requiring city services in order to develop. The underlying lots within the proposed annexation are that will be subject to the Suburban Residential Future land Use were platted in the early to mid-1950s.***

### 4. Natural Resources Protection:

Fails to adequately protect and conserve natural resources, such as wetlands, floodplains, native vegetation, environmentally sensitive areas, natural groundwater aquifer recharge areas, lakes, rivers, shorelines, beaches, bays, estuarine systems, and other significant natural systems.

***This indicator does not apply. The subject property is not subject to floodplain impact, and does not contain wetland areas. The subject properties were originally platted in the 1950s as part of the Rosenwald Gardens subdivision. The Comprehensive Plan and the Land Development Regulations include standards for the protection of environmentally sensitive lands that would apply should the conditions at the time of development warrant such protection.***

### 5. Agricultural Area Protection:

Fails to adequately protect adjacent agricultural areas and activities, including silviculture, active agricultural and silvicultural activities, passive agricultural activities, and dormant, unique, and prime farmlands and soils.

***This indicator does not apply. This site and adjacent areas do not support active agricultural or silvicultural activities. The site is within an existing developed and further developing area.***

### 6. Public Facilities:

Fails to maximize the use of existing public facilities and services.

***This indicator does not apply. City water is available to serve the property. Development of this parcel will maximize the use and efficiency of the City water services. City Sewer is available with adequate capacity to serve the property and will be addressed via the site development process.***

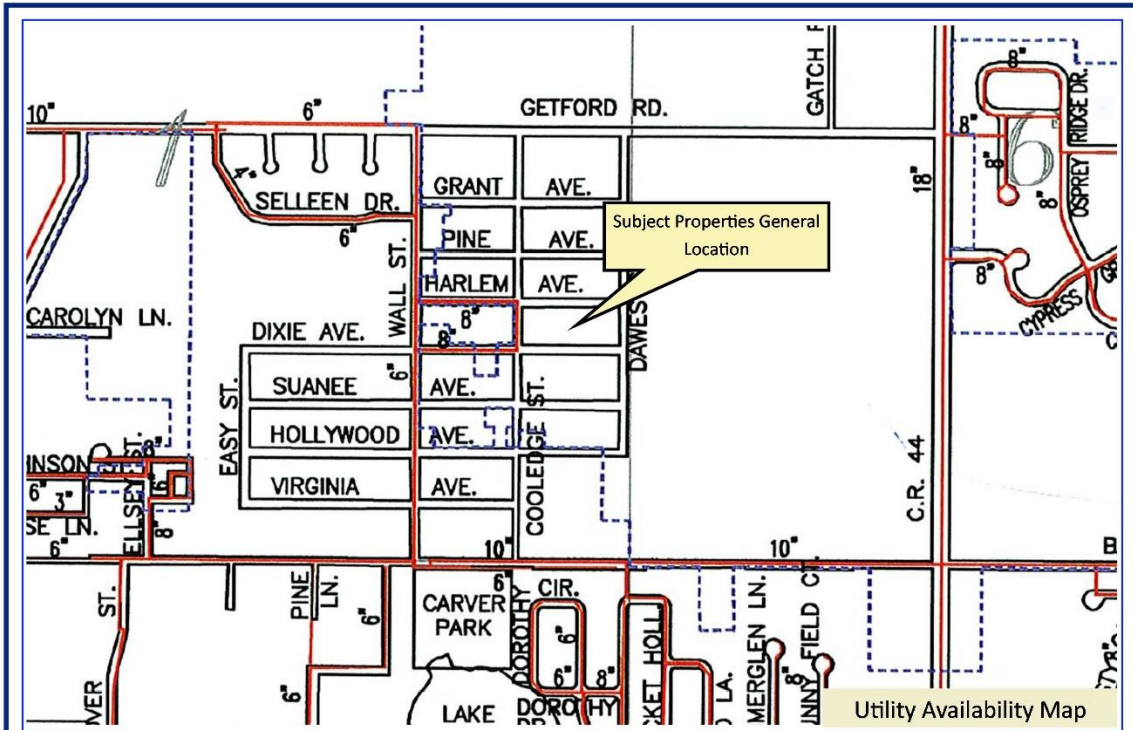

First Assembly of God of Eustis, Inc.  
Water

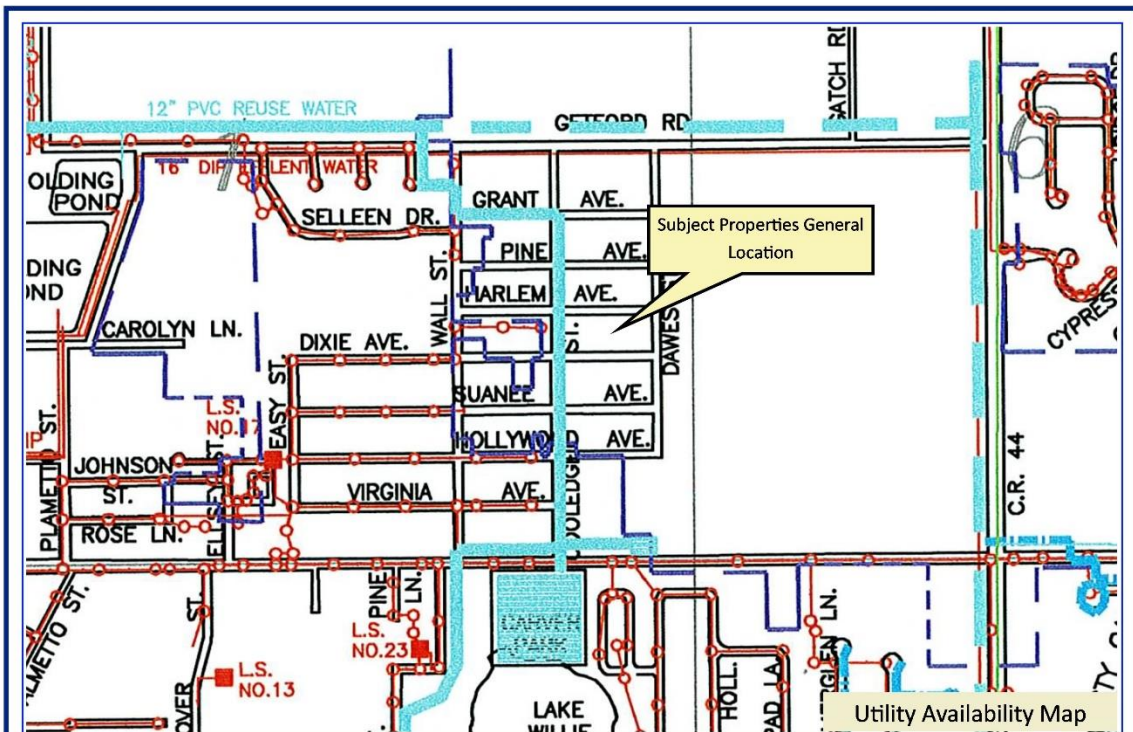

First Assembly of God of Eustis, Inc.  
Sewer and Reuse



7. Cost Effectiveness and Efficiency of Public Facilities:

Allows for land use patterns or timing which disproportionately increase the cost in time, money, and energy of providing and maintaining facilities and services, including roads, potable water, sanitary sewer, stormwater management, law enforcement, education, health care, fire and emergency response, and general government.

***This indicator does not apply. Adequate capacity is available to serve the existing and future development.***

8. Separation of Urban and Rural:

Fails to provide a clear separation between rural and urban uses.

***This indicator does not apply. No nearby properties contain active agricultural activities or use. The surrounding area is developed or has development entitlements attached to the land. These developments have densities and intensities that are clearly suburban uses.***

9. Infill and Redevelopment:

Discourages or inhibits infill development or the redevelopment of existing neighborhoods and communities.

***This indicator does not apply. This property will promote infill development by allowing access to public facilities.***

10. Functional Mix of Uses:

Fails to encourage a functional mix of uses.

***This indicator does not apply. The site is surrounded by single-family development on the adjacent properties, which is consistent with permitted uses in the area.***

11. Accessibility among Uses:

Results in poor accessibility among linked or related land uses.

***This indicator does not apply. The Land Development Regulations include provisions to provide adequate access and linkage between related uses. City Departments will ensure compliance with these standards at the time of development review.***

12. Open Space:

Results in the loss of significant amounts of functional open space.

***This indicator does not apply. The site does not contain functional open space and is not connected to regionally significant open space. The subject properties are existing residential lots.***

13. Urban Sprawl:

The future land use element or plan amendment shall be determined to discourage the proliferation of urban sprawl if it incorporates a development pattern or urban form that achieves four or more of the following:

a. Direction of Growth:

Directs or locates economic growth and associated land development to geographic areas of the community in a manner that does not have an adverse impact on and protects natural resources and ecosystems.

***The site is adjacent to existing urban/suburban development patterns and is a logical infill of the urban development boundary. The Comprehensive Plan and Land***



**Development Regulations have provisions to protect natural resources and ecosystems at the time of site plan approval.**

b. Efficient and Cost-Effective Services:

Promotes the efficient and cost-effective provision or extension of public infrastructure and services.

**Water and Sewer service is available. The development of the property will further encourage the efficient provision of services.**

c. Walkable and Connected Communities:

Promotes walkable and connected communities and provides for compact development and a mix of uses at densities and intensities that will support a range of housing choices and a multimodal transportation system, including pedestrian, bicycle, and transit, if available.

**At the time of development, the site must meet the City's Land Development Regulations including the creation of streets and street connections where they do not currently exist.**

d. Water and Energy Conservation:

Promotes the conservation of water and energy.

**The development of the site must meet City development and Florida Building Code standards that will require energy and water-efficient appliances.**

e. Agricultural Preservation:

Preserves agricultural areas and activities, including silviculture, and dormant, unique, and prime farmlands and soils.

**Not applicable; this site and adjacent areas do not support active agricultural or silvicultural activities. The site is within an existing developed residential area.**

f. Open Space:

Preserves open space and natural lands and provides for public open space and recreation needs.

**This is not applicable. The site does not provide functional open space or natural areas on a regional basis.**

g. Balance of Land Uses:

Creates a balance of land uses based upon demands of the residential population for the nonresidential needs of an area.

**The proposed land use is consistent with the surrounding area the site is not positioned to front primary or secondary corridors that would encourage commercial development.**

h. Urban Form Densities and Intensities:

Provides uses, densities, and intensities of use and urban form that would remediate an existing or planned development pattern in the vicinity that constitutes sprawl or if it provides for an innovative development pattern such as transit-oriented developments or new towns as defined in s. 163.3164.

**Not applicable.**

## **In Accordance with Comprehensive Plan Future Land Use Element Appendix:**

All applications for a Plan amendment relating to the development patterns described and supported within the Plan including, but not limited to, site specific applications for changes in land use designations, are presumed to involve a legislative function of local government which, if approved, would be by legislative act of the City and shall, therefore, be evaluated based upon the numerous generally acceptable planning, timing, compatibility, and public facility considerations detailed or inferred in the policies of the Plan. Each application for an amendment to the Map #1: 2035 Future Land Use Map by changing the land use designation assigned to a parcel of property shall also be reviewed to determine and assess any significant impacts to the policy structure on the Comprehensive Plan of the proposed amendment including, but not limited to, the effect of the land use change on either the internal consistency or fiscal structure of the Plan.

### *Major Categories of Plan Policies:*

This Plan amendment application review and evaluation process will be prepared and presented in a format consistent with the major categories of Plan policies as follows:

#### 1. General Public Facilities/Services:

Since the Plan policies address the continuance, expansion and initiation of new government service and facility programs, including, but not limited to, capital facility construction, each application for a land use designation amendment shall include a description and evaluation of any Plan programs (such as the effect on the timing/financing of these programs) that will be affected by the amendment if approved. This analysis shall include the availability of, and actual and anticipated demand on, facilities and services serving or proposed to serve the subject property. The facilities and services required for analysis include emergency services, parks and recreation, potable water, public transportation if and when available, sanitary sewer, schools, solid waste, stormwater, and the transportation network.

##### a. Emergency Services Analysis:

***Eustis Emergency Services already provide emergency response to other properties in the area. Any development consistent with the Suburban Residential future land use designation would not have a significant negative impact on the operations of Eustis emergency services.***

##### b. Parks & Recreation:

***In 2010, the City prepared a Park Inventory and Level of Service Demand and Capacity analysis as part of the Comprehensive Plan Evaluation and Appraisal Report. The results show that a surplus of park area exists up to and beyond the City's population of 20,015. The current population is approximately 24,500. Pursuant to Comprehensive Plan policies and Land Development Regulations, residential development will be required to provide on-site park amenities.***

##### c. Potable Water & Sanitary Sewer:

***Water and sewer are available to the subject property. Both the water and sewer systems have adequate capacity to serve the development of the property.***

##### d. Schools:

***The proposed change should not negatively impact schools. At the time of development application verification of capacity will be required from Lake County Schools.***

- e. Solid Waste:

***The City contracts with Waste Management for the hauling of solid waste. The company already services properties in the general area of the subject property. Serving this property will increase efficiency in the delivery of services.***

- f. Stormwater:

***The Comprehensive Plan and Land Development Regulations include the level of service standards to which new development must adhere. Projects designed to meet these standards will not negatively affect the existing facilities and services.***

- g. Transportation Network Analysis:

***This potential annexation and the subsequent development of the property will not add additional impacts as the parcels being annexed include existing platted lots.***

## **2. Natural Resources/Natural Features:**

The policies of the Plan also contain general regulatory guidelines and requirements for managing growth and protecting the environment. These guidelines will be used to evaluate the overall consistency of the land use amendment with the Comprehensive Plan. Specifically, each amendment will be evaluated to 1) determine the existence of groundwater recharge areas; 2) the existence of any historical or archaeological sites; 3) the location of flood zones and the demonstration that the land uses proposed in flood-prone areas are suitable to the continued natural functioning of flood plains; and 4) the suitability of the soil and topography to the development proposed.

- a. Groundwater recharge areas:

***The site may be within a recharge area, and a site-specific geotechnical and hydrologic study will be needed to determine the site-specific impact at the time of development. Source: Lake County Comprehensive Plan 2030 Floridian Aquifer Recharge Map.***

- b. Historical or archaeological sites:

***The City does not have any record of Florida Master Site Files related to this property and no known historical or cultural resources exist.***

- c. Flood zones:

***The subject property is not impacted by a 100-year flood zone area. Source - Lake County GIS - 2012 Flood Zones.***

- d. Soil and topography:

***The site soils are primarily Myakka sands. These sands are all typically moderately to poorly drained soils.***

## **3. Comprehensive Plan Review:**

Additional criteria and standards are also included in the Plan that describe when, where, and how development is to occur. Plan development policies will be used to evaluate the appropriateness of the compatibility of the use, intensity, location, and timing of the proposed amendment.

***Existing Land Use According to the Lake County Comprehensive Plan:***

The existing Lake County future land use designation of the property is Urban Low, which provides for residential uses at up to 4 dwelling units per acre as well as supporting commercial and institutional uses.

***Proposed Land Use According to the Eustis Comprehensive Plan:***

***The Suburban Residential (SR) land use designation is provided to accommodate the majority of residential development within the City. The general range of uses include: a mix of single family detached, patio home, and townhouse dwellings in a suburban atmosphere and may also include ACLF, parks and recreation facilities, and schools. Apartments may be permitted through the PUD process. Public and utility services and facilities that are 2 acres or less in size are also permitted. Suburban Residential lands may be developed up to a maximum density of 5 dwelling units per net buildable acre.***

**Comparison of Lake County Development Conditions**

***The land use designations of residential properties within the City of Eustis in the surrounding area are generally Suburban Residential (SR) with a maximum density of 5 dwelling units per acre (du/ac).***

***The surrounding properties, immediately adjacent to the north and east, are unincorporated areas are designated Urban low with a maximum density of 4 dwelling units per net buildable acre.***

**Proposed Residential Land Uses.**

The City shall limit these uses adjacent to incompatible commercial or industrial lands unless sufficient mitigation, such as buffering and setbacks is provided and available, which lessens the impact to the proposed residences.

***This area is predominantly residential in nature the proposed use of the land will continue to be residential.***

**Proposed Non-Residential Land Uses.**

The City shall generally not permit new industrial uses to be located adjacent to existing or planned residentially designated areas.

***Not applicable.***

1. Transportation:

Each application for a land use designation amendment will be required to demonstrate consistency with the Transportation Element of the adopted Comprehensive Plan.

***The use of the land is already residential in nature and was previously platted the increase in traffic should be negligible.***

2. Water Supply:

Each application for a land use designation amendment will be required to demonstrate that adequate water supplies and associated public facilities are (or will be) available to meet the projected growth demands.

***City water service and other services are available. The City's adopted Water Supply Plan anticipated additional growth consistent with this development, so both supply and capacity are available.***

In Accordance with Chapter 102-16(f), Land Development Regulations

*Standards for Review:*

In reviewing the application of a proposed amendment to the comprehensive plan, the local planning agency and the city commission shall consider:

a. *Consistent with Comprehensive Plan:*

Whether the proposed amendment is consistent with all expressed policies the comprehensive plan.

***The proposed amendment is consistent with the Comprehensive Plan.***

b. *In Conflict with Land Development Regulations:*

Whether the proposed amendment is in conflict with any applicable provisions of these land development regulations.

***The proposed amendment is not in conflict with the Land Development Regulations. At the time of development, there will be further review for compliance.***

c. *Inconsistent with Surrounding Uses:*

Whether, and the extent to which, the proposed amendment is inconsistent with existing and proposed land uses.

***The existing land uses in the immediate area are residential and the proposed use of the land is continued residential.***

d. *Changed Conditions:*

Whether there have been changed conditions that justify an amendment.

***The applicant wishes to annex the property into the City limits of Eustis. Assignment of a City of Eustis future land use designation is required. Upon annexation, the subject property will have a full array of municipal services, including central water. These changed conditions warrant a change in the land use designation.***

e. *Demand on Public Facilities:*

Whether, and the extent to which, the proposed amendment would result in demands on public facilities, and whether, or to the extent to which, the proposed amendment would exceed the capacity of such public facilities, infrastructure and services, including, but not limited to police, roads, sewage facilities, water supply, drainage, solid waste, parks and recreation, schools, and fire and emergency medical facilities.

***City water and sewer services are available and, in close proximity to the site. Adequate capacity is available to serve future development consistent with the requested Suburban Residential future land use designation.***

***Upon annexation, the City will also provide other services such as fire and police protection, library services, parks, and recreation. The City provides these services to other properties in the area, so efficiency will improve.***

f. *Impact on Environment:*

Whether, and the extent to which, the proposed amendment would result in significant impacts on the natural environment.

***The site contains no apparent natural resources and is not connected to significant open space.***

g. *Orderly Development Pattern:*

Whether, and the extent to which, the proposed amendment would result in an orderly and logical development pattern, specifically identifying any negative effects on such pattern.

***The site is contiguous to the City limits. The development patterns already exist in the area and the future building on the previously platted lots will not cause incompatibilities with those development patterns.***

h. *Public Interest and Intent of Regulations:*

Whether the proposed amendment would be consistent with or advance the public interest, and in harmony with the purpose and intent of these land development regulations.

*The purpose and intent of the Land Development Regulations is as follows:*

“The general purpose of this Code is to establish procedures and standards for the development of land within the corporate boundaries and the planning area of the city, such procedures and standards being formulated in an effort to promote the public health, safety and welfare and enforce and implement the City's Comprehensive Plan, while permitting the orderly growth and development with the city and Eustis planning area consistent with its small-town community character and lifestyle.”

***The requested designation of SR land use will provide for orderly growth and development. This designation would advance the public interest by potentially providing additional housing, and the application of the LDRs to future development will ensure consistency with the community character and lifestyle of the city.***

i. *Other Matters:*

Any other matters that may be deemed appropriate by the local planning agency or the city commissioners, in review and consideration of the proposed amendment.

**No other matters.**

Analysis of Design District Request (**Ordinance Number 23-20**):

Form-Based Code:

The City's Land Development Regulations is a form-based code. Design districts are unique to form-based codes. Lake County still uses traditional Euclidean zoning, so there are no design districts for parcels in unincorporated Lake County. When a parcel annexes into the City of Eustis, the City must assign a consistent design district that follows the urban, suburban, and rural transect

1. *Standards for Review:*

The Land Development Regulations include the following standards for review of an amendment to the Design District Map. In approving a change in the designation, the City Commission shall consider: Whether the amendment is in conflict with any applicable provisions of the Code.

a. *Section 102-17(a) "...Section 109-3 Design Districts:*

identifies the definition, structure, and form of each design district. The assignment of design district must follow the district pattern and intent."

***The requested amendment assigns a newly annexed parcel a designation that meets the district pattern and intent (Suburban Neighborhood). The Suburban development pattern and intent, and the Suburban neighborhood definition, structure, and form description are stated below. The assignment of a Suburban Neighborhood design district designation is appropriate due to the established and proposed development patterns in the area.***

b. *Sec. 109-3.4. Suburban development pattern intent statements:*

Intent. Suburban development pattern...relies primarily on a pattern of residential development that provides the majority of property owners with substantial yards on their own property. The street layout, comprised of streets with fewer vehicular connections, helps to reduce cut-through traffic and establishes distinct boundaries for residential communities/subdivisions. Each land use provides for pedestrian and bicycle connections.

Design districts – Suburban Neighborhood

a. Definition. Predominately residential uses with some neighborhood-scale commercial services.

b. Structure. Interconnected trails, bikeways, and walkways with a street framework comprised of a range of blocks permitted throughout the neighborhoods.

c. Form. Mix of detached residential uses with some neighborhood-supporting retail, parks and civic spaces as focal points in the neighborhoods.

***The Suburban development patterns statement above indicates that residential uses are primarily located on streets with fewer vehicle connections. A Suburban Neighborhood designation follows the district pattern and intent outlined in the Land Development Regulations and is consistent with the existing transect in the area.***

c. **Section 102-17(a)**

The following guidelines must be followed when proposing the reassignment of the design district:

Compatible intensities should face across streets. Changes in design districts should occur along rear alleys or lanes or along conservation edges.

**Reassignment is not being proposed; a Eustis design district designation must be assigned to annexed property; the proposed design district is compatible with the surrounding design districts.**

d. *Consistent with Comprehensive Plan:*

Whether the proposed amendment is consistent with all elements of the comprehensive plan.

**The requested amendment is consistent with the Future Land Use element (including Policy FLU 1.2.4, Development Patterns, and FLU 1.3.2. Maintain Residential Compatibility), as well as all other elements of the Comprehensive Plan.**

e. *Consistent with Surrounding Uses:*

Whether, and the extent to which, the proposed design district is consistent with existing and proposed land uses.

**The Suburban Neighborhood definition, structure, and form are compatible with the existing uses and any proposed uses permitted under the Suburban Residential future land use designation.**

f. **Changed Conditions:**

Whether there have been changed conditions that justify amending the design district.

**The subject property is proposed for annexation and a design district assignment is necessary. The conditions have changed from land located in unincorporated Lake County without central services to a site within the City of Eustis with municipal services.**

g. **Public Facilities.**

Whether, and the extent to which, the proposed redistricting would result in demands on public facilities, and whether, or to the extent to which, the proposed change would exceed the capacity of such public facilities, including, but not limited to police, roads, sewage facilities, water supply, drainage, solid waste, parks and recreation, schools, and fire and emergency medical facilities.

**A redistricting is not proposed. Assigning a design district to an annexation property will not change the demand impact on public facilities. The Future Land Use designation controls the density and intensity permitted on the site, so the Design District map amendment would not result in impacts beyond that already anticipated. Also, see the analysis of public facilities in the above sections of this report.**

h. *Impact on Environment:*

Whether, and the extent to which, the redistricting would result in significant impacts on the natural environment.

**The proposed Design District designation for this property does not change the development potential of the parcel. Design Districts control the form and**



**function of any development that does occur. The Future Land Use designation controls the density, intensity, and minimum open space permitted on the site, so the Design District amendment would not result in additional impacts on the natural environment. As building permit approval must be obtained before development can begin, the Comprehensive Plan and the Land Development Regulations include standards for the protection of environmentally sensitive lands that would apply should the conditions at the time of development warrant such protection.**

i. *Property Values:*

Whether, and the extent to which, the proposed redistricting would affect the property values in the area.

**Redistricting is not being proposed; a Eustis design district designation must be assigned to the annexed property. This request should not affect property values, because the proposed Design District designation is consistent with the surrounding development patterns and design districts.**

j. *Orderly Development Pattern:*

Whether, and the extent to which, the proposed redistricting would result in an orderly and logical development pattern.

**The request is the assignment of a design district to an annexation parcel, not redistricting. However, the proposed Design District designation is consistent with the suburban development pattern identified in Section 109-5.5 of the Land Development Regulations. Assignment of the requested designation will result in a more orderly and logical development pattern; making the designation consistent with the surrounding area designations and established development patterns.**

k. *Public Interest and Intent of Regulations:*

Whether the proposed redistricting would be in conflict with the public interest, and in harmony with the purpose and intent of these regulations.

**The request is the assignment of a design district to an annexation parcel, not redistricting. The proposed Design District is not in conflict with the public interest and reflects the purpose and intent of the regulations.**

l. *Other Matters:*

Any other matters that may be deemed appropriate by the city commission, in review and consideration of the proposed redistricting.

**The request is the assignment of a design district to an annexation parcel, not redistricting. The City's Land Development Regulations are a form-based code. The Design District designations define the development form, but not the types of land use, densities, intensities, or required open space. The districts, therefore, must be consistent and follow the urban, suburban, and rural transects. This request assigns a Suburban Neighborhood design district designation to an annexation parcel, which is consistent with the existing transect.**

## **Applicable Policies and Codes**

### 1. Resolution Number 87-34

Joint Planning Area Agreement with Lake County: “The City and the County agree that the unincorporated areas adjacent to the City might be appropriately served by urban services provided by the City, and might therefore be annexed into the City in accordance with State law..... The City agrees to annex property in accordance with State law and provide adequate urban services and facilities to serve those areas within the Joint Planning Area.”

### 2. Florida Statutes Chapter 171.044: Voluntary Annexation:

- a. “The owner or owners of real property in an unincorporated area of a county which is contiguous to a municipality and reasonably compact may petition the governing body of said municipality that said property be annexed to the municipality.”
- b. “Land shall not be annexed through voluntary annexation when such annexation results in the creation of enclaves.”

### 3. Comprehensive Plan – Suburban Residential (SR)

This designation is provided to accommodate the majority of residential development within the City.

General Range of Uses: This designation is intended to provide for a mix of single-family detached, patio home, and townhouse dwellings in a suburban atmosphere and may also include ACLF, parks and recreation facilities, and schools. Apartments may be permitted through the PUD process. Public and utility services and facilities that are 2 acres or less in size are also permitted.

Maximum Density/Intensity: Suburban Residential lands may be developed up to a maximum density of 5 dwelling units per net buildable acre. The maximum density may be exceeded through an affordable housing density bonus as provided in the Special Provisions below.

#### Special Provisions:

- (1) Density bonuses are permitted for the provision of affordable housing, including opportunities for a bonus increase between 5-15 percent in density in the Suburban Residential (SR) classification where at least 20 percent of the dwelling units are affordable to families having incomes less than 80 percent of the Orlando Metropolitan Statistical Area median, or where at least 50 percent of the dwelling units are affordable to families having incomes less than 120 percent of the Orlando Metropolitan Statistical Area median. Affordability is based on a housing cost-to-family income factor of 30 percent. A density bonus may also be allowed for energy conservation or green certification as provided for in the LDRs. The combined density bonus for affordable housing and energy conservation/green certification is limited to a total increase of 15%.
- (2) Permit the placement of residential units manufactured off site which otherwise meet all applicable federal and state regulations and standards, provided that:

- a. all such housing is attached to foundations as in the case of conventional site-built construction; and
  - b. all such housing otherwise meets applicable lot, yard, and related residential classification as set forth in the Land Development Regulations.
- (3) Developments within the Wekiva Protection Overlay that include longleaf pine, sand hill, sand pine, and xeric oak communities shall protect these areas as dedicated open space or conservation easements, with total open space equal to at least 35% of the net buildable area.
4. Land Development Regulations Section 109-5.5(b)(1): The Suburban Neighborhood Design District has predominately residential uses with some neighborhood-scale commercial services with interconnected trails, bikeways and walkways with a street framework comprised of a range of blocks permitted throughout the neighborhoods.
  5. Land Development Regulations Section 109-3 (Table 1) and Section 109-2.6: Suburban Residential land use has a maximum density of 5 units to one acre. The Suburban Residential designation is intended to regulate the character and scale of allowed uses so as to minimize their impacts on adjacent roadways and promote their compatibility with adjacent or nearby land uses.

**Recommended Action:**

Development Services recommends approval of Ordinance Numbers 23-18, 23-19, and 23-20.

**Policy Implications:**

None

**Alternatives:**

1. Approve Ordinance Numbers 23-18 (Annexation), 23-19 (Comp. Plan Amendment), and 23-20 (Design District Designation).
2. Deny Ordinance Numbers 23-12, 23-13, and 23-14.

**Budget/Staff Impact:**

There would be no direct costs to the City beyond the normal City services. There would be no additional staff time beyond the normal review process.

**Prepared By:**

Jeff Richardson, AICP, Deputy Development Services Director

**Reviewed By:**

Mike Lane, AICP, Development Services Director

Heather Croney, Senior Planner