

# **CARVER PARK BASKETBALL COURTS SHADE STRUCTURE**

Craig Dolan

September 7, 2023



# AERIAL VIEW OF LOCATION



# VIEW FROM THE NORTH



# CONCEPTUAL DESIGN

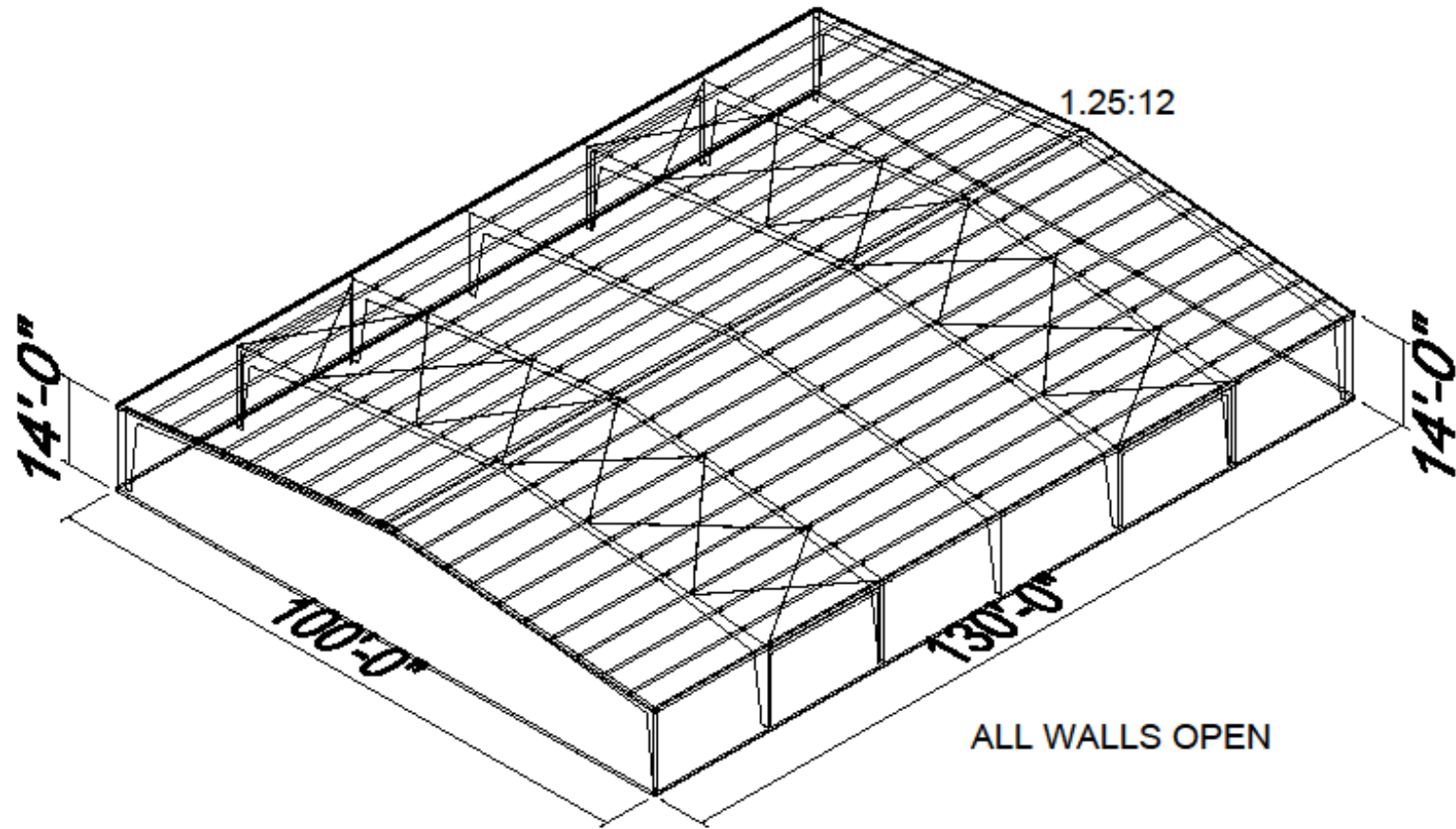



**EXAMPLE**



# EXAMPLES



- Lighting can be added
  - We currently have both courts lighted, so moving current fixtures will save both time and money.
- Fans can be added
  - Two different brands
    - Big Ass Fans: [Big Ass Fans](#)
    - Humongous Fans: [Humongous Fans](#)



# POTENTIAL COSTS

- Metal Building alone: \$120,000 - \$135,000
  - This does not include building of the structure, site work, equipment, engineering, permitting, design
  - Labor and installation: \$56,000
  - Additional Cost Estimate: \$251,790
    - Does not include the risk factor cost
- Complete project: \$390,000 (Turn Key)
  - Includes installation of fans
  - Includes installation of lights
  - Permitting, any rental equipment, materials, labor







**QUESTIONS?**

