



Record No: VAR-26-13

Variance Application

Status: Active

Submitted On: 3/26/2026

Primary Location

32.297719, -81.399183

Owner

No owner information

Applicant

Gloria & Rodney Durrance



306 Shirley Dr.
Guyton, GA 31312

Staff Review

Board of Commissioner Meeting Date*

04/21/2026

Notification Letter Description*

a decrease in required minimum setbacks in AR-1.

Public Notification Letters Mailed*

04/06/2026

Location Information*

Floyd Avenue

Staff Description

Section 5.1

Board of Commissioner Ads

04/01/2026

Commissioner District*

3rd

Request Approved or Denied

—

Letter & ZMA Mailed

—

Map#* 

296

Parcel#* 

51

Applicant Name* 

Gloria Durrance

General Information

Zoning District*

AR-1

Map/Parcel Number*

296-51

Is this concurrent with a Rezoning? *

No

Describe why the variance is needed*

The require setbacks is 25 feet but to built my house it will be at 19 feet so I need a 6 foot variance on each side.

Water Connection*

Private Well

Sewer Connection*

Private Septic System

Who is applying for variance request?*

Owner

Applicant Information

Applicant Name*

Gloria Durrance

Applicant Phone Number*



Applicant Email Address*



Applicant Address*

306 Shirley Drive

City*

Guyton

State*

GA

Zip Code*

31312

Signature

The undersigned (applicant) (owner), hereby acknowledges that the information contained herein is true and complete to the best of its knowledge,

Digital Signature*

 Gloria M Durrance

Mar 26, 2026

(Book)
Plat Cabinet B46/Pg B1

Filed for Record

Town of Pineora/Pineora Investment Co.

Book B46 Page B1
Date 8/11/1891

Taken out of Deed Book 5, Page 50

1411

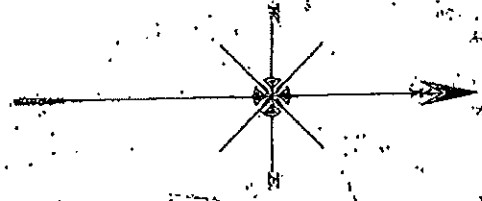

INVESTMENT CO.
SCALE OF FEET

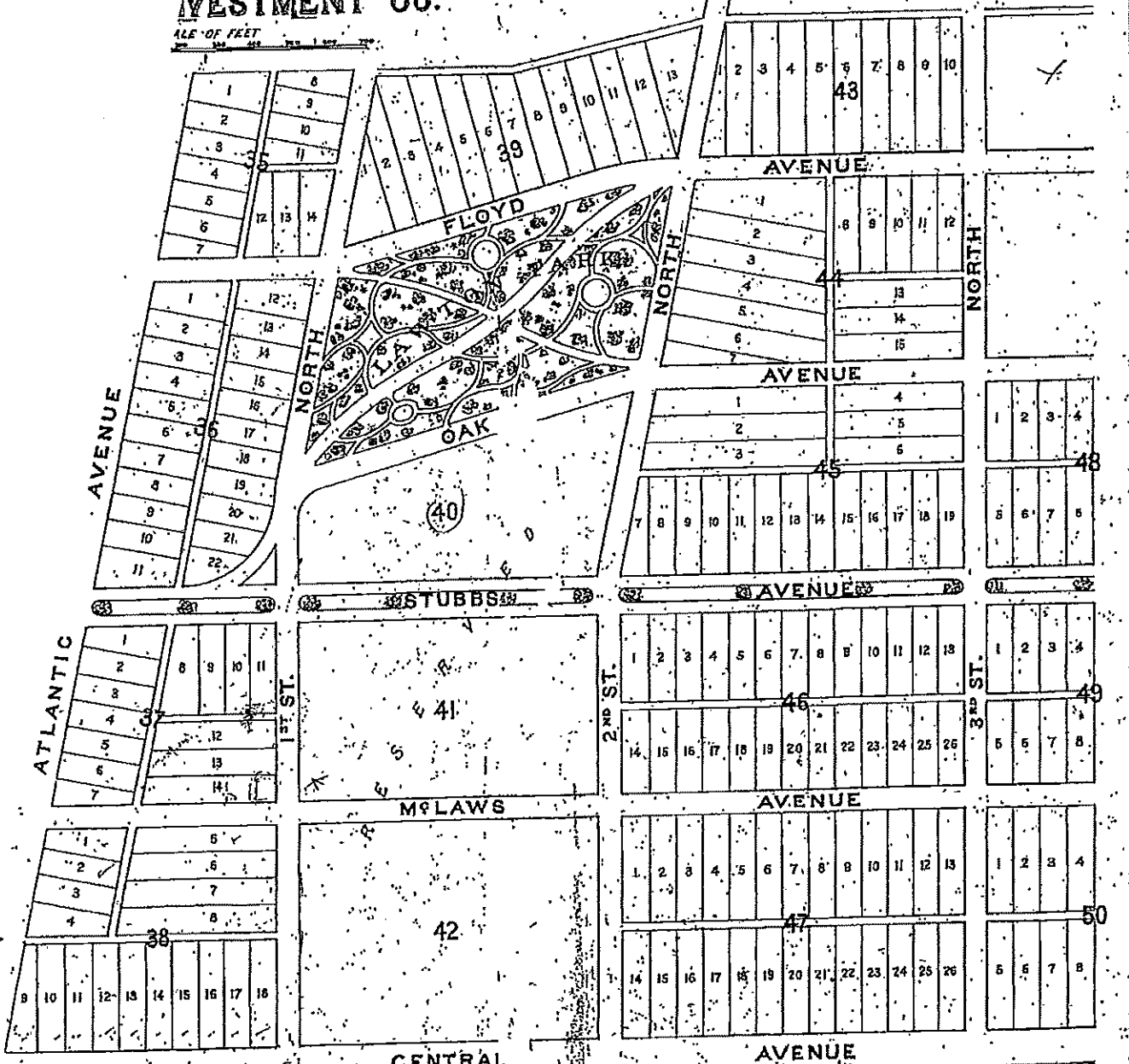

Railroad of Georgia

CENTRAL AVENUE

AVENUE

Plat Cabinet B46/ Page B1

Town of Pineora/Pineora Investment Company
Taken out of Deed BK 5/Pg 50

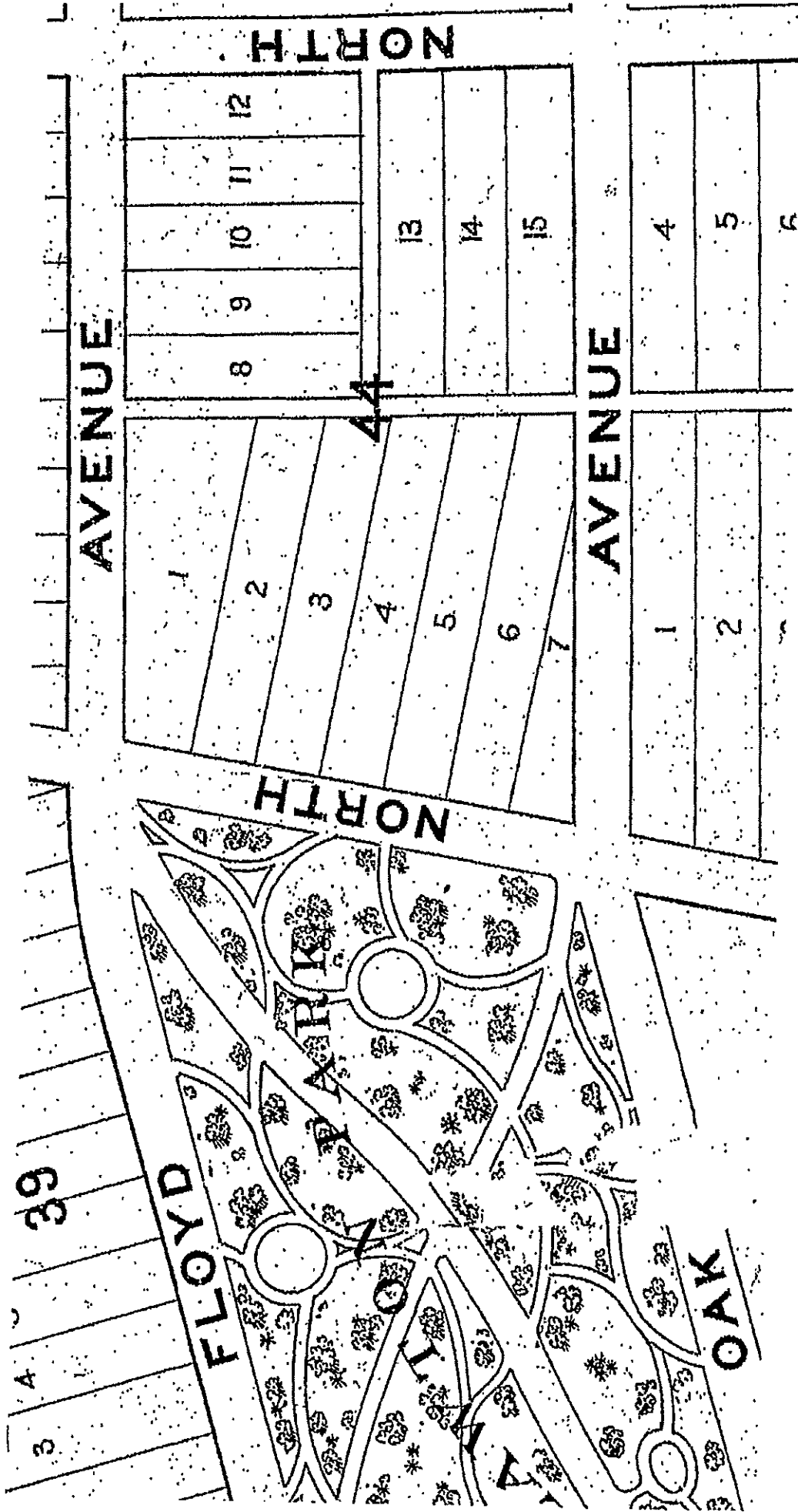

Filed for Record
Book B 316 Page A
Date 8/11/1891

Taken out of Deed Book 5 Page 50 Town of Pineora/Pineora Investment Co.

1st half of plat

Info

PROFILE OF CENTRAL RAILROAD FROM SAVANNAH TO PINEORA



MAP OF PINEORA PREPARED FOR THE TOWN OF PINEORA GEORGIA

BRASSIUS & GIGLIOLLI
Engineers & Architects
Savannah, Ga.



296-51



3/26/2026

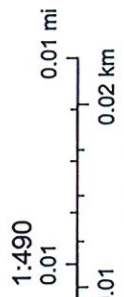

ECBOC, Est. HERE, Garmin, INCREMENT P, USGS, EPA, USDA

296-51



3/26/2026

- Addresses
- Parcels
- Zoning
- Roads
- AR-2
- R-1
- AR-1
- Citations

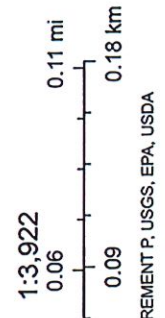

ECBOC, Esri, HERE, Garmin, INCREMENT P, USGS, EPA, USDA

296-51



3/26/2026

- Addresses
- Parcels
- Roads
- FLUM Areas
- Agricultural-Residential
- Public-Institutional
- Citations

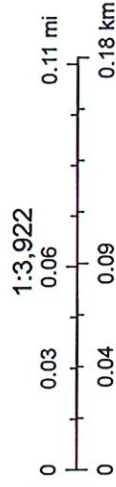

1:3,922
ECBOC, Esri, HERE, Garmin, INCREMENT P, USGS, EPA, USDA