

Lighting System

Pole/Fixture Summary						
Pole ID	Pole Height	Mtg Height	Fixture Qty	Luminaire Type	Load	Circuit
A1	60'	60'	1	TLC-LED-550	0.54 kW	B
		60'	1	TLC-LED-900	0.88 kW	A
		60'	2	TLC-LED-550	1.08 kW	A
A2	60'	16'	1	TLC-BT-575	0.57 kW	A
		60'	1	TLC-LED-900	0.88 kW	A
		60'	2	TLC-LED-550	1.08 kW	A
B1-B2	70'	16'	1	TLC-BT-575	0.57 kW	A
		70'	1	TLC-LED-900	0.88 kW	A
		70'	3	TLC-LED-1200	3.51 kW	A
P1-P2	20'	16'	1	TLC-BT-575	0.57 kW	A
		20'	1	Cree OSQ	0.10 kW	B
			21			15.74 kW

Circuit Summary			
Circuit	Description	Load	Fixture Qty
A	Softball	15.00 kW	18
B	Walkway	0.74 kW	3

Fixture Type Summary							
Type	Source	Wattage	Lumens	L90	L80	L70	Quantity
Cree OSQ	LED 5700K - 70 CRI	100W	8,463	--	--	--	2
TLC-BT-575	LED 5700K - 75 CRI	575W	52,000	>120,000	>120,000	>120,000	4
TLC-LED-1200	LED 5700K - 75 CRI	1170W	150,000	>120,000	>120,000	>120,000	6
TLC-LED-550	LED 5700K - 75 CRI	540W	67,000	>120,000	>120,000	>120,000	5
TLC-LED-900	LED 5700K - 75 CRI	880W	104,000	>120,000	>120,000	>120,000	4

Single Luminaire Amperage Draw Chart							
Driver Specifications (.90 min power factor)	Line Amperage Per Luminaire (max draw)						
	208 (60)	220 (60)	240 (60)	277 (60)	347 (60)	380 (60)	480 (60)
Single Phase Voltage							
CREE OSQ	-	-	-	-	0.3	-	0.2
TLC-BT-575	3.3	3.2	2.9	2.5	2.0	1.8	1.5
TLC-LED-1200	6.9	6.5	6.0	5.2	4.2	3.8	3.0
TLC-LED-550	3.2	3.0	2.8	2.4	1.9	1.8	1.4
TLC-LED-900	5.2	4.9	4.5	3.9	3.1	2.9	2.3

Light Level Summary

Calculation Grid Summary								
Grid Name	Calculation Metric	Illumination					Circuits	Fixture Qty
		Ave	Min	Max	Max/Min	Ave/Min		
Softball (Infield)	Horizontal Illuminance	32.55	23	38	1.68	1.45	A	18
Softball (Outfield)	Horizontal Illuminance	21.85	15	31	2.07	1.48	A	18
Softball Spill	Horizontal Illuminance	0.0196	0.00	0.07	-	-	A	18
Softball Spill	Max Vertical Illuminance Metric	0.0632	0.00	0.20	928.575	293.246	A	18
Softball Spill Max Candela	Max Candela (by Fixture)	2759.5906	6.14	8081.84	1316.669	449.584	A	18
Walkway	Horizontal	1.23	0	7	8134.32	1386.97	B	3

From Hometown to Professional

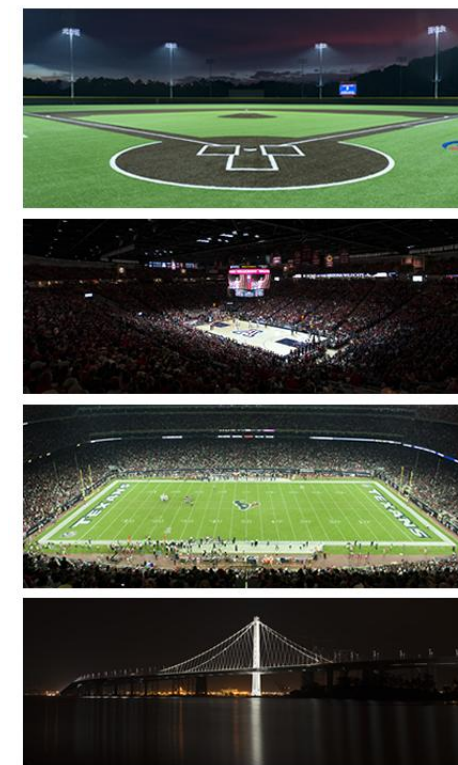

We Make It Happen.

Not to be reproduced in whole or part without the written consent of Musco Sports Lighting, LLC. ©1981, 2023 Musco Sports Lighting, LLC.

Equipment List For Areas Shown

Pole				Luminaires				
QTY	LOCATION	SIZE	GRADE ELEVATION	ABOVE GRADE LEVEL	LUMINAIRE TYPE	QTY/POLE	THIS GRID	OTHER GRIDS
1	A1	60'	-	60'	TLC-LED-550	3	2	1
				60'	TLC-LED-900	1	1	0
				15.5'	TLC-BT-575	1	1	0
1	A2	60'	-	60'	TLC-LED-550	2	2	0
				60'	TLC-LED-900	1	1	0
				15.5'	TLC-BT-575	1	1	0
2	B1-B2	70'	-	70'	TLC-LED-1200	3	3	0
				70'	TLC-LED-900	1	1	0
				15.5'	TLC-BT-575	1	1	0
4	Totals					19	18	1

*Above Grade level relative to the field

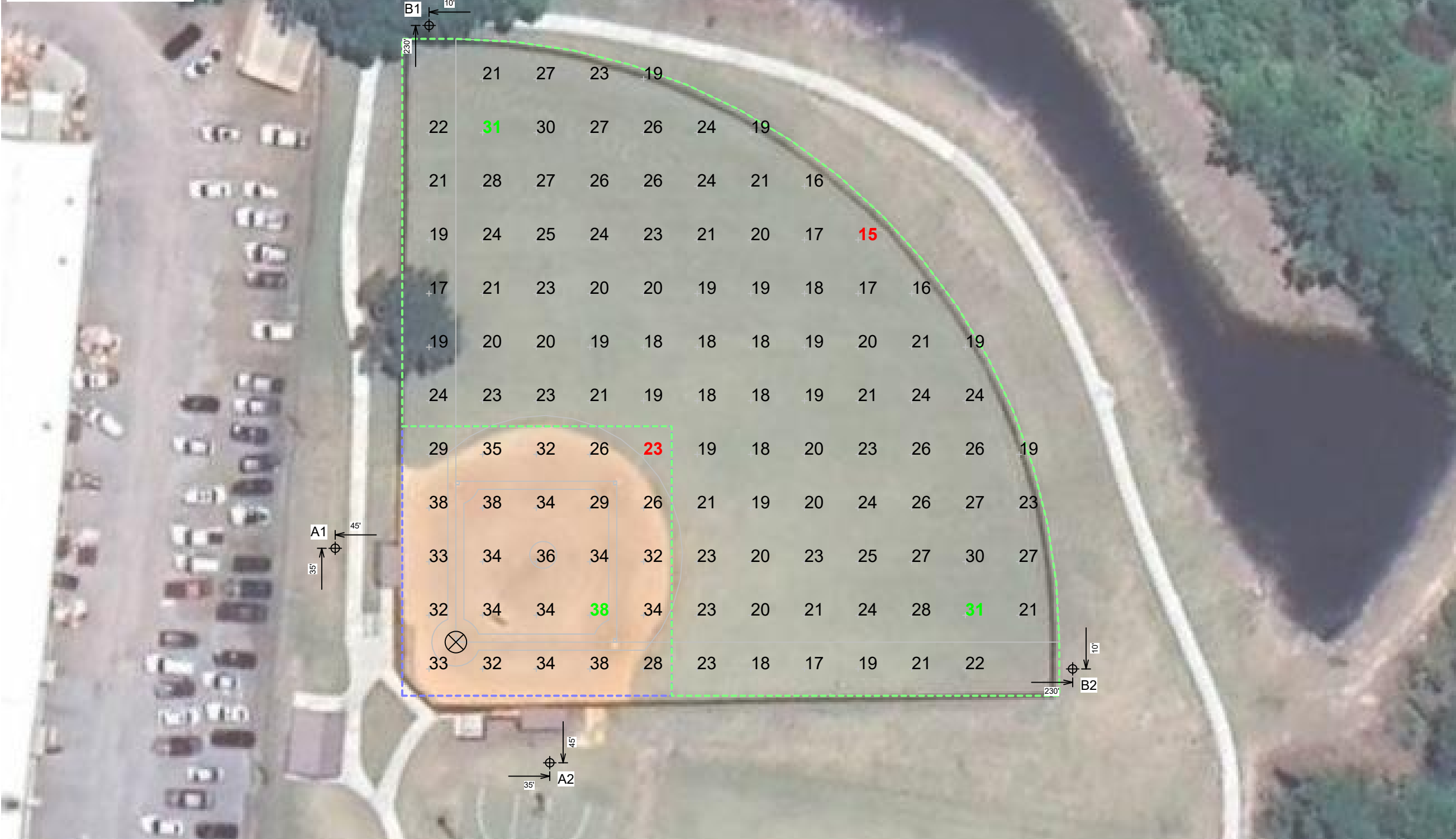

McCall Park

Rincon, GA

Grid Summary

Name	Softball
Size	225'/225'/225' - basepath 60'
Spacing	20.0' x 20.0'
Height	3.0' above grade

Illumination Summary

	MAINTAINED HORIZONTAL FOOTCANDLES	
	Infield	Outfield
Guaranteed Average	30	20
Scan Average	32.55	21.85
Maximum	38	31
Minimum	23	15
Avg/Min	1.45	1.48
Guaranteed Max/Min	2.5	2
Max/Min	1.68	2.07
UG (adjacent pts)	1.34	1.44
CU	0.65	
No. of Points	25	94
LUMINAIRE INFORMATION		
Applied Circuits	A	
No. of Luminaires	18	
Total Load	15.00 kW	

Guaranteed Performance: The ILLUMINATION described above is guaranteed per your Musco Warranty document and includes a 0.95 dirt depreciation factor.

Field Measurements: Individual field measurements may vary from computer-calculated predictions and should be taken in accordance with IESNA RP-6-15.

Electrical System Requirements: Refer to Amperage Draw Chart and/or the "Musco Control System Summary" for electrical sizing.

Installation Requirements: Results assume ± 3% nominal voltage at line side of the driver and structures located within 3 feet (1m) of design locations.

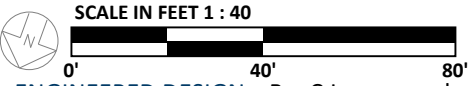

Pole location(s) ⊕ dimensions are relative to 0,0 reference point(s) ⊗



Not to be reproduced in whole or part without the written consent of Musco Sports Lighting, LLC. ©1981, 2023 Musco Sports Lighting, LLC.

ILLUMINATION SUMMARY

Equipment List For Areas Shown

Pole				Luminaires				
QTY	LOCATION	SIZE	GRADE ELEVATION	ABOVE GRADE LEVEL	LUMINAIRE TYPE	QTY/POLE	THIS GRID	OTHER GRIDS
1	A1	60'	-	60'	TLC-LED-550	3	1	2
				60'	TLC-LED-900	1	0	1
				15.5'	TLC-BT-575	1	0	1
2	P1-P2	20'	-	20'	CREE OSQ	1	1	0
3				Totals		7	3	4

*Above Grade level relative to the field

McCall Park

Rincon, GA

Grid Summary	
Name	Walkway
Spacing	10.0' x 10.0'
Height	3.0' above grade

Illumination Summary	
MAINTAINED HORIZONTAL FOOTCANDLES	
Entire Grid	
Scan Average	1.23
Maximum	7
Minimum	0
Avg/Min	1386.97
Max/Min	8134.32
UG (adjacent pts)	5.89
CU	0.62
No. of Points	340
LUMINAIRE INFORMATION	
Applied Circuits	B
No. of Luminaires	3
Total Load	0.74 kW

Guaranteed Performance: The ILLUMINATION described above is guaranteed per your Musco Warranty document and includes a 0.95 dirt depreciation factor.

Field Measurements: Individual field measurements may vary from computer-calculated predictions and should be taken in accordance with IESNA RP-6-15.

Electrical System Requirements: Refer to Amperage Draw Chart and/or the "Musco Control System Summary" for electrical sizing.

Installation Requirements: Results assume ± 3% nominal voltage at line side of the driver and structures located within 3 feet (1m) of design locations.

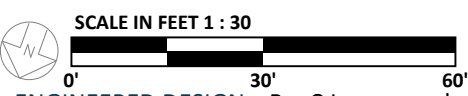

Pole location(s) ⊕ dimensions are relative to 0,0 reference point(s) ⊗



We Make It Happen.

Equipment List For Areas Shown

Pole				Luminaires				
QTY	LOCATION	SIZE	GRADE ELEVATION	ABOVE GRADE LEVEL	LUMINAIRE TYPE	QTY/POLE	THIS GRID	OTHER GRIDS
1	A1	60'	-	60'	TLC-LED-550	3	2	1
				60'	TLC-LED-900	1	1	0
				15.5'	TLC-BT-575	1	1	0
1	A2	60'	-	60'	TLC-LED-550	2	2	0
				60'	TLC-LED-900	1	1	0
				15.5'	TLC-BT-575	1	1	0
2	B1-B2	70'	-	70'	TLC-LED-1200	3	3	0
				70'	TLC-LED-900	1	1	0
				15.5'	TLC-BT-575	1	1	0
4	Totals					19	18	1

*Above Grade level relative to the field



McCall Park

Rincon, GA

Grid Summary	
Name	Softball Spill
Spacing	30.0' x 30.0'
Height	3.0' above grade

Illumination Summary	
	MAINTAINED HORIZONTAL FOOTCANDLES
Scan Average	0.0196
Maximum	0.07
Minimum	0.00
CU	0.00
No. of Points	59
LUMINAIRE INFORMATION	
Applied Circuits	A
No. of Luminaires	18
Total Load	15.00 kW

Guaranteed Performance: The ILLUMINATION described above is guaranteed per your Musco Warranty document and includes a 0.95 dirt depreciation factor.

Field Measurements: Individual field measurements may vary from computer-calculated predictions and should be taken in accordance with IESNA RP-6-15.

Electrical System Requirements: Refer to Amperage Draw Chart and/or the "Musco Control System Summary" for electrical sizing.

Installation Requirements: Results assume ± 3% nominal voltage at line side of the driver and structures located within 3 feet (1m) of design locations.

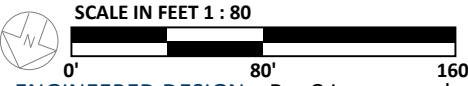

Pole location(s) ⊕ dimensions are relative to 0,0 reference point(s) ⊗



We Make It Happen.

Equipment List For Areas Shown

Pole				Luminaires				
QTY	LOCATION	SIZE	GRADE ELEVATION	ABOVE GRADE LEVEL	LUMINAIRE TYPE	QTY/POLE	THIS GRID	OTHER GRIDS
1	A1	60'	-	60'	TLC-LED-550	3	2	1
				60'	TLC-LED-900	1	1	0
				15.5'	TLC-BT-575	1	1	0
1	A2	60'	-	60'	TLC-LED-550	2	2	0
				60'	TLC-LED-900	1	1	0
				15.5'	TLC-BT-575	1	1	0
2	B1-B2	70'	-	70'	TLC-LED-1200	3	3	0
				70'	TLC-LED-900	1	1	0
				15.5'	TLC-BT-575	1	1	0
4	Totals					19	18	1

*Above Grade level relative to the field



McCall Park

Rincon, GA

Grid Summary	
Name	Softball Spill
Spacing	30.0' x 30.0'
Height	3.0' above grade

Illumination Summary	
	MAINTAINED MAX VERTICAL FOOTCANDLES
Scan Average	0.0632
Maximum	0.20
Minimum	0.00
CU	0.00
No. of Points	59
LUMINAIRE INFORMATION	
Applied Circuits	A
No. of Luminaires	18
Total Load	15.00 kW

Guaranteed Performance: The ILLUMINATION described above is guaranteed per your Musco Warranty document and includes a 0.95 dirt depreciation factor.

Field Measurements: Individual field measurements may vary from computer-calculated predictions and should be taken in accordance with IESNA RP-6-15.

Electrical System Requirements: Refer to Amperage Draw Chart and/or the "Musco Control System Summary" for electrical sizing.

Installation Requirements: Results assume ± 3% nominal voltage at line side of the driver and structures located within 3 feet (1m) of design locations.



We Make It Happen.

Not to be reproduced in whole or part without the written consent of Musco Sports Lighting, LLC. ©1981, 2023 Musco Sports Lighting, LLC.

Pole location(s) ⊕ dimensions are relative to 0,0 reference point(s) ⊗

ILLUMINATION SUMMARY

Equipment List For Areas Shown

Pole				Luminaires				
QTY	LOCATION	SIZE	GRADE ELEVATION	ABOVE GRADE LEVEL	LUMINAIRE TYPE	QTY/POLE	THIS GRID	OTHER GRIDS
1	A1	60'	-	60'	TLC-LED-550	3	2	1
				60'	TLC-LED-900	1	1	0
				15.5'	TLC-BT-575	1	1	0
1	A2	60'	-	60'	TLC-LED-550	2	2	0
				60'	TLC-LED-900	1	1	0
				15.5'	TLC-BT-575	1	1	0
2	B1-B2	70'	-	70'	TLC-LED-1200	3	3	0
				70'	TLC-LED-900	1	1	0
				15.5'	TLC-BT-575	1	1	0
4	Totals					19	18	1

*Above Grade level relative to the field



McCall Park

Rincon, GA

Grid Summary	
Name	Softball Spill Max Candela
Spacing	30.0' x 30.0'
Height	5.0' above grade

Illumination Summary	
MAINTAINED CANDELA (PER LIGHTBANK)	
Scan Average	2759.5906
Maximum	8081.84
Minimum	6.14
CU	0.00
No. of Points	59
LUMINAIRE INFORMATION	
Applied Circuits	A
No. of Luminaires	18
Total Load	15.00 kW

Guaranteed Performance: The ILLUMINATION described above is guaranteed per your Musco Warranty document and includes a 0.95 dirt depreciation factor.

Field Measurements: Individual field measurements may vary from computer-calculated predictions and should be taken in accordance with IESNA RP-6-15.

Electrical System Requirements: Refer to Amperage Draw Chart and/or the "Musco Control System Summary" for electrical sizing.

Installation Requirements: Results assume ± 3% nominal voltage at line side of the driver and structures located within 3 feet (1m) of design locations.

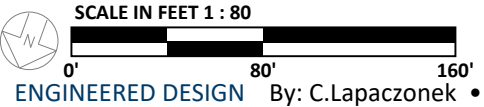

Pole location(s) ⊕ dimensions are relative to 0,0 reference point(s) ⊗



We Make It Happen.

Not to be reproduced in whole or part without the written consent of Musco Sports Lighting, LLC. ©1981, 2023 Musco Sports Lighting, LLC.

ILLUMINATION SUMMARY

McCall Park

Rincon, GA

Equipment Layout

INCLUDES:
- Softball

Electrical System Requirements: Refer to Amperage Draw Chart and/or the "Musco Control System Summary" for electrical sizing.

Installation Requirements: Results assume ± 3% nominal voltage at line side of the driver and structures located within 3 feet (1m) of design locations.

Equipment List For Areas Shown

QTY	Pole			Luminaires		
	LOCATION	SIZE	GRADE ELEVATION	ABOVE GRADE LEVEL	LUMINAIRE TYPE	QTY/POLE
1	A1	60'	-	60'	TLC-LED-550	3
				60'	TLC-LED-900	1
				15.5'	TLC-BT-575	1
1	A2	60'	-	60'	TLC-LED-550	2
				60'	TLC-LED-900	1
				15.5'	TLC-BT-575	1
2	B1-B2	70'	-	70'	TLC-LED-1200	3
				70'	TLC-LED-900	1
				15.5'	TLC-BT-575	1
2	P1-P2	20'	-	20'	CREE OSQ	1
6	Totals					21

Single Luminaire Amperage Draw Chart

Driver Specifications (.90 min power factor)	Line Amperage Per Luminaire (max draw)						
	208 (60)	220 (60)	240 (60)	277 (60)	347 (60)	380 (60)	480 (60)
CREE OSQ	-	-	-	-	0.3	-	0.2
TLC-BT-575	3.3	3.2	2.9	2.5	2.0	1.8	1.5
TLC-LED-1200	6.9	6.5	6.0	5.2	4.2	3.8	3.0
TLC-LED-550	3.2	3.0	2.8	2.4	1.9	1.8	1.4
TLC-LED-900	5.2	4.9	4.5	3.9	3.1	2.9	2.3



SCALE IN FEET 1 : 80
0' 80' 160'
ENGINEERED DESIGN By: C.Lapaczonek • File #234559A • 28-Mar-24

Pole location(s) ⊕ dimensions are relative to 0,0 reference point(s) ⊗



Not to be reproduced in whole or part without the written consent of Musco Sports Lighting, LLC. ©1981, 2023 Musco Sports Lighting, LLC.

EQUIPMENT LAYOUT