

DEVELOPER / RESPONSIBLE PARTY

KILDARE LAND COMPANY, LLC AND G AND G LAND HOLDINGS, LLC JODY BURNS AND DAVE BURNS 215 SPRINGFIELD ROAD SPRINGFIELD, GA 31329 (912) 682-1299

SUBDIVISION PLAT OF LAUREL GROVE - PHASE III 1559TH G. M. DISTRICT EFFINGHAM COUNTY, GEORGIA 02/11/2026 EMC PROJECT NO. 21-0100 PARENT PARCEL ID - 03520058

PROJECT DATA table with fields: OWNER/DEVELOPER, 24HR CONTACT, PIN, ZONING CLASSIFICATION, PROPOSED LAND USE, NUMBER OF LOTS, MINIMUM LOT SIZE, MIN. LOT FRONTAGE, FRONT SETBACK, REAR SETBACK (SIDE), REAR SETBACK (INTERIOR), SIDE SETBACK (STREET), SIDE SETBACK (INTERIOR).

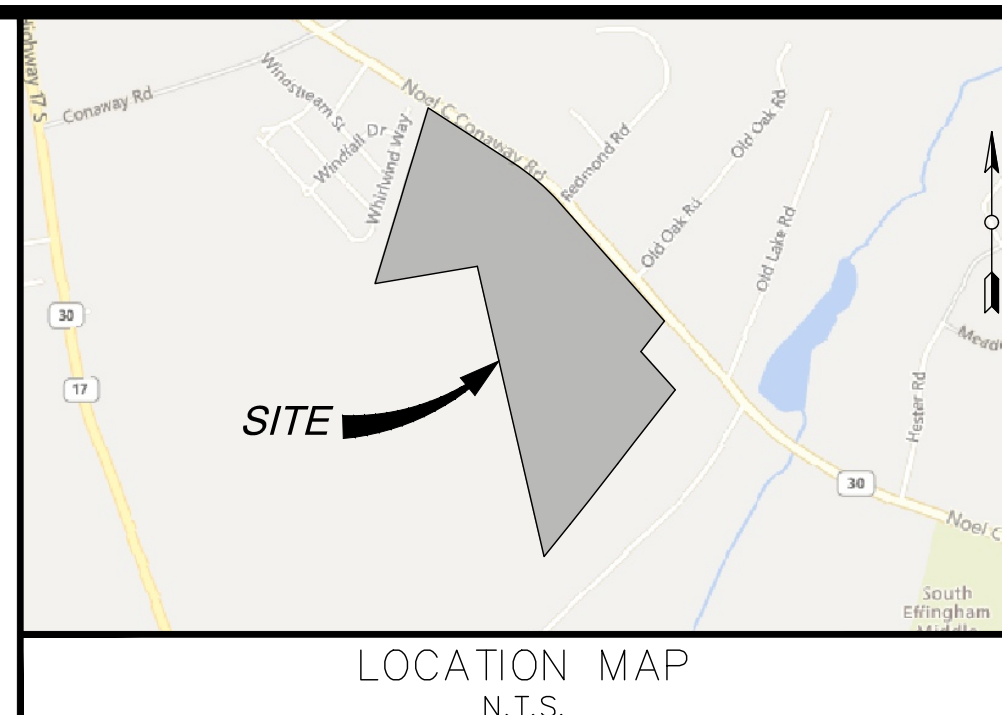

REVISION DESCRIPTION table with columns: NO., REVISION DESCRIPTION, DATE.

THIS BOX IS RESERVED FOR THE SUPERIOR COURT CLERKS FILING INFORMATION

CURVE TABLE and LINE TABLE with columns: CURVE #, BEARING, CHORD, RADIUS, ARC, LINE#, DIRECTION, LENGTH.

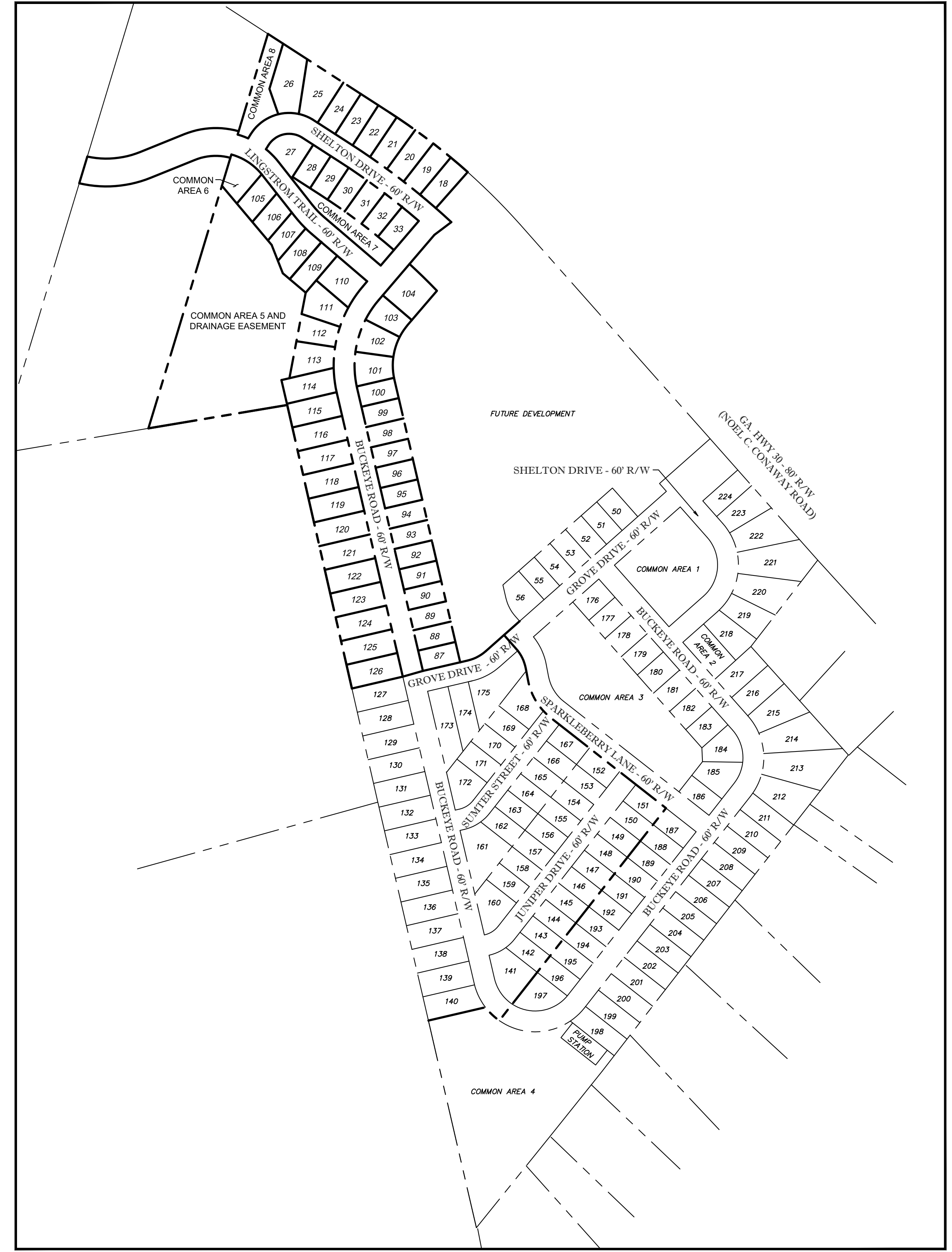

SURVEY NOTES

- 1. Horizontal Datum is Georgia State Plane Coordinate System of 1985, East Zone, North American Datum of 1983 (NAD83).
2. Vertical Datum is North American Vertical Datum of 1988 (NAVD88).
3. Basis of Bearings, Horizontal Control, Vertical Control and some spot elevations were obtained utilizing GPS (global positioning systems)...



EMC ENGINEERING SERVICES, INC. 27 Chatham Center South, Suite A Savannah, GA 31405

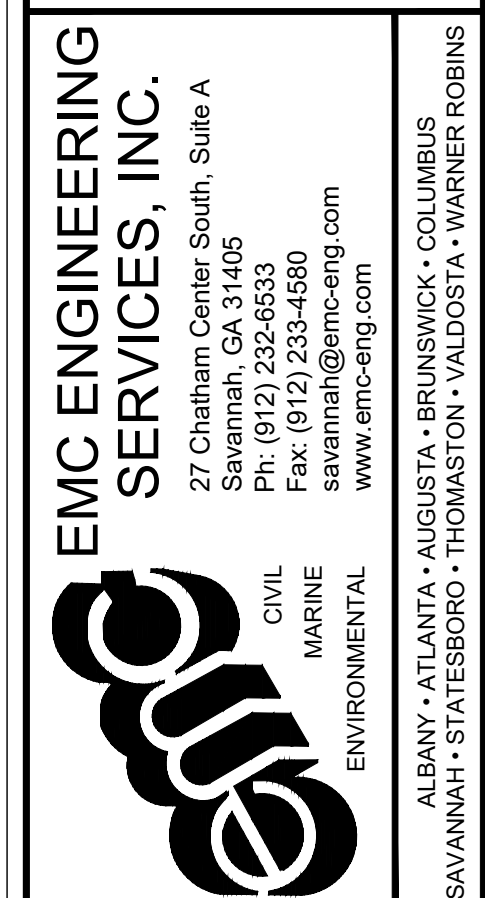

CERTIFICATIONS / APPROVALS

CERTIFICATE OF OWNERSHIP & DEDICATION IT IS HEREBY CERTIFIED THAT KILDARE LAND COMPANY, LLC AND G AND G LAND HOLDINGS, LLC, A CORPORATION DULY ORGANIZED AND EXISTING UNDER THE LAWS OF THE STATE OF GEORGIA, IS THE OWNER OF THE PROPERTY SHOWN AND DESCRIBED HEREON AND THAT WE HEREBY DEDICATE ALL STREETS, ALLEYS, WALKS, PARKS, AND OTHER SITES TO PUBLIC OR PRIVATE USE AS NOTED.

Signature lines for Corporation Name, Witness Name, and Chairman of Effingham County Board of Commissioners.

SURVEYORS CERTIFICATION

As required by subsection (d) of O.C.G.A. Section 15-6-67, this plat has been prepared by a land surveyor and approved by all applicable local jurisdictions for recording as evidenced by approval certificates, signatures, stamps, or statements hereon.



GA REG. L. S. LIC. NO. 3119 DATE

KEY MAP SCALE: 1" = 200'

SURVEY DATA table with columns: LAND AREA, RESIDENTIAL LOTS, RIGHTS-OF-WAY, COMMON AREA, TOTAL PHASE III AREA, FUTURE DEVELOPMENT, EXISTING PHASE I AREA, EXISTING PHASE II AREA, GA POWER EASEMENT AREA, TOTAL LAND AREA.

Plat Closure: 1 in 1,636,245 Field Precision: This entire survey was completed using GPS to set control, the Geomax Zoom90 Robotic Total Station to locate property corners and improvements.

REFERENCES table listing various deed books and pages (DB 140, PG 87; DB 212, PG 67; etc.).

LEGEND

Legend table defining symbols for ADJACENT PROPERTY LINE, PROPERTY BOUNDARY, METES AND BOUNDS, TAG LABEL, 1/2" IRON REBAR FOUND, 5/8" IRON REBAR FOUND, 5/8" IRON REBAR SET W/ CAP, CONCRETE MONUMENT SET, RIGHT-OF-WAY MONUMENT FOUND, CONCRETE MONUMENT FOUND, AXLE FOUND, POINT OF COMMENCING, POINT OF BEGINNING, PROPERTY ID NUMBER, NOW OR FORMERLY, RIGHT-OF-WAY, PLAT BOOK, DEED BOOK, PAGE, NOT TO SCALE, TEMPORARY BENCHMARK SET.

A MAJOR SUBDIVISION PLAT OF LAUREL GROVE - PHASE III 1559TH G. M. DISTRICT EFFINGHAM COUNTY, GEORGIA Prepared for: KILDARE LAND COMPANY, LLC AND G AND G LAND HOLDINGS, LLC

PROJECT NO.: 21-0100 DRAWN BY: SMB DESIGNED BY: SURVEYED BY: SURVEY DATE: 01/09/2026 CHECKED BY: SCALE: 1" = 200' DATE: 02/11/2026

01/2021/21-0100 BURNS DEVELOPMENT - HRV 30/01/21-0100_505 - PHASE 3/DWG 2/11/2026 12:45 PM

