

# ELIZABETH PARK PLAYGROUND

## PLAYGROUND EQUIPMENT

- 1-Bay 1-Cantilever Single Post Swing- PSW110WS
- 4-Foot Single Wave Slide- PSL019
- Zig Zag Balance Beam- PFS062
- Single Post Overhead Inverted Horizon Climber with Rope- PGS025
- Single Post Overhead Parallel Bar Climber- PGS026

## PLAYGROUND INFORMATION

### 1 BAY- 1 CANTILEVER SINGLE POST SWING

SKU: PSW110WS  
Quantity: 1



### 4 FOOT SINGLE WAVE SLIDE

SKU: PSL019  
Quantity: 1  
Use Zone: 25' X 16'  
Age Group: 2 to 12 Years



### ZIG ZAG BALANCE BEAM

SKU: PFS062  
Quantity: 1  
Use Zone: 14' X 21'  
Age Group: 2 to 12 Years



### SINGLE POST OVERHEAD INVERTED HORIZON CLIMBER WITH ROPE

SKU: PGS025  
Quantity: 1  
Use Zone: 21' X 15'  
Age Group: 5 to 12 Years

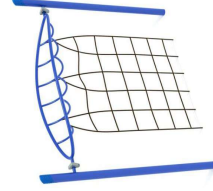

### SINGLE POST OVERHEAD PARALLEL BAR CLIMBER

SKU: PGS026  
Quantity: 1  
Use Zone: 21' X 14'  
Age Group: 5 to 12 Years



### DESIGN APPROVAL

By signing or initialing below, you agree that you have reviewed this drawing carefully and approve all elements depicted in this drawing which include the specific items themselves and their colors and placement as well as any surfacing depicted on this drawing including the type of surfacing, color, placement, layout, square footage, etc. Deviations or requests for changes from this plan after products have been ordered and/or work has begun may result in additional charges, change orders and delays to your project.

APPROVED BY: \_\_\_\_\_

SIGNATURE / TITLE: \_\_\_\_\_

DATE: \_\_\_\_\_

PROJECT NAME:  
ELIZABETH PARK  
PLAYGROUND

ADDRESS:  
31 ELIZABETH ST,  
EATONVILLE, FL 32751

REVISION: 2

DRAWN BY: MM

DATE: 04.06.2026

SHEET 1 OF 2

# ELIZABETH PARK PLAYGROUND



ProPlaygrounds, The Play  
and Recreation Experts  
1-800-573-PLAY  
www.proplaygrounds.com

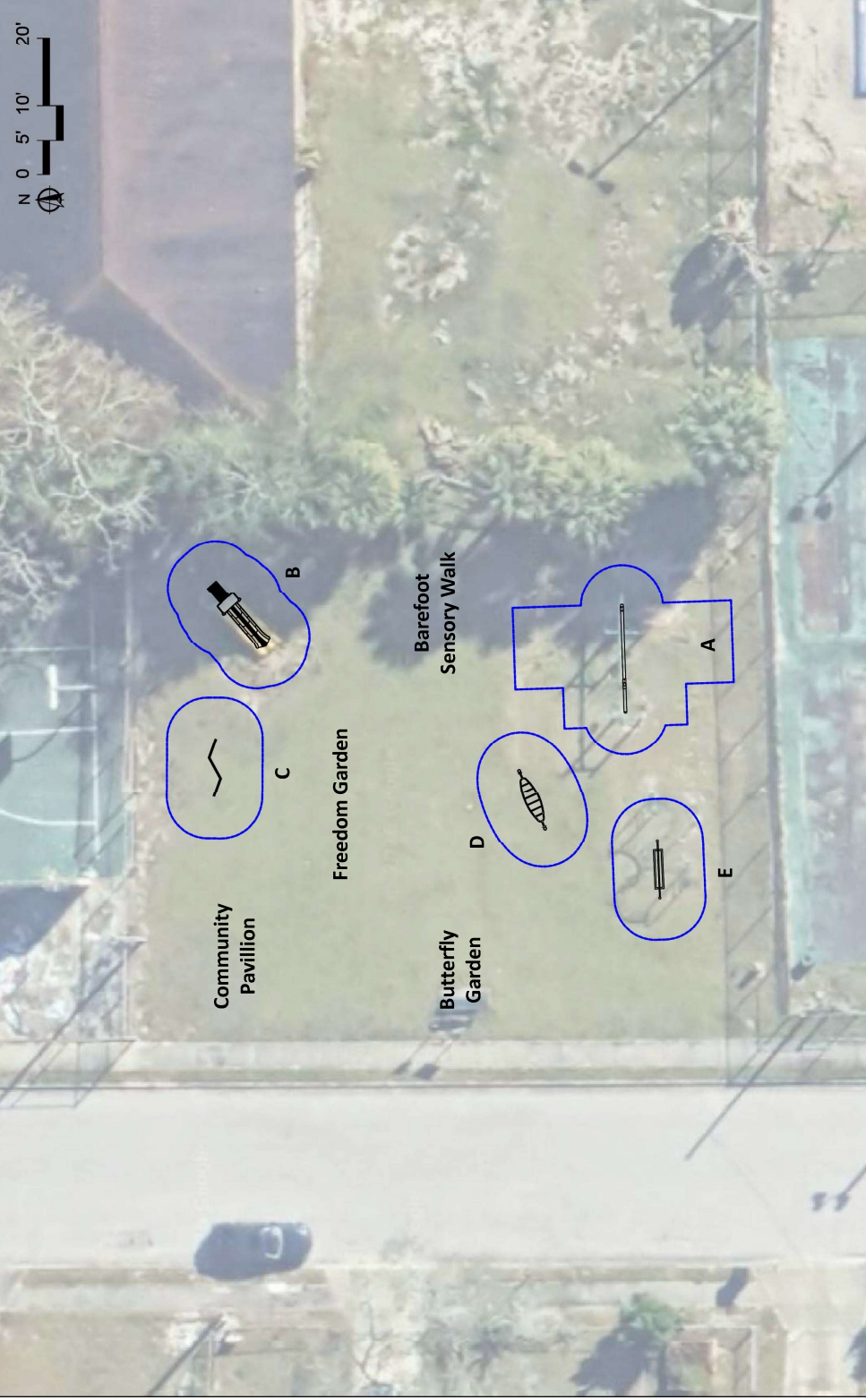

**DESIGN APPROVAL**  
By signing or initialing below, you agree that you have reviewed this drawing carefully and approve all elements depicted in this drawing which include the specific items themselves and their colors and placement as well as any surfacing depicted on this drawing including the type of surfacing, color, placement, layout, square footage, etc. Deviations or requests for changes from this plan after products have been ordered and/or work has begun may result in additional charges, change orders and delays to your project.

APPROVED BY: \_\_\_\_\_

SIGNATURE / TITLE: \_\_\_\_\_

DATE: \_\_\_\_\_

**PROJECT NAME:**  
ELIZABETH PARK  
PLAYGROUND

**ADDRESS:**  
31 ELIZABETH ST,  
EATONVILLE, FL 32751

**REVISION:**  
2

**DRAWN BY:** MM

**DATE:** 04.06.2026

**SHEET** 2 OF 2

## PLAYGROUND EQUIPMENT

- A. 1-Bay 1-Cantilever Single Post Swing- PSW110WS
- B. 4-Foot Single Wave Slide- PSL019
- C. Zig Zag Balance Beam- PFS062
- D. Single Post Overhead Inverted Horizon Climber with Rope- PGS025
- E. Single Post Overhead Parallel Bar Climber- PGS026