

RECORDER'S INDEX

LOCATION: LOT 1 OF "WEBER PLACE" IN SECTION 26,
BREMEN TOWNSHIP, DELAWARE COUNTY,
IOWA AND THAT PORTION OF ABANDONED
RAILROAD RIGHT OF WAY AS DESCRIBED
IN DEED BOOK 113, PAGE 129,
DELAWARE COUNTY, IOWA
REQUESTOR: DYERSVILLE READY MIX, INC.
c/o ELIJAH DEMMER
PROPRIETOR: DYERSVILLE READY MIX, INC.
SURVEYOR: DAVID P. SCHNEIDER
SURVEYOR COMPANY: SCHNEIDER LAND SURVEYING
AND PLANNING, INC.
RETURN TO: DAVID P. SCHNEIDER
P.O. BOX 128 FARLEY, IOWA
Ph#563-744-3631 daves@yousq.net

FINAL PLAT**WEBER PLACE PLAT 2, DELAWARE COUNTY, IOWA**

LOT 1 OF "WEBER PLACE" IN SECTION 26, BREMEN TOWNSHIP,
DELAWARE COUNTY, IOWA, AND THAT PORTION OF ABANDONED
RAILROAD RIGHT OF WAY AS DESCRIBED IN DEED BOOK 113,
PAGE 129 IN THE OFFICE OF THE RECORDER OF
DELAWARE COUNTY, IOWA

SEE PLAT OF SURVEY ON SHEET 2

TOTAL AREA
48.897 ACRES

SURVEY DESCRIPTION - WEBER PLACE PLAT 2, DELAWARE COUNTY, IOWA:

LOT 1 OF "WEBER PLACE" IN SECTION 26, BREMEN TOWNSHIP, DELAWARE COUNTY, IOWA AND THAT PORTION OF ABANDONED RAILROAD RIGHT OF WAY AS DESCRIBED IN DEED BOOK 113, PAGE 129 IN THE OFFICE OF THE RECORDER OF DELAWARE COUNTY, IOWA, MORE PARTICULARLY DESCRIBED AS FOLLOWS: BEGINNING AT THE NORTHWEST CORNER OF LOT 1 OF "WEBER PLACE" IN SECTION 26, BREMEN TOWNSHIP, DELAWARE COUNTY, IOWA; THENCE N89°27'02"E, 2080.69 FEET TO THE NORTHEAST CORNER OF SAID LOT 1; THENCE S00°32'58"E, 24.00 FEET ALONG THE EAST LINE OF SAID LOT 1; THENCE S89°27'02"W, 256.00 FEET ALONG THE EASTERLY LINE OF SAID LOT 1; THENCE S00°53'05"E, 1304.50 FEET ALONG THE EAST LINE OF SAID LOT 1 TO THE SOUTHEAST CORNER OF SAID LOT 1 AND THE NORTHWEST CORNER OF PARCEL 2017-64 AS ILLUSTRATED ON A PLAT OF SURVEY FILED ON DECEMBER 12, 2017 IN BOOK 2017, PAGE 3378 IN THE OFFICE OF THE RECORDER OF DELAWARE COUNTY, IOWA; THENCE S00°53'38"E, 103.87 FEET TO THE SOUTHWEST CORNER OF SAID PARCEL 2017-64 AND THE SOUTHERLY RIGHT OF WAY LINE OF THE ABANDONED RAILROAD PROPERTY AND THE NORTHERLY RIGHT OF WAY LINE OF VINE ROAD; THENCE N75°12'40"W, 1030.35 FEET ALONG SAID RIGHT OF WAY LINES TO THE BEGINNING OF A RIGHT OF WAY CURVE; THENCE WESTERLY AND NORTHWESTERLY, 445.82 FEET ALONG SAID CURVE HAVING A RADIUS OF 2915.00 FEET, CONCAVE TO THE NORTH, A CENTRAL ANGLE OF 8°45'46" AND A CHORD WHICH BEARS N70°51'00"W, 445.39 FEET; THENCE N66°25'41"W, 460.32 FEET ALONG SAID RIGHT OF WAY LINE TO THE NORTHWEST CORNER OF PARCEL "R" AS ILLUSTRATED ON A PLAT OF SURVEY FILED SEPTEMBER 12, 2006 IN BOOK 2006, PAGE 3366 IN THE OFFICE OF THE RECORDER OF DELAWARE COUNTY, IOWA; THENCE N00°32'20"W, 821.54 FEET ALONG THE WEST LINE OF THE SOUTHWEST QUARTER OF THE NORTHWEST QUARTER OF SECTION 26, TOWNSHIP 89 NORTH, RANGE 3 WEST OF THE 5th P.M., DELAWARE COUNTY, IOWA, TO THE POINT OF BEGINNING, CONTAINING 48.897 ACRES.

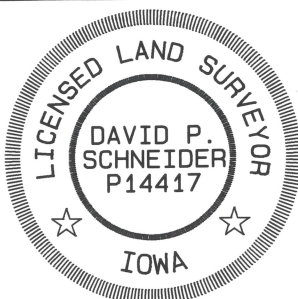

I hereby certify that this land surveying document was prepared and the related survey work was performed by me or under my direct personal supervision and that I am a duly licensed Land Surveyor under the laws of the State of Iowa.

David P. Schneider P.L.S. P14417

Date:

My license renewal date is December 31, 2025.

Pages or sheets covered by this seal: SHEETS 1 AND 2

SCHNEIDER
Land Surveying
&
Planning, Inc.

P.O. Box 128
Farley, Iowa 52046
Ph# 563-744-3631
daves@yousq.net

Project: 2928

Survey Date: 12/30/2024

Sheet: 1 of 2

