

LOCATION: LOT 2 OF WESTRIDGE ESTATES
9th ADDITION, CITY OF DYERSVILLE,
DELAWARE COUNTY, IOWA

REQUESTOR: JEANINE KOCH

PROPRIETORS: K & K BUILDING & SUPPLY, INC.

SURVEYOR: DAVID P. SCHNEIDER

SURVEYOR
COMPANY: SCHNEIDER LAND SURVEYING
AND PLANNING, INC.

RETURN TO: DAVID P. SCHNEIDER
P.O.BOX 128 FARLEY, IOWA
Ph#563-744-3631 daves@yousq.net

TOTAL AREA
0.299 ACRES

LOT B.
WESTRIDGE ESTATES
14th ADDITION
(BOOK 2018, PAGE 1678)

LOT 1
0.152 ACRES

LOT 2
0.147 ACRES

LOT 2, WESTRIDGE ESTATES 9th ADDITION
(BOOK 2013, PAGE 2395)

LOT 2, WESTRIDGE ESTATES 9th ADDITION
(BOOK 2010, PAGE 3993)

LOT 2, PIRC 2nd ADDITION
(BOOK 2014, PAGE 2936)

SURVEY DESCRIPTION:
LOT 2 OF WESTRIDGE ESTATES 9th
ADDITION IN THE CITY OF DYERSVILLE,
DELAWARE COUNTY, IOWA, ACCORDING TO THE
PLAT RECORDED IN BOOK 2013, PAGE 2395

FOUND 1/2" REBAR w/ YELLOW CAP #14417

FOUND 5/8" REBAR w/ ORANGE CAP #15487

SET 1/2" REBAR w/ YELLOW CAP #14417

FOUND MAG NAIL (TYP.)

NE CORNER, LOT 2, WESTRIDGE ESTATES 9th ADDITION FOUND MAG NAIL

SET MAG NAIL

SE CORNER, LOT 2, WESTRIDGE ESTATES 9th ADDITION FOUND 5/8" REBAR w/ ORANGE CAP #15487

8th STREET SW (50')

PUBLIC UTILITY EASEMENT (5')

PUBLIC UTILITY EASEMENT (8')

NW CORNER, LOT 2, WESTRIDGE ESTATES 9th ADDITION FOUND 5/8" REBAR w/ ORANGE CAP #15487

SW CORNER, LOT 2, WESTRIDGE ESTATES 9th ADDITION FOUND 5/8" REBAR

REC. AS: S02°24'42"E 100.01'

N00°51'14"W 99.92'

48.25'

51.66'

S00°53'18"E 53.91'

S89°13'24"W 130.09'

K & K ADDITION (BOOK 2022, PAGE 3244)

N89°57'42"E 130.08'

PUBLIC UTILITY EASEMENT (5')

N00°51'44"W 55.59'

49.91'

100.03'

S00°51'44"E 100.01'

REC. AS: S02°24'42"E 100.01'

50.13'

N89°59'13"W 130.10'

REC. AS: N88°23'22"E 130.01'

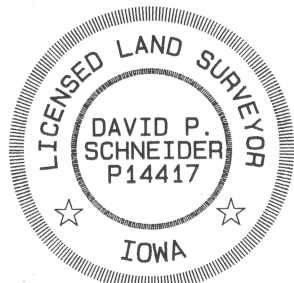

I hereby certify that this land surveying document was prepared and the related survey work was performed by me or under my direct personal supervision and that I am a duly licensed Land Surveyor under the laws of the State of Iowa.

David P. Schneider P.L.S. P14417 Date:
My license renewal date is December 31, 2025.
Pages or sheets covered by this seal: THIS SHEET ONLY

SCHNEIDER
Land Surveying
&
Planning, Inc.
P.O. Box 128
Farley, Iowa 52046
Ph# 563-744-3631
daves@yousg.net

| |
|-----------------------|
| Project: 2734A |
| Survey Date: 5/7/2024 |
| Sheet: 1 of 4 |