

DUBUQUE COUNTY - IOWA  
**APPLICATION FOR PLATTING**

1225 SEIPPEL ROAD,  
DUBUQUE, IA 52002

(Attach a Sketch Plat with application, showing existing structures, accesses and new lot lines)

Owner Name: Wayne Ameskamp Phone: 563-920-7450

Legal Description:

The NE 1/4 of the NW 1/4, except Lot 1, and the SE 1/4 of the NW 1/4, all in Sect. 27, T89N, R2W of the 5th P.M., Dubuque County, Iowa

Parcel #(s): 0727126001 # Acres 33.97  
0727100004 # Acres 38.79  
# Acres \_\_\_\_\_

Zoning District: \_\_\_\_\_ Total Acres: \_\_\_\_\_

Current Use of Property: \_\_\_\_\_

Existing Buildings & Structures:

NONE

Reason for Survey & Proposed Use of Each Lot:

To create a parcel to build new house to continue to assist in the farming operation - Lot 1  
Lot 2 - to remain as cultivated field

Note the Access for Each Lot:

Lot 1 - applied for entrance permit off Golf Course Road.  
Lot 2 = 2 entrances off Dyersville East + 1 entrance off Golf Course Road

**For Office Use Only**

Is Ag Exemption Form Required? No \_\_\_\_\_ Yes \_\_\_\_\_

Is property within 2 miles of a City? No \_\_\_\_\_ Yes \_\_\_\_\_  
Name of City \_\_\_\_\_

Is there access to each lot? \_\_\_\_\_

Acquisition Plat \_\_\_\_\_ Simple Plat \_\_\_\_\_ Subdivision: Major \_\_\_\_\_ Minor \_\_\_\_\_

List current addresses: \_\_\_\_\_

# RECORDER'S INDEX

LOCATION: THE NORTHEAST QUARTER OF THE  
NORTHWEST QUARTER, EXCEPT LOT 1,  
AND THE SOUTHEAST QUARTER OF THE  
NORTHWEST QUARTER, ALL IN SECTION 27,  
TOWNSHIP 89 NORTH, RANGE 2 WEST OF  
THE 5th P.M., DUBUQUE COUNTY, IOWA

REQUESTOR: RYAN AMESKAMP  
PROPRIETOR: WAYNE AMESKAMP AND  
SHARON AMESKAMP

SURVEYOR: DAVID P. SCHNEIDER  
SURVEYOR SCHNEIDER LAND SURVEYING  
COMPANY: AND PLANNING, INC.

RETURN TO: DAVID P. SCHNEIDER  
P.O. BOX 128 FARLEY, IOWA  
Ph#563-744-3631 daves@yousq.net

## FINAL PLAT AMESKAMP FARM SUBDIVISION, DUBUQUE COUNTY, IOWA THE NORTHEAST QUARTER OF THE NORTHWEST QUARTER, EXCEPT LOT 1, AND THE SOUTHEAST QUARTER OF THE NORTHWEST QUARTER, ALL IN SECTION 27, TOWNSHIP 89 NORTH, RANGE 2 WEST OF THE 5th P.M., DUBUQUE COUNTY, IOWA

### SURVEY DESCRIPTION - AMESKAMP FARM SUBDIVISION, DUBUQUE COUNTY, IOWA:

THE NORTHEAST QUARTER OF THE NORTHWEST QUARTER, EXCEPT LOT 1, AND  
THE SOUTHEAST QUARTER OF THE NORTHWEST QUARTER, ALL IN SECTION 27,  
TOWNSHIP 89 NORTH, RANGE 2 WEST OF THE 5th P.M., DUBUQUE COUNTY, IOWA,  
MORE PARTICULARLY DESCRIBED AS FOLLOWS: BEGINNING AT THE CENTER  
OF SAID SECTION 27; THENCE N89°21'38"W, 1327.98 FEET TO THE SOUTHWEST  
CORNER OF THE SOUTHEAST QUARTER OF THE NORTHWEST QUARTER OF SAID  
SECTION 27; THENCE N00°00'37"E, 1328.48 FEET TO THE NORTHWEST CORNER  
OF THE SOUTHEAST QUARTER OF THE NORTHWEST QUARTER OF SAID SECTION 27;  
THENCE N00°06'57"E, 1333.28 FEET TO THE NORTHWEST CORNER OF THE NORTHEAST  
QUARTER OF THE NORTHWEST QUARTER OF SAID SECTION 27; THENCE S89°35'54"E,  
1056.07 FEET ALONG THE NORTH LINE OF THE NORTHEAST QUARTER OF THE  
NORTHWEST QUARTER OF SAID SECTION 27 TO THE NORTHWEST CORNER OF LOT 1  
OF THE NORTHEAST QUARTER OF THE NORTHWEST QUARTER OF SAID SECTION 27;  
THENCE S00°13'43"W, 722.25 FEET TO THE SOUTHWEST CORNER OF SAID LOT 1;  
THENCE S89°43'48"E, 280.56 FEET TO THE SOUTHEAST CORNER OF SAID LOT 1;  
THENCE S00°15'28"W, 611.74 FEET TO THE SOUTHEAST CORNER OF THE NORTHEAST  
QUARTER OF THE NORTHWEST QUARTER OF SAID SECTION 27; THENCE S00°15'28"W,  
1333.88 FEET TO THE POINT OF BEGINNING, CONTAINING 76.889 ACRES, WHICH  
INCLUDES 2.587 ACRES OF EXISTING PUBLIC ROAD RIGHT OF WAY.

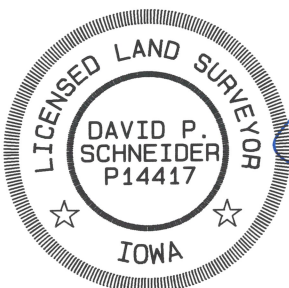

I hereby certify that this land surveying document was  
prepared and the related survey work was performed  
by me or under my direct personal supervision and that  
I am a duly licensed Land Surveyor under the laws of  
the State of Iowa

David P. Schneider P.L.S. P14417

Date:

My license renewal date is December 31, 2025.

Pages or sheets covered by this seal: SHEETS 1 & 2

**SCHNEIDER**  
Land Surveying  
&  
Planning, Inc.

P.O. Box 128  
Farley, Iowa 52046  
Ph# 563-744-3631  
daves@yousq.net

Project: 2925

Survey Date: 10/23/2024

Sheet: 1 of 7

