

1ST AVENUE WEST RESURFACING 2026 DYERSVILLE, IOWA

ON 1ST AVENUE WEST, FROM WCL TO 332ND AVE.

UTILITY PROVIDER CONTACTS	
ALLIANT ENERGY TERRY DEMPEWOLF 563-543-5885 terrydempewolf@alliantenergy.com	
GAS (HEATING) BLACK HILLS ENERGY JAN KRUEGER JAN.KRUEGER@BLACKHILLSCORP.COM 1-888-890-5554	
COMMUNICATIONS COMELEC INTERNET SERVICE 563-557-8442 AND WINDSTREAM COMMUNICATIONS LOCATE DESK WWW.IOWATELECOM.NET 1-800-347-1991	
LUMEN TECHNOLOGIES 877-453-8353	
MAQUOKETA VALLEY ELECTRIC COOPERATIVE 800-927-6068 ELECTRIC 800-582-8998 FIBER 877-811-1568	
IA DEPT. OF TRANSPORTATION JOE KILBURG 563-582-3063 JOEKILBURG@IOWADOT.US	
IA COMMUNICATIONS NETWORK SHANNON MARLOW 515-725-4402 shannon.marlow@iowa.gov	
MEDIACOM WWW.MEDIACOMCC.COM 1-855-633-4226	
DISH NETWORK 1-800-896-4616	
GARBAGE, RECYCLING BINS BI-COUNTY DISPOSAL 563-875-9076	
WATER & WASTEWATER DYERSVILLE UTILITIES TERRY RECKER 563-875-7724 WWW.CITYOFDYERSVILL.COM	



2021 AVERAGE ANNUAL DAILY TRAFFIC: 1080 VEHICLES PER DAY

LOCATION MAP

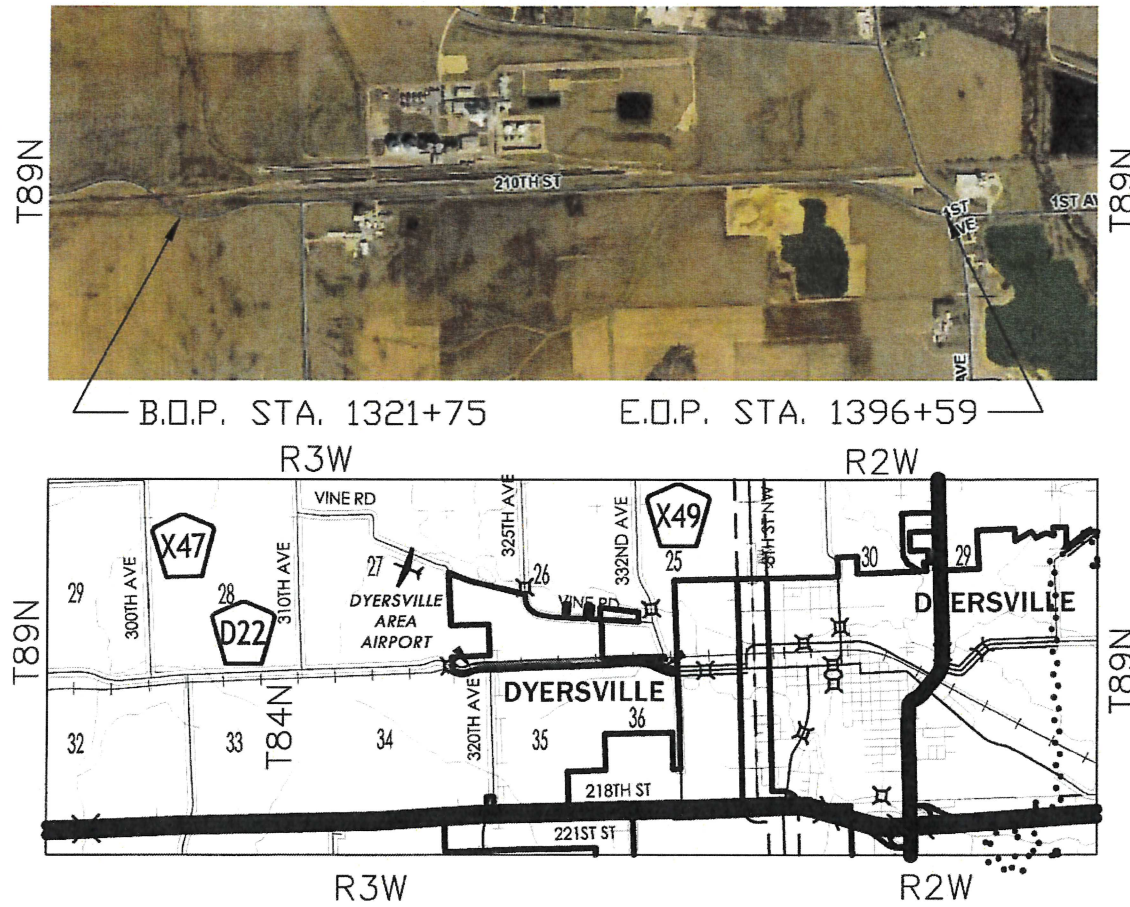

- REFER TO THE PROPOSAL FORM FOR LIST OF APPLICABLE SPECIFICATIONS.
- REFER TO SHEET C.02 FOR LIST OF STANDARD ROAD PLANS
- TRAFFIC CONTROL PLAN:
THIS ROAD WILL BE CLOSED TO THROUGH TRAFFIC BUT OPEN TO LOCAL TRAFFIC DURING CONSTRUCTION AS PROVIDED FOR IN ARTICLE 1107.08, 2025 STANDARD SPECIFICATIONS PLUS CURRENT SUPPLEMENTAL SPECIFICATIONS. TRAFFIC CONTROL DEVICES, PROCEDURES, LAYOUTS, SIGNING AND PAVEMENT MARKINGS INSTALLED WITHIN THE LIMITS OF THIS PROJECT SHALL CONFORM TO THE "MANUAL ON UNIFORM TRAFFIC CONTROL DEVICES FOR STREETS AND HIGHWAYS" AS ADOPTED BY THE DEPARTMENT PER 761 OF THE IOWA ADMINISTRATIVE CODE (IAC) CHAPTER 130.

INDEX OF SHEETS		9 SHEETS
No.	Description	
A.01	TITLE SHEET	
B.01	TYPICAL SECTIONS	
B.02	TYPICAL SECTIONS	
B.03	TYPICAL SHOULDERS AND JOINT SPACING	
C.01	ESTIMATE OF QUANTITIES	
C.02	GENERAL NOTES, STANDARD ROAD PLANS	
C.03	MISC. TABULATIONS	
J.01	DETOUR SHEET	
K.01	320th AVE. INTERSECTION AND E.O.P. DETAILS	

MILEAGE SUMMARY			
DIV.	LOCATION	LIN. FT.	MILES
	STA. 1321+75 TO STA. 1396+59	7484.00	1.4174
TOTAL		7484.00	1.4174



Public Works Department

JOHN WANDSNIDER, P.E.
CITY ENGINEER
340 1st AVENUE EAST
DYERSVILLE, IOWA 52040
PHONE 563-875-7724 FAX 563-875-8238
WWW.CITYOFDYERSVILLE.COM

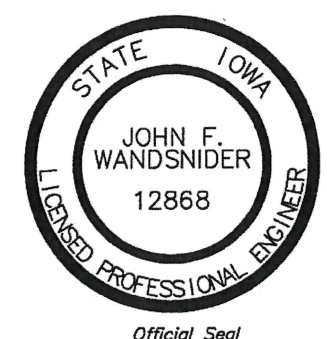

I hereby certify that this engineering document was prepared by me or under my direct supervision and that I am a duly licensed Professional Engineer under the laws of the State of Iowa.

John F. Wandsnider 11/3/25
John F. Wandsnider P.E. #12868 Date

My license renewal date is December 31, 2025
Pages or sheets covered by this seal:
ALL SHEETS LISTED IN SHEET INDEX



Client Name
CITY OF DYERSVILLE

Project Name
1st AVE. WEST RESURFACING 2026

NUMBER;
WO-1105-25

Location/Description
ON 1st AVE, FROM WCL TO 332nd AVE.

Revisions	Rev. Description	Date	Project Number	Project Manager

Sheet Title
COVER
A.01

Client Name

CITY OF
DYERSVILLE

Project Name
1st AVE. WEST
RESURFACING
2026

NUMBER;
WO-1105-25

Location/Description

ON 1st Ave.
FROM WCL
TO 332nd AVE.

Sheet Title

TYPICAL
SECTIONS

B.01

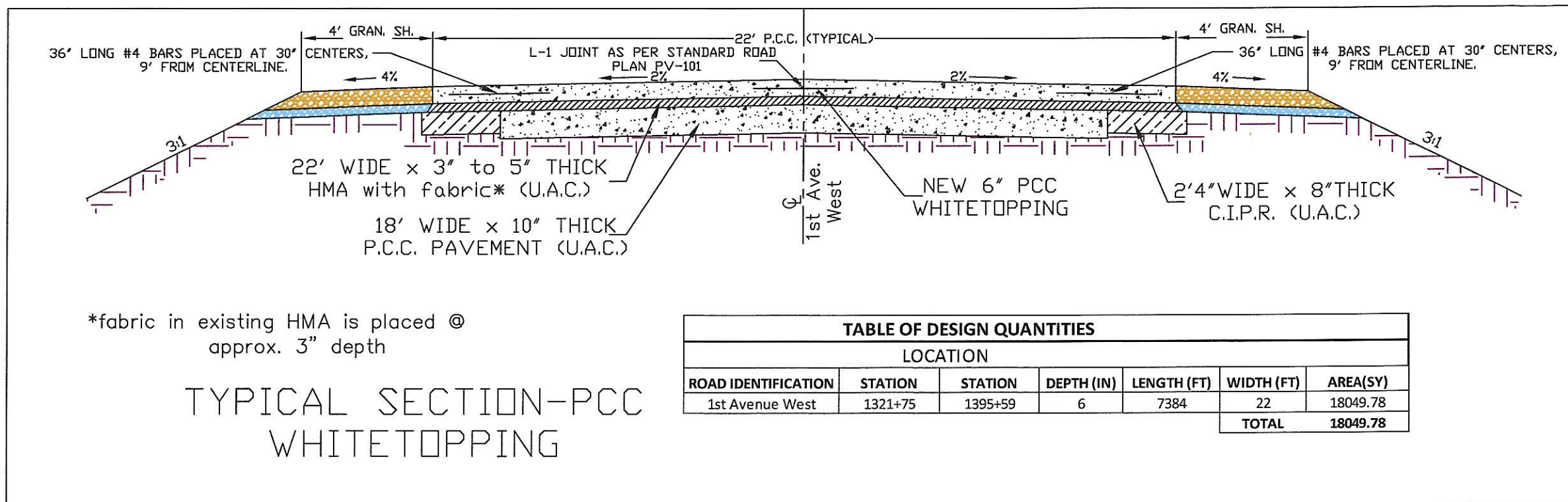
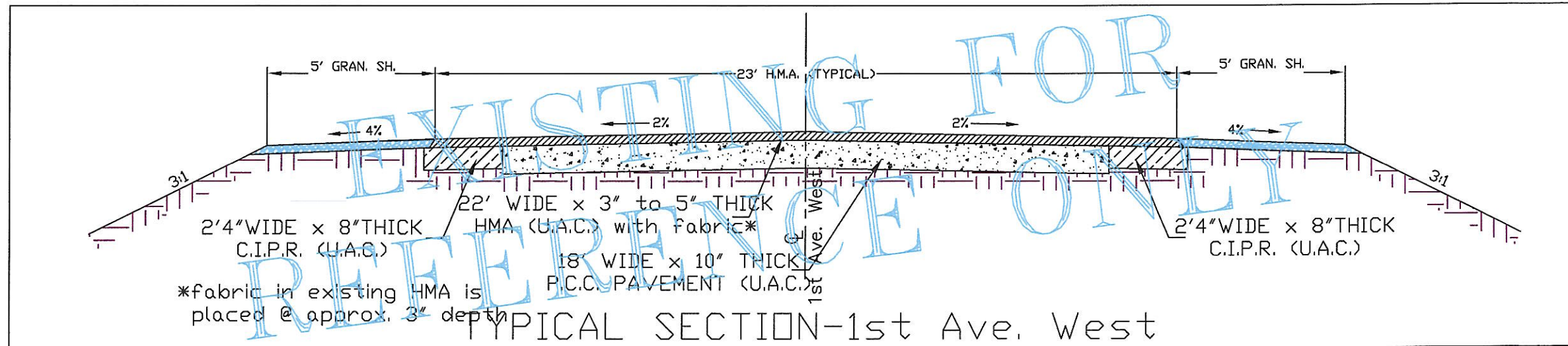

TABLE OF DESIGN QUANTITIES						
LOCATION						
ROAD IDENTIFICATION	STATION	STATION	DEPTH (IN)	LENGTH (FT)	WIDTH (FT)	AREA(SY)
1st Avenue West	1321+75	1395+59	6	7384	22	18049.78
TOTAL						18049.78

Client Name

CITY OF DYERSVILLE

Project Name
1st AVE. WEST RESURFACING 2026

NUMBER;
WO-1105-25

Location/Description

ON 1st Ave.
FROM WCL
TO 332nd AVE.

Sheet Title

TYPICAL SECTIONS

B.02

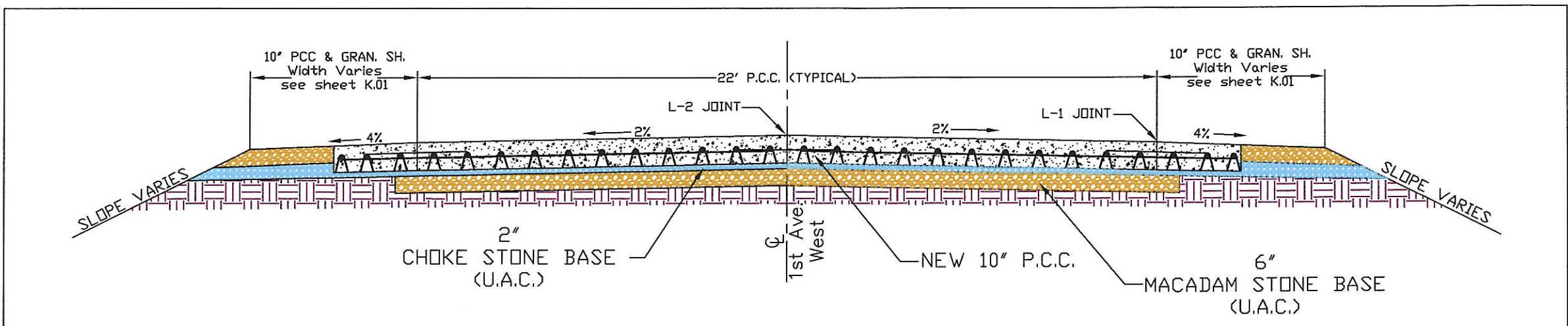
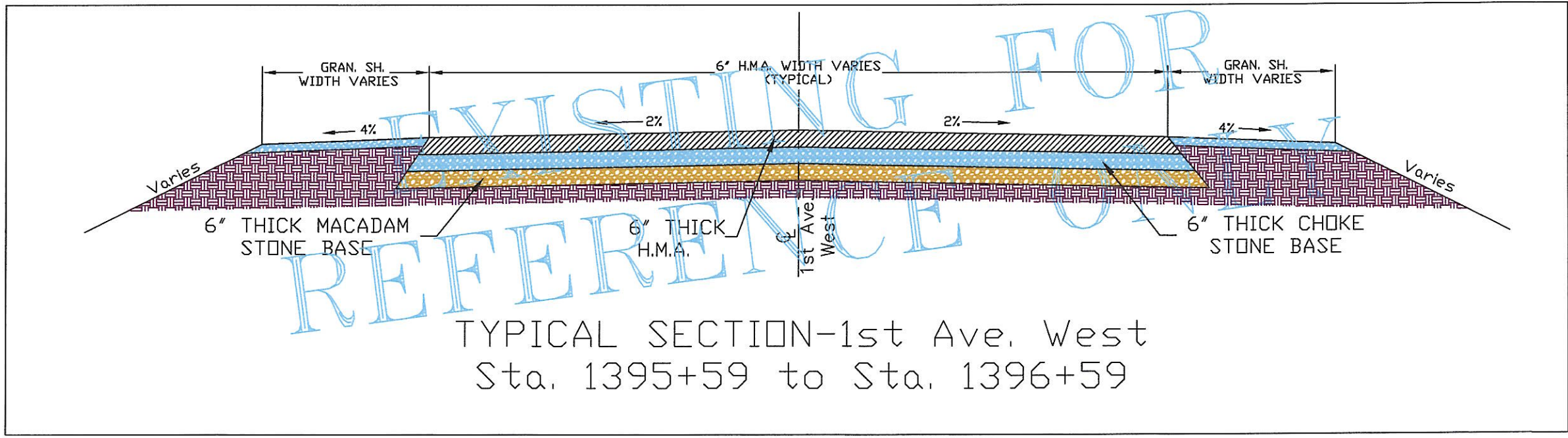

10" P.C.C. TABULATION					
	ROAD ID.	STATION TO STATION	LENGTH (ft)	WIDTH (ft)	S.Y.
1	1st Ave. West	1395+59 to 1396+59	100	Varies	367.62
2	320th Intersection	1334+94 Right	Varies	Varies	469.98
				TOTAL	837.60

TYPICAL SECTION-10" P.C.C.
(MAINLINE AND SHOULDER PAVEMENT AREAS)
INTERSECTION OF 320th Ave Rt. SHALL BE 10" P.C.C.
(SEE DETAIL ON SHEET K.01)

Client Name

CITY OF
DYERSVILLE

Project Name
1st AVE. EAST
RESURFACING
2026

NUMBER;
WO-1105-25

Location/Description

ON 1st St.
FROM WCL
TO 332nd AVE.

Sheet Title
TYPICAL
SHOULDERS
AND JOINT
SPACING

B.03

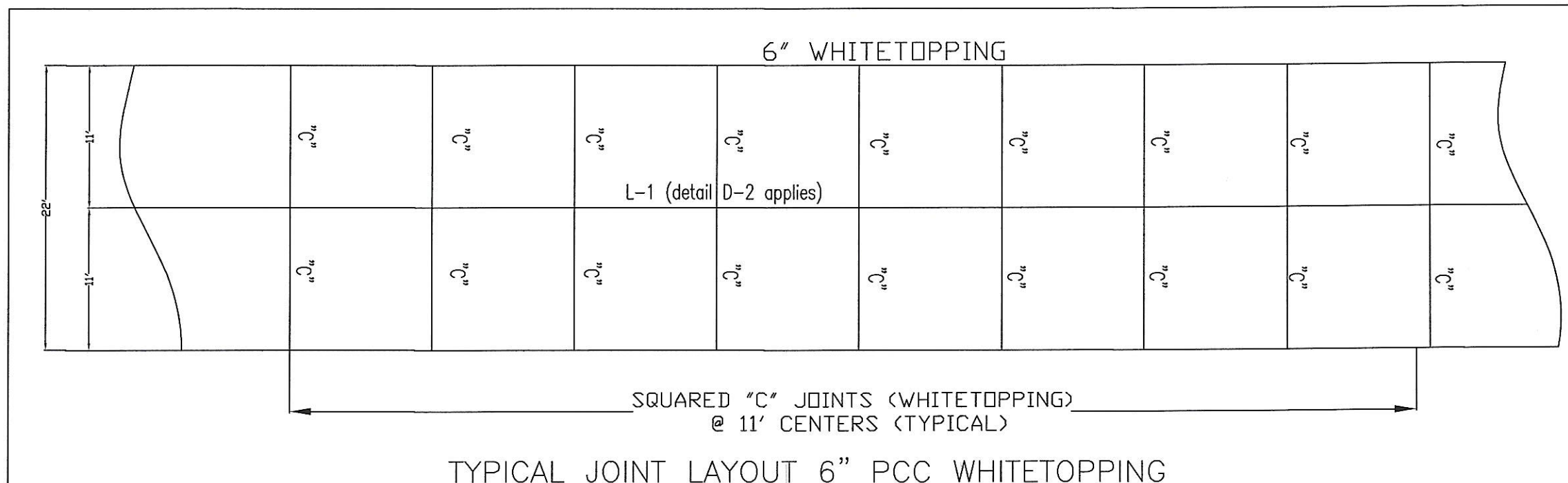
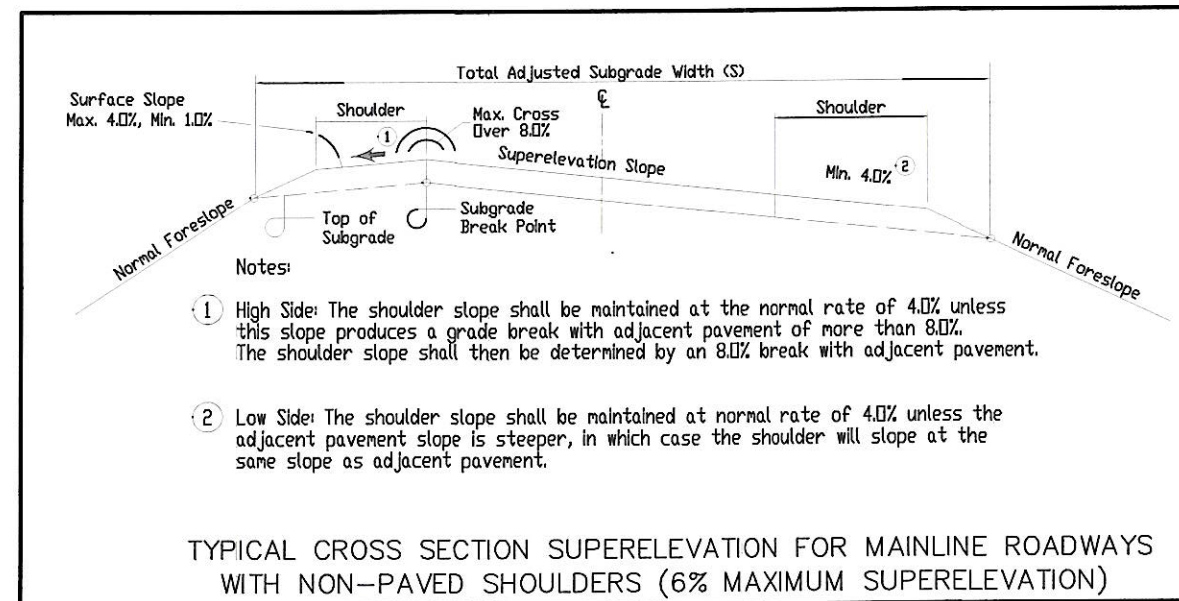
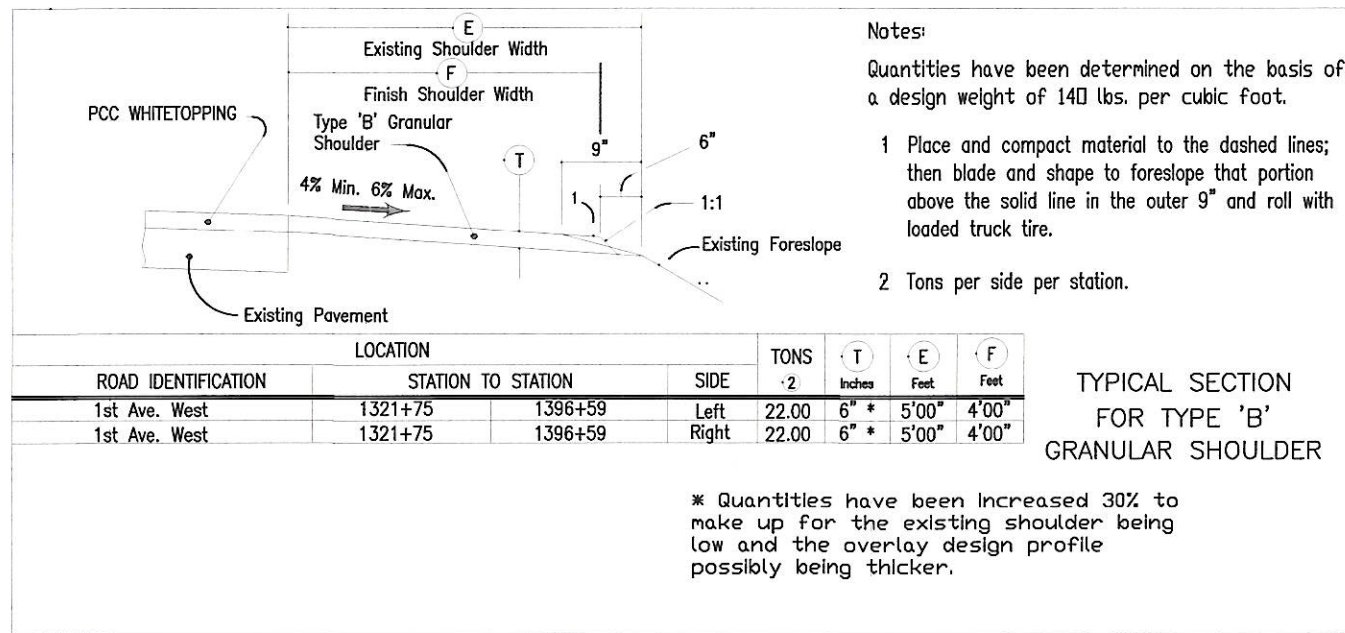



Client Name

CITY OF DYERSVILLE

Project Name

1st AVE. WEST RESURFACING 2026

NUMBER; WO-1105-25

Location/Description

ON 1st Ave. FROM WCL TO 332nd AVE.

Sheet Title

ESTIMATE OF QUANTITIES

C.01

ESTIMATED PROJECT QUANTITIES

PROJECT NUMBER; 1st AVE. WEST RESURFACING 2026

P.C.C. OVERLAY

REF. #	ITEM CODE	ITEM DESCRIPTION	UNIT	TOTAL
1	2102-2710090	EXCAVATION, CLASS 10, WASTE	CY	206.10
2	2115-0100000	MODIFIED SUBBASE	CY	112.00
3	2121-7425020	GRANULAR SHOULDERS, TYPE B	TON	3404.00
4	2213-7100400	RELOCATION OF MAILBOXES	EACH	1.00
5	2214-5145150	PAVEMENT SCARIFICATION	SY	1248.45
6	2301-1034100	STD/SLIPFORM PCC PAVEMENT, CLASS C 3i DURA, 10 IN.	SY	837.60
7	2310-5151040	PCC OVERLAY, FURNISH ONLY	CY	3610.00
8	2310-5151045	PCC OVERLAY, PLACEMENT ONLY	SY	18049.78
9	2315-8275025	SURFACING, DRIVEWAY, CLASS "A" CRUSHED STONE	TON	224.00
10	2316-0000110	PAYMENT ADJUSTMENT INC/DISINC FOR PCC PVMT SMOOTHNESS	EACH	13770.00
11	2510-6745850	REMOVAL OF PAVEMENT	SY	292.00
12	2526-8285000	CONSTRUCTION SURVEY	LS	1.00
13	2527-9263109	PAINTED PVMT. MARKINGS, WATERBORNE/SOLVENT	STA.	157.51
14	2528-2518000	SAFETY CLOSURE	EACH	8.00
15	2528-8445110	TRAFFIC CONTROL	LS	1.00
16	2533-4980005	MOBILIZATION	LS	1.00

ESTIMATED REFERENCE INFORMATION

Data listed is for informational purposes only and shall not constitute a basis for any extra work orders

NO.	ITEM CODE	DESCRIPTION
1	2102-2710090	EXCAVATION, CLASS 10, WASTE; FOR THE CORE OUTS IN THE 10" PCC AREAS IN ORDER TO ACCOMMODATE THE MODIFIED SUBBASE. THE CHOKER STONE THAT'S REMOVED FROM THE E.O.P CAN BE PLACED IN THE GRANULAR SHOULDERS OR UNDER THE PAVED SHOULDERS, ALL OTHER MATERIAL IS TO BECOME THE PROPERTY OF THE CONTRACTOR AND REMOVED FROM THE PROJECT.
2	2115-0100000	MODIFIED SUBBASE; TO BE PLACED 8" DEEP UNDER AND EXTEND 1' OUTSIDE THE FORM LINE AT THE 320 AVE. RT, INTERSECTION.
3	2121-7425020	GRANULAR SHOULDERS, TYPE B; CONSISTS OF FURNISHING, PLACING AND COMPACTING CLASS A SHOULDER STONE. SEE TYPICAL ON SHEET B.02. QUANTITIES HAVE BEEN INCREASED TO FILL LOW SHOULDERS. THE CONTRACTOR SHALL "BEE LINE" THE NEW SHOULDER IN ORDER FOR THE OUTSIDE EDGE OF THE NEW SHOULDER TO BLEND INTO THE EXISTING FORESLOPES.
4	2213-7100400	RELOCATION OF MAILBOXES; ITEM TO INCLUDE MOVING A MAILBOX DURING THE PAVING/SHOULDERING OPERATIONS TO A CENTRAL LOCATION DETERMINED BETWEEN THE CONTRACTOR AND THE POST OFFICE, THEN REINSTALLING BACK AT THE ORIGINAL LOCATIONS AT THE PROPER HEIGHT. THE ENGINEER WILL COUNT THE NUMBER OF MAILBOXES RELOCATED AND PAY THE CONTRACT UNIT PRICE OFF OF THAT COUNT. ONLY BOXES THAT U.S.P.S. IS DELIVERED TO WILL BE PAID FOR. SEE TABULATION BLOCK ON SHEET C.03.
5	2214-5145150	PAVEMENT SCARIFICATION; SEE SHEET C.03 FOR THE TABULATION BLOCK. ALL MATERIAL GENERATED FROM THE PAVEMENT SCARIFICATION SHALL BECOME THE PROPERTY OF THE CONTRACTOR AND BE REMOVED FROM THE PROJECT.
6	2301-1034100	STD/SLIPFORM PCC PAVEMENT, CLASS C, 3i DURA. 10 INCH; SEE SHEETS B.02 AND K.01 FOR TYPICALS AND LOCATIONS. CERTIFIED PLANT INSPECTION PER SPECIFICATION 2521, SHALL APPLY TO THIS ITEM. JOINT SPACING TO BE 11' PLACED PERPENDICULAR TO THE CENTERLINE OF THE ROADWAY AND HAVE DOWELED BASKETS.

ESTIMATED REFERENCE INFORMATION

Data listed is for informational purposes only and shall not constitute a basis for any extra work orders

NO.	ITEM CODE	DESCRIPTION
7	2310-5151040	PCC OVERLAY, FURNISH ONLY AND PCC PLACEMENT ONLY; STRENGTH OF PCC USING THE MATURITY METHOD SHALL APPLY. A MATURITY CURVE SHALL BE ESTABLISHED BEFORE THE START OF PAVING. CERTIFIED PLANT INSPECTION PER STANDARD SPECIFICATION 2521 SHALL APPLY. PAVEMENT SMOOTHNESS SPECIFICATION 2316 SHALL APPLY TO THIS PROJECT. L-1 JOINT TO BE PLACED AT THE CENTERLINE. TRANSVERSE "C" JOINTS SHALL BE PLACED AT 11' SPACING PERPENDICULAR TO THE CENTERLINE. THE CENTERLINE JOINT SHALL BE CUT AND SEALED. SEE TYPICAL AND TABULATION ON SHEET B.01. CLASS 3i STONE WILL BE REQUIRED IN THE MIX. QUANTITY OF PCC FURNISH ITEM HAS BEEN INCREASED BY 20% IN ORDER TO COMPENSATE FOR DEVIATIONS IN THE DESIGN PROFILE.
8	2310-5151045	
9	2315-8275025	SURFACING, DRIVEWAY, CLASS "A" STONE; TO BE PLACED AT ALL ENTRANCES AND INTERSECTIONS. ESTIMATED AT 16 TON PER ENTRANCE, 32 TON PER SIDE ROAD INTERSECTION AND 48 TON PER LARGE ENTRANCE (TOTAL FOR PROJECT 3 ENTRANCES, 3 LARGE ENTRANCES AND 1 INTERSECTION). EXTRA QUANTITY HAS BEEN FIGURED IN TO ALLOW FOR PLACEMENT OF ROCK WEDGES TO GET PROPERTY OWNERS ONTO THE PAVEMENT BEFORE THE SHOULDERING IS COMPLETED.
10	2316-0000110	PAYMENT ADJUSTMENT INCENTIVE/DISINCENTIVE FOR PCC PAVEMENT SMOOTHNESS (BY SCHEDULE; PRICE SHOWN IS DETERMINED BY THE I.D.O.T. DESIGN MANUAL (CHAPTER 1). THIS PRICE IS FOR BUDGETING PURPOSES ONLY. THE ACTUAL PAYMENT FOR THIS ITEM WILL BE DETERMINED BY THE PROFILOMETER REPORTS AFTER THE PAVING IS COMPLETED.
11	2510-6745850	REMOVAL OF PAVEMENT; SEE TABULATION ON SHEET C.03.
12	2526-8285000	CONSTRUCTION SURVEY; THE CONTRACTOR SHALL PERFORM A TOPOGRAPHICAL SURVEY OF THE ROAD AND DEVELOP A FINAL ALIGNMENT AND PROFILE TO BE SUBMITTED AND APPROVED BY THE CITY OF DYERSVILLE FOR USE WITH EITHER STRING OR STRINGLESS PAVING. CONTRACTOR IS TO ESTABLISH ALL CONTROL POINTS, BENCH MARKS ETC. TO TOPO AND CONSTRUCT THE OVERLAY. THE CONTRACTOR SHALL PRESERVE AND REESTABLISH ALL SECTION CORNERS. THE PRELIMINARY SURVEY FOR PLAN DEVELOPEMENT WAS DONE USING THE RTN, ELKADER REGIONAL COORDINATE SYSTEM.
13	2527-9263109	PAINTED PAVEMENT MARKINGS, WATERBORNE/SOLVENT BASED; TWO GUN SYSTEM WITH THE 10" SPACE AT CENTERLINE TO BE USED AND ALL MARKINGS SHALL BE PLACED WITHIN AN ACCURACY TOLERANCE OF 2" +/- FROM THE SPECIFIED APPLICATION LINE OR IT SHALL BE CORRECTED AS DIRECTED BY THE PROJECT ENGINEER. SEE SHEET C.03 FOR TABULATIONS. THE CURING COMPOUND SHALL BE REMOVED BEFORE ANY PAINT IS PLACED.
14	2528-2518000	SAFETY CLOSURE; CONTRACTOR SHALL FURNISH, ERECT AND MAINTAIN SAFETY CLOSURE AT THE LOCATIONS SHOWN ON SHEET C.03. SAFETY CLOSURES SHALL ALSO BE PLACED AT DAYS END HEADERS.
15	2528-8445110	TRAFFIC CONTROL; ITEM INCLUDES ALL ROAD CLOSURE AND DETOUR SIGNAGE. SEE SHEET C.02 FOR TRAFFIC CONTROL NOTES AND SHEET J.01 FOR DETOUR SIGNAGE.

GENERAL NOTES & INFORMATION

THE IOWA DEPARTMENT OF TRANSPORTATION STANDARD SPECIFICATIONS SERIES 2023 AND ALL SUPPLEMENTAL SPECIFICATION WILL APPLY TO THIS PROJECT.

UNLESS OTHERWISE DIRECTED OR AUTHORIZED, ALL ASPHALTIC CEMENT CONCRETE AND OTHER BITUMINOUS MATERIALS WHICH ARE NOT SPECIFICALLY ADDRESSED OR DESCRIBED IN THE PLANS SHALL BECOME THE PROPERTY OF THE CONTRACTOR.

THE CONTRACTOR IN ACCORDANCE WITH CURRENT RULES AND REGULATIONS OF THE IOWA DEPARTMENT OF NATURAL RESOURCES MAY;

1. WITH THE APPROVAL OF THE ENGINEER, BLEND OR OTHERWISE PROCESS THE MATERIAL FOR USE WITH SHOULDER OR SPECIAL BACKFILL AGGREGATE FOR USE ON THIS PROJECT.
2. WITH THE APPROVAL OF THE ENGINEER, PLACE WITH MATERIAL DESIGNATED BY THE ENGINEER AS SOIL AGGREGATE SUBBASE WITHOUT EXTRA CHARGE.
3. REMOVE THE MATERIAL FROM THE PROJECT AND STOCKPILE FOR THE CONTRACTORS FUTURE USE.

TRAFFIC CONTROL PLAN

THIS ROAD WILL BE CLOSED TO THROUGH TRAFFIC DURING CONSTRUCTION. LOCAL TRAFFIC TO ADJACENT PROPERTIES WILL BE MAINTAINED AS PROVIDED FOR IN ARTICLE 1107.08 OF THE CURRENT STANDARD SPECIFICATIONS. TRAFFIC CONTROL DEVICES, PROCEDURES AND LAYOUTS SHALL BE AS PER PART VI OF THE MANUAL OF UNIFORM TRAFFIC CONTROL DEVICES (MUTCO) FOR STREET AND HIGHWAYS AS ADOPTED BY THE DEPARTMENT PER 761 OF THE IOWA ADMINISTRATIVE CODE (IAC) CHAPTER 130.

1. AS SOON AS PAVEMENT REACHES MATURITY FOR EACH DAY OF PAVING, THE CONTRACTOR SHALL FURNISH AND PLACE SIGNING TO AND ALLOW FOR RESIDENT ACCESS ONLY. GRANULAR WEDGES SHALL BE PLACED AT THIS TIME AT EACH DRIVE.
2. ROAD CLOSURE CONFIGURATION TC-252 (SAFETY CLOSURE, CLOSED TO THROUGH TRAFFIC ETC.) SHALL BE ADJUSTED AS THE PAVING PROGRESSES.
3. ALL TRAFFIC CONTROL DEVICES SHALL BE FURNISHED, ERECTED, MAINTAINED AND REMOVED BY THE CONTRACTOR.
4. AS APPLICABLE PERMANENT EDGE LINES, CENTER LINES AND LANE LINES SHALL BE PLACED BEFORE THE ROADWAY IS RETURNED TO NORMAL TRAFFIC.
5. PERMANENT SIGNING THAT CONVEYS A MESSAGE CONTRARY TO THE MESSAGE OF THE TEMPORARY SIGNING AND NOT APPLICABLE TO THE WORKING CONDITIONS SHALL BE COVERED BY THE CONTRACTOR WHEN DIRECTED BY THE ENGINEER.
6. PROPOSED CHANGES OF THE TRAFFIC CONTROL PLAN SHALL BE REVIEWED BY THE ENGINEER BEFORE CHANGES ARE MADE.
7. "BUMP" OR "ROUGH ROAD" SIGNS SHALL BE ERECTED IN ADVANCE OF SCARIFICATION AREAS. "NO PAVEMENT MARKING" SIGNS SHALL BE ERECTED AND KEPT IN PLACE UNTIL THE PAVEMENT MARKINGS ARE COMPLETED.
8. THE CONTRACTOR SHALL COORDINATE TRAFFIC CONTROL WITH OTHER PROJECTS IN THE AREA.
9. IT SHALL BE THE CONTRACTOR'S RESPONSIBILITY TO WORK WITH THE ADJOINING PROPERTY OWNERS IN ORDER TO PROVIDE THEM ACCESS DURING THE PROJECT. ANY PROBLEMS THAT ARISE CONCERNING ACCESS FOR THE ADJOINING PROPERTY OWNERS SHALL BE THE CONTRACTOR'S RESPONSIBILITY, NOT THE CITY OF DYERSVILLE'S.
10. THE CONTRACTOR SHALL SET UP AND MAINTAIN THE DETOUR FOR THIS PROJECT. SEE SHEET J.01 FOR SIGNAGE LAYOUT. THE CONTRACTING AUTHORITY WILL PROVIDE THE ROUTE MARKING SIGNS AND THE CONTRACTOR IS TO RETURN THESE SIGNS AFTER THE PROJECT IS COMPLETED.

STANDARD ROAD PLANS

Number	Date	Sheets	Title
PM-110	04/16/24	4	LINE TYPES
PV-101	04/19/22	8	JOINTS
TC-233	10/17/17	2	PAVEMENT MARKING OPERATION, TWO LANE
TC-252	10/21/25	4	ROUTES CLOSED TO TRAFFIC
TC-284	10/15/19	1	NO CENTERLINE MARKINGS ON NON-PRIMARY ROADS

CERTIFIED PLANT INSPECTION

CERTIFIED PLANT INSPECTION SHALL APPLY TO ALL ITEMS INVOLVING CONCRETE ON THIS PROJECT.

CONSTRUCTION STAGING

THE CONTRACTOR SHALL SUBMIT TO THE ENGINEER A PROPOSED SEQUENCE OF WORK ACTIVITIES PRIOR TO THE BEGINNING OF WORK.



Client Name

CITY OF DYERSVILLE

Project Name

1st AVE. WEST
RESURFACING
2026

NUMBER;
WO-1105-25

Location/Description

ON 1st Ave.
FROM WCL
TO 332nd AVE.

Sheet Title

GENERAL NOTES/
STANDARD ROAD
PLANS

C.02



Client Name

CITY OF DYERSVILLE

Project Name
1st AVE. WEST RESURFACING 2026

NUMBER;
WO-1105-25

Location/Description

ON 1st Ave.
FROM WCL
TO 332nd AVE.

Sheet Title

MISC.
TABULATIONS

C.03

CLASS 10 WASTE TABULATION (Item #1)				
Location		area	depth	total
Sta.	Sta.	(s.f.)	(inches)	(c.y.)
1395+59	1396+59	3309.0	0.33	40.1
320th Ave. Rt. Intersection		4474.0	12	166.0
Total				206.1

MODIFIED SUBBASE TABULATION (Item #2)						
Sta.	Sta.	length	width	depth	total	total
		(ft)	(ft)	(inches)	s.f.	(c.y.)
320th Ave. Rt Intersection		Varies	Varies	8	4514	112.0
					TOTAL	112.0

REMARKS;
*Width varies due to the intersection geometry. See K sheets for details.

RELOCATION OF MAILBOXES (Item #4)				
#	ROAD	911 ADDRESS	SIDE	NUMBER
1	1st Ave. West	3240	Lt.	1
			TOTAL	1

Only boxes that U.S.P.S. delivers to will be paid for. Paper boxes are not included in this bid item.

PAVEMENT SCARIFICATION AREAS (Item # 5)						
Sta.	Sta.	length	width	depth	total	total
		(ft)	(ft)	(inches)	s.f.	(s.y.)
1321+75	1324+75	300	23 +/-	Tapers 6" to 0"	6782	753.56
1393+59	1395+59	200	23 +/-	Tapers 0" to 4"	4454	494.89
					TOTAL	1248.45

Centerline Pavement Marking Tabulation (yellow) (Item #13)			
Station	Station	Meas. Factor	Stations
1321+75	1342+44	1.33	27.51
1342+44	1352+52	0.84	8.47
1352+52	1379+61	0.17	4.61
1379+61	1390+00	0.84	8.73
1390+00	1396+59	1.33	8.76
Total			58.08

Edgeline Pavement Marking Tabulation (white) (Item #13)				
Station	Station	Side	Meas. Factor	Stations
1321+75	1396+59	Left	0.67	50.14
1321+75	1334+30	Right	0.67	8.41
1335+57	1396+59	Right	0.67	40.88
Total				99.43

TABULATION OF SAFETY CLOSURES (Item #14)			
REFER TO 2528 OF THE STANDARD SPECIFICATIONS			
LOCATION	SIDE	EACH	REMARKS
B.O.P. Sta. 1321+75		1	THIS LIST MAY NOT BE ALL INCLUSIVE, ADDITIONAL SAFETY CLOSURES MAY BE NEEDED AS THE PROJECT PROGRESSES. THE PROJECT ENGINEER MAY APPROVE ADDITIONAL SAFETY CLOSURES IF THE NEED ARISES.
320th Ave.	Right	1	
E.O.P. Sta. 1396+59		1	
End of Day		5	
TOTAL		8	

REMOVAL OF PAVEMENT (Item #10)						
Station to Station	Pavement Type	Length (feet)	Width (feet)	Area (sq. yds.)	Saw Cut* (lin. Feet)	Remarks
1395+59	1396+59	6" HMA	100	Varies	292.00	22
				TOTAL	292.00	

* NOT A PAY ITEM

ALL PAVEMENT REMOVED SHALL BECOME THE PROPERTY OF THE CONTRACTOR AND REMOVED FROM THE PROJECT. HMA MAY BE THICKER IN SOME AREAS, NO EXTRA COMPENSATION WILL BE MADE FOR REMOVING EXTRA DEPTH PAVEMENT.

B.O.P. 1321+75

E.O.P. 1396+59

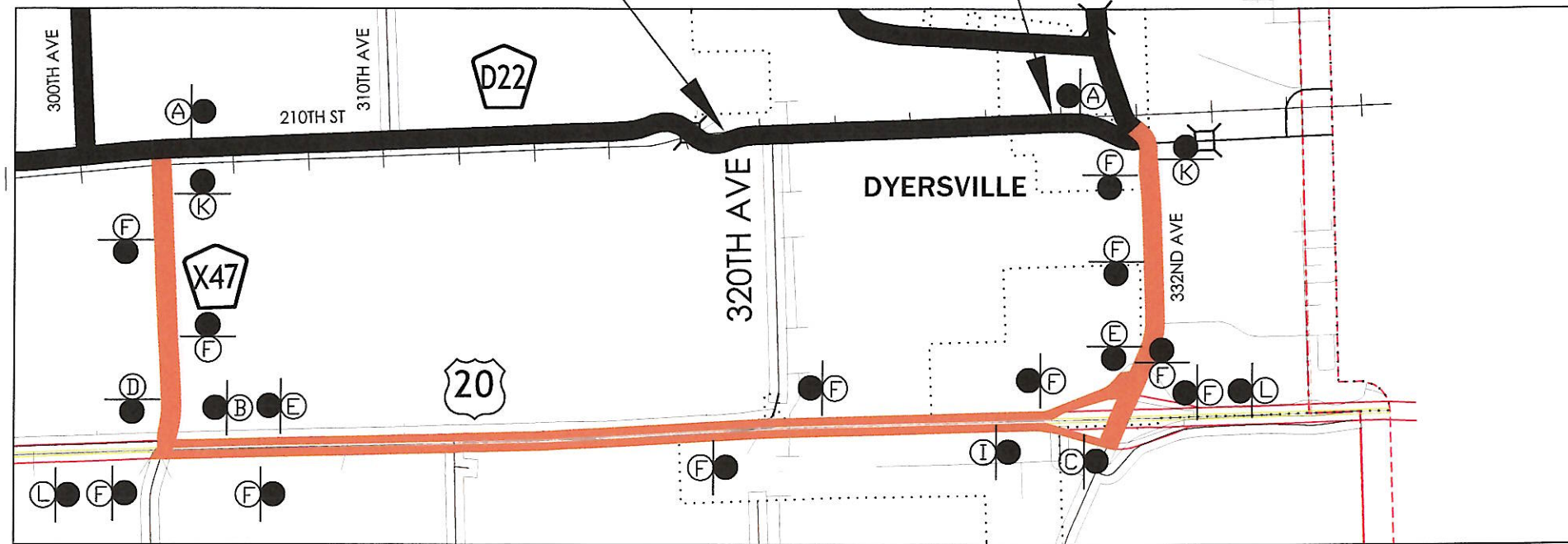

— DETOUR ROUTE
— PAVEMENTS
— GRAVELS

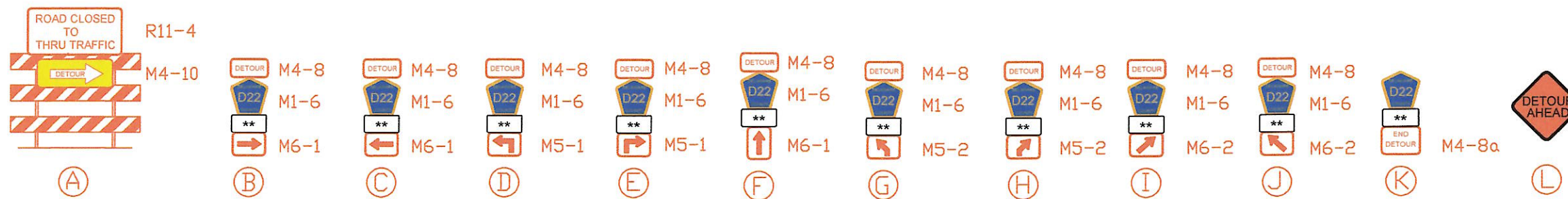

** THE APPROPRIATE (WEST/EAST) CARDINAL DIRECTION SIGNS SHALL BE PLACED ON ALL SIGN ASSEMBLIES

THE CONTRACTING AUTHORITY WILL PROVIDE THE ROUTE MARKER SIGNS AND THE CONTRACTOR IS TO RETURN THE SIGNS AFTER THE PROJECT IS COMPLETED.

DETOUR SIGNAGE

Client Name

CITY OF DYERSVILLE

Project Name
1st AVE. WEST
RESURFACING
2026

NUMBER;
WO-1105-25

Location/Description

ON 1st Ave.
FROM WCL
TO 332nd AVE.

Sheet Title

320th Ave. Rt.
INTERSECTION
AND E.O.P.
DETAILS

K.01

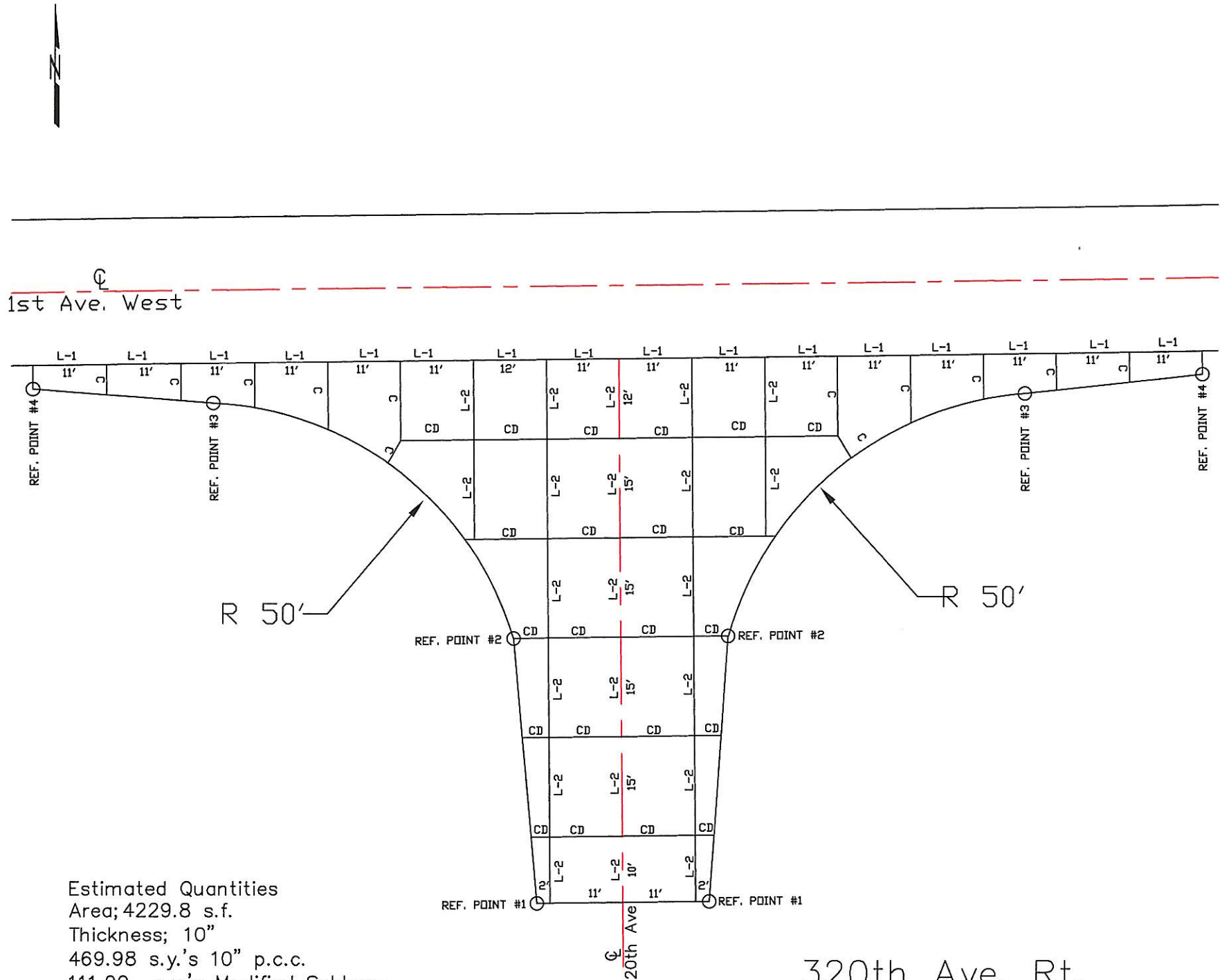

Estimated Quantities
Area; 4229.8 s.f.
Thickness; 10"
469.98 s.y.'s 10" p.c.c.
111.00 c.y.'s Modified Subbase
166.00 c.y.'s Class 10 Waste

REFERENCE POINTS		
#	FROM ϕ OF COUNTY ROAD 320th Ave.	FROM EDGE OF 1st Ave.
1	13'00"	82'00"
2	16'02"	42'00"
3	61'03"	6'00"
4	87'00"	4'00"

320th Ave. Rt. P.C.C. Intersection Details

INTERSECTION NOTES;
Joints should match the mainline PCC joints.
Intersection to be poured to drain towards the south and west.

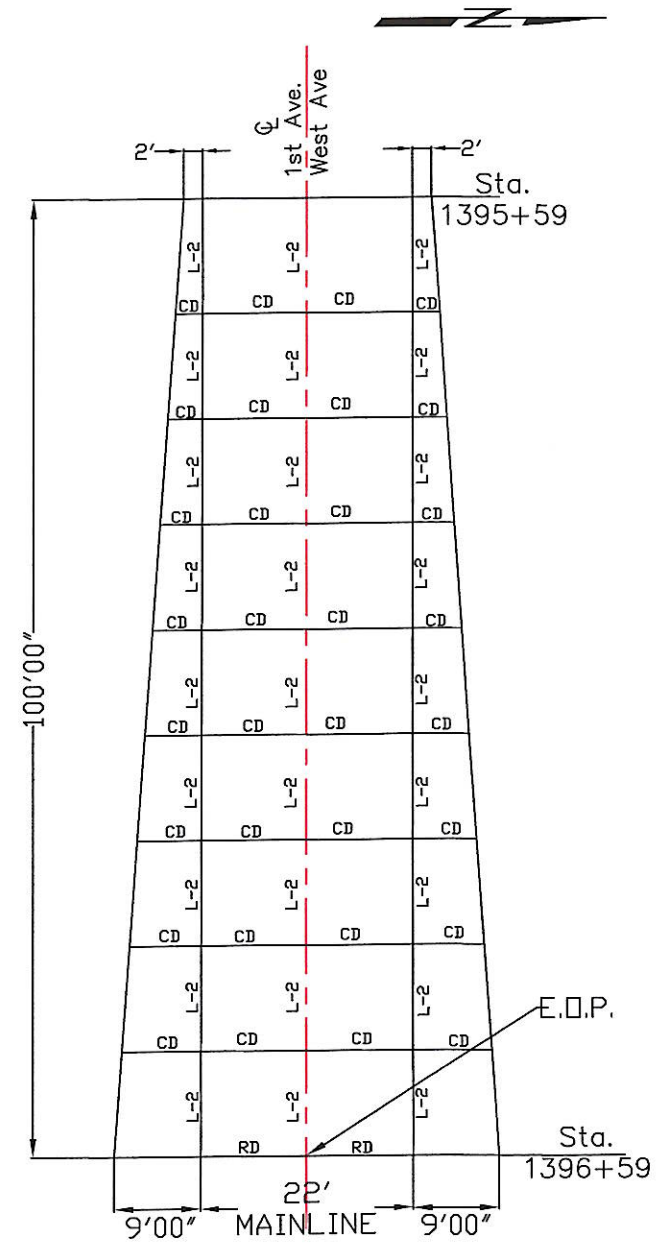
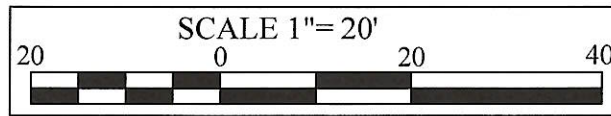

E.O.P. DETAILS

Estimated Quantities for E.O.P.
Excavation, Class 10 waste; 40.10 c.y.'s
Removal of pavement; 292.00 s.y.'s
10" PCC; 266.66 s.y.'s

