

Task #60295

**FENCE PERMIT**

NO. 25-05

ZONING DISTRICT R-2

FLOOD PLAIN: YES ☒ NO ☐

Floodway

This Fence Permit is hereby issued to Logan Shaw

622 2nd Street SE (Address) Phone # 563-542-9639 (Name) in accordance with

the provisions set out in Chapter 165.09.11 (Fences) of the Code of Ordinances of the City of Dyersville, Iowa.

**FENCES:** In any residential district, no fence or continuous planting over 3' in height shall be maintained in any **front yard**, no fence or continuous planting over 4' in height shall be maintained in any **side yard**, and no fence or continuous planting over 8' in height shall be maintained in a **rear yard**. In addition, in any residential district, no fence or continuous planting shall be maintained within 30' of any **corner lot** street line intersection, which would impair the sight distance of the operator of a motor vehicle.

**SEE REVERSE SIDE FOR STANDARD FENCE DIMENSIONS**

TYPE OF FENCE (PLANTING) Chain link fence

HEIGHTS:

FRONT \_\_\_\_\_

SIDE \_\_\_\_\_

6 ft. REAR Standard Chain link fence

*on corner lots be  
near fence to  
free line.*

In addition, the following shall be the sole responsibility of the property owner:

1. Determination of lot lines.
2. Recognition of easements.
3. Location of utility lines. *Can be obtained by calling Iowa 1 Call (1-800-292-8989)*

DATE \_\_\_\_\_

CITY ADMINISTRATOR \_\_\_\_\_

# RESIDENTIAL FENCES

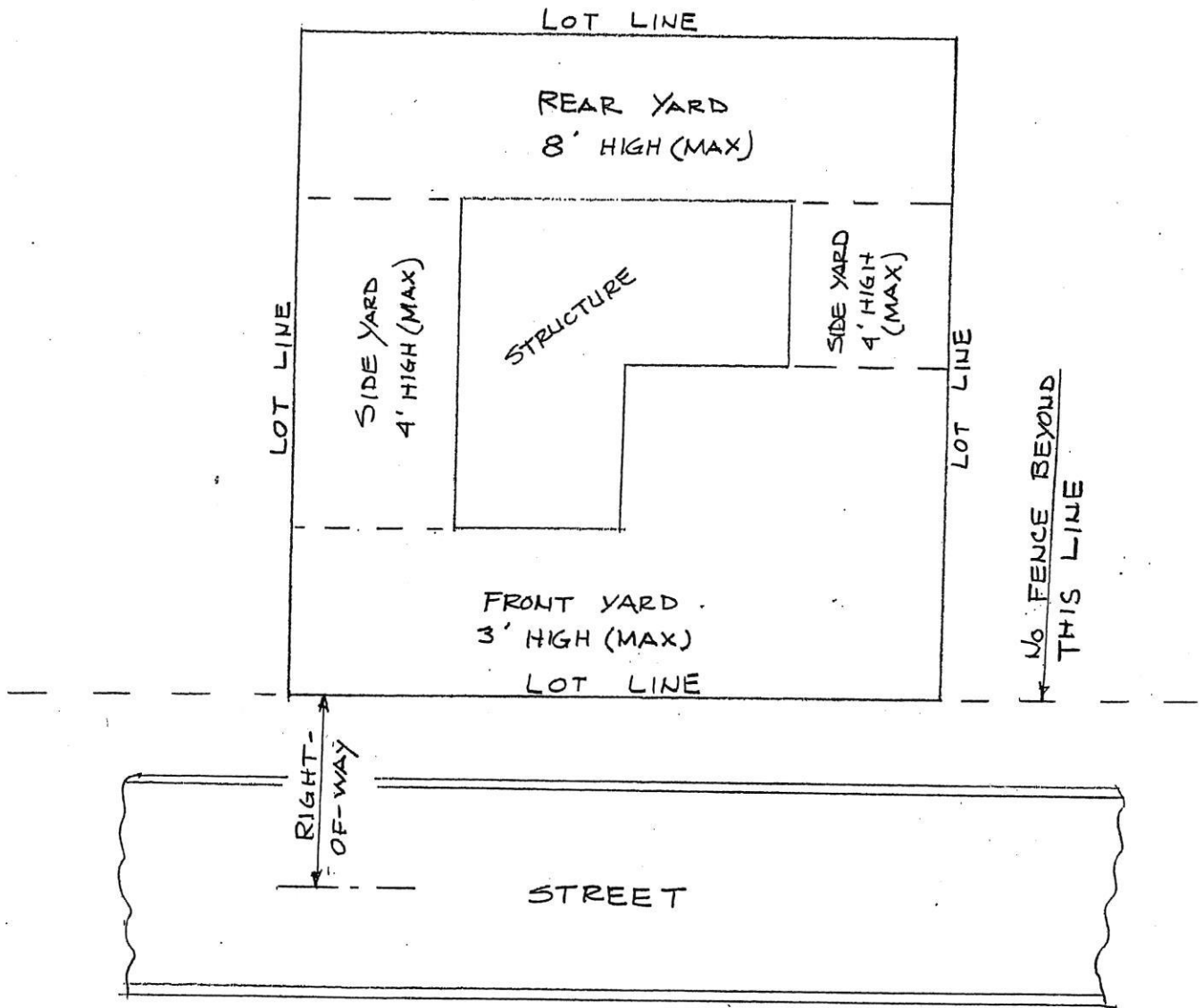



# ArcGIS Web Map



4/4/2025, 9:10:22 AM

