

EXHIBIT C

PERFORMANCE BOND

Bond No. 0842702

KNOWN ALL MEN BY THESE PRESENTS, That we, KB Home Orlando LLC, as Principal, and Harco National Insurance Company, a corporation organized and doing business under and by virtue of the laws of the State of Illinois and duly licensed to conduct surety business in the State of Florida, as Surety, are held and firmly bound unto the Town of Dundee, a municipal corporation organized and existing under the laws of the State of Florida, as Obligee, in the sum of Two Million Four Hundred Forty Four Thousand Seven Hundred Seventy Seven and 50/100 (\$ 2,444,777.50) Dollars, for which payment, well and truly to be made, we bind ourselves, our heirs, executors and successors, jointly and severally firmly by these presents.

WHEREAS, the Land Development Code of the Town of Dundee (hereinafter the "LDC") and *Town of Dundee Resolution No.* 22-49 (hereinafter the "Resolution") are, by reference, incorporated into and made part of this Performance Bond (hereinafter "Bond"); and

WHEREAS, the Principal has agreed to construct the dedicated improvements, improvements, infrastructure and other items described in the Engineer's Cost Estimate, attached hereto as **Composite Exhibit "A"** and incorporated into and made part of this Bond (hereinafter "Improvements"), in the Landings at Lake Mabel Loop platted subdivision, in accordance with the ULDC, drawings, plans, specifications, and other applicable data and information (hereinafter collectively referred to as the "Plans") filed with the Town of Dundee, which the Plans are by reference incorporated into and made part of this Bond by reference; and

WHEREAS, the LDC and/or Resolution requires the Principal to submit an instrument ensuring completion of construction of the Improvements.

NOW, THEREFORE, the conditions of this Bond are such that:

1. If the Principal shall well and truly perform the construction of the Improvements in the platted area known as Landings at Lake Mabel Loop - Phase 1 subdivision in accordance with the Plans, LDC and Resolution by October 22, 20 26 (the "Guaranty Period") and as verified by the Town of Dundee Development Services Division, upon the written approval and acceptance by the Obligee by resolution of the Town Commission of the Town of Dundee, this Bond shall be null and void. If the Improvements are not constructed by 10/22/26 or such later date the Obligee may approve, then this Bond shall be payable to the Obligee.
2. The Surety unconditionally covenants and agrees that if the Principal fails to perform all or any part of the Improvements within the time specified in Paragraph 1, above, the Surety, upon thirty (30) days written notice from the Obligee, or its authorized agent or officer, of the default, will forthwith perform and complete the Improvements and pay the cost thereof, including without limitation, engineering, legal, and contingent costs. Should the

Initials

Surety fail or refuse to perform and complete the Improvements, the Obligee, in view of the public interest, health, safety and welfare factors involved and the inducement in approving and filing the plat for the above-referenced subdivision, shall have the right to resort to any and all legal remedies against the Principal and Surety, or either, both at law and in equity including specific performance, to which the Principal and Surety unconditionally agree.

3. The Principal and Surety further jointly and severally agree that the Obligee, at its option, shall have the right to construct, or caused to be constructed the Improvements in case the Principal should fail or refuse to do so. In the event the Obligee should exercise such right, the Principal and Surety shall be jointly and severally liable hereunder to reimburse the Obligee the total cost of, including without limitation, construction, design, engineering, legal costs and fees, and any contingent costs, together with any damages, either direct or consequential, which may be sustained on account of the failure of the Principal to complete all of the obligations for construction of the Improvements.
4. Applicable Law, Jurisdiction and Venue. This Performance Bond shall be governed by, construed under, and enforced in accordance with the laws of the State of Florida. Venue for any litigation pertaining to the subject matter hereof shall be exclusively in the Tenth Judicial Circuit in and for Polk County, Florida.
5. All notices, demands, and correspondence with respect to this Bond shall be in writing and addressed to:

The Surety at:

**Harco National Insurance Company
702 Oberlin Road
Raleigh, NC 27605**

The Principal at:

**KB Home Orlando LLC
9102 Southpark Center Loop Suite 100
Orlando FL 32837**

The Obligee at:

Town of Dundee
202 E. Main Street
Dundee, FL 33838

[Signatures appear on the next page]



IN WITNESS WHEREOF, the Principal and Surety have caused this Bond to be executed by their duly authorized officers this 13th day of September, 20 24.

PRINCIPAL:

[Signature]
Witness

Stephen White
Printed Name

[Signature]
Witness

Eileen Sesto
Printed Name

KB Home Orlando LLC
Name of Corporation

By: [Signature]

James Makransky
Printed Name

Title: VP of Finance
(SEAL)

SURETY:

[Signature]
Witness

My Hua
Printed Name

[Signature]
Witness

Claire Trinidad
Printed Name

Harco National Insurance Company
Name of Corporation

By: [Signature]

Brenda Wong
Printed Name

Title: Attorney-in-Fact
(SEAL)

(attach power of attorney)

Initials [Signature]

**CALIFORNIA ALL-PURPOSE ACKNOWLEDGMENT
CIVIL CODE §1189**

A notary public or other officer completing this certificate verifies only the identity of the individual who signed the document to which this certificate is attached, and not the truthfulness, accuracy, or validity of that document.

State of California

County of Los Angeles

On 9/13/2024 before me, M. Gonzales, Notary Public, personally appeared Brenda Wong who proved to me on the basis of satisfactory evidence to be the person(s) whose name(s) is/are subscribed to the within instrument and acknowledged to me that he/she/they executed the same in his/her/their authorized capacity(ies), and that by his/her/their signature(s) on the instrument the person(s), or the entity upon behalf of which the person(s) acted, executed the instrument.

I certify under PENALTY OF PERJURY under the laws of the State of California that the foregoing paragraph is true and correct.

WITNESS my hand and official seal.

(seal)

Signature

M. Gonzales
M. Gonzales, Notary Public

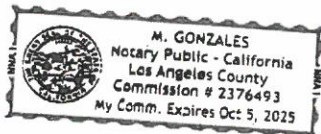

POWER OF ATTORNEY

Bond # 0842702

**HARCO NATIONAL INSURANCE COMPANY
INTERNATIONAL FIDELITY INSURANCE COMPANY**

Member companies of IAT Insurance Group, Headquartered: 4200 Six Forks Rd, Suite 1400, Raleigh, NC 27609

KNOW ALL MEN BY THESE PRESENTS: That **HARCO NATIONAL INSURANCE COMPANY**, a corporation organized and existing under the laws of the State of Illinois, and **INTERNATIONAL FIDELITY INSURANCE COMPANY**, a corporation organized and existing under the laws of the State of New Jersey, and having their principal offices located respectively in the cities of Rolling Meadows, Illinois and Newark, New Jersey, do hereby constitute and appoint

SOKHA EVANS, JEFFREY STRASSNER, BRENDA WONG, MARTHA GONZALES, TENZER V. CUNNINGHAM

Los Angeles, CA

their true and lawful attorney(s)-in-fact to execute, seal and deliver for and on its behalf as surety, any and all bonds and undertakings, contracts of indemnity and other writings obligatory in the nature thereof, which are or may be allowed, required or permitted by law, statute, rule, regulation, contract or otherwise, and the execution of such instrument(s) in pursuance of these presents, shall be as binding upon the said **HARCO NATIONAL INSURANCE COMPANY** and **INTERNATIONAL FIDELITY INSURANCE COMPANY**, as fully and amply, to all intents and purposes, as if the same had been duly executed and acknowledged by their regularly elected officers at their principal offices.

This Power of Attorney is executed, and may be revoked, pursuant to and by authority of the By-Laws of **HARCO NATIONAL INSURANCE COMPANY** and **INTERNATIONAL FIDELITY INSURANCE COMPANY** and is granted under and by authority of the following resolution adopted by the Board of Directors of **INTERNATIONAL FIDELITY INSURANCE COMPANY** at a meeting duly held on the 13th day of December, 2018 and by the Board of Directors of **HARCO NATIONAL INSURANCE COMPANY** at a meeting held on the 13th day of December, 2018.

"RESOLVED, that (1) the Chief Executive Officer, President, Executive Vice President, Senior Vice President, Vice President, or Secretary of the Corporation shall have the power to appoint, and to revoke the appointments of, Attorneys-in-Fact or agents with power and authority as defined or limited in their respective powers of attorney, and to execute on behalf of the Corporation and affix the Corporation's seal thereto, bonds, undertakings, recognizances, contracts of indemnity and other written obligations in the nature thereof or related thereto; and (2) any such Officers of the Corporation may appoint and revoke the appointments of joint-control custodians, agents for acceptance of process, and Attorneys-in-fact with authority to execute waivers and consents on behalf of the Corporation; and (3) the signature of any such Officer of the Corporation and the Corporation's seal may be affixed by facsimile to any power of attorney or certification given for the execution of any bond, undertaking, recognizance, contract of indemnity or other written obligation in the nature thereof or related thereto, such signature and seals when so used whether heretofore or hereafter, being hereby adopted by the Corporation as the original signature of such officer and the original seal of the Corporation, to be valid and binding upon the Corporation with the same force and effect as though manually affixed."

IN WITNESS WHEREOF, **HARCO NATIONAL INSURANCE COMPANY** and **INTERNATIONAL FIDELITY INSURANCE COMPANY** have each executed and attested these presents on this 31st day of December, 2023



STATE OF NEW JERSEY
County of Essex

STATE OF ILLINOIS
County of Cook



Michael F. Zurcher
Executive Vice President, Harco National Insurance Company
and International Fidelity Insurance Company

On this 31st day of December, 2023, before me came the individual who executed the preceding instrument, to me personally known, and, being by me duly sworn, said he is the therein described and authorized officer of **HARCO NATIONAL INSURANCE COMPANY** and **INTERNATIONAL FIDELITY INSURANCE COMPANY**; that the seals affixed to said instrument are the Corporate Seals of said Companies; that the said Corporate Seals and his signature were duly affixed by order of the Boards of Directors of said Companies.



IN TESTIMONY WHEREOF, I have hereunto set my hand affixed my Official Seal, at the City of Newark, New Jersey the day and year first above written.

Cathy Cruz a Notary Public of New Jersey
My Commission Expires April 16, 2024

CERTIFICATION

I, the undersigned officer of **HARCO NATIONAL INSURANCE COMPANY** and **INTERNATIONAL FIDELITY INSURANCE COMPANY** do hereby certify that I have compared the foregoing copy of the Power of Attorney and affidavit, and the copy of the Sections of the By-Laws of said Companies as set forth in said Power of Attorney, with the originals on file in the home office of said companies, and that the same are correct transcripts thereof, and of the whole of the said originals, and that the said Power of Attorney has not been revoked and is now in full force and effect.

IN TESTIMONY WHEREOF, I have hereunto set my hand on this day, 9/13/2024

A00846

Irene Martins, Assistant Secretary

Traditions Engineering
35 Don Polston Rd, Suite 115,
Eagle Lake, FL 33839
(863) 397 - 1626
cbrooker@traditions-eng.com

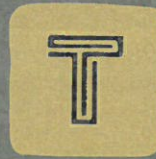

TRADITIONS ENGINEERING

Lorraine Peterson
Town of Dundee – Development Services
124 Dundee Road
Dundee, Florida 33838

August 19th, 2024

Re: Seasons at Bella Vista
Engineer's Certification of Cost for Total Construction (Maintenance Bond)

Dear Ms. Peterson:

In my professional opinion, as a registered engineer in the State of Florida, I certify that the following information reflects the total cost of construction. These costs were based on John M. Hall pay application number 23028-03 Rev 2 and Garrison Land Management Inc. bid dated 5/6/2024. The remaining costs are as follows:

I.	Paving On Site	\$ 841,000.50
II.	Sanitary Sewer	\$ 581,962.50
III.	Storm Sewer	\$ 703,915.00
IV.	Water System	\$ 633,455.00
V.	Concrete Work	\$ 556,450.00
	TOTAL	\$ 3,316,783.00

A surety amount of ~~\$331,678.30~~ (\$3,316,783.00 x 10%) is proposed. Your review and approval of the proposed surety amount is requested.

Charles R. Brooker III, P.E.
P.E. Number 88615
Hunter Engineering, INC.

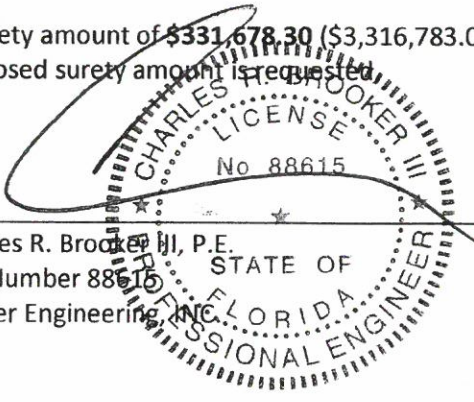

08/19/2024

Sincerely,

Charles "Chad" Brooker, P.E.
CEO, Traditions Engineering, LLC
cbrooker@traditions-eng.com
(863) 397-1627

 ENGINEERING & SURVEYING, LLC	<input checked="" type="checkbox"/> Reviewed without objection <input type="checkbox"/> Rejected <input type="checkbox"/> Resubmit
Review is only for general conformance of the submittal with information given and the design concept expressed in the Contract Documents, Plans, and Specifications. Comments made during this review do not provide relief from compliance with the requirements of the same. The Contractor is responsible for confirming and correlating all quantities, dimensions, site conditions, construction means, methods, sequences, procedures, and the coordination of all trades.	
Caleb Wingo	Aug 22 2024
Name	Date
810 East Main Street, Bartow, FL 33830 • 863-537-7901	

APPLICATION AND CERTIFICATE FOR PAYMENT

TO OWNER:

Richmond American Homes
2822 Commerce Park Dr Suite 100
Orlando FL 32719

PROJECT: 23028

Bella Vista - Dundee, FL

PO 751156

FROM CONTRACTOR:

Jon M. Hall Company (# 1190134)
1400 Martin Luther King Jr Blvd
Sanford FL 32771
Ph: 407-215-0410

VIA ENGINEER:

Traditions Engineering
6039 Cypress Gardens Blvd, Suite 290
Winter Haven FL 33894
Chad Booker, P.E. 883-397-1626

APPLICATION NO.: 23028-03 Rev 2

APPLICATION DATE: 04/25/24

PERIOD TO: 04/30/24

Richmond PO #

CONTRACTOR'S APPLICATION FOR PAYMENT

Application is made for payment, as shown below, in connection with the contract.
Continuation sheets, as applicable, are attached.

- 1. ORIGINAL CONTRACT SUM \$ 3,924,154.71
- 2. Net change by Change Orders \$ 121,923.05
- 3. Contract Sum To Date (line 1+2) \$ 4,046,077.76
- 4. TOTAL COMPLETED AND STORED TO DATE \$ 2,087,830.98
- 5. RETAINAGE:
 - a. 10% of completed work \$ 208,783.10
- 6. TOTAL EARNED LESS RETAINAGE \$ 1,879,047.88
- 7. LESS PREVIOUS PAYMENTS \$ 1,323,528.67
- 8. CURRENT PAYMENT DUE \$ 555,519.21
- 9. BALANCE TO FINISH, INCL. RETAINAGE \$ 2,167,029.88

CHANGE ORDER SUMMARY	ADDITION	DEDUCTIONS
Total changes approved in previous months by owner	88,854.64	
Total approved this month		
TOTALS	88,854.64	
NET CHANGES by Change Order	\$88,854.64	

The undersigned Contractor certifies that to the best of the Contractors knowledge, information and belief the Work covered by this Application for payment has been completed in accordance with the contract documents and that all amounts have been paid by the Contractor for work for which previous Certificates for Payment were issued and payments received from the Owner, and that current payment shown herein is now due.

CONTRACTOR: Jon M. Hall Company

By: *[Signature]* Date: 4/25/2024

Noy Rivers, President

State of : Florida
County of : Seminole
Subscribed and sworn to before me
this 25th day of April, 2024.

Notary Public : *[Signature]*
My Commission expires :



ENGINEER'S CERTIFICATE FOR PAYMENT

In accordance with the Contract Documents, based on on-site observation and the data comprising this application, the Engineer certifies to the Owner that to the best of the Engineer's knowledge, information and belief, the work has progressed as indicated, the quality of the work is in accordance with the Contract Documents, and the Contractor is entitled to payment of the Amount Certified.

AMOUNT CERTIFIED _____ Date: _____

(Asterisk explanation if amount certified differs from the amount applied for. Initial all figures on this application and on the Continuation Sheet that are changed to conform to the amount certified.)

Engineer : _____ Date: _____

Continuation Sheet

APPLICATION AND CERTIFICATE FOR PAYMENT,
containing Contractor's signed Certification, is attached.

23028
Bella Vista - Dundee, FL

Application No: 23028-03 Rev 2
Application Date: 04/25/24
Period To: 04/30/24

A	B	C	D	E	F	G	H	I	J	K	L	M	N	
RICHMOND COST CODE	BID ITEM NO.	DESCRIPTION OF WORK	QTY	UM	Unit Price	SCHEDULED VALUE (C*E)	QTY INSTALLED PREVIOUS PERIOD	QTY INSTALLED THIS PERIOD	WORK COMPLETED PREVIOUS APPLICATION (E*G)	AMOUNT COMPLETED THIS PERIOD (E*H)	COMPLETED AND STORED TO DATE (I+J)	% (K/L)	REMAINING FINISH (F-K)	RETAINAGE (K*10)
01 MOBILIZATION & GENERAL CONDITIONS														
33306	10010	Jobsite Facilities	1.00	LS	15,100.00	\$ 15,100.00	0.20	0.40	\$ 3,020.00	\$ 6,040.00	\$ 9,060.00	60%	\$ 6,040.00	\$ 906.00
33306	10020	Supervision	1.00	LS	59,200.00	\$ 59,200.00	0.30	0.30	\$ 17,760.00	\$ 17,760.00	\$ 35,520.00	60%	\$ 23,880.00	\$ 3,552.00
33306	10030	Geotechnical Testing	1.00	LS	42,700.00	\$ 42,700.00	0.20	0.40	\$ 8,540.00	\$ 17,080.00	\$ 25,620.00	60%	\$ 17,080.00	\$ 2,562.00
33306	10040	Survey & As-Builts	1.00	LS	56,800.00	\$ 56,800.00	0.15	0.35	\$ 8,520.00	\$ 19,880.00	\$ 28,400.00	50%	\$ 28,400.00	\$ 2,840.00
33306	10050	Mobilization & Material Offload	1.00	LS	61,700.00	\$ 61,700.00	0.60	0.40	\$ 37,020.00	\$ 24,680.00	\$ 61,700.00	100%	\$ -	\$ 6,170.00
33306	10060	Construction Entrance	1.00	EA	13,600.00	\$ 13,600.00	0.70	0.30	\$ 9,520.00	\$ 4,080.00	\$ 13,600.00	100%	\$ -	\$ 1,360.00
33306	10070	Silt Fence (Single Row)		LF	1.50	\$ 10,252.50	6,835.00		\$ 10,252.50	\$ -	\$ 10,252.50	100%	\$ -	\$ 1,025.25
33306	10080	SWPPP Permit & Monitoring	1.00	LS	4,640.00	\$ 4,640.00	0.20	0.20	\$ 928.00	\$ 928.00	\$ 1,856.00	40%	\$ 2,784.00	\$ 185.60
MOB & GENERAL CONDITIONS Subtotal						263,992.50			95,560.50	90,448.00	186,008.50		77,984.00	18,600.85
02 CLEAR, GRUB & STRIP														
33303	10090	Sawcut Entrance Crossing	125.00	LF	2.00	\$ 250.00			\$ -	\$ -	\$ -	0%	\$ 250.00	\$ -
Heavy Disking Site (In Lieu Of Stripping) (Based Upon Site Visit The Site Appears To Be 100% Cleared; However, If Additional Clearing Is Required It Will Be Billed As A Change Order)			32.20	ACRE	800.00	\$ 25,760.00	32.20		\$ 25,760.00	\$ -	\$ 25,760.00	100%	\$ -	\$ 2,576.00
33303	10110	Demo Exist Asphalt Pavement	188.00	SY	4.30	\$ 808.40			\$ -	\$ -	\$ -	0%	\$ 808.40	\$ -
33303	10120	Remove & Cap Well (By Others)	2.00	EA	0.00	\$ -			\$ -	\$ -	\$ -		\$ -	\$ -
02 Clear, Grub & Strip Subtotal						26,818.40			25,760.00	0.00	25,760.00		1,058.40	2,576.00
03 EARTHWORK														
33303	10130	Site Excavation (Cut To Fill) (Raise Site To Offset Excess Material)	47,968.00	BCY	2.40	\$ 115,123.20	47,968.00		\$ 115,123.20	0.00	\$ 115,123.20	100%	\$ 0.00	\$ 11,512.32
Pond Excavation (Cut To Fill) (Pond - 100 11', Pond 200 - 7', Pond 3 - 7') (Raise Site To Offset Excess Material)			11,126.00	BCY	2.40	\$ 26,702.40	11,126.00		\$ 26,702.40	\$ -	\$ 26,702.40	100%	\$ -	\$ 2,670.24
33303	10140	Rough Grade Pavement Box	18,297.00	SY	0.76	\$ 13,905.72	13,800.00	2,000.00	\$ 10,488.00	\$ 1,520.00	\$ 12,008.00	86%	\$ 1,897.72	\$ 1,200.80
03 Earthwork Subtotal						155,731.32			152,313.60	1,520.00	153,833.60		1,897.72	15,383.36
04 FINISH GRADING														
33830	10160	Fine Grade Ponds	13,618.00	SY	0.55	\$ 7,489.90	13,618.00		\$ -	\$ 7,489.90	\$ 7,489.90	100%	\$ -	\$ 748.99
33830	10170	Fine Grade ROW	11,174.00	SY	0.82	\$ 9,162.68			\$ -	\$ -	\$ -	0%	\$ 9,162.68	\$ -
33830	10180	Fine Grade Perimeter Slopes & Swales	3,357.00	SY	0.74	\$ 2,484.18			\$ -	\$ -	\$ -	0%	\$ 2,484.18	\$ -
33830	10190	Fine Grade Lots	109.00	EA	221.00	\$ 24,089.00			\$ -	\$ -	\$ -	0%	\$ 24,089.00	\$ -
33830	10200	Backfill Curbs	14,245.00	LF	0.48	\$ 6,837.60			\$ -	\$ -	\$ -	0%	\$ 6,837.60	\$ -
04 Finish Grading Subtotal						50,063.36			0.00	7,489.90	7,489.90		42,573.46	748.99
05 PAYING ON SITE														
33830	10210	Traffic Control (Entrance/Turn Lanes)	1.00	LS	13,700.00	\$ 13,700.00	0.80		\$ -	\$ 10,960.00	\$ 10,960.00	80%	\$ 2,740.00	\$ 1,096.00
33830	10220	Build Curb Pads	14,245.00	LF	1.90	\$ 27,065.50			\$ -	\$ -	\$ -	0%	\$ 27,065.50	\$ -
33830	10230	12" Stabilized Subgrade (LBR 40)	18,297.00	SY	7.00	\$ 128,079.00			\$ -	\$ -	\$ -	0%	\$ 128,079.00	\$ -
33830	10240	6" Limerock Base	10,455.00	SY	17.50	\$ 182,962.50			\$ -	\$ -	\$ -	0%	\$ 182,962.50	\$ -
33830	10250	8" Limerock Base	7,842.00	SY	22.00	\$ 172,524.00			\$ -	\$ -	\$ -	0%	\$ 172,524.00	\$ -

Continuation Sheet
APPLICATION AND CERTIFICATE FOR PAYMENT,
 containing Contractor's signed Certification, is attached.

23028
 Bella Vista - Dundee, FL

Application No: 23028-03 Rev 2
 Application Date: 04/25/24
 Period To: 04/30/24

A	B	C	D	E	F	G	H	I	J	K	L	M	N	
RICHMOND COST CODE	BID ITEM NO.	DESCRIPTION OF WORK	QTY	UM	Unit Price	SCHEDULED VALUE (C-E)	QTY INSTALLED PREVIOUS PERIOD	QTY INSTALLED THIS PERIOD	AMOUNT PREVIOUS APPLICATION (E-G)	WORK COMPLETED AMOUNT THIS PERIOD (E+H)	COMPLETED AND STORED TO DATE (H+K)	% (K/F)	REMAINING TO FINISH (F-K)	RETAINAGE (K*10)
33830	10260	1.25" SP-9.5 Asphalt (1 Lft)	10,455.00	SY	12.50	\$ 130,687.50						0%	\$ 130,687.50	\$ -
33830	10270	2" SP-9.5 Asphalt (2 Lifts)	7,842.00	SY	21.00	\$ 164,682.00						0%	\$ 164,682.00	\$ -
33830	10280	Striping & Signs	1.00	LS	21,300.00	\$ 21,300.00						0%	\$ 21,300.00	\$ -
05 PAVING ON SITE Subtotal						841,000.50			0.00	10,960.00			10,960.00	1,096.00
07 SANITARY SEWER														
33403	10290	Connect To Existing Manhole (6.5' Deep)	1.00	EA	2,670.00	\$ 2,670.00		1.00	\$ -	\$ 2,670.00	\$ 2,670.00	100%	\$ -	\$ 267.00
33403	10300	8" PVC Gravity Sewer Main (0'-6")	1,535.00	LF	34.00	\$ 52,190.00	832.00	400.00	\$ 28,288.00	\$ 13,600.00	\$ 41,888.00	80%	\$ 10,302.00	\$ 4,188.80
33403	10310	8" PVC Gravity Sewer Main (6'-8")	2,790.00	LF	35.00	\$ 97,650.00	1,475.00	750.00	\$ 51,625.00	\$ 26,250.00	\$ 77,875.00	80%	\$ 19,775.00	\$ 7,787.50
33403	10320	8" PVC Gravity Sewer Main (8'-10")	590.00	LF	36.00	\$ 21,240.00	302.00	288.00	\$ 10,672.00	\$ 10,368.00	\$ 21,240.00	100%	\$ -	\$ 2,124.00
33403	10330	8" PVC Gravity Sewer Main (10'-12")	895.00	LF	37.50	\$ 33,562.50	440.00	455.00	\$ 16,500.00	\$ 17,062.50	\$ 33,562.50	100%	\$ -	\$ 3,356.25
33403	10340	8" PVC Gravity Sewer Main (12'-14")	230.00	LF	56.00	\$ 12,880.00	85.00	145.00	\$ 4,760.00	\$ 8,120.00	\$ 12,880.00	100%	\$ -	\$ 1,288.00
33403	10350	4" Diameter Manhole (0'-6")	6.00	EA	6,680.00	\$ 40,080.00	4.98		\$ 33,266.40	\$ -	\$ 33,266.40	83%	\$ 6,813.60	\$ 3,326.64
33403	10360	4" Diameter Manhole (6'-8")	6.00	EA	8,190.00	\$ 49,140.00	4.75		\$ 38,902.50	\$ -	\$ 38,902.50	79%	\$ 10,237.50	\$ 3,890.25
33403	10370	4" Diameter Manhole (8'-10")	4.00	EA	9,870.00	\$ 39,480.00	3.06	0.94	\$ 30,202.20	\$ 9,277.80	\$ 39,480.00	100%	\$ -	\$ 3,948.00
33403	10380	4" Diameter Manhole (10'-12")	1.00	EA	10,900.00	\$ 10,900.00	0.75	0.25	\$ 8,175.00	\$ 2,725.00	\$ 10,900.00	100%	\$ -	\$ 1,090.00
33403	10390	4" Diameter Manhole (12'-14")	3.00	EA	16,300.00	\$ 48,900.00	2.35	0.65	\$ 38,305.00	\$ 10,595.00	\$ 48,900.00	100%	\$ -	\$ 4,890.00
33403	10400	4" Single Service	20.00	EA	1,420.00	\$ 28,400.00	11.00	5.00	\$ 15,620.00	\$ 7,100.00	\$ 22,720.00	80%	\$ 5,680.00	\$ 2,272.00
33403	10410	4" Double Service	45.00	EA	1,810.00	\$ 81,450.00	28.00	8.00	\$ 50,680.00	\$ 14,480.00	\$ 65,160.00	80%	\$ 16,290.00	\$ 6,516.00
33403	10420	Gravity Main Testing	6,040.00	LF	10.50	\$ 63,420.00			\$ -	\$ -	\$ -	0%	\$ 63,420.00	\$ -
07 SANITARY SEWER Subtotal						581,962.50			327,196.10	122,248.30	449,444.40		132,518.10	44,944.44
08 STORM SEWER														
33503	10430	15" PVC (For Pond Outfall)	75.00	LF	77.50	\$ 5,812.50	60.00	8.00	\$ 4,650.00	\$ 620.00	\$ 5,270.00	91%	\$ 542.50	\$ 527.00
33503	10440	18" HP	2,805.00	LF	49.50	\$ 138,847.50	1,823.25	800.00	\$ 90,250.88	\$ 39,600.00	\$ 129,850.88	94%	\$ 8,996.63	\$ 12,985.09
33503	10450	24" HP	1,270.00	LF	73.50	\$ 93,345.00	917.00	225.00	\$ 67,999.50	\$ 16,537.50	\$ 83,937.00	90%	\$ 9,408.00	\$ 8,393.70
33503	10460	30" HP	470.00	LF	109.00	\$ 51,230.00	359.00	111.00	\$ 39,131.00	\$ 12,099.00	\$ 51,230.00	100%	\$ -	\$ 5,123.00
33503	10470	36" HP	210.00	LF	120.00	\$ 25,200.00	161.00	49.00	\$ 19,320.00	\$ 5,880.00	\$ 25,200.00	100%	\$ -	\$ 2,520.00
33503	10480	C Inlet	1.00	EA	3,520.00	\$ 3,520.00	0.66	0.24	\$ 2,323.20	\$ 844.80	\$ 3,168.00	90%	\$ 352.00	\$ 316.80
33503	10490	C Control Structure	1.00	EA	5,775.00	\$ 5,775.00	0.77	0.03	\$ 4,446.75	\$ 173.25	\$ 4,620.00	80%	\$ 1,155.00	\$ 462.00
33503	10500	P-5 Curb Inlet	21.00	EA	6,910.00	\$ 145,110.00	13.65	5.50	\$ 94,321.50	\$ 38,005.00	\$ 132,326.50	91%	\$ 12,783.50	\$ 13,232.65
33503	10510	J-5 Curb Inlet	7.00	EA	11,935.00	\$ 83,545.00	5.45	1.00	\$ 65,045.75	\$ 11,935.00	\$ 76,980.75	92%	\$ 6,564.25	\$ 7,698.08
33503	10520	P-6 Curb Inlet	7.00	EA	7,765.00	\$ 54,355.00	4.80	1.00	\$ 37,272.00	\$ 7,765.00	\$ 45,037.00	83%	\$ 9,318.00	\$ 4,503.70
33503	10530	J-6 Curb Inlet	2.00	EA	10,575.00	\$ 21,150.00	1.50	0.20	\$ 15,862.50	\$ 2,115.00	\$ 17,977.50	85%	\$ 3,172.50	\$ 1,797.75
33503	10540	P Manhole	1.00	EA	4,920.00	\$ 4,920.00	0.71	0.20	\$ 3,493.20	\$ 984.00	\$ 4,477.20	91%	\$ 442.80	\$ 447.72
33503	10550	18" MES	1.00	EA	2,100.00	\$ 2,100.00	0.60	0.60	\$ -	\$ 1,260.00	\$ 1,260.00	60%	\$ 840.00	\$ 126.00
33503	10560	Riprap (Broken Concrete)	30.00	SY	76.00	\$ 2,280.00			\$ -	\$ -	\$ -	0%	\$ 2,280.00	\$ -
33503	10570	24" MES	1.00	EA	3,270.00	\$ 3,270.00	1.00	1.00	\$ -	\$ 3,270.00	\$ 3,270.00	100%	\$ -	\$ 327.00

Continuation Sheet

APPLICATION AND CERTIFICATE FOR PAYMENT,
containing Contractor's signed Certification, is attached.

23028
Bella Vista - Dundee, FL

Application No: 23028-03 Rev 2
Application Date: 04/25/24
Period To: 04/30/24

A	B	C	D	E	F	G	H	I	J	K	L	M	N	
RICHMOND COST CODE	BID ITEM NO.	DESCRIPTION OF WORK	QTY	UM	Unit Price	SCHEDULED VALUE (C+E)	QTY INSTALLED PREVIOUS PERIOD	QTY INSTALLED THIS PERIOD	WORK COMPLETED AMOUNT PREVIOUS APPLICATION (E*G)	AMOUNT THIS PERIOD (E*H)	COMPLETED AND STORED TO DATE (I+J)	% TO DATE (K/I)	REMAINING TO FINISH (E-K)	RETAINAGE (K*10)
08 STORM SEWER Subtotal														
						703,915.00			443,516.28	160,528.55	604,044.83		99,870.18	60,404.48
09 WATER SYSTEM														
33603	10620	Temporary Jumper	2.00	EA	1,880.00	\$ 3,760.00	0.79	0.90	\$ 1,485.20	\$ 1,892.00	\$ 3,177.20	85%	\$ 582.80	\$ 317.72
33603	10630	10" X 10" Wet Tap	2.00	EA	9,640.00	\$ 19,280.00	1.49	0.11	\$ 14,363.60	\$ 1,060.40	\$ 15,424.00	80%	\$ 3,856.00	\$ 1,542.40
33603	10640	8" PVC Watermain	5,480.00	LF	41.50	\$ 227,420.00	3,960.00	950.00	\$ 164,340.00	\$ 39,425.00	\$ 203,765.00	90%	\$ 23,655.00	\$ 20,376.50
33603	10650	10" PVC Watermain	320.00	LF	61.00	\$ 19,520.00	235.00	54.00	\$ 14,335.00	\$ 3,294.00	\$ 17,629.00	90%	\$ 1,891.00	\$ 1,762.90
33603	10660	Fire Hydrant Assembly	8.00	EA	7,980.00	\$ 63,840.00	6.55	0.65	\$ 52,269.00	\$ 5,187.00	\$ 57,456.00	90%	\$ 6,384.00	\$ 5,745.60
33603	10670	Fittings & Restraints	1.00	LS	58,375.00	\$ 58,375.00	0.90		\$ 52,537.50	\$ -	\$ 52,537.50	90%	\$ 5,837.50	\$ 5,253.75
33603	10680	8" Gate Valve	6.00	EA	3,160.00	\$ 18,960.00	4.70	0.70	\$ 14,852.00	\$ 2,212.00	\$ 17,064.00	90%	\$ 1,896.00	\$ 1,706.40
33603	10690	10" Gate Valve	4.00	EA	4,860.00	\$ 19,440.00	3.00	0.60	\$ 14,580.00	\$ 2,916.00	\$ 17,496.00	90%	\$ 1,944.00	\$ 1,749.60
33603	10700	Air Release Valve (Poly Enclosure)	2.00	EA	4,760.00	\$ 9,520.00	1.80		\$ -	\$ 8,568.00	\$ 8,568.00	90%	\$ 952.00	\$ 856.80
33603	10710	1" Single Service	16.00	EA	1,050.00	\$ 16,800.00	13.00		\$ -	\$ 13,650.00	\$ 13,650.00	81%	\$ 3,150.00	\$ 1,365.00
33603	10720	2" Double Service	47.00	EA	2,020.00	\$ 94,940.00	42.00		\$ -	\$ 84,840.00	\$ 84,840.00	89%	\$ 10,100.00	\$ 8,484.00
33603	10730	1" Irrigation Water Service	10.00	EA	2,390.00	\$ 23,900.00	8.00		\$ -	\$ 19,120.00	\$ 19,120.00	80%	\$ 4,780.00	\$ 1,912.00
33603	10740	Test & Chlorinate	1.00	LS	18,500.00	\$ 18,500.00			\$ -	\$ -	\$ -	0%	\$ 18,500.00	\$ -
33603	10750	10" HDPE Directional Bore	100.00	LF	392.00	\$ 39,200.00	22.00	23.00	\$ 8,624.00	\$ 9,016.00	\$ 17,640.00	45%	\$ 21,560.00	\$ 1,764.00
						633,455.00			337,386.30	190,980.40	528,366.70		105,088.30	52,836.67
11 CONCRETE WORK														
33830	10760	Miami Curb	14,245.00	LF	24.00	\$ 341,880.00			\$ -	\$ -	\$ -	0%	\$ 341,880.00	\$ -
33830	10770	5' Sidewalk (4" Thick)	5,370.00	LF	33.50	\$ 179,895.00			\$ -	\$ -	\$ -	0%	\$ 179,895.00	\$ -
33830	10780	Handicap Ramp w/ Detectable Warning	19.00	EA	1,825.00	\$ 34,675.00			\$ -	\$ -	\$ -	0%	\$ 34,675.00	\$ -
						556,450.00			0.00	0.00	0.00		556,450.00	-
12 GRASSING														
33303	10790	Seed & Mulch Lots	108,614.00	SY	0.27	\$ 29,325.78			\$ -	\$ -	\$ -	0%	\$ 29,325.78	\$ -
33303	10800	Seed & Mulch Pond Bottom	1,590.00	SY	0.27	\$ 429.30			\$ -	\$ -	\$ -	0%	\$ 429.30	\$ -
33303	10810	Sod ROW	6,940.00	SY	3.05	\$ 21,167.00			\$ -	\$ -	\$ -	0%	\$ 21,167.00	\$ -
33303	10820	Sod Perimeter Slopes & Swales	3,355.00	SY	3.05	\$ 10,232.75			\$ -	\$ -	\$ -	0%	\$ 10,232.75	\$ -
33303	10830	Sod Pond Slopes	12,028.00	SY	3.05	\$ 36,685.40			\$ -	\$ -	\$ -	0%	\$ 36,685.40	\$ -
33303	10840	Sod Two Strips Behind Curbs & Sidewalks	4,238.00	SY	3.05	\$ 12,925.90			\$ -	\$ -	\$ -	0%	\$ 12,925.90	\$ -
						110,766.13			0.00	0.00	0.00		110,766.13	-
ORIGINAL CONTRACT TOTAL						3,924,154.71			1,381,732.78	584,175.15	1,965,907.93	50%	1,958,246.79	196,590.79

CHANGE ORDERS

Continuation Sheet

APPLICATION AND CERTIFICATE FOR PAYMENT.
 containing Contractor's signed Certification, is attached.

23028
 Bella Vista - Dundee, FL
 Application No: 23028-03 Rev 2
 Application Date: 04/25/24
 Period To: 04/30/24

A	B	C	D	E	F	G	H	I	J	K	L	M	N	
RICHMOND COST CODE	BID ITEM NO.	DESCRIPTION OF WORK	QTY	UM	Unit Price	SCHEDULED VALUE (C*E)	QTY INSTALLED PREVIOUS PERIOD	QTY INSTALLED THIS PERIOD	WORK COMPLETED PREVIOUS APPLICATION (E*G)	AMOUNT THIS PERIOD (E*H)	COMPLETED AND STORED TO DATE (H+J)	% (K/L)	REMAINING TO FINISH (F-K)	RETAINAGE (K*10)
01 Clear & Burn On-Site / Engineering Fee														
33409	CO-01-01	OCIP Fee	1	LS	\$827.50	827.50	1.00		827.50	0.00	827.50	100%	0.00	82.75
33306	CO-01-02	Engineering Fee	1	LS	\$20,000.00	20,000.00	1.00		20,000.00	0.00	20,000.00	100%	0.00	2,000.00
33302	CO-01-03	Clear, Grub, and Curtain Burn Onsite	7	ACRE	\$8,511.36	59,579.52	7.00		59,579.52	0.00	59,579.52	100%	0.00	5,957.95
		CO 1 Subtotal				80,407.02			80,407.02	-	80,407.02		-	8,040.70
02 Temporary Clay Road														
33409	CO-02-01	OCIP Fee	1	LS	\$104.30	104.30	1.00		104.30	0.00	104.30	100%	0.00	10.43
33830	CO-02-02	Removal of Existing power Poles / Well abandon	1	LS	\$8,343.32	8,343.32	1.00		8,343.32	0.00	8,343.32	100%	0.00	834.33
		CO 2 Subtotal				8,447.62			8,447.62	-	8,447.62		-	844.76
03 Saturday (Overtime) Work														
33409	CO-04-01	OCIP Fee	1	LS	\$408.25	408.25		1.00	0.00	408.25	408.25	100%	0.00	40.83
33830	CO-04-02	Saturday Work	1	LS	\$32,660.16	32,660.16		1.00	0.00	32,660.16	32,660.16	100%	0.00	3,266.02
		CO 2 Subtotal				33,068.41			-	33,068.41	33,068.41		-	3,306.84
		CHANGE ORDER Totals				121,923.05			88,854.84	33,068.41	121,923.05		-	12,192.31
		GRAND TOTALS				4,046,077.76			1,470,587.42	617,243.56	2,087,830.98	52%	1,958,246.79	208,783.10