

Traditions Engineering  
35 Don Polston Rd, Suite 115,  
Eagle Lake, FL 33839  
(863) 397 - 1626  
cbrooker@traditions-eng.com

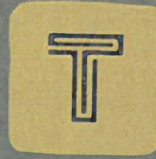

TRADITIONS ENGINEERING

Lorraine Peterson  
Town of Dundee – Development Services  
124 Dundee Road  
Dundee, Florida 33838

EXHIBIT D

August 19th, 2024

Re: Seasons at Bella Vista  
Engineer's Certification of Cost for Total Construction (Maintenance Bond)

Dear Ms. Peterson:

In my professional opinion, as a registered engineer in the State of Florida, I certify that the following information reflects the total cost of construction. These costs were based on John M. Hall pay application number 23028-03 Rev 2 and Garrison Land Management Inc. bid dated 5/6/2024. The remaining costs are as follows:

I.	Paving On Site	\$ 841,000.50
II.	Sanitary Sewer	\$ 581,962.50
III.	Storm Sewer	\$ 703,915.00
IV.	Water System	\$ 633,455.00
V.	Concrete Work	\$ 556,450.00
	<b>TOTAL</b>	<b>\$ 3,316,783.00</b>

A surety amount of ~~\$331,678.30~~ (\$3,316,783.00 x 10%) is proposed. Your review and approval of the proposed surety amount is requested.

Charles R. Brooker III, P.E.  
P.E. Number 88615  
Hunter Engineering, Inc.

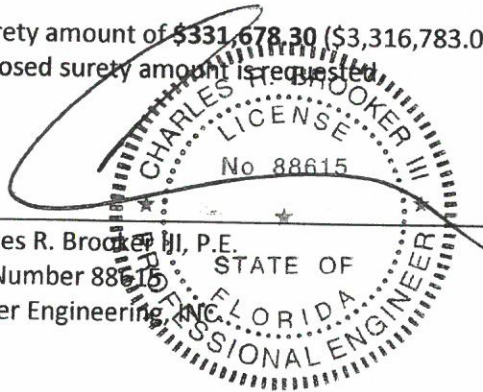

08/19/2024

Sincerely,

Charles "Chad" Brooker, P.E.  
CEO, Traditions Engineering, LLC  
[Cbrooker@traditions-eng.com](mailto:Cbrooker@traditions-eng.com)  
(863) 397-1627

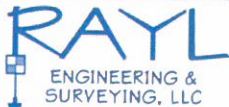
 ENGINEERING & SURVEYING, LLC	<input checked="" type="checkbox"/> Reviewed without objection <input type="checkbox"/> Rejected <input type="checkbox"/> Resubmit
Review is only for general conformance of the submittal with information given and the design concept expressed in the Contract Documents, Plans, and Specifications. Comments made during this review do not provide relief from compliance with the requirements of the same. The Contractor is responsible for confirming and correlating all quantities, dimensions, site conditions, construction means, methods, sequences, procedures, and the coordination of all trades.	
Caleb Wingo	Aug 22 2024
Name	Date
810 East Main Street, Bartow, FL 33830 • 863-537-7901	

# APPLICATION AND CERTIFICATE FOR PAYMENT

TO OWNER:

Richmond American Homes  
2822 Commerce Park Dr Suite 100  
Orlando FL 32719

PROJECT: 23028

Bella Vista - Dundee, FL

**PO 751156**

FROM CONTRACTOR:

Jon M. Hall Company (# 1190134)  
1400 Martin Luther King Jr Blvd  
Sanford FL 32771  
Ph: 407-215-0410

VIA ENGINEER:

Traditions Engineering  
6039 Cypress Gardens Blvd, Suite 290  
Winter Haven FL 33884  
Chad Booker, P.E. 863-397-1626

APPLICATION NO.: 23028-03 Rev 2

APPLICATION DATE: 04/25/24

PERIOD TO: 04/30/24

Richmond PO #

## CONTRACTOR'S APPLICATION FOR PAYMENT

Application is made for payment, as shown below, in connection with the contract.  
Continuation sheets, as applicable, are attached.

1. ORIGINAL CONTRACT SUM ..... \$ 3,924,154.71
2. Net change by Change Orders ..... \$ 121,923.05
3. Contract Sum To Date (line 1+2) ..... \$ 4,046,077.76
4. TOTAL COMPLETED AND STORED TO DATE ..... \$ 2,087,830.98
5. RETAINAGE:
  - a. 10% of completed work ..... \$ 208,783.10
6. TOTAL EARNED LESS RETAINAGE ..... \$ 1,879,047.88
7. LESS PREVIOUS PAYMENTS ..... \$ 1,323,528.67
8. CURRENT PAYMENT DUE ..... \$ 555,519.21
9. BALANCE TO FINISH, INCL. RETAINAGE ..... \$ 2,167,029.88

CHANGE ORDER SUMMARY		ADDITION	DEDUCTIONS
Total changes approved in previous months by owner		88,854.64	
Total approved this month			
<b>TOTALS</b>		<b>88,854.64</b>	
<b>NET CHANGES by Change Order</b>		<b>\$88,854.64</b>	

The undersigned Contractor certifies that to the best of the Contractor's knowledge, information and belief the Work covered by this Application for payment has been completed in accordance with the contract documents and that all amounts have been paid by the Contractor for work for which previous Certificates for Payment were issued and payments received from the Owner, and that current payment shown herein is now due.

CONTRACTOR: Jon M. Hall Company

By: Noy Rivers, President

Date: 4/25/2024

State of: Florida  
County of: Seminole  
Subscribed and sworn to before me this 25 th day of April, 2024.

Notary Public: [Signature]  
My Commission expires: \_\_\_\_\_



### ENGINEER'S CERTIFICATE FOR PAYMENT

In accordance with the Contract Documents, based on on-site observation and the data comprising this application, the Engineer certifies to the Owner that to the best of the Engineer's knowledge, information and belief, the work has progressed as indicated, the quality of the work is in accordance with the Contract Documents, and the Contractor is entitled to payment of the Amount Certified.

AMOUNT CERTIFIED ..... Date: \_\_\_\_\_  
(Attach explanation if amount certified differs from the amount applied for. Initial all figures on this application and on the Continuation Sheet that are changed to conform to the amount certified.)

Engineer: \_\_\_\_\_ Date: \_\_\_\_\_  
By: \_\_\_\_\_

Continuation Sheet

APPLICATION AND CERTIFICATE FOR PAYMENT, containing Contractor's signed Certification, is attached.

23028  
Bella Vista - Dundee, FL  
Application No: 23028-03 Rev 2  
Application Date: 04/25/24  
Period To: 04/30/24

A RICHMOND COST CODE	B ITEM NO.	C DESCRIPTION OF WORK	D QTY	E UM	F Unit Price	G SCHEDULED VALUE (C-E)	H QTY INSTALLED PREVIOUS PERIOD	I QTY INSTALLED THIS PERIOD	J AMOUNT PREVIOUS APPLICATION (E*G)	K AMOUNT COMPLETED THIS PERIOD (E*H)	L COMPLETED AND STORED TO DATE (H+J)	M % (K/F)	N REMAINING TO FINISH (F-K)	O RETAINAGE (K*.10)
<b>01 MOBILIZATION &amp; GENERAL CONDITIONS</b>														
33306	10010	Jobsite Facilities	1.00	LS	15,100.00	\$ 15,100.00	0.20	0.40	\$ 3,020.00	\$ 6,040.00	\$ 9,060.00	60%	\$ 6,040.00	\$ 906.00
33306	10020	Supervision	1.00	LS	59,200.00	\$ 59,200.00	0.30	0.30	\$ 17,760.00	\$ 17,760.00	\$ 35,520.00	60%	\$ 23,680.00	\$ 3,552.00
33306	10030	Geotechnical Testing	1.00	LS	42,700.00	\$ 42,700.00	0.20	0.40	\$ 8,540.00	\$ 17,080.00	\$ 25,620.00	60%	\$ 17,080.00	\$ 2,562.00
33306	10040	Survey & As-Builts	1.00	LS	56,800.00	\$ 56,800.00	0.15	0.35	\$ 8,520.00	\$ 19,880.00	\$ 28,400.00	50%	\$ 28,400.00	\$ 2,840.00
33306	10050	Mobilization & Material Offroad	1.00	LS	61,700.00	\$ 61,700.00	0.60	0.40	\$ 37,020.00	\$ 24,680.00	\$ 61,700.00	100%	\$ -	\$ 6,170.00
33306	10060	Construction Entrance	1.00	EA	13,600.00	\$ 13,600.00	0.70	0.30	\$ 9,520.00	\$ 4,080.00	\$ 13,600.00	100%	\$ -	\$ 1,360.00
33306	10070	Silt Fence (Single Row)	6.835	LF	1.50	\$ 10,252.50	6.835	0.20	\$ 928.00	\$ 928.00	\$ 1,856.00	40%	\$ 2,784.00	\$ 185.60
33306	10080	SWPPP Permit & Monitoring	1.00	LS	4,640.00	\$ 4,640.00	0.20	0.20	\$ 928.00	\$ 928.00	\$ 1,856.00	40%	\$ 2,784.00	\$ 185.60
<b>MOB &amp; GENERAL CONDITIONS Subtotal</b>						<b>263,922.50</b>			<b>95,560.50</b>	<b>90,448.00</b>	<b>186,008.50</b>		<b>77,984.00</b>	<b>16,600.85</b>
<b>02 CLEAR, GRUB &amp; STRIP</b>														
33303	10090	Sawcut (Entrance Crossing) Heavy Disking Site (In Lieu Of Stripping) (Based Upon Site Visit The Site Appears To Be 100% Cleared. However, If Additional Clearing Is Required It Will Be Billed As A Change Order)	125.00	LF	2.00	\$ 250.00			\$ -	\$ -	\$ -	0%	\$ 250.00	\$ -
33303	10100	Demo Exist Asphalt Pavement	32.20	ACRE	800.00	\$ 25,760.00	32.20		\$ 25,760.00	\$ -	\$ 25,760.00	100%	\$ -	\$ 2,576.00
33303	10110	Remove & Cap Well (By Others)	2.00	EA	0.00	\$ -			\$ -	\$ -	\$ -	0%	\$ 808.40	\$ -
<b>02 Clear, Grub &amp; Strip Subtotal</b>						<b>26,818.40</b>			<b>25,760.00</b>	<b>0.00</b>	<b>25,760.00</b>		<b>1,058.40</b>	<b>2,576.00</b>
<b>03 EARTHWORK</b>														
33303	10130	Site Excavation (Cut To Fill) (Raise Site To Pond Excavation Material)	47,968.00	BCY	2.40	\$ 115,123.20	47,968.00		\$ 115,123.20	\$ 0.00	\$ 115,123.20	100%	\$ 0.00	\$ 11,512.32
33303	10140	Pond Excavation (Cut To Fill) (Pond - 100 11', Pond 200 - 7', Pond 3 - 7')	11,126.00	BCY	2.40	\$ 26,702.40	11,126.00		\$ 26,702.40	\$ -	\$ 26,702.40	100%	\$ -	\$ 2,670.24
33303	10150	Rough Grade Pavement Box	18,297.00	SY	0.76	\$ 13,905.72	13,800.00	2,000.00	\$ 10,488.00	\$ 1,520.00	\$ 12,008.00	86%	\$ 1,897.72	\$ 1,200.80
<b>03 Earthwork Subtotal</b>						<b>155,731.32</b>			<b>152,313.60</b>	<b>1,520.00</b>	<b>153,833.60</b>		<b>1,897.72</b>	<b>15,383.36</b>
<b>04 FINISH GRADING</b>														
33830	10160	Fine Grade Ponds	13,618.00	SY	0.55	\$ 7,489.90		13,618.00	\$ -	\$ 7,489.90	\$ 7,489.90	100%	\$ -	\$ 748.99
33830	10170	Fine Grade ROW	11,174.00	SY	0.82	\$ 9,162.68			\$ -	\$ -	\$ -	0%	\$ 9,162.68	\$ -
33830	10180	Fine Grade Perimeter Slopes & Swales	3,357.00	SY	0.74	\$ 2,484.18			\$ -	\$ -	\$ -	0%	\$ 2,484.18	\$ -
33830	10190	Fine Grade Lots	109.00	EA	221.00	\$ 24,089.00			\$ -	\$ -	\$ -	0%	\$ 24,089.00	\$ -
33830	10200	Backfill Curbs	14,245.00	LF	0.48	\$ 6,837.60			\$ -	\$ -	\$ -	0%	\$ 6,837.60	\$ -
<b>04 Finish Grading Subtotal</b>						<b>50,063.36</b>			<b>0.00</b>	<b>7,489.90</b>	<b>7,489.90</b>		<b>42,573.46</b>	<b>748.99</b>
<b>05 PAVING ON SITE</b>														
33830	10210	Traffic Control (Entrance/Turn Lanes)	1.00	LS	13,700.00	\$ 13,700.00		0.80	\$ -	\$ 10,960.00	\$ 10,960.00	80%	\$ 2,740.00	\$ 1,096.00
33830	10220	Build Curb Pads	14,245.00	LF	1.90	\$ 27,065.50			\$ -	\$ -	\$ -	0%	\$ 27,065.50	\$ -
33830	10230	12" Stabilized Subgrade (LBR 40)	18,297.00	SY	7.00	\$ 128,079.00			\$ -	\$ -	\$ -	0%	\$ 128,079.00	\$ -
33830	10240	6" Limerock Base	10,455.00	SY	17.50	\$ 182,962.50			\$ -	\$ -	\$ -	0%	\$ 182,962.50	\$ -
33830	10250	8" Limerock Base	7,842.00	SY	22.00	\$ 172,524.00			\$ -	\$ -	\$ -	0%	\$ 172,524.00	\$ -

Continuation Sheet

APPLICATION AND CERTIFICATE FOR PAYMENT  
containing Contractor's signed Certification, is attached.

23028  
Bella Vista - Dundee, FL

Application No: 23028-03 Rev 2  
Application Date: 04/25/24  
Period To: 04/30/24

A	B	C	D	E	F	G	H	I		J		K	L	M	N
								WORK COMPLETED PREVIOUS PERIOD (E-G)	AMOUNT THIS PERIOD (E-H)	AMOUNT THIS PERIOD (E-H)	COMPLETED AND STORED TO DATE (+/-)				
RICHMOND CODE	BID ITEM NO.	DESCRIPTION OF WORK	QTY	UM	Unit Price	SCHEDULED VALUE (C-E)	QTY INSTALLED PREVIOUS PERIOD	QTY INSTALLED THIS PERIOD	AMOUNT PREVIOUS APPLICATION (E-G)	AMOUNT THIS PERIOD (E-H)	COMPLETED AND STORED TO DATE (+/-)	% (K/F)	REMAINING TO FINISH (E-K)	RETAINAGE (K-10)	
33630	10260	1.25" SP-9.5 Asphalt (1 Lft)	10,455.00	SY	12.50	\$ 130,687.50									
33630	10270	2" SP-9.5 Asphalt (2 Lfts)	7,842.00	SY	21.00	\$ 164,682.00									
33630	10280	Striping & Signs	1.00	LS	21,300.00	\$ 21,300.00									
<b>05 PAVING ON SITE Subtotal</b>						<b>841,000.50</b>			<b>0.00</b>	<b>10,960.00</b>	<b>10,960.00</b>		<b>0%</b>	<b>\$ 21,300.00</b>	<b>1,096.00</b>
<b>07 SANITARY SEWER</b>															
33403	10290	Connect To Existing Manhole (6.5' Deep)	1.00	EA	2,670.00	\$ 2,670.00		1.00	\$ -	\$ 2,670.00	\$ 2,670.00	100%	\$ -	\$ 267.00	
33403	10300	8" PVC Gravity Sewer Main (0'-6')	1,535.00	LF	34.00	\$ 52,190.00	832.00	400.00	\$ 28,288.00	\$ 13,600.00	\$ 41,888.00	80%	\$ 10,302.00	\$ 4,188.80	
33403	10310	8" PVC Gravity Sewer Main (6'-8')	2,790.00	LF	35.00	\$ 97,650.00	1,475.00	750.00	\$ 51,625.00	\$ 26,250.00	\$ 77,875.00	80%	\$ 19,775.00	\$ 7,875.00	
33403	10320	8" PVC Gravity Sewer Main (8'-10')	690.00	LF	36.00	\$ 21,240.00	302.00	288.00	\$ 10,872.00	\$ 10,368.00	\$ 21,240.00	100%	\$ -	\$ 2,124.00	
33403	10330	8" PVC Gravity Sewer Main (10'-12')	895.00	LF	37.50	\$ 33,562.50	440.00	455.00	\$ 16,500.00	\$ 17,062.50	\$ 33,562.50	100%	\$ -	\$ 3,562.50	
33403	10340	8" PVC Gravity Sewer Main (12'-14')	230.00	LF	56.00	\$ 12,880.00	85.00	145.00	\$ 4,760.00	\$ 8,120.00	\$ 12,880.00	100%	\$ -	\$ 1,288.00	
33403	10350	4" Diameter Manhole (0'-6')	6.00	EA	6,680.00	\$ 40,080.00	4.98		\$ 33,266.40	\$ -	\$ 33,266.40	83%	\$ 6,813.60	\$ 3,326.64	
33403	10360	4" Diameter Manhole (6'-8')	6.00	EA	8,190.00	\$ 49,140.00	4.75		\$ 38,902.50	\$ -	\$ 38,902.50	79%	\$ 10,237.50	\$ 3,890.25	
33403	10370	4" Diameter Manhole (8'-10')	4.00	EA	9,870.00	\$ 39,480.00	3.06	0.94	\$ 30,202.20	\$ 9,277.80	\$ 39,480.00	100%	\$ -	\$ 3,948.00	
33403	10380	4" Diameter Manhole (10'-12')	1.00	EA	10,900.00	\$ 10,900.00	0.75	0.25	\$ 8,175.00	\$ 2,725.00	\$ 10,900.00	100%	\$ -	\$ 1,090.00	
33403	10390	4" Diameter Manhole (12'-14')	3.00	EA	16,300.00	\$ 48,900.00	2.35	0.65	\$ 38,305.00	\$ 10,595.00	\$ 48,900.00	100%	\$ -	\$ 4,890.00	
33403	10400	4" Single Service	20.00	EA	1,420.00	\$ 28,400.00	11.00	5.00	\$ 15,620.00	\$ 7,100.00	\$ 22,720.00	80%	\$ 5,680.00	\$ 2,272.00	
33403	10410	4" Double Service	45.00	EA	1,810.00	\$ 81,450.00	28.00	8.00	\$ 50,680.00	\$ 14,480.00	\$ 65,160.00	80%	\$ 16,290.00	\$ 6,516.00	
33403	10420	Gravity Main Testing	6,040.00	LF	10.50	\$ 63,420.00			\$ -	\$ -	\$ -	0%	\$ 63,420.00	\$ -	
<b>07 SANITARY SEWER Subtotal</b>						<b>581,962.50</b>			<b>327,196.10</b>	<b>122,248.30</b>	<b>449,444.40</b>		<b>132,518.10</b>	<b>44,944.44</b>	
<b>08 STORM SEWER</b>															
33503	10430	15" PVC (For Pond Outfall)	75.00	LF	77.50	\$ 5,812.50	60.00	8.00	\$ 4,650.00	\$ 620.00	\$ 5,270.00	91%	\$ 542.50	\$ 527.00	
33503	10440	18" HP	2,805.00	LF	49.50	\$ 138,847.50	1,823.25	800.00	\$ 90,250.88	\$ 39,600.00	\$ 129,850.88	94%	\$ 8,996.63	\$ 12,985.09	
33503	10450	24" HP	1,270.00	LF	73.50	\$ 93,345.00	917.00	225.00	\$ 67,399.50	\$ 16,537.50	\$ 83,937.00	90%	\$ 9,408.00	\$ 8,393.70	
33503	10460	30" HP	470.00	LF	109.00	\$ 51,230.00	359.00	111.00	\$ 39,131.00	\$ 12,099.00	\$ 51,230.00	100%	\$ -	\$ 5,123.00	
33503	10470	36" HP	210.00	LF	120.00	\$ 25,200.00	161.00	49.00	\$ 19,320.00	\$ 5,880.00	\$ 25,200.00	100%	\$ -	\$ 2,520.00	
33503	10480	C Inlet	1.00	EA	3,520.00	\$ 3,520.00	0.66	0.24	\$ 2,323.20	\$ 844.80	\$ 3,168.00	90%	\$ 352.00	\$ 316.80	
33503	10490	C Control Structure	1.00	EA	5,775.00	\$ 5,775.00	0.77	0.03	\$ 4,446.75	\$ 173.25	\$ 4,620.00	80%	\$ 1,155.00	\$ 462.00	
33503	10500	P-5 Curb Inlet	21.00	EA	6,910.00	\$ 145,110.00	13.65	5.50	\$ 94,321.50	\$ 38,005.00	\$ 132,326.50	91%	\$ 12,783.50	\$ 13,232.65	
33503	10510	J-5 Curb Inlet	7.00	EA	11,935.00	\$ 83,545.00	5.45	1.00	\$ 65,045.75	\$ 11,935.00	\$ 76,980.75	92%	\$ 6,564.25	\$ 7,698.08	
33503	10520	P-6 Curb Inlet	7.00	EA	7,765.00	\$ 54,355.00	4.80	1.00	\$ 37,272.00	\$ 7,765.00	\$ 45,037.00	83%	\$ 9,318.00	\$ 4,503.70	
33503	10530	J-6 Curb Inlet	2.00	EA	10,575.00	\$ 21,150.00	1.50	0.20	\$ 15,862.50	\$ 2,115.00	\$ 17,977.50	85%	\$ 3,172.50	\$ 1,797.75	
33503	10540	P Manhole	1.00	EA	4,920.00	\$ 4,920.00	0.71	0.20	\$ 3,493.20	\$ 984.00	\$ 4,477.20	91%	\$ 442.80	\$ 447.72	
33503	10550	18" MES	1.00	EA	2,100.00	\$ 2,100.00		0.60	\$ -	\$ 1,260.00	\$ 1,260.00	60%	\$ 840.00	\$ 126.00	
33503	10560	Riprap (Broken Concrete)	30.00	SY	76.00	\$ 2,280.00			\$ -	\$ -	\$ -	0%	\$ 2,280.00	\$ -	
33503	10570	24" MES	1.00	EA	3,270.00	\$ 3,270.00		1.00	\$ -	\$ 3,270.00	\$ 3,270.00	100%	\$ -	\$ 327.00	

Continuation Sheet

APPLICATION AND CERTIFICATE FOR PAYMENT, containing Contractor's signed Certification, is attached.

23028  
Bella Vista - Dundee, FL

Application No: 23028-03 Rev 2  
Application Date: 04/25/24  
Period To: 04/30/24

A	B	C	D	E	F	G	H	I	J	K	L	M	N	
RICHMOND COST CODE	BID ITEM NO. DESCRIPTION OF WORK	QTY	UM	Unit Price	SCHEDULED VALUE (C-E)	QTY INSTALLED PREVIOUS PERIOD	QTY INSTALLED THIS PERIOD	WORK COMPLETED PREVIOUS APPLICATION (E-G)	AMOUNT COMPLETED THIS PERIOD (E-H)	COMPLETED AND STORED TO DATE ((+)-K)	% (K/F)	REMAINING TO FINISH (F-K)	RETAINAGE ((K*-10)	
33503	10580 30" MES	1.00	EA	3,650.00	3,650.00		1.00	-	3,650.00	3,650.00	100%	-	365.00	
33503	10590 36" MES	2.00	EA	4,000.00	8,000.00		2.00	-	8,000.00	8,000.00	100%	-	800.00	
33503	10600 Well 4" Concrete	2.00	EA	7,790.00	15,580.00		1.00	-	7,790.00	7,790.00	50%	7,790.00	779.00	
33503	10610 Clean, Flush, TV & Laser Profile	4,830.00	LF	7.50	36,225.00			-	-	-	0%	36,225.00	-	
<b>08 STORM SEWER Subtotal</b>					<b>703,915.00</b>			<b>443,516.28</b>	<b>160,528.55</b>	<b>604,044.83</b>			<b>99,870.18</b>	<b>60,404.48</b>
<b>09 WATER SYSTEM</b>														
33603	10620 Temporary Lumber	2.00	EA	1,880.00	3,760.00		0.79	-	1,485.20	1,692.00	85%	582.80	317.72	
33603	10630 10 X 10 Wet Tap	2.00	EA	9,640.00	19,280.00		1.49	-	14,363.60	1,060.40	80%	3,856.00	1,542.40	
33603	10640 8" PVC Watermain	5,480.00	LF	41.50	227,420.00	3,960.00	950.00	164,340.00	39,425.00	203,765.00	90%	23,655.00	20,376.50	
33603	10650 10" PVC Watermain	320.00	LF	61.00	19,520.00	235.00	54.00	14,335.00	3,294.00	17,629.00	90%	1,891.00	1,762.90	
33603	10660 Fire Hydrant Assembly	8.00	EA	7,980.00	63,840.00		6.55	52,269.00	5,187.00	57,456.00	90%	6,384.00	5,745.60	
33603	10670 Fittings & Restraints	1.00	LS	58,375.00	58,375.00		0.90	52,537.50	-	52,537.50	90%	5,837.50	5,253.75	
33603	10680 8" Gate Valve	6.00	EA	3,160.00	18,960.00		4.70	14,852.00	2,212.00	17,064.00	90%	1,896.00	1,706.40	
33603	10690 10" Gate Valve	4.00	EA	4,860.00	19,440.00		3.00	14,580.00	2,916.00	17,496.00	90%	1,944.00	1,749.60	
33603	10700 Air Release Valve (Poly Enclosure)	2.00	EA	4,760.00	9,520.00		1.80	-	8,568.00	8,568.00	90%	952.00	856.80	
33603	10710 1" Single Service	16.00	EA	1,050.00	16,800.00		13.00	-	13,650.00	13,650.00	81%	3,150.00	1,365.00	
33603	10720 2" Double Service	47.00	EA	2,020.00	94,940.00		42.00	-	84,840.00	84,840.00	89%	10,100.00	8,484.00	
33603	10730 1" Irrigation Water Service	10.00	EA	2,390.00	23,900.00		8.00	-	19,120.00	19,120.00	80%	4,780.00	1,912.00	
33603	10740 Test & Chlorinate	1.00	LS	18,500.00	18,500.00			-	-	-	0%	18,500.00	-	
33603	10750 10" HDPE Directional Bore	100.00	LF	392.00	39,200.00		22.00	8,624.00	9,016.00	17,640.00	45%	21,560.00	1,764.00	
<b>09 WATER SYSTEM Subtotal</b>					<b>633,455.00</b>			<b>337,386.30</b>	<b>190,980.40</b>	<b>528,366.70</b>			<b>105,088.30</b>	<b>52,836.67</b>
<b>11 CONCRETE WORK</b>														
33830	10760 Miami Curb	14,245.00	LF	24.00	341,880.00			-	-	-	0%	341,880.00	-	
33830	10770 5' Sidewalk (4" Thick)	5,370.00	LF	33.50	179,895.00			-	-	-	0%	179,895.00	-	
33830	10780 Handicap Ramp W/ Detectable Warning	19.00	EA	1,825.00	34,675.00			-	-	-	0%	34,675.00	-	
<b>11 CONCRETE WORK Subtotal</b>					<b>556,450.00</b>			<b>0.00</b>	<b>0.00</b>	<b>0.00</b>			<b>556,450.00</b>	<b>-</b>
<b>12 GRASSING</b>														
33303	10790 Seed & Mulch Lots	108,614.00	SY	0.27	29,325.78			-	-	-	0%	29,325.78	-	
33303	10800 Seed & Mulch Pond Bottom	1,590.00	SY	0.27	429.30			-	-	-	0%	429.30	-	
33303	10810 Sod ROW	6,940.00	SY	3.05	21,167.00			-	-	-	0%	21,167.00	-	
33303	10820 Sod Perimeter Slopes & Swales	3,355.00	SY	3.05	10,232.75			-	-	-	0%	10,232.75	-	
33303	10830 Sod Pond Slopes	12,028.00	SY	3.05	36,685.40			-	-	-	0%	36,685.40	-	
33303	10840 Sod Two Strips Behind Curbs & Sidewalks	4,238.00	SY	3.05	12,925.90			-	-	-	0%	12,925.90	-	
<b>12 GRASSING Subtotal</b>					<b>110,766.13</b>			<b>0.00</b>	<b>0.00</b>	<b>0.00</b>			<b>110,766.13</b>	<b>-</b>
<b>ORIGINAL CONTRACT TOTAL</b>					<b>3,924,154.71</b>			<b>1,381,732.78</b>	<b>584,175.15</b>	<b>1,965,907.93</b>	<b>50%</b>	<b>1,958,246.79</b>	<b>196,590.79</b>	

**Continuation Sheet**

APPLICATION AND CERTIFICATE FOR PAYMENT.  
containing Contractor's signed Certification, is attached.

23028  
Bella Vista - Dundee, FL

Application No: 23028-03 Rev 2  
Application Date: 04/25/24  
Period To: 04/30/24

A	B	C	D	E	F	G	H	I	J	K	L	M	N
RICHMOND COST CODE	BID ITEM NO. DESCRIPTION OF WORK	QTY	U/M	Unit Price	SCHEDULED VALUE (C-E)	QTY INSTALLED PREVIOUS PERIOD	QTY INSTALLED THIS PERIOD	WORK COMPLETED PREVIOUS APPLICATION (E-G)	AMOUNT THIS PERIOD (E-H)	COMPLETED AND STORED TO DATE (I+J)	% (K/L)	REMAINING TO FINISH (F-K)	RETAINAGE (K*10)
01	Clear & Burn On-Site / Engineering Fee												
33409	CO-01-01 OCIP Fee	1	LS	\$827.50	827.50	1.00		827.50	0.00	827.50	100%	0.00	82.75
33306	CO-01-02 Engineering Fee	1	LS	\$20,000.00	20,000.00	1.00		20,000.00	0.00	20,000.00	100%	0.00	2,000.00
33302	CO-01-03 Clear, Grub, and Curtain Burn Onsite	7	ACRE	\$8,511.36	59,579.52	7.00		59,579.52	0.00	59,579.52	100%	0.00	5,957.95
	<b>CO 1 Subtotal</b>				<b>80,407.02</b>			<b>80,407.02</b>		<b>80,407.02</b>			<b>8,040.70</b>
02	Temporary Clay Road												
33409	CO-02-01 OCIP Fee	1	LS	\$104.30	104.30	1.00		104.30	0.00	104.30	100%	0.00	10.43
33830	CO-02-02 Removal of Existing power Poles / Well abandonment	1	LS	\$8,343.32	8,343.32	1.00		8,343.32	0.00	8,343.32	100%	0.00	834.33
	<b>CO 2 Subtotal</b>				<b>8,447.62</b>			<b>8,447.62</b>		<b>8,447.62</b>			<b>844.76</b>
03	Saturday (Overtime) Work												
33409	CO-04-01 OCIP Fee	1	LS	\$408.25	408.25	1.00		408.25	0.00	408.25	100%	0.00	40.83
33830	CO-04-02 Saturday Work	1	LS	\$32,660.16	32,660.16	1.00		32,660.16	0.00	32,660.16	100%	0.00	3,266.02
	<b>CO 2 Subtotal</b>				<b>33,068.41</b>			<b>33,068.41</b>		<b>33,068.41</b>			<b>3,306.84</b>
	<b>CHANGE ORDER Totals</b>				<b>121,923.05</b>			<b>88,854.64</b>	<b>33,068.41</b>	<b>121,923.05</b>			<b>12,192.31</b>
	<b>GRAND TOTALS</b>				<b>4,046,077.76</b>			<b>1,470,587.42</b>	<b>617,243.56</b>	<b>2,087,830.98</b>	<b>52%</b>		<b>208,783.10</b>

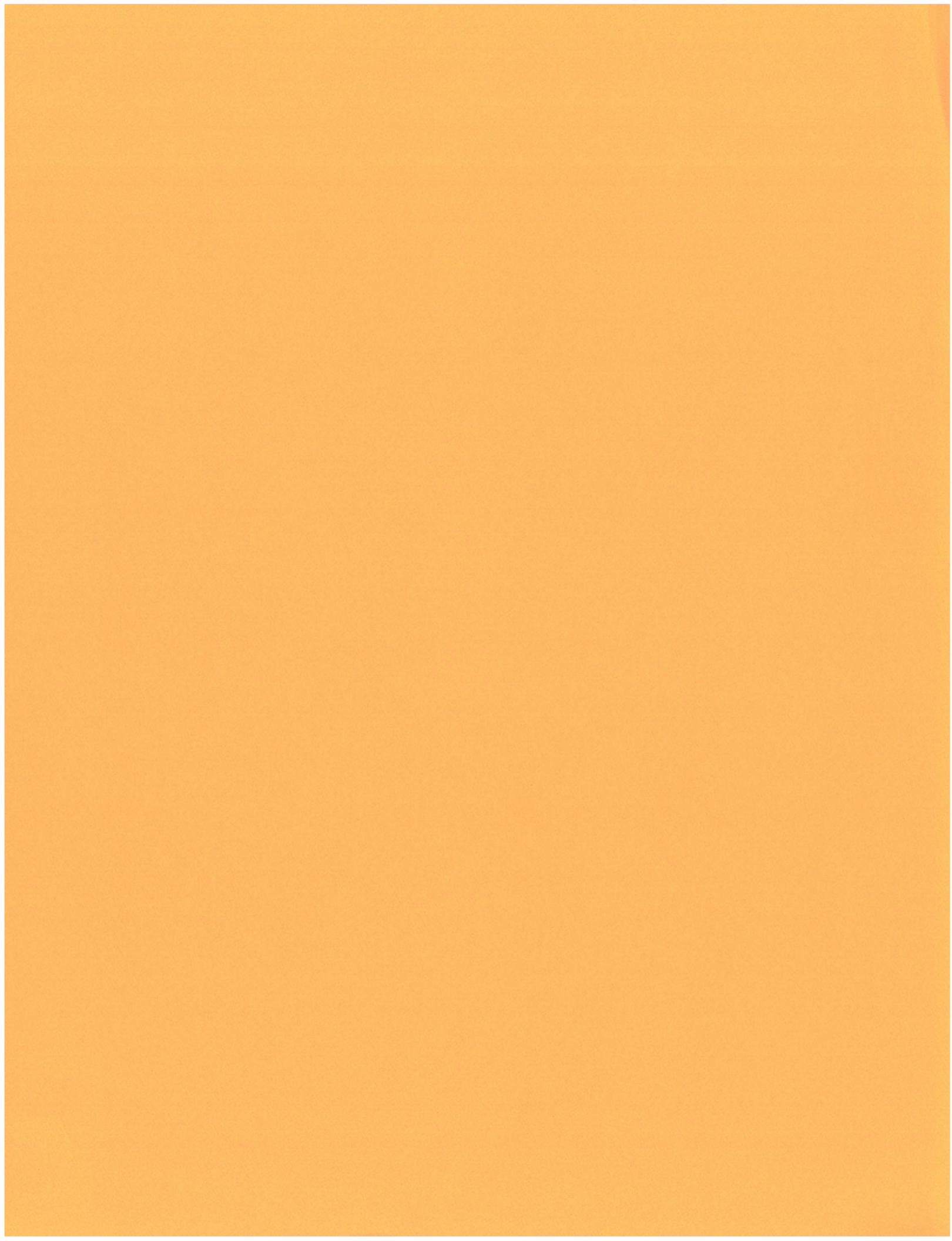

# EXHIBIT D



## CERTIFICATION OF CONSTRUCTION COMPLETION AND REQUEST FOR CLEARANCE TO PLACE PERMITTED PWS COMPONENTS INTO OPERATION

See page 5 for instructions.

### I. General Project Information

A. Name of Project: Bella Vista

B. Department of Environmental Protection (DEP) Construction Permit

Permit Number: 136414-085

Date Permit Was Issued: 09-08-2022

C. Portion of Project for Which Construction Is Substantially Complete and for Which Clearance Is Requested

Entire Project

Following Portion of Project: \_\_\_\_\_

D. Permittee

PWS/Company Name: Richmond American Homes

PWS Identification Number: \*

PWS Type: \*  Community  Non-Transient Non-Community  Transient Non-Community  Consecutive

Contact Person: Kenneth L. Smith

Contact Person's Title: Division President

Contact Person's Mailing Address: 2822 Commerce Park Drive, Suite 100

City: Orlando

State: FL

Zip Code: 32819

Contact Person's Telephone Number: 407.586.7622

Contact Person's Fax Number: \_\_\_\_\_

Contact Person's E-Mail Address: Tim.Wheeler@mdch.com

\* This information is required only if the permittee is a public water system (PWS).

E. Public Water System (PWS) Supplying Water to Project

PWS Name: Town of Dundee

PWS Identification Number: \_\_\_\_\_

PWS Type:  Community  Non-Transient Non-Community  Transient Non-Community  Consecutive

PWS Owner: Town of Dundee

Contact Person: Tandra Davis

Contact Person's Title: Town Manager

Contact Person's Mailing Address: 202 E Main St

City: Dundee

State: FL

Zip Code: 33838

Contact Person's Telephone Number: 863-438-8330

Contact Person's Fax Number: \_\_\_\_\_

Contact Person's E-Mail Address: tdavis@townofdundee.com

F. Public Water System (PWS) that Will Own Project After It Is Placed into Permanent Operation

PWS Name: Town of Dundee

PWS Identification Number: \*

PWS Type: \*  Community  Non-Transient Non-Community  Transient Non-Community  Consecutive

PWS Owner: \_\_\_\_\_

Contact Person: Tandra Davis

Contact Person's Title: Town Manager

Contact Person's Mailing Address: 202 E Main St

City: Dundee

State: FL

Zip Code: 33838

Contact Person's Telephone Number: 863-438-8338

Contact Person's Fax Number: \_\_\_\_\_

Contact Person's E-Mail Address: tdavis@townofdundee.com

\* This information is required only if the owner/operator is an existing PWS.

G. Professional Engineer in Responsible Charge of Inspecting Construction of Project\*

Company Name: Traditions Engineering

Engineer: Charles Brooker

Engineer's Florida License Number: 88615

Engineer's Title: P.E.

Engineer's Mailing Address: 35 Don Polston Dr

City: Eagle Lake

State: FL

Zip Code: 33839

Engineer's Telephone Number: 863.397.1626

Engineer's Fax Number: \_\_\_\_\_

Engineer's E-Mail Address: Cbrooker@traditions-eng.com

\* This information is required if construction of this project is inspected under the responsible charge of a professional engineer licensed in Florida. Whenever a project is designed under the responsible charge of a professional engineer licensed in Florida and is permitted by the Department, construction of the project shall be inspected under the responsible charge of a professional engineer licensed in Florida.



**CERTIFICATION OF CONSTRUCTION COMPLETION AND REQUEST FOR CLEARANCE TO PLACE PERMITTED PWS COMPONENTS INTO OPERATION**

DEP Construction Permit Number: 136414-085
Substantially Complete Portion of Project if Other than Entire Project:

**II. Deviations from Department of Environmental Protection (DEP) Construction Permit for Project\***

Description and explanation of all deviations from the DEP construction permit, including the approved preliminary design report or drawings and specifications, for the substantially complete portion of this project:

Existing water main near corner of Florida Ave & 8th street was found to be 6" size. As such, the eastern wet tap was changed to 6"x6" and the small section of permitted 10" was reduced to 8".

I completed Part II of this form, and the information provided in Part II is true and accurate to the best of my knowledge and belief.

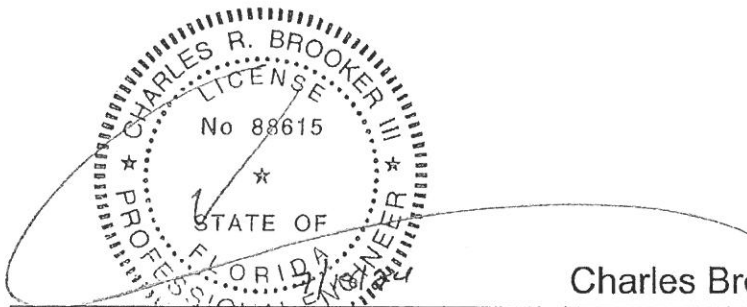

Charles Brooker

88615

Signature, Seal, and Date of Professional Engineer or  
Signature and Date of Authorized Representative of  
Permittee\*

Printed or Typed Name

License Number of Professional  
Engineer or Title of Authorized  
Representative of Permittee\*

*\* Whenever a project is designed under the responsible charge of a professional engineer licensed in Florida and is permitted by the Department, construction of the project shall be inspected under the responsible charge of a professional engineer licensed in Florida. If construction of this project is inspected under the responsible charge of a professional engineer licensed in Florida, Part II of this form shall be completed, signed, sealed, and dated by the professional engineer in responsible charge. If this project is not inspected under the responsible charge of a professional engineer licensed in Florida, Part II shall be completed, signed, and dated by an authorized representative of the permittee.*

**III. Certifications**

**A. Certification by Permittee**

I am duly authorized to sign this form on behalf of the permittee identified in Part I.D of this form. I certify the following:

- to the best of my knowledge and belief, the substantially complete portion of this project is sufficiently complete to be utilized for the purposes for which it is intended;
- to the best of my knowledge and belief, the substantially complete portion of this project has been completed in accordance with the Department of Environmental Protection construction permit, including the approved preliminary design report or drawings and specifications, for this project; or to the best of my knowledge and belief, the deviations described and explained in Part II of this form will not prevent the substantially complete portion of this project from functioning in compliance with Chapters 62-550 and 62-555, F.A.C.;

## CERTIFICATION OF CONSTRUCTION COMPLETION AND REQUEST FOR CLEARANCE TO PLACE PERMITTED PWS COMPONENTS INTO OPERATION

DEP Construction Permit Number: 136414-085

Substantially Complete Portion of Project if Other than Entire Project:

- to the best of my knowledge and belief, all new or altered public water system components that are included in the substantially complete portion of this project and that must be disinfected and bacteriologically surveyed or evaluated per subsection 62-555.315(6), F.A.C., or Rule 62-555.340, F.A.C., have been disinfected and bacteriologically surveyed or evaluated in accordance with said subsection or said rule;
- the permittee has had complete record drawings produced for the substantially complete portion of this project; to the best of my knowledge and belief, said record drawings adequately depict the substantially complete portion of this project as constructed and identify the deviations described and explained in Part II of this form; and said record drawings are available for review at the following location: 202 East Main st, Dundee, FL 33838

- if the substantially complete portion of this project includes any new or altered drinking water treatment facilities, an operation and maintenance manual for said treatment facilities is available for reference at the site of said treatment facilities or at a convenient location near the site of said treatment facilities.

I also certify that, if the permittee will not own this project after it is placed into permanent operation, the permittee has provided a copy of the above mentioned record drawings and a copy of the above mentioned operation and maintenance manual, if applicable, to the PWS that will own this project after it is placed into permanent operation.

	Kenneth L. Smith	Division President
Signature and Date	Printed or Typed Name	Title

**B. Certification by PWS Supplying Water to Project**

I am duly authorized to sign this form on behalf of the PWS identified in Part I.E of this form. I certify that said PWS will supply the water necessary to meet the water demands for the substantially complete portion of this project, and I certify the following:

- to the best of my knowledge and belief, said PWS's connection to the substantially complete portion of this project will not cause said PWS to be, or contribute to said PWS being, in noncompliance with Chapter 62-550 or 62-555, F.A.C.;
- said PWS considers the connection(s) between the substantially complete portion of this project and said PWS acceptable as constructed.

	Tandra Davis	Town Manager
Signature and Date	Printed or Typed Name	Title

**C. Certification by PWS that Will Own Project After It Is Placed into Permanent Operation**

I am duly authorized to sign this form on behalf of the PWS identified in Part I.F of this form. I certify that said PWS will own the substantially complete portion of this project after it is placed into permanent operation, and I certify the following:

- said PWS considers the substantially complete portion of this project acceptable as constructed;
- said PWS has received complete record drawings for the substantially complete portion of this project and the record drawings are available for review at the following location: 202 East Main st, Dundee, FL 33838

- if the substantially complete portion of this project includes any new or altered drinking water treatment facilities, said PWS has received an operation and maintenance manual for the new or altered treatment facilities, and the operation and maintenance manual is available for reference at the site of the new or altered treatment facilities or at a convenient location near the site of the new or altered treatment facilities.

I understand that said PWS must operate and maintain this project in a such a manner as to comply with Chapters 62-550, 62-555, 62-560, and 62-699, F.A.C.

	Tandra Davis	Town Manager
Signature and Date	Printed or Typed Name	Title

## CERTIFICATION OF CONSTRUCTION COMPLETION AND REQUEST FOR CLEARANCE TO PLACE PERMITTED PWS COMPONENTS INTO OPERATION

DEP Construction Permit Number: 136414-085
Substantially Complete Portion of Project if Other than Entire Project:

**D. Certification by Professional Engineer in Responsible Charge of Inspecting Construction of Project\***

I, the undersigned professional engineer licensed in Florida, am in responsible charge of inspecting construction of this project for the purpose of determining in general if the construction proceeds in compliance with the Department of Environmental Protection (DEP) construction permit, including the approved preliminary design report or drawings and specifications, for this project. I, or a person acting under my responsible charge, observed construction of the substantially complete portion of this project and reviewed shop drawings, test results, and record drawings for the substantially complete portion of this project, and based upon said observation and reviews, I certify the following:

- the substantially complete portion of this project is sufficiently complete to be utilized for the purposes for which it is intended;
- the substantially complete portion of this project has been completed in accordance with the DEP construction permit, including the approved preliminary design report or drawings and specifications, for this project; or to the best of my knowledge and belief, the deviations described and explained in Part II of this form will not prevent the substantially complete portion of this project from functioning in compliance with Chapters 62-550 and 62-555, F.A.C.;
- all new or altered public water system components that are included in the substantially complete portion of this project and that must be disinfected and bacteriologically surveyed or evaluated per subsection 62-555.315(6), F.A.C., or Rule 62-555.340, F.A.C., have been disinfected and bacteriologically surveyed or evaluated in accordance with said subsection or said rule; and
- the record drawings for the substantially complete portion of this project adequately depict the substantially complete portion of this project as constructed and identify the deviations described and explained in Part II of this form.

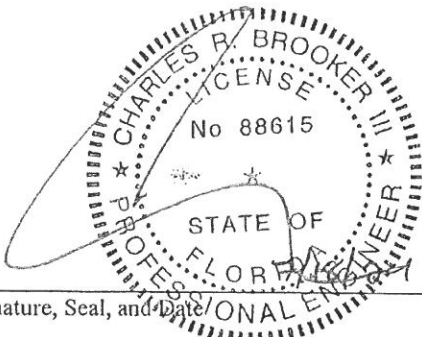

Charles Brooker P.E.      88615

Signature, Seal, and Date

Printed or Typed Name

License Number

\* Whenever a project is designed under the responsible charge of a professional engineer licensed in Florida and is permitted by the Department, construction of the project shall be inspected under the responsible charge of a professional engineer licensed in Florida. If construction of this project is inspected under the responsible charge of a professional engineer licensed in Florida, Part III.D of this form shall be completed, signed, sealed, and dated by the professional engineer in responsible charge. If this project is not inspected under the responsible charge of a professional engineer licensed in Florida, Part III.D does not have to be completed.

## CERTIFICATION OF CONSTRUCTION COMPLETION AND REQUEST FOR CLEARANCE TO PLACE PERMITTED PWS COMPONENTS INTO OPERATION

INSTRUCTIONS: This form shall be completed and submitted for projects permitted and constructed under specific Department of Environmental Protection (DEP) construction permits for public water system components, under the DEP's "General Permit for Construction of Water Main Extensions for Public Water Systems," or under the DEP's "General Permit for Construction of Lead or Copper Corrosion Control, or Iron or Manganese Sequestration, Treatment Facilities for Small or Medium Public Water Systems." AFTER COMPLETING, OR SUBSTANTIALLY COMPLETING, CONSTRUCTION OF A PROJECT, OR A PORTION THEREOF, AND BEFORE PLACING THE SUBSTANTIALLY COMPLETE PROJECT, OR PORTION THEREOF, INTO OPERATION FOR ANY PURPOSE OTHER THAN DISINFECTION, TESTING FOR LEAKS, OR TESTING EQUIPMENT OPERATION, complete and submit one copy of this form to the appropriate DEP District Office or Approved County Health Department along with one copy of the following information:

- the portion of record drawings showing deviations from the DEP construction permit, including the approved preliminary design report or drawings and specifications, if there are any deviations from said permit (note that it is necessary to submit a copy of only the portion of record drawings showing deviations and not a complete set of record drawings);
- bacteriological test results, including a sketch or description of all bacteriological sampling locations, demonstrating compliance with subsection 62-555.315(6), F.A.C., or Rule 62-555.340, F.A.C., if the substantially complete portion of the project includes any new or altered public water system (PWS) components that must be disinfected and bacteriologically surveyed or evaluated per said subsection or said rule;
- analytical test results demonstrating compliance with Part III of Chapter 62-550, F.A.C., or subsection 62-524.650(2), F.A.C., if the substantially complete portion of the project includes any new or altered PWS components that are necessary to achieve, or affect, compliance with said part or said subsection;
- a completed Form 62-555.900(20), New Water System Capacity Development Financial and Managerial Operations Plan, if the DEP construction permit was issued before the effective date of Rule 62-555.525, F.A.C., (9-22-99) and the substantially complete portion of the project creates a "new system" as described under subsection 62-555.525(1), F.A.C.; and
- any other information required by conditions in the DEP construction permit.

All information provided on this form shall be typed or printed in ink. NOTE THAT A SEPARATE CERTIFICATION OF CONSTRUCTION COMPLETION AND REQUEST FOR CLEARANCE IS REQUIRED FOR EACH PERMITTED PROJECT. **DO NOT PLACE ANY NEW OR ALTERED PWS COMPONENTS INTO PERMANENT OPERATION UNTIL THE DEPARTMENT ISSUES WRITTEN APPROVAL, OR CLEARANCE, TO PLACE THE COMPONENTS INTO PERMANENT OPERATION.**