

FBI

1986

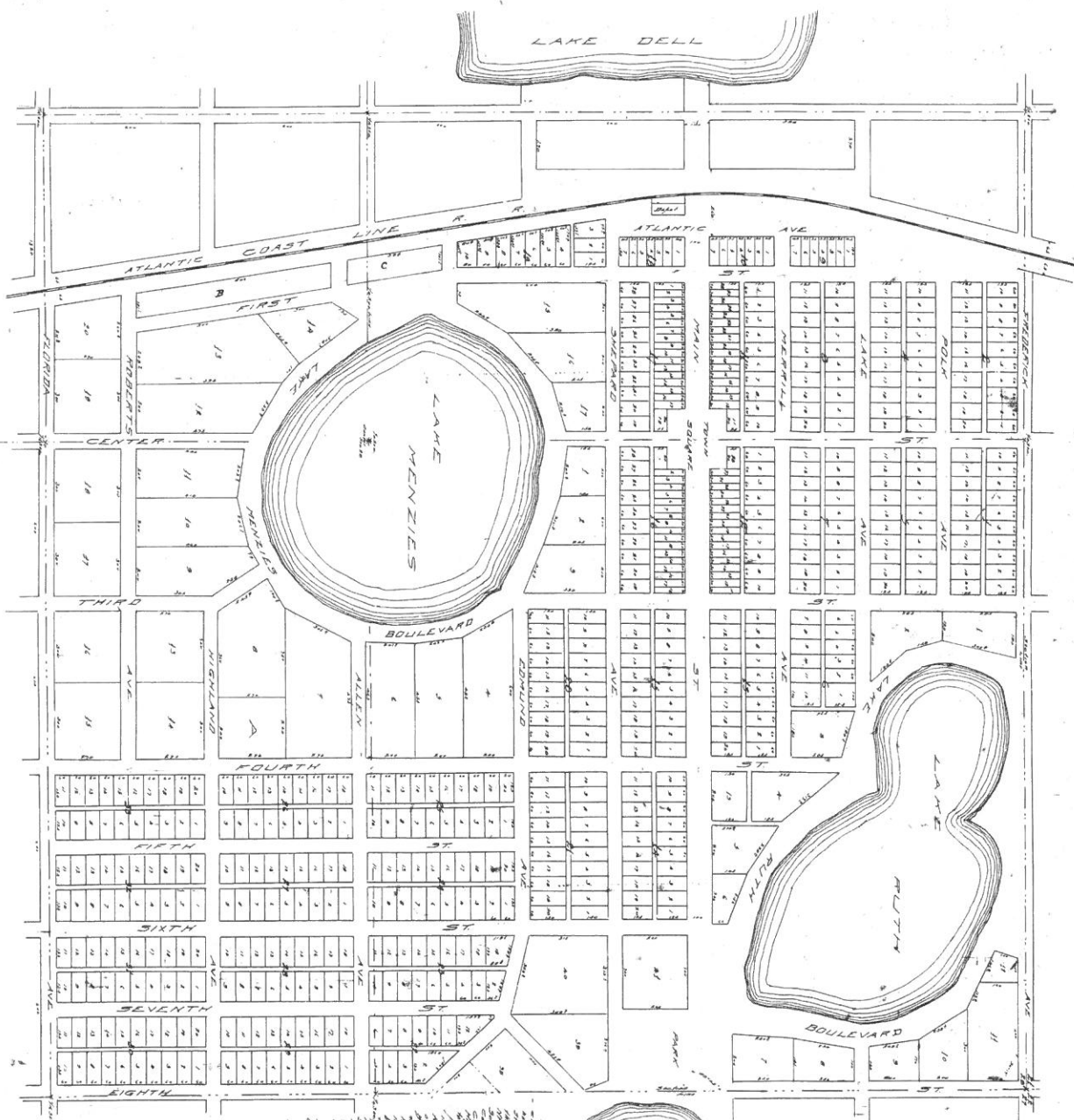

DEED BOOK 86
PONDIE

POLK COUNTY
FLORIDA

Map of Lake Pelcier
No. 1000
Recorded in Official Record
Book 1000 Page 1000
Date of Record 1000

CONTRACT NO. 90-13
Recorded in Official Record
Book 1000 Page 1000
Date of Record 1000

Map of Lake Pelcier
No. 1000
Recorded in Official Record
Book 1000 Page 1000
Date of Record 1000

Map of Lake Pelcier
No. 1000
Recorded in Official Record
Book 1000 Page 1000
Date of Record 1000

Map of Lake Pelcier
No. 1000
Recorded in Official Record
Book 1000 Page 1000
Date of Record 1000

MAY 23 2023

RESOLUTION 00-07**A RESOLUTION ACCEPTING ALL STREETS, ALLEYS, EASEMENTS, RIGHTS OF WAY, AND THOROUGHFARES PREVIOUSLY DEDICATED IN THE TOWN OF DUNDEE;**

WHEREAS, numerous subdivision plats of property located within the Town of Dundee were recorded in the Official Records of Polk County, prior to September 1, 1971, and

WHEREAS, from and after September 1, 1991, the dedication of all streets, alleys, easements, rights of way and public areas as deemed completed upon approval by the Town Council and the recordation of such plat; and

WHEREAS, the Town wishes to formally accept all streets, alleys, easements, rights of way, and all other public areas heretofore dedicated on plats of land within the Town which were recorded in the Official Records of Polk County, Florida, prior to September 1, 1971;

NOW THEREFORE BE IT UNANIMOUSLY RESOLVED by the Town Council of the Town of Dundee, Florida:

1. All streets, alleys, easements, and rights of way, and public areas heretofore dedicated to the Town of Dundee on plats of real property located within the Town which were recorded prior to September 1, 1971, are hereby accepted and approved by the Town Council.
2. The Town Council specifically accepts all streets, alleys, easements, and rights of way, and public areas heretofore dedicated to the Town of Dundee located in the following subdivisions in the Town of Dundee:
 - A. Florida Highland Company Subdivision, a subdivision of a portion of Sections 27, 28, 33 and 34, in Township 28 South, Range 27 East, Polk County, Florida, which subdivision plat was recorded in Plat Book 1C, on page 87, the office of the Clerk of the Circuit Court, in and for Polk County, Florida, on or about June 30, 1911.
 - B. W.J. Howey Land Company's First Addition to Dundee, Polk County, Florida, being a sub of all that part of Sec. 28, Tp 28 S, R. 27E, which lies W. of the ACL Railroad, which subdivision was filed May 1, 1916, in the office of the Clerk of the Circuit Court, in Polk County, Florida, in Plat Book 28, page 6, public records of Polk County, Florida.
 - C. D.L. Hart's Subdivision, as recorded in Plat Book 23, page 16, public records of Polk County, Florida, as approved by the Dundee Town Council on March 9, 1926, and as recorded by J.D. Raulerson, Clerk, on or about April 9, 1926, in the official records of Polk County, Florida.

RESOLVED AND PASSED in regular session assembled this 9th days of May, 2000.

TOWN OF DUNDEE

Joe Garrison, Mayor

ATTEST:

Tracy Ackroyd, Town Clerk

Town of Dundee
PO Box 1000
Dundee FL 33838

INSTN # 2000102729 OR BK 4485 PG 074 RECD 06/29/2000 10:30 AM
RICHARD M. VEISS, CLERK OF COURT, POLK COUNTY
DEPUTY CLERK P VAUGHAN

