

**TOWN OF DUNDEE  
PRICE QUOTE SHEET**

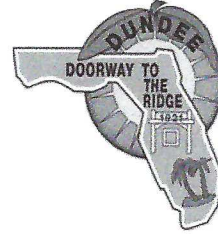

DATE: 12/2/2022

DEPARTMENT: PARKS AND RECS

NAME OF PERSON SECURING THE QUOTE: JOHNATHON VICE

GENERAL DESCRIPTION OF ITEM: REPLACEING CHAINLINK FENCE AT LAKE MARIE PARK  
4FT HIGH AND 342FT IN LENGTH AND REPLACE A  
12FT DOUBLE GATE OPENING

Vendor Selected: ☒

**VENDOR #1**

COMPANY NAME: WALKERS FENCE CO

CONTACT NUMBER: 863-967-7748

NAME OF REPRESENTATIVE: MARCUS

PRICE: \$6892.16

SHIPPING: N/A

COMMENTS: REPLACEING FENCE WITH GALV FENCE

Vendor Selected: ☐

**VENDOR #2**

COMPANY NAME: SUMMERLIN FENCE & FEED INC

CONTACT NUMBER: 863-422-4537

NAME OF REPRESENTATIVE: RANDY S.

PRICE: \$9400.00

SHIPPING: N/A

COMMENTS: REPLACEING FENCE WITH GALV FENCE

Vendor Selected: ☐

**VENDOR #3**

COMPANY NAME: SUPERIOR FENCE&RAIL INC

CONTACT NUMBER: 863-229-2762

NAME OF REPRESENTATIVE: DAVID

PRICE: \$14630.51

SHIPPING: N/A

COMMENTS: REPLACEING FENCE WITH GALV FENCE

DEPARTMENT DIRECTOR/SUPERVISOR:

*Johnathon Vice*

DATE: 12/2/2022

FINANCE DIRECTOR APPROVAL:

*[Signature]*

DATE: 12/2/2022

TOWN MANAGER APPROVAL:

*[Signature]*

DATE: 12/2/2022

ADDITIONAL COMMENTS:

SOLE SOURCE JUSTIFICATION:



Revised 11-17-22

Quote Date June 21 2022

Invoice No. \_\_\_\_\_ / Date \_\_\_\_\_

Completion Date \_\_\_\_\_ Posted \_\_\_\_\_

Proposal To City of Dundee

Address Across from 603 Wk Marie Dr.

City Dundee

Zip \_\_\_\_\_

Source of Lead John Vice  
Home/Cell Telephone No. 514-CC36

Work No. \_\_\_\_\_

Fax No. \_\_\_\_\_

1028 Highway 92 West • Auburndale, FL 33823  
Phone: (863) 967-7748 • (863) 666-1330  
Fax: (863) 967-4168

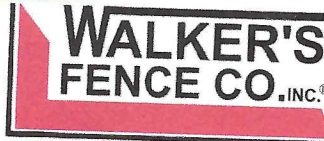

Total Height 4' Top Rail 15/8 Walk Gate Post -  
Post Spaced 10' Line Post 2" Drive Gate Posts 2 1/2  
Gauge ☐ 9 ☒ 11 1/2 End Post 2 1/2 Gate Frames 15/8  
Knuckled ☒ Corner Post 2 1/2  
Safeguard ☐ Fence Type (s) Galv c/l

Posts set in concrete ☐ Yes ☐ No  
Stakes Visible ☐ Yes ☐ No  
Flagged ☐ Yes ☐ No  
Tentative Install Date 7-9 weeks

447'	Complete Fence With - Without Top Rail
	Complete Fence With - Without Top Rail
8	2 1/2 Terminal Posts
	Terminal Posts
	Off-Set
	Tie-On
1	12'w Gate
	Gate
	Gate
	Gate
Yes	Ten Wire

c/l tearout + haul off

Salesman Marcus  
Total Contract Price \$ 6,237.34  
Deposit \$ \_\_\_\_\_

**BALANCE DUE UPON COMPLETION OF JOB \$**



Total Price \$6,892.16

~~IN BLACK VINYL COATED~~  
~~Light Commercial Same Specs~~  
~~\$7898.32~~

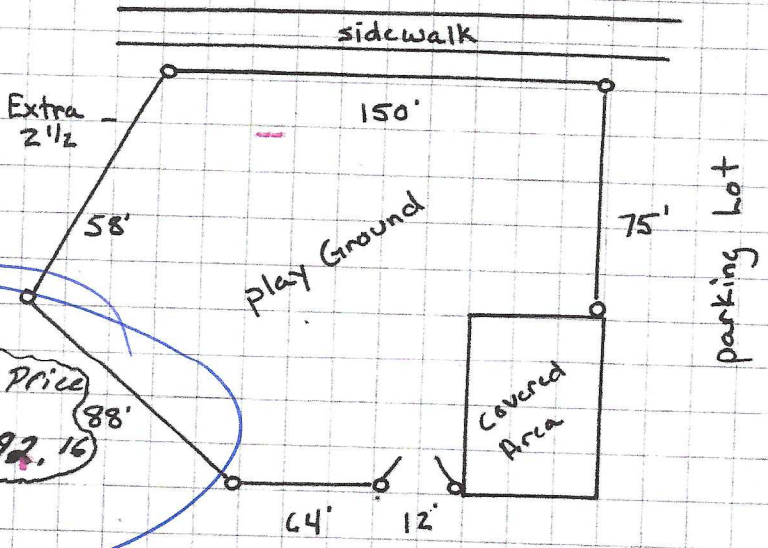

All work will be performed in a professional quality manner in accordance with standard trade practices. **Location of property lines and/or damage to underground objects or utilities not located by the Locating Service are the responsibility of the owner.** Unless specified, quotations do not include grading, brushing or jackhammer work, which are charged by the hour as needed. Walker's Fence Co. reserves the right to repossess all material delivered to or installed on the job, if payment is not made as specified. The customer will be responsible for all materials delivered to job site and/or to customer. The customer agrees to hold the company harmless for all claims arising from questions of survey of said property of location of said lines and

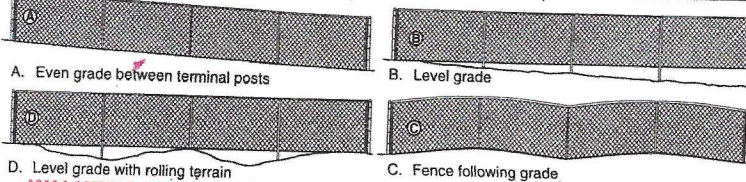

**WALKER'S FENCE NOT RESPONSIBLE FOR IRRIGATION**

from claims for personal injury, property damage or trespass from or by means of the installation of said fence material. Not responsible for loss due to wind, rain, flood or other natural causes. This proposal becomes a contract when accepted by both parties. Interest will be charged at 1.5% per month on accounts over 30 days. Costs of collection and attorney fees if any, will be added. **NOTICE TO BUYER: THERE IS 20% CANCELLATION FEE ON THIS CONTRACT WHICH REPRESENTS LIQUIDATED DAMAGES.** Purchasers of cypress wood fences installed by Walker's Fence Co. are informed of the following: Fence wood materials are rough mill-cut pieces. This wood has knots, a rough surface and is of the "rustic" appearance. Cypress is a wood that shrinks in hot weather and small gaps will appear between boards. Cracks in the wood are common and an accepted occurrence. Our guarantee covers workmanship **ONLY** on wood fences. **CUSTOMER IS RESPONSIBLE FOR OBTAINING ALL NECESSARY BUILDING PERMITS UNLESS SPECIFICALLY STATED OTHERWISE IN THIS CONTRACT.**

I have read, understood and accepted the above contract terms and conditions:

White: Office Copy

Signature of Buyer

Yellow: Customer Copy

Date

# Summerlin Fence & Feed Inc.

909 U.S. 17-92 South

P.O. Box 981

Davenport, Florida 33836

Ph: 863-422-4537 Fax: 863-422-9579

<b>Town of Dundee</b>	<b>Date:</b> November 28, 2022
	<b>Terms:</b>
	<b>FOB</b>
<b>We are pleased to quote the following</b>	

Lake Marie Park

Install approx. 429' of 4' commercial chain link fence w/1-14' double swing gate.  
Town will be demolishing existing fence.  
Project will be quoted 2 ways, Black and galvanized.

## Materials

2" x 6' SS 40 Line posts  
2 1/2" x 6' SS 40 Terminal posts  
3" x 7' SS 40 Gate posts  
1 5/8" SS 20 Top rail  
6 Ga. Bottom tension wire  
2 x 9 Ga. Galv. Fabric, 2 x 6 Ga. Black vinyl coated Fabric  
All post set in concrete

Estimated Total

Galv. \$9,400.00

~~Black \$12,900.00~~

Quote valid for 30 days or December 28, 2022



● **4ft Tall Galvanized Chainlink (Commercial)**

**4'H Commercial Galvanized Chain-Link**

**Galvanized**

**Features & Benefits**

- Superior Chain Link Specification
- Includes Top Rail & Tension Wire
- Commercial Grade Framework

**Specifications**

- Post: 2" // 2-1/2"
- Rail: 1-5/8" x 21'
- Picket: 9 ga.

o  
o

Choose this package ↓

**Included in the job**

112' Double Gate

427 Linear Feet - Take Down and Haul Away

**Job Notes**

Tear Down Haul Off Cost (\$1200)

No returns for special order products

Today's Price: **4ft Tall Galvanized Chainlink (Commercial)** \$14,630.51

**Choose your payment method**

Pay with ACH/E-Check  
Save **\$219.46**

**\$14,411.05**

Pay with Credit Card

**\$14,630.51**

Contact Sales