

Old Fitzhugh Road: Reimagining the Gateway to Historic Dripping Springs



June 6, 2024 Presentation to the Dripping Springs Historic Preservation Commission
Prepared by McCann Adams Studio for HDR

Agenda

- Old Fitzhugh Road (OFR): Overall Project Update
- Proposed Gateway Concept at the RM 12 Intersection
- Concept Design: Recalling an Historic Native Plant Landscape



Old Fitzhugh Road (OFR): Overall Project Update



DRAFT 90% Design Plan: in-progress

RM 12 & OFR "Gateway"

Proposed Gateway Concept at the RM 12 Intersection

The land on the south side of this RM 12 & OFR intersection is already a gateway to the Dripping Springs Old Fitzhugh Road Historic District and to the Downtown area.

There is an existing "Dripping Springs-Gateway to the Hill Country" sign located at this entry. This sign is not owned by the City and will be replaced by newer, fresher and more appropriate identity signage.

This is a unique opportunity to create an enhanced, inviting place that helps tell the story of Dripping Springs' history, landscapes and preservation by re-imagining this highly-visible entry to the Old Fitzhugh Road historic district.



The Mercer Street Historic District uses limestone flagstone paving, limestone benches, specialty pedestrian street-lighting poles and litter bins to enhance the unique identity of this main street.

Gateway Site: looking south toward Old Fitzhugh Road



Gateway Site: aerial view of existing conditions before parkway construction



Gateway Pollinator Garden Concept Plan

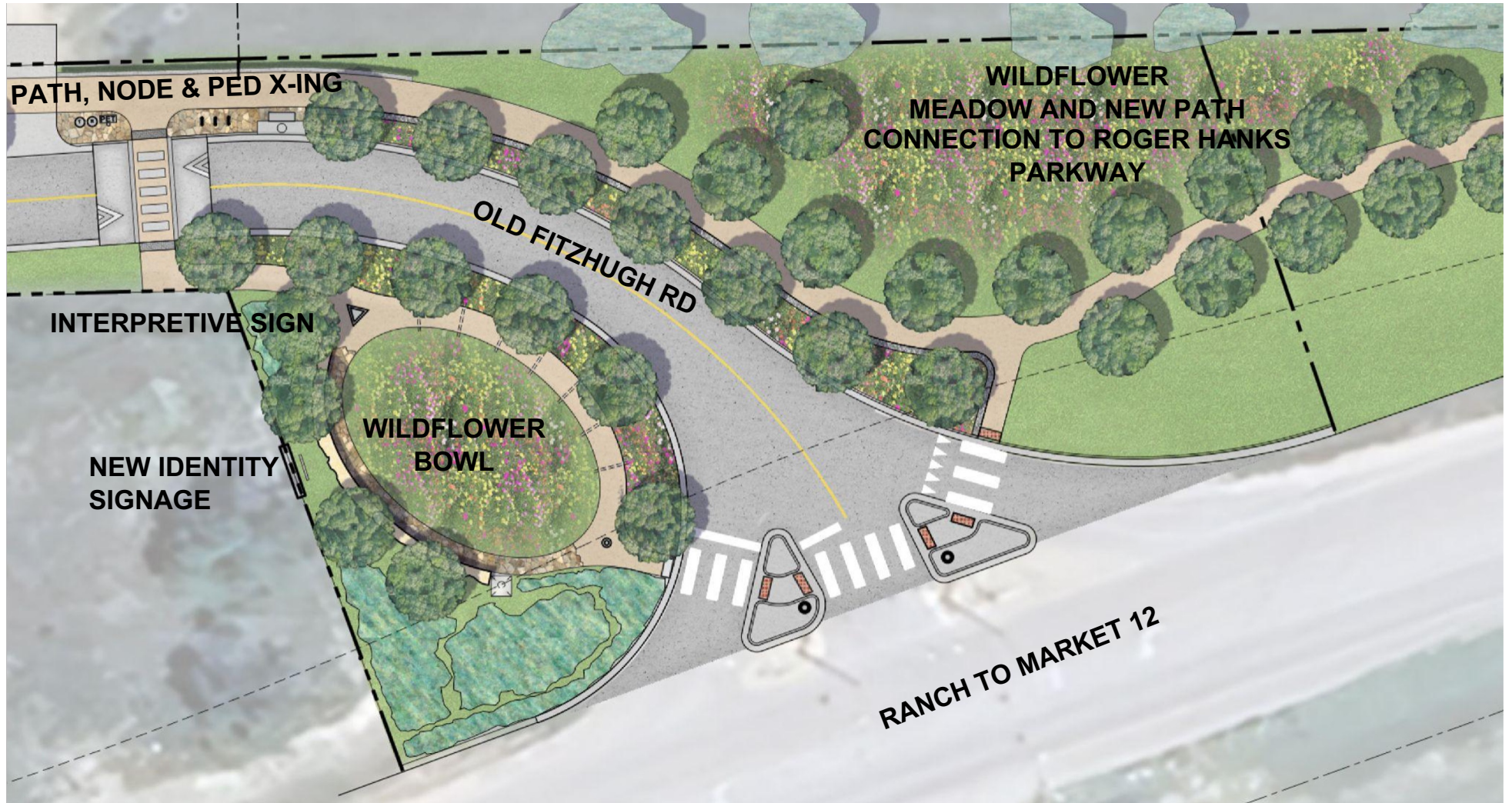

Trees & Hardscape Elements



Limestone picnic table under Hill Country native, the Live Oak



Limestone ledgerrock along flagstone and gravel and pathways

Historic Hill Country Plants



Evergreen and Flameleaf Sumac will shape and buffer the Gateway Garden from the RM 12 traffic.



Autumn color of Flameleaf Sumac

Historic Hill Country Plants



Native wildflower mix for the "Bowl"



Silver Ponyfoot for Curbside Planting Zones

Potential Wayfinding & Interpretive Signage



2-Sided Interpretive Sign Identifying Plant Types, Located along Greenway Trail



3-Sided Historical Interpretive Sign

Gateway Pollinator Garden Concept Rendering

