





LEGEND

-  SIGN
-  TYPE III BARRICADE
-  GRABBER CONE
-  SECURITY BARRIER (MOVABLE)
-  EVENT AREA
-  CREEK CENTERLINE

| SIGN ID | DESCRIPTION | SIZE | QTY |
|---------|---|-----------|-----|
| R11-2 | ROAD CLOSED | 48" X 30" | 10 |
| R11-4 | ROAD CLOSED TO THRU TRAFFIC | 60" X 30" | 4 |
| CW20-3D | ROAD CLOSED AHEAD | 36" X 36" | 2 |
| R3-1 | NO RIGHT TURN | 24" X 24" | 5 |
| R3-2 | NO LEFT TURN | 24" X 24" | 2 |
| R8-3a | NO PARKING | 18" X 24" | 22 |
| | OLD FITZHUGH ROAD | 30" X 9" | 3 |
| | PARADE ENTRANCE SIGN | 30" X 9" | 3 |
| | PORTABLE CHANGEABLE MESSAGE SIGN (PCMS) | | 1 |

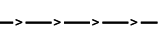
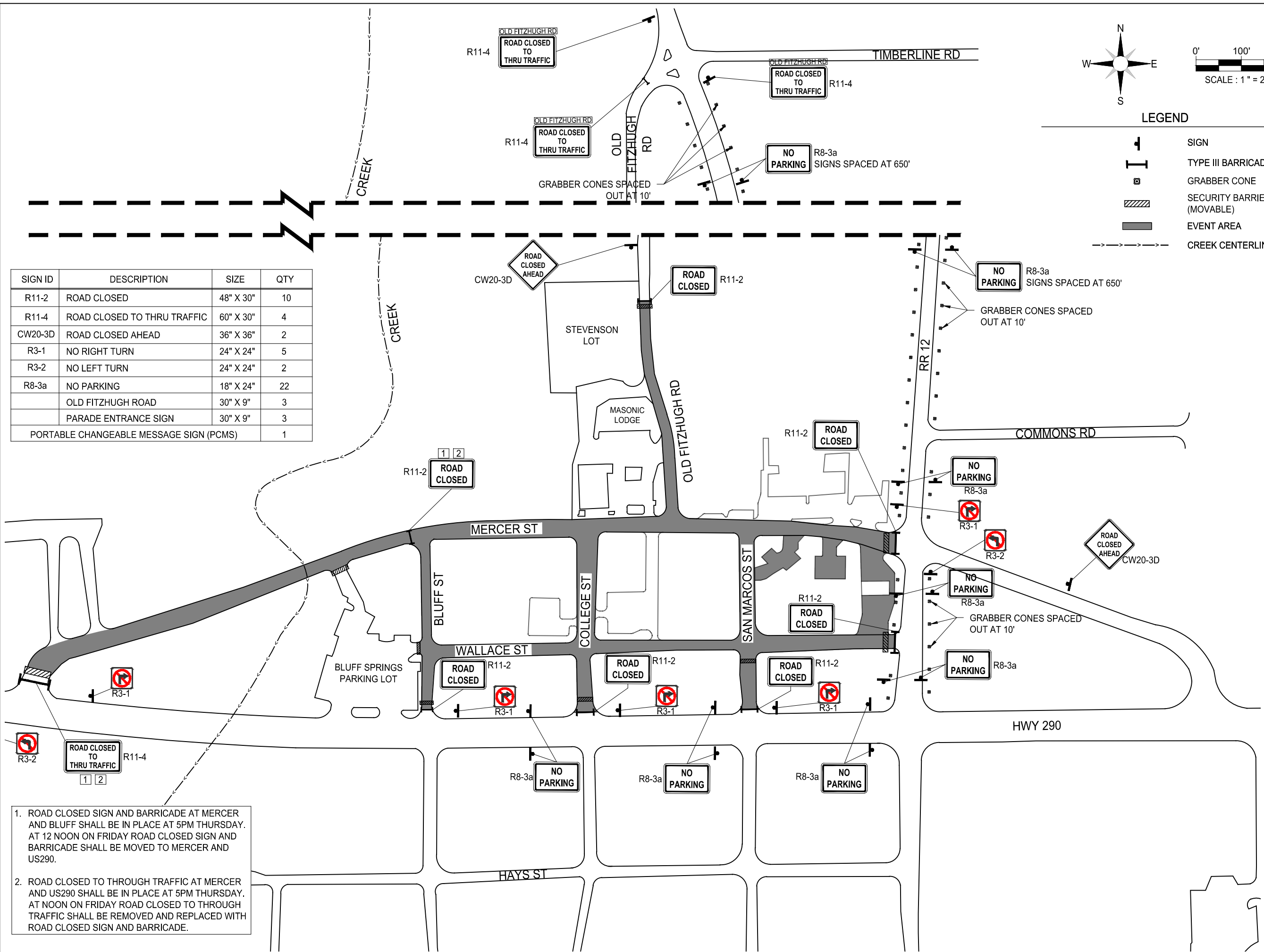

1. ROAD CLOSED SIGN AND BARRICADE AT MERCER AND BLUFF SHALL BE IN PLACE AT 5PM THURSDAY. AT 12 NOON ON FRIDAY ROAD CLOSED SIGN AND BARRICADE SHALL BE MOVED TO MERCER AND US290.
2. ROAD CLOSED TO THROUGH TRAFFIC AT MERCER AND US290 SHALL BE IN PLACE AT 5PM THURSDAY. AT NOON ON FRIDAY ROAD CLOSED TO THROUGH TRAFFIC SHALL BE REMOVED AND REPLACED WITH ROAD CLOSED SIGN AND BARRICADE.

COPYRIGHT NOTICE:
THE DESIGNS REPRESENTED BY THESE PLANS ARE COPYRIGHTED AND ARE SUBJECT TO COPYRIGHT PROTECTION UNDER 17 U.S.C. §101, ET SEQ., AS AMENDED. UNAUTHORIZED USE OF THESE PLANS OR THE DESIGNS REPRESENTED THEREIN WILL SUBJECT THE INFRINGER TO DAMAGES AND/OR JUDICIAL ACTION AS PROVIDED BY FEDERAL LAW.

REVISIONS:

| NO. | REVISION | DATE |
|-----|----------|------|
| | | |
| | | |
| | | |
| | | |
| | | |

DATE: 10/16/2024
DESIGNED BY: DC
CHECKED BY: CG
PROJ #: TCP2025-001



PROJECT:
FOUNDERS DAY FESTIVAL 2025

SHEET TITLE:
TRAFFIC CONTROL PLAN