

Site photos



Existing homestead from Old Fitzhugh Road

Site photos



Existing homestead

Site photos



Existing homestead – propose restoration of original gable roof profile

Site photos



Non-contributing addition to existing homestead, to be removed.

Site photos



Non-contributing addition to existing homestead, to be removed.

Site photos



Existing homestead fireplace to remain

Site photos



View of fireplace from inside existing homestead.
Existing fireplace to remain.



Site photos



Existing garage to be removed.



Existing garage to be removed.

Site photos



Open space adjacent to existing homestead

Site photos



Tree canopy near existing homestead



Site photos



Tree canopy

Site photos



Grass land and open space

Survey of existing conditions



- Contributing historic structure to remain
- Existing structures to be removed

Site development features



1. Non-contributing structure to be removed for entry drive.
2. Drive follows natural clearing so no trees need to be removed for new drive. Re-use of existing curb-cut.
3. Parking lot is designed around existing trees. 74 parking spaces to be provided.
4. Addition to existing structure for ADA restrooms & mechanical equipment.
5. Adaptive reuse of existing homestead
6. Non-contributing addition to be removed
7. Outdoor gathering space.
8. New Restaurant.
9. Old Fitzhugh Trail (shared use path)

Existing structure site plan



1. Existing homestead porch
2. Existing homestead (Event Space)
740 gsf
24' x 30'
3. Addition to existing homestead for
restrooms & mechanical equipment.
500 gsf
16' - 8" x 30'
4. Entry Drive
5. Old Fitzhugh Trail (shared use path)
6. Pathways for nature walk and place
making.
7. Gathering spaces in existing tree canopy.
See reference imagery.

Existing structure massing diagram

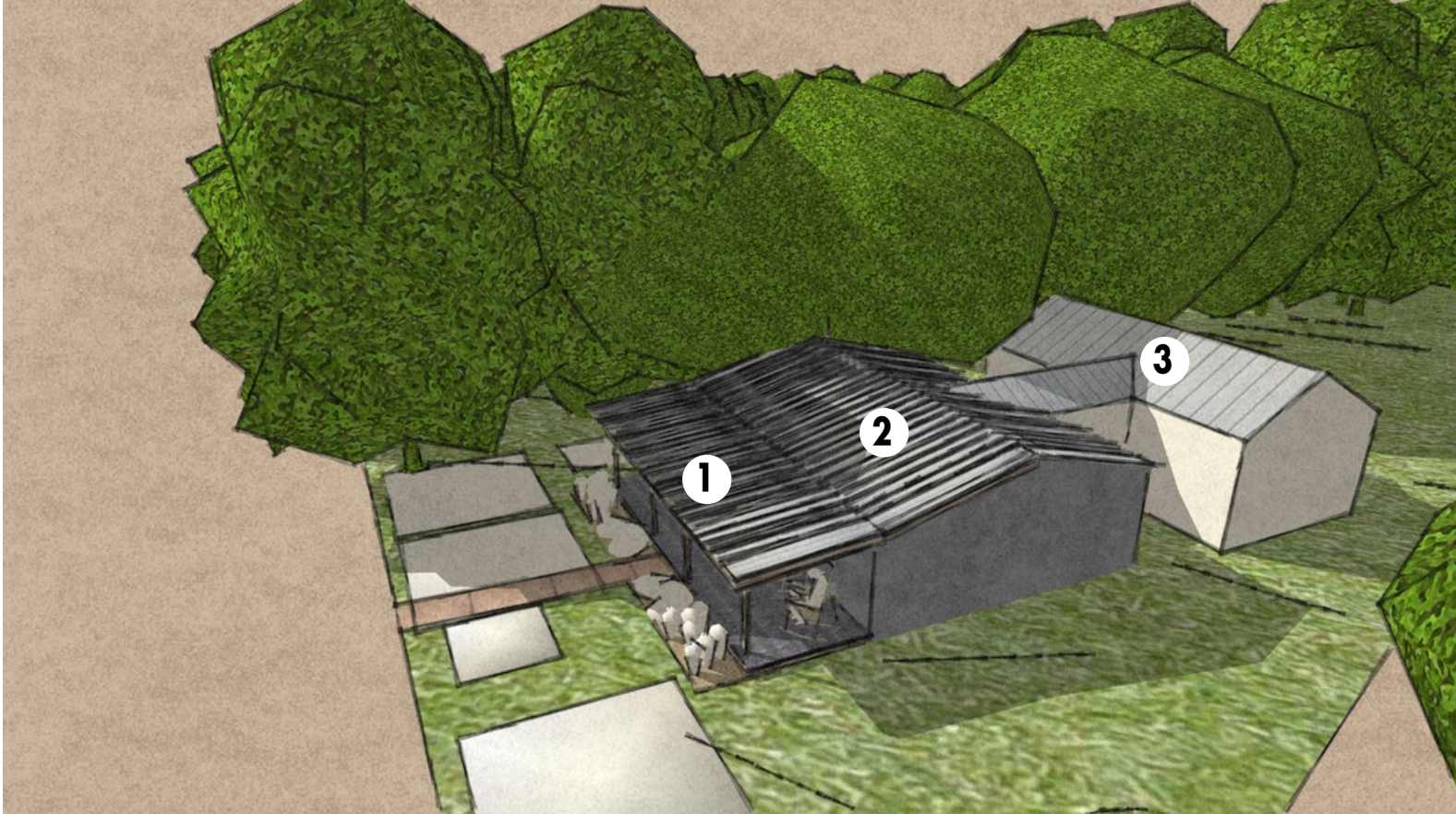

- 1. Existing homestead porch
- 2. Existing homestead (Event Space)
740 gsf
24' x 30'
- 3. Addition to existing homestead for restrooms & mechanical equipment.
500 gsf
16' - 8" x 30'

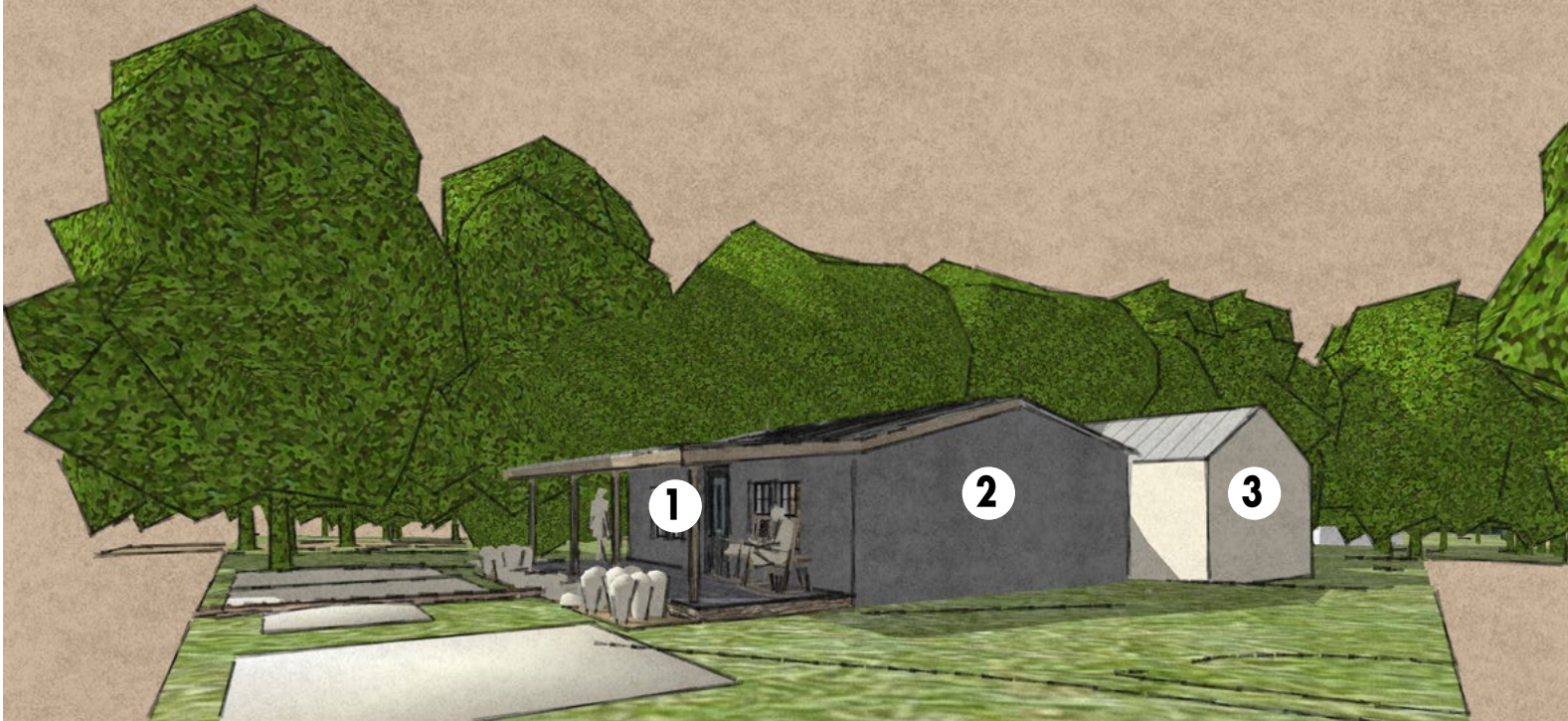

Concept design for reconstruction of existing homestead



Concept design for reconstruction of existing homestead



Concept design for reconstruction of existing homestead



Material board for reconstruction of existing homestead

Reclaimed farmhouse door.



Standing seam metal roof.



Extruded cement tile @ patio



Flagstone at base.



Existing masonry chimney



Cypress framed porch.

New construction site plan



1. Restaurant Entry & Bar Dining
2,160 gsf
36' x 60'
2. Dining room
5,000 gsf
50' x 100'
3. Kitchen & Restrooms
2,500 gsf
50' x 50'
4. Gathering space in existing tree canopy.
See reference imagery.
5. Pathways for nature walk and place making.
6. Outdoor dining & patio space.
7. Landscaped entry and patio.

New construction massing diagram

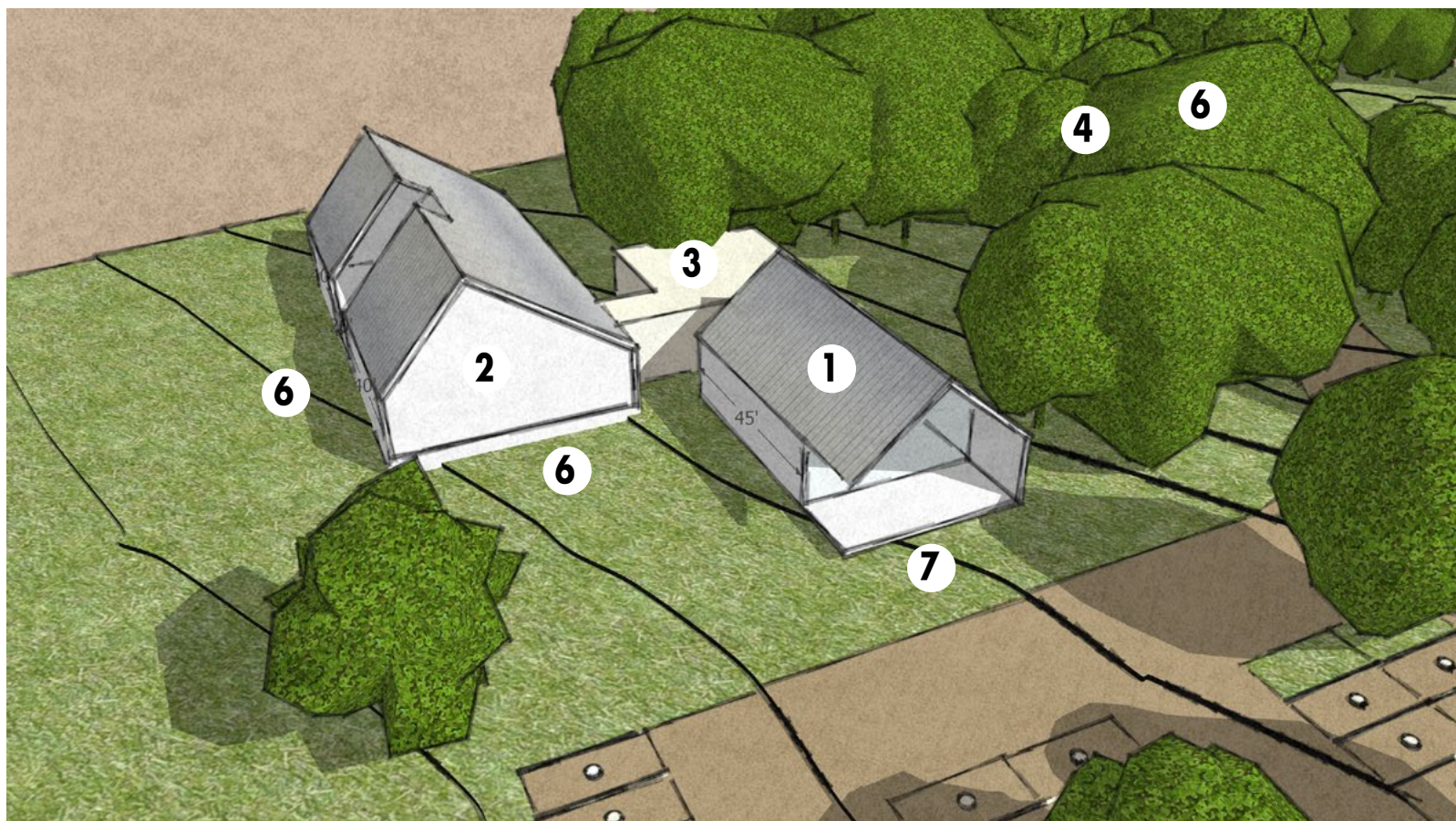
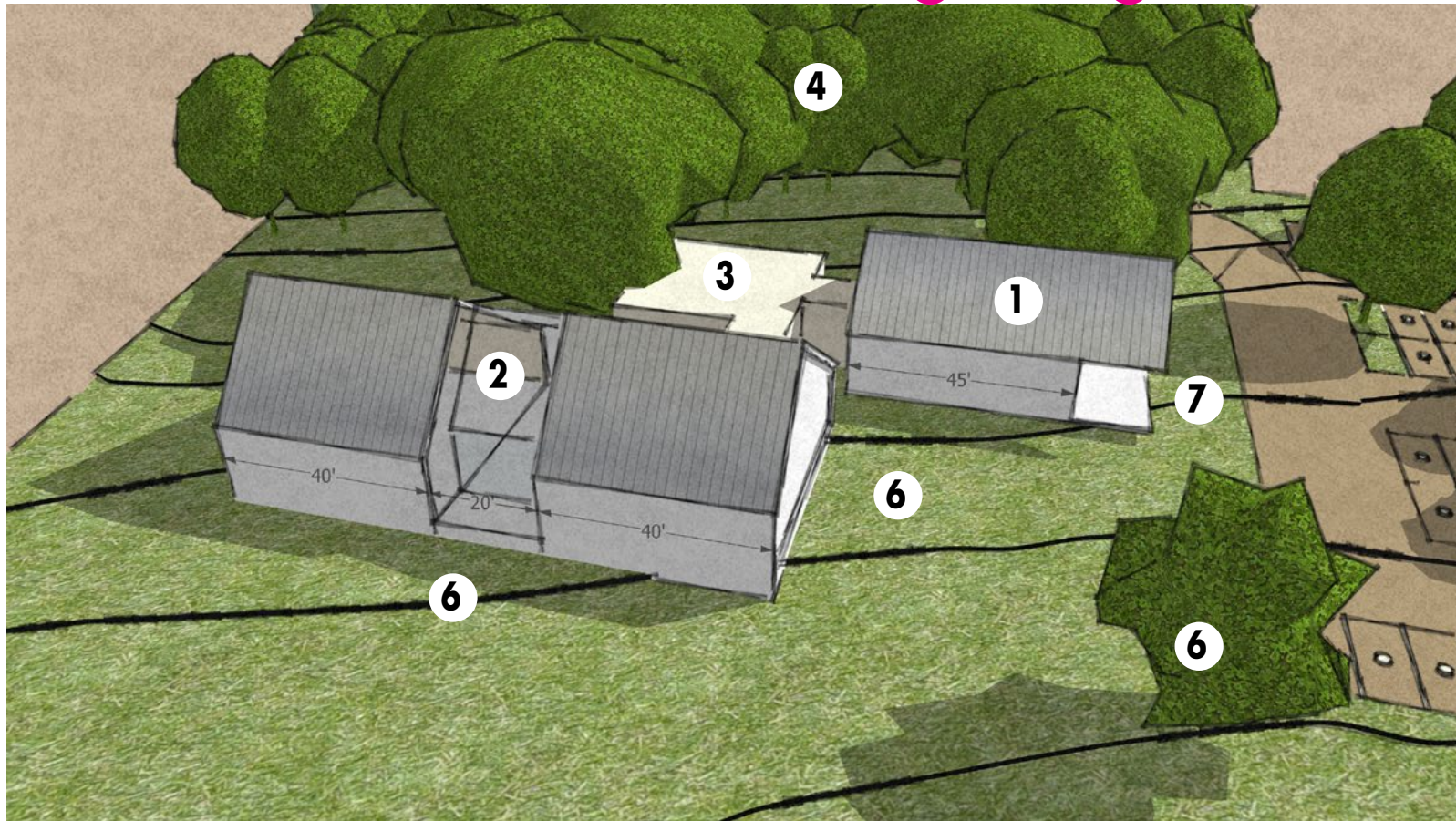

1. Restaurant Entry & Bar Dining
2,160 gsf
36' x 60'
2. Dining room
5,000 gsf
50' x 100'
3. Kitchen & Restrooms
2,500 gsf
50' x 50'
4. Gathering space in existing tree canopy.
See reference imagery.
5. Pathways for nature walk and place making.
6. Outdoor dining & patio space.
7. Landscaped entry and patio.

New construction reference imagery



New construction material palette

Cold rolled steel @ accents Reclaimed wood

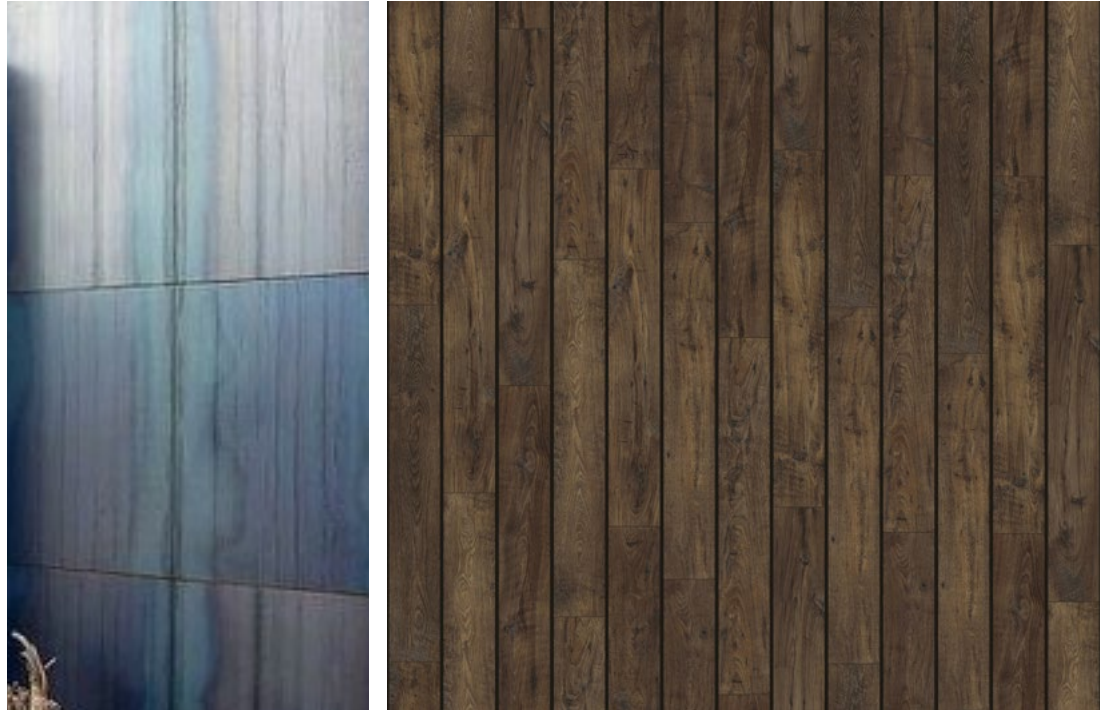

Textured steel panels



Glass



Cypress wood siding & ceilings



Flagstone at base

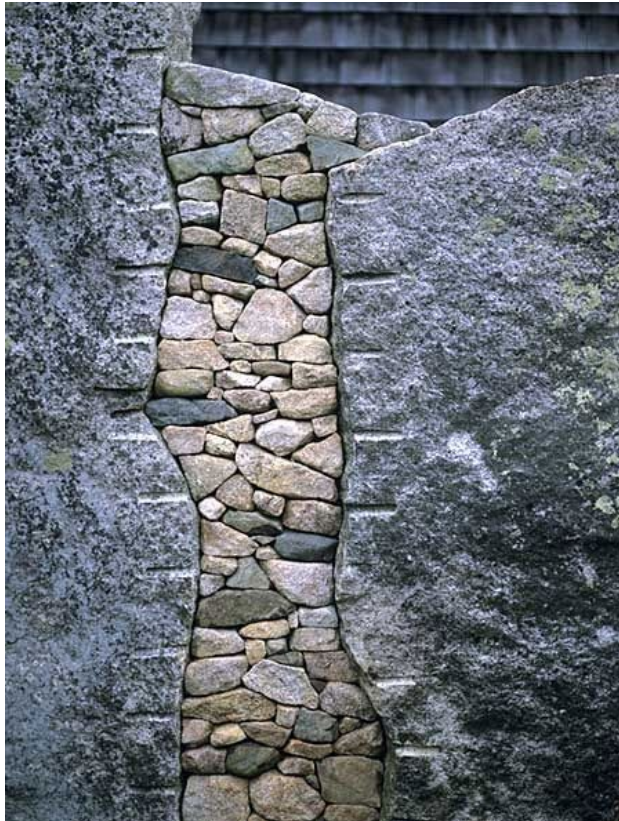

Bespoke masonry details



Rammed earth accent wall

Outdoor gathering spaces



Whimsical follies accentuate the beauty of existing heritage trees on site.



Contrast between organic landscaping and minimal lines help to shape the landscape.

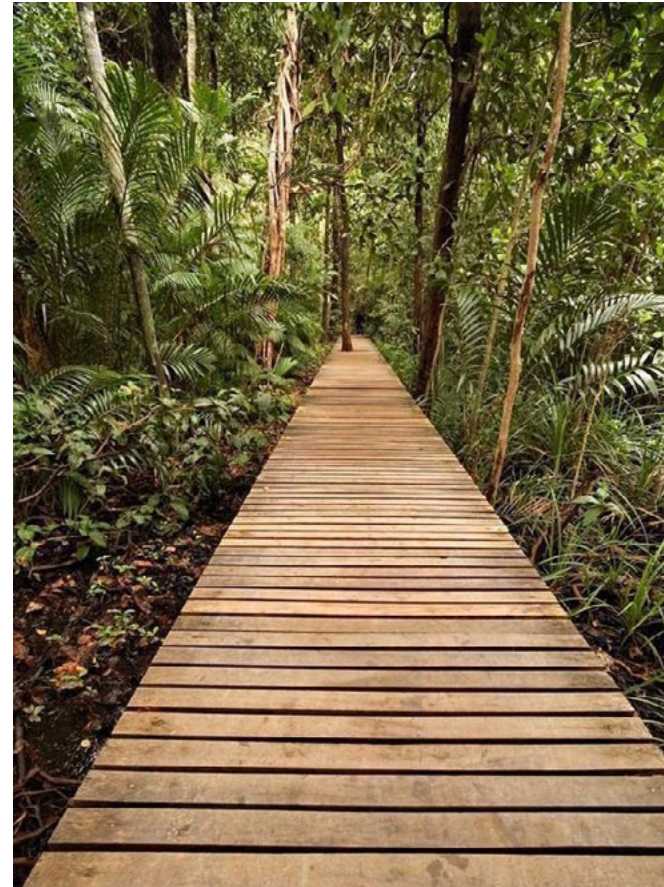

Wooden decks allow pathways to delicately touch the landscape and navigate around the grove of existing mature trees.



Place making within the landscape.