

DETAIL "A"
1" = 10'

1. TREES SHOWN ON HERE, WERE LOCATED ON MONTH XX, 20XX.

PRIOR TO CONSTRUCTION, CONTRACTOR SHALL VERIFY EXISTING UTILITY INVERT, LOCATION AND SIZE AND NOTIFY ENGINEER IMMEDIATELY IF CONCERNS ARISE REGARDING THE HORIZONTAL OR VERTICAL CONFLICTS.

TELECOM KEYED NOTES

- E1 1-1/4 TRANSFORMER REF. MEP PLANS
- E2 1-PULL BOX REF. MEP PLANS
- E3 SECONDARY PULL BOX REF. MEP PLANS

- | | | | |
|---|--|--|--|
| W0 PRIVATE LIFT STATION
8" INV IN=1140.14 | W5 WW CO-B2
8" CLEANOUT
INV=1146.00 | W1 8" 1/8 BEND, M.J. | W6 8"X8" WYE, M.J. |
| W1 WW MH-A1 DROP MANHOLE
TOP=1150.08
8" INV IN (W)=1140.32
8" INV IN (E)=1144.30
8" INV OUT=1140.22 | W9 WW MH-B3
TOP=1153.00
8" INV IN(N)=1146.15
8" INV IN(C)=1145.08
8" INV OUT=1144.98 | W2 8"X8" TEE, M.J.
1-8" GATE VALVE
1-6" VALVE BOX, COMPLETE | W7 8" 1/16 BEND, M.J. |
| W2 WW MH-A2
TOP=1149.95
8" INV IN (N)=1142.91
8" INV IN (W)=1141.09
8" INV OUT=1140.99 | W10 WW CO-B4
8" CLEANOUT
INV=1149.00 | W3 12"X8" TAPPING SLEEVE
±32 LF ~ 8" DI
1-8" GATE VALVE, M.J.
1-6" VALVE BOX, COMPLETE | W8 12"X1.5" TAPPING SADDLE
1-1" COPPER PIPE - CUT AS REQ.
±27 LF ~ 1.5" IRR
1-1.5" GATE VALVE, M.J.
1-6" VALVE BOX, COMPLETE |
| W3 WW MH-A3
TOP=1148.40
8" INV IN=1141.77
8" INV OUT=1141.60 | W11 WW MH-B5
TOP=1154.00
8" INV IN=1146.51
8" INV OUT=1145.60 | W4 1-8"X8" TEE, M.J.
1-8" GATE VALVE, M.J.
1-6" GATE VALVE, M.J.
2-6" VALVE BOX, COMPLETE
1-STD FIRE HYDRANT ASSEMBLY
REF. PLAN SHEET FOR
REQUIRED LF. | W9 8"X2" FIRE FLOW METER |
| W5 WW CO-A5
6" CLEANOUT
INV=1144.00 | W12 WW CO-B4
6" CLEANOUT
INV=1150.00 | W5 8"X8" TEE, M.J.
1-8" GATE VALVE
1-6" VALVE BOX, COMPLETE | W10 1-8" DOUBLE CHECK DETECTOR
ASSEMBLY AND VAULT |
| W6 WW CO-A6
8" CLEANOUT
INV=1146.00 | W13 WW MH-C1
4" INV IN=1154.16
8" INV OUT=1153.82 | | W11 REF. MEP FOR CONTINUATION |
| W7 WW WYE-B1
8"X8" WYE
INV=1144.40 | W14 WW MH-C2
8" INV IN=1153.55
8" INV OUT=1153.45 | | W12 8" 1/32 BEND, M.J. |
| | W15 EXISTING WW MANHOLE
PROP 8" INV IN=1153.42
EXIST 15" INV IN=1152.84
EXIST 15" INV OUT=1152.74 | | |

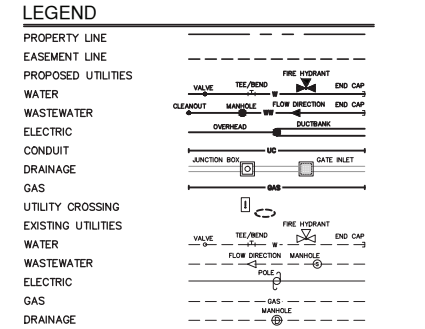
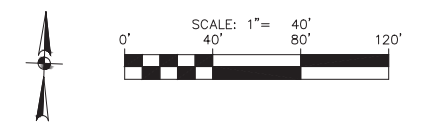

SPORTS PARK ROAD
(60' R.O.W.)

S. ROB SHELTON
BOULEVARD
(60' R.O.W.)

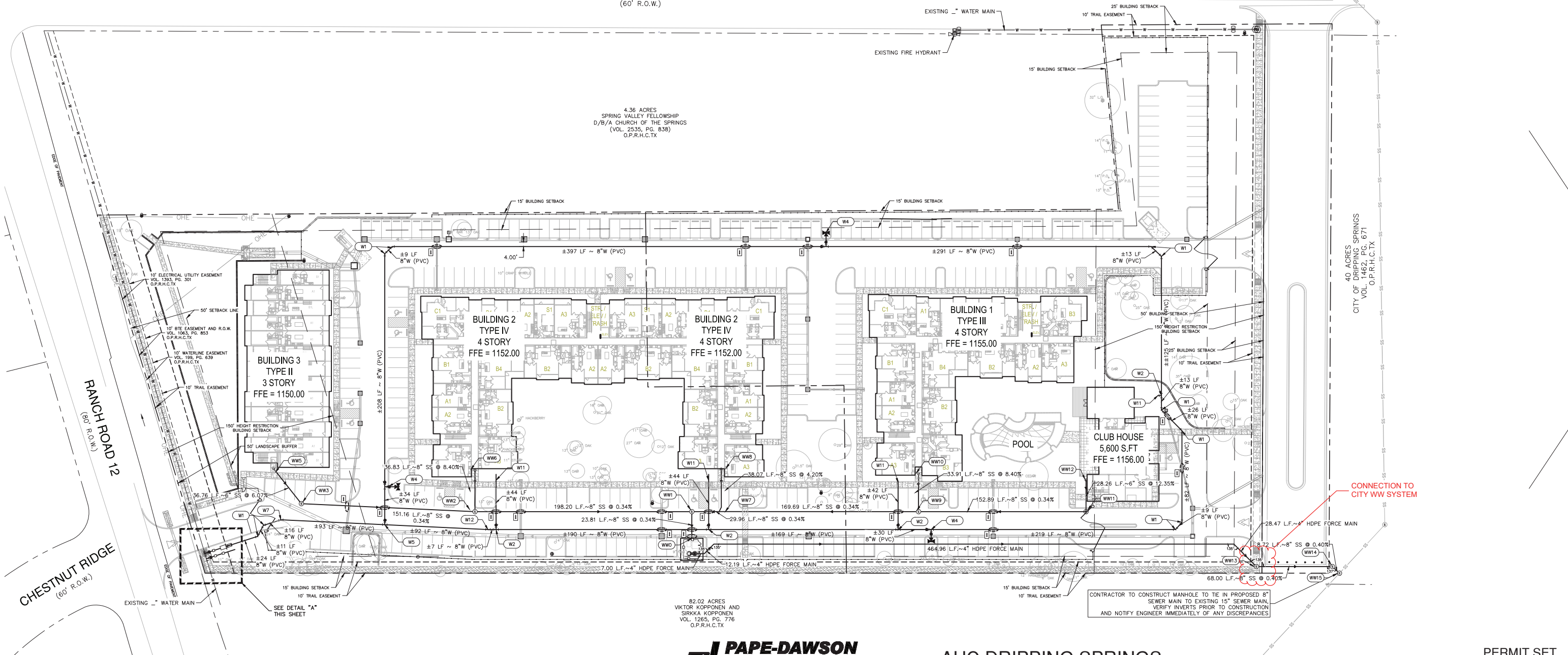

4.38 ACRES
SPRING VALLEY FELLOWSHIP
D/B/A CHURCH OF THE SPRINGS
(VOL. 2535, PG. 838)
O.P.R.H.C.T.X

40 ACRES
CITY OF DRIPPING SPRINGS
VOL. 1462, PG. 671
O.P.R.H.C.T.X

82.02 ACRES
VIKTOR KOPPONEN AND
SIRKKA KOPPONEN
VOL. 1265, PG. 776
O.P.R.H.C.T.X

CONTRACTOR TO CONSTRUCT MANHOLE TO TIE IN PROPOSED 8" SEWER MAIN TO EXISTING 15" SEWER MAIN. VERIFY INVERTS PRIOR TO CONSTRUCTION AND NOTIFY ENGINEER IMMEDIATELY OF ANY DISCREPANCIES

CONNECTION TO CITY WW SYSTEM

Date: May 20, 2021, 6:25am User ID: GManilus
File: H:\Projects\312\312\1\00\Design\Civil\00-5122100.dwg