

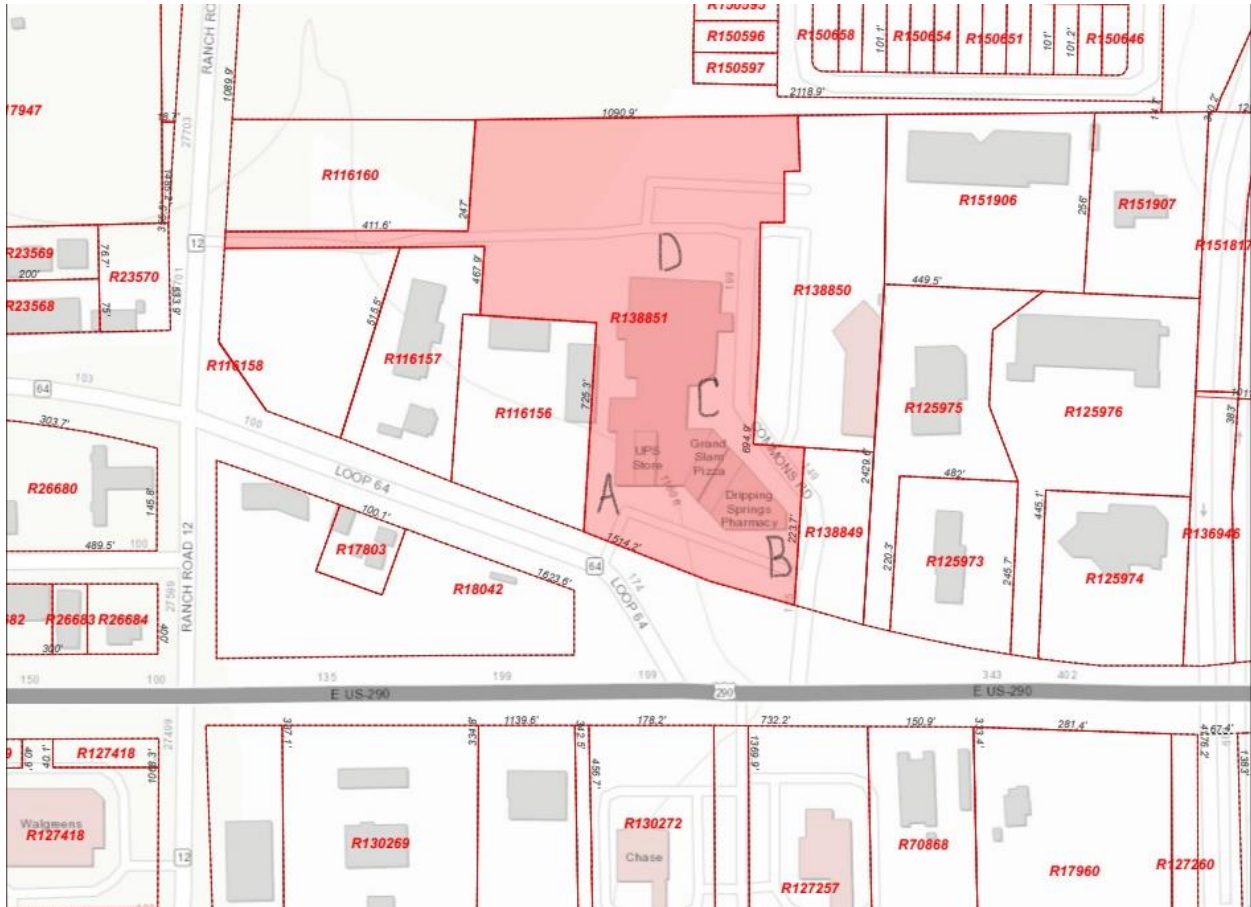

I have broken up the parking into 4 zones that customers/residents may use to utilize the businesses at 100 Commons Rd.



Parking in zoning A is has a total of 19 parking spaces directly in front of Leslie's Pool Supplies, UPS Store, The Sated Sheep, Sharp Fitness, Grand Slam Pizza, and the vacant property (previously Cricket Wireless, proposed Turcotte Butcher and Delicatessen).

The following photos were taken in Zone A









Zone B is directly in front of the entrance to the Dripping Springs Pharmacy and has easy access to the vacant property references before. Zone B has a total of 10 parking spaces directly in front and 15 on the side near the entrance to the Pharmacy





Zone C is directly in front of the Chiropractic Office, The Work Place, and the Hill Country Bible. This area has a total of 55 parking spaces. This zone also fronts the Daycare which is one a separate parcel and has parking on that parcel but some overlap of users may occur.





Parking Zone D is in the back of the property and is the access point to The Goodwill. This zone has roughly 53 parking spaces.

