

Typical Transition Lengths and Suggested Maximum Spacing of Devices

Speed KMPH	Posted Speed MPH	Formula	Minimum Desirable Taper Lengths (L) Meters (Feet)			Suggested Max. Device Spacing		Suggested Sign Spacing Meters (Feet)
			3.0(10) Offset Meters (feet)	3.3(11) Offset Meters (feet)	3.6(12) Offset Meters (feet)	On a taper Meters (feet)	On a tangent Meters (feet)	
50	30	L=WS ² / ₆₀	45 (150)	50 (165)	55 (180)	9 (30)	15-20 (60-75)	40 (120)
			65 (205)	70 (225)	75 (245)	10 (35)	25-25 (70-90)	
			80 (265)	90 (295)	100 (320)	12 (40)	25-30 (80-100)	
55	35	L=WS	135 (450)	150 (495)	165 (540)	13 (45)	25-30 (90-110)	100 (320)
			150 (500)	165 (550)	180 (600)	15 (50)	30-35 (100-125)	
			165 (550)	185 (605)	200 (660)	16 (55)	35-40 (110-140)	
65	40	L=WS	180 (600)	200 (660)	220 (720)	18 (60)	40-45 (120-150)	180 (600)
			195 (650)	215 (715)	235 (780)	19 (65)	40-50 (130-165)	
			215 (700)	235 (770)	255 (840)	21 (70)	45-55 (140-175)	
70	45	L=WS	180 (600)	200 (660)	220 (720)	18 (60)	40-45 (120-150)	180 (600)
			195 (650)	215 (715)	235 (780)	19 (65)	40-50 (130-165)	
			215 (700)	235 (770)	255 (840)	21 (70)	45-55 (140-175)	
80	50	L=WS	180 (600)	200 (660)	220 (720)	18 (60)	40-45 (120-150)	180 (600)
			195 (650)	215 (715)	235 (780)	19 (65)	40-50 (130-165)	
			215 (700)	235 (770)	255 (840)	21 (70)	45-55 (140-175)	
90	55	L=WS	180 (600)	200 (660)	220 (720)	18 (60)	40-45 (120-150)	180 (600)
			195 (650)	215 (715)	235 (780)	19 (65)	40-50 (130-165)	
			215 (700)	235 (770)	255 (840)	21 (70)	45-55 (140-175)	
95	60	L=WS	180 (600)	200 (660)	220 (720)	18 (60)	40-45 (120-150)	180 (600)
			195 (650)	215 (715)	235 (780)	19 (65)	40-50 (130-165)	
			215 (700)	235 (770)	255 (840)	21 (70)	45-55 (140-175)	
105	65	L=WS	180 (600)	200 (660)	220 (720)	18 (60)	40-45 (120-150)	180 (600)
			195 (650)	215 (715)	235 (780)	19 (65)	40-50 (130-165)	
			215 (700)	235 (770)	255 (840)	21 (70)	45-55 (140-175)	
115	70	L=WS	180 (600)	200 (660)	220 (720)	18 (60)	40-45 (120-150)	180 (600)
			195 (650)	215 (715)	235 (780)	19 (65)	40-50 (130-165)	
			215 (700)	235 (770)	255 (840)	21 (70)	45-55 (140-175)	

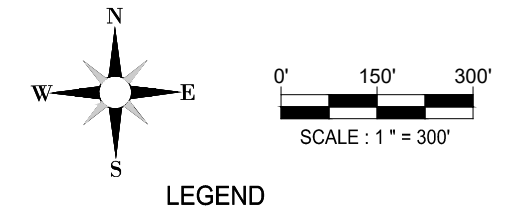

LEGEND

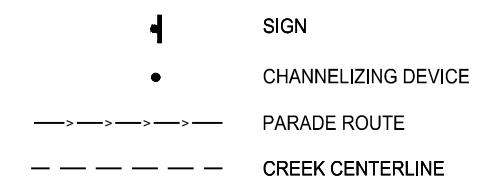

CODE	DESCRIPTION	SIZE	QTY
G20-2	END ROAD WORK	36" X 18"	2
CW20-3A	ROAD CLOSED AHEAD	36" X 36"	1
CW20-5R	RIGHT LANE CLOSED	36" X 36"	2

INFORMATION FROM CITY OF AUSTIN TRAFFIC CONTROL DETAIL 804S-1

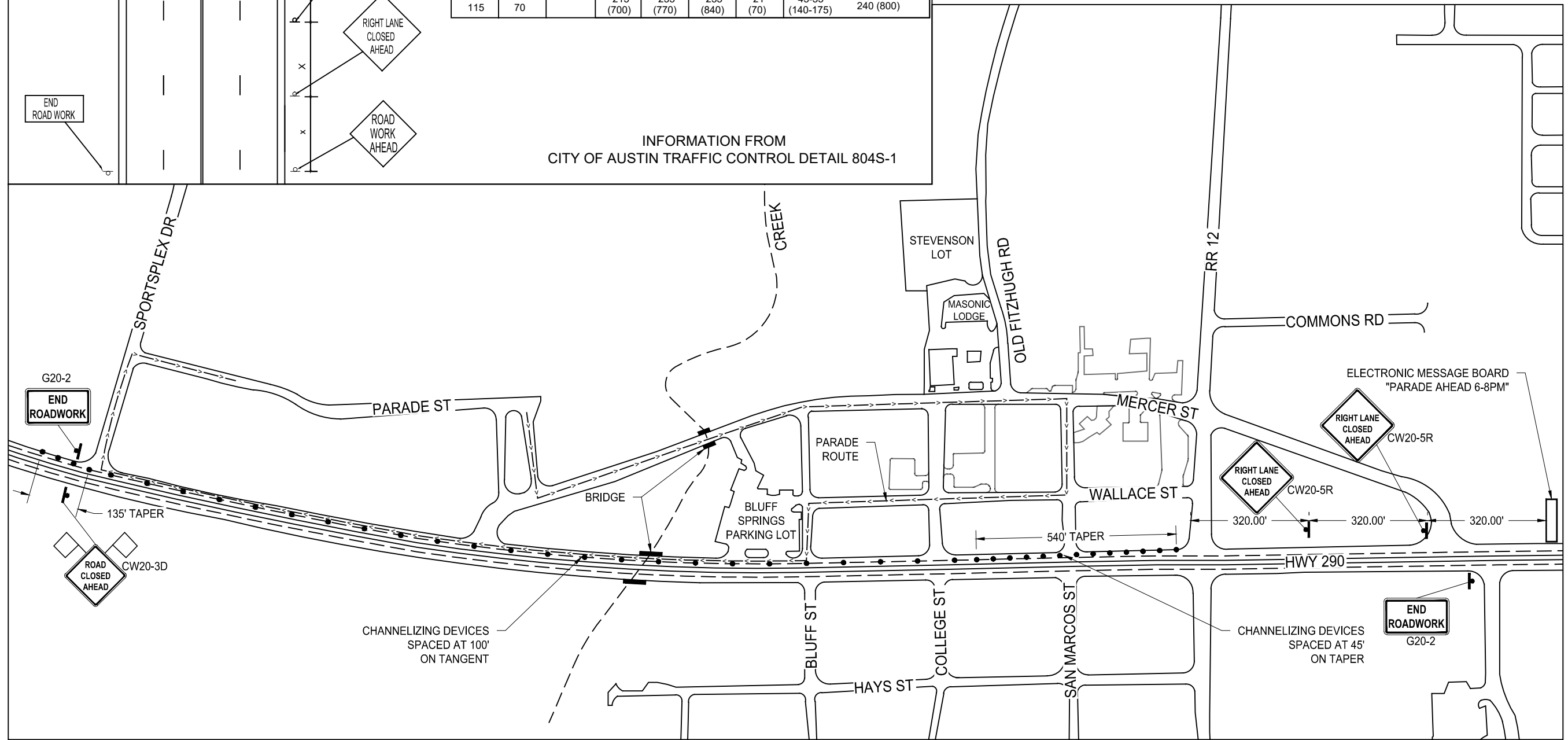

GILPIN
ENGINEERING COMPANY
T.B.P.L.S. Firm Registration # 10193770
T.B.P.E. Firm Registration # F-8266
9701 BRODIE LANE #203
AUSTIN, TX 78748
PH: 512.220.8100

ENGINEER'S SEAL:

CHAD GILPIN
91800
LICENSED PROFESSIONAL ENGINEER
10/16/2024

COPYRIGHT NOTICE:
THE DESIGNS REPRESENTED BY THESE PLANS ARE COPYRIGHTED AND ARE SUBJECT TO COPYRIGHT PROTECTION UNDER 17 U.S.C. §101, ET SEQ., AS AMENDED. UNAUTHORIZED USE OF THESE PLANS OR THE DESIGNS REPRESENTED THEREIN WILL SUBJECT THE INFRINGER TO DAMAGES AND/OR JUDICIAL ACTION AS PROVIDED BY FEDERAL LAW.

REVISIONS:

NO.	REVISION	DATE

DATE: 10/16/2024
DESIGNED BY: DC
CHECKED BY: CG
PROJ #: TCP 2025-001

DIPPING SPRINGS
Texas

PROJECT:
FOUNDERS DAY FESTIVAL 2025

SHEET TITLE:
PARADE ROUTE