

KEY PLAN VIEW
 12680 W US 290
 STE. 230
 AUSTIN, TX 78737 US

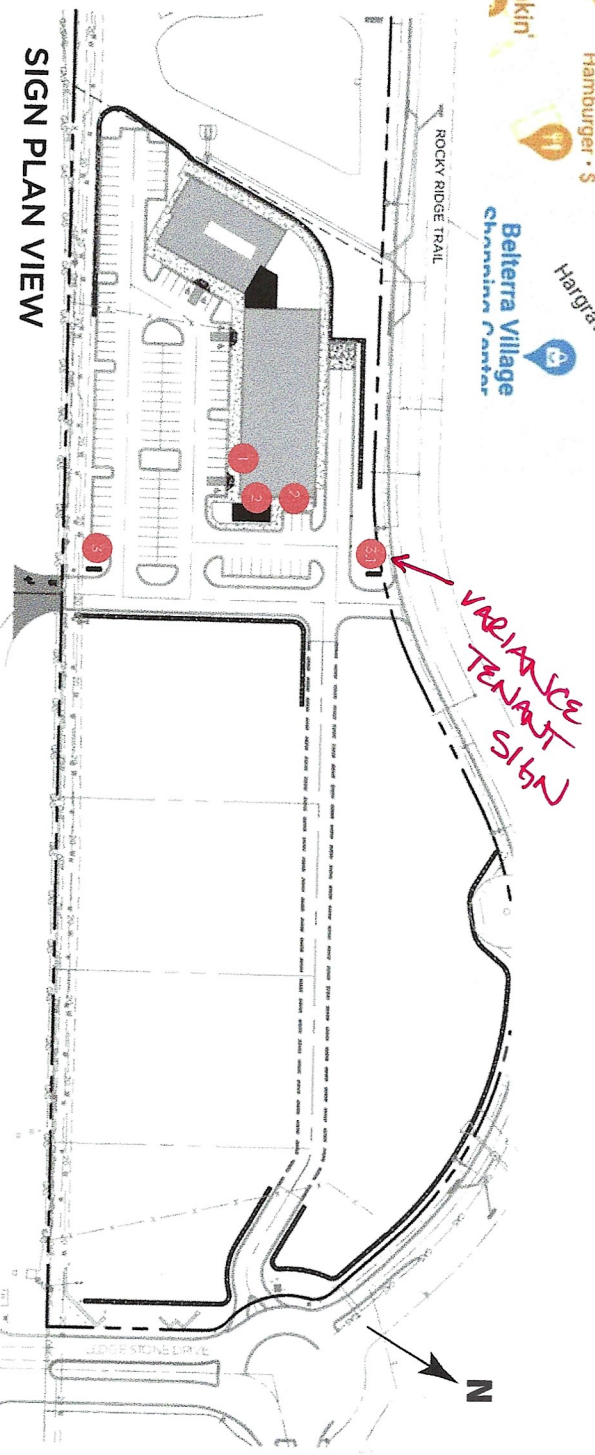

330 Washington Ave
 Caldwell, NJ 0 7072

T 800 203 0301
 F 201 528 0890

e info@vgs-sign.com
 www.vgsonline.com

This drawing and all other drawings are the property of Visual Graphic Systems Inc. The information contained herein is confidential and intended for the use of the client only. It is not to be distributed, copied, or otherwise used without the written consent of Visual Graphic Systems Inc. © 2012 Visual Graphic Systems Inc. All rights reserved. VGS is a registered trademark of Visual Graphic Systems Inc. and VGS is a registered trademark of Visual Graphic Systems Inc. All other trademarks are the property of their respective owners.

Drawn By: OP
 Issue Date: 03.28.2012

APPROVED DRAWINGS must be returned to Visual Graphic Systems Inc. signed & dated by Client (or Authorized Agent), before fabrication will begin.

Signature _____ Date _____

SIGN TYPE 3 AND 3.1 • LEDGE STONE PYLON
PAGE 14



SIGN TYPE 3 AND 3.1 • LAYOUT FRONT VIEW (BACK VIEW IS SIMILAR)

DOUBLE FACE INTERNALLY ILLUMINATED ALUMINUM MULTI-TENANT SIGN CABINET
PAINTED MBGI MIDDNIGHT BRONZE - 2 1/2" DIVIDERS, ROUTED OUT GRAPHICS BACKED WITH
WHITE PLEXI \ 3000 K LED, OUTDOOR LIGHTING ORDINANCE COMPLIANT ILLUMINATION.



330 Washington Ave
Camden, NJ 0 7072

t 800 203 0301
f 201 528 0890

e info@vgs-inc.com
www.vgsonline.com

Notwithstanding to whom these drawings are prepared, the drafter shall be responsible for the accuracy of the information furnished hereon. The drafter shall not be responsible for the accuracy of the information furnished hereon. The drafter shall not be responsible for the accuracy of the information furnished hereon. The drafter shall not be responsible for the accuracy of the information furnished hereon. The drafter shall not be responsible for the accuracy of the information furnished hereon.

Drawn By: OP
Issue Date: 03.28.2012

APPROVED DRAWINGS must be returned to Visual Graphic Systems Inc.
signed & dated by client (or authorized agent) before our section will begin.

Signature: _____ Date: _____

SIGN TYPE 3 AND 3.1 • LEDGE STONE PYLON



LEGE STONE SIGN #3 PERSPECTIVE LOCATION VIEW
NTS



LEGE STONE SIGN #3.1 PERSPECTIVE LOCATION VIEW
NTS



VGS

330 Washington Ave
Carterville, NJ 07072

1 800 203 0301
t 201 528 0890

e info@vgs-sign.com
www.vgsigns.com

These signs are the property of VGS and are not to be reproduced or used in any other way without the written consent of VGS. All rights reserved. © 2022 VGS. All other trademarks and service marks are the property of their respective owners. VGS is not responsible for any damage to property or injury to persons or animals caused by the use of these signs. VGS is not responsible for any damage to property or injury to persons or animals caused by the use of these signs. VGS is not responsible for any damage to property or injury to persons or animals caused by the use of these signs.

Drawn By: OP
Issue Date: 03.29.2022

APPROVED DRAWINGS must be returned to Visual Graphic Systems, Inc., signed & dated by client for additional sign orders before fabrication will begin.

Signature _____ Date _____

SIGN TYPE 3 AND 3.1 • LEDGE STONE PYLON

PAGE 16



1/8" ALUMINUM PANEL WITH ROUTED OUT GRAPHICS
PAINTED FBICI MIDNIGHT BRONZE
BACKED WITH WHITE PLEXI WITH 3M DK.

* DIMENSIONS TO BE VAF



330 Washington Ave
Caldwell, NJ 07072

T 800 203 0301
F 201 528 0880

e info@vgs-sign.com
www.vgsign.com

This drawing is intended for informational purposes only and does not constitute an offer of any product or service. The design and specifications are subject to change without notice. The client is responsible for providing accurate information and for obtaining all necessary permits and approvals. The client is also responsible for ensuring that the sign is properly installed and maintained. VGS Sign Systems, Inc. is not responsible for any damage to property or injury to persons resulting from the use of this drawing or any sign fabricated therefrom. © 2012 VGS Sign Systems, Inc. All rights reserved.

Drawn By: OP
Issue Date: 03.28.2012

APPROVED DRAWING must be returned to Visual Graphic Systems Inc., signed & dated by Client (or Authorized Agent) before fabrication will begin.

Signature _____ Date _____