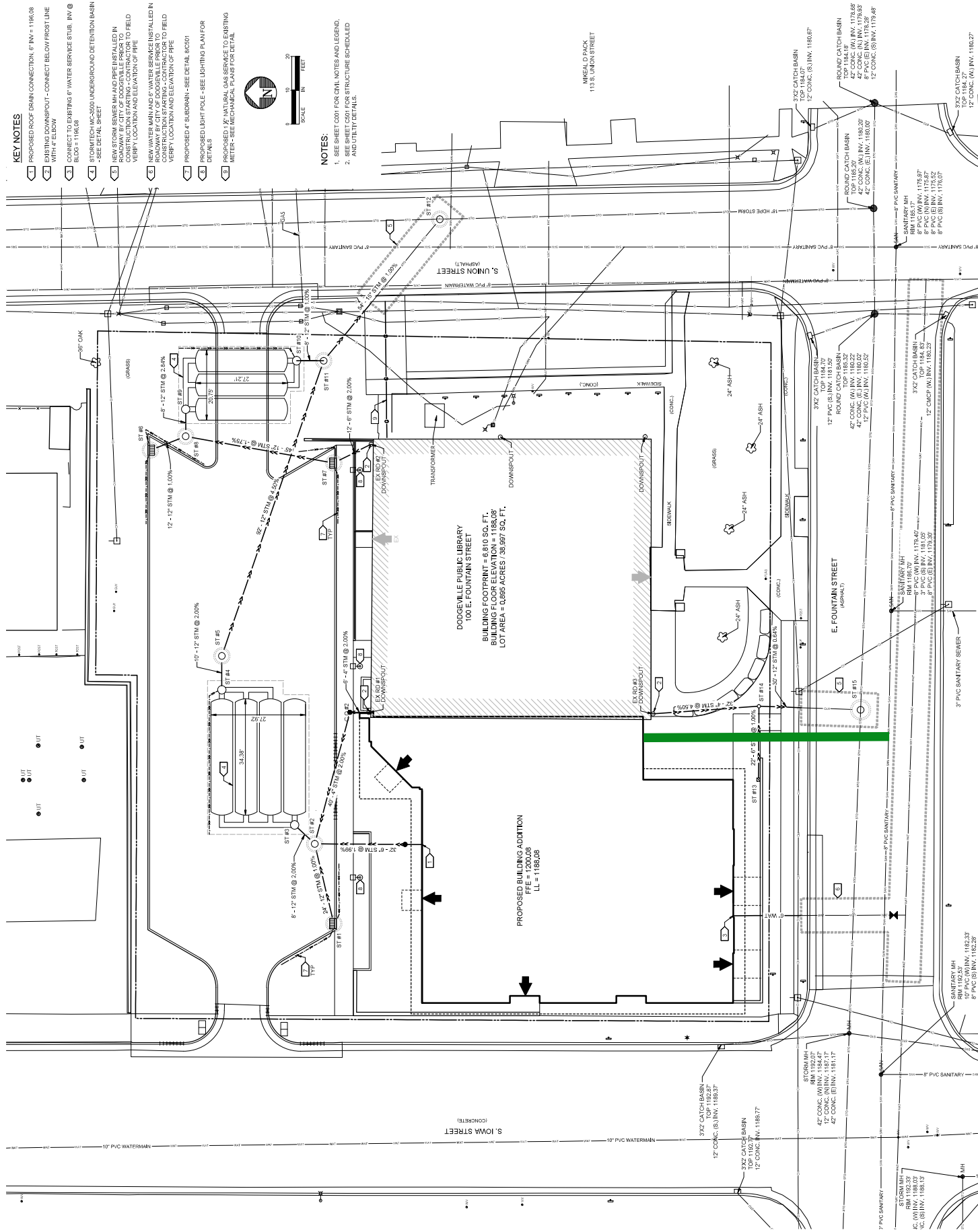

KEY NOTES

- | | |
|---|---|
| 1 | PROPOSED ROOF DRAIN CONNECTION. 6" DIA. x 1'x6.0' |
| 2 | EXISTING DOWNSPOUT - CONNECT BELOW FIRST LINE WITH A FLEWB |
| 3 | CONNECT TO EXISTING 6" WATER SERVICE STUB. 8" DIA. BLOCK x 1'x6.0' |
| 4 | STORMWATER-16"X30" UNDERGROUND DETENTION BASIN. -SEE DETAIL SHEET |
| 5 | NEW 10" CITY MAIN AND PRE-INSTALLED IN ROWWAY BY CITY OF DOUGLASVILLE PRIOR TO CONSTRUCTION STARTING - CONTRACTOR TO FIELD VERIFY LOCATION AND ELEVATION OF PIPE |
| 6 | NEW WATER MAIN AND 6" WATER SERVICE INSTALLED IN ROWWAY BY CITY OF DOUGLASVILLE PRIOR TO CONSTRUCTION STARTING - CONTRACTOR TO FIELD VERIFY LOCATION AND ELEVATION OF THE |
| 7 | PROPOSED 6" SUBDRAIN - SEE DETAIL 8/2001 |
| 8 | PROPOSED LIGHT POLE - SEE LIGHTING PLAN FOR DETAILS |
| 9 | PROPOSED 1/2" NATURAL GAS SERVICE TO EXISTING |

NOTES:

- SEE SHEET C001 FOR CIVIL NOTES AND LEGEND.
SEE SHEET C501 FOR STRUCTURE SCHEDULED
AND UTILITY DETAILS.

[illegible]

WGA NO: 3757-004-00

**SITE UTILITY
PLAN**

DATE: MARCH 21, 2025

CONSTRUCTION DOCUMENTS

C500

Copyright © 2007 by Green and Abrahamson, Inc.