

REVISED: MAY 14, 2001



244092

244092

Final Plat of the First Addition to Greater Heights Subdivision

Located in the Southwest One-quarter of the Southeast One-quarter of Section 22,
Township 6 North, Range 3 East, Town of Dodgeville, Iowa County, Wisconsin.

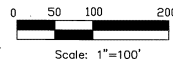

North
Beaching on reference to
the west line of the SE 1/4
of Section 22, Recorded as
N00°32'08" W
110.32' 0.00'

Greater Heights
Subdivision

BROWNS STREET

CITY OF DODGEVILLE

BROWNS

U.S. ARMY

BEA ANN DRIVE

UNPLATTED LANDS
BY OWNER

TOWN OF DODGEVILLE

UNPLATTED LANDS
BY OWNER

UNPLATTED LANDS

LEGEND

- 1-1/4"x30" Iron Rebar (Wt. 4.30 lb/ft) set
- Found 1-1/4" iron rod
- ◇ Found 1" iron pipe
- All other lot corners marked with
3/4" x 24" iron rod (wt. = 1.502 lb./lin. ft.)
set
- * Indicates Storm Sewer Easement

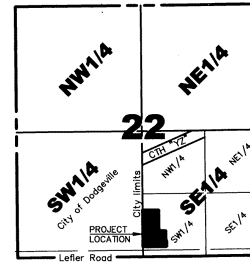

PROJECT LOCATION

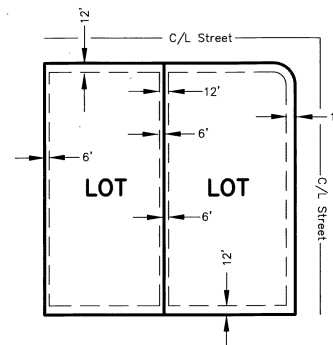

TYPICAL PUBLIC UTILITY EASEMENTS

LINE TABLE

LINE	BEARING	DISTANCE
L1	S89°30'45" W	24.02'
L2	N00°33'07" W	30.50'

CURVE TABLE

Curve	Lot	Central Angle	Radius	Arc length	Chord Length	Chord Bearing	Tangent Bearing
Curve1		41°48'18"	83.00'	60.56'	59.23'	S21°26'54"E	N00°32'45"W
							N42°21'03"W
Curve2		89°56'08"	83.00'	130.28'	117.31'	N45°31'11"W	S89°30'45"W
							N00°33'07"W
	39	26°33'40"	83.00'	38.48'	38.13'	S13°49'57"E	
	40	36°46'39"	83.00'	53.28'	52.37'	S45°30'06.5"E	
	41	26°35'49"	83.00'	38.53'	38.18'	S77°11'20.5"E	
Curve3		89°56'30"	17.00'	26.69'	24.03'	N45°31'00"W	N00°32'45"W
							S89°30'45"W
Curve4		89°55'36"	17.00'	26.68'	24.03'	N45°30'55"W	S89°31'17"W
							N00°33'07"W
Curve5		89°56'08"	17.00'	26.68'	24.03'	N45°31'11"W	S89°30'45"W
							N00°33'07"W
Curve6		90°04'24"	17.00'	26.73'	24.06'	N44°29'05"E	N89°31'17"E
							S89°30'45"W
Curve7		48°08'12"	83.00'	69.72'	67.69'	N66°25'09"W	N42°21'03"W
							S89°30'45"W
Curve8		89°56'30"	50.00'	78.48'	70.67'	N45°31'00"W	N00°32'45"W
							S89°30'45"W
Curve9		89°56'08"	50.00'	78.48'	70.67'	N45°31'11"W	S89°30'45"W
							N00°33'07"W

Survey for:
Greater Heights, Inc.
c/o Cory Berg
Dodgeville, WI 53533
Ph. (608)935-2345

Survey by:
Theodore J. Greenheck
Jewell & Associates, Inc.
P.O. Box 718
156 W. Jefferson St.
Spring Green, WI 53588

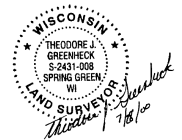

JEWELL & ASSOC., INC.
ENGINEERS-SURVEYORS-ARCHITECTS
156 W. JEFFERSON ST. - SPRING GREEN, WI 53588

REVISED: JULY 28, 2000

SHEET 1 OF 2

244092

Final Plat of the First Addition to Greater Heights Subdivision

Located in the Southwest One-quarter of the Southeast One-quarter of Section 22,
Township 6 North, Range 3 East, Iowa County, Town of Dodgeville, Wisconsin.

SURVEYOR'S CERTIFICATE

I, THEODORE J. GREENHECK, REGISTERED WISCONSIN LAND SURVEYOR, DO HEREBY CERTIFY: THAT IN FULL COMPLIANCE WITH THE PROVISIONS OF CHAPTER 236 OF THE WISCONSIN STATUTES AND THE SUBDIVISION REGULATIONS OF THE CITY OF DODGEVILLE, AND UNDER THE DIRECTION OF KENNETH BERG, PRESIDENT OF GREATER HEIGHTS, INC., OWNERS OF SAID LAND, I HAVE SURVEYED, DIVIDED, AND MAPPED "THE FIRST ADDITION TO GREATER HEIGHTS SUBDIVISION"; THAT SUCH PLAT CORRECTLY REPRESENTS ALL EXTERIOR BOUNDARIES AND THE SUBDIVISION OF THE LAND SURVEYED; AND THAT THIS LAND IS LOCATED IN THE SOUTHWEST ONE-QUARTER OF THE SOUTHEAST ONE-QUARTER OF SECTION TWENTY-TWO, TOWNSHIP SIX NORTH, RANGE THREE EAST, TOWN OF DODGEVILLE, IOWA COUNTY, WISCONSIN, CONTAINING 7.18 ACRES OF LAND AND DESCRIBED AS FOLLOWS:

COMMENCING AT THE SOUTH ONE-QUARTER CORNER OF SAID SECTION TWENTY-TWO;
THENCE NORTH 00°32'06" WEST 208.00 FEET ALONG THE WEST LINE OF THE SOUTHEAST ONE-QUARTER OF SAID SECTION TWENTY-TWO TO THE POINT OF BEGINNING;
THENCE CONTINUING ALONG SAID WEST LINE NORTH 00°32'06" WEST 773.20 FEET;
THENCE NORTH 89°27'07" EAST 338.80 FEET;
THENCE SOUTH 00°33'31" EAST 437.67 FEET;
THENCE NORTH 89°31'17" EAST 142.97 FEET;
THENCE SOUTH 00°32'45" EAST 177.57 FEET;
THENCE SOUTHEASTERLY ALONG THE ARC OF A CURVE TO THE RIGHT WHICH HAS A RADIUS OF 83.00 FEET, A CENTRAL ANGLE OF 41°48'18", AND A CHORD BEARING SOUTH 21°28'54" EAST 58.23 FEET;
THENCE SOUTH 00°32'48" EAST 102.36 FEET;
THENCE SOUTH 89°26'29" WEST 503.14 FEET TO THE POINT OF BEGINNING;

DATED THIS 28th DAY OF July, 2000

REVISED: MAY 14, 2001

Theodore J. Greenheck
THEODORE J. GREENHECK,
REGISTERED LAND SURVEYOR, S-2431



CORPORATE OWNER'S CERTIFICATE OF DEDICATION

GREATER HEIGHTS, INC., A CORPORATION DULY ORGANIZED AND EXISTING UNDER AND BY VIRTUE OF THE LAWS OF THE STATE OF WISCONSIN, AS OWNER, DOES HEREBY CERTIFY THAT SAID CORPORATION CAUSED THE LAND DESCRIBED ON THIS PLAT TO BE SURVEYED, DIVIDED, MAPPED, AND DEDICATED AS REPRESENTED ON THIS PLAT.
GREATER HEIGHTS, INC., DOES FURTHER CERTIFY THAT THIS PLAT IS REQUIRED BY S.236.10 OR S.236.12 TO BE SUBMITTED TO THE FOLLOWING FOR APPROVAL OR OBJECTION:

WISCONSIN DEPARTMENT OF ADMINISTRATION
CITY OF DODGEVILLE
TOWN OF DODGEVILLE
IOWA COUNTY

IN WITNESS WHEREOF, THE SAID GREATER HEIGHTS, INC., HAS CAUSED THESE PRESENTS TO BE SIGNED BY KENNETH BERG, ITS PRESIDENT, AND COUNTERSIGNED BY CORY BERG, ITS VICE PRESIDENT, AT DODGEVILLE WISCONSIN, AND ITS CORPORATE SEAL TO BE HEREUNTO AFFIXED ON THIS 19th DAY OF October, 2000.

IN THE PRESENCE OF:

GREATER HEIGHTS

Kenneth Berg
KENNETH BERG, PRESIDENT

Cory Berg
CORY BERG, VICE PRESIDENT

(CORPORATE SEAL)

RECORDED
Dodgeville WI 53533

JUL 19 2001

11:30
David E. Eide
DAVID EIDE, Iowa Co. Register of Deeds

STATE OF WISCONSIN)
IOWA COUNTY)SS

PERSONALLY CAME BEFORE ME THIS 19th DAY OF October, 2000, KENNETH BERG, PRESIDENT, AND CORY BERG VICE PRESIDENT OF THE ABOVE NAMED CORPORATION, TO ME KNOWN TO BE THE PERSONS WHO EXECUTED THE FOREGOING INSTRUMENT, AND TO ME KNOWN TO BE SUCH PRESIDENT AND VICE PRESIDENT OF SAID CORPORATION, AND ACKNOWLEDGED THAT THEY EXECUTED THE FOREGOING INSTRUMENT AS SUCH OFFICERS AS THE DEED OF SAID CORPORATION, BY ITS AUTHORITY.

NOTARY SEAL Lawrence M. Poth NOTARY PUBLIC, Iowa County, WISCONSIN
MY COMMISSION EXPIRES 13 June 2004

There are no objections to this plat with respect to
Secs. 236.15, 236.16, 236.20 and 236.21 (1) and (2),
Wis. Stats.

Certified August 17th, 2000
David M. Dowling
Department of Administration

TOWN OF DODGEVILLE APPROVAL CERTIFICATE

RESOLVED THAT THE PLAT OF THE FIRST ADDITION TO GREATER HEIGHTS SUBDIVISION LOCATED IN THE TOWN OF DODGEVILLE, IOWA COUNTY, WISCONSIN, IS HEREBY APPROVED AS REQUIRED BY CHAPTER 236 OF THE WISCONSIN STATUTES, AND THE REQUIREMENTS OF THE TOWN OF DODGEVILLE, IOWA COUNTY, WISCONSIN, IS HEREBY APPROVED BY THE TOWN BOARD.

I, BARBARA LEY, CLERK FOR THE TOWN OF DODGEVILLE, IOWA COUNTY, WISCONSIN, HEREBY CERTIFY THAT THE FOREGOING IS A COPY OF A RESOLUTION ADOPTED BY THE TOWN BOARD OF THE TOWN OF DODGEVILLE.

Barbara Ley
BARBARA LEY, CLERK, TOWN OF DODGEVILLE

RESOLUTION OF THE COMMON COUNCIL, CITY OF DODGEVILLE

I, CHERYL MENON, BEING THE DULY APPOINTED, QUALIFIED, AND ACTING CLERK OF THE CITY OF DODGEVILLE, IOWA COUNTY, WISCONSIN, DO HEREBY CERTIFY THAT THE COMMON COUNCIL OF THE CITY OF DODGEVILLE PASSED RESOLUTION NUMBER 4-10 ON THIS 3rd DAY OF November, 2000 AUTHORIZING ME TO ISSUE A CERTIFICATE OF APPROVAL OF THE FINAL PLAT OF THE FIRST ADDITION TO GREATER HEIGHTS SUBDIVISION, GREATER HEIGHTS, INC., OWNER, UPON SATISFACTION OF CERTAIN CONDITIONS, AND I HEREBY CERTIFY THAT ALL CONDITIONS WERE SATISFIED AND THE APPROVAL WAS GRANTED AND EFFECTIVE ON THE 8th DAY OF November, 2000.

DATED 11-8-2000

Cheryl Menon
CHERYL MENON, CLERK, CITY OF DODGEVILLE

CERTIFICATE OF IOWA COUNTY ZONING AND PLANNING

STATE OF WISCONSIN)
IOWA COUNTY)SS

RESOLVED THAT THE PLAT OF THE FIRST ADDITION TO GREATER HEIGHTS SUBDIVISION IN THE TOWN OF DODGEVILLE, BE AND IS HEREBY APPROVED IN COMPLIANCE WITH CHAPTER 236 OF THE WISCONSIN STATUTES, AND THE IOWA COUNTY ZONING AND SUBDIVISION REGULATIONS.

I HEREBY CERTIFY THAT THE FOREGOING IS A TRUE AND CORRECT COPY OF A RESOLUTION ADOPTED BY THE IOWA COUNTY ZONING AND PLANNING COMMISSION COMMITTEE, AND MADE EFFECTIVE ON THIS 22 DAY OF August, 2000.

DATED 6/29/01

Scott Godfrey
SCOTT GODFREY, IOWA COUNTY ZONING ADMINISTRATOR

TOWN OF DODGEVILLE TREASURER'S CERTIFICATE

STATE OF WISCONSIN)
IOWA COUNTY)SS

I, BARBARA LEY, BEING THE DULY ELECTED, QUALIFIED, AND ACTING TREASURER OF THE TOWN OF DODGEVILLE, DO HEREBY CERTIFY THAT IN ACCORDANCE WITH THE RECORDS IN MY OFFICE, THERE ARE NO UNPAID TAXES OR UNPAID SPECIAL ASSESSMENTS AS OF JUNE 30, 2001 (DATE) ON ANY OF THE LAND INCLUDED IN THE PLAT OF THE FIRST ADDITION TO GREATER HEIGHTS SUBDIVISION.

6/30/01
(DATE)

Barbara Ley
BARBARA LEY, TOWN OF DODGEVILLE TREASURER

IOWA COUNTY TREASURER'S CERTIFICATE

STATE OF WISCONSIN)
IOWA COUNTY)SS

I, JOLENE MILLARD, BEING THE DULY ELECTED, QUALIFIED, AND ACTING TREASURER OF IOWA COUNTY, DO HEREBY CERTIFY THAT IN ACCORDANCE WITH THE RECORDS IN MY OFFICE, THERE ARE NO UNPAID TAXES OR UNPAID SPECIAL ASSESSMENTS AS OF 7-3-2001 ON ANY OF THE LAND INCLUDED IN THE PLAT OF THE FIRST ADDITION TO GREATER HEIGHTS SUBDIVISION.

7-3-2001
(DATE)

Jolene M. Millard
JOLENE MILLARD, IOWA COUNTY TREASURER

JEWELL & ASSOC., INC.
ENGINEERS-SURVEYORS-ARCHITECTS
156 W. JEFFERSON ST. - SPRING GREEN, WI 53588