

1918 Neva Road, PO Box 267
Antigo, WI 54409
800.686.6886 or 715.623.7454
fax: 715.627.7504



dan@pomasl.com
kevin@pomasl.com
www.pomasl.com

June 26, 2023

Dodgeville Area Ambulance
300 W. Spring Street
Dodgeville, WI 53533

Dear Brian,

We are proud to present our **quotation** to **upfit your 2023 F250 truck** for your department. The F250 truck would be supplied by your department and delivered to our office unless other arrangements would be made.

The following items would be supplied by and installed by Pomasl Fire Equipment:

Ranch Hand model PBF201BL1 full height center bull bar including shipping and installation.

- We have installed several Ranch Hand full bumper / grill guar replacements and these are well made and durable.



Amber LED fog lights will be supplied and installed – location to be determined after the bull bar is installed.

Gamber Johnson wide cab console with armrest and cupholders will be installed including the following:

- Gamber Johnson 7160-0597, 6" short interior pocket
- Gamber Johnson MCS-POCKET3, tall interior pocket
- Gamber Johnson 7160-0339, faceplate for Whelen CenCom
- (2) Gamber Johnson #7160-0321, faceplates for APX 8500 mobile radio heads

Prompt, Courteous Service since 1939



1918 Neva Road, PO Box 267
Antigo, WI 54409
800.686.6886 or 715.623.7454
fax: 715.627.7504



dan@pomasl.com
kevin@pomasl.com
www.pomasl.com

Gamber Johnson filler panels as needed to complete the console box

- (1) round 12vdc power point charging port
- (2) round charging power points that include (1) USB and (1) USB-C connection
- (1) 110vac duplex on the cab console – location to be determined by the customer

RAM® X-Grip® Drill-Down Double Ball Mount for 12" Tablets, the mount will bolt down to the top front flat surface of the Gamber Johnson console. The item includes the mounting arm and the X-Grip holder for the iPad.



Crew cab under seat storage that fits under the crew cab seats. The mobile radio amplifiers and inverter/charger will be installed in the smaller storage area. The larger storage area would provide secured storage for additional department equipment

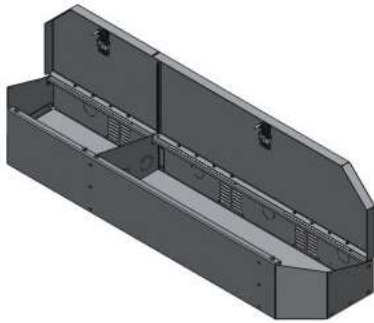

Kussmaul 63-11-2106, 20-amp super auto eject with Deluxe cover with bar graph display will be supplied and installed – location will be determined later.

Prompt, Courteous Service since 1939



1918 Neva Road, PO Box 267
Antigo, WI 54409
800.686.6886 or 715.623.7454
fax: 715.627.7504



dan@pomasl.com
kevin@pomasl.com
www.pomasl.com



Xantrex 817-02080, XC watt inverter / charger - 2,000-watt inverter with 4,000-watt surge power. Includes Smart charger built in that will charge in bulk mode, steady mode, and trickle mode. The inverter will be wired to the shoreline and 110-vac outlets

A.R.E. truck bed cap / topper or similar brand of equal quality will be supplied and installed. Including storage with hinged door on the left side and right side. A hinged swing up door without a window will be installed on the rear above the tailgate. Includes incoming shipping and installation.

(1) Whelen Legacy, DUO WeCanX light bar will be supplied and installed on the chassis cab roof with hook kit mounting brackets

(10) forward facing red / white LED modules

(4) corner red / white LED modules

(2) side facing white LED Alley lights

(10) rear facing red / amber LED modules

- rear amber LEDs will be programed for arrow stick mode unless the customer requests other programing

Smoked lenses on light bar

(1) Whelen MKAJ94, mounting bracket for the above light bar

Example Picture of light bar. This shows blue on the right side, however your light bar will be red / white on the front and sides and red / amber on the rear.

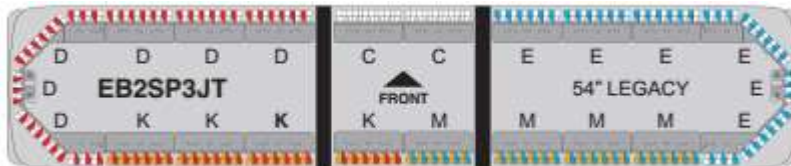

(1) Whelen C399 CenCom Core controller with module with siren amplifier to control warning lights and siren via programable pattern including dimming and DVI

Prompt, Courteous Service since 1939



1918 Neva Road, PO Box 267
Antigo, WI 54409
800.686.6886 or 715.623.7454
fax: 715.627.7504



dan@pomasl.com
kevin@pomasl.com
www.pomasl.com

(1) Whelen CCTL6, control head to control warning light, scene light, and siren functions. Slide switch for quick activation, dial for siren tones, (8) programable top buttons, (3) lower arrow stick programable buttons

(1) Whelen C399K1, OBDII CanPort installation kit for use with a F350 chassis – allows the Core to communicate with the chassis for advanced programing functions like automatically changing a flash pattern when the vehicle is put in park.

(1) Whelen CV2V, vehicle to vehicle module includes antenna

(2) Whelen CEM16, expansion modules; one front and one rear of the chassis. The C399 Core unit has an ample but limited amount of inputs and outputs. The expansion modules allow additional lights to be connected with less wiring and easy programing.

(2) Whelen SA315P, siren speaker with SAK9 mounting brackets. The siren speakers will be mounted behind the grill on the F350 chassis.

(2) Whelen TCRWX2, Tracer, 2 POD, DUO red / white to be supplied and installed on the front bull bar, overall length of each 2 POD Tracer is 26.16” long

(2) Whelen TCRWXPd, primary POD, red/white

(2) Whelen TCRWXSD, secondary POD, red/white

(3) Whelen TCRLBKT, TRACER 'L' brackets

(2) Whelen M4RC, M4 red LED with a clear lens to be installed on the sides of the bull bar facing the left/right side of the vehicle. Whelen M4FB black flanges will be included

Headlights to Wig Wag via programming

(1) Whelen ARGES2, ProFocus with spot / flood light to be supplied and installed on the driver side fender panel

(1) Whelen ARGCH1, control head to be supplied and installed on the cab console

(1) Whelen ARGFM, flat mount bracket for control head

(1) Whelen ARG47BD, F250/350 driver side fender mount

(2) Whelen TCRWX6, Tracer, 6 POD, DUO red / white to be supplied and installed on the chassis running board light, overall length of each 6 POD Tracer is 75.62”

(2) Whelen TCRWXP#, Primary DUO - Position 1

(10) Whelen TCRWXS#, Secondary DUO - Position 2,3,4,5,6

(2) Whelen TCRB47, running board mounting kit

Prompt, Courteous Service since 1939



1918 Neva Road, PO Box 267
Antigo, WI 54409
800.686.6886 or 715.623.7454
fax: 715.627.7504



dan@pomasl.com
kevin@pomasl.com
www.pomasl.com

(4) Whelen M4RC, M4 red LED with a clear lens to be installed on the sides of the sides of the topper; upper forward and upper rearward. Whelen M4FB black flanges will be included.

(1) Whelen TCRWX3, Tracer, 2 POD, DUO red / white to be supplied and installed inside the topper to face rearward through the glass in the hinged singe up door. White light to turn off when chassis in Park.

- (1) Whelen TCRWXP, primary POD, red/white
- (2) Whelen TCRWXSD, secondary POD, red/white
- (4) Whelen TCRLBKT, TRACER 'L' brackets

(2) Whelen VTX9D, Vertex DUO red / white lights will be supplied and installed on rear above taillights on the truck box. Whelen VTXFB black flanges will be installed. White will be programmed to turn off when the chassis is in Park.

- Note: after considerable issues installing lights inside the taillight housings on the project we are working on, we are declining installing lights inside the Ford taillight assemblies.

(3) Whelen PSD02FCR, Strip-Lite Plus DUO red/white: install on tail gate on the left, center, and right. Each light is 11.11" wide. White lights to steady burn when chassis in Reverse

(2) Whelen TLI2D, ION T-series DUO red / white LED lights: installed on license plate mounting bracket. Whelen TIONBKT2 license plate bracket will be installed for mounting the lights

(2) Tecniq 30 LED, 47.5" long white LED aluminum extrusion light with black housing with perpendicular mounting clips, sealed with TPE end caps for superior protection of LEDs and wiring. The lights will be installed one each side in the side facing storage.

(2) Tecniq 30 LED, 47.5" long white LED aluminum extrusion light with black housing with perpendicular mounting clips, sealed with TPE end caps for superior protection of LEDs and wiring. The lights will be installed inside the topper.

(3) Whelen 60CREGCS, 6" dome lights, red / white to be installed in the cab; one above the inside shoulder of the passenger seat and two in the crew cab

Install (2) CTF dual head mobile radios - Amps to be mounted under crew cab seats in the Havis storage box. The antenna will be provided with the radios

(2) NMO antenna mounts with coax cable

Prompt, Courteous Service since 1939



1918 Neva Road, PO Box 267
Antigo, WI 54409
800.686.6886 or 715.623.7454
fax: 715.627.7504



dan@pomasl.com
kevin@pomasl.com
www.pomasl.com

(5) Magnetic Mic MMSU-1 mic holders; one for the siren, four for the mobile radio. Location to be determined

Install customer supplied router / Wi-Fi module with antenna

Install Rosco DV-440, dual vision dash cam

(4) TROND 5-place power strips with (3) USB outlets to be installed two each side of the topper; exact locations to be determined

(1) 5 lb. fire extinguisher with vehicle bracket; installed per customer directions

Programming: Flash patterns, Dimming & Variable Intensity
Wire, Lume, hardware, shop supplied to install all the above
Labor to install all the above

Slide-Master 1,000 lb. slide out tray, 6' truck bed, 3/16" tray, Powdercoat Silver, IMS spring lock open/closed

Install by Slide-Master

Command module to be installed on the slide out tray: side access for bags on left side, slide our drawer on right side for laptop/other storage, radio head mounting spots rear upper, white board on rear, location for LCD monitor, other as determined

- (1) 24" monitor with flush mount bracket for installation on the cabinet
- (2) 12 vdc round outlet; location to be determined
- (2) dual USB outlets; USB & USB-C; location to be determined
- (2) Trond 110vac duplex power strips with (3) USB; location to be determined

(4) Tecniq 12 LED, 11.5" long white LED aluminum extrusion light with black housing with perpendicular mounting clips, sealed with TPE end caps for superior protection of LEDs and wiring. The lights will be installed inside the topper.

Graphics: design similar to picture from Brian – White cab forward with orange reflective stripe on white paint. Orange reflective lettering on the cab doors – DODGEVILLE EMS. Large Star of Life mid-body with reflective outline. Orange non-reflective wrap rear of Star of Life. White reflective stripe on orange wrap. Chevrons on rear tailgate. Proof to be provided prior to installation.

Prompt, Courteous Service since 1939



1918 Neva Road, PO Box 267
Antigo, WI 54409
800.686.6886 or 715.623.7454
fax: 715.627.7504



dan@pomasl.com
kevin@pomasl.com
www.pomasl.com

\$ 500.00 Allowance for equipment mounting in the cab for gloves and other items.

- I have not been able to find the ceiling mount glove, speaker, light unit that you sent me the picture. If you can remember where you found that, please pass along the website.
- I was able to find some tactical MOLLE panel mounts. These are black metal tactical/military mounting panels that we could use to mount glove box holders and other items to. If we cannot find the item from the picture, these would probably work.

\$ 64,788.00 Total for all the above including shipping and installation

If you have any questions or concerns, please *reach out to me anytime* via cell phone at **715-610-4210** or at the office at **1-800-686-6886** or via email at kevin@pomasl.com.

Sincerely,

A handwritten signature in black ink that reads "Kevin Pomasl".

Kevin Pomasl
Pomasl Fire Equipment

Prompt, Courteous Service since 1939

