

CURVE DATA CHART

| CURVE NO. | RADIUS | DELTA | LENGTH | TANGENT | CHORD | BEARING | CURVE NO. |
|-----------|--------|------------|--------|---------|--------|-------------|-----------|
| 1 | 250.00 | 44°21'25" | 193.34 | 101.91 | 188.75 | N67°10'42"E | 1 |
| 2 | 300.00 | 44°21'25" | 232.25 | 122.30 | 226.50 | N67°10'42"E | 2 |
| 3 | 350.00 | 4°28'56" | 27.33 | 13.67 | 27.32 | N47°44'13"E | 3 |
| 4 | 350.00 | 8°11'54" | 50.08 | 25.08 | 50.04 | N85°15'28"E | 4 |
| 5 | 20.00 | 90°00'00" | 31.42 | 20.00 | 28.28 | N36°08'31"E | 5 |
| 6 | 20.00 | 90°00'00" | 31.42 | 20.00 | 28.28 | N53°50'29"W | 6 |
| 7 | 270.00 | 32°39'31" | 153.90 | 79.10 | 151.83 | N25°10'15"W | 7 |
| 8 | 300.00 | 32°39'31" | 171.00 | 87.89 | 188.69 | N25°10'15"W | 8 |
| 9 | 330.00 | 32°39'31" | 188.10 | 96.68 | 185.56 | N25°10'15"W | 9 |
| 10 | 20.00 | 90°00'00" | 31.42 | 20.00 | 28.28 | N86°30'00"W | 10 |
| 11 | 20.00 | 90°00'00" | 31.42 | 20.00 | 28.28 | N03°30'00"E | 11 |
| 12 | 20.00 | 90°00'00" | 31.42 | 20.00 | 28.28 | NORTH | 12 |
| 13 | 20.00 | 83°00'00" | 28.97 | 17.69 | 26.50 | EAST | 13 |
| 14 | 300.00 | 17°01'57" | 89.97 | 45.32 | 89.63 | N88°35'28"E | 14 |
| 15 | 20.00 | 124°36'02" | 43.49 | 38.09 | 35.42 | S12°49'36"E | 15 |
| 16 | 267.00 | 5°30'15" | 25.65 | 12.83 | 25.64 | S77°52'44"E | 16 |

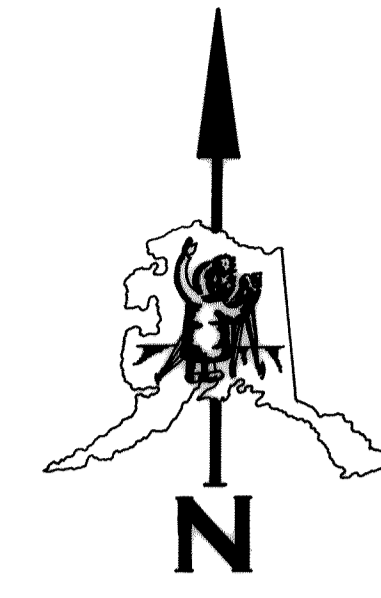

CERTIFICATE OF OWNERSHIP & DEDICATION

I (we) hereby certify that I am (we are) the owner(s) of the property shown and described hereon, and that I (we) hereby adopt this plan of subdivision and dedicate all streets, alleys, walks, parks, utility easements, and other open spaces to public use.

CHODDUNG LIMITED
P.O. BOX 247
DILLINGHAM, ALASKA 99576

NOTARY'S ACKNOWLEDGEMENT

State of Alaska
Third Judicial District
On this 20th day of July, 1981, before me, the undersigned, a notary public for the state of Alaska, personally appeared Stanley E. Sears to me known to be the person(s) described in and who executed the foregoing certificate of ownership and dedication, and acknowledged to me that he (they) executed the same as his (their) free and voluntary act.
Witness my hand and official seal the day, month, and year hereinafore written.

My Commission Expires JAN. 28. 1982
Notary Public for Alaska

PLAT APPROVAL

This plat having been approved by the City of Dillingham Planning Commission as recorded in the official minutes of the meeting of February 11, 1981, is hereby acknowledged and accepted as the official plat, subject to any and all conditions and requirements of ordinances and law appertaining thereto.

City of Dillingham
By: William D. Johnson

LEGEND

- ⊙ RECOVERED BLM & GLO BRASS CAP MONUMENTS
- ⊙ RECOVERED BRIDGE SPIKE IN E ROAD
- ⊙ CURVE NUMBER, SEE CURVE DATA CHART
- (R) RECORD
- (F) FOUND
- T 5/8" x 30" REBAR WITH 1 1/2" ALUMINUM SURVKAP SET THIS SURVEY AT ALL CORNERS, UNLESS OTHERWISE NOTED.

TYPICAL 1 1/2" ALUMINUM SURVKAP

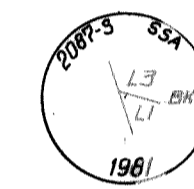

GENERAL NOTES

1. Record information taken from Plat of U.S. Survey No. 3699 dated February 11, 1963.
2. Basis of Bearing is the line between Corner 4 and the Witness Post on line between corner 4 and Corner 5 of U.S. Survey No. 3699 (N 48°30'W)
3. There shall be a 20-foot Building Setback requirement from all dedicated rights-of-way.
4. Wastewater disposal systems shall comply with existing laws at the time of construction.

SURVEYOR'S CERTIFICATE

I, the undersigned registered land surveyor, hereby certify that this survey has been completed by me or under my direct supervision and that the corners and monuments have been located and established and that dimensions shown hereon are true and correct.

Date July 17, 1981
Stanley E. Sears R.L.S.
2087-S

CERTIFICATE OF ACCEPTANCE

The City of Dillingham hereby accepts for public uses and for public purposes the real property dedicated on this plat including, but not limited to, the real property, rights-of-way and easements for public utilities, streets, alleys, thoroughfares, trails, parks and other public areas shown hereon.

Dated at Dillingham, Alaska this 20th day of July, 1981.
Mayor

ATTEST: Russell M. Braxton
City Clerk (Ordinance 78-14 S1, 1978-Ordinance 75-1 S5, 1975)

VIGNETTE MAP
SCALE 1" = 1 MILE
DILLINGHAM (A-P) QUADRANGLE

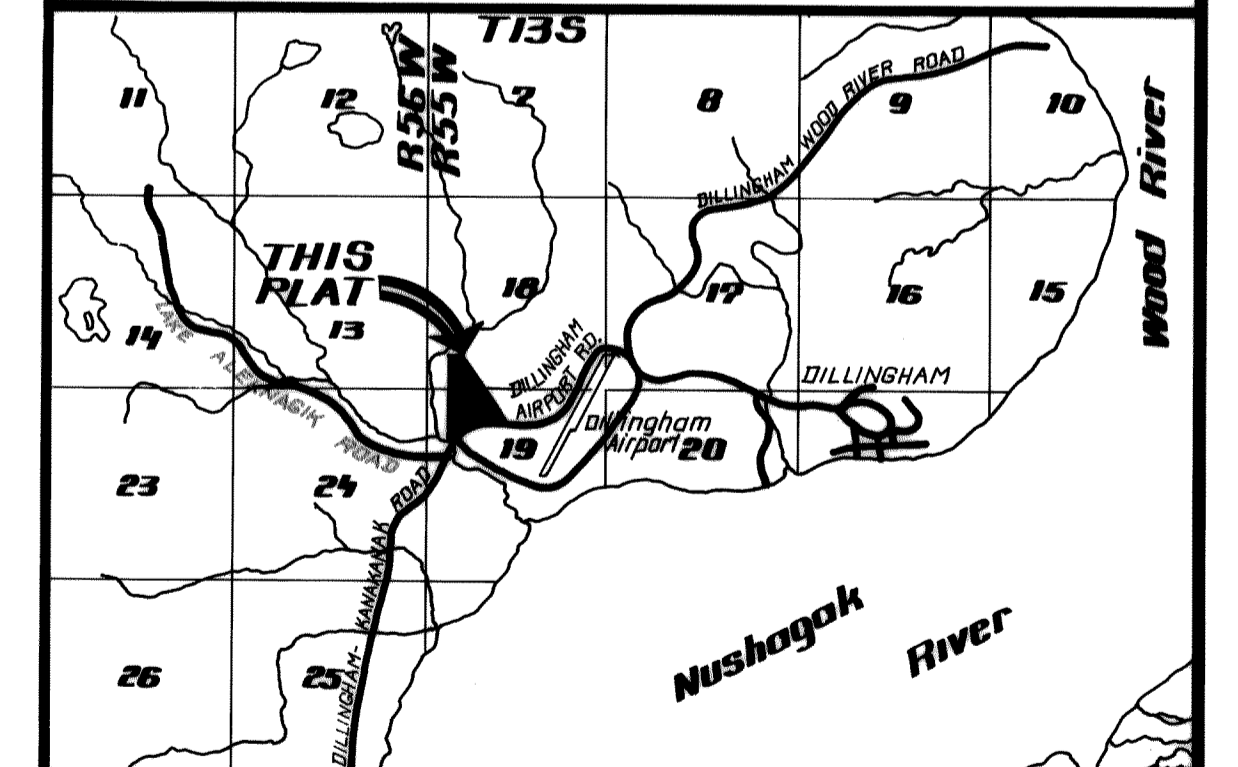

PLAT OF
MISSION SUBDIVISION
A SUBDIVISION
OF
LOT 5, U.S. SURVEY NO. 3699
CONTAINING 63.51 ACRES MORE OR LESS

STAN SEARS AND ASSOCIATES
REGISTERED LAND SURVEYORS
POST OFFICE BOX 263
EAGLE RIVER, ALASKA 99577

| | | | |
|--------------------|--------------------|------------------|-------------------|
| GRID DILLINGHAM | SCALE 1" = 200' | DATE 12/01/80 | FB 74,70,64,55 |
| DRAWN I.E.G. | CHECKED S.E.S. | FILE C-1 | WD 78-82 |

RECOVERED 3" BLM BRASS CAP MONUMENT IN POOR CONDITION 2" BELOW SWAMP SURFACE (DUG AROUND MONUMENT TO FIND WHERE PIPE WAS PLUMB ESTABLISHED POSITION AT THAT POINT)

RECOVERED 3" BLM BRASS CAP MONUMENT IN POOR CONDITION 3" SHOWING CAP TURNED 90°

U.S. SURVEY NO. 5688
(BLM) STATE OF ALASKA
DEPARTMENT OF TRANSPORTATION

U.S. SURVEY NO. 4980
(Charlie Franklin)
LOT 2

TRACT A
217,800 S.F.
5.00 AC.

TRACT C
UNSUBDIVIDED
3.70 AC.

TRACT D
UNSUBDIVIDED
2.91 AC.

TRACT E
10.00 AC.

U.S. SURVEY NO. 3699
LOT 2
(John & Patricia Moores)

MATTOM COURT SUBDIVISION
U.S.S. 3699 LOT 6 (Joe McGill)
U.S.S. NO. 3699 LOT 4 (Joe McGill)
U.S.S. NO. 3699 LOT 3 (Rosemary Barrios)

U.S.S. NO. 3699
LOT 11
(Juann Armstrong)

LOT 8
(Carol Coleman)

81-8
RECORDED - FILED 10-
Bristol Bay, Inc.
DATE July 30, 1981
TIME 9:30 A.M.
Presented by City of Dillingham
Address Box 191
Dillingham, Ak. 99574



CITY OF DILLINGHAM

P.O. BOX 191

DILLINGHAM, ALASKA 99576

TELEPHONE (907) 842-5211 or 842-5212

July 22, 1981

TO WHOM IT MAY CONCERN:

There are no taxes owing on the Mission Subdivision.

Sincerely,

Vivian M. Braswell

Vivian M. Braswell
City Clerk



81-8

| |
|---------------------------------|
| RECORDED - FILED 10- |
| Bristol Bay REC. DIST. |
| DATE July 30, 1981 |
| TIME 9:30 A.M. |
| Requested by City of Dillingham |
| Address _____ |