

CERTIFICATE OF OWNERSHIP AND DEDICATION:

I, THE UNDERSIGNED, HEREBY CERTIFY THAT I AM THE OWNER OF THE REAL PROPERTY SHOWN AND DESCRIBED HEREON AND I HEREBY ADOPT THIS PLAN OF SUBDIVISION AND DEDICATE ALL RIGHTS-OF-WAY TO PUBLIC USE AND GRANT ALL EASEMENTS TO THE USES SHOWN.

LAND OWNER:
 YEGANEH ATAIAN MANGING MEMBER OF:
 BRISTOL PROPERTIES L.L.C.
 1634 CAPE NOBLE CIRCLE
 ANCHORAGE, ALASKA 99516.

NOTARY'S ACKNOWLEDGEMENT:

SUBSCRIBED AND SWORN BEFORE ME THIS _____ DAY OF _____, 201____.

For _____

NOTARY PUBLIC FOR ALASKA

MY COMMISSION EXPIRES _____

SURVEYOR'S CERTIFICATE:

I, JOHN O'CONNOR, PROFESSIONAL LAND SURVEYOR, DO HEREBY CERTIFY THAT I AM DULY LICENSED TO PRACTICE LAND SURVEYING IN THE STATE OF ALASKA AND THAT I HAVE COMPLETED THE SURVEY SHOWN HEREON. I DECLARE THAT THE BEARINGS, DISTANCES, CORNERS, AND DIMENSIONS HAVE BEEN ESTABLISHED OR LOCATED TO THE BEST OF MY PROFESSIONAL ABILITY.

JOHN P. O'CONNOR LS 10406 DATE _____

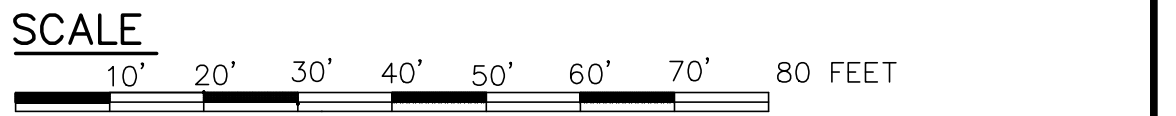
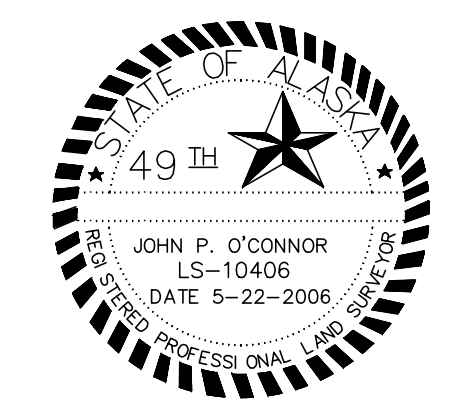

PLAT APPROVAL:
 THIS PLAT, HAVING BEEN APPROVED BY THE CITY OF DILLINGHAM PLANNING COMMISSION, AS RECORDED IN THE OFFICIAL MINUTES OF THE MEETING OF _____, 201____, IS HEREBY ACKNOWLEDGED AND ACCEPTED AS THE OFFICIAL PLAT SUBJECT TO ANY AND ALL CONDITIONS AND REQUIREMENTS OF ORDINANCES AND LAW APPERTAINING THERETO.

BY: _____ DATE _____

CHAIRPERSON, PLANNING COMMISSION

- LEGEND:**
- ⊕ 2" ALUMINUM CAP SET
 - ⊕ 2" CAP FOUND THIS SURVEY AS NOTED
 - ⊕ 5/8" REBAR FOUND THIS SURVEY
 - POWER POLE
 - (M) MEASURED THIS SURVEY
 - (R) RECORD DATA
 - MH SEWER MANHOLE
 - SWR CL SEWER CLEAN OUT

TAX CERTIFICATION:
 I HEREBY CERTIFY THAT ALL AD VALOREM TAXES, SPECIAL ASSESSMENTS, AND OTHER CHARGES REQUIRED BY LAW TO BE PLACED ON THE TAX ROLL HAVE BEEN PAID.

 CITY CLERK CITY OF DILLINGHAM

 DATE

PLAT OF: U.S. 2732 A, B LOT 1A, BLOCK 14			
A RESUBDIVISION OF LOTS 1 AND 4 BLOCK 14 OF U.S. SURVEY 2732 A&B, CREATING LOT 1A, BLOCK 14. CONTAINING 0.25 ACRES MORE OR LESS. LOCATED WITHIN THE DILLINGHAM TOWNSITE			
IN THE BRISTOL BAY RECORDING DISTRICT			
PREPARED BY: SOUTHWEST ALASKA SURVEYING CERTIFICATE OF AUTHORIZATION No. 74853D 2800 N.PARK DR. WASILLA, ALASKA 99654 PHONE 907-373-5775 OR 907-842-2903			
DRAWN BY: J.O.	DATE: 10/25/2023	GRID:	REVISION NO. 1
CHECKED BY: J.O.	SCALE: 1"=20'	F.B.:	DRAWING NO.

Ownership

Signatures of all legal owners are required on this application. If signing for a corporation or partnership, provide proof of authority to sign.

For vacations, signatures of owners of a majority of the land adjoining the proposed vacation must be submitted. *This does not apply to public utility easement vacations.*

By this signature, owners authorize processing of this application and site inspection of land involved.

Name: (print) Phillip J. Baumgartner Phone: 907-244-4084
Signature: _____
Mailing Address: P.O. Box 1473, Dillingham, AK 99576
Property Owned: Lot 1+4, block 14, USS 3732 A+B, Bristol Bay Dist., 3rd judicial

Name: (print) Georgette R. Baumgartner Phone: 907-244-8460
Signature: _____
Mailing Address: P.O. Box 1473, Dillingham, AK 99576
Property Owned: lots 1+4, blk 14, USS 3732 A+B, Bristol Bay Dist., 3rd judicial dist.

Name: (print) _____ Phone: _____
Signature: _____
Mailing Address: _____
Property Owned: _____

Name: (print) _____ Phone: _____
Signature: _____
Mailing Address: _____
Property Owned: _____

Name: (print) _____ Phone: _____
Signature: _____
Mailing Address: _____
Property Owned: _____

Name: (print) _____ Phone: _____
Signature: _____
Mailing Address: _____
Property Owned: _____

Name: (print) _____ Phone: _____
Signature: _____
Mailing Address: _____
Property Owned: _____