



*Mississippi Gulf Coast National Heritage Area
Heritage Community Grant
Request for 2020-2021 Funding Application*

**Please note that the Mississippi Gulf Coast National Heritage Area (hereinafter referred to as MS Coast NHA) will not award funding to any sub-recipient with an open Heritage Community Sub-Grant Agreement. Previous sub-recipient must be in good standing and project must be closed before being eligible to apply for next round of funding.*

Project Title: Diamondhead Fishing Pier and Boardwalk

Project Location: Twin Lakes, Diamondhead, MS
(List the county or counties where the project will take place)

Project Category: Historical Cultural Natural Resources ☒ Recreation

Applicant /Organization: City of Diamondhead, MS

Address: 5000 Diamondhead Circle

City: Diamondhead **State:** MS **Zip Code:** 39525

Website: www.diamondhead.ms.gov

U.S. Congressional District # 4th **MS Senate District #** 46 **MS House District #** 95
(To find your federal and state district numbers (<http://www.ms.gov/State/Government/Branches>))

Dun & Bradstreet (DUNS) Number: 07-881-4954
(To find your DUNS "Data Universal Numbering System" Number) (<https://fedgov.dnb.com/webform/index.jsp>)

W-9: 45-4475966

Project Manager: Michael Reso **Title:** City Manager

Telephone: 228-222-4626 **Fax Number:** 228-222-4390

Email: m.reso@diamondhead.ms.gov

Are there other organizations collaborating on this project? Yes No ☒

If yes, which organizations:

Brief Project Summary (not to exceed 250 characters):

This project will create a new park on the east side of the waterfront at Twin Lakes in Diamondhead, MS. There will be off street parking (including ADA accessibility and golf cart parking). There will be a pier for fishing, bird watching and relaxing. This will connect to a 8 foot walking path along the water and through the wood to allow residents to enjoy the outdoors. In addition, the plans include ADA bathrooms, storage area with covering for protection from the weather. Future amenities include a fences area for dogs to play.

Amount Requested from MS Coast NHA \$ 150,000
(Must equal total amount requested)

Cash Match \$ 0 **In-Kind Match \$** _____

Total Amount of Matching Contributions \$ _____

Total Project Cost \$ 150,000
(Amount requested plus the amount of match being provided)

How many months will the project take to complete? 12 months
(The maximum grant period is twelve (12) months)

Proposed Start Date: September 2021
(Should be no earlier than July 1, 2021. If grant related activities will take place prior to this date, please note what and when in the Project Narrative)

Target Completion Date: June 2022
(Should be no later than June 30, 2022)

***The application must be signed by two authorized officials of the applicant organization.**

Statement of Assurances

The information provided in this application is correct and complete. By signing below, we affirm that we are authorized representatives and have authority to act on behalf of the organization applying for this Heritage Community Grant from the MS Coast NHA.

| | |
|---------------------------------------|---|
| _____ Signature | Michael J. Reso _____ Printed Name |
| City Manager _____ Title | _____ Date |
| _____ Signature | Jeannie Klein _____ Printed Name |
| City Clerk _____ Title | _____ Date |

Project Narrative

Please attach a completed project narrative to the 2020-2021 funding application, not to exceed four pages.

Project Narrative

The project narrative should explain what the project will accomplish and how this project is linked to the MS Coast NHA Management Plan. The plan can be downloaded at <http://msgulfcoasterheritage.ms.gov/> under the 'About MGCNHA' tab. It must also include the below sub-categories:

NOTE: If photographs or drawings will help to explain the project, they may be attached, but are not required.

1. Project Narrative: Provide a detailed description of your project. Be sure to include the following:

- a. Detailed project description
- b. The need for the project.
- c. The goals for the project.
- d. The location for the project
- e. Explain how it is going to be implemented.
- f. The period of performance.

2. Anticipated Benefits:

- a. How will the project benefit the public?
- b. How will the project be shared with the public?
- c. Do you expect to see economic, social, community, and/or quality of life impacts?
- d. Will this project create jobs?
- e. What happens after the grant is completed? Will the project be sustained? If so, how do you plan to sustain it?
- f. How do you plan to evaluate the success of the project? How will you know whether you are successful?

3. Partner Organizations Involved in Project (if any):

- a. Explain briefly the role and contribution of each listed partner organization involved in the project.

4. Project timeline/milestones:

Outline a timetable listing measurable goals for each quarter of the project. Be sure to include target dates for major project elements or deliverables.

| |
|--|
| <i>First Quarter (July 1-Sept 30)</i> |
| Preliminary design: March 2021 (completed) Construction Plans Ready to Bid the Project: July 2021 |
| <i>Second Quarter (Oct 1-Dec 31)</i> |
| Bid Project: October 2021 |
| <i>Third Quarter (Jan 1-March 31)</i> |
| Construction Begins: January 2022 Construction Completed: June 2022 |
| <i>Fourth Quarter (April 1-June 30)</i> |
| |

5. Outreach and Education Requirements

- a. How do you plan to recognize the project and to acknowledge the support of the Mississippi Gulf Coast National Heritage Area (if a grant is awarded)?
- b. How will the project be shared with the public?

6. Project Budget

Attach the project budget form showing key areas of requested expenditures. Describe your management and staffing plan for the project. If you are seeking funds for project administration, please explain how those funds will be utilized.

NOTE: Documentation of efficient management and financial ability to complete the project must be provided with the application.

Project Budget Form

This grant is a 1:1 match. Therefore, this figure must be equal to or greater than the grant amount you are requesting for your project.

The match may consist of real dollars or in-kind (non-cash) contributions of labor, services, materials, equipment, supplies, and or travel expenses that are necessary and reasonable for the accomplishment of project objectives. Grantees must be able to produce records of in-kind contributions.

Provide a detailed project budget using the following tables. All included estimated costs must be reasonable and necessary to complete the project objectives.

Be sure to list your requested indirect cost rate in the Indirect Cost Rate row. Indirect is limited to 10% unless your organization has a current negotiated indirect cost rate with a Federal agency. All equipment costs must be excluded from your calculation of indirect costs.

Please check your math before you finalize the budget form and make sure the totals correspond to the totals listed on the Grant Application.

| 2020-2021 Heritage Community Grant Project Budget Form | | | |
|--|-------------------------|------------------------|---------------------------|
| Itemized Project Cost | Amount Requested | Recipient Match | Total Project Cost |
| Personnel: (staff time, employees, etc.) | | | |
| Volunteer: (donated non-skilled services) | | | |
| Professional Services/Contractual: | | | 150000 |
| Commodities:(goods that will be used only for grant related work) | | | |
| Equipment: (durable goods that will last beyond the grant period) | | | |
| Travel:(for Personnel or Volunteer travel) | | | |
| Other Expenses: | | | |
| Sub-Total cost from each column | | | 150000 |
| Indirect Cost (Indirect Rate @ ____%) | | | |
| Total Project (Direct and Indirect Costs) | | | 150000 |

MS Coast NHA Heritage Community Grant Application Checklist

You should use this checklist to confirm that your application is complete. Incomplete applications will not be considered for funding. Submit one (1) copy of each of the below documents and you do not need to submit this page with your application.

- ☒ Grant Application Form
- ☒ Project Narrative
- ☒ Project Budget Form
- ☒ Project Timeline
- ☒ Letter documenting the amount of matching contributions to the project
- ☒ Documentation of the qualifications of key project personnel
- ☒ A copy of your organization's annual budget (non-profit organizations only)
- ☒ Letters of support (these may be mailed separately)
- ☒ Copy of IRS letter confirming tax-exempt status (non-profit organizations only)
- ☒ A copy of your organization's most recently completed year-end financial statement. (Audited statements are preferred)
- ☐ Annual audit if your organization has expended \$750,000.00 or more in federal funds (cumulatively) during a fiscal year.

Submitting your application

The deadline for submitting a grant application is **Monday, May 17, 2021**. If mailed, the application must be postmarked by that date. If delivered, the application must be received in our office by the close of business at 5:00 p.m. on that date. Submission can be emailed to Heritage@dmr.ms.gov and must be received by close of business at 5:00 p.m. on that date.

You must submit a completed printed copy of your application and all supporting documents. Print or type your application on 8 ½ by 11 white paper with one (1) inch side margins. Font needs to Times New Roman size 12. You may use a paper clip or a binder clip to hold your application together, **but please do not use staples**.

Letters of support are preferred to be included with the application or can be mailed separately but must be postmarked by the application deadline of **Monday, May 17, 2021**.

Application and letters of support should be addressed to:

**MS Coast National Heritage Area
Attention: Joyce Hart
Mississippi Department of Marine Resources
1141 Bayview Avenue
Biloxi, MS 39530**

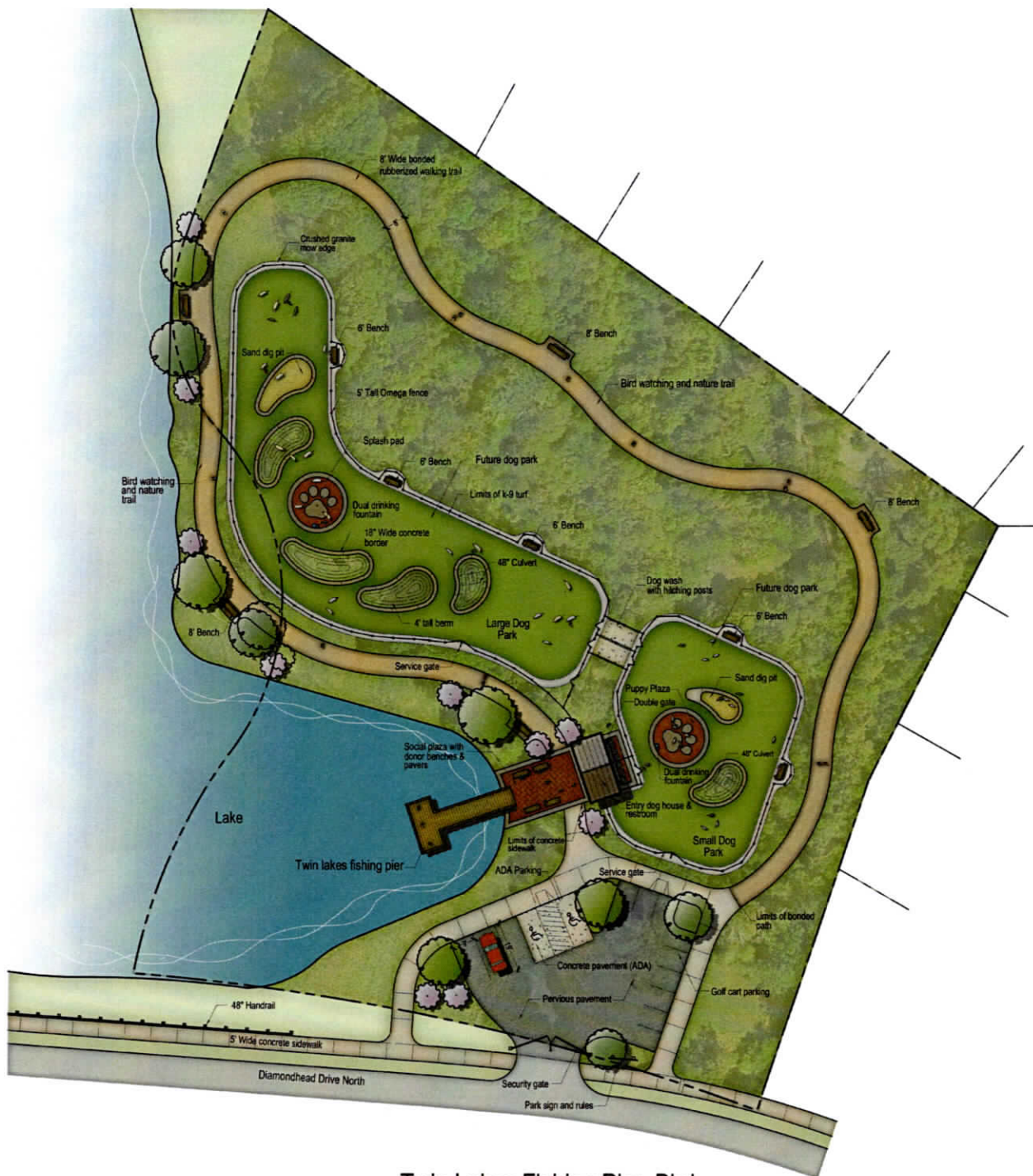

**Twin Lakes Fishing Pier, Bird
Watching and Nature Trail Park**
• Conceptual Site Plan •
The City of Diamondhead, Mississippi

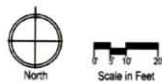

Diamondhead Fishing Pier and Boardwalk

| Earthwork, Paving & Pathways | Total Cost |
|--------------------------------------|---------------------|
| Clearing and Grubbing | \$9,571.12 |
| Porous Pavement | \$4,245.60 |
| Excavation | \$10,307.36 |
| 4" Concrete sidewalk, Pavement | \$20,000.00 |
| Bonded Rubber Path (8' wide) | \$78,500.00 |
| Stained Concrete | \$5,100.00 |
| Concrete Pavers | \$12,650.00 |
| Subtotal | \$140,374.08 |
| Utilities | Total Cost |
| Sewer Laterals | \$2,737.50 |
| Sewer Cleanouts | \$700.00 |
| Water Lateral (1") | \$3,760.00 |
| Water Meter | \$260.00 |
| Electrical (underground, in conduit) | \$6,370.00 |
| Pole lights (underground wiring) | \$12,500.00 |
| Low voltage lighting | \$8,500.00 |
| Subtotal | \$34,827.50 |
| Landscaping & Irrigation | Total Cost |
| Sod | \$8,047.20 |
| Irrigation | \$8,851.92 |
| Trees (ornamental) | \$3,000.00 |
| Shade Trees (3-1/2" Call) | \$3,600.00 |
| Shrubs, Ground Cover, Annuals | \$3,500.00 |
| Subtotal | \$26,999.12 |
| Structures, Signage & Miscellaneous | Total Cost |
| Restroom and Storage | \$13,529.00 |
| Signage | \$1,850.00 |
| Fishing Dock | \$15,400.00 |
| Benches (8' long backless) | \$7,200.00 |
| Benche (6' long w/Back Rest) | \$3,600.00 |
| Subtotal | \$41,579.00 |
| TOTAL | \$243,779.70 |

PROJECT NARRATIVE

Applicant: City of Diamondhead, MS

Project Name: Diamondhead Fishing Pier and Boardwalk

Detailed Project Description

This project will create a new park on the east side of the waterfront at Twin Lakes in Diamondhead, MS. There will be off street parking (including ADA accessible and golf cart parking). There will be a pier for fishing, bird watching and relaxing. This will connect to an 8 ft wide walking path along the water and through the woods to allow residents to enjoy the outdoors. In addition, the plans include an ADA bathroom, and a storage area with covering for protection from the weather. Future amenities include a fenced area for dogs to play.

Golf cart and car parking will be available with porous pavement to secure runoff. Handicap parking will be provided with the pavement and access ramps to the ADA nature trail. Public restrooms and drinking fountain will be available at the park as well.

The nature trail meanders through the woods allowing access to nature and bird watching while enhancing public fitness. The public pier, view dock and brick paver sitting area will allow fishing and observation with educational signage.

This project will allow all residents access to nature and waterways that are currently not accessible. The walking trail gives all residents an opportunity to enjoy nature while learning from the educational signage.

This project will provide conservation, preservation, education and enhance public access to the waterways.

This project will connect to the proposed greenway project that will span from the Hancock Harrison County lines traveling west to the Rotten Bayou Kayak Launch. This would be midway through this new multimodal lane.

The Need for the Project

Residents are asking for more locations to fishing, birding and relaxing outdoors. This is a beautiful location for residents to enjoy. The city purchased this 2-acre parcel of land last year to protect the greenspace in our city. Residents provided feedback through our comprehensive plan process and the tree ordinance revisions that clearly demonstrated their support and love for the outdoors. This new park area with fishing pier and bird watching area will provide more access for our residents and visitors to enjoy the beauty of South Mississippi and Diamondhead.

Goals for the Project

The goal and objective for this project is to enhance public access, fishing, nature trails, education, and conservation.

This project will provide a beautiful place for residents to enjoy the outdoors. The project includes construction of a new fishing pier, bird watching boardwalk, ADA accessible parking area, ADA accessible restrooms with storage and covered areas. In the future, the city plans to add a fenced area for dogs to play. This will bring another amenity to the area that residents can enjoy. In addition, this location will connect to the future greenway project that the city is developing through its comprehensive plan process.

All residents, tourists and visitors to Diamondhead will enjoy this area. The waterfront park area is designed to accommodate the residents of Woodland Village Nursing Home. There is complete ADA accessibility for the park.

Location of the Project

Twin Lakes on Diamondhead Drive West in Diamondhead, MS.

Project Tasks

1. Preliminary site layout
2. Construction plans
3. Bidding and Award of Contract
4. Construction
5. Final close out

Explain How It Is Going To Be Implemented

The mayor and city council created a steering committee of residents to help plan this new park area. The city hired Orion Planning and Design to develop a sketch for the park with the help of the steering committee. We used the vision of the residents to develop the plans. Now, the City is working to secure grants funding and to solicit donations from residents to help pay for the new park. The city has hired Orion Planning and Machado Panano to design the construction documents for the park. Once funding is secured to pay for the park, the city will bid the project. We are hoping to bid this project in September 2021 and to have construction begin by January 2022. Construction will take about 6 months; so, the park would be accessible to resident by June 2022.

How will the Project Benefit the Public?

Some of the benefits of this project include:

1. Allow resident access to the waterways
2. Promote public health and fitness
3. Offers the chance to see wildlife
4. Walking, picnicking, fishing, nature walks and bird watching, year-round

How will the project be shared with the public?

This is an open area that is located on a main connector street in Diamondhead. All residents will have easy access to the park area. It is also centrally located in the city.

Do you expect to see economic, social, community, and/or quality of life impacts?

Absolutely! Residents and prospective homeowners are wanting to have more open green spaces and parks for them to enjoy. This will help increase property values since there will be more demand for housing in the city. A new park and greenspace with fishing pier will be positive for this community and will allow residents to gather and enjoy the beauty of nature in Diamondhead.

Will this create jobs?

The project will not directly create any new jobs. However, indirectly, we can expect increase business in the community by residents and visitors who come to enjoy the park. This may result in the creation of more jobs in our local businesses.

What happens after the grant is completed? Will the project be sustained? If so, how do you plan to sustain it?

Once the park and fishing pier is constructed, the City of Diamondhead will allocate annual funds to support the park for repairs, maintenance, and other improvements. The City will use general funds in the budget to pay for these expenses.

How do you plan to evaluate the success of the project? How will you know whether you are successful?

The completion of the park construction will mean success for the project. However, seeing the residents utilize the new fishing pier and boardwalk daily will provide support that this project will be a long-term benefit for this community.

How do we plan to recognize the project and to acknowledge the support of the Mississippi Gulf Coast National Heritage Area (if a grant is awarded)?

The City Council has approved a donor recognition plan. This is part of the City's attempt to secure donations from residents to help pay for the project. This will include plaques with names of the donors. The city will display a sign to recognize the MS Gulf Coast National Heritage Area at the new park area.