

Mailing Date:
Friday, October 27, 2023

COMMUNITY DEVELOPMENT

NOTICE OF PUBLIC HEARING

HEARING FORMAT

The Deschutes County Hearings Officer will conduct the public hearing described below by video and telephone. If participation by video and telephone is not possible, in-person testimony is available. Options for participating in the public hearing are detailed in the Public Hearing Participation section.

PROJECT DESCRIPTION

FILE NUMBER: 247-23-000302-DR

**OWNER/
APPLICANT:** Oregon Department of Transportation (ODOT)

PROPOSAL: The applicant requests interpretations of the County's Zoning Code, Zoning Maps, and Comprehensive Plan to determine if a future multi-use path, to be located within the ODOT right-of-way and lands owned by the High Desert Museum, is a use permitted outright.

PROPOSAL

LOCATION:

1. ODOT Highway 97 right-of-way located in Township 18S, Range 12E, Sections 19, 30, & 31 and Township 18S, Range 11E, Section 36 (see attached location map).
2. 59800 HWY 97, BEND, OR 97702 / Map and Taxlot: 1811000001900

HEARING DATE: Wednesday, December 6th, 2023

HEARING START: 6:00 pm

HEARING

LOCATION: Barnes and Sawyer Rooms of the Deschutes Services Center, 1300 NW Wall Street, Bend and Zoom

STAFF PLANNER: Caroline House, Senior Planner
Caroline.House@deschutes.org / 541-388-6667

RECORD: Record items can be viewed and downloaded from:
<https://www.deschutes.org/cd/page/247-23-000302-dr-odot-lava-butte-trail>

TIME LIMITS

The Deschutes County Planning Division has set the following time limits for testimony at the hearing:

- Applicant: 30 minutes
- Other Public Agencies: 10 minutes
- General Public: 3 minutes
- Applicant Rebuttal: 10 minutes

Please note, the above time limits can be modified or eliminated by the Hearings Officer at their discretion.

STANDARDS AND APPLICABLE CRITERIA:

Deschutes County Code

 Title 17, Subdivisions

 Chapter 17.08, Definitions and Interpretation of Language

 Chapter 17.48, Design and Construction Specifications

 Title 18, Deschutes County Zoning Ordinance

 Chapter 18.04, Title, Purpose, and Definitions

 Chapter 18.12, Establishment of Zones

 Chapter 18.40, Forest Use Zone (F2)

 Chapter 18.48, Open Space and Conservation Zone (OSC)

 Chapter 18.60, Rural Residential Zone (RR10)

 Chapter 18.124, Site Plan Review

 Title 22, Deschutes County Development Procedures Ordinance

PUBLIC HEARING PARTICIPATION

- If you wish to provide testimony during the public hearing, please contact the staff planner by 4 pm on Tuesday, December 5th, 2023. Testimony can be provided as described below.
- Members of the public may listen, view, and/or participate in this hearing using Zoom. Using Zoom is free of charge. To login to the electronic meeting online using your computer, copy this link: <https://us02web.zoom.us/j/89037885399>. Using this option may require you to download the Zoom app to your device.
- Members of the public can access the meeting via telephone, dial 1-669-444-9171. When prompted, enter the following Webinar ID: 890-3788-5399.
- Written comments can also be submitted to the record. Please see the Document Submission section below for details regarding written submittals.

- If participation during the hearing by video and telephone is not possible, the public can provide testimony in person at 6 pm in the Barnes and Sawyer Rooms of the Deschutes Services Center, 1300 NW Wall Street, Bend.

All documents and evidence submitted by or on behalf of the applicant and applicable criteria are available for inspection at no cost at the Deschutes County Community Development Department (CDD) at 117 NW Lafayette Avenue. Seven (7) days prior to the public hearing, a copy of the staff report will be available for inspection at no cost at CDD and on the websites listed above. Copies of all documents, evidence and the staff report can be purchased at CDD for (25) cents a page.

ALL INTERESTED PERSONS MAY APPEAR, BE HEARD, BE REPRESENTED BY COUNSEL, OR SEND WRITTEN SIGNED TESTIMONY. ANY PARTY TO THE APPLICATION IS ENTITLED TO A CONTINUANCE OF THE INITIAL EVIDENTIARY HEARING OR TO HAVE THE RECORD LEFT OPEN IN ACCORDANCE WITH SECTION 22.24.140 OF THE DESCHUTES COUNTY CODE.

Failure to raise an issue in person at a hearing or in writing precludes appeal by that person to the Land Use Board of Appeals (LUBA), and that failure to provide statements or evidence sufficient to afford the decision maker an opportunity to respond to the issue precludes appeal to LUBA based on that issue.

Deschutes County encourages persons with disabilities to participate in all programs and activities. This event/location is accessible to people with disabilities. If you need accommodations to make participation possible, please contact the staff planner identified above.

DOCUMENT SUBMISSION

Any person may submit written comments on a proposed land use action. Documents may be submitted to our office in person, U.S. mail, or email.

In Person

We accept all printed documents.

U.S. Mail

Deschutes County Community Development
Planning Division, Caroline House
P.O. Box 6005
Bend, OR 97708-6005

Email

Email submittals should be directed to Caroline.House@deschutes.org.

Limitations

- Deschutes County does not take responsibility for retrieving information from a website link or a personal cloud storage service. It is the submitter's responsibility to provide the specific information they wish to enter into the record. We will print the email which includes the link(s), however, we will not retrieve any information on behalf of the submitter.
- Deschutes County makes an effort to scan all submittals as soon as possible. Recognizing staff availability and workload, there is often a delay between the submittal of a document to the record, and when it is scanned and uploaded to Accela Citizen Access (ACA) and Deschutes County Property Information (DIAL).
- To ensure your submission is entered into the correct land use record, please specify the land use file number(s).
- For the open record period after a public hearing, electronic submittals are valid **if received by the County's server** by the deadline established for the land use action.

NOTICE TO MORTGAGEE, LIENHOLDER, VENDOR OR SELLER: ORS CHAPTER 215 REQUIRES THAT IF YOU RECEIVE THIS NOTICE, IT MUST PROMPTLY BE FORWARDED TO THE PURCHASER.

This Notice was mailed pursuant to Deschutes County Code Chapters 22.20 and 22.24.

US-97 LAVA BUTTE TRAIL

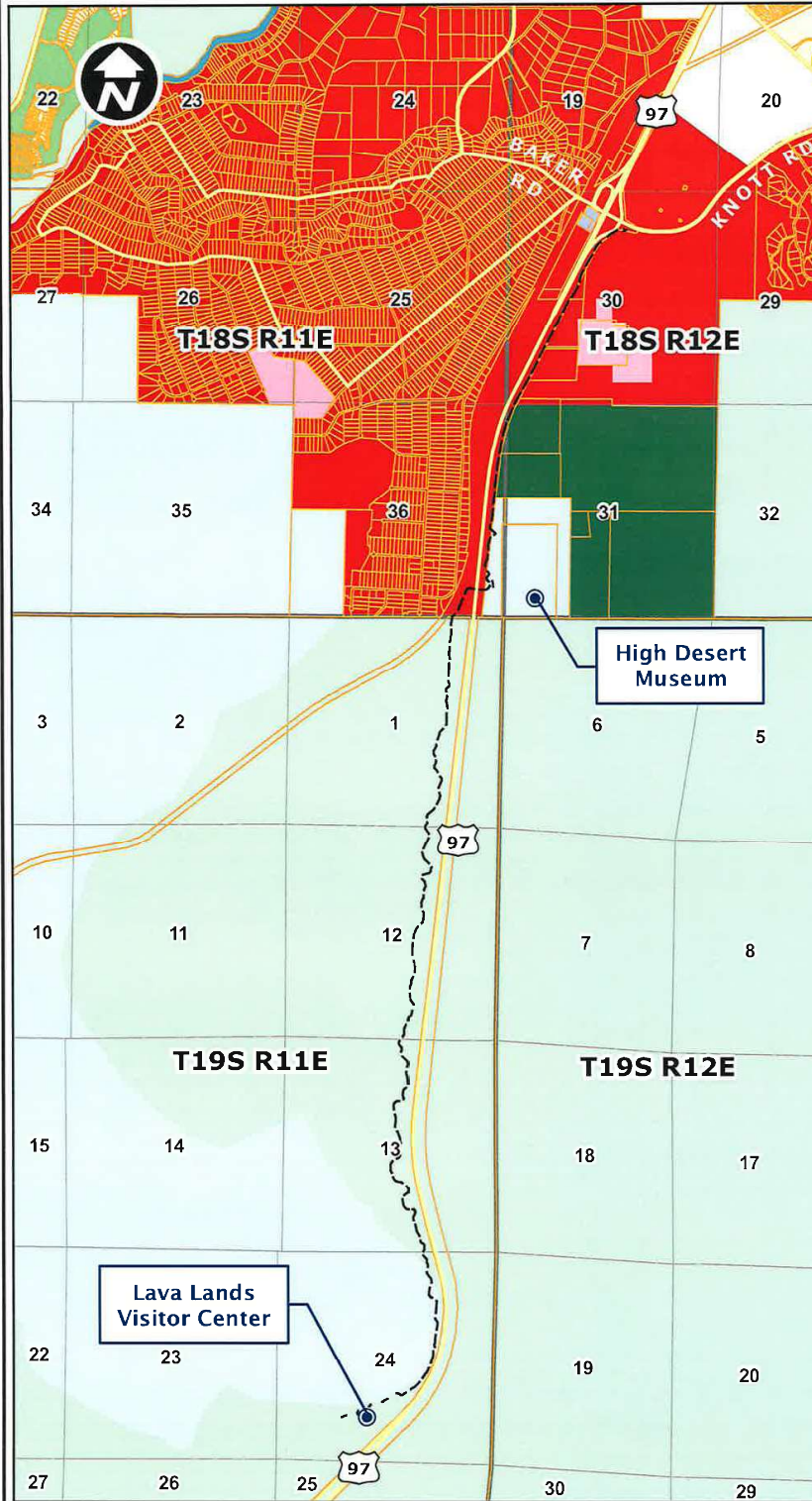

FEATURES

- Lava Butte Trail
- Tax Lot Boundary
- Township & Range Grid
- Section Grid
- Roads & Highways

ZONING

- Forest Use 1
- Forest Use 2
- Flood Plain
- Open Space & Conservation
- Rural Commercial
- Rural Residential
- Bend Residential
- Surface Mining
- Widgi Crk Seventh Mtn Residential
- Widgi Creek Residential



PRODUCED BY ODOT GIS UNIT
 GIS No. 23-62 | FEBRUARY 2023
 ODOTMaps@odot.oregon.gov

This product is for informational purposes and may not be suitable for legal, engineering, or surveying purposes. Users of this product should review and consult the primary data sources to determine the usability of the information. Conclusions drawn from this information are the responsibility of the user.

owner	agent	inCareof	address	cityStZip	type	cdd id	email
ARNOLD IRRIGATION DISTRICT			19604 BUCK CANYON RD.	Bend, OR 97702	NOPH	23-302-DR	
BNSF RAILWAY - ASSISTANT DIR., PUBLIC PROJECTS			740 CARNEGIE DRIVE	San Bernadino, CA 92408	NOPH	23-302-DR	
DEPT. OF FORESTRY			P.O. BOX 670	Prineville, OR 97754	NOPH	23-302-DR	
DEPT. OF LAND CONSERV. & DEVEL.			1011 SW ENKAY DR., SUITE 108	Bend, OR 97702	NOPH	23-302-DR	
DEPT. OF LAND CONSERV. & DEVEL.			635 CAPITOL ST. NE, #150	Salem, OR 97301-2540	NOPH	23-302-DR	
DESCHUTES CO. BUILDING SAFETY			ELECTRONIC		NOPH	23-302-DR	
DESCHUTES CO. FIRE ADAPTED COMMUNITIES COORDINATOR	CORINNE HEINER		ELECTRONIC		NOPH	23-302-DR	
DESCHUTES CO. FORESTER	KEVIN MORIARTY		ELECTRONIC		NOPH	23-302-DR	
DESCHUTES CO. PROPERTY MGMT.	DEBORAH COOK		ELECTRONIC		NOPH	23-302-DR	
DESCHUTES CO. ROAD DEPT.	CODY SMITH		ELECTRONIC		NOPH	23-302-DR	
DESCHUTES CO. SR. TRANS. PLANNER	PETER RUSSELL		ELECTRONIC		NOPH	23-302-DR	
DESCHUTES NAT. FOREST	CYNTHIA ANDERSON		ELECTRONIC		NOPH	23-302-DR	
DEPT. OF STATE LANDS (DSL-OWNED PROPERTY)	Shawn Zumwalt		ELECTRONIC		NOPH	23-302-DR	
OREGON DEPT OF FISH & WILDLIFE	Jessica S.Clark and Andrew Walch		ELECTRONIC		NOPH	23-302-DR	
ODOT REGION 4 PLANNING			ELECTRONIC		NOPH	23-302-DR	
ODOT Region 4 Planning	David Amiton		63055 N. Highway 97, Bldg M	Bend, OR 97703	NOPH	23-302-DR	David.Amiton@odot.oregon.gov
ABRAHAMS, MICHAEL & JODY			59647 NAVAJO CIR	BEND, OR 97702	NOPH	23-302-DR	
ACOSTA, NYDIA A			60294 CINDER BUTTE RD	BEND, OR 97702	NOPH	23-302-DR	
ADAIR, DANIEL R			60296 CINDER BUTTE RD	BEND, OR 97702	NOPH	23-302-DR	
ALEXANDRE TRUST ET AL	ALEXANDRE, YVONNE TTEE		19505 CHEROKEE RD	BEND, OR 97702	NOPH	23-302-DR	
ANDERSON, DONALD B & FE L			60399 CINDER BUTTE RD	BEND, OR 97702	NOPH	23-302-DR	
ARNDT, TOBIAS R & ARNDT, ANGELA R			59990 CHEYENNE RD	BEND, OR 97702	NOPH	23-302-DR	
ARNOLD,STEPHEN J & TRESA J			59888 NAVAJO RD	BEND, OR 97702	NOPH	23-302-DR	
ARZOLA, ANAITIS IBANEZ ET AL			60319 CINDER BUTTE RD	BEND, OR 97702	NOPH	23-302-DR	
AVION WATER COMPANY INC			60813 PARRELL RD	BEND, OR 97702	NOPH	23-302-DR	
BALDWIN, SEAN E			60091 CHEYENNE RD	BEND, OR 97702	NOPH	23-302-DR	
BANCROFT, LORANA TTEE ET AL	WILL OF ALLAN G TON		7760 E STATE ROUTE 69 #C5-356	PRESCOTT VALLEY, AZ 86314	NOPH	23-302-DR	
BARBARA MOORE TRUST	MOORE, BARBARA J TTEE		59966 NAVAJO RD	BEND, OR 97702	NOPH	23-302-DR	
BAXTER, EMILIA & CORNELIUS, JETT			60299 ADDIE TRIPLETT LOOP	BEND, OR 97702	NOPH	23-302-DR	
BEARD, JONATHAN SCOTT			19881 ROCKING HORSE RD	BEND, OR 97702	NOPH	23-302-DR	
BEND CHRISTIAN FELLOWSHIP			19831 ROCKING HORSE RD	BEND, OR 97702	NOPH	23-302-DR	
BENNETT, MORGAN			59781 CHEYENNE RD	BEND, OR 97702	NOPH	23-302-DR	
BERNHARDT, ALLISON RAE & RYAN S			20067 SHADY PINE PL	BEND, OR 97702	NOPH	23-302-DR	
BERRY, RICHARD G & KARON A			59798 NAVAJO RD	BEND, OR 97702	NOPH	23-302-DR	
BETHANY R HILLIER TRUST	HILLIER, BETHANY R TTEE		59960 NAVAJO RD	BEND, OR 97702	NOPH	23-302-DR	
BEVERLY A GREEN REVOCABLE LIVING TRUST	GREEN, BEVERLY A TTEE ET AL	C/O KYLE GREEN	530 LIVE OAK DR	BERTRAM , TX 78605	NOPH	23-302-DR	
BFL INVESTMENTS LLC			761 SELDON DR	WINCHESTER, VA 22601	NOPH	23-302-DR	
BILLINGTON,ROBERT C & VALERIE			60255 NAVAJO RD	BEND, OR 97702	NOPH	23-302-DR	
BILYEU, THERESA ET AL			PO BOX 8103	BEND, OR 97708	NOPH	23-302-DR	
BISHOP, BRYAN C			59881 CHEYENNE RD	BEND, OR 97702	NOPH	23-302-DR	
BIXLER LIVING TRUST	BIXLER, TIMOTHY J & VIRGINIA J TTEES		5338 W 138TH PL	HAWTHORNE, CA 90250	NOPH	23-302-DR	
BLACKWELDER,ANTHONY L			60323 CINDER BUTTE RD	BEND, OR 97702	NOPH	23-302-DR	
BLAKE, AMBER M			60105 CHEYENNE RD	BEND, OR 97702	NOPH	23-302-DR	
BLAKLEY, RICHARD W JR ET AL			19219 BUCK CANYON RD	BEND, OR 97702	NOPH	23-302-DR	
BLAYLOCK, SCOTT M & CAROL A			60668 ROCKING HORSE CT	BEND, OR 97702	NOPH	23-302-DR	
BOBBY & ROSELEE OSTRANDER LIV TRUST	OSTRANDER, BOBBY D & ROSELEE J TTEES		59852 NAVAJO RD	BEND, OR 97702	NOPH	23-302-DR	
BOGGESS, DORALEE R			60887 MCMULLIN DR	BEND, OR 97702	NOPH	23-302-DR	
BOHREN,ANTHONY C			60189 CHEYENNE RD	BEND, OR 97702	NOPH	23-302-DR	
BONNIE J BOEHM REVOCABLE TRUST	BOEHM, BONNIE J TTEE		60281 CHEYENNE RD	BEND, OR 97702	NOPH	23-302-DR	
BOROWINSKI, FRANK M & GEORGIA C			60818 GRANITE DR	BEND, OR 97702	NOPH	23-302-DR	
BOYD, STEVEN T & VALADEZ-BOYD, ANITA			19887 ROCKING HORSE	BEND, OR 97702	NOPH	23-302-DR	
BOYER, MATTHEW			59774 NAVAJO RD	BEND, OR 97702	NOPH	23-302-DR	
BRANSON,GAIL			59905 CHEYENNE RD	BEND, OR 97702	NOPH	23-302-DR	
BRAVO, GEORGE H III			59789 CHEYENNE RD	BEND, OR 97702	NOPH	23-302-DR	
BRENT JORDAN BOHLKEN LIVING TRUST	BOHLKEN, BRENT JORDAN TTEE		1649 VISTA DE MONTEMAR	EL CAJON, CA 92021	NOPH	23-302-DR	
BRITTAIN, KEVIN DANIEL ET AL			19877 ROCKING HORSE RD	BEND, OR 97702	NOPH	23-302-DR	
BROADHEAD,GARY L & DENISE L			59830 CHEYENNE RD	BEND, OR 97702	NOPH	23-302-DR	
BROCKWAY, PATRICK R & KAREN F			19645 BAKER RD	BEND, OR 97702	NOPH	23-302-DR	
BROTHERS LIVING TRUST	BROTHERS, BRUCE J & CAROL L TTEES	C/O BRUCE J BROTHERS (A)	242 STILLWATER CT	MARCO ISLAND, FL 34145	NOPH	23-302-DR	
BROWNING, DALE A JR & CHARMAINE M			59948 CHEYENNE RD	BEND, OR 97702	NOPH	23-302-DR	
BUCKLEY, JASON & DARCY L			59617 NAVAJO CIR	BEND, OR 97702	NOPH	23-302-DR	
BULLOCK, KAREN E			60256 NAVAJO RD	BEND, OR 97702	NOPH	23-302-DR	
BURNSON, ISAAC D & BRIANA A			59743 CHEYENNE RD	BEND, OR 97702	NOPH	23-302-DR	
CAMERON M KERR REV LIV TRUST	KERR, CAMERON M TRUSTEE		59700 SCALE HOUSE RD	BEND, OR 97702	NOPH	23-302-DR	

CAMPBELL, BOBBY & LISA		60255 ADDIE TRIPLETT LOOP	BEND, OR 97702	NOPH	23-302-DR
CAPASSO, DANIEL		60276 CINDER BUTTE RD	BEND, OR 97702	NOPH	23-302-DR
CARTER, RONALD PAUL		59676 CHEYENNE RD	BEND, OR 97702	NOPH	23-302-DR
CARTWRIGHT, BRIAN J & MARGO LYNN		59664 NAVAJO RD	BEND, OR 97702	NOPH	23-302-DR
CECIL, PETER		19840 ROCKING HORSE RD	BEND, OR 97702	NOPH	23-302-DR
CHAMBERS LIVING TRUST	CHAMBERS, JAMES & JANET TTEES	19860 ROCKING HORSE RD	BEND, OR 97702	NOPH	23-302-DR
CHAVEZ, WAYNE		60233 CHEYENNE RD	BEND, OR 97702	NOPH	23-302-DR
CHRISTENSEN, JEFF & KOSS, LAUREN BROOKE		59683 CHEYENNE RD	BEND, OR 97702	NOPH	23-302-DR
CJ DENS LACAMAS I LLC		PO BOX 2239	KALAMA, WA 98625	NOPH	23-302-DR
CLARK, DANIEL KEVIN		PO BOX 6131	BEND, OR 97708	NOPH	23-302-DR
CLARK, VICKI A		60030 CHEYENNE RD	BEND, OR 97702	NOPH	23-302-DR
CLEMENS, BRUCE D & JEAN M		59736 NAVAJO RD	BEND, OR 97702	NOPH	23-302-DR
CLOUD, RICHARD & ANDREWS, KATHLEEN		PO BOX 7737	BEND, OR 97708	NOPH	23-302-DR
COLEMAN, LOIS R		60843 EMIGRANT CIR	BEND, OR 97702	NOPH	23-302-DR
COLLINS 2008 REVOCABLE TRUST	COLLINS, NORMAN C & CLAUDIA B TTEES	432 EASTWOOD DR	PETALUMA, CA 94954	NOPH	23-302-DR
COSMOS COMPUTING INC		60365 CINDER BUTTE RD	BEND, OR 97702	NOPH	23-302-DR
CRESS, DANA & KIMBERLE		60213 CHEYENNE RD	BEND, OR 97702	NOPH	23-302-DR
CRONIN, AUSTIN & ANDREA		59757 CHEYENNE RD	BEND, OR 97702	NOPH	23-302-DR
CRUM, DONALD D & SUSAN A		19872 ROCKING HORSE RD	BEND, OR 97702	NOPH	23-302-DR
CURTIS, CHRISTOPHER W		60203 CHEYENNE RD	BEND, OR 97702	NOPH	23-302-DR
CYMBALA, JOHN W		1110 CATALINA DR #102	LAKE HAVASU CITY, AZ 86403	NOPH	23-302-DR
DAMMEN, DEREK L & GRANT, BRIANNA		59959 CHEYENNE RD	BEND, OR 97702	NOPH	23-302-DR
DANIELS, DAVID HARLEY		65611 HIGHWAY 20	BEND, OR 97703	NOPH	23-302-DR
DARDENNE, JORDAN M		20058 GRAND TETON DR	BEND, OR 97702	NOPH	23-302-DR
DAVID CHARLES NUTTING REV TRUST	NUTTING, DAVID CHARLES TRUSTEE	60124 NAVAJO RD	BEND, OR 97702-8991	NOPH	23-302-DR
DAVIES, RICHARD J ET AL		6721 AZALEA WAY SE	SNOQUALMIE, WA 98065	NOPH	23-302-DR
DAWSON, ELLEN ELIZABETH & DANIEL SCOTT		59773 CHEYENNE RD	BEND, OR 97702	NOPH	23-302-DR
DEFOE FAMILY TRUST	DEFOE, DONALD R & THERESA G TTEES	63310 OB RILEY RD	BEND, OR 97703	NOPH	23-302-DR
DESCHUTES COUNTY		PO BOX 6005	BEND, OR 97708-6005	NOPH	23-302-DR
DORIS E DILDAY REVOCABLE TRUST	C/O PROPERTY MANAGEMENT	60271 ADDIE TRIPLETT LOOP	BEND, OR 97702	NOPH	23-302-DR
DRW I LLC	DILDAY, DORIS E TTEE	8611 NE OCHOCO HWY	PRINEVILLE, OR 97754	NOPH	23-302-DR
DUNMIRE, MARK B & ERIN C ET AL		378 WALNUT DR S	MONMOUTH, OR 97361	NOPH	23-302-DR
DYLLA, RICHARD P & CANDYCE R		59767 CHEYENNE RD	BEND, OR 97702	NOPH	23-302-DR
ECKSTEIN, BENJAMIN ET AL		59705 CHEYENNE RD	BEND, OR 97702	NOPH	23-302-DR
EDDIE W OWENS TRUST	OWENS, EDDIE W TTEE	60298 CINDER BUTTE RD	BEND, OR 97702	NOPH	23-302-DR
EDMONSTON, MARCIA A		60251 ADDIE TRIPLETT LOOP	BEND, OR 97702	NOPH	23-302-DR
EDWARDS, KRISTIN D		59728 NAVAJO RD	BEND, OR 97702	NOPH	23-302-DR
EGGENSPERGER, NEIL P		60238 NAVAJO RD	BEND, OR 97702	NOPH	23-302-DR
EGGERT, JEREMY D & JESSICA L		1528 SE RIVERA RD	BEND, OR 97702	NOPH	23-302-DR
ERVIN, MAX W		19976 WAGON TREE CT	BEND, OR 97702	NOPH	23-302-DR
EVERHART, SYDNEY E		60287 CHEYENNE RD	BEND, OR 97702	NOPH	23-302-DR
EVERSAUL, SCOTT		60207 CHEYENNE RD	BEND, OR 97702	NOPH	23-302-DR
FERULLO, TODD W & NICHOLLE A		59849 CHEYENNE RD	BEND, OR 97702	NOPH	23-302-DR
FIRKUS, CONRAD G & TAMMY L		60150 CHEYENNE RD	BEND, OR 97702	NOPH	23-302-DR
FOLLETT, MARK L		60265 NAVAJO RD	BEND, OR 97702	NOPH	23-302-DR
FORSEY, JENNIFER		60286 ADDIE TRIPLETT LOOP	BEND, OR 97702	NOPH	23-302-DR
FOSTER HAYES LIVING TRUST	HAYES, DALE KEVIN TTEE ET AL	60305 CINDER BUTTE RD	BEND, OR 97702	NOPH	23-302-DR
FRANCES W MILLS REV LIV TRUST	MILLS, FRANCES W & MICHAEL CO TTEES	5660 SW HELMHOLTZ	REDMOND, OR 97756	NOPH	23-302-DR
FREEMAN, LEE J & KIMBERLY A		59810 CHEYENNE RD	BEND, OR 97702	NOPH	23-302-DR
FRY, DEBORAH MINOR		19668 BAKER RD	BEND, OR 97702	NOPH	23-302-DR
GARCIA, MARCELO ENRIQUE CUEVAS ET AL		59981 CHEYENNE RD	BEND, OR 97702	NOPH	23-302-DR
GARZA, BRIAN		59965 CHEYENNE RD	BEND, OR 97702	NOPH	23-302-DR
GILLESPIE JEFFRIES LIVING TRUST	JEFFRIES, SHERIDAN GM TTEE	59625 NAVAJO RD	BEND, OR 90272	NOPH	23-302-DR
GO FORTH MINISTRIES		60377 CINDER BUTTE RD	BEND, OR 97702	NOPH	23-302-DR
GONZALES, HARVEY JR & LYDAY, KYLA F		59720 NAVAJO RD	BEND, OR 97702	NOPH	23-302-DR
GONZALEZ, MARIA D		19967 DOUBLE TREE CT	BEND, OR 97702	NOPH	23-302-DR
GORMLEY, DANIEL A & JENNIFER M		60113 CHEYENNE RD	BEND, OR 97702	NOPH	23-302-DR
GREGORY & SANDRA BEHRENS TRUST	BEHRENS, GREGORY J TTEE ETAL	59806 NAVAJO RD	BEND, OR 97702	NOPH	23-302-DR
GREGORY, TIMOTHY D		59641 CHEYENNE RD	BEND, OR 97702	NOPH	23-302-DR
GRUBE, CHERYL A	WAINSCOAT, RENESH (CB)	136339 W FRIENDLY LN	CRESCENT, OR 97733	NOPH	23-302-DR
GULNAC, STACY N		60271 CHEYENNE RD	BEND, OR 97702	NOPH	23-302-DR
HALL, MICHAEL A		19735 MANZANITA LN	BEND, OR 97702	NOPH	23-302-DR
HAMILTON, CHRISTOPHER K & HEATHER M		60237 CHEYENNE RD	BEND, OR 97702	NOPH	23-302-DR
HAMILTON, JORDAN K & LISA A		60050 CHEYENNE RD	BEND, OR 97702	NOPH	23-302-DR
HAMMER, TINA M		59674 NAVAJO RD	BEND, OR 97702	NOPH	23-302-DR
HARPOLE, JOSHUA & BARBARA J		19830 ROCKING HORSE RD	BEND, OR 97702	NOPH	23-302-DR
HAUN, CARTER RYAN & WAVERS, SARAH		19748 MANZANITA LN	BEND, OR 97702	NOPH	23-302-DR

HEAVIRLAND, LORENE ET AL		59884 CHEYENNE RD	BEND, OR 97702	NOPH	23-302-DR
HEDEMAN, JO ANNE		2329 E BEATRICE DR	MERIDIAN, ID 83642	NOPH	23-302-DR
HENDRIXSON, CHARLES SCOTT		60650 ROCKING HORSE CT	BEND, OR 97702	NOPH	23-302-DR
HENSLEY, BILLY		19699 MANZANITA LN	BEND, OR 97702	NOPH	23-302-DR
HENSON, CALVIN D		60215 CHEYENNE RD	BEND, OR 97702	NOPH	23-302-DR
HERMAN, DONNA	C/O DONNA LEON	786 NE TIERRA RD	BEND, OR 97701	NOPH	23-302-DR
HERNANDEZ, JOSE A		60023 CHEYENNE RD	BEND, OR 97702	NOPH	23-302-DR
HERRERA, THOMAS		19698 MANZANITA LN	BEND, OR 97702	NOPH	23-302-DR
HICKEY, DEBRA (BOBBIE) V ET AL		108 BIRCH ST	LAKEVIEW, OR 97630	NOPH	23-302-DR
HIGGINS, ERIN L		59971 CHEYENNE RD	BEND, OR 97702	NOPH	23-302-DR
HILLERICH, MICHAEL R & LISA D		60072 NAVAJO RD	BEND, OR 97702	NOPH	23-302-DR
HOLMES, JOSHUA L		59812 NAVAJO RD	BEND, OR 97702	NOPH	23-302-DR
HOUNSHELL, GERALD JR & AVA D		60129 CHEYENNE RD	BEND, OR 97702	NOPH	23-302-DR
IACOVETTA REVOCABLE TRUST	IACOVETTA, GLENN T & VONDA L			NOPH	23-302-DR
JACOBS, NANCY D	TTEES	60320 ADDIE TRIPLETT LOOP	BEND, OR 97702	NOPH	23-302-DR
JANET KAYE ASAY REVOCABLE TRUST	ASAY, JANET KAYE TTEE	20050 GRAND TETON DR	BEND, OR 97702	NOPH	23-302-DR
JARRETTE, GABRIELA N & AMOS D		60854 EMIGRANT DR	BEND, OR 97702	NOPH	23-302-DR
JEANTROUT, RICHARD F JR		60146 NAVAJO RD	BEND, OR 97702	NOPH	23-302-DR
JENSVOLD, JACOB SHELDON		59947 CHEYENNE RD	BEND, OR 97702	NOPH	23-302-DR
JERRY & YVONNE PAXTON REVOCABLE TRUST	PAXTON, JERRY R TTEE	19747 MANZANITA LN	BEND, OR 97702	NOPH	23-302-DR
JIMENEZ, JAIRO		61141 S HWY 97 ## 602	BEND, OR 97702-2523	NOPH	23-302-DR
JOHN A KOBLE TRUST	KOBLE, JOHN A TTEE	59800 CHEYENNE RD	BEND, OR 97702	NOPH	23-302-DR
JOHNSON, GEORGE L		60311 ADDIE TRIPLETT LOOP	BEND, OR 97702	NOPH	23-302-DR
JOHNSON, KENA & KARL, SCOTT		19766 BUCK CANYON RD	BEND, OR 97702	NOPH	23-302-DR
JONES, GARY M & SANDRA A		59870 CHEYENNE RD	BEND, OR 97702	NOPH	23-302-DR
JONES, GREGORY J & JULIA V		2650 W 6TH ST	WASHOUGAL, WA 98671	NOPH	23-302-DR
JONES, KATHLEEN & RALPH, DANIEL		2660 NE HWY 20 #610-413	BEND, OR 97701	NOPH	23-302-DR
K B-3 LLC		55375 BIG RIVER DR	BEND, OR 97707	NOPH	23-302-DR
KALOKE, RICHARD P & BRANDEE M		59935 NAVAJO RD	BEND, OR 97702	NOPH	23-302-DR
KATHLEEN F DONOHUE REVOCABLE TRUST	DONOHUE, KATHLEEN F TTEE	19742 MANZANITA LN	BEND, OR 97702	NOPH	23-302-DR
KEEPERS, ROBERT S & LINDA B		60319 ADDIE TRIPLETT LP	BEND, OR 97702	NOPH	23-302-DR
KENTNER, MICHAEL D		59998 CHEYENNE RD	BEND, OR 97702	NOPH	23-302-DR
KERR, HODGE & DEBORA NORENE		59691 CHEYENNE RD	BEND, OR 97702	NOPH	23-302-DR
KEYSER, JOHN M & PAMELA A		21345 SW EDY RD	SHERWOOD, OR 97140	NOPH	23-302-DR
KINCANNON, PAUL & MEGHAN		60393 CINDER BUTTE RD	BEND, OR 97702	NOPH	23-302-DR
KINNARD JOINT LIVING TRUST	KINNARD, JEFFERY L & ROSEMARY E	60339 CINDER BUTTE RD	BEND, OR 97702	NOPH	23-302-DR
KOLANDER, KIM JANEEN	TTEES	60333 CINDER BUTTE RD	BEND, OR 97702	NOPH	23-302-DR
KOOK, KEEGAN		60267 ADDIE TRIPLETT LOOP	BEND, OR 97702	NOPH	23-302-DR
KRUEGER, EILEEN A		19737 BAKER RD	BEND, OR 97701-7961	NOPH	23-302-DR
LAIRSON, ROSEANN		60196 NAVAJO RD	BEND, OR 97702	NOPH	23-302-DR
LANG, MARTIN J & PAULETTE M		59797 CHEYENNE RD	BEND, OR 97702	NOPH	23-302-DR
LANGENHUYSEN, ELLIOT K		60475 ZUNI RD	BEND, OR 97702	NOPH	23-302-DR
LARA, MICHAEL M II		60197 CHEYENNE RD	BEND, OR 97702	NOPH	23-302-DR
LARSEN FAMILY TRUST	LARSEN, DARRYL A & MELINDA J	59766 CHEYENNE RD	BEND, OR 97702	NOPH	23-302-DR
LARSEN, TROY DARROLL	TTEES	PO BOX 8268	BEND, OR 97708	NOPH	23-302-DR
LASSILA, DAVID H & RENE M		59828 NAVAJO RD	BEND, OR 97702	NOPH	23-302-DR
LEBART, JUSTIN M ET AL		19789 ROCKING HORSE RD	BEND, OR 97702	NOPH	23-302-DR
LEDFORD, THOMAS L & DONNA J		60108 NAVAJO RD	BEND, OR 97702	NOPH	23-302-DR
LEIGHTY, MICHELLE C & REEVES, ASHLIN		59968 CHEYENNE RD	BEND, OR 97702	NOPH	23-302-DR
LINDSLEY, ROBERT S		60426 POCAHONTAS LN	BEND, OR 97702	NOPH	23-302-DR
LINSTAD, RYAN PATRICK		19700 MANZANITA LN	BEND, OR 97702	NOPH	23-302-DR
LIU, DAVID		60330 CINDER BUTTE RD	BEND, OR 97702	NOPH	23-302-DR
LOCKE, WALTER CRAIG ET AL		3383 NW FAIRWAY HEIGHTS DR	BEND, OR 97703	NOPH	23-302-DR
LOCKLING, MICHAEL ET AL		19685 BAKER RD	BEND, OR 97702	NOPH	23-302-DR
LOEKS FAMILY LIVING TRUST		19720 BAKER RD	BEND, OR 97702	NOPH	23-302-DR
LOVERSO, PETER R & ACOSTA, MONIKA M		16368 EMERALD GREEN LN	JEFFERSON, OR 97352	NOPH	23-302-DR
LUCERO, CHRISTINE A & HILL, JOHN		19508 CHEROKEE RD	BEND, OR 97702	NOPH	23-302-DR
MACHACEK, GARY & PATRICIA		19722 MANZANITA LN	BEND, OR 97702	NOPH	23-302-DR
MAQUET, JOSHUA		1359 32ND AVE S	SEATTLE, WA 98114-3926	NOPH	23-302-DR
MARIE CELESTINO TRUST	CELESTINO, MARIE MARINA TRUSTEE	PO BOX 2142	BEND, OR 97709-4131	NOPH	23-302-DR
MARTIN, NOEL MAKENA & TRAVIS PATRICK		9608 OAKDALE AVE	CHATSWORTH, CA 91311	NOPH	23-302-DR
MASINGALE, DARIEN & CHRISTINE		59610 NAVAJO CIR	BEND, OR 97702	NOPH	23-302-DR
MASTERS, DANIEL T & HILBURN, MELANIE A		60061 CHEYENNE RD	BEND, OR 97702	NOPH	23-302-DR
MAYO, CURTIS E & MICHELLE D		59735 CHEYENNE RD	BEND, OR 97702	NOPH	23-302-DR
MCKEIRNAN, ROBIN R & MAURICE A		59865 CHEYENNE RD	BEND, OR 97702	NOPH	23-302-DR
MCNAUGHTON-VANOVER LIVING TRUST	MCNAUGHTON, DAVID K TTEE ET AL	60248 NAVAJO RD	BEND, OR 97702	NOPH	23-302-DR
		65230 94TH ST	BEND, OR 97703	NOPH	23-302-DR

MCWILLIAMS, TRACY A		60373 CINDER BUTTE RD	BEND, OR 97702	NOPH	23-302-DR
MEALEY, JOAN E		PO BOX 6653	BEND, OR 97708-6653	NOPH	23-302-DR
MEEKS, JAMES NACY & TERA ROXAN		59665 CHEYENNE RD	BEND, OR 97701	NOPH	23-302-DR
MENDEZ, LUIS ALBERTO VILLANUEVA		60020 CHEYENNE RD	BEND, OR 97702	NOPH	23-302-DR
MICHAEL KOZAK REVOCABLE LIVING TRUST	KOZAK, MICHAEL TRUSTEE	PO BOX 271	BEND, OR 97709	NOPH	23-302-DR
MILLER, PATRICIA A		59811 CHEYENNE RD	BEND, OR 97702	NOPH	23-302-DR
MITTAN, KYLE GLENN & CHELSEA ANNE		59712 NAVAJO RD	BEND, OR 97702	NOPH	23-302-DR
MONE, ERIC A & SAMANTHA E		59637 CHEYENNE RD	BEND, OR 97702	NOPH	23-302-DR
MONROE, BRANDON & KYMBERLY		59707 CHEYENNE RD	BEND, OR 97702	NOPH	23-302-DR
MONTGOMERY, GARRETT ET AL		59823 CHEYENNE RD	BEND, OR 97702	NOPH	23-302-DR
MORALES, REYES NAVA		59951 CHEYENNE RD	BEND, OR 97702	NOPH	23-302-DR
MORGAN WILLIAM SMITH FAM REV LIV TRUST	SMITH, MORGAN W TTEE	19805 BUCK CANYON RD	BEND, OR 97702	NOPH	23-302-DR
MORGAN, VINCENT J & AMANDA		59609 NAVAJO CIR	BEND, OR 97702	NOPH	23-302-DR
MORISSETTE, LANCE & KRISTINA R		19483 COMANCHE LN	BEND, OR 97702	NOPH	23-302-DR
MORITZ, JOSEPH E & PAMELA A		59930 NAVAJO RD	BEND, OR 97702	NOPH	23-302-DR
MORNING STAR CHRISTIAN SCHOOL		19741 BAKER RD	BEND, OR 97702	NOPH	23-302-DR
MORRISON, COLIN & STEPHANIE		60308 ADDIE TRIPLETT LOOP	BEND, OR 97702	NOPH	23-302-DR
MOUNTAIN PINES PUD OWNERS' ASSOCIATION	C/O MILE HIGH MANAGEMENT	PO BOX 1048	BEND, OR 97709	NOPH	23-302-DR
MURRAY, ALEXANDRE & HANNAH Z	MUSSER, GEORGE CALVERT TTEE ET AL	60083 CHEYENNE RD	BEND, OR 97702	NOPH	23-302-DR
MUSSER FAMILY TRUST		16404 S MOORE RD	OREGON CITY, OR 97045	NOPH	23-302-DR
NAIRN, SAMANTHA		59774 CHEYENNE RD	BEND, OR 97702	NOPH	23-302-DR
NICKLAW, JOHN O		59706 NAVAJO RD	BEND, OR 97702	NOPH	23-302-DR
NICKLAW, DAVID A & TINA M		59700 NAVAJO RD	BEND, OR 97702	NOPH	23-302-DR
NORRIS, CHRISTOPHER D & JANET W		60312 ADDIE TRIPLETT LOOP	BEND, OR 97702	NOPH	23-302-DR
NORRIS, MICHAEL J		59644 CHEYENNE RD	BEND, OR 97702	NOPH	23-302-DR
NORRIS, WILLIAM D & BONNIE T		59790 NAVAJO RD	BEND, OR 97702	NOPH	23-302-DR
OATHES, DELORIS MAE		19692 BAKER RD	BEND, OR 97702	NOPH	23-302-DR
O'CONNELL, CRYSTAL M ET AL		61382 GEARY DR	BEND, OR 97702	NOPH	23-302-DR
OLEACHEA, GARRY & JENNIFER		59895 CHEYENNE RD	BEND, OR 97702	NOPH	23-302-DR
OLSEN, SANDRA P		59820 CHEYENNE RD	BEND, OR 97702	NOPH	23-302-DR
OLSEN, SANDRA P		59820 CHEYENNE RD	BEND, OR 97702	NOPH	23-302-DR
OREGON HIGH DESERT MUSEUM		59800 S HWY 97	BEND, OR 97702	NOPH	23-302-DR
ORRICO, NICHOLAS A		60287 ADDIE TRIPLETT LOOP	BEND, OR 97702	NOPH	23-302-DR
ORTIZ, JOSE MANUEL ET AL		59920 CHEYENNE RD	BEND, OR 97702	NOPH	23-302-DR
OVERTON, AVERY		59871 CHEYENNE RD	BEND, OR 97702	NOPH	23-302-DR
PACIFICORP		825 NE MULTNOMAH #STE 1900	PORTLAND, OR 97232	NOPH	23-302-DR
PAHLISCH, DENNIS & BEVERLY		210 SW WILSON AVE #100	BEND, OR 97702	NOPH	23-302-DR
PALMER, MICHAEL W & TERESA A		60345 CINDER BUTTE RD	BEND, OR 97702	NOPH	23-302-DR
PALMESE, WILLIAM S		59819 CHEYENNE RD	BEND, OR 97702	NOPH	23-302-DR
PANICO FAMILY TRUST	PANICO, PAUL JOHN TTEE ETAL	8 HILTON HEAD	RANCHO MIRAGE, CA 92270	NOPH	23-302-DR
PAT & CINDY BAGHDIKIAN 2011 REV LIV TR	BAGHDIKIAN, CYNTHIA MARIE TTEE ET AL	PO BOX 8952	SOUTH LAKE TAHOE, CA 96158	NOPH	23-302-DR
PATE, TINA LOUISE		1906 BRAINERD CT	LUTZ, FL 33549	NOPH	23-302-DR
PAULSON FAMILY TRUST	PAULSON, KARL A & MARY A TTEES	3194 NW FAIRWAY HEIGHTS DR	BEND, OR 97703	NOPH	23-302-DR
PECK, ANDREW D		59620 NAVAJO CIR	BEND, OR 97702	NOPH	23-302-DR
PEETERS, CHRISTIAN & RACHAEL ET AL		60260 ADDIE TRIPLETT LOOP	BEND, OR 97702	NOPH	23-302-DR
PEFFERLE LIVING TRUST	PEFFERLE, RANDALL TTEE	59656 NAVAJO RD	BEND, OR 97702	NOPH	23-302-DR
PEIL, RICHARD R & CYNTHIA M		60680 ROCKING HORSE RD	BEND, OR 97702	NOPH	23-302-DR
PENNY DARLENE ALCORN LIVING TRUST	ALCORN, PENNY DARLENE TTEE	2856 DOS LOMAS	FALLBROOK, CA 92028	NOPH	23-302-DR
PERKINS, CARL W		60060 NAVAJO RD	BEND, OR 97702	NOPH	23-302-DR
PERRINE, BRIAN S		59626 NAVAJO CIR	BEND, OR 97702	NOPH	23-302-DR
PETERSON, WILLIAM N		PO BOX 1923	BEAVERTON, OR 97075	NOPH	23-302-DR
PHELPS FAMILY TRUST	PHELPS, BARTON P II & LINDA J TTEES	60395 CINDER BUTTE RD	BEND, OR 97702	NOPH	23-302-DR
PHELPS, MATTHEW & DANIELLE		60182 NAVAJO RD	BEND, OR 97702	NOPH	23-302-DR
PINEDA, JORGE LUIS & ARMINDA		60292 CINDER BUTTE RD	BEND, OR 97702	NOPH	23-302-DR
PONDEROSA PINE ESTATES LLC		475 NE BELLEVUE AVE #210	BEND, OR 97701	NOPH	23-302-DR
PONDEROSA TRUST	SET SAIL LLC, TTEE	3225 MCLEOD DR #777	LAS VEGAS, NV 89121	NOPH	23-302-DR
PRIDAY, COURTNEY RYAN ET AL		19745 BAKER RD	BEND, OR 97702	NOPH	23-302-DR
PURCELL, MARK S & ROSEMARY Y		3554 CHINOOK ST	LONGVIEW, WA 98632	NOPH	23-302-DR
PUTNAM JOINT REVOCABLE LIVING TRUST	PUTNAM, DIANA M & LAWRENCE J TTEES	59988 NAVAJO RD	BEND, OR 97702	NOPH	23-302-DR
QUARREL, JOHNATHON & COOLEY, LAUREN		60264 NAVAJO RD	BEND, OR 97702	NOPH	23-302-DR
RADCLIFF, ROY ALAN & TERRI L		60310 CINDER BUTTE RD	BEND, OR 97702	NOPH	23-302-DR
RALEY, NICKLES J		59730 CHEYENNE RD	BEND, OR 97702	NOPH	23-302-DR
RAY, VALERIE A		59937 CHEYENNE RD	BEND, OR 97702	NOPH	23-302-DR
RAYMOND, MICHAEL		60444 POCAHONTAS LN	BEND, OR 97702	NOPH	23-302-DR
RAZO, JUAN C & ROSAURA		60405 POCAHONTAS LN	BEND, OR 97702	NOPH	23-302-DR
REBECCA ANDERSON REVOCABLE TRUST	ANDERSON, REBECCA TTEE	60279 ADDIE TRIPLETT LOOP	BEND, OR 97702	NOPH	23-302-DR

REBTEB LLC		2157 NE KIM LN	BEND, OR 97701	NOPH	23-302-DR
RED BARN INVESTMENTS LLC		PO BOX 2234	BEND, OR 97709	NOPH	23-302-DR
RHOADES, DANIEL S L & SHARON GAYE		19683 PLATINUM WAY	BEND, OR 97702	NOPH	23-302-DR
RICHARDS, JEFF & LISA G		60116 NAVAJO RD	BEND, OR 97702	NOPH	23-302-DR
RICHARDSON, JENNIFER A ET AL		19358 MOHAWK RD	BEND, OR 97702	NOPH	23-302-DR
RICKETSON, RUSSELL R		60179 CHEYENNE RD	BEND, OR 97702	NOPH	23-302-DR
RIGGS FAMILY TRUST	RIGGS, ROBERT GRANT TTEE ET AL	19552 E CAMPBELL RD	BEND, OR 97702	NOPH	23-302-DR
RIGNEY, MARK L		60812 GRANITE DR	BEND, OR 97702	NOPH	23-302-DR
ROBERTSON, BLAKE & SPANI, JESANN		11 E ALLISON ST #2	SEATTLE, WA 98102	NOPH	23-302-DR
ROBERTSON, KELLY M & PETER L		59754 CHEYENNE RD	BEND, OR 97702	NOPH	23-302-DR
ROBERTSON, PETE L & HAMILTON, KELLY M		59754 CHEYENNE RD	BEND, OR 97702	NOPH	23-302-DR
RODGERS, SHERRY A		66230 BARR RD	BEND, OR 97703	NOPH	23-302-DR
ROGER A KADEL TRUST ET AL	KADEL, ROGER A & JANET S TTEES	22415 SW 65TH AVE	TUALATIN, OR 97062	NOPH	23-302-DR
ROGERS, BARRY D		59892 NAVAJO RD	BEND, OR 97702	NOPH	23-302-DR
ROGERS, DAMON J		PO BOX 295	LOMITA, CA 90717-9998	NOPH	23-302-DR
ROGERS, LYDIA A		23043 MAPLE AVE #B-625	TORRANCE, CA 90505	NOPH	23-302-DR
ROGERS, VIRGINIA J & DAMON A		PO BOX 295	LOMITA, CA 90717-9998	NOPH	23-302-DR
ROLANDSON, SHELLY ANN		59922 NAVAJO RD	BEND, OR 97702	NOPH	23-302-DR
ROSE, CATHLEEN		PO BOX 265	MT VERNON, OR 97865	NOPH	23-302-DR
ROSS, CAMERON & BETH		59697 CHEYENNE RD	BEND, OR 97702	NOPH	23-302-DR
RUIZ, ANDREW M & OSBERG, ERIN C		59898 NAVAJO RD	BEND, OR 97702	NOPH	23-302-DR
RUSH, MICHAEL A		59744 NAVAJO RD	BEND, OR 97702	NOPH	23-302-DR
RUSSELL, STEPHEN G & DENA M		19850 ROCKING HORSE RD	BEND, OR 97702-8942	NOPH	23-302-DR
RUSSENBERGER, MARCEL		60483 UMATILLA CIR	BEND, OR 97702	NOPH	23-302-DR
RUTH ANN HERZER FAMILY TRUST	HERZER, RUTH ANN TTEE HILDEBRANDT, WARREN R & VICTORIA B TTEES	PO BOX 7762	BEND, OR 97708	NOPH	23-302-DR
RV TRUST		8180 MANITOBA ST #320	PLAYA DEL REY, CA 90293	NOPH	23-302-DR
SALISBURY, ANTHONY RAY ET AL		60121 CHEYENNE RD	BEND, OR 97702	NOPH	23-302-DR
SAMS, RAYMOND D & CINDY M		19873 ROCKING HORSE RD	BEND, OR 97702	NOPH	23-302-DR
SANTANA, EDUARDO D & SANTANA, MAYRA A		59860 CHEYENNE RD	BEND, OR 97702	NOPH	23-302-DR
SCHNEIDER, VIRGINIA L		61535 S HWY 97 #174	BEND, OR 97702	NOPH	23-302-DR
SELLERS, ASHLEY K	BOTTEN, MELISSA (CB)	4808 MILL CREEK TRL	FORT WORTH, TX 76092	NOPH	23-302-DR
SHIIKI, BETH A		9512 NE 56TH CT	VANCOUVER, WA 98665-8253	NOPH	23-302-DR
SHONKA, PAUL J & CINDY B		19776 BUCK CANYON RD	BEND, OR 97702	NOPH	23-302-DR
SIEG, AVEL G		55 EL CID PL	SPARKS, NV 89441	NOPH	23-302-DR
SILVEY, GUY WILLIAM ET AL		60175 CHEYENNE RD	BEND, OR 97702	NOPH	23-302-DR
SIMPSON, DANIEL B & SUSAN L		60302 CINDER BUTTE RD	BEND, OR 97702	NOPH	23-302-DR
SKELTON, PATRICK R & BRENDA J		59904 NAVAJO RD	BEND, OR 97702	NOPH	23-302-DR
SMITH, DANIEL S & NATASHA M		20071 SHADY PINE PL	BEND, OR 97702	NOPH	23-302-DR
SMITH, ELIZABETH		59657 CHEYENNE RD	BEND, OR 97702	NOPH	23-302-DR
SMITH, FREDRICK S & ETHEL M		3249 SUMMER BREEZE AVE	ROSAMOND, CA 93560	NOPH	23-302-DR
SMITH, JAMES L & CINDY L		60245 CHEYENNE RD	BEND, OR 97702	NOPH	23-302-DR
SNELL, THOMAS D & SHANNA L		19825 ROCKING HORSE RD	BEND, OR 97702	NOPH	23-302-DR
SOUTH 97 LLC		20335 FAIRWAY DR	BEND, OR 97702	NOPH	23-302-DR
SPATRISANO, KATRINA & DENTON, CHAD		59925 CHEYENNE RD	BEND, OR 97702	NOPH	23-302-DR
SPECIAL NEEDS TRUST FBO KAY O GREER	JOHN S & BARBARA C OTTONE FAM TRUST SPERLING, DAVID J & PATRICIA M TTEES	C/O LINDSEY BERG & JOSEPH GREER	20631 MARY WAY BEND, OR 97701	NOPH	23-302-DR
SPERLING LIVING TRUST		20524 BRIGHTENWOOD CIR	BEND, OR 97702	NOPH	23-302-DR
STALEY, MATHEW T & RANAE M		59990 NAVAJO RD	BEND, OR 97702	NOPH	23-302-DR
STANLEY, JAMIE		60526 CHICKASAW WAY	BEND, OR 97702	NOPH	23-302-DR
STATE OF OREGON DEPT OF TRANSPORTATION		4040 FAIRVIEW INDUSTRIAL DR SE #MS 2	SALEM, OR 97302-1142	NOPH	23-302-DR
STEED, WILLIAM JOSEPH & JESSICA CHERI		19730 MANZANITA LN	BEND, OR 97702	NOPH	23-302-DR
STEELEY, DAVID A & LINDA KAY		60029 CHEYENNE RD	BEND, OR 97702	NOPH	23-302-DR
STEPHAN, GEORGE & PATRICIA		60259 ADDIE TRIPLETT LOOP	BEND, OR 97702	NOPH	23-302-DR
STEPHEN MARSH REV TRUST	MARSH, STEPHEN TTEE	60315 ADDIE TRIPLETT LOOP	BEND, OR 97702	NOPH	23-302-DR
STEPHEN W ROBERTS TRUST	ROBERTS, STEPHEN W TTEE	19502 COMMANCHE LN	BEND, OR 97702	NOPH	23-302-DR
STEVENS, WILLIAM KENT & ROSE MARIE		19505 COMANCHE LN	BEND, OR 97702	NOPH	23-302-DR
STIFF, BRYAN W & DONNA F		19772 BUCK CANYON RD	BEND, OR 97702	NOPH	23-302-DR
STILLWATER MANAGERS LLC		131 S HIGGINS #STE P-1	MISSOULA, MT 59802	NOPH	23-302-DR
STOCKAMP, MARK C		60204 NAVAJO RD	BEND, OR 97702	NOPH	23-302-DR
STOLBERG, RYAN & WOOD, MEGUMI		60295 ADDIE TRIPLETT LOOP	BEND, OR 97702	NOPH	23-302-DR
STONEGATE OWNERS ASSOCIATION		PO BOX 7384	REDMOND, OR 97708-7384	NOPH	23-302-DR
STORLIE, CHRISTOPHER		1051 SW CROSSCUT	BEND, OR 97701	NOPH	23-302-DR
STROHECKER, SHAWN W		19672 BAKER RD	BEND, OR 97702	NOPH	23-302-DR
STRONG, STANLEY M & JOYCE A		19966 WAGON TREE CT	BEND, OR 97702	NOPH	23-302-DR
STUART, HENRY C III & MILLER, MICHELLE A		60225 CHEYENNE RD	BEND, OR 97702	NOPH	23-302-DR
SURVIVORS TRUST	ROGERS, SCOTT V TTEES	27024 WOODBROOK RD	RANCHO PALOS VERDES, CA 90275	NOPH	23-302-DR
SWEET, NATHANIEL DAVID		14925 S CLAIM RD	MOLLALA, OR 97038	NOPH	23-302-DR

SZIGETI, RYDER		61386 GEARY DR	BEND, OR 97702	NOPH	23-302-DR	
TERRY L & CANDICE E ANDERSON LIV TRUST	ANDERSON, TERRY L & CANDICE E	PO BOX 2185	SISTERS, OR 97759	NOPH	23-302-DR	
TEXEIRA, JOHN	TTEES	59956 NAVAJO RD	BEND, OR 97702	NOPH	23-302-DR	
THOMPSON, JEFF S & HEATHER L		59862 NAVAJO RD	BEND, OR 97702	NOPH	23-302-DR	
THORN, ANDREW		5020 HIDDEN CREEK LN	FAIR OAKS, CA 95628-4111	NOPH	23-302-DR	
THORSTROM, MICHELLE A		60169 CHEYENNE RD	BEND, OR 97702	NOPH	23-302-DR	
THUMB LLC		20505 MURPHY RD	BEND, OR 97702	NOPH	23-302-DR	
TRACIE LORAIN LAYMAN LIV TRUST	LAYMAN, TRACIE LORAIN TTEE	60254 ADDIE TRIPLETT LOOP	BEND, OR 97702	NOPH	23-302-DR	
UEHLIN, TROY N & BRANDEE		19955 WAGON TREE CT	BEND, OR 97702	NOPH	23-302-DR	
URIZ, DANIEL J & TAMERA A		19770 BUCK CANYON RD	BEND, OR 97702	NOPH	23-302-DR	
URTON, BRIAN D		59822 NAVAJO RD	BEND, OR 97702	NOPH	23-302-DR	
VAN VLIET, MARTIN T & DEBBIE D		60155 CHEYENNE RD	BEND, OR 97702	NOPH	23-302-DR	
VANDERPOOL, JON K		60174 NAVAJO RD	BEND, OR 97702	NOPH	23-302-DR	
VEEK FAMILY REVOCABLE LIVING TRUST	VEEK, JEFFREY ARTHUR TTEE ET AL	60148 NAVAJO RD	BEND, OR 97702	NOPH	23-302-DR	
WAISNER, CLARA B		19700 BAKER RD	BEND, OR 97702	NOPH	23-302-DR	
WAITE, BRIAN		60811 GRANITE DR	BEND, OR 97702	NOPH	23-302-DR	
WALLACE, JERRY J		59936 CHEYENNE RD	BEND, OR 97702	NOPH	23-302-DR	
WALLACE, STEPHANIE L		19696 MANZANITA LN	BEND, OR 97702	NOPH	23-302-DR	
WARREN, JAMES R		60313 CINDER BUTTE RD	BEND, OR 97702	NOPH	23-302-DR	
WATNE, RYAN P		60100 NAVAJO RD	BEND, OR 97702	NOPH	23-302-DR	
WEIGAND, GREGORY LOUIS		59842 NAVAJO RD	BEND, OR 97702	NOPH	23-302-DR	
WESTFALL, BRENT C		60224 NAVAJO RD	BEND, OR 97702	NOPH	23-302-DR	
WHITE, IAN & CURRIE, JACQUELINE		60193 CHEYENNE RD	BEND, OR 97702	NOPH	23-302-DR	
WHITE, TERRY L		60060 CHEYENNE RD	BEND, OR 97702	NOPH	23-302-DR	
WHITNEY, DENISE		61149 S HWY 97 #178	BEND, OR 97702	NOPH	23-302-DR	
WHITWORTH, GREGORY A & AMY DARLYNE		59633 NAVAJO CIR	BEND, OR 97702	NOPH	23-302-DR	
WILLIAM & KARLIN CONKLIN TRUST ET AL	CONKLIN, WILLIAM P & KARLIN M	59935 NAVAJO RD	BEND, OR 97702	NOPH	23-302-DR	
	TTEES					
	HOFFMAN, WILLIAM R & SHERYLE Y					
	TTEES					
WILLIAM R & SHERYLE Y HOFFMAN TRUST		60181 CHEYENNE RD	BEND, OR 97702	NOPH	23-302-DR	
WILLIAMS, JOHN S & EMILY N		19715 MANZANITA LN	BEND, OR 97702	NOPH	23-302-DR	
WINDLINX RANCH TRUST		59850 SCALE HOUSE RD	BEND, OR 97702	NOPH	23-302-DR	rwindlinx@empnet.com
WINDLINX, FREDERICK R	WINDLINX, ROBERT H JR TTEE	59895 SCALE HOUSE RD	BEND, OR 97702	NOPH	23-302-DR	
WINDLINX, FREDRICK R		59885 SCALE HOUSE RD	BEND, OR 97702	NOPH	23-302-DR	
WINDLINX, RICHARD S & KARIN A		60025 SCALE HOUSE RD	BEND, OR 97702	NOPH	23-302-DR	
WOLFINGER, DWIGHT		60221 CHEYENNE RD	BEND, OR 97702	NOPH	23-302-DR	
WOLTER, KRISTIN K		19738 MANZANITA LN	BEND, OR 97702	NOPH	23-302-DR	
WOOD, BRUCE A & ERTHA MAE		20063 SHADY PINE PL	BEND, OR 97702	NOPH	23-302-DR	
WUERTHNER, GEORGE		PO BOX 8359	BEND, OR 97708	NOPH	23-302-DR	
ZIVNEY, BRYAN CHRISTOPHER & CADY		19736 MANZANITA LN	BEND, OR 97702	NOPH	23-302-DR	
ZOEPHEL, CARL		59878 NAVAJO RD	BEND, OR 97702	NOPH	23-302-DR	
Christopher P. Koback		1331 NW Lovejoy Street, Suite 950	Portland, OR 97209	NOPH	23-302-DR	chris@hathawaylarrison.com
Dana Whitelaw	Oregon DOJ Counsel			NOPH	23-302-DR	dwhitelaw@highdesertmuseum.org
Stacy C. Posegate				NOPH	23-302-DR	stacy.c.posegate@doj.state.or.us
Ken Shonkwiler		63055 N. Hwy 97, Bldg M	Bend OR 97703	NOPH	23-302-DR	Kenneth.d.shonkwiler@odot.oregon.gov