

OPTION 1 - RIGHT TURN CHANNELIZATION**KEY POINTS**

- 0.2 Ac +/- ROW Acquisition
- Pavement widening to add buffered right turn lane with thru bike lane
- Consider increasing left turn visibility/efficiency by increasing right turn length, but balance against PGE impacts
- No change to BLM recreation area access

**OPTION 2 - REALIGNMENT****KEY POINTS**

- 2.8 Ac +/- ROW Acquisition
- 2.5 Ac +/- Excess ROW
- 2,600 LF +/- of new roadway
- Significant overlap with PGE and BPA facilities
- No change to BLM recreation area access

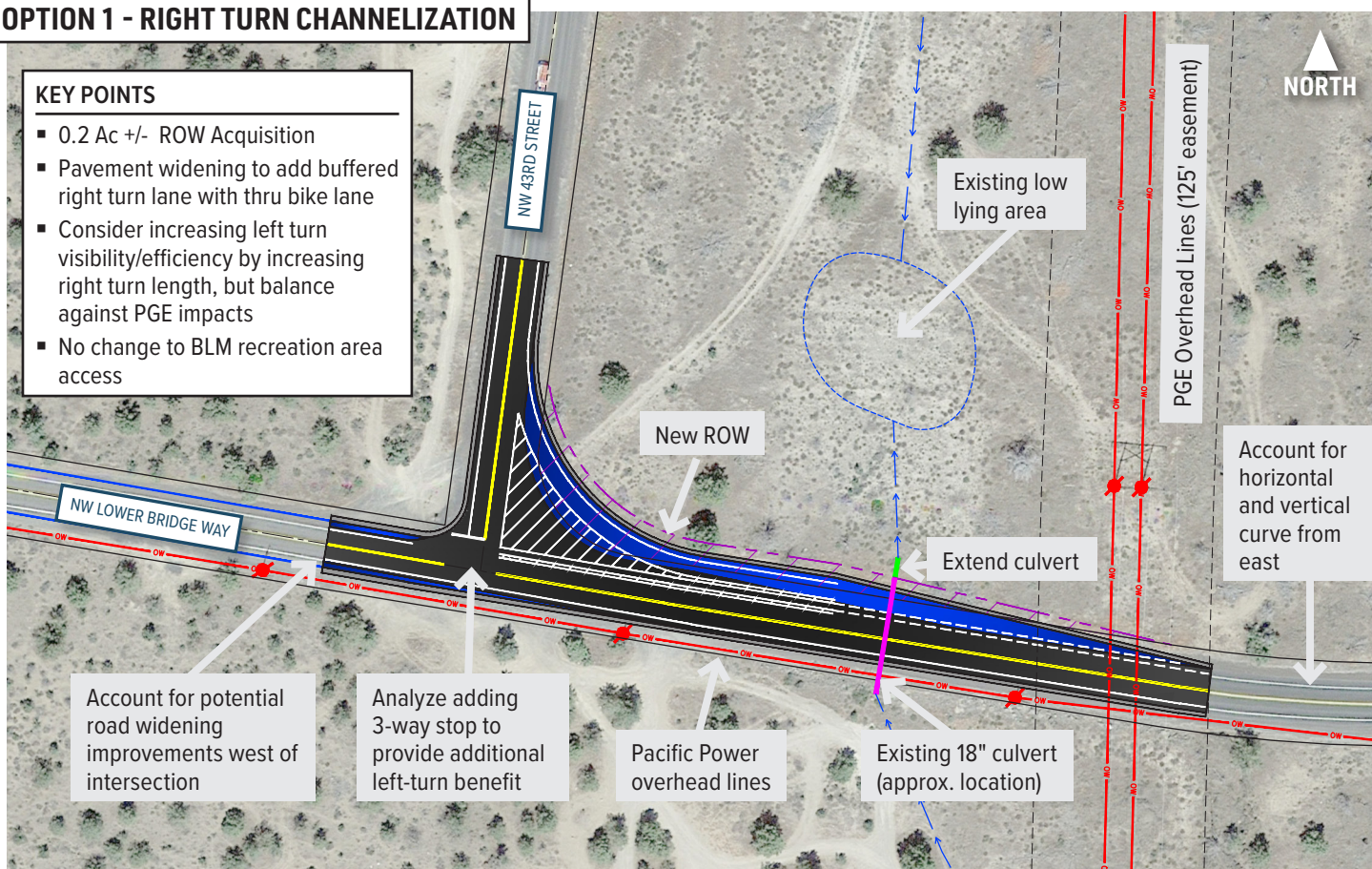
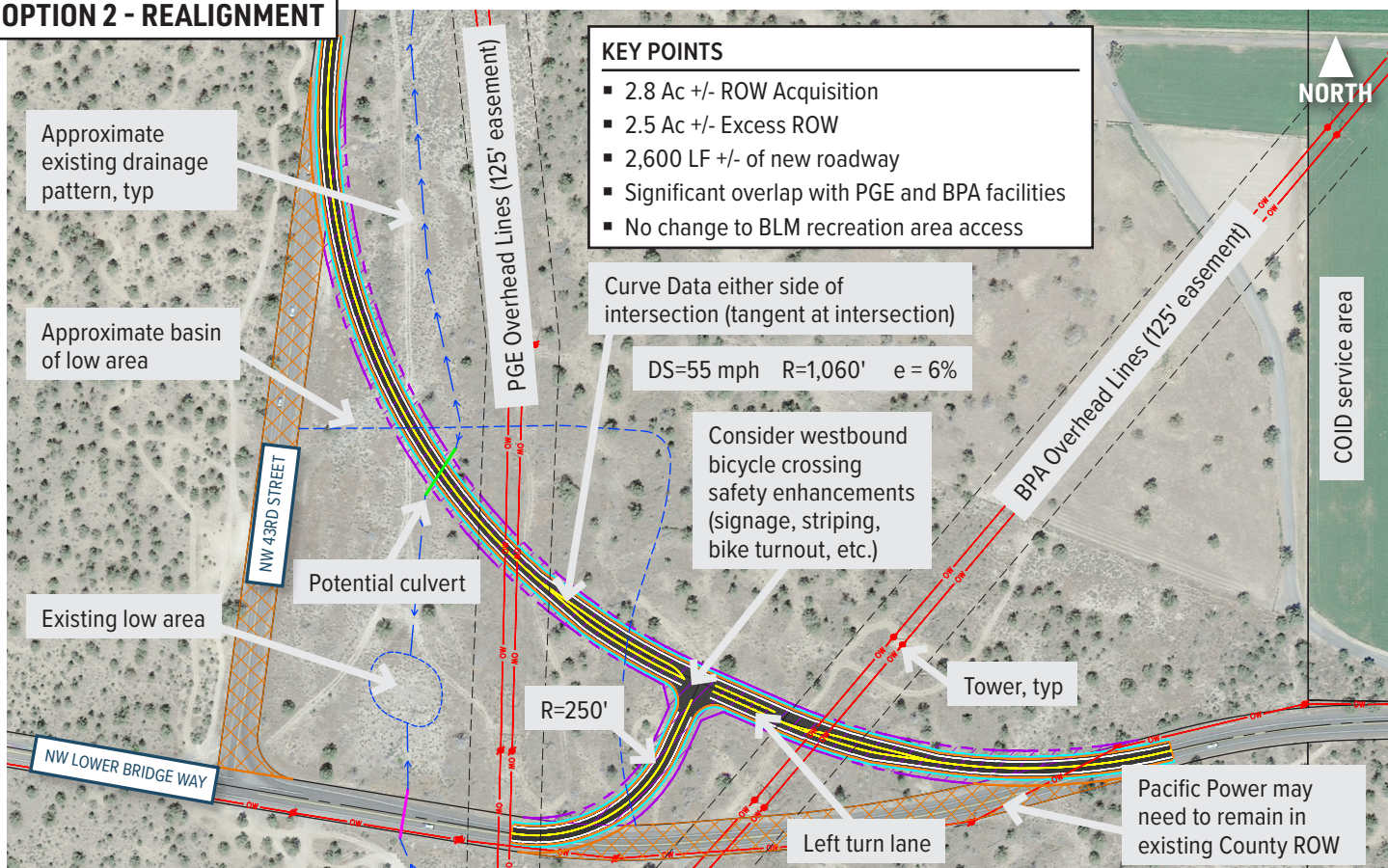

OPTION 3 - ROUNDABOUT

KEY POINTS

- 1.9 Ac +/- ROW Acquisition
- Smaller footprint may meet all project objectives and accommodate future traffic from west
- Compatible with STSRSB
- Avoids utilities
- No change to BLM recreation area access
- Requires illumination, but can investigate options for reduced lighting due to rural location

