

**BUILDING A**  
 (2) BUILDING'S TOTAL  
 (8) 1-BDRM UNITS  
 FOOTPRINT - 3,744 S.F.  
 MAXIMUM HEIGHT - 35'-0"± (2) STORY  
 OCCUPANCY R-2  
 FULLY SPRINKLERED PER NFPA 13R  
 CONSTRUCTION TYPE: VB

**BUILDING B**  
 (3) BUILDING'S TOTAL  
 (8) 2-BDRM UNITS  
 FOOTPRINT - 4,207 S.F.  
 MAXIMUM HEIGHT - 35'-0"± (2) STORY  
 OCCUPANCY R-2  
 FULLY SPRINKLERED PER NFPA 13R  
 CONSTRUCTION TYPE: VB

**BUILDING C**  
 (2) BUILDING'S TOTAL  
 (8) 3-BDRM UNITS  
 FOOTPRINT - 5,427 S.F.  
 MAXIMUM HEIGHT - 35'-0"± (2) STORY  
 OCCUPANCY R-2  
 FULLY SPRINKLERED PER NFPA 13R  
 CONSTRUCTION TYPE: VB

**BUILDING D**  
 (1) BUILDING'S TOTAL  
 (4) 3-BDRM UNITS  
 FOOTPRINT - 5,427 S.F.  
 MAXIMUM HEIGHT - 24'-0"± (1) STORY  
 OCCUPANCY R-2  
 FULLY SPRINKLERED PER NFPA 13R  
 CONSTRUCTION TYPE: VB

**COMMUNITY BUILDING**  
 (1) BUILDING TOTAL  
 FOOTPRINT - 3,498 S.F.  
 MAXIMUM HEIGHT - 24'-0"± (1) STORY  
 OCCUPANCY B/A-3  
 FULLY SPRINKLERED PER NFPA 13  
 CONSTRUCTION TYPE: VB

**APPLICANT**  
 DANCO GROUP  
 CHRIS DART  
 5251 ERICSON WAY  
 ARCATA, CALIFORNIA 95521  
 (707) 822-9000

**ARCHITECT**  
 DG GROUP ARCHITECTURE, PLLC  
 DOUGLAS GIBSON, AIA  
 430 E. STATE STREET, SUITE 100  
 EAGLE, IDAHO 83616  
 (208)-461-0022 X3021

**ACCESSIBILITY**

	# OF UNITS	PERCENTAGE
VISITABLE UNITS / TYPE B (ALL GRND. FLR. NON-ADA)	29	5.0%
TYPE A / ADA FULLY ACCESSIBLE UNITS (5% TOTAL)	3	5.0%
SENSORY COMMUNICATION UNITS (2% TOTAL)	3	5.0%

**UNIT MIX SUMMARY**

	CONDITIONED SQ. FOOTAGES
(16) 1-BEDROOM UNITS	(16) x 659 S.F. = 10,544 S.F.
(12) 2-BEDROOM UNITS	(12) x 765 S.F. = 9,180 S.F.
(12) 2-BEDROOM-A UNITS	(12) x 749 S.F. = 8,988 S.F.
(12) 3-BEDROOM UNITS	(12) x 1,052 S.F. = 12,624 S.F.
(8) 3-BEDROOM-A UNITS	(8) x 1,037 S.F. = 8,296 S.F.
(60) UNITS TOTAL	49,632 S.F.
COMMUNITY BUILDING	3,289 S.F.
TOTAL	52,921 S.F.

**FIRE SPRINKLER**  
 AUTOMATIC FULLY SPRINKLERED SYSTEM WITH CENTRAL CALL STATION, OFF-SITE MONITORING AND FDC'S

**SITE SIZE**  
 204,730 S.F.± (4.699 ACRES) ±  
 12.77 DWELLING UNITS/ACRE

**ZONING**  
 MIXED USE COMMERCIAL

**SITE COVERAGE**

	SQ. FT.	PERCENTAGE
BUILDING FOOTPRINTS	40,097 S.F.	19.59%
ON-SITE ASPHALT CONCRETE PAVING	63,332 S.F.	30.93%
SITE AMENITIES (PERGOLAS, TOT LOT, DOG PARK, HALF COURT BASKETBALL, COMMUNITY GARDENS)	5,489 S.F.	2.68%
CONCRETE WALKS & PADS	22,264 S.F.	10.87%
LANDSCAPE, OPEN SPACE	73,548 S.F.	35.93%
TOTAL AREA	204,730 S.F.	100%

NOTE: \* ALL NUMBERS PROVIDED ARE ESTIMATED FOR SITE COVERAGE

**PARKING SUMMARY**

**TOTAL MULTI-FAMILY REQUIRED BY CITY OF LA PINE DEVELOPMENT CODE TABLE 15.86-1:**

(16) 1-BDRM UNITS X 1 =	16 SPACES REQUIRED
(24) 2-BDRM UNITS X 1 =	24 SPACES REQUIRED
(20) 3-BDRM UNITS X 1 =	20 SPACES REQUIRED
TOTAL SPACES REQUIRED:	60 SPACES

TOTAL PROVIDED: 142 (INCLUDING 9 ADA SPACES WHICH INCLUDE 3 VAN SPACES, AND 1 USPS SPACE)

BICYCLE PARKING: 46 SPACES TO BE PROVIDED (INCLUDING 4 LONG TERM BICYCLE LOCKERS)

FUTURE ELECTRIC VEHICLE CHARGING STATIONS (EVCS):  
 142 PARKING SPACES \* 0.20 = (29) REQUIRED  
 (30) FUTURE EV SPACES PROVIDED, INCLUDING (1) FUTURE ADA EVCS SPACE AND (1) FUTURE VAN ADA EVCS SPACE

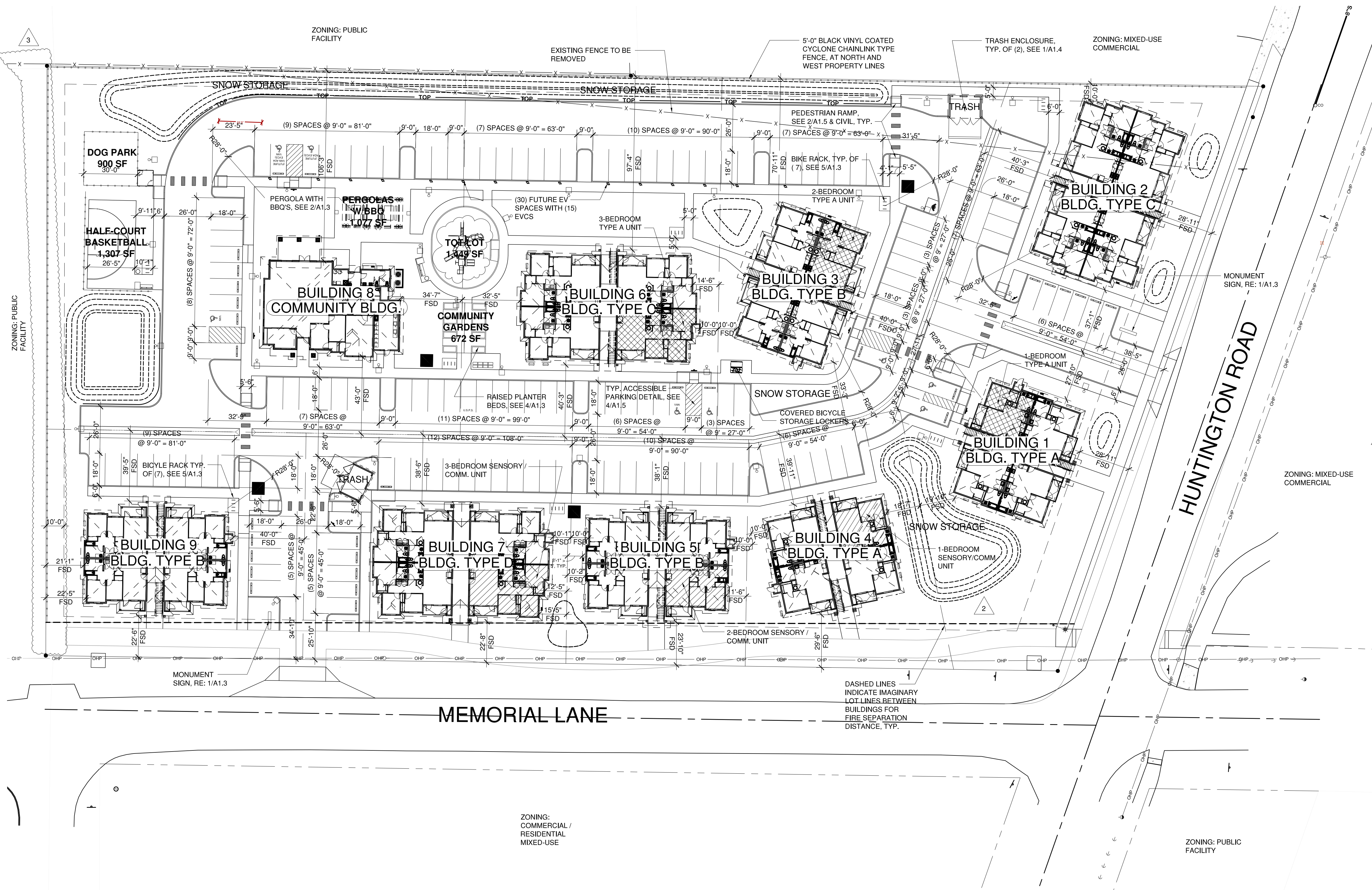

**SITE PLAN**  
 SCALE: 1" = 30'-0"



**REVISIONS**

1	QC/QA & COORDINATION REVISIONS	09/08/23
2	PERMIT PLAN CHECK REVISIONS	09/08/23
3	ASI 02: 3RD PARTY COORDINATION REVISIONS	10/06/23

COPYRIGHT © BY DG GROUP ARCHITECTURE PLLC

COPYRIGHT DATE: 04/10/2023  
 DRAWN BY: BP  
 PROJECT#: DNG22-04



THIS DRAWING CONTAINS INFORMATION WHICH IS THE PROPRIETARY PROPERTY OF DOUGLAS L. GIBSON, NO UNAUTHORIZED REUSE OR REPLICATION OF THESE PLANS OR ANY INFORMATION CONTAINED HEREIN WITHOUT THE EXPRESS WRITTEN CONSENT OF DOUGLAS L. GIBSON. THIS DRAWING IS NOT TO BE USED FOR CONSTRUCTION UNLESS IT IS SIGNED BY THE ARCHITECT.



DG GROUP ARCHITECTURE PLLC  
 430 E. STATE STREET, SUITE 100  
 EAGLE, IDAHO 83616  
 (208) 392-2269 FAX

ALASKA - ARIZONA - CALIFORNIA - COLORADO - HAWAII - IDAHO - LOUISIANA - MONTANA - NEBRASKA - NEVADA - NEW MEXICO - NORTH DAKOTA - OREGON - SOUTH DAKOTA - UTAH - WASHINGTON - WYOMING

**HUNTINGTON APARTMENTS**  
 PROJECT  
 51771 HUNTINGTON RD  
 LA PINE, OR

**A1.1**  
 ARCHITECTURAL SITE PLAN

BUILDING PERMIT SET - 04/10/23