

KEYED NOTES - SITE PLAN
 1. INSERT NOTE HERE.

GENERAL NOTES - SITE PLAN

- A. SITE PLAN KEYED NOTES APPLY TO A000 SHEET SERIES. ALL KEYED NOTES MAY NOT OCCUR ON THIS SHEET AND DO NOT APPLY TO ANY OTHER SHEETS EXCEPT THOSE NOTED.
- B. ARCHITECTURAL REFERENCE ELEVATION 100'-0" = XXX'XX" ON SURVEY AND CIVIL DOCUMENTS.
- C. REFERENCE CIVIL AND LANDSCAPE DRAWINGS FOR ADDITIONAL SITEWORK INFORMATION.
- D. WORK IN THE RIGHT OF WAY IS SHOWN FOR REFERENCE ONLY. REFER TO SEPARATE RIGHT OF WAY IMPROVEMENT DRAWINGS FOR INFORMATION.
- E. REFERENCE ELECTRICAL DRAWINGS FOR LIGHTING SCHEDULE.

ADDITIONAL SITE INFORMATION

- A. ADD ALL OF THE EXTRA SITE INFORMATION NOTES HERE THAT DOESNT FIT ANYWHERE ELSE.

RESERVED FOR JURISDICTIONAL PROCESSING

LEGEND - SITE PLAN

- EXISTING PAVING AND/OR LANDSCAPE AREA
- ASPHALT PAVING
- EXISTING CONCRETE PAVING TO REMAIN
- CONCRETE PAVING
- EXISTING STRUCTURE TO REMAIN
- PARKING AND DRIVE STRIPING
- LANDSCAPE AREAS

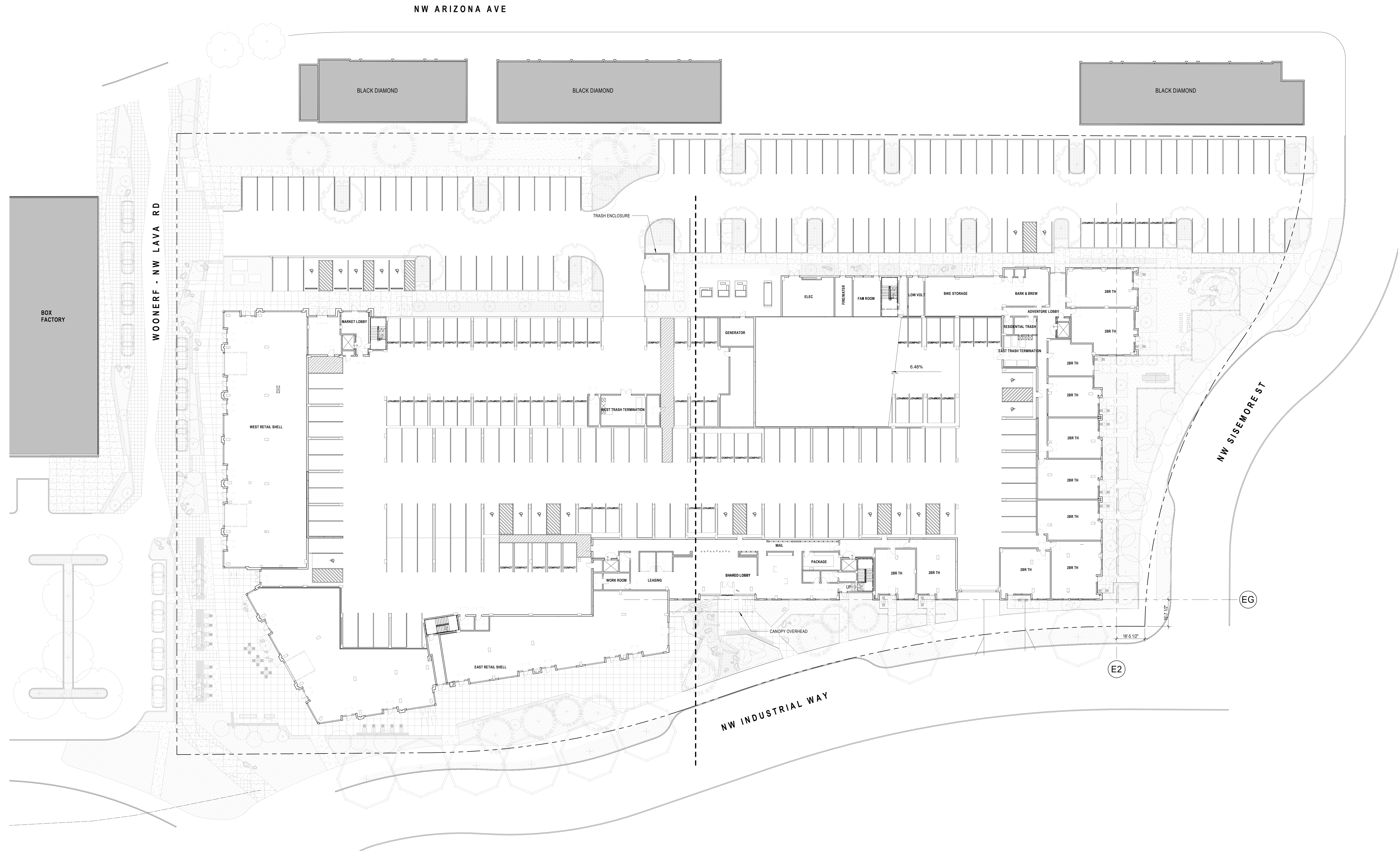

1 SITE PLAN
 1" = 20'-0"



ARCHITECTURE
 URBAN DESIGN + PLANNING
 INTERIOR DESIGN

PORTLAND, OREGON
 SERADESIGN.COM



JACKSTRAW
 INDUSTRIAL WAY CO2B LLC
 1800 NW INDUSTRIAL WAY
 BEASLEY, OR 97102

REVISIONS

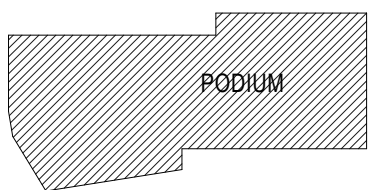

CHECKED BY: ARG
 ISSUE DATE: 2023.02.13
 PROJECT NO: 2103057

SITE PLAN
A051

GMP SET