

**SITE PLAN NOTES - SPECIFIC:**

- 1. STUB OUT AND CAP FOR FUTURE USE.
- 2. 11" X 18" X 12" IN-GRADE POLYMER CONCRETE JUNCTION BOX WITH BOLTED GASKETED COVER LABELED "LIGHTING", TIER 5 RATED OPEN BOTTOM WITH 12" STONE BASE, QUARTZITE PC SERIES OR EQUAL.
- 3. ELECTRICAL SERVICE PRIMARY/SECONDARY CONDUITS, TRANSFORMER, VAULT, BOLLARDS BY E.C. PER UTILITY CO. STANDARDS. COORDINATE AND VERIFY FINAL LOCATIONS WITH UTILITY CO.
- 4. VERIFY ALL ELECTRICAL INSTALLATIONS WITH SITE ENGINEERING DRAWINGS PRIOR TO PERFORMING WORK.
- 5. REFER TO RISER DIAGRAM FOR FEEDER/CIRCUIT SIZES.
- 6. 12" X 12" X 12" IN-GRADE POLYMER CONCRETE JUNCTION BOX WITH BOLTED GASKETED COVER LABELED "POWER", TIER 5 RATED OPEN BOTTOM WITH 12" STONE BASE, QUARTZITE PC SERIES OR EQUAL.
- 7. COORDINATE DISCONNECT LOCATION/MOUNTING AND CONNECTION REQUIREMENTS WITH GATE SUPPLIER.
- 8. 11" X 18" X 12" IN-GRADE POLYMER CONCRETE JUNCTION BOX WITH BOLTED GASKETED COVER LABELED "POWER", TIER 5 RATED OPEN BOTTOM WITH 12" STONE BASE, QUARTZITE PC SERIES OR EQUAL.
- 9. RECEPTACLE MOUNTED IN SECURITY PANEL CABINET. PROVIDE 120V BRANCH CIRCUIT, 2# 8 AWG IN SAME CONDUIT SERVING GATE.
- 10. EXISTING SHP WELL PUMP TO BE REPLACED BY OTHERS.

- 11. REMOVE EXISTING PUMP FEEDER CONDUCTORS. VERIFY EXISTING CONDUIT SIZE. REUSE FOR NEW PUMP FEEDER.
- 12. EXISTING ELECTRICAL PANEL. REPLACE EXISTING WELL PUMP BREAKER WITH NEW. REFER TO RISER DIAGRAM.
- 13. NEW VFD FURNISHED BY WELL PUMP SUPPLIER. E.C. TO INSTALL VFD AND PROVIDE NEW PRIMARY AND SECONDARY FEEDERS.
- 14. EXISTING OVERHEAD ELECTRICAL COMMUNICATIONS POLE LINE TO BE REMOVED BY UTILITY COMPANY.
- 15. NEW UNDERGROUND WATER LINE BY OTHERS. FOLLOW SIMILAR PATH/ROUTING WITH NEW PRIMARY ELECTRICAL CONDUIT.
- 16. TERMINATE 2-4" AT NEW UTILITY CO. POLE FOR 12KV PRIMARY ELECTRIC CONDUCTORS. COORDINATE STUB UP AT POLE WITH UTILITY CO. (CEC).
- 17. 2-4" FURNISHED AND INSTALLED BY E.C. PER UTILITY CO. STANDARDS FOR UTILITY COMPANY PRIMARY CONDUCTORS. PROVIDE PULL STRINGS PER CEC STANDARDS.
- 18. 12KV PRIMARY ELECTRIC VAULT FURNISHED AND INSTALLED BY E.C. PER UTILITY CO. (CEC) STANDARDS. COORDINATE/VERIFY FINAL LOCATIONS/QUANTITIES WITH UTILITY CO. DESIGN DRAWINGS.
- 19. E.C. TO FURNISH AND INSTALL VAULT SPAD, PROTECTION BOLLARDS, AND GROUNDING FOR UTILITY CO. TRANSFORMER PER CEC STANDARDS.

**SITE PLAN NOTES - GENERAL:**

- A. EACH BRANCH CIRCUIT SHALL HAVE AN INDIVIDUAL NEUTRAL. EACH NEUTRAL SHALL BE IDENTIFIED AT ALL JUNCTION BOXES AND TERMINALS THE SAME AS ITS CORRESPONDING BRANCH CIRCUIT NUMBER.
- B. ALL SITE CONDUITS SHALL BE A MINIMUM OF 1" SCHEDULE 40 PVC U.N.D.
- C. ALL SITE CONDUCTORS SHALL BE #10(0) MINIMUM U.N.D.
- D. ALL SITE CONDUITS SHALL BE INSTALLED A MINIMUM OF 30" BELOW FINISHED GRADE.
- E. RETURN ALL EXCAVATED AREAS TO ORIGINAL CONDITIONS. A MINIMUM OF SIX (6) INCHES OF TOPSOIL SHALL BE PLACED ON ALL GRASS AREAS.
- F. INSTALL A RED TRACER WARNING TAPE 12" BELOW FINISHED GRADE ABOVE ALL UNDERGROUND CONDUITS.

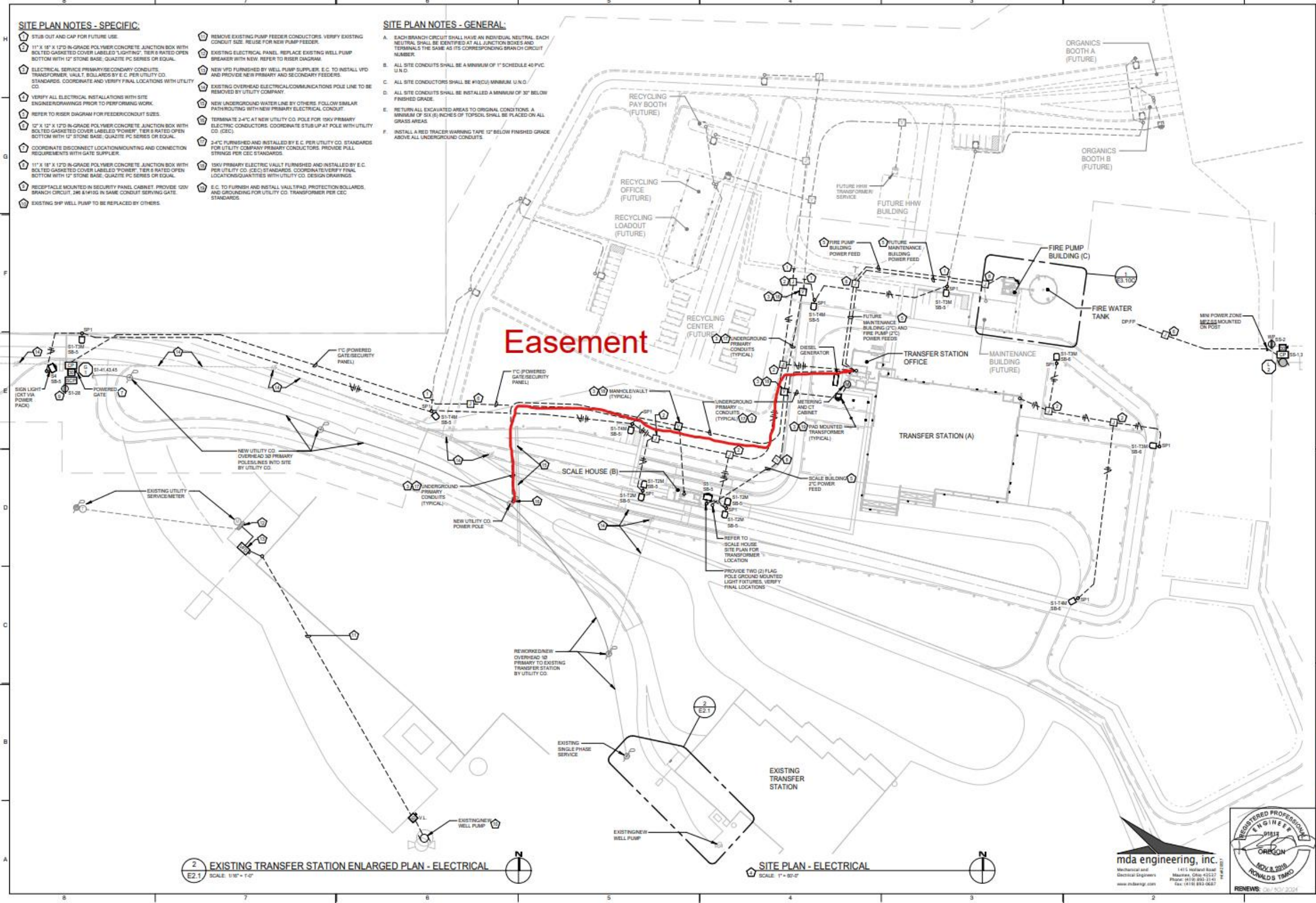

**2** EXISTING TRANSFER STATION ENLARGED PLAN - ELECTRICAL  
SCALE: 1/8" = 1'-0"

**1** SITE PLAN - ELECTRICAL  
SCALE: 1" = 80'-0"

NO.	DATE	DESCRIPTION

**CEE**  
**Civil & Environmental Consultants, Inc.**  
 4045 NW 64th Street - Suite 415 - Oklahoma City, OK 73116  
 PH: 405.246.9411  
 WWW.CEECONC.COM

**DESCHUTES COUNTY**  
**SOLID WASTE DEPARTMENT**  
 2400 NE MAPLE AVENUE  
 REDMOND, OREGON 97756

SITE PLAN - ELECTRICAL	
DATE	06-28-2023
DRAWN BY	TRAVARBY
CHECKED BY	AS NOTED
PROJECT NO.	200317
APPROVED BY	
DRAWING NO.	<b>E2.1</b>
SHEET	02

**mda engineering, inc.**  
 Mechanical and Electrical Engineers  
 1415 Holland Road  
 Mulvum, Ohio 43028  
 Phone: (614) 293-2141  
 Fax: (614) 883-0827  
 WWW.MDAENG.COM



RENEWS: 06/15/2024